

NO. OF COPIES RECEIVED	
DISTRIBUTION	
SANTA FE	
FILE	✓
U.S.G.S.	
LAND OFFICE	
OPERATOR	

5A. Indicate Type of Lease
STATE FEE

5. State Oil & Gas Lease No.
L 6631

APPLICATION FOR PERMIT TO DRILL, DEEPEN, OR PLUG BACK

1a. Type of Work

b. Type of Well DRILL DEEPEN PLUG BACK
OIL WELL GAS WELL OTHER SINGLE ZONE MULTIPLE ZONE

2. Name of Operator
Public Lands Exploration Co., Inc.

3. Address of Operator
4835 LBJ Freeway, Suite 635, Dallas, Texas 75234

4. Location of Well UNIT LETTER 0 LOCATED 990 FEET FROM THE South LINE AND 1650 FEET FROM THE East LINE OF SEC. 15 TWP. 11 N RGE. 25 E NMPM

7. Unit Agreement Name

8. Farm or Lease Name
State

9. Well No.
15

10. Field and Pool, or Wildcat
Wildcat

12. County
Guadalupe

19. Proposed Depth
415

19A. Formation
Chinle

20. Rotary or C.T.
Rotary

21. Elevations (Show whether DF, RT, etc.)
4577.4' GL

21A. Kind & Status Plug. Bond
Blanket

21B. Drilling Contractor
F. Rhymes Drlg. Co.

22. Approx. Date Work will start
December 7, 1980

PROPOSED CASING AND CEMENT PROGRAM

SIZE OF HOLE	SIZE OF CASING	WEIGHT PER FOOT	SETTING DEPTH	SACKS OF CEMENT	EST. TOP
11"	85/8"	24#	30'	10	Surface
77/8"	4 1/2"	10.5 #	415'	240	Surface

This well will be drilled with air. Blowout preventers will not be installed as a number of wells have been drilled in the field and no high pressure zones have been encountered. Oil zones encountered were saturated with an inactive oil which tested 15 degrees API gravity.

APPROVAL VALID FOR 90 DAYS
PERMIT EXPIRES 4-13-81
UNLESS DRILLING UNDERWAY

OIL CONSERVATION DIVISION COMMISSION TO BE NOTIFIED
WITHIN 24 HOURS OF BEGINNING OPERATIONS

ABOVE SPACE DESCRIBE PROPOSED PROGRAM: IF PROPOSAL IS TO DEEPEN OR PLUG BACK, GIVE DATA ON PRESENT PRODUCTIVE ZONE AND PROPOSED NEW PRODUCTIVE ZONE. GIVE BLOWOUT PREVENTER PROGRAM, IF ANY.

I hereby certify that the information above is true and complete to the best of my knowledge and belief.

Signed Charles C Joy Title Agent Date December 6, 1980
(This space for State Use)

APPROVED BY Carl Veloz TITLE AGENT DATE 1-13-81
CONDITIONS OF APPROVAL, IF ANY:

NEW MEXICO OIL CONSERVATION COMMISSION
WELL LOCATION AND ACREAGE DEDICATION PLAT

Form C-102
Supersedes C-101
Effective 1-1-61

All distances must be from the outer boundary of the Section.

Operator Public Lands Exploration Co., Inc.		Lease		State		Well No. #15
Unit Letter Q	Section 15	Township 11 North	Range 25 East	County Guadalupe		
Actual Footage Location of Well: 990 feet from the South line and 1650 feet from the East line						
Ground Level Elev. 4577.40	Producing Formation Chinle	Pool Wildcat	Dedicated Acreage: 40 Acres			

1. Outline the acreage dedicated to the subject well by colored pencil or hachure marks on the plat below.
2. If more than one lease is dedicated to the well, outline each and identify the ownership thereof (both as to working interest and royalty).
3. If more than one lease of different ownership is dedicated to the well, have the interests of all owners been consolidated by communitization, unitization, force-pooling, etc?
 Yes No If answer is "yes," type of consolidation _____

If answer is "no," list the owners and tract descriptions which have actually been consolidated. (Use reverse side of this form if necessary.) _____

No allowable will be assigned to the well until all interests have been consolidated (by communitization, unitization, forced-pooling, or otherwise) or until a non-standard unit, eliminating such interests, has been approved by the Commission.

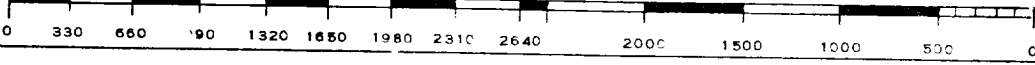
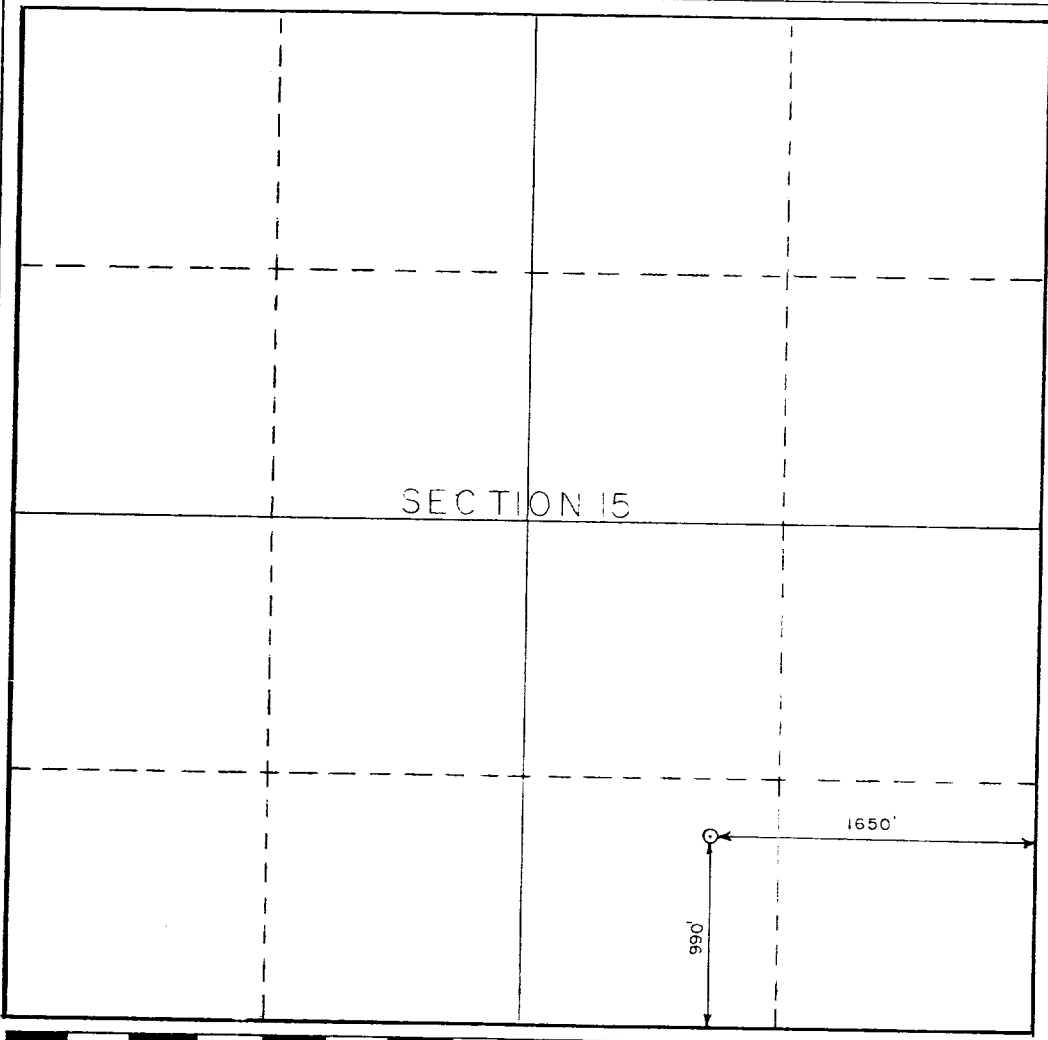

CERTIFICATION

I hereby certify that the information contained herein is true and complete to the best of my knowledge and belief.

Name
Charles C Joy

Position
Agent

Company
Public Lands Exploration Co., Inc

Date
12-9-1980

I hereby certify that the well location shown on this plat was plotted from field notes of actual surveys made by me or under my supervision, and that the same is true and correct to the best of my knowledge.

Date
December 9, 1980

By
Richard R. Drew

Registered Professional Engineer and/or Surveyor

Certificate No. **3276**