

NO. OF COPIES RECEIVED		
DISTRIBUTION		
SANTA FE		
FILE		✓
U.S.G.S.		
LAND OFFICE		
OPERATOR		

NEW MEXICO OIL CONSERVATION COMMISSION

API # 30-021-20033

Form C-101  
Revised 1-1-65

5A. Indicate Type of Lease

STATE  FEE

5. State Oil & Gas Lease No.

APPLICATION FOR PERMIT TO DRILL, DEEPEN, OR PLUG BACK

1a. Type of Work		7. Unit Agreement Name	
b. Type of Well DRILL <input checked="" type="checkbox"/> DEEPEN <input type="checkbox"/> PLUG BACK <input type="checkbox"/> OIL WELL <input type="checkbox"/> GAS WELL <input checked="" type="checkbox"/> OTHER (CO <sub>2</sub> Gas) SINGLE ZONE <input checked="" type="checkbox"/> MULTIPLE ZONE <input type="checkbox"/>		8. Farm or Lease Name Mitchell	
2. Name of Operator S.E.C. Corporation		9. Well No. 16	
3. Address of Operator P. O. Box 9737, El Paso, Texas 79987		10. Field and Pool, or Wildcat Wildcat	
4. Location of Well UNIT LETTER <u>J</u> LOCATED <u>1980</u> FEET FROM THE <u>South</u> LINE AND <u>1980</u> FEET FROM THE <u>East</u> LINE OF SEC. <u>5</u> TWP. <u>18N</u> PGE. <u>30E</u> NMPM		12. County Harding	
19. Proposed Depth 2100		19A. Formation Abo	20. Rotary or C.T. Rotary
21. Elevations (Show whether DF, RT, etc.) 4390 G.L.	21A. Kind & Status Plug. Bond Blanket Bond	21B. Drilling Contractor Service Drilling Co.	22. Approx. Date Work will start 3/15/75

PROPOSED CASING AND CEMENT PROGRAM

SIZE OF HOLE	SIZE OF CASING	WEIGHT PER FOOT	SETTING DEPTH	SACKS OF CEMENT	EST. TOP
12 1/4"	8-5/8"	24	150	150	Surface
7-7/8"	4 1/2"	9 1/2	2100	700	Surface

APPROVAL VALID  
FOR 90 DAYS FROM  
DATE OF COMPLETION,  
MAY 19, 1975

IN ABOVE SPACE DESCRIBE PROPOSED PROGRAM: IF PROPOSAL IS TO DEEPEN OR PLUG BACK, GIVE DATA ON PRESENT PRODUCTIVE ZONE AND PROPOSED NEW PRODUCTIVE ZONE. GIVE BLOWOUT PREVENTER PROGRAM, IF ANY.

I hereby certify that the information above is true and complete to the best of my knowledge and belief.

Signed P. F. Bealon Title Manager-Technical Services Date February 12, 1975

(This space for State Use)

APPROVED BY Carl Ulvog TITLE SENIOR PETROLEUM GEOLOGIST DATE Feb. 17, 1975

CONDITIONS OF APPROVAL, IF ANY:

NEW MEXICO OIL CONSERVATION COMMISSION  
WELL LOCATION AND ACREAGE DEDICATION PLAT

Form C-102  
Supersedes C-128  
Effective 1-1-65

All distances must be from the outer boundaries of the Section.

Operator <b>S.E.C. Corporation</b>		Lease <b>Mitchell</b>			Well No. <b>16</b>
Unit Letter <b>J</b>	Section <b>5</b>	Township <b>18N</b>	Range <b>30E</b>	County <b>Harding</b>	
Actual Footage Location of Well: <b>1980</b> feet from the <b>South</b> line and <b>1980</b> feet from the <b>East</b> line					
Ground Level Elev. <b>4390</b>	Producing Formation <b>Abo</b>	Pool <b>Wildcat</b>		Dedicated Acreage: <b>160</b> Acres	

1. Outline the acreage dedicated to the subject well by colored pencil or hachure marks on the plat below.
2. If more than one lease is dedicated to the well, outline each and identify the ownership thereof (both as to working interest and royalty).
3. If more than one lease of different ownership is dedicated to the well, have the interests of all owners been consolidated by communitization, unitization, force-pooling, etc?

Yes  No If answer is "yes," type of consolidation \_\_\_\_\_

If answer is "no," list the owners and tract descriptions which have actually been consolidated. (Use reverse side of this form if necessary.) \_\_\_\_\_

No allowable will be assigned to the well until all interests have been consolidated (by communitization, unitization, forced-pooling, or otherwise) or until a non-standard unit, eliminating such interests, has been approved by the Commission. Non-Standard unit approved. Case 5312, Order R-4870

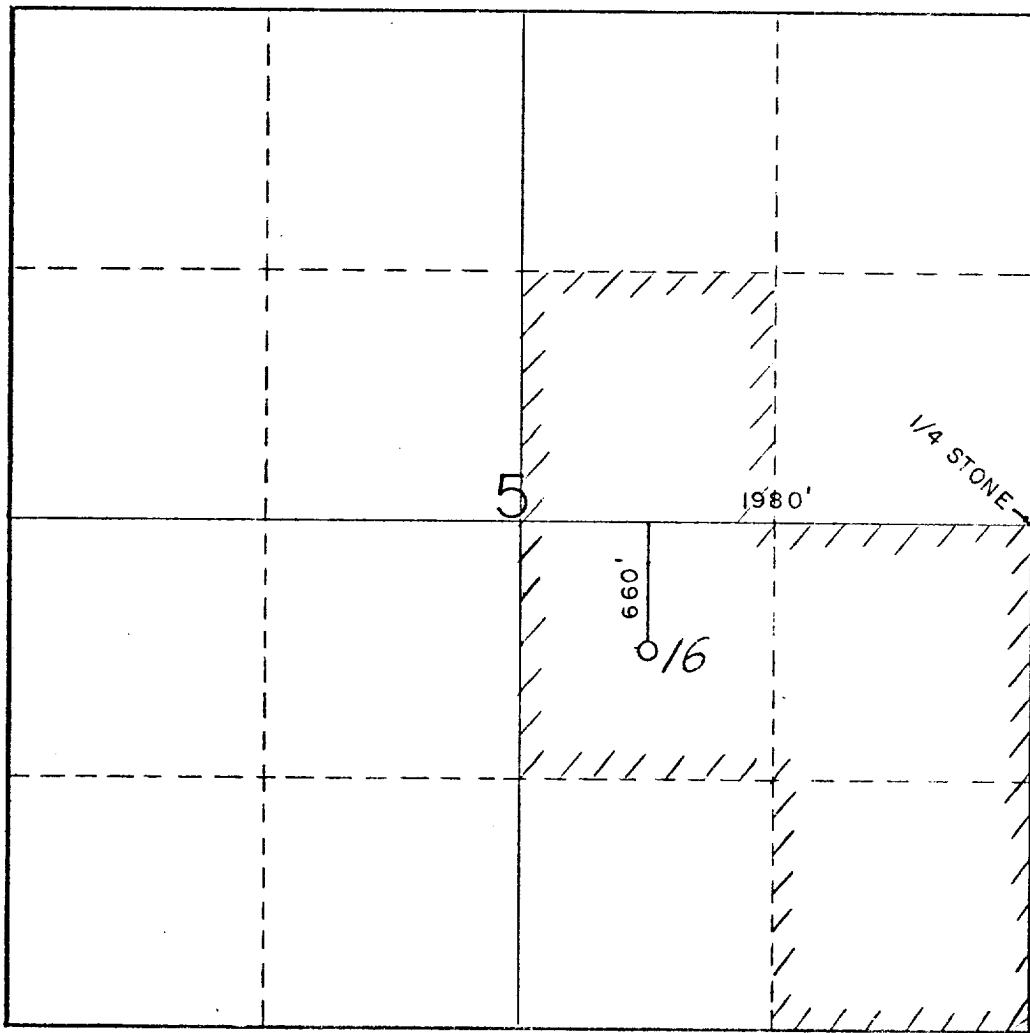

CERTIFICATION

I hereby certify that the information contained herein is true and complete to the best of my knowledge and belief.

*P. F. Beeler*

Name <b>P. F. Beeler</b>
Position <b>Manager-Technical Services</b>
Company <b>S.E.C. Corporation</b>
Date <b>February 12, 1975</b>

I hereby certify that the well location shown on this plat was plotted from field notes of actual surveys made by me or under my supervision, and that the same is true and correct to the best of my knowledge and belief.

Date Surveyed <b>January 6, 1975</b>
Registered Professional Engineer and/or Land Surveyor

*W. E. Shields*

Certificate No.  
**N.M.L.S. No. 5103**

