

3R - 111

2007 AGWMR

MAR 2008

XTO ENERGY INC.

ANNUAL GROUNDWATER REPORT

2007

***GARCIA GC B #1
(J) SECTION 21 – T29N – R10W, NMPM
SAN JUAN COUNTY, NEW MEXICO***

***PREPARED FOR:
MR. GLENN VON GONTEN
NEW MEXICO OIL CONSERVATION DIVISION***

January 2008

TABLE OF CONTENTS

Site Details	3
Previous Activities	3
Site Map	3
Summary Tables	3
Potentiometric Surface Diagrams	3
Annual Groundwater Remediation Reports.....	3
2007 Activities	3
Geologic Logs and Well Completion Diagrams	3
Disposition of Generated Wastes	3
Conclusions	4
Recommendations	4

Appendices

Table 1:	Summary Groundwater Laboratory Results
Figure 1:	Site Map
Figures 2 – 3:	Potentiometric Surface Diagrams
Attachment 1:	2007 Laboratory Reports

2007 XTO GROUNDWATER REPORT

GARCIA GAS COM B #1

SITE DETAILS

LEGALS - TWN: 29N	RNG: 10W	SEC: 21	UNIT: H
NMOCD HAZARD RANKING: 30		LAND TYPE: FEE	

PREVIOUS ACTIVITIES

Excavation: Aug-93

Monitoring Wells: Oct-Nov-99

Sampling Initiated: Nov-99

SITE MAP

A site map is presented as Figure 1.

SUMMARY TABLES

A summary of laboratory results from historical and current groundwater monitoring is presented as Table 1. Copies of the laboratory data sheets and associated quality assurance/quality control data for 2007 are presented as Attachment 1.

POTENTIOMETRIC SURFACE DIAGRAMS

Field data collected during site monitoring activities indicates a groundwater gradient that trends towards the northeast. Figures 2–3 illustrate the estimated groundwater gradients for the last two quarters of 2006, respectively. Sampling in monitoring well MW-3 was terminated in 2005 and was dry during 2007 leaving only two data points; therefore there are no diagrams for 2007.

ANNUAL GROUNDWATER REMEDIATION REPORTS

The 2005 annual groundwater report was submitted to New Mexico Oil Conservation Division (NMOCD) in January 2006, proposing termination of quarterly sampling of monitoring wells MW-1 and MW-3 and continued sampling of MW-2.

The 2006 annual groundwater report was submitted to NMOCD in February 2007, proposing continued sampling of MW-2 for hydrocarbon constituents on a quarterly schedule, in accordance with the NMOCD approved Groundwater Management Plan, until four (4) consecutive quarters reveal benzene, toluene, ethyl benzene and total xylenes (BTEX) below New Mexico Water Quality Control Commission (NMWQCC) standards.

2007 ACTIVITIES

Quarterly groundwater samples were collected from MW-2 in 2007 and submitted for laboratory analysis of BTEX. Laboratory results indicate BTEX constituents are below standards or not detectable for four (4) quarters.

GEOLOGIC LOGS AND WELL COMPLETION DIAGRAMS

No Bore/Test Hole Reports to present.

DISPOSITION OF GENERATED WASTES

Waste generated (groundwater) during monitoring well sampling and development was placed in the produced water tank located on the well site.

2007 XTO GROUNDWATER REPORT

CONCLUSIONS

January 1998 XTO Energy Inc. (XTO) acquired the Garcia Gas Com B #1 from Amoco Production Company. XTO understands the initial evaluation of groundwater impact came from samples of groundwater collected from the bottom of the earthen blow pit following excavation of hydrocarbon impacted soil. Laboratory analysis of the initial samples indicated elevated levels of dissolved phase BTEX constituents in groundwater. In 1999 three groundwater monitoring wells were installed to delineate the extent of hydrocarbon impact to groundwater. Monitoring well numbered MW-2 was installed near the center of the source area (closed and backfilled earthen blow pit). Monitoring well numbered MW-1 was placed down gradient of MW-2 and MW-3 was placed up gradient of MW-2. BTEX constituents were not detected above the laboratory equipment detection limits (0.2 ug/L) in MW-1 or MW-3. Termination of sampling was proposed in the 2005 annual groundwater report for these two monitoring wells.

Groundwater analytical data from MW-2 for four (4) consecutive quarters in 2007 have demonstrated no detectable levels of BTEX constituents or concentrations below closure standards. NMWQCC standards have been met. Therefore, XTO requests closure of this site.

RECOMMENDATIONS

- XTO requests closure of this site.
- Following OCD approval for closure, all monitoring well locations will be abandoned in accordance with the monitoring well abandonment plan.

TABLE 1

XTO ENERGY INC. GROUNDWATER LAB RESULTS

GARCIA GC B #1- BLOW PIT UNIT J, SEC. 21, T29N, R10W

Sample Date	Monitor Well No.	DTW (ft)	TD (ft)	Product (ft)	BTEX EPA Method 801 (ppb)			
					Benzene (ug/L)	Toluene (ug/L)	Ethyl Benzene (ug/L)	Total Xylene (ug/L)
18-Nov-99	MW #1	31.06	37.00		64.9	46.8	36.7	302.2
14-Mar-00		32.97			1.3	ND	46	303.4
05-Jun-00		29.92			1.5	ND	33	242.4
30-Aug-00		29.24			ND	ND	32	191.1
19-Mar-01		32.86			ND	ND	39	212.6
18-Nov-99	MW #2	27.98	35.00		449	104	369	1454
14-Mar-00		29.83			ND	ND	70	3800
05-Jun-00		26.6			4.9	14	65	5,405.8
16-May-01		28.64			2.2	ND	47	2,901.3
24-Sep-01		26.82			ND	13	45	3,202.3
25-Jun-02		25.11			ND	7.9	14	460
27-Aug-02		25.73			ND	ND	15	420
09-Dec-02		28.45			ND	8.3	29	1,103.4
27-Jun-03		25.75			ND	ND	ND	330
25-Aug-03		25.34			ND	3.4	6.9	110
19-Nov-03		27.68			ND	ND	17	300
30-Mar-04		29.50			ND	ND	28	640
25-Feb-06		29.08			ND	ND	ND	340
24-May-06					ND	19	ND	690
31-Aug-06		25.34	33.10		2.3	ND	2	110
28-Nov-06		27.52	33.43		ND	2.1	4.8	190
19-Feb-07		27.35	33.10		ND	ND	3.8	220
17-May-07		24.97	33.10		ND	1.5	1.4	74
09-Aug-07		22.87	33.10		5.7	6.2	ND	6.5
27-Nov-07		26.08	33.10		ND	ND	3.5	33
18-Nov-99	MW #3	27.07	38.00		25.8	65.6	158	799
14-Mar-00		28.86			ND	ND	ND	ND
05-Jun-00		25.39			ND	ND	ND	ND
19-Mar-01		28.74			ND	ND	ND	ND
16-May-01		27.49			ND	ND	ND	ND
24-Sep-01		25.77			ND	ND	ND	ND
NMWQCC GROUNDWATER STANDARDS					10	750	750	620

FIGURE 1

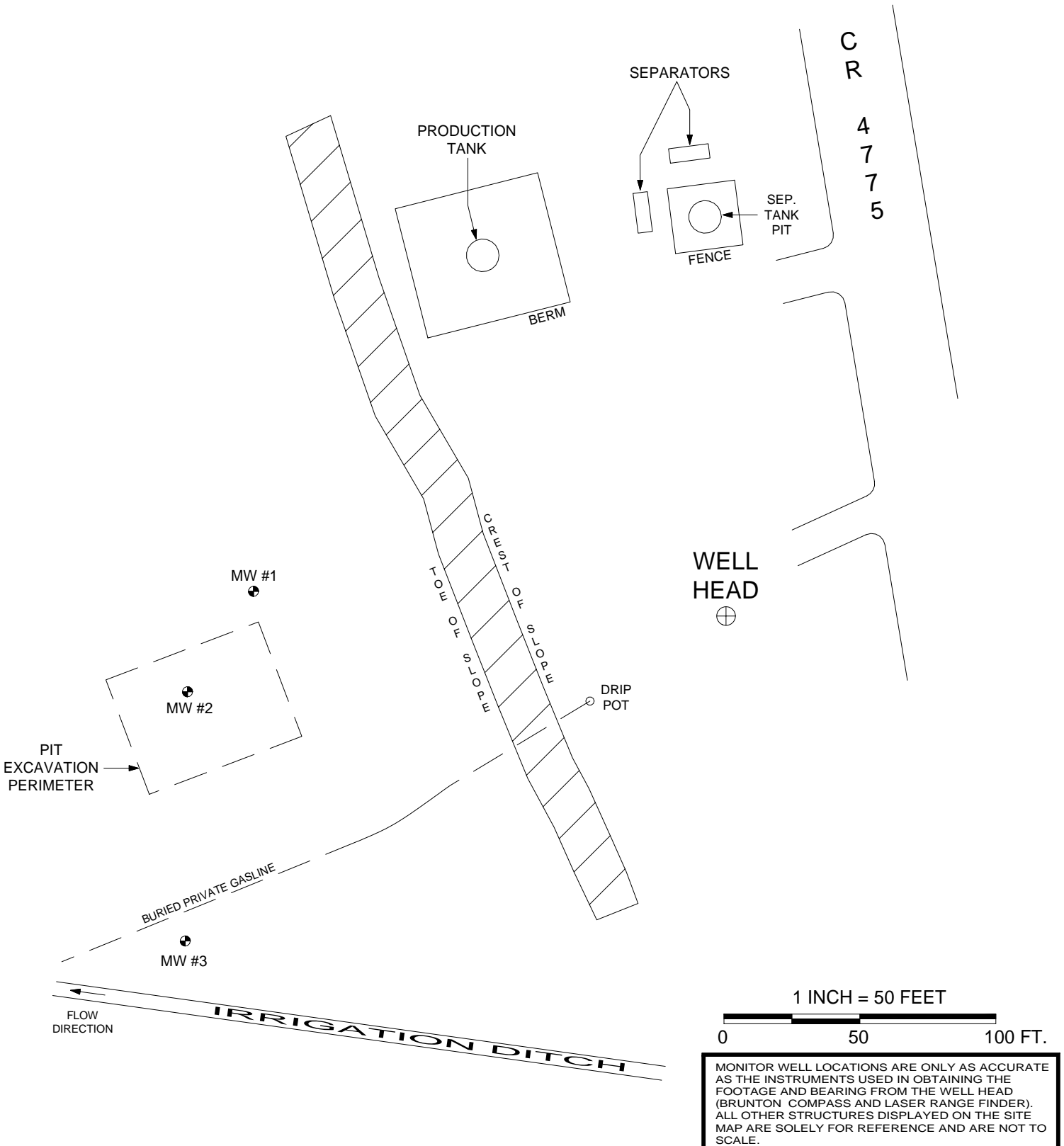

MONITOR WELL LOCATIONS ARE ONLY AS ACCURATE AS THE INSTRUMENTS USED IN OBTAINING THE FOOTAGE AND BEARING FROM THE WELL HEAD (BRUNTON COMPASS AND LASER RANGE FINDER). ALL OTHER STRUCTURES DISPLAYED ON THE SITE MAP ARE SOLELY FOR REFERENCE AND ARE NOT TO SCALE.

XTO ENERGY INC.

GARCIA GC B # 1

NW/4 SE/4 SEC. 21, T29N, R10W

SAN JUAN COUNTY, NEW MEXICO

BLAGG ENGINEERING, INC.

CONSULTING PETROLEUM / RECLAMATION SERVICES

P.O. BOX 87
BLOOMFIELD, NEW MEXICO 87413

PHONE: (505) 632-1199

PROJECT: MW SAMPLING

DRAWN BY: NJV

FILENAME: 06-05-00-SM.SKF

REVISED: 11/10/05 NJV

**SITE
MAP**

06/00



TOE OF SLOPE

MW-1
TOC = 89.38
GWEL = 63.92

PIT
EXCAVATION
PERIMETER

MW-2
TOC = 89.38
GWEL = 64.04

Flow = 0.002

64.0

BURIED PRIVATE GASLINE

64.1

MW-3
TOC = 88.46
GWEL = 64.12

FLOW
DIRECTION

IRRIGATION DITCH

MONITORING WELL LOCATIONS ARE ONLY AS ACCURATE AS THE INSTRUMENTS USED IN OBTAINING THE FOOTAGE AND BEARING FROM THE WELL HEAD (BRUNTON COMPASS AND LASER RANGE FINDER). ALL OTHER STRUCTURES DISPLAYED ON THE SITE MAP ARE SOLELY FOR REFERENCE AND MAY NOT BE TO SCALE.

TOC = TOP OF CASING ELEVATION
GWEL = GROUNDWATER ELEVATION
--- = INFERRED GROUNDWATER CONTOUR LINE

1 INCH = 25 FEET

0 25 50 FT.

Lodestar Services, Inc
PO Box 3861
Farmington, NM 87499

GARCIA GAS COM B #1
NW/4 SE/4 SEC. 21, T29N, R10W
SAN JUAN COUNTY, NEW MEXICO

PROJECT: XTO GROUND WATER
DRAWN BY: ALA
REVISED: 12/04/06

FIGURE 2
GROUNDWATER
ELEVATIONS
08/31/2006



PIT
EXCAVATION
PERIMETER

MW-2
TOC = 89.38
GWEL = 61.86

MW-1
TOC = 89.38
GWEL = 61.70

Flow = 0.002

61.70

61.80

61.90

MW-3
TOC = 88.46
GWEL = 61.91

FLOW
DIRECTION

BURIED PRIVATE GASLINE

IRRIGATION DITCH

TOE OF SLOPE

MONITORING WELL LOCATIONS ARE ONLY AS ACCURATE AS THE INSTRUMENTS USED IN OBTAINING THE FOOTAGE AND BEARING FROM THE WELL HEAD (BRUNTON COMPASS AND LASER RANGE FINDER). ALL OTHER STRUCTURES DISPLAYED ON THE SITE MAP ARE SOLELY FOR REFERENCE AND MAY NOT BE TO SCALE.

TOC = TOP OF CASING ELEVATION
GWEL = GROUNDWATER ELEVATION
--- = INFERRED GROUNDWATER CONTOUR LINE

1 INCH = 25 FEET

0 25 50 FT.

Lodestar Services, Inc
PO Box 3861
Farmington, NM 87499

GARCIA GAS COM B #1
NW/4 SE/4 SEC. 21, T29N, R10W
SAN JUAN COUNTY, NEW MEXICO

PROJECT: XTO GROUND WATER
DRAWN BY: ALA
REVISED: 12/04/06

FIGURE 3
GROUNDWATER
ELEVATIONS
11/28/2006

Hall Environmental Analysis Laboratory, Inc.

Date: 26-Feb-07

CLIENT: XTO Energy
Project: Ground Water

Lab Order: 0702229

Lab ID: 0702229-10

Collection Date: 2/19/2007 12:42:00 PM

Client Sample ID: ~~Abrams JI MW 9~~

Matrix: AQUEOUS

Analyses	Result	PQL	Qual	Units	DF	Date Analyzed
EPA METHOD 8021B: VOLATILES						Analyst: NSB
Methyl tert-butyl ether (MTBE)	ND	2.5		µg/L	1	2/22/2007 2:25:42 PM
Benzene	ND	1.0		µg/L	1	2/22/2007 2:25:42 PM
Toluene	ND	1.0		µg/L	1	2/22/2007 2:25:42 PM
Ethylbenzene	ND	1.0		µg/L	1	2/22/2007 2:25:42 PM
Xylenes, Total	ND	2.0		µg/L	1	2/22/2007 2:25:42 PM
1,2,4-Trimethylbenzene	ND	1.0		µg/L	1	2/22/2007 2:25:42 PM
1,3,5-Trimethylbenzene	ND	1.0		µg/L	1	2/22/2007 2:25:42 PM
Surr: 4-Bromofluorobenzene	87.6	70.2-105		%REC	1	2/22/2007 2:25:42 PM

Lab ID: 0702229-11

Collection Date: 2/19/2007 1:30:00 PM

Client Sample ID: Garcia GC BI MW-2

Matrix: AQUEOUS

Analyses	Result	PQL	Qual	Units	DF	Date Analyzed
EPA METHOD 8021B: VOLATILES						Analyst: NSB
Methyl tert-butyl ether (MTBE)	ND	2.5		µg/L	1	2/22/2007 5:25:50 PM
Benzene	ND	1.0		µg/L	1	2/22/2007 5:25:50 PM
Toluene	ND	1.0		µg/L	1	2/22/2007 5:25:50 PM
Ethylbenzene	3.8	1.0		µg/L	1	2/22/2007 5:25:50 PM
Xylenes, Total	220	10		µg/L	5	2/23/2007 9:41:27 AM
1,2,4-Trimethylbenzene	190	5.0		µg/L	5	2/23/2007 9:41:27 AM
1,3,5-Trimethylbenzene	94	5.0		µg/L	5	2/23/2007 9:41:27 AM
Surr: 4-Bromofluorobenzene	89.6	70.2-105		%REC	1	2/22/2007 5:25:50 PM

Lab ID: 0702229-12

Collection Date:

Client Sample ID: 19022006TB01

Matrix: TRIP BLANK

Analyses	Result	PQL	Qual	Units	DF	Date Analyzed
EPA METHOD 8021B: VOLATILES						Analyst: NSB
Methyl tert-butyl ether (MTBE)	ND	2.5		µg/L	1	2/22/2007 6:26:19 PM
Benzene	ND	1.0		µg/L	1	2/22/2007 6:26:19 PM
Toluene	ND	1.0		µg/L	1	2/22/2007 6:26:19 PM
Ethylbenzene	ND	1.0		µg/L	1	2/22/2007 6:26:19 PM
Xylenes, Total	ND	2.0		µg/L	1	2/22/2007 6:26:19 PM
1,2,4-Trimethylbenzene	ND	1.0		µg/L	1	2/22/2007 6:26:19 PM
1,3,5-Trimethylbenzene	ND	1.0		µg/L	1	2/22/2007 6:26:19 PM
Surr: 4-Bromofluorobenzene	86.5	70.2-105		%REC	1	2/22/2007 6:26:19 PM

Qualifiers: * Value exceeds Maximum Contaminant Level

E Value above quantitation range

J Analyte detected below quantitation limits

ND Not Detected at the Reporting Limit

S Spike recovery outside accepted recovery limits 4 / 8

B Analyte detected in the associated Method Blank

H Holding times for preparation or analysis exceeded

MCL Maximum Contaminant Level

RL Reporting Limit

QA/QC SUMMARY REPORT

Client: XTO Energy
Project: Ground Water

Work Order: 0702229

Analyte	Result	Units	PQL	%Rec	LowLimit	HighLimit	%RPD	RPDLimit	Qual
---------	--------	-------	-----	------	----------	-----------	------	----------	------

Method: SW8021

Sample ID: 0702229-10A MSD

MSD

Batch ID: R22570 Analysis Date: 2/22/2007 3:25:51 PM

Methyl tert-butyl ether (MTBE)	19.30	µg/L	2.5	96.5	51.2	138	0.897	28
Benzene	19.64	µg/L	1.0	98.2	85.9	113	2.69	27
Toluene	19.77	µg/L	1.0	98.8	86.4	113	1.36	19
Ethylbenzene	19.78	µg/L	1.0	98.9	83.5	118	2.27	10
Xylenes, Total	59.88	µg/L	2.0	99.8	83.4	122	2.13	13
1,2,4-Trimethylbenzene	19.41	µg/L	1.0	97.1	83.5	115	2.48	21
1,3,5-Trimethylbenzene	19.43	µg/L	1.0	97.2	85.2	113	2.27	10

Sample ID: 5ML REAGENT BLA

MBLK

Batch ID: R22570 Analysis Date: 2/22/2007 8:13:34 AM

Methyl tert-butyl ether (MTBE)	ND	µg/L	2.5					
Benzene	ND	µg/L	1.0					
Toluene	ND	µg/L	1.0					
Ethylbenzene	ND	µg/L	1.0					
Xylenes, Total	ND	µg/L	2.0					
1,2,4-Trimethylbenzene	ND	µg/L	1.0					
1,3,5-Trimethylbenzene	ND	µg/L	1.0					

Sample ID: 5ML REAGENT BLA

MBLK

Batch ID: R22594 Analysis Date: 2/23/2007 8:08:20 AM

Methyl tert-butyl ether (MTBE)	ND	µg/L	2.5					
Benzene	ND	µg/L	1.0					
Toluene	ND	µg/L	1.0					
Ethylbenzene	ND	µg/L	1.0					
Xylenes, Total	ND	µg/L	2.0					
1,2,4-Trimethylbenzene	ND	µg/L	1.0					
1,3,5-Trimethylbenzene	ND	µg/L	1.0					

Sample ID: 100NG BTEX LCS

LCS

Batch ID: R22570 Analysis Date: 2/22/2007 3:55:54 PM

Methyl tert-butyl ether (MTBE)	19.74	µg/L	2.5	98.7	51.2	138		
Benzene	20.24	µg/L	1.0	101	85.9	113		
Toluene	20.28	µg/L	1.0	101	86.4	113		
Ethylbenzene	20.44	µg/L	1.0	102	83.5	118		
Xylenes, Total	61.89	µg/L	2.0	103	83.4	122		
1,2,4-Trimethylbenzene	20.52	µg/L	1.0	103	83.5	115		
1,3,5-Trimethylbenzene	20.33	µg/L	1.0	102	85.2	113		

Sample ID: 100NG BTEX LCS

LCS

Batch ID: R22594 Analysis Date: 2/23/2007 8:14:12 PM

Methyl tert-butyl ether (MTBE)	17.63	µg/L	2.5	88.2	51.2	138		
Benzene	20.52	µg/L	1.0	103	85.9	113		
Toluene	20.30	µg/L	1.0	102	86.4	113		
Ethylbenzene	20.25	µg/L	1.0	101	83.5	118		
Xylenes, Total	61.56	µg/L	2.0	103	83.4	122		
1,2,4-Trimethylbenzene	20.17	µg/L	1.0	101	83.5	115		
1,3,5-Trimethylbenzene	20.03	µg/L	1.0	100	85.2	113		

Sample ID: 0702229-10A MS

MS

Batch ID: R22570 Analysis Date: 2/22/2007 2:55:46 PM

Methyl tert-butyl ether (MTBE)	19.48	µg/L	2.5	97.4	51.2	138		
Benzene	20.17	µg/L	1.0	101	85.9	113		
Toluene	20.04	µg/L	1.0	100	86.4	113		

Qualifiers:

E Value above quantitation range
J Analyte detected below quantitation limits
R RPD outside accepted recovery limits

H Holding times for preparation or analysis exceeded
ND Not Detected at the Reporting Limit
S Spike recovery outside accepted recovery limits

QA/QC SUMMARY REPORT

Client: XTO Energy
Project: Ground Water

Work Order: 0702229

Analyte	Result	Units	PQL	%Rec	LowLimit	HighLimit	%RPD	RPDLimit	Qual
---------	--------	-------	-----	------	----------	-----------	------	----------	------

Method: SW8021

Sample ID: 0702229-10A MS

MS

Batch ID: R22570 Analysis Date: 2/22/2007 2:55:46 PM

Ethylbenzene	20.24	µg/L	1.0	101	83.5	118			
Xylenes, Total	61.17	µg/L	2.0	102	83.4	122			
1,2,4-Trimethylbenzene	19.90	µg/L	1.0	99.5	83.5	115			
1,3,5-Trimethylbenzene	19.88	µg/L	1.0	99.4	85.2	113			

Qualifiers:

E	Value above quantitation range	H	Holding times for preparation or analysis exceeded
J	Analyte detected below quantitation limits	ND	Not Detected at the Reporting Limit
R	RPD outside accepted recovery limits	S	Spike recovery outside accepted recovery limits

Hall Environmental Analysis Laboratory, Inc.

Date: 29-May-07

CLIENT: XTO Energy
Project: Ground Water

Lab Order: 0705289

Lab ID: 0705289-04 Collection Date: 5/17/2007 10:46:00 AM

Client Sample ID: ~~OH Randel #7 MW-5~~ Matrix: AQUEOUS

Analyses	Result	PQL	Qual	Units	DF	Date Analyzed
EPA METHOD 8021B: VOLATILES						Analyst: NSB
Benzene	ND	1.0		µg/L	1	5/24/2007 4:29:40 PM
Toluene	ND	1.0		µg/L	1	5/24/2007 4:29:40 PM
Ethylbenzene	ND	1.0		µg/L	1	5/24/2007 4:29:40 PM
Xylenes, Total	ND	2.0		µg/L	1	5/24/2007 4:29:40 PM
Surr: 4-Bromofluorobenzene	87.1	70.2-105		%REC	1	5/24/2007 4:29:40 PM

Lab ID: 0705289-05 Collection Date: 5/17/2007 11:35:00 AM

Client Sample ID: ~~OH Randel #7 MW-8~~ Matrix: AQUEOUS

Analyses	Result	PQL	Qual	Units	DF	Date Analyzed
EPA METHOD 8021B: VOLATILES						Analyst: NSB
Benzene	ND	1.0		µg/L	1	5/24/2007 4:59:40 PM
Toluene	1.9	1.0		µg/L	1	5/24/2007 4:59:40 PM
Ethylbenzene	ND	1.0		µg/L	1	5/24/2007 4:59:40 PM
Xylenes, Total	3.7	2.0		µg/L	1	5/24/2007 4:59:40 PM
Surr: 4-Bromofluorobenzene	86.6	70.2-105		%REC	1	5/24/2007 4:59:40 PM

Lab ID: 0705289-06 Collection Date: 5/17/2007 12:33:00 PM

Client Sample ID: Garcia GCB #1 MW-2 Matrix: AQUEOUS

Analyses	Result	PQL	Qual	Units	DF	Date Analyzed
EPA METHOD 8021B: VOLATILES						Analyst: NSB
Benzene	ND	1.0		µg/L	1	5/24/2007 12:07:24 AM
Toluene	1.5	1.0		µg/L	1	5/24/2007 12:07:24 AM
Ethylbenzene	1.4	1.0		µg/L	1	5/24/2007 12:07:24 AM
Xylenes, Total	74	2.0		µg/L	1	5/24/2007 12:07:24 AM
Surr: 4-Bromofluorobenzene	91.4	70.2-105		%REC	1	5/24/2007 12:07:24 AM

Qualifiers: * Value exceeds Maximum Contaminant Level
E Value above quantitation range
J Analyte detected below quantitation limits
ND Not Detected at the Reporting Limit
S Spike recovery outside accepted recovery limits

B Analyte detected in the associated Method Blank
H Holding times for preparation or analysis exceeded
MCL Maximum Contaminant Level
RL Reporting Limit

QA/QC SUMMARY REPORT

Client: XTO Energy
Project: Ground Water

Work Order: 0705289

Analyte	Result	Units	PQL	%Rec	LowLimit	HighLimit	%RPD	RPDLimit	Qual
Method: SW8021									
Sample ID: 0705289-02A MSD		<i>MSD</i>			Batch ID: R23705		Analysis Date: 5/23/2007 9:34:21 PM		
Benzene	19.06	µg/L	1.0	95.3	85.9	113	0.794	27	
Toluene	19.13	µg/L	1.0	95.7	86.4	113	0.812	19	
Ethylbenzene	19.00	µg/L	1.0	95.0	83.5	118	0.462	10	
Xylenes, Total	56.16	µg/L	2.0	93.6	83.4	122	0.901	13	
Sample ID: 0705289-16A MSD		<i>MSD</i>			Batch ID: R23752		Analysis Date: 5/25/2007 10:32:54 AM		
Benzene	20.43	µg/L	1.0	102	85.9	113	1.85	27	
Toluene	20.97	µg/L	1.0	105	86.4	113	1.52	19	
Ethylbenzene	20.81	µg/L	1.0	104	83.5	118	2.27	10	
Xylenes, Total	61.35	µg/L	2.0	102	83.4	122	1.79	13	
Sample ID: 5ML RB-II		<i>MBLK</i>			Batch ID: R23705		Analysis Date: 5/23/2007 10:03:56 AM		
Benzene	ND	µg/L	1.0						
Toluene	ND	µg/L	1.0						
Ethylbenzene	ND	µg/L	1.0						
Xylenes, Total	ND	µg/L	2.0						
Sample ID: 5ML REAGENT BLA		<i>MBLK</i>			Batch ID: R23736		Analysis Date: 5/24/2007 8:33:09 AM		
Benzene	ND	µg/L	1.0						
Toluene	ND	µg/L	1.0						
Ethylbenzene	ND	µg/L	1.0						
Xylenes, Total	ND	µg/L	2.0						
Sample ID: 5ML REAGENT BLA		<i>MBLK</i>			Batch ID: R23752		Analysis Date: 5/25/2007 8:32:19 AM		
Benzene	ND	µg/L	1.0						
Toluene	ND	µg/L	1.0						
Ethylbenzene	ND	µg/L	1.0						
Xylenes, Total	ND	µg/L	2.0						
Sample ID: 100NG BTEX LCS		<i>LCS</i>			Batch ID: R23705		Analysis Date: 5/23/2007 11:04:02 AM		
Benzene	18.93	µg/L	1.0	94.6	85.9	113			
Toluene	19.74	µg/L	1.0	98.7	86.4	113			
Ethylbenzene	19.87	µg/L	1.0	99.3	83.5	118			
Xylenes, Total	60.16	µg/L	2.0	100	83.4	122			
Sample ID: 100NG BTEX LCS		<i>LCS</i>			Batch ID: R23736		Analysis Date: 5/24/2007 9:38:17 PM		
Benzene	19.56	µg/L	1.0	97.8	85.9	113			
Toluene	19.93	µg/L	1.0	99.7	86.4	113			
Ethylbenzene	19.97	µg/L	1.0	99.9	83.5	118			
Xylenes, Total	59.82	µg/L	2.0	99.7	83.4	122			
Sample ID: 100NG BTEX LCS		<i>LCS</i>			Batch ID: R23752		Analysis Date: 5/25/2007 2:03:57 PM		
Benzene	19.64	µg/L	1.0	98.2	85.9	113			
Toluene	20.09	µg/L	1.0	100	86.4	113			
Ethylbenzene	19.98	µg/L	1.0	99.9	83.5	118			
Xylenes, Total	59.73	µg/L	2.0	99.5	83.4	122			
Sample ID: 0705289-02A MS		<i>MS</i>			Batch ID: R23705		Analysis Date: 5/23/2007 9:04:25 PM		
Benzene	19.21	µg/L	1.0	96.0	85.9	113			
Toluene	19.29	µg/L	1.0	96.4	86.4	113			

Qualifiers:

E	Value above quantitation range	H	Holding times for preparation or analysis exceeded
J	Analyte detected below quantitation limits	ND	Not Detected at the Reporting Limit
R	RPD outside accepted recovery limits	S	Spike recovery outside accepted recovery limits

QA/QC SUMMARY REPORT

Client: XTO Energy
Project: Ground Water

Work Order: 0705289

Analyte	Result	Units	PQL	%Rec	LowLimit	HighLimit	%RPD	RPDLimit	Qual
---------	--------	-------	-----	------	----------	-----------	------	----------	------

Method: SW8021

Sample ID: 0705289-02A MS

MS

Batch ID: R23705

Analysis Date: 5/23/2007 9:04:25 PM

Ethylbenzene 19.09 µg/L 1.0 95.4 83.5 118

Xylenes, Total 56.66 µg/L 2.0 94.4 83.4 122

Sample ID: 0705289-16A MS

MS

Batch ID: R23752

Analysis Date: 5/25/2007 10:02:41 AM

Benzene 20.05 µg/L 1.0 100 85.9 113

Toluene 20.66 µg/L 1.0 103 86.4 113

Ethylbenzene 20.34 µg/L 1.0 102 83.5 118

Xylenes, Total 60.26 µg/L 2.0 99.8 83.4 122

Qualifiers:

E Value above quantitation range

J Analyte detected below quantitation limits

R RPD outside accepted recovery limits

H Holding times for preparation or analysis exceeded

ND Not Detected at the Reporting Limit

S Spike recovery outside accepted recovery limits

Hall Environmental Analysis Laboratory, Inc.

Date: 20-Aug-07

CLIENT: XTO Energy
Project: Groundwater

Lab Order: 0708171

Lab ID: 0708171-04

Collection Date: 8/9/2007 4:11:00 PM

Client Sample ID: ~~OH Randel #7 MW-8~~

Matrix: AQUEOUS

Analyses	Result	PQL	Qual	Units	DF	Date Analyzed
EPA METHOD 8021B: VOLATILES						Analyst: SMP
Benzene	ND	1.0		µg/L	1	8/17/2007 5:45:31 PM
Toluene	ND	1.0		µg/L	1	8/17/2007 5:45:31 PM
Ethylbenzene	ND	1.0		µg/L	1	8/17/2007 5:45:31 PM
Xylenes, Total	ND	2.0		µg/L	1	8/17/2007 5:45:31 PM
Surr: 4-Bromofluorobenzene	83.1	70.2-105		%REC	1	8/17/2007 5:45:31 PM

Lab ID: 0708171-05

Collection Date: 8/9/2007 4:40:00 PM

Client Sample ID: Garcia GC B#1 MW-2

Matrix: AQUEOUS

Analyses	Result	PQL	Qual	Units	DF	Date Analyzed
EPA METHOD 8021B: VOLATILES						Analyst: SMP
Benzene	5.7	1.0		µg/L	1	8/17/2007 6:15:25 PM
Toluene	6.2	1.0		µg/L	1	8/17/2007 6:15:25 PM
Ethylbenzene	ND	1.0		µg/L	1	8/17/2007 6:15:25 PM
Xylenes, Total	6.5	2.0		µg/L	1	8/17/2007 6:15:25 PM
Surr: 4-Bromofluorobenzene	83.4	70.2-105		%REC	1	8/17/2007 6:15:25 PM

Lab ID: 0708171-06

Collection Date:

Client Sample ID: Trip Blank

Matrix: TRIP BLANK

Analyses	Result	PQL	Qual	Units	DF	Date Analyzed
EPA METHOD 8021B: VOLATILES						Analyst: SMP
Benzene	ND	1.0		µg/L	1	8/17/2007 6:45:18 PM
Toluene	ND	1.0		µg/L	1	8/17/2007 6:45:18 PM
Ethylbenzene	ND	1.0		µg/L	1	8/17/2007 6:45:18 PM
Xylenes, Total	ND	2.0		µg/L	1	8/17/2007 6:45:18 PM
Surr: 4-Bromofluorobenzene	79.2	70.2-105		%REC	1	8/17/2007 6:45:18 PM

Qualifiers: * Value exceeds Maximum Contaminant Level
E Value above quantitation range
J Analyte detected below quantitation limits
ND Not Detected at the Reporting Limit
S Spike recovery outside accepted recovery limits

B Analyte detected in the associated Method Blank
H Holding times for preparation or analysis exceeded
MCL Maximum Contaminant Level
RL Reporting Limit

QA/QC SUMMARY REPORT

Client: XTO Energy
Project: Groundwater

Work Order: 0708171

Analyte	Result	Units	PQL	%Rec	LowLimit	HighLimit	%RPD	RPDLimit	Qual
Method: SW8021									
Sample ID: 0708171-01A MSD		<i>MSD</i>							
					Batch ID: R24814	Analysis Date: 8/17/2007 3:15:30 PM			
Benzene	19.21	µg/L	1.0	95.6	85.9	113	0.943	27	
Toluene	18.74	µg/L	1.0	92.8	86.4	113	1.65	19	
Ethylbenzene	19.19	µg/L	1.0	95.4	83.5	118	0.125	10	
Xylenes, Total	56.88	µg/L	2.0	94.1	83.4	122	0.962	13	
Sample ID: 5ML RB		<i>MBLK</i>							
					Batch ID: R24814	Analysis Date: 8/17/2007 10:13:04 AM			
Benzene	ND	µg/L	1.0						
Toluene	ND	µg/L	1.0						
Ethylbenzene	ND	µg/L	1.0						
Xylenes, Total	ND	µg/L	2.0						
Sample ID: 100NG BTEX LCS		<i>LCS</i>							
					Batch ID: R24814	Analysis Date: 8/17/2007 10:15:30 PM			
Benzene	19.61	µg/L	1.0	98.1	85.9	113			
Toluene	19.49	µg/L	1.0	97.5	86.4	113			
Ethylbenzene	19.55	µg/L	1.0	97.8	83.5	118			
Xylenes, Total	57.96	µg/L	2.0	96.6	83.4	122			
Sample ID: 0708171-01A MS		<i>MS</i>							
					Batch ID: R24814	Analysis Date: 8/17/2007 2:45:30 PM			
Benzene	19.39	µg/L	1.0	96.5	85.9	113			
Toluene	19.05	µg/L	1.0	94.3	86.4	113			
Ethylbenzene	19.16	µg/L	1.0	95.2	83.5	118			
Xylenes, Total	57.43	µg/L	2.0	95.0	83.4	122			

Qualifiers:

E	Value above quantitation range	H	Holding times for preparation or analysis exceeded
J	Analyte detected below quantitation limits	ND	Not Detected at the Reporting Limit
R	RPD outside accepted recovery limits	S	Spike recovery outside accepted recovery limits

Hall Environmental Analysis Laboratory, Inc.

Date: 06-Dec-07

CLIENT: XTO Energy
Project: Ground Water

Lab Order: 0711456

Lab ID: 0711456-01
Client Sample ID: Garcia GC BIMW-2

Collection Date: 11/27/2007 11:54:00 AM

Matrix: AQUEOUS

Analyses	Result	PQL	Qual	Units	DF	Date Analyzed
EPA METHOD 8021B: VOLATILES						Analyst: NSB
Benzene	ND	1.0		µg/L	1	12/4/2007 12:05:21 PM
Toluene	ND	1.0		µg/L	1	12/4/2007 12:05:21 PM
Ethylbenzene	3.5	1.0		µg/L	1	12/4/2007 12:05:21 PM
Xylenes, Total	33	2.0		µg/L	1	12/4/2007 12:05:21 PM
Surr: 4-Bromofluorobenzene	100	70.2-105		%REC	1	12/4/2007 12:05:21 PM

Lab ID: 0711456-02
Client Sample ID: OH Randel #7 MW-3

Collection Date: 11/27/2007 12:25:00 PM

Matrix: AQUEOUS

Analyses	Result	PQL	Qual	Units	DF	Date Analyzed
EPA METHOD 8021B: VOLATILES						Analyst: NSB
Benzene	ND	1.0		µg/L	1	12/4/2007 12:35:27 PM
Toluene	ND	1.0		µg/L	1	12/4/2007 12:35:27 PM
Ethylbenzene	ND	1.0		µg/L	1	12/4/2007 12:35:27 PM
Xylenes, Total	ND	2.0		µg/L	1	12/4/2007 12:35:27 PM
Surr: 4-Bromofluorobenzene	85.1	70.2-105		%REC	1	12/4/2007 12:35:27 PM

Lab ID: 0711456-03
Client Sample ID: OH Randel #7 MW-4

Collection Date: 11/27/2007 12:53:00 PM

Matrix: AQUEOUS

Analyses	Result	PQL	Qual	Units	DF	Date Analyzed
EPA METHOD 8021B: VOLATILES						Analyst: NSB
Benzene	ND	1.0		µg/L	1	12/4/2007 1:05:29 PM
Toluene	ND	1.0		µg/L	1	12/4/2007 1:05:29 PM
Ethylbenzene	ND	1.0		µg/L	1	12/4/2007 1:05:29 PM
Xylenes, Total	ND	2.0		µg/L	1	12/4/2007 1:05:29 PM
Surr: 4-Bromofluorobenzene	83.6	70.2-105		%REC	1	12/4/2007 1:05:29 PM

Lab ID: 0711456-04
Client Sample ID: OH Randel #7 MW-7

Collection Date: 11/27/2007 1:28:00 PM

Matrix: AQUEOUS

Analyses	Result	PQL	Qual	Units	DF	Date Analyzed
EPA METHOD 8021B: VOLATILES						Analyst: NSB
Benzene	12000	500		µg/L	500	12/4/2007 1:35:44 PM
Toluene	9000	100		µg/L	100	12/4/2007 2:05:54 PM
Ethylbenzene	940	100		µg/L	100	12/4/2007 2:05:54 PM
Xylenes, Total	13000	200		µg/L	100	12/4/2007 2:05:54 PM
Surr: 4-Bromofluorobenzene	97.7	70.2-105		%REC	100	12/4/2007 2:05:54 PM

Qualifiers: * Value exceeds Maximum Contaminant Level

E Value above quantitation range

J Analyte detected below quantitation limits

ND Not Detected at the Reporting Limit

S Spike recovery outside accepted recovery limits

B Analyte detected in the associated Method Blank

H Holding times for preparation or analysis exceeded

MCL Maximum Contaminant Level

RL Reporting Limit

QA/QC SUMMARY REPORT

Client: XTO Energy
Project: Ground Water

Work Order: 0711456

Analyte	Result	Units	PQL	%Rec	LowLimit	HighLimit	%RPD	RPDLimit	Qual
Method: EPA Method 8021B: Volatiles									
Sample ID: 0711456-05A MSD		MSD			Batch ID: R26348		Analysis Date: 12/4/2007 6:00:52 PM		
Benzene	23.48	µg/L	1.0	102	85.9	113	0.358	27	
Toluene	21.37	µg/L	1.0	102	86.4	113	0.610	19	
Ethylbenzene	20.56	µg/L	1.0	103	83.5	118	0.273	10	
Xylenes, Total	63.13	µg/L	2.0	102	83.4	122	0.505	13	
Sample ID: 5ML RB		MBLK			Batch ID: R26348		Analysis Date: 12/4/2007 8:34:08 AM		
Benzene	ND	µg/L	1.0						
Toluene	ND	µg/L	1.0						
Ethylbenzene	ND	µg/L	1.0						
Xylenes, Total	ND	µg/L	2.0						
Sample ID: 5ML RB		MBLK			Batch ID: R26381		Analysis Date: 12/5/2007 8:29:31 AM		
Benzene	ND	µg/L	1.0						
Toluene	ND	µg/L	1.0						
Ethylbenzene	ND	µg/L	1.0						
Xylenes, Total	ND	µg/L	2.0						
Sample ID: 100UL BTEX LCS		LCS			Batch ID: R26348		Analysis Date: 12/4/2007 6:31:06 PM		
Benzene	18.58	µg/L	1.0	92.9	85.9	113			
Toluene	18.15	µg/L	1.0	90.2	86.4	113			
Ethylbenzene	18.46	µg/L	1.0	92.3	83.5	118			
Xylenes, Total	54.76	µg/L	2.0	91.3	83.4	122			
Sample ID: 100NG BTEX LCS		LCS			Batch ID: R26381		Analysis Date: 12/5/2007 11:44:35 PM		
Benzene	19.64	µg/L	1.0	98.2	85.9	113			
Toluene	19.43	µg/L	1.0	96.6	86.4	113			
Ethylbenzene	19.64	µg/L	1.0	98.2	83.5	118			
Xylenes, Total	59.27	µg/L	2.0	98.8	83.4	122			
Sample ID: 100NG BTEX LCSD		LCSD			Batch ID: R26381		Analysis Date: 12/6/2007 12:14:45 AM		
Benzene	20.41	µg/L	1.0	102	85.9	113	3.85	27	
Toluene	20.15	µg/L	1.0	100	86.4	113	3.66	19	
Ethylbenzene	20.53	µg/L	1.0	103	83.5	118	4.42	10	
Xylenes, Total	61.86	µg/L	2.0	103	83.4	122	4.28	13	
Sample ID: 0711456-05A MS		MS			Batch ID: R26348		Analysis Date: 12/4/2007 5:30:50 PM		
Benzene	23.40	µg/L	1.0	102	85.9	113			
Toluene	21.24	µg/L	1.0	101	86.4	113			
Ethylbenzene	20.51	µg/L	1.0	103	83.5	118			
Xylenes, Total	62.81	µg/L	2.0	101	83.4	122			

Qualifiers:

E	Value above quantitation range	H	Holding times for preparation or analysis exceeded
J	Analyte detected below quantitation limits	ND	Not Detected at the Reporting Limit
R	RPD outside accepted recovery limits	S	Spike recovery outside accepted recovery limits