

GW - 66

**PERMITS,
RENEWALS,
& MODS**

ACKNOWLEDGEMENT OF RECEIPT
OF CHECK/CASH

I hereby acknowledge receipt of check No. _____ dated 2/28/11

or cash received on _____ in the amount of \$ 100.00

from GAS COMPANY OF NEW MEXICO

for GW-66

Submitted by: Lawrence Romero Date: 2/28/11

Submitted to ASD by: Lawrence Romero Date: 2/28/11

Received in ASD by: _____ Date: _____

Filing Fee ☒ New Facility _____ Renewal ☒

Modification _____ Other _____

Organization Code 521.07 Applicable FY 2010

To be deposited in the Water Quality Management Fund.

Full Payment _____ or Annual Increment _____



If you have any questions about this payment please contact:

NEW MEXICO GAS COMPANY
P O Box 97500 MS AC3
Accounts Payable
Albuquerque, NM 87199-7500

BANK #	CHECK DATE	VENDOR NO.		CHECK NO.		
523	Feb/11/2011	0000011449		024089		
INVOICE #	DATE	AMOUNT	DISC.	NET AMT	VOUCHER ID	REMARKS
OIL020411	Feb/02/2011	300.00	0.00	300.00	00081621	
Mark Sikleanos BC22						

\$100 For GW-65 Redondo C.S. filing fees 4:
\$100 for GW-66 Espejo C.S.
\$100 for GW-263 Starlake C.S.

Total Gross Amount	Total Discounts	Total Paid Amount
\$300.00	\$0.00	\$300.00

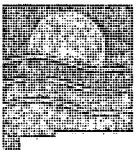

New Mexico GAS COMPANY

RECEIVED OOD
2011 FEB 25 P 12:44

CERTIFIED MAIL
RETURN RECEIPT REQUESTED

February 24, 2011

Oil Conservation Division
Attn: Leonard Lowe
1220 South St. Francis Drive
Santa Fe, NM 87505

RE: NMGC Discharge Plans GW-065, -066, and -263
Discharge Plan Approvals for Redonda, Espejo, and Star Lake Compressor Stations

Dear Mr. Lowe:

Attached please find signed original copies of the discharge plan renewal applications for the above-referenced compressor stations. New Mexico Gas Company is submitting a check in the amount of \$300 to cover the application fees for the three compressor stations (\$100/facility).

Thank you for your assistance regarding this matter. Please call me at (505) 697-3516 if you have any questions.

Sincerely,

Marcelle Fiedler
Senior Environmental Scientist

cc: Arlington Kennedy, NMGC Gas Operations (cover letter only)
Curtis Winner, NMGC Land Services Manager
OCD District III, Aztec office (one copy of Star Lake Discharge Plan renewal application)

District I
1625 N. French Dr., Hobbs, NM 88240
District II
1301 W. Grand Avenue, Artesia, NM 88210
District III
1000 Rio Brazos Road, Aztec, NM 87410
District IV
1220 S. St. Francis Dr., Santa Fe, NM 87505

State of New Mexico
Energy Minerals and Natural Resources
Oil Conservation Division
1220 South St. Francis Dr.
Santa Fe, NM 87505

Revised June 10, 2003

Submit Original
Plus 1 Copy
to Santa Fe
1 Copy to Appropriate
District Office

**DISCHARGE PLAN APPLICATION FOR SERVICE COMPANIES, GAS PLANTS,
REFINERIES, COMPRESSOR, GEOTHERMAL FACILITIES
AND CRUDE OIL PUMP STATIONS**

(Refer to the OCD Guidelines for assistance in completing the application)

☐ New ☒ Renewal ☐ Modification

1. Type: Espejo Compressor Station GW-066 k: 02.25.11
2. Operator: New Mexico Gas Company (NMGC)
- Address: 7120 Wyoming Blvd., NE, Ste 20, Albuquerque, NM 87109
- Contact Person: Arlington Kennedy Phone: (505) 697-3447
3. Location: NW/4 NW/4 Section 31 Township 12N Range 2E
Submit large-scale topographic map showing exact location. (see attached map)
4. Attach the name, telephone number and address of the landowner of the facility site. (no change)
5. Attach the description of the facility with a diagram indicating location of fences, pits, dikes and tanks on the facility. (see revised attached Item 5 and revised facility diagram)
6. Attach a description of all materials stored or used at the facility. (see revised attached Item 6)
7. Attach a description of present sources of effluent and waste solids. Average quality and daily volume of waste water must be included. (no change)
8. Attach a description of current liquid and solid waste collection/treatment/disposal procedures. (see revised attached Item 8)
9. Attach a description of proposed modifications to existing collection/treatment/disposal systems. (no change)
10. Attach a routine inspection and maintenance plan to ensure permit compliance. (see revised attached Item 10)
11. Attach a contingency plan for reporting and clean-up of spills or releases. (no change)
12. Attach geological/hydrological information for the facility. Depth to and quality of ground water must be included. (no change)
13. Attach a facility closure plan, and other information as is necessary to demonstrate compliance with any other OCD rules, regulations and/or orders. (no change)

14. CERTIFICATION I hereby certify that the information submitted with this application is true and correct to the best of my knowledge and belief.

Name: Arlington Kennedy

Title: Gas Compression Operations Supervisor II

Signature: 

Date: 2-8-11

E-mail

Address: arlington.kennedy@nmgco.com

General Information

This document follows the format presented in the "Guidelines for the Preparation of Discharge Plans at Natural Gas Plants, Refineries, Compressor and Crude Oil Pump Stations (Revised 12-95)".

A. Name of Discharger or Legally Responsible Party:

New Mexico Gas Company (NMGC)
7120 Wyoming Blvd., NE, Ste 20
Albuquerque, NM 87109

B. Name of Local Representative or Contact Person:

Facility Contact: Arlington Kennedy
New Mexico Gas Company (NMGC)
7120 Wyoming Blvd., NE, Ste 20
Albuquerque, NM 87109
(505) 697-3447

Permit Application Contact: Mark Sikelianos
New Mexico Gas Company (NMGC)
7120 Wyoming Blvd., NE, Ste 20
Albuquerque, NM 87109
(505) 697-3508

C. Location of Discharge:

NW ¼ of the NW 1/4, Section 31, Township 12 North, Range 2 East, NMPM
Unit 9, Rio Rancho Estates
Sandoval County, New Mexico

D. Copies:

Three (3) copies of Discharge Plan Renewal Application are submitted to OCD.

E. Affirmation:

"I hereby certify that I am familiar with the information contained herein and submitted with this discharge plan and that such information is true, accurate and complete to the best of my knowledge."

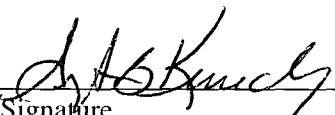
Signature

2-8-11
Date

Arlington Kennedy
Printed Name

Compression Operations Supervisor
Title

Item 5: Revised

Attach the description of the facility with a diagram indicating location of fences, pits, dikes and tanks on the facility.

Espejo is a compressor station located on NMGC's natural gas transmission system. Four natural-gas fired compressor engines are at the facility for a total rated site horsepower (hp) of 5,466 hp. An equipment list is given below. A revised facility map that shows the entire compressor plant layout is attached.

Equipment	ID No.	Equipment Description
Compressor	1	Waukesha L7042 GSI
Compressor	2	Waukesha L7042 GL
Compressor	3	Waukesha L7044 GSI
Compressor	4	Waukesha L7044 GSI

Item 6: Revised

Attach a description of all materials stored or used at the facility.

Container	ID No.	Material Stored	Volume (gallons)	Location	Containment
AGT	TK-1	Stoddard Solvent	500	East of compressor building	Secondary containment, galvanized steel/cement
AGT	TK-2	Ambitrol (FL-50) and lube oil (Pegasus 805)	6000 (3000 Ambitrol and 3000 lube oil)	East of compressor building	Secondary containment, galvanized steel/cement
IGT	TK-3	Waste water	2940	Northeast of compressor building	Double walled, double bottomed in secondary containment, galvanized steel/gravel
IGT	TK-4	Used oil	2940	Northeast of compressor building	Double walled, double bottomed in secondary containment, galvanized steel/gravel
AGT	TK-5	Pipeline liquids (condensate)	1000	West of compressors	Secondary containment, galvanized steel/cement
Drum	--	Degreaser (1) 55-gallon	55	Tank berm or building	Secondary containment, galvanized steel/Cement or building
Drum	--	Detergent (1) 55-gallon	55	Tank berm or building	Secondary containment, galvanized steel/Cement or building

TK: tank

IGT: in-ground tank

AGT: above ground tank

(1): Number of drums

Item 8: Revised

Attach a description of current liquid and solid waste collection/treatment/disposal procedures.

<i>Type of Waste</i>	<i>Collection</i>	<i>Storage</i>	<i>Hauled by</i>	<i>Disposal</i>
Pipeline liquids (condensate)	Piped to TK-5	TK-5	Thermo Fluids	Thermo Fluids
Used oil	Piped to TK-4 by 2" line	TK-4	Thermo Fluids	Thermo Fluids
Waste water	Piped to TK-3 by 2" line	TK-3	Thermo Fluids	Thermo Fluids
Solid Waste	Trash receptacle	Trash receptacle	Waste Management	Waste Management Landfill, Rio Rancho, NM
Used filters	Drained into barrel	Containment area	Waste Management	Waste Management Landfill, Rio Rancho, NM

Thermo Fluids – 9010 Bates Rd, Albuquerque, NM 87105 (505) 247-9699

Waste Management Landfill, 402 Industrial Park Loop, NE, Rio Rancho, NM 87124 (505) 892-2055

NMGC performed pressure testing on the underground wastewater and condensate lines on August 21, 2009 and submitted these results to the Oil Conservation Division. NMGC will perform these tests every five years as specified in the Discharge Permit.

Item 10: Revised

Attach a routine inspection and maintenance plan to ensure permit compliance.

Espejo is continuously operated and is manned **4** hours per day. The station is equipped with alarms that will notify the designated on-call operator of an emergency. The site is inspected daily by facility personnel. Inspection and maintenance are performed and documented according to the guidelines set forth in the Espejo Prevention, Control, and Countermeasure (SPCC) Plan.

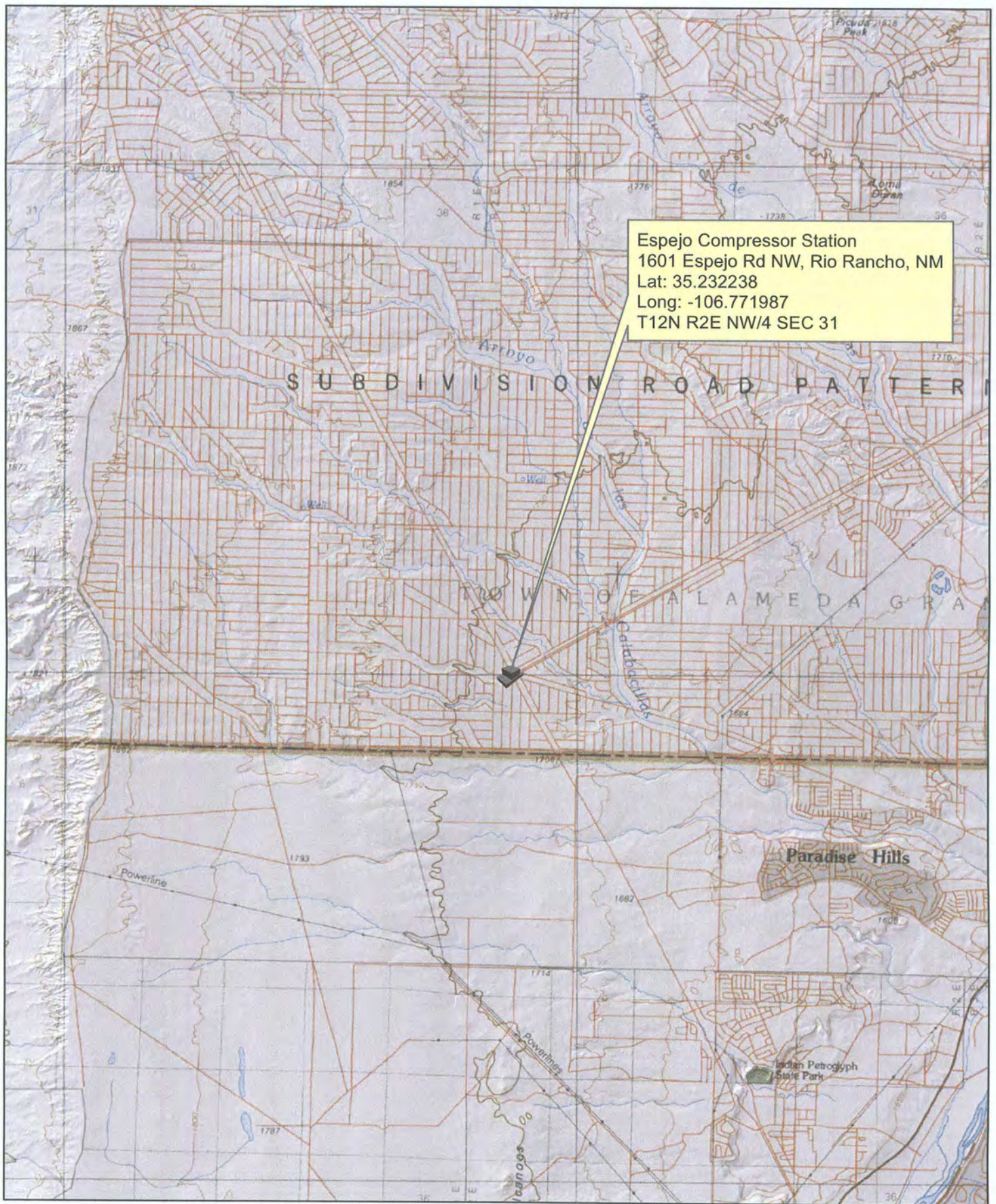

Map Name: DRG100K Albuquerque
Map Scale: 1:100,000
Map Type: Topographic
Contour Interval: 20 Meter
Year Created: 1976

Site Location Map
Espejo Compressor Station
NW/4 Section 31 Township 12N Range 2E

0 2 4 Miles



New Mexico
GAS COMPANY

7120 Wyoming Blvd., NE Ste. 20
Albuquerque, NM 87109

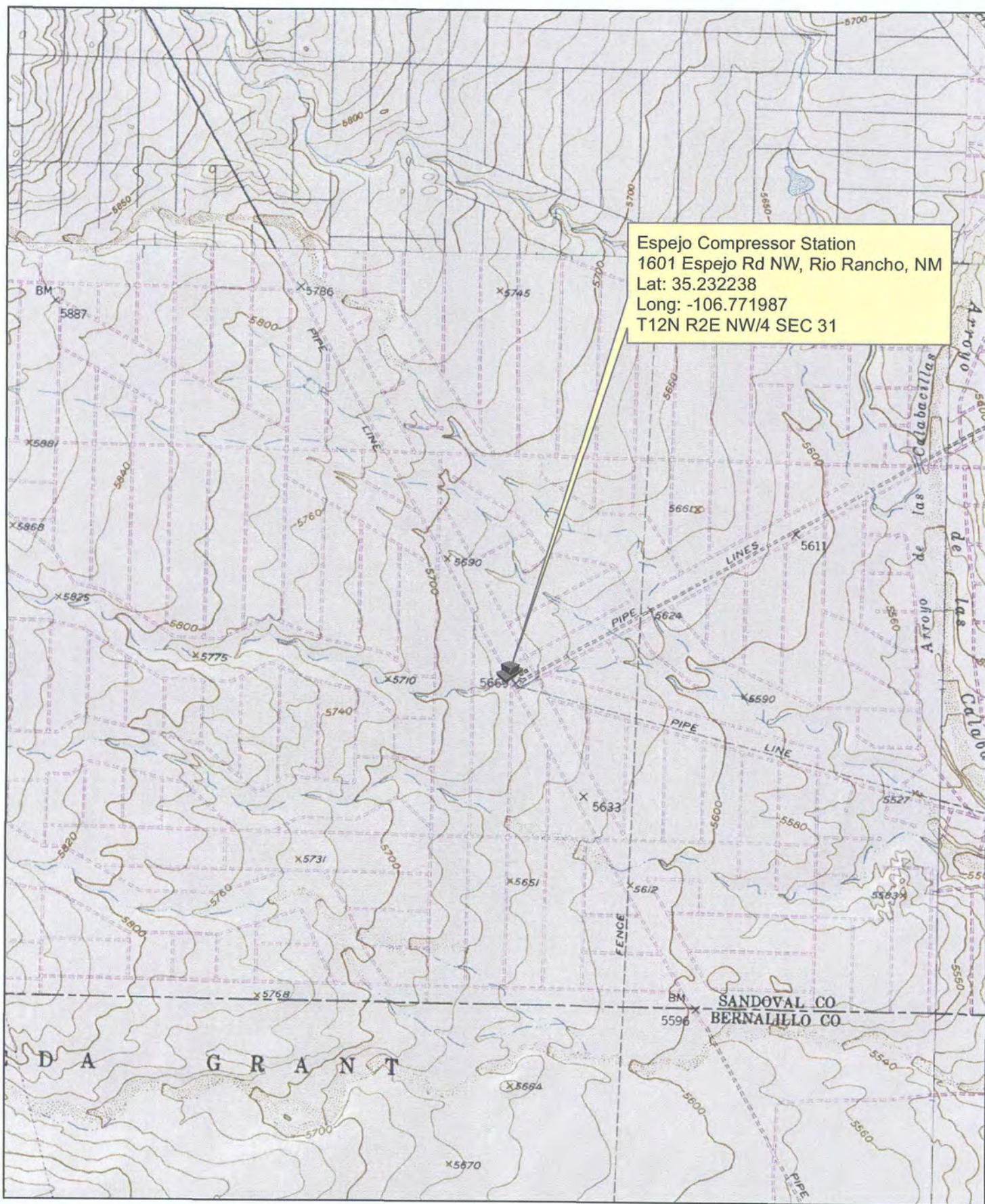

Map Name: Volcano Ranch
 Map Scale: 1:24,000
 Map Type: Topographic
 Contour Interval: 20 Feet
 Year Created: 1972

Site Topographic Map
 Espejo Compressor Station
 NW/4 Section 31 Township 12N Range 2E

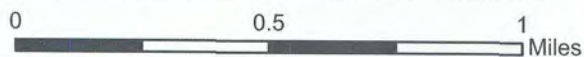

New Mexico
 GAS COMPANY

7120 Wyoming Blvd., NE Ste. 20
 Albuquerque, NM 87109



Field Office
Espejo Compressor Station
1601 Espejo Rd NW, Rio Rancho, NM
Lat: 35.232238
Long: -106.771987
T12N R2E NW/4 SEC 31

1- 1232 HP Waukesha Compressor
1- 1478 HP Waukesha Compressor
1- 1600 HP Waukesha Compressor
1- 1600 HP Waukesha Compressor

2940 - Gallons
Waste water

2940 - Gallons
Used Oil

500 - Gallons
Stoddard
Solvent

1000 - Gallons
Pipeline Liquids

6,000 Gallon Tank
3,000 Gallon - Ambitrol
2,000 Gallon - Motor Oil
1,000 Gallon - Motor Oil

Inlet Filter Separator

Map Name: Volcano Ranch
Map Scale: 1:24,000
Map Type: Topographic
Contour Interval: 20 Feet
Year Created: 1972

Site Map/Aerial Photograph
Espejo Compressor Station
NW/4 Section 31 Township 12N Range 2E

1 inch = 100 feet

0 50 100 200
Feet



New Mexico
GAS COMPANY

7120 Wyoming Blvd., NE Ste. 20
Albuquerque, NM 87109



New Mexico GAS COMPANY

OIL CONSERVATION DIVISION
1220 SOUTH ST. FRANCIS DRIVE
SANTA FE, NEW MEXICO 87505

RECEIVED

2009 JAN 30 PM 12 04

HAND DELIVERED

January 30, 2009

Mr. Carl Chavez
Oil Conservation Division
1220 South St. Francis Dr.
Santa Fe, NM 87505

SUBJECT: Discharge Plans GW-066, GW-263, and GW-065
Transfer of Espejo, Star Lake, and Redonda Compressor Station Discharge Plans

Dear Mr. Chavez:

Effective January 30, 2009 the Public Service Company of New Mexico sold their gas operations to the New Mexico Gas Company (NMGC). Included in the sale are three facilities that have Oil Conservation Division Discharge Plans for the Espejo (GW-066), Star Lake (GW-263) and Redonda (GW-065) Compressor Stations. The NMGC will be the new operators of the compressor stations and their discharge plans. The NMGC understands the terms and conditions of the discharge plan and agrees to comply with them (see attached certification). The NMGC contact will be Curtis Winner. His contact information is:

New Mexico Gas Company Business Center Office
7120 Wyoming Blvd. NE Suite 20
Albuquerque, New Mexico 87109
505-697-3639

If you have any questions, please contact Curtis Winner at 505-697-3639.

Sincerely,

Marcelle Fiedler
Senior Environmental Scientist

Cc: OCD Aztec District III Office, 1000 Rio Brazos Road, Aztec, NM 87410
Curtis Winner, Manager Environmental Construction and Maintenance
Debbie Brunt, Director Gas Engineering
Kevin Lawrence, Operations Supervisor

OCD CERTIFICATION

New Mexico Gas Company (NMGC), through its undersigned representative, hereby acknowledges receipt of the foregoing notice letter and further acknowledges all terms and conditions of the attached Espejo (GW-066), Star Lake (GW-263), and Redonda (GW-065) discharge plan permits, and agrees to comply with all such terms and conditions. NMGC further acknowledges that the Oil Conservation Division (OCD) may change the terms and conditions for good cause shown as necessary to protect fresh water, human health, and the environment. The undersigned also attests to the fact that he or she understands the requirements under 19.15.1.41 NMAC which provides that "Any person who conducts any activity pursuant to a permit, administrative order or other written authorization or approval from the division shall comply with every term, condition and provision of such permit, administrative order, authorization or approval."

Date: January 29, 2009

New Mexico Gas Company

By: Mueller Mueller
Its: Senior Environmental Scientist
P.O. Box 97500
Albuquerque, New Mexico 87199-7500

OIL CONSERVATION DIVISION
1220 SOUTH ST. FRANCIS DRIVE
SANTA FE, NEW MEXICO 87505

PNM

Alvarado Square

Albuquerque, NM 87158-2104

505 241-2031

Fax 505 241-2376

www.pnm.com

RECEIVED

2009 JAN 30 January 30, 2009

HAND-DELIVERED

Carl Chavez

New Mexico Oil Conservation Division

1220 South St. Francis Dr.

Santa Fe, NM 87505



A personal commitment
to New Mexico

**SUBJECT: Documentation of Notification to the New Mexico Gas Company of
Discharge Permits for the Espejo (GW-066), Star Lake (GW-263), and
Redonda (GW-065) Compressor Stations**

Dear Mr. Chavez,

Public Service Company of New Mexico ("PNM") is selling its gas utility assets to New Mexico Gas Company ("NMGC"). The anticipated closing date is January 30, 2009. As part of this transaction, NMGC will acquire the Espejo Compressor Station, the Star Lake Compressor Station and the Redonda Compressor Station. All of these stations have individual groundwater discharge permits issued by the New Mexico Oil Conservation Division ("OCD"). The discharge permits were assigned by PNM to NMGC upon closing. The discharge permits are more specifically identified as follows:

- Espejo – GW-066
- Star Lake - GW-263
- Redonda - GW-065

This letter is submitted to the OCD pursuant to 20.6.2.3111 NMAC which requires written confirmation that PNM has provided written notice to NMGC of these discharge permits. Enclosed is a copy of PNM's letter to NMGC dated January 28, 2009 providing written notice to NMGC of the subject discharge permits. The enclosed letter includes written confirmation of receipt by NMGC.

Should you have any questions concerning this matter, please don't hesitate to contact me at (505) 241-2019. Thank you.

Sincerely,

Claudette Horn

Environmental Manager

PNM Environmental and Land Services Department

Attachment

cc: Debbie Brunt, NMGC
Kevin Lawrence, NMGC
DDC Files

PNM
Alvarado Square
Albuquerque, NM 87158-2104
505 241-2031
Fax 505 241-2376
www.pnm.com

January 28 , 2009



*A personal commitment
to New Mexico*

HAND-DELIVERED

Annette Gardiner, President
New Mexico Gas Company, Inc.
P.O. Box 97500
Albuquerque, New Mexico 87199-7500

**SUBJECT: Notification of Oil Conservation Division Discharge Permits for the
Espejo (GW-066), Star Lake (GW-263), and Redonda (GW-065)
Compressor Stations**

Dear Ms. Gardiner:

As you know, as part of the acquisition by New Mexico Gas Company ("NMGC") of the gas utility assets of Public Service Company of New Mexico, NMGC will acquire the Espejo Compressor Station, the Star Lake Compressor Station and the Redonda Compressor Station. All of these stations have individual groundwater discharge permits issued by the New Mexico Oil Conservation Commission ("OCC"). The discharge permits will be assigned by PNM to NMGC upon closing.

This letter is submitted to NMGC pursuant to 20.6.2.3111 NMAC which requires written notice of these discharge permits prior to transfer of ownership. The pertinent discharge permits are identified as follows:

- Espejo - GW-066
- Star Lake - GW-263
- Redonda - GW-065

Pursuant to 20.6.2.3111.B NMAC, NMGC has a duty to inquire into all of the provisions of and requirements contained in these permits and is charged with notice of all provisions and requirements of these permits as they appear of record in the ODC's files.

This letter is provided in duplicate so that NMGC can acknowledge its receipt in writing. Pursuant to 20.6.2.3111.E. NMAC, PNM is required to send a copy of this notice letter and confirmation of the receipt of the letter by NMGC. Therefore, please sign the certification below and return an executed copy to me.

Should you have any questions concerning this matter, please don't hesitate to contact me at (505) 241-2019.

Sincerely,

Claudette Horn

Environmental Manager
PNM Environmental and Land Services Department

Attachments

cc: Debbie Brunt, NMGC
Kevin Lawrence, NMGC
DDC Files

OCD CERTIFICATION

New Mexico Gas Company (NMGC), through its undersigned representative, hereby acknowledges receipt of the foregoing notice letter and further acknowledges all terms and conditions of the attached Espejo (GW-066), Star Lake (GW-263), and Redonda (GW-065) discharge plan permits, and agrees to comply with all such terms and conditions. NMGC further acknowledges that the Oil Conservation Division (OCD) may change the terms and conditions for good cause shown as necessary to protect fresh water, human health, and the environment. The undersigned also attests to the fact that he or she understands the requirements under 19.15.1.41 NMAC which provides that "Any person who conducts any activity pursuant to a permit, administrative order or other written authorization or approval from the division shall comply with every term, condition and provision of such permit, administrative order, authorization or approval."

Date: January 28, 2009

New Mexico Gas Company

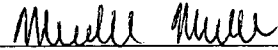
By: 
Its: Senior Environmental Scientist
P.O. Box 97500
Albuquerque, New Mexico 87199-7500

PNM
Alvarado Square
Albuquerque, NM 87158-2104
505 241-2031
Fax 505 241-2376
www.pnm.com

CERTIFIED MAIL
RETURN RECEIPT REQUESTED



*A personal commitment
to New Mexico*

July 17, 2006

Oil Conservation Division
Attn: Ben Stone
1120 South St. Francis Drive
Santa Fe, NM 87505

RE: PNM Discharge Plans GW-065, -066, and -263
Discharge Plan Approvals for Redonda, Espejo, and Star Lake Compressor Stations

Dear Mr. Stone:

Attached please find signed original copies of the discharge plan renewal approvals for the above-referenced compressor stations. Public Service Company of New Mexico is submitting check number 108761 in the amount of \$5100.00. This check pays the flat fee of \$1700 assessed for each of the three compressor stations and covers the five (5) year period of the discharge plans that end April 3, 2011.

Thank you for your assistance regarding this matter. Please call me at (505) 241-2016 if you have any questions.

Sincerely,

Robin K. DeLapp
Senior Environmental Scientist

cc: Kevin Lawrence, PNM Gas Operations (cover letter only)
DCC
ESD File



If you have any questions about this payment please contact:

PNM UTILITY
Accounts Payable, MS 0720
Alvarado Square
Albuquerque, NM 87158

BANK	CHECK DATE	VENDOR NO.	CHECK NO.			
615	Jul/17/2006	0000011449				
INVOICE #	DATE	AMOUNT	DISC	NET AMT	VOUCHER ID	REMARKS
050806	May/08/2006	5,100.00	0.00	5,100.00	00016481	

Total Gross Amount	Total Discounts	Total Paid Amount
\$5,100.00	\$0.00	\$5,100.00

THE ORIGINAL DOCUMENT HAS A WHITE REFLECTIVE WATERMARK ON THE BACK. HOLD AT AN ANGLE TO VIEW. DO NOT CASH IF NOT PRESENT.



WELLS FARGO, N.A.
200 Lomas Blvd. NW
Albuquerque, NM 87102

615

108761

CHECK NO.	DATE	AMOUNT
	Jul/17/2006	\$5,100.00***

PAY ****FIVE THOUSAND ONE HUNDRED AND XX / 100 DOLLAR****

TO THE NEW MEXICO ENVIRONMENT DEPARTMENT
ORDER WATER MGMT QUALITY MGMT FUND
OF C/O OIL CONSERVATION DIVISION
1220 NORTH ST FRANCIS DRIVE
SANTA FE, NM 87505

Authorized Signature



NEW MEXICO ENERGY, MINERALS and NATURAL RESOURCES DEPARTMENT

BILL RICHARDSON

Governor

Joanna Prukop

Cabinet Secretary

Mark E. Fesmire, P.E.

Director

Oil Conservation Division

May 8, 2006

Ms. Robin K. DeLapp
Public Service Company of New Mexico
Alvarado Square
Albuquerque, New Mexico 87158

**RE: Discharge Plan Renewal Approval GW-066
Public Service Company of New Mexico
Espejo Compressor Station
Sandoval County, New Mexico**

Dear Ms. DeLapp:

The ground water discharge renewal plan GW-066 for the Public Service Company of New Mexico Espejo Compressor Station located in the NW/4 NW/4 of Section 31, Township 12 North, Range 2 East, NMPM, Sandoval County, New Mexico, **is hereby approved** under the conditions contained in the enclosed attachment. Enclosed are two copies of the conditions of approval. **Please sign and return one copy to the New Mexico Oil Conservation Division (OCD) Santa Fe Office within 10 working days of receipt of this letter.**

The original discharge plan application was submitted on June 18, 1996 pursuant to Section 5101.B.3. of the New Mexico Water Quality Control Commission (WQCC) Regulations. The discharge plan renewal application was submitted May 14, 2001 pursuant to Section 3106 of the New Mexico Water Quality Control Commission (WQCC) Regulations. It is approved pursuant to Section 3109.A. Please note Section 3109.G., which provides for possible future amendment of the plan. Please be advised that approval of this plan does not relieve Public Service Company of New Mexico of liability should operations result in pollution of surface water, ground water, or the environment.

Please be advised that all exposed pits, including lined pits and open tanks (tanks exceeding 16 feet in diameter), shall be screened, netted, or otherwise rendered non-hazardous to wildlife including migratory birds.

Please note that Section 3104 of the regulations provides: "When a plan has been approved, discharges must be consistent with the terms and conditions of the plan." Pursuant to Section 3107.C., Public Service Company of New Mexico is required to notify the Director of any

facility expansion, production increase, or process modification that would result in any change in the discharge of water quality or volume.

Pursuant to Section 3109.H.4., this discharge plan is for a period of five years. This plan will expire on **April 3, 2011**, and Public Service Company of New Mexico should submit an application in ample time before this date. Note that under Section 3106.F. of the regulations, if a discharger submits a discharge plan renewal application at least 120 days before the discharge plan expires and is in compliance with the approved plan, then the existing discharge plan will not expire until the application for renewal has been approved or disapproved. It should be noted that all discharge plan facilities will be required to submit the results of an underground drainage testing program as a requirement for discharge plan .

Public Service Company of New Mexico will submit a storm water run-off plan for approval by the OCD within six (6) months of the date of this approval letter for the Espejo Compressor Station.

The discharge plan application for the Public Service Company of New Mexico Espejo Compressor Station is subject to WQCC Regulation 3114. Every billable facility submitting a discharge plan application will be assessed a non-refundable fee equal to the filing fee of \$100. There is a flat fee assessed for natural gas compressor stations with horsepower rating greater than 1001 horsepower equal to \$1,700.00. The OCD has received the filing fee.

Please make all checks payable to:

**Water Management Quality Management Fund
C/o: Oil Conservation Division
1220 North St. Francis Drive
Santa Fe, New Mexico 87505.**

If you have any questions please contact Mr. Ben Stone at (505) 476-3474. On behalf of the staff of the OCD, I wish to thank you and your staff for your cooperation during this discharge plan review.

Sincerely,

Wayne Price
Chief, Environmental Bureau
Oil Conservation Division

LWP/BES
Attachment

xc: OCD Aztec District Office

ATTACHMENT TO THE DISCHARGE PLAN GW-066
PUBLIC SERVICE COMPANY OF NEW MEXICO
ESPEJO COMPRESSOR STATION
DISCHARGE PLAN APPROVAL CONDITIONS
(April 3, 2006)

1. Payment of Discharge Plan Fees: The \$100.00 filing fee has been received by the OCD. There is a flat fee assessed for natural gas compressor stations with horsepower rating greater than 1001 horsepower equal to \$1,700.00. The required flat fee may be paid in a single payment due at the time of approval, or in equal annual installments over the duration of the plan, with the first payment due upon receipt of this approval.
2. Public Service Company of New Mexico Commitments: Public Service Company of New Mexico will abide by all commitments submitted in the discharge plan renewal application dated February 16, 2006 and these conditions for approval.
3. Waste Disposal: All wastes will be disposed of at an OCD approved facility. Only oilfield exempt wastes shall be disposed of down Class II injection wells. Non-exempt oilfield wastes that are non-hazardous may be disposed of at an OCD approved facility upon proper waste determination per 40 CFR Part 261. Any waste stream that is not listed in the discharge plan will be approved by OCD on a case-by-case basis.
4. Drum Storage: All drums containing materials other than fresh water must be stored on an impermeable pad with curbing. All empty drums will be stored on their sides with the bungs in and lined up on a horizontal plane. Chemicals in other containers such as sacks or buckets will also be stored on an impermeable pad and curb type containment.
5. Process Areas: All process and maintenance areas which show evidence that leaks and spills are reaching the ground surface must be either paved and curbed or have some type of spill collection device incorporated into the design.
6. Above Ground Tanks: All above ground tanks which contain fluids other than fresh water must be bermed to contain a volume of one-third more than the total volume of the largest tank or of all interconnected tanks. All new tanks or existing tanks that undergo a major modification, as determined by the Division, must be placed within an impermeable bermed enclosure.
7. Above Ground Saddle Tanks: Above ground saddle tanks must have impermeable pad and curb type containment unless they contain fresh water or fluids that are gases at atmospheric temperature and pressure.
8. Labeling: All tanks, drums and containers will be clearly labeled to identify their contents and other emergency notification information.

9. Below Grade Tanks/Sumps: All below grade tanks, sumps, and pits must be approved by the OCD prior to installation or upon modification and must incorporate secondary containment and leak-detection into the design. All pre-existing sumps and below-grade tanks must demonstrate integrity on an annual basis. Integrity tests include pressure testing to 3 pounds per square inch above normal operating pressure and/or visual inspection of cleaned out tanks and/or sumps, or other OCD approved methods. The OCD will be notified at least 72 hours prior to all testing.
10. Underground Process/Wastewater Lines: All underground process/wastewater pipelines must be tested to demonstrate their mechanical integrity every 5 years. The permittee may propose various methods for testing such as pressure testing to 3 pounds per square inch above normal operating pressure or other means acceptable to the OCD. The OCD will be notified at least 72 hours prior to all testing.
11. Class V Wells: No Class V wells that inject non-hazardous industrial wastes or a mixture of industrial wastes and domestic wastes will be closed unless it can be demonstrated that groundwater will not be impacted in the reasonably foreseeable future. Leach fields and other wastewater disposal systems at OCD regulated facilities which inject non-hazardous fluid into or above an underground source of drinking water are considered Class V injection wells under the EPA UIC program. Class V wells that inject domestic waste only must be permitted by the New Mexico Environment Department.
12. Housekeeping: All systems designed for spill collection/prevention will be inspected weekly and after each storm event to ensure proper operation and to prevent overtopping or system failure. A record of inspections will be retained on site for a period of five years.
13. Spill Reporting: All spills/releases will be reported pursuant to OCD Rule 116 and WQCC 1203 to the OCD Aztec District Office.
14. Transfer of Discharge Plan: The OCD will be notified prior to any transfer of ownership, control, or possession of a facility with an approved discharge plan. A written commitment to comply with the terms and conditions of the previously approved discharge plan must be submitted by the purchaser and approved by the OCD prior to transfer.
15. Storm Water Plan: The facility will have an approved storm water run-off plan.
16. Closure: The OCD will be notified when operations of the Espejo Compressor Station are discontinued for a period in excess of six months. Prior to closure of the Espejo Compressor Station a closure plan will be submitted for approval by the Director. Closure and waste disposal will be in accordance with the statutes, rules and regulations in effect at the time of closure.

17. Certification: Public Service Company of New Mexico, by the officer whose signature appears below, accepts this permit and agrees to comply with all terms and conditions contained herein. Public Service Company of New Mexico further acknowledges that these conditions and requirements of this permit may be changed administratively by the Division for good cause shown as necessary to protect fresh water, human health and the environment.

Accepted:

PUBLIC SERVICE COMPANY OF NEW MEXICO

By

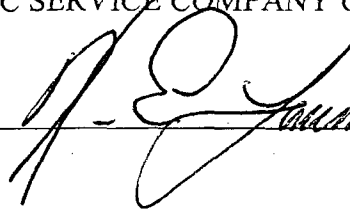

Title

06/28/06



NEW MEXICO ENERGY, MINERALS and NATURAL RESOURCES DEPARTMENT

BILL RICHARDSON

Governor

Joanna Prukop

Cabinet Secretary

Mark E. Fesmire, P.E.

Director

Oil Conservation Division

May 8, 2006

Ms. Robin K. DeLapp
Public Service Company of New Mexico
Alvarado Square
Albuquerque, New Mexico 87158

**RE: Discharge Plan Renewal Approval GW-066
Public Service Company of New Mexico
Espejo Compressor Station
Sandoval County, New Mexico**

Dear Ms. DeLapp:

The ground water discharge renewal plan GW-066 for the Public Service Company of New Mexico Espejo Compressor Station located in the NW/4 NW/4 of Section 31, Township 12 North, Range 2 East, NMPM, Sandoval County, New Mexico, **is hereby approved** under the conditions contained in the enclosed attachment. Enclosed are two copies of the conditions of approval. **Please sign and return one copy to the New Mexico Oil Conservation Division (OCD) Santa Fe Office within 10 working days of receipt of this letter.**

The original discharge plan application was submitted on June 18, 1996 pursuant to Section 5101.B.3. of the New Mexico Water Quality Control Commission (WQCC) Regulations. The discharge plan renewal application was submitted May 14, 2001 pursuant to Section 3106 of the New Mexico Water Quality Control Commission (WQCC) Regulations. It is approved pursuant to Section 3109.A. Please note Section 3109.G., which provides for possible future amendment of the plan. Please be advised that approval of this plan does not relieve Public Service Company of New Mexico of liability should operations result in pollution of surface water, ground water, or the environment.

Please be advised that all exposed pits, including lined pits and open tanks (tanks exceeding 16 feet in diameter), shall be screened, netted, or otherwise rendered non-hazardous to wildlife including migratory birds.

Please note that Section 3104 of the regulations provides: "When a plan has been approved, discharges must be consistent with the terms and conditions of the plan." Pursuant to Section 3107.C., Public Service Company of New Mexico is required to notify the Director of any

facility expansion, production increase, or process modification that would result in any change in the discharge of water quality or volume.

Pursuant to Section 3109.H.4., this discharge plan is for a period of five years. This plan will expire on **April 3, 2011**, and Public Service Company of New Mexico should submit an application in ample time before this date. Note that under Section 3106.F. of the regulations, if a discharger submits a discharge plan renewal application at least 120 days before the discharge plan expires and is in compliance with the approved plan, then the existing discharge plan will not expire until the application for renewal has been approved or disapproved. It should be noted that all discharge plan facilities will be required to submit the results of an underground drainage testing program as a requirement for discharge plan .

Public Service Company of New Mexico will submit a storm water run-off plan for approval by the OCD within six (6) months of the date of this approval letter for the Espejo Compressor Station.

The discharge plan application for the Public Service Company of New Mexico Espejo Compressor Station is subject to WQCC Regulation 3114. Every billable facility submitting a discharge plan application will be assessed a non-refundable fee equal to the filing fee of \$100. There is a flat fee assessed for natural gas compressor stations with horsepower rating greater than 1001 horsepower equal to \$1,700.00. The OCD has received the filing fee.

Please make all checks payable to:

**Water Management Quality Management Fund
C/o: Oil Conservation Division
1220 North St. Francis Drive
Santa Fe, New Mexico 87505.**

If you have any questions please contact Mr. Ben Stone at (505) 476-3474. On behalf of the staff of the OCD, I wish to thank you and your staff for your cooperation during this discharge plan review.

Sincerely,

Wayne Price 
Chief, Environmental Bureau
Oil Conservation Division

LWP/BES
Attachment

xc: OCD Aztec District Office

ATTACHMENT TO THE DISCHARGE PLAN GW-066
PUBLIC SERVICE COMPANY OF NEW MEXICO
ESPEJO COMPRESSOR STATION
DISCHARGE PLAN APPROVAL CONDITIONS
(April 3, 2006)

1. Payment of Discharge Plan Fees: The \$100.00 filing fee has been received by the OCD. There is a flat fee assessed for natural gas compressor stations with horsepower rating greater than 1001 horsepower equal to \$1,700.00. The required flat fee may be paid in a single payment due at the time of approval, or in equal annual installments over the duration of the plan, with the first payment due upon receipt of this approval.
2. Public Service Company of New Mexico Commitments: Public Service Company of New Mexico will abide by all commitments submitted in the discharge plan renewal application dated February 16, 2006 and these conditions for approval.
3. Waste Disposal: All wastes will be disposed of at an OCD approved facility. Only oilfield exempt wastes shall be disposed of down Class II injection wells. Non-exempt oilfield wastes that are non-hazardous may be disposed of at an OCD approved facility upon proper waste determination per 40 CFR Part 261. Any waste stream that is not listed in the discharge plan will be approved by OCD on a case-by-case basis.
4. Drum Storage: All drums containing materials other than fresh water must be stored on an impermeable pad with curbing. All empty drums will be stored on their sides with the bungs in and lined up on a horizontal plane. Chemicals in other containers such as sacks or buckets will also be stored on an impermeable pad and curb type containment.
5. Process Areas: All process and maintenance areas which show evidence that leaks and spills are reaching the ground surface must be either paved and curbed or have some type of spill collection device incorporated into the design.
6. Above Ground Tanks: All above ground tanks which contain fluids other than fresh water must be bermed to contain a volume of one-third more than the total volume of the largest tank or of all interconnected tanks. All new tanks or existing tanks that undergo a major modification, as determined by the Division, must be placed within an impermeable bermed enclosure.
7. Above Ground Saddle Tanks: Above ground saddle tanks must have impermeable pad and curb type containment unless they contain fresh water or fluids that are gases at atmospheric temperature and pressure.
8. Labeling: All tanks, drums and containers will be clearly labeled to identify their contents and other emergency notification information.

9. Below Grade Tanks/Sumps: All below grade tanks, sumps, and pits must be approved by the OCD prior to installation or upon modification and must incorporate secondary containment and leak-detection into the design. All pre-existing sumps and below-grade tanks must demonstrate integrity on an annual basis. Integrity tests include pressure testing to 3 pounds per square inch above normal operating pressure and/or visual inspection of cleaned out tanks and/or sumps, or other OCD approved methods. The OCD will be notified at least 72 hours prior to all testing.
10. Underground Process/Wastewater Lines: All underground process/wastewater pipelines must be tested to demonstrate their mechanical integrity every 5 years. The permittee may propose various methods for testing such as pressure testing to 3 pounds per square inch above normal operating pressure or other means acceptable to the OCD. The OCD will be notified at least 72 hours prior to all testing.
11. Class V Wells: No Class V wells that inject non-hazardous industrial wastes or a mixture of industrial wastes and domestic wastes will be closed unless it can be demonstrated that groundwater will not be impacted in the reasonably foreseeable future. Leach fields and other wastewater disposal systems at OCD regulated facilities which inject non-hazardous fluid into or above an underground source of drinking water are considered Class V injection wells under the EPA UIC program. Class V wells that inject domestic waste only must be permitted by the New Mexico Environment Department.
12. Housekeeping: All systems designed for spill collection/prevention will be inspected weekly and after each storm event to ensure proper operation and to prevent overtopping or system failure. A record of inspections will be retained on site for a period of five years.
13. Spill Reporting: All spills/releases will be reported pursuant to OCD Rule 116 and WQCC 1203 to the OCD Aztec District Office.
14. Transfer of Discharge Plan: The OCD will be notified prior to any transfer of ownership, control, or possession of a facility with an approved discharge plan. A written commitment to comply with the terms and conditions of the previously approved discharge plan must be submitted by the purchaser and approved by the OCD prior to transfer.
15. Storm Water Plan: The facility will have an approved storm water run-off plan.
16. Closure: The OCD will be notified when operations of the Espejo Compressor Station are discontinued for a period in excess of six months. Prior to closure of the Espejo Compressor Station a closure plan will be submitted for approval by the Director. Closure and waste disposal will be in accordance with the statutes, rules and regulations in effect at the time of closure.

17. Certification: Public Service Company of New Mexico, by the officer whose signature appears below, accepts this permit and agrees to comply with all terms and conditions contained herein. Public Service Company of New Mexico further acknowledges that these conditions and requirements of this permit may be changed administratively by the Division for good cause shown as necessary to protect fresh water, human health and the environment.

Accepted:

PUBLIC SERVICE COMPANY OF NEW MEXICO

By _____
Title



If you have any questions about this payment please contact:

Public Service Company of New Mexico

Accounts Payable, MS 0720

Alvarado Square

Albuquerque, New Mexico 87158

(505) 241-2120

CO.	BANK #	CK DATE	VENDOR NO.		CK NO.		
WA	606	012606	NME336222101				
INVOICE #	DATE	GROSS AMT	DISC.	DED	NET AMT	SOURCE REF	REMARKS A
NMEDWQ060182999	01/25/06	100.00	0.00	0.00	100.00	060182999	FILING FEE Y

Espevo Compressor Station GW-066

TOTAL

\$100.00

ACKNOWLEDGEMENT OF RECEIPT
OF CHECK/CASH

I hereby acknowledge receipt of check No. [REDACTED] dated 1/26/06
or cash received on _____ in the amount of \$ 100.00
from Public Service Co.
for Espresso Compressor Station GW-066
Submitted by: Lawrence Romero (Facility Name) Date: 2/28/06 (CP No.)
Submitted to ASD by: Lawrence Romero Date: 2/28/06
Received in ASD by: Romero & Romero Date: 2/28/06
Filing Fee ☒ New Facility _____ Renewal _____
Modification _____ Other _____
(Optional)
Organization Code 521.07 Applicable FY 2004
To be deposited in the Water Quality Management Fund.
Full Payment _____ or Annual Increment _____

THE ORIGINAL DOCUMENT HAS A WHITE REFLECTIVE WATERMARK ON THE BACK. HOLD AT AN ANGLE TO VIEW. DO NOT CASH IF NOT PRESENT.

PNM

606 [REDACTED]



General Fund Account

CHECK NO.	DATE	AMOUNT
[REDACTED]	012606	\$*****100.00

NMED WATER QUALITY MANAGEMENT FUND
PAY OIL CONSERVATION DIVISION, ENVIRONMENTAL
TO THE 1220 S. ST. FRANCIS DRIVE
ORDER SANTA FE, NM 87505
OF

GW-066

Authorized Signature

Public Service Company
of New Mexico
Alvarado Square MS 2104
Albuquerque, NM 87158
Fax 241-2376

Jack Ford

CERTIFIED MAIL
RETURN RECEIPT REQUESTED



July 27, 2001

Oil Conservation Division
Att: Roger C. Anderson
1120 South St. Francis Dr.
Santa Fe, NM 87505

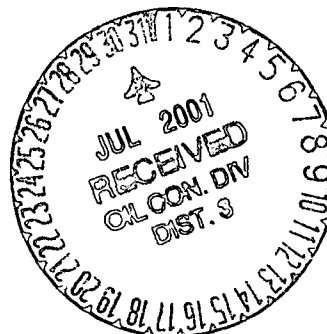

RE: PNM Discharge Plan GW-066
Discharge Plan Approval for Espejo Compressor Station

Dear Mr. Anderson:

Attached find one signed copy of Conditions of Approval for the above-referenced compressor station. As required under WQCC 3114 Public Service Company of New Mexico hereby submits its check number 729932 in the amount of \$1,700.00. This flat fee covers the five (5) renewal period ending June 25, 2006.

Thank you for your assistance regarding this matter. Call me at (505) 241-4873 if OCD has any questions.

Sincerely,

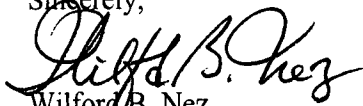
Wilford B. Nez
Sr. Engineering Tech

CC: OCD Aztec District III Office
D. J. Engert, PNM Compressor Station Mgr.

ATTACHMENT TO THE DISCHARGE PLAN GW-066
PUBLIC SERVICE COMPANY OF NEW MEXICO
ESPEJO COMPRESSOR STATION
DISCHARGE PLAN APPROVAL CONDITIONS
(July 3, 2001)

1. Payment of Discharge Plan Fees: The \$100.00 filing fee has been received by the OCD. There is a flat fee assessed for natural gas compressor stations with horsepower rating greater than 1001 horsepower equal to \$1,700.00. The required flat fee may be paid in a single payment due at the time of approval, or in equal annual installments over the duration of the plan, with the first payment due upon receipt of this approval.
2. Public Service Company of New Mexico Commitments: Public Service Company of New Mexico will abide by all commitments submitted in the discharge plan renewal application dated May 14, 2001 and these conditions for approval.
3. Waste Disposal: All wastes will be disposed of at an OCD approved facility. Only oilfield exempt wastes shall be disposed of down Class II injection wells. Non-exempt oilfield wastes that are non-hazardous may be disposed of at an OCD approved facility upon proper waste determination per 40 CFR Part 261. Any waste stream that is not listed in the discharge plan will be approved by OCD on a case-by-case basis.
4. Drum Storage: All drums containing materials other than fresh water must be stored on an impermeable pad with curbing. All empty drums will be stored on their sides with the bungs in and lined up on a horizontal plane. Chemicals in other containers such as sacks or buckets will also be stored on an impermeable pad and curb type containment.
5. Process Areas: All process and maintenance areas which show evidence that leaks and spills are reaching the ground surface must be either paved and curbed or have some type of spill collection device incorporated into the design.
6. Above Ground Tanks: All above ground tanks which contain fluids other than fresh water must be bermed to contain a volume of one-third more than the total volume of the largest tank or of all interconnected tanks. All new tanks or existing tanks that undergo a major modification, as determined by the Division, must be placed within an impermeable bermed enclosure.
7. Above Ground Saddle Tanks: Above ground saddle tanks must have impermeable pad and curb type containment unless they contain fresh water or fluids that are gases at atmospheric temperature and pressure.

8. Labeling: All tanks, drums and containers will be clearly labeled to identify their contents and other emergency notification information.
9. Below Grade Tanks/Sumps: All below grade tanks, sumps, and pits must be approved by the OCD prior to installation or upon modification and must incorporate secondary containment and leak-detection into the design. All pre-existing sumps and below-grade tanks must demonstrate integrity on an annual basis. Integrity tests include pressure testing to 3 pounds per square inch above normal operating pressure and/or visual inspection of cleaned out tanks and/or sumps, or other OCD approved methods. The OCD will be notified at least 72 hours prior to all testing.
10. Underground Process/Wastewater Lines: All underground process/wastewater pipelines must be tested to demonstrate their mechanical integrity every 5 years. The permittee may propose various methods for testing such as pressure testing to 3 pounds per square inch above normal operating pressure or other means acceptable to the OCD. The OCD will be notified at least 72 hours prior to all testing.
11. Class V Wells: No Class V wells that inject non-hazardous industrial wastes or a mixture of industrial wastes and domestic wastes will be closed unless it can be demonstrated that groundwater will not be impacted in the reasonably foreseeable future. Leach fields and other wastewater disposal systems at OCD regulated facilities which inject non-hazardous fluid into or above an underground source of drinking water are considered Class V injection wells under the EPA UIC program. Class V wells that inject domestic waste only must be permitted by the New Mexico Environment Department.
12. Housekeeping: All systems designed for spill collection/prevention will be inspected weekly and after each storm event to ensure proper operation and to prevent overtopping or system failure. A record of inspections will be retained on site for a period of five years.
13. Spill Reporting: All spills/releases will be reported pursuant to OCD Rule 116 and WQCC 1203 to the OCD Aztec District Office.
14. Transfer of Discharge Plan: The OCD will be notified prior to any transfer of ownership, control, or possession of a facility with an approved discharge plan. A written commitment to comply with the terms and conditions of the previously approved discharge plan must be submitted by the purchaser and approved by the OCD prior to transfer.
15. Storm Water Plan: The facility will have an approved storm water run-off plan.

16. Closure: The OCD will be notified when operations of the Espejo Compressor Station are discontinued for a period in excess of six months. Prior to closure of the Espejo Compressor Station a closure plan will be submitted for approval by the Director. Closure and waste disposal will be in accordance with the statutes, rules and regulations in effect at the time of closure.
17. Certification: Public Service Company of New Mexico, by the officer whose signature appears below, accepts this permit and agrees to comply with all terms and conditions contained herein. Public Service Company of New Mexico further acknowledges that these conditions and requirements of this permit may be changed administratively by the Division for good cause shown as necessary to protect fresh water, human health and the environment.

Accepted:

PUBLIC SERVICE COMPANY OF NEW MEXICO

by M. Christopher VP, Ops & Eng
Title

If you have any questions about this payment please contact:

Public Service Company of New Mexico
Accounts Payable, MS 0720
Alvarado Square
Albuquerque, New Mexico 87158
(505) 241-2120

PNM

Electric and Gas Services

CO.	BANK #	CK DATE	VENDOR NO.	CK NO.				
WP	600	010725	WAT443077101					
INVOICE #	DATE	GROSS AMT	DISC.	DED	NET AMT	SOURCE REF	REMARKS	A
01773599	07/03/01	1,700.00	0.00	0.00	1,700.00	010773599 PNM		Y

TOTAL

\$1,700.00

THE FACE OF THIS DOCUMENT HAS A MULTICOLORED BACKGROUND ON WHITE PAPER

600



PNM

Electric and Gas Services

General Fund Account

CHECK NO.	DATE	AMOUNT
	010725	\$*****1,700.00

PAY
TO THE ORDER OF WATER MANAGEMENT QUALITY MANAGEMENT FUND
C/O OIL CONSERVATION DIVISION
1220 NORTH ST. FRANCIS DRIVE
SANTA FE, NM 87505

Authorized Signature



NEW MEXICO ENERGY, MINERALS and NATURAL RESOURCES DEPARTMENT

GARY E. JOHNSON

Governor

Jennifer A. Salisbury

Cabinet Secretary

July 3, 2001

Lori Wrotenbery

Director

Oil Conservation Division

CERTIFIED MAIL

RETURN RECEIPT NO. 5051 0623

Mr. D. J. Engert
Public Service Company of New Mexico
Alvarado Square
Albuquerque, New Mexico 87158

**RE: Discharge Plan Renewal Approval GW-066
Public Service Company of New Mexico
Espejo Compressor Station
Sandoval County, New Mexico**

Dear Mr. Engert:

The ground water discharge renewal plan GW-066 for the Public Service Company of New Mexico Espejo Compressor Station located in the NW/4 NW/4 of Section 31, Township 12 North, Range 2 East, NMPM, Sandoval County, New Mexico, **is hereby approved** under the conditions contained in the enclosed attachment. Enclosed are two copies of the conditions of approval. **Please sign and return one copy to the New Mexico Oil Conservation Division (OCD) Santa Fe Office within 10 working days of receipt of this letter.**

The original discharge plan application was submitted on June 18, 1996 pursuant to Section 5101.B.3. of the New Mexico Water Quality Control Commission (WQCC) Regulations. The discharge plan renewal application was submitted May 14, 2001 pursuant to Section 3106 of the New Mexico Water Quality Control Commission (WQCC) Regulations. It is approved pursuant to Section 3109.A. Please note Section 3109.G., which provides for possible future amendment of the plan. Please be advised that approval of this plan does not relieve Public Service Company of New Mexico of liability should operations result in pollution of surface water, ground water, or the environment.

Please be advised that all exposed pits, including lined pits and open tanks (tanks exceeding 16 feet in diameter), shall be screened, netted, or otherwise rendered nonhazardous to wildlife including migratory birds.

Please note that Section 3104 of the regulations provides: "When a plan has been approved, discharges must be consistent with the terms and conditions of the plan." Pursuant to Section 3107.C., Public Service Company of New Mexico is required to notify the Director of any facility expansion, production increase, or process modification that would result in any change in the discharge of water quality or volume.

Mr. D. J. Engert
GW-066 Espejo Compressor Station
July 3, 2001
Page 2

Pursuant to Section 3109.H.4., this discharge plan is for a period of five years. This plan will expire on **June 25, 2006**, and Public Service Company of New Mexico should submit an application in ample time before this date. Note that under Section 3106.F. of the regulations, if a discharger submits a discharge plan renewal application at least 120 days before the discharge plan expires and is in compliance with the approved plan, then the existing discharge plan will not expire until the application for renewal has been approved or disapproved. It should be noted that all discharge plan facilities will be required to submit the results of an underground drainage testing program as a requirement for discharge plan .

Public Service Company of New Mexico will submit a storm water run-off plan for approval by the OCD within six (6) months of the date of this approval letter for the Espejo Compressor Station.

The discharge plan application for the Public Service Company of New Mexico Espejo Compressor Station is subject to WQCC Regulation 3114. Every billable facility submitting a discharge plan application will be assessed a non-refundable fee equal to the filing fee of \$100. There is a flat fee assessed for natural gas compressor stations with horsepower rating greater than 1001 horsepower equal to \$1,700.00. The OCD has received the filing fee.

**Please make all checks payable to: Water Management Quality Management Fund
C/o: Oil Conservation Division
1220 North St. Francis Drive
Santa Fe, New Mexico 87505.**

If you have any questions please contact Mr. W. Jack Ford at (505) 476-3489. On behalf of the staff of the OCD, I wish to thank you and your staff for your cooperation during this discharge plan review.

Sincerely,

Roger C. Anderson
Chief, Environmental Bureau
Oil Conservation Division

RCA/wjf
Attachment

xc: OCD Aztec District Office

U.S. Postal Service CERTIFIED MAIL RECEIPT (Domestic Mail Only; No Insurance Coverage Provided)	
Article Sent To:	
Postage \$	
Certified Fee	
Return Receipt Fee (Endorsement Required)	
Restricted Delivery Fee (Endorsement Required)	
Total Postage & Fees	\$
Name (Please Print Clearly) (To be completed by mailer) <i>D. Engert</i>	
Street, Apt. No., or PO Box No. <i>PNM</i>	
City, State, ZIP+ 4 <i>GW-066</i>	

7099 3220 0000 0222 6607
5051 1505 0629

PS Form 3800, July 1999 See Reverse for Instructions

ATTACHMENT TO THE DISCHARGE PLAN GW-066
PUBLIC SERVICE COMPANY OF NEW MEXICO
ESPEJO COMPRESSOR STATION
DISCHARGE PLAN APPROVAL CONDITIONS
(July 3, 2001)

1. Payment of Discharge Plan Fees: The \$100.00 filing fee has been received by the OCD. There is a flat fee assessed for natural gas compressor stations with horsepower rating greater than 1001 horsepower equal to \$1,700.00. The required flat fee may be paid in a single payment due at the time of approval, or in equal annual installments over the duration of the plan, with the first payment due upon receipt of this approval.
2. Public Service Company of New Mexico Commitments: Public Service Company of New Mexico will abide by all commitments submitted in the discharge plan renewal application dated May 14, 2001 and these conditions for approval.
3. Waste Disposal: All wastes will be disposed of at an OCD approved facility. Only oilfield exempt wastes shall be disposed of down Class II injection wells. Non-exempt oilfield wastes that are non-hazardous may be disposed of at an OCD approved facility upon proper waste determination per 40 CFR Part 261. Any waste stream that is not listed in the discharge plan will be approved by OCD on a case-by-case basis.
4. Drum Storage: All drums containing materials other than fresh water must be stored on an impermeable pad with curbing. All empty drums will be stored on their sides with the bungs in and lined up on a horizontal plane. Chemicals in other containers such as sacks or buckets will also be stored on an impermeable pad and curb type containment.
5. Process Areas: All process and maintenance areas which show evidence that leaks and spills are reaching the ground surface must be either paved and curbed or have some type of spill collection device incorporated into the design.
6. Above Ground Tanks: All above ground tanks which contain fluids other than fresh water must be bermed to contain a volume of one-third more than the total volume of the largest tank or of all interconnected tanks. All new tanks or existing tanks that undergo a major modification, as determined by the Division, must be placed within an impermeable bermed enclosure.
7. Above Ground Saddle Tanks: Above ground saddle tanks must have impermeable pad and curb type containment unless they contain fresh water or fluids that are gases at atmospheric temperature and pressure.

8. Labeling: All tanks, drums and containers will be clearly labeled to identify their contents and other emergency notification information.
9. Below Grade Tanks/Sumps: All below grade tanks, sumps, and pits must be approved by the OCD prior to installation or upon modification and must incorporate secondary containment and leak-detection into the design. All pre-existing sumps and below-grade tanks must demonstrate integrity on an annual basis. Integrity tests include pressure testing to 3 pounds per square inch above normal operating pressure and/or visual inspection of cleaned out tanks and/or sumps, or other OCD approved methods. The OCD will be notified at least 72 hours prior to all testing.
10. Underground Process/Wastewater Lines: All underground process/wastewater pipelines must be tested to demonstrate their mechanical integrity every 5 years. The permittee may propose various methods for testing such as pressure testing to 3 pounds per square inch above normal operating pressure or other means acceptable to the OCD. The OCD will be notified at least 72 hours prior to all testing.
11. Class V Wells: No Class V wells that inject non-hazardous industrial wastes or a mixture of industrial wastes and domestic wastes will be closed unless it can be demonstrated that groundwater will not be impacted in the reasonably foreseeable future. Leach fields and other wastewater disposal systems at OCD regulated facilities which inject non-hazardous fluid into or above an underground source of drinking water are considered Class V injection wells under the EPA UIC program. Class V wells that inject domestic waste only must be permitted by the New Mexico Environment Department.
12. Housekeeping: All systems designed for spill collection/prevention will be inspected weekly and after each storm event to ensure proper operation and to prevent overtopping or system failure. A record of inspections will be retained on site for a period of five years.
13. Spill Reporting: All spills/releases will be reported pursuant to OCD Rule 116 and WQCC 1203 to the OCD Aztec District Office.
14. Transfer of Discharge Plan: The OCD will be notified prior to any transfer of ownership, control, or possession of a facility with an approved discharge plan. A written commitment to comply with the terms and conditions of the previously approved discharge plan must be submitted by the purchaser and approved by the OCD prior to transfer.
15. Storm Water Plan: The facility will have an approved storm water run-off plan.

16. Closure: The OCD will be notified when operations of the Espejo Compressor Station are discontinued for a period in excess of six months. Prior to closure of the Espejo Compressor Station a closure plan will be submitted for approval by the Director. Closure and waste disposal will be in accordance with the statutes, rules and regulations in effect at the time of closure.
17. Certification: Public Service Company of New Mexico, by the officer whose signature appears below, accepts this permit and agrees to comply with all terms and conditions contained herein. Public Service Company of New Mexico further acknowledges that these conditions and requirements of this permit may be changed administratively by the Division for good cause shown as necessary to protect fresh water, human health and the environment.

Accepted:

PUBLIC SERVICE COMPANY OF NEW MEXICO

by _____
Title

**ACKNOWLEDGEMENT OF RECEIPT
OF CHECK/CASH**

I hereby acknowledge receipt of check No. [REDACTED] dated 8/30/01
or cash received on 8/30/01 in the amount of \$ 1,200.00
from PNM GAS SERVICES
for PNM SANTA FE JUNCTION C.S. GW-066
(Facility Name)
Submitted by: ED MARTIN Date: 8/30/01 (DP No.)
Submitted to ASD by: ED MARTIN Date: 8/30/01
Received in ASD by: _____ Data: _____
Filing Fee _____ New Facility _____ Renewal ☒
Modification _____ Other _____
(specify)
Organization Code 521.07 Applicable FY 2001
To be deposited in the Water Quality Management Fund.
Full Payment ☒ or Annual Increment _____

**NEW MEXICO ENVIRONMENT DEPARTMENT
REVENUE TRANSMITTAL FORM**

Description	FUND	CES	DFA ORG	DFA ACCT	ED ORG	ED ACCT	AMOUNT	
1 CY Reimbursement Project _____ Tax _____	064	01						
5 Gross Receipt Tax	064	01		2329	900000	2329134		
3 Air Quality Title V	092	13	1300	1896	900000	4169134		
4 PRP Prepayments	248	14	1400	9696	900000	4969014		
2 Climax Chemical Co.	248	14	1400	9696	900000	4969015		
6 Circle K Reimbursements	248	14	1400	9696	900000	4969248		
7 Hazardous Waste Permits	339	27	2700	1696	900000	4169027		
8 Hazardous Waste Annual Generator Fees	339	27	2700	1696	900000	4169338		
10 Water Quality - Oil Conservation Division	341	29		2329	900000	2329029		10
11 Water Quality - GW Discharge Permit (2)	341	29	2900	1696	900000	4169029	3400.00	11
12 Air Quality Permits	631	31	2500	1696	900000	4169031		12
13 Payments under Protest	651	33		2919	900000	2919033		13
*14 Xerox Copies	652	34		2349	900000	2349001		**14
15 Ground Water Penalties	652	34		2349	900000	2349002		15
16 Witness Fees	652	34		2349	900000	2439003		16
17 Air Quality Penalties	652	34		2349	900000	2349004		17
18 OSHA Penalties	652	34		2349	900000	2349005		18
19 Prior Year Reimbursement	652	34		2349	900000	2349006		19
20 Surface Water Quality Certification	652	34		2349	900000	2349009		20
21 Jury Duty	652	34		2349	900000	2349012		21
22 CY Reimbursements (i.e. telephone)	652	34		2349	900000	2349014		22
*23 UST Owner's List	783	24	2500	9696	900000	4969201		*23
*24 Hazardous Waste Notifiers List	783	24	2500	9696	900000	4969202		*24
*25 UST Maps	783	24	2500	9696	900000	4969203		*25
*26 UST Owner's Update	783	24	2500	9696	900000	4969205		*26
*28 Hazardous Waste Regulations	783	24	2500	9696	900000	4969207		*28
*29 Radiologic Tech. Regulations	783	24	2500	9696	900000	4969208		*29
*30 Superfund CERLIS List	783	24	2500	9696	900000	4969211		*30
31 Solid Waste Permit Fees	783	24	2500	9696	900000	4969213		31
32 Smoking School	783	24	2500	9696	900000	4969214		32
*33 SWQB - NPS Publications	783	24	2500	9696	900000	4969222		*33
*34 Radiation Licensing Regulation	783	24	2500	9696	900000	4969228		*34
*35 Sale of Equipment	783	24	2500	9696	900000	4969301		*35
*36 Sale of Automobile	783	24	2500	9696	900000	4969302		*36
*37 Lost Recoveries	783	24	2500	9696	900000	4969814		**37
*38 Lost Repayments	783	24	2500	9696	900000	4969815		**38
39 Surface Water Publication	783	24	2500	9696	900000	4969801		39
40 Exxon Reese Drive Ruidoso - CAF	783	24	2500	9696	900000	4969242		40
41 Emerg. Hazardous Waste Penalties NOV	957	32	9600	1696	900000	4164032		41
42 Radiologic Tech. Certification	987	05	0500	1696	900000	4169005		42
44 Ust Permit Fees	989	20	3100	1696	900000	4169020		44
45 UST Tank Installers Fees	989	20	3100	1696	900000	4169021		45
46 Food Permit Fees	991	26	2600	1696	900000	4169026		46
43 Other								43

* Gross Receipt Tax Required

** Site Name & Project Code Required

TOTAL 3400.00

Contact Person: EO MARTIN Phone: 476-3492 Date: 8/30/01

Received in ASD By: _____ Date: _____ RT #: _____ ST #: _____

GW-066
Espejo



Electric and Gas Services

If you have any questions about this payment please contact:

Public Service Company of New Mexico

Accounts Payable, MS 0720

Alvarado Square

Albuquerque, New Mexico 87158

(505) 241-2120

CO	BANK #	CK DATE	VENDOR NO.		CK NO.		
WP	600	010725	WAT443077101				
INVOICE #	DATE	GROSS AMT	DISC.	DED	NET AMT	SOURCE REF	REMARKS
01773599	07/03/01	1,700.00	0.00	0.00	1,700.00	010773599	PNM

TOTAL

\$1,700.00

THE FACE OF THIS DOCUMENT HAS A MULTICOLORED BACKGROUND ON WHITE PAPER

600



Electric and Gas Services

General Fund Account



CHECK NO.	DATE	AMOUNT
	010725	*****1,700.00

PAY
TO THE WATER MANAGEMENT QUALITY MANAGEMENT FUND
ORDER C/O OIL CONSERVATION DIVISION
OF 1220 NORTH ST. FRANCIS DRIVE
SANTA FE, NM 87505

Authorized Signature

ACKNOWLEDGEMENT OF RECEIPT
OF CHECK/CASH

I hereby acknowledge receipt of check No. [REDACTED] dated 5/9/01
or cash received on _____ in the amount of \$ 200.00
from PNM
for Redonda C.S. 9W-065
Espejo C.S. 9W-066
(Family Name)
Submitted by: [Signature] Date: 5-17-01
Submitted to ASD by: _____ Date: _____
Received in ASD by: _____ Date: _____
Filing Fee ☒ New Facility _____ Renewal ☒
Modification _____ Other _____
(Agency)
Organization Code 521.07 Applicable FY 2001
To be deposited in the Water Quality Management Fund.
Full Payment ☒ or Annual Increment _____

THE FACE OF THIS DOCUMENT HAS A MULTICOLORED BACKGROUND ON WHITE PAPER

600 [REDACTED]



PNM

Electric and Gas Services

General Fund Account

CHECK NO.	DATE	AMOUNT
[REDACTED]	010509	\$*****200.00

PAY
TO THE
ORDER OF NMED-WATER QUALITY MANAGEMENT
PO BOX 2088
SANTA FE, NM 87504

[Signature]
Authorized Signature

ACKNOWLEDGEMENT OF RECEIPT
OF CHECK/CASH

I hereby acknowledge receipt of check No. [REDACTED] dated 2/23/98
or cash received on _____ in the amount of \$ 690.00
from PNM

for Santa Fe Junction GW 066

Submitted by: _____ Date: _____

Submitted to ASD by: [Signature] Date: 3/27/98

Received in ASD by: _____ Date: _____

Filing Fee _____ New Facility _____ Renewal X

Modification _____ Other _____

Organization Code 521.07 Applicable FY 98

To be deposited in the Water Quality Management Fund.

Full Payment _____ or Annual Increment _____

800 [REDACTED]



PNM

Electric and Gas Services
General Fund Account

CHECK NO.	DATE	AMOUNT
[REDACTED]	02/23/98	\$*****690.00

PAY
THE
ORDER
OF

OIL CONSERVATION DIVISION
GAS MARKETING
C/O BRIDGET JACOB
PO BOX 2088
SANTA FE, NM 87504

[Signature]
Authorized Signature



Electric and Gas Services

If you have any questions about this payment please contact:

Public Service Company of New Mexico

Accounts Payable, MS 0720

Alvarado Square

Albuquerque, New Mexico 87158

(505) 848-2120

CO.	BANK #	CK DATE	VENDOR NO.		CK NO.		
EL	800	02/23/98	OIL120052501				
INVOICE #	DATE	GROSS AMT	DISC.	DED	NET AMT	SOURCE REF	REMARKS A
GW066	02/19/98	690.00	0.00	0.00	690.00	980211698	DICHARGE PLAN

TOTAL

\$690.00



Electric and Gas Services

If you have any questions about this payment please contact:

Public Service Company of New Mexico
Accounts Payable, MS 0720
Alvarado Square
Albuquerque, New Mexico 87158
(505) 848-2120

CO.	BANK #	CK DATE	VENDOR NO.	CK NO.			
EL	800	02/23/98	OIL120052501				
INVOICE #	DATE	GROSS AMT	DISC.	DED	NET AMT	SOURCE REF	REMARKS
GW066	02/19/98	690.00	0.00	0.00	690.00	980211698	DICHARGE PLA

TOTAL

\$690.00



Electric and Gas Services
General Fund Account

800



CHECK NO.	DATE	AMOUNT
	02/23/98	\$*****690.00

PAY
TO THE
ORDER
OF

OIL CONSERVATION DIVISION
GAS MARKETING
C/O BRIDGET JACOBER
PO BOX 2088
SANTA FE, NM 87504

Authorized Signature



STATE OF NEW MEXICO

ENERGY, MINERALS AND NATURAL RESOURCES DEPARTMENT

OIL CONSERVATION DIVISION
RECEIVED
2040 S. PACHECO
SANTA FE, NEW MEXICO 87505
(505) 827-7131

1996 AUG 8 AM 8 52

August 7, 1996

RECEIVED

AUG 19 1996

Environmental Bureau
Oil Conservation Division

CERTIFIED MAIL

RETURN RECEIPT NO. P-594-835-292

Ms. Toni K. Ristau
Director, Environmental Services
PNMGS
Alvarado Square, M.S. 0408
Albuquerque, NM 87158

RECEIVED

AUG 12 1996

**RE: Renewal of Discharge Plan GW-66
Santa Fe Junction Compressor Station
Valencia County, New Mexico**

Dear Ms. Ristau:

The discharge plan renewal GW-66 for the PNMGS Santa Fe Junction Compressor Station located in Section 31, Township 12 North, Range 2 East, NMPM, Sandoval County, New Mexico, is hereby approved under the conditions contained in the enclosed attachment. The discharge plan renewal consists of the application dated June 18, 1996, as well as the letter and additional information dated June 20, 1996 from PNMGS and this approval letter with conditions of approval from OCD dated August 7, 1996. Enclosed are two copies of the conditions of approval. Please sign and return one copy to the New Mexico Oil Conservation Division (OCD) Santa Fe Office within five working days of receipt of this letter.

The discharge plan renewal application was submitted pursuant to Section 3106 of the New Mexico Water Quality Control Commission Regulations. Please note Sections 3109.E and 3109.F which provide for possible future amendments or modifications of the plan. Please be advised that the approval of this plan does not relieve PNMGS of liability should the operations associated with this facility result in pollution of surface water, ground water, or the environment.

Please be advised that all exposed pits, including lined pits and open top tanks (tanks exceeding 16 feet in diameter), shall be screened, netted, or otherwise rendered nonhazardous to wildlife including migratory birds.

Ms. Toni K. Ristau
PNMGS
Page 2
August 7, 1996

Please note that Section 3104 of the regulations requires that "When a plan has been approved, discharges must be consistent with the terms and conditions of the plan." Pursuant to Section 3107.C PNMGS is required to notify the Director of any facility expansion, production increase, or process modification that would result in any change in the discharge of water quality or volume.

Pursuant to Section 3109.G.4, this plan is for a period of five (5) years. **This approval will expire June 25, 2001, and an application for renewal should be submitted in ample time before that date.** It should be noted that all discharge plan facilities will be required to submit plans for, or the results of, an underground drainage testing program as a requirement for discharge plan renewal approval.

The discharge plan renewal for the PNMGS Santa Fe Junction Compressor Station GW-66 is subject to the WQCC Regulation 3114 discharge plan fee. Every billable facility submitting a discharge plan will be assessed a fee equal to the filing fee of fifty dollars (\$50) plus a flat fee of six-hundred and ninety dollars (\$690) for Compressor Stations between above 3,000 horsepower.

The \$50 filing fee has been received by the OCD. The flat fee for an approved discharge plan has not been received by the OCD.

On behalf of the staff of the Oil Conservation Division, I wish to thank you and your staff for your cooperation during this discharge plan review.

Sincerely,

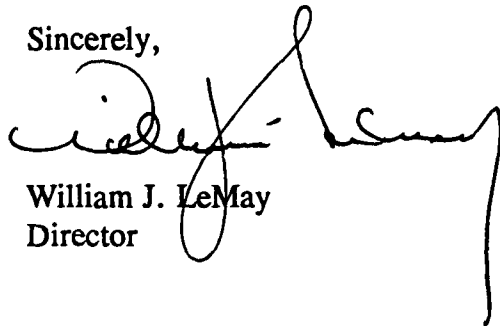
A handwritten signature in black ink, appearing to read 'William J. LeMay', is written over the typed name and title.

William J. LeMay
Director

Attachment

xc: Mr. Denny Foust

Ms. Toni K. Ristau
PNMGS
Page 3
August 7, 1996

ATTACHMENT TO DISCHARGE PLAN GW-66
PNMGS - Santa Fe Junction Compressor Station
DISCHARGE PLAN REQUIREMENTS
(August 7, 1996)

1. **Payment of Discharge Plan Fees:** The \$690 flat fee shall be submitted upon receipt of this approval. The required flat fee may be paid in a single payment due at the time of approval, or in equal annual installments over the duration of the plan, with the first payment due upon receipt of this approval.

2. **PNMGS Commitments:** PNMGS will abide by all commitments submitted in the Application dated June 18, 1996, as well as the letter and additional information dated June 20, 1996 from PNMGS and this approval letter with conditions of approval from OCD dated August 7, 1996.

3. **Drum Storage:** All drums containing materials other than fresh water must be stored on an impermeable pad and curb type containment. All empty drums should be stored on their sides with the bungs in place and lined up on a horizontal plane. Chemicals in other containers such as sacks or buckets should also be stored on an impermeable pad and curb type containment.

All drums and chemical containers shall be clearly labeled to identify their contents and other emergency information necessary if they were to rupture, spill, or ignite.

4. **Process Areas:** All process and maintenance areas which show evidence that leaks and spills are reaching the ground surface must be either paved and curbed or have some type of spill collection device incorporated into the design.

5. **Above Ground Tanks:** All above ground tanks which contain fluids other than fresh water must be bermed to contain a volume of one-third more than the total volume of the largest tank or of all interconnected tanks. All new facilities or modifications to existing facilities must place the tank on an impermeable type pad.

6. **Above Ground Saddle Tanks:** Above ground saddle tanks must have impermeable pad and curb type containment unless they contain fresh water or fluids that are gases at atmospheric temperature and pressure.

7. **Tank Labeling:** All tanks should be clearly labeled to identify their contents and other emergency information necessary if the tank were to rupture, spill, or ignite.

Ms. Toni K. Ristau
PNMGS
Page 4
August 7, 1996

8. **Below Grade Tanks/Sumps:** All below grade tanks, sumps, and pits must be approved by the OCD prior to installation or upon modification and must incorporate secondary containment and leak-detection into the design. All pre-existing sumps and below-grade tanks that do not have secondary containment and leak detection must demonstrate integrity on an annual basis. Integrity tests include pressure testing to 3 pounds per square inch above normal operating pressure and/or visual inspection of cleaned out tanks /or sumps.

9. **Underground Process/Wastewater Lines:** All underground process/wastewater pipelines must be tested to demonstrate their mechanical integrity at present and then every 5 years there after. Companies may propose various methods for testing such as pressure testing to 3 pounds per square inch above normal operating pressure or other means acceptable to the OCD. The OCD will be notified at least 72 hours prior to all testing so that an OCD representative may witness the testing.

10. **Housekeeping:** All systems designed for spill collection/prevention should be inspected to ensure proper operation and to prevent overtopping or system failure.

Any contaminated soils that are collected at the facility will be tested for hazardous constituents, and after receiving OCD approval, will be disposed of at an OCD approved site.

11. **Spill Reporting:** All spills/releases shall be reported pursuant to OCD Rule 116 and WQCC 1203 to the Aztec OCD District Office at (505)-334-6178.

12. **Transfer of Discharge Plan:** The OCD will be notified prior to any transfer of ownership, control, or possession of a facility with an approved discharge plan. A written commitment to comply with the terms and conditions of the previously approved discharge plan must be submitted by the purchaser and approved by the OCD prior to transfer.

13. **New Mexico Oil Conservation Division Inspections:** Additional requirements may be placed on the facility based upon results from New Mexico Oil Conservation Division inspections.

14. **Closure:** The OCD will be notified when operations of the facility are discontinued for a period in excess of six months. Prior to closure of the facility a closure plan will be submitted for approval by the director. Closure and waste disposal will be in accordance with the statutes, rules and regulations in effect at the time of closure.

15. **Conditions accepted by:**

Gerald W. Buep 8/16/96
Company Representative Date

Plant Supv.
Title



STATE OF NEW MEXICO
ENERGY, MINERALS AND NATURAL RESOURCES DEPARTMENT

OIL CONSERVATION DIVISION

2040 S. PACHECO
SANTA FE, NEW MEXICO 87505
(505) 827-7131

August 7, 1996

CERTIFIED MAIL
RETURN RECEIPT NO. P-594-835-292

Ms. Toni K. Ristau
Director, Environmental Services
PNMGS
Alvarado Square, M.S. 0408
Albuquerque, NM 87158

**RE: Renewal of Discharge Plan GW-66
Santa Fe Junction Compressor Station
Valencia County, New Mexico**

Dear Ms. Ristau:

The discharge plan renewal GW-66 for the PNMGS Santa Fe Junction Compressor Station located in Section 31, Township 12 North, Range 2 East, NMPM, Sandoval County, New Mexico, is hereby approved under the conditions contained in the enclosed attachment. The discharge plan renewal consists of the application dated June 18, 1996, as well as the letter and additional information dated June 20, 1996 from PNMGS and this approval letter with conditions of approval from OCD dated August 7, 1996. Enclosed are two copies of the conditions of approval. Please sign and return one copy to the New Mexico Oil Conservation Division (OCD) Santa Fe Office within five working days of receipt of this letter.

The discharge plan renewal application was submitted pursuant to Section 3106 of the New Mexico Water Quality Control Commission Regulations. Please note Sections 3109.E and 3109.F which provide for possible future amendments or modifications of the plan. Please be advised that the approval of this plan does not relieve PNMGS of liability should the operations associated with this facility result in pollution of surface water, ground water, or the environment.

Please be advised that all exposed pits, including lined pits and open top tanks (tanks exceeding 16 feet in diameter), shall be screened, netted, or otherwise rendered nonhazardous to wildlife including migratory birds.

P 594 835 292

US Postal Service

Receipt for Certified Mail

No Insurance Coverage Provided. *amb66*

Do not use for International Mail (See reverse)

Sent to *PNMGS - Ristau*

Street & Number *MS. Toni Ristau*

Post Office, State, & ZIP Code

Postage \$

Certified Fee

Special Delivery Fee

Restricted Delivery Fee

Return Receipt Showing to Whom & Date Delivered

Return Receipt Showing to Whom, Date, & Addressee's Address

TOTAL Postage & Fees \$

Postmark or Date

PS Form 3800, April 1995

Ms. Toni K. Ristau
PNMGS
Page 2
August 7, 1996

Please note that Section 3104 of the regulations requires that "When a plan has been approved, discharges must be consistent with the terms and conditions of the plan." Pursuant to Section 3107.C PNMGS is required to notify the Director of any facility expansion, production increase, or process modification that would result in any change in the discharge of water quality or volume.

Pursuant to Section 3109.G.4, this plan is for a period of five (5) years. **This approval will expire June 25, 2001, and an application for renewal should be submitted in ample time before that date.** It should be noted that all discharge plan facilities will be required to submit plans for, or the results of, an underground drainage testing program as a requirement for discharge plan renewal approval.

The discharge plan renewal for the PNMGS Santa Fe Junction Compressor Station GW-66 is subject to the WQCC Regulation 3114 discharge plan fee. Every billable facility submitting a discharge plan will be assessed a fee equal to the filing fee of fifty dollars (\$50) plus a flat fee of six-hundred and ninety dollars (\$690) for Compressor Stations between above 3,000 horsepower.

The \$50 filing fee has been received by the OCD. The flat fee for an approved discharge plan has not been received by the OCD.

On behalf of the staff of the Oil Conservation Division, I wish to thank you and your staff for your cooperation during this discharge plan review.

Sincerely,

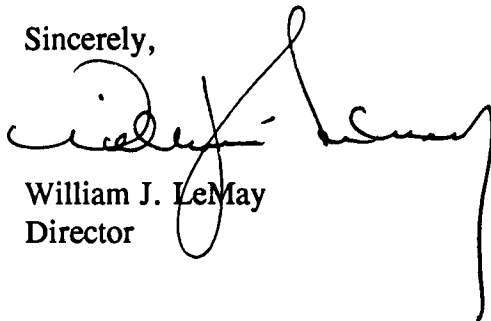
A handwritten signature in black ink, appearing to read 'William J. LeMay', is written over the typed name and title.

William J. LeMay
Director

Attachment

xc: Mr. Denny Foust

Ms. Toni K. Ristau
PNMGS
Page 3
August 7, 1996

ATTACHMENT TO DISCHARGE PLAN GW-66
PNMGS - Santa Fe Junction Compressor Station
DISCHARGE PLAN REQUIREMENTS
(August 7, 1996)

1. **Payment of Discharge Plan Fees:** The \$690 flat fee shall be submitted upon receipt of this approval. The required flat fee may be paid in a single payment due at the time of approval, or in equal annual installments over the duration of the plan, with the first payment due upon receipt of this approval.
2. **PNMGS Commitments:** PNMGS will abide by all commitments submitted in the Application dated June 18, 1996, as well as the letter and additional information dated June 20, 1996 from PNMGS and this approval letter with conditions of approval from OCD dated August 7, 1996.
3. **Drum Storage:** All drums containing materials other than fresh water must be stored on an impermeable pad and curb type containment. All empty drums should be stored on their sides with the bungs in place and lined up on a horizontal plane. Chemicals in other containers such as sacks or buckets should also be stored on an impermeable pad and curb type containment.

All drums and chemical containers shall be clearly labeled to identify their contents and other emergency information necessary if they were to rupture, spill, or ignite.
4. **Process Areas:** All process and maintenance areas which show evidence that leaks and spills are reaching the ground surface must be either paved and curbed or have some type of spill collection device incorporated into the design.
5. **Above Ground Tanks:** All above ground tanks which contain fluids other than fresh water must be bermed to contain a volume of one-third more than the total volume of the largest tank or of all interconnected tanks. All new facilities or modifications to existing facilities must place the tank on an impermeable type pad.
6. **Above Ground Saddle Tanks:** Above ground saddle tanks must have impermeable pad and curb type containment unless they contain fresh water or fluids that are gases at atmospheric temperature and pressure.
7. **Tank Labeling:** All tanks should be clearly labeled to identify their contents and other emergency information necessary if the tank were to rupture, spill, or ignite.

Ms. Toni K. Ristau

PNMGS

Page 4

August 7, 1996

8. **Below Grade Tanks/Sumps:** All below grade tanks, sumps, and pits must be approved by the OCD prior to installation or upon modification and must incorporate secondary containment and leak-detection into the design. All pre-existing sumps and below-grade tanks that do not have secondary containment and leak detection must demonstrate integrity on an annual basis. Integrity tests include pressure testing to 3 pounds per square inch above normal operating pressure and/or visual inspection of cleaned out tanks /or sumps.

9. **Underground Process/Wastewater Lines:** All underground process/wastewater pipelines must be tested to demonstrate their mechanical integrity at present and then every 5 years there after. Companies may propose various methods for testing such as pressure testing to 3 pounds per square inch above normal operating pressure or other means acceptable to the OCD. The OCD will be notified at least 72 hours prior to all testing so that an OCD representative may witness the testing.

10. **Housekeeping:** All systems designed for spill collection/prevention should be inspected to ensure proper operation and to prevent overtopping or system failure.

Any contaminated soils that are collected at the facility will be tested for hazardous constituents, and after receiving OCD approval, will be disposed of at an OCD approved site.

11. **Spill Reporting:** All spills/releases shall be reported pursuant to OCD Rule 116 and WQCC 1203 to the Aztec OCD District Office at (505)-334-6178.

12. **Transfer of Discharge Plan:** The OCD will be notified prior to any transfer of ownership, control, or possession of a facility with an approved discharge plan. A written commitment to comply with the terms and conditions of the previously approved discharge plan must be submitted by the purchaser and approved by the OCD prior to transfer.

13. **New Mexico Oil Conservation Division Inspections:** Additional requirements may be placed on the facility based upon results from New Mexico Oil Conservation Division inspections.

14. **Closure:** The OCD will be notified when operations of the facility are discontinued for a period in excess of six months. Prior to closure of the facility a closure plan will be submitted for approval by the director. Closure and waste disposal will be in accordance with the statutes, rules and regulations in effect at the time of closure.

15. **Conditions accepted by:**

Company Representative

Date

Title