

GW - 334

**GENERAL
CORRESPONDENCE**

YEAR(S):

2006-2000



NEW MEXICO ENERGY, MINERALS and NATURAL RESOURCES DEPARTMENT

BILL RICHARDSON

Governor

Joanna Prukop

Cabinet Secretary

Mark E. Fesmire, P.E.

Director

Oil Conservation Division

December 28, 2006

Mr. Shiver J. Nolan
Senior Compliance Administrator
Enterprise Products Operating, L.P.
P.O. Box 4324
Houston, Texas 77210-4324

**RE: Discharge Plan Permit Renewals
Mid-America Pipeline Company, LLC
Natural Gas Liquid Pipeline System
GW-334 (Kutz Pump Station)
San Juan County, New Mexico**

Dear Mr. Nolan:

The New Mexico Oil Conservation Division (OCD) has received Enterprise Products Operating, L.P. request dated May 11, 2006, on the behalf of Mid-America Pipeline Company, LLC, to renew the discharge plan permit GW-334 for the Mid-America Pipeline Company, LLC Kutz Pump Station located in the NW/4 of the NW/4 of Section 13, Township 11 North, Range 11 West, NMPM, San Juan County, New Mexico. The initial submittal did not include the required filing fee in order to initiate the review process. The filing fee was received and processed on October 26, 2006. The two submittals and a follow up email, which proposed the newspaper to publish the public notice, provided the required information in order to deem the application "administratively" complete.

Now that the submittal is deemed "administratively" complete, the New Mexico Water Quality Control Commission regulations (WQCC) public notice requirements of 20.6.2.3108 NMAC must be satisfied and demonstrated to the OCD. The OCD recommends a draft version of the public notice be provided for a pre-review prior to publishing in the newspaper and providing notice by certified mail to the property owner, in order to ensure all of the required information is provided prior to translation into Spanish and to prevent the expenditure of additional funds to republish the public notice.

The review of the submittal is to determine if any additional information or modifications may be required before consideration for technical approval. The submittal has been determined to be

technically incomplete. Therefore, the OCD requests additional information. All technical issues must be resolved prior to OCD's consideration for approval and initiation of the notice requirements of Subsection H of 20.6.2.3108 NMAC. In order to expedite and shorten the review and the OCD public notice time period, the OCD recommends that the requested information and modifications be provided within two weeks of receipt of this letter. A list of the required changes, additions, and corrections is provided below:

Page 1, Section III, Location of Facility

Please provide a street address, if available, and sufficient information to locate the discharge location with respect to surrounding landmarks.

Page 2, Section VII

The third paragraph suggests that laboratory analyses of non-exempt will occur once during the approval period of this plan and at a minimum of once every five years. OCD requires more frequent verification sampling. Wash-down bay water should be analyzed annually and all other non-exempt waste should be analyzed at a minimum once every two years. Please make the appropriate changes to this section.

Page 4, Section VIII, Storm Water Plan

The second paragraph states "this section concentrates on the identification of potential pollutants, identification of personnel responsible for the implementation, inspection and maintenance of the pollutant controls, and gives a description of structural controls to prevent storm water pollution." This is the appropriate information for this section. Please provide the information listed in the statement.

Page 4, Section VIII, Storm Water Plan – Site Assessment and Facility Controls

The plan states that "there are no engineered storm water controls or conveyances; all storm water leaves the site by overland flow." It also states that "any leakage or spill from the identified potential pollutant sources, if uncontained by existing berms, curbs, or emergency response actions, could flow overland to open off-site drainage ditches (arroyos) and this impact storm water. In such an event, containment would occur by blocking the ditch or culvert downstream of the pollutant." Engineered storm water controls must be proposed, installed, and implemented. The engineered storm water controls must be properly located and constructed to prevent releases from entering any drainage ditches, culverts, or watercourses. Please provide the details of the storm water plan and also mention the containment and spill prevention features listed in Table 2.

Page 6, Section XII, Facility Closure Plan

Please properly reference the Water Quality Control Commission (WQCC) in the first paragraph. In the second paragraph, please include the removal of all above and below ground tanks in the general closure measures.

Release Reporting Procedures, Interoffice Communication

Please include OCD contact information and notice criteria in the release reporting procedures.

Mr. Nolan
December 28, 2006
Page 3 of 3

If there are any questions regarding this matter, please do not hesitate to contact me at (505) 476-3487 or brad.a.jones@state.nm.us. On behalf of the staff of the OCD, I wish to thank you and your staff for your cooperation during this discharge permit review.

Sincerely,

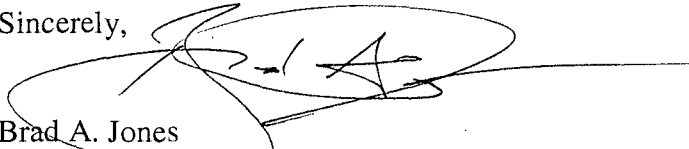
A handwritten signature in black ink, appearing to read "Brad A. Jones", is written over a large, loopy circular flourish.

Brad A. Jones
Environmental Engineer

BAJ/baj

cc: OCD District III Office, Aztec
Runell A. Seale, Permitting Specialist, EPCO, Inc., Farmington, NM

Jones, Brad A., EMNRD

From: Seale, Runell [RSeale@eprod.com]
Sent: Friday, October 27, 2006 8:23 AM
To: Jones, Brad A., EMNRD
Cc: Fernald, Donald
Subject: RE: Renewal Applications for Mid-America Pipeline Company pump stations.
Attachments: Public Notice - Caprock Renewal.doc; Newspapers-OCD.xls

Hello Brad,

I have attached a sample public notice in English for the Caprock station. The other stations will be similar with site specific location data for each of the eleven facilities. I will have this translated into Spanish after you approve the wording. I have also attached a spreadsheet that lists the newspapers I plan to have the notice/advertisement published in. Please advise if you have any questions.

Runell A. Seale

Specialist, Environmental Permitting
EPCO, Inc.
614 Reilly Ave.
Farmington, NM 87401
505 599-2124 office
505 599-2538 fax
505 320-2816 cell
e-mail: rseale@eprod.com

From: Jones, Brad A., EMNRD [mailto:brad.a.jones@state.nm.us]
Sent: Tuesday, October 03, 2006 3:27 PM
To: Seale, Runell
Subject: RE: Renewal Applications for Mid-America Pipeline Company pump stations.

Runell,

I have attached a copy of the July 2006 WQCC regulations (20.6.2.3108 NMAC) regarding only the notice requirements. The highlighted (red) sections are the tasks that must be satisfied for renewals. Please review Subsections A and C closely. Subsections A specifies what must be submitted in order to be deemed administratively complete and Subsection C specifies the notice requirements for renewals. It is recommended that a draft notice is submitted to us for review to determine if all of the required information and language of Subsection F is provided, prior to publication. You will find that the questions proposed below are answered in the highlighted sections. If you have any additional questions, please do not hesitate to contact me.

FYI: The requirements for new permits and modifications for different from renewals.

Brad

Brad A. Jones
Environmental Engineer
Environmental Bureau

12/28/2006

*NM Oil Conservation Division
1220 S. St. Francis Drive
Santa Fe, New Mexico 87505
E-mail: brad.a.jones@state.nm.us
Office: (505) 476-3487
Fax: (505) 476-3462*

From: Seale, Runell [<mailto:RSeale@eprod.com>]
Sent: Tuesday, October 03, 2006 2:11 PM
To: Jones, Brad A., EMNRD
Subject: Renewal Applications for Mid-America Pipeline Company pump stations.

Brad,

In reviewing the new guidelines (June 2006) I notice that the language refers to "in a form provided by the department" Would you please provide an example of the format that is required for the synopsis publication notice, in English and Spanish.

I also note that we must not put this in the legal notice section. I assume that this means it should look like a box advertisement, is that correct?

Runell A. Seale

Environmental Specialist
EPCO, Inc.
614 Reilly Ave.
Farmington, NM 87401
505 599-2124 office
505 599-2538 fax
505 320-2816 cell
e-mail: rseale@eprod.com

Confidentiality Notice: This e-mail, including all attachments is for the sole use of the intended recipient (s) and may contain confidential and privileged information. Any unauthorized review, use, disclosure or distribution is prohibited unless specifically provided under the New Mexico Inspection of Public Records Act. If you are not the intended recipient, please contact the sender and destroy all copies of this message. -- This email has been scanned by the Sybari - Antigen Email System.

12/28/2006

Newspapers for Public Notice for MAPL Discharge Plans

Pump Station	Plan Number	County	Newspaper	City
Caprock	GW342	Lea	Hobbs News Sun	Hobbs
Edgewood	GW340	Santa Fe	Moriarity Mountain View Telegraph	Moriarity
Estancia	GW339	Torrance	Moriarity Mountain View Telegraph	Moriarity
Duran	GW336	Guadalupe	Roswell Daily Record	Roswell
Huerfano	GW335	San Juan	The Daily Times	Farmington
Kutz	GW334	San Juan	The Daily Times	Farmington
Lybrook	GW337	Rio Arriba	The Daily Times	Farmington
Mesa	GW338	Chaves	Roswell Daily Record	Roswell
San Luis	GW333	Sandoval	Rio Rancho Observer	Rio Rancho
San Ysidro	GW332	Sandoval	Rio Rancho Observer	Rio Rancho
White Lakes	GW341	Chaves	Roswell Daily Record	Roswell

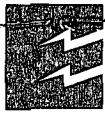

Enterprise Products

October 18, 2006

P.O. Box 4324
2727 North Loop West

Houston, Texas 77210-4324
Houston, Texas 77008-1044

713.880.6500
www.epplp.com

Return Receipt Requested
7005 1820 0000 7947 3702

Mr. Brad Jones
Environmental Bureau
New Mexico Energy Mineral and
Natural Resources Department
1220 South St. Francis Drive
Santa Fe, New Mexico 87505

RE: Discharge Plan Application/Discharge Plant Renewals

Dear Mr. Jones,

In compliance with New Mexico Water Quality Control Commission Regulation 20.6.2.3114 Fees enclosed please find a check in the amount of \$1,100.00 in payment for application filing fees for the following Mid-America Pipeline Company, LLC pump stations. The applications were submitted to your department on May 11, 2006.

Pump Station Name	County	Discharge Plan Number
Caprock	Lea County	GW-342 ✓
Edgewood	Santa Fe County	GW-340 ✓
Estancia	Torrance County	GW-339 ✓
Duran	Guadalupe County	GW-336 ✓
Huerfano	San Juan County	GW-335 ✓
Kintz	San Juan County	GW-334 ✓
Lybrook	Rio Arriba County	GW-337 ✓
Mesa	Chaves County	GW-338 ✓
San Luis	Sandoval County	GW-333 ✓
San Ysidro	Sandoval County	GW-332 ✓
White Lakes	Chaves County	GW-341 ✓

Should you have questions or need additional information, please contact Ms. Runell Seale, Specialist-Environmental Permitting at 505/599-2124 or Mr. Clay Roesler, Manager-Environmental Permitting at 713/803-7917.

Yours truly,

Shiver J. Nolan

Description	FUND	CEB	DFA ORG	D AC	ED ORG	ED ACCT	AMOUNT	
1 CY Reimbursement Project Tax	064	01						1
2 Gross Receipt Tax	064	01		2328	900000	2328134		2
3 Air Quality Title V	092	13	1300	1896	900000	4168134		3
4 PRP Payments	248	14	1400	9696	900000	4989014		4
5 Olinax Chemical Co.	248	14	1400	9696	900000	4989015		5
6 Olinax Reimbursements	248	14	1400	9696	900000	4989248		6
7 Hazardous Waste Permits	338	27	2700	1686	900000	4169027		7
8 Hazardous Waste Annual Generator Fees	339	27	2700	1686	900000	4166339		8
9 Air Quality - Oil Conservation Division	341	29		2328	900000	2328029	110000	9
10 Air Quality - GW Discharge Permit	341	29	2900	1696	900000	4169029		10
11 Air Quality Permits	631	31	2500	1696	900000	4169031		11
12 Payments Under Protest	651	33		2349	900000	2349033		12
13 Copies	652	34		2349	900000	2349001		13
14 Groundwater Penalties	652	34		2349	900000	2349002		14
15 Mineral Fees	652	34		2349	900000	2439003		15
16 Air Quality Penalties	652	34		2349	900000	2349004		16
17 OSHA Penalties	652	34		2349	900000	2349005		17
18 Prior Year Reimbursement	652	34		2349	900000	2349006		18
19 Surface Water Quality Certification	652	34		2349	900000	2349009		19
20 Jury Duty	652	34		2349	900000	2349012		20
21 CY Reimbursements (i.e. telephone)	652	34		2349	900000	2349014		21
22 UST Owner's List	783	24	2500	9696	900000	4989201		22
23 Hazardous Waste Notifiers List	783	24	2500	9696	900000	4989202		23
24 UST Maps	783	24	2500	9696	900000	4989203		24
25 UST Owner's Update	783	24	2500	9696	900000	4989205		25
26 Hazardous Waste Regulations	783	24	2500	9696	900000	4989207		26
27 Radiologic Tech. Regulations	783	24	2500	9696	900000	4989208		27
28 Superfund CERLIS List	783	24	2500	9696	900000	4989211		28
29 Solid Waste Permit Fees	783	24	2500	9696	900000	4989213		29
30 Smoking School	783	24	2500	9696	900000	4989214		30
31 GWQB - NPS Publications	783	24	2500	9696	900000	4989222		31
32 Radiation Licensing Regulation	783	24	2500	9696	900000	4989228		32
33 Sale of Equipment	783	24	2500	9696	900000	4989301		33
34 Sale of Automobile	783	24	2500	9696	900000	4989302		34
35 Lost Recoveries	783	24	2500	9696	900000	4989314		35
36 Lost Repayments	783	24	2500	9696	900000	4989315		36
37 Surface Water Publication	783	24	2500	9696	900000	4989301		37
38 Exxon Release Drive Ruidoso - CAF	783	24	2500	9696	900000	4989242		38
39 Emerg. Hazardous Waste Penalties NOV	957	32	9600	1696	900000	4164032		39
40 Radiologic Tech. Certification	957	05	0500	1696	900000	4169005		40
41 Ust Permit Fees	989	20	3100	1696	900000	4169020		41
42 UST Tank Installers Fees	989	20	3100	1696	900000	4169021		42
43 Food Permit Fees	991	26	2600	1696	900000	4169026		43
44 Other								44

Gross Receipt Tax Required

Site Name & Project Code Required

TOTAL \$1,100.00

Contact Person: Wayne Price

Phone: 476-3490

Date:

10/26/00

Received in ASD By:

Date:

RT #:

ST #:

ACKNOWLEDGEMENT OF RECEIPT
OF CHECK/CASH

I hereby acknowledge receipt of check No. [REDACTED] dated 10/16/06

or cash received on [REDACTED] in the amount of \$ 100.00

for Enterprise Products

to GW-334 Kutz

Submitted by Lawrence Romero Date 10/26/06

Submitted to ASD by [REDACTED] Date 10/26/06

Received in ASD by [REDACTED] Date [REDACTED]

Filing Fee ☒ New Facility [REDACTED] Renewal [REDACTED]

Modification [REDACTED] Other [REDACTED]

Organization Code 52107 Applicable FY 2004

To be deposited in the Water Quality Management Fund.

Full Payment [REDACTED] or Annual Increment [REDACTED]



THE FACE OF THIS DOCUMENT CONTAINS SECURITY PRINTING.



MID-AMERICA PIPELINE COMPANY, LLC
P.O. BOX 4324
HOUSTON, TEXAS 77210

JPMORGAN CHASE BANK, N.A.

56-1544/441



DATE

16-OCT-06

PAY EXACTLY

AMOUNT

One Thousand One Hundred And No/100 Dollars

\$*****1,100.00

PAY TO THE
ORDER OF

STATE OF NEW MEXICO
ENERGY MINERALS & NAT RES DEPT
1220 SOUTH ST FRANCIS DR
SANTA FE, NM 87505
United States

REGULAR ACCOUNT
VOID AFTER 180 DAYS

W. Randolph Farley



Jones, Brad A., EMNRD

From: Chavez, Carl J, EMNRD
Sent: Tuesday, September 19, 2006 1:50 PM
To: RSeale@eprod.com
Cc: Jones, Brad A., EMNRD
Subject: FW: Renewal Discharge Plans
Attachments: Chavez, Carl J, EMNRD.vcf

Ms. Seale:

Mr. Ed Martin was the permit writer, but has recently accepted another position in the Bureau. As you can see from the msgs. below, it appears that Mr. Brad Jones will take over for Mr. Martin and will be pulling the files to begin work on renewing discharge plans for Mid-America Pipeline Company, LLC.

Thank you for contacting the Oil Conservation Division and you may contact Mr. Brad Jones at (505) 476-3487 or via Brad's e-mail address above if you have question. Sincerely,

Carl J. Chavez, CHMM
New Mexico Energy, Minerals & Natural Resources Dept.
Oil Conservation Division, Environmental Bureau
1220 South St. Francis Dr., Santa Fe, New Mexico 87505
Office: (505) 476-3491
Fax: (505) 476-3462
E-mail: CarlJ.Chavez@state.nm.us
Website: <http://www.emnrd.state.nm.us/ocd/>
(Pollution Prevention Guidance is under "Publications")

From: Price, Wayne, EMNRD
Sent: Tuesday, September 19, 2006 12:11 PM
To: Chavez, Carl J, EMNRD; Jones, Brad A., EMNRD
Cc: Martin, Ed, EMNRD
Subject: RE: Renewal Discharge Plans

Brad, please go into RBDMS and change the reviewer name from Martin to Jones. When the new guy gets here I want us to inspect these facilities. Also please pull the files and determine what our next move is.

From: Chavez, Carl J, EMNRD
Sent: Thursday, September 14, 2006 3:33 PM
To: Price, Wayne, EMNRD
Cc: Martin, Ed, EMNRD
Subject: FW: Renewal Discharge Plans

Wayne:

FYI. I am copying Ed Martin on this msg. I think she wants to know the status. Thnx.

Carl J. Chavez, CHMM
New Mexico Energy, Minerals & Natural Resources Dept.

9/20/2006

Oil Conservation Division, Environmental Bureau
 1220 South St. Francis Dr., Santa Fe, New Mexico 87505
 Office: (505) 476-3491
 Fax: (505) 476-3462
 E-mail: CarlJ.Chavez@state.nm.us
 Website: <http://www.emnrd.state.nm.us/ocd/>
 (Pollution Prevention Guidance is under "Publications")

From: Seale, Runell [mailto:RSeale@eprod.com]
Sent: Thursday, September 14, 2006 3:14 PM
To: Chavez, Carl J, EMNRD
Subject: Renewal Discharge Plans

Hello Carl,

As we discussed today, I have listed the Discharge Plans we are awaiting approval upon. Would you please check on status of these renewals and let me know? Thanks for your assistance.

Mid-America Pipeline Company, LLC Renewal Discharge Plans were sent to Ed Martin, New Mexico Energy Minerals and Natural Resources Department, 1220 S. St. Francis Drive, Santa Fe, NM 87505 on May 11, 2006.

Awaiting approval from NM Energy, Minerals & Natural Resources Dept/Environmental Bureau-Santa Fe for the following:

Caprock Pump Station	GW342
Edgewood Pump Station	GW340
Estancia Pump Station	GW339
Duran Pump Station	GW336
Huerfano Pump Station	GW335
Kutz Pump Station	GW334
Lybrook Pump Station	GW337
Mesa Pump Station	GW338
San Luis Pump Station	GW333
San Ysidro Pump Station	GW332
White Lakes Pump Station	GW341

Runell A. Seale

Environmental Specialist
 EPCO, Inc. (Enterprise Products Operating, LLP)
 614 Reilly Ave.
 Farmington, NM 87401
 505 599-2124 office
 505 599-2538 fax
 505 320-2816 cell
 e-mail: rseale@eprod.com



Enterprise Products

May 11, 2006

P.O. Box 4324 Houston, Texas 77210-4324 713.880.6500
2727 North Loop West Houston, Texas 77008-1044 www.epplp.com

Return Receipt Requested
7003 1680 0005 0234 3578

Mr. Ed Martin
Oil Conservation Division
NEW MEXICO ENERGY MINERALS AND
NATURAL RESOURCES DEPARTMENT
1220 South Saint Francis Drive
Santa Fe, New Mexico 87505

RE: Discharge Plan Application/Discharge Plan Renewals –

Dear Mr. Martin:

Enclosed for your review and handling are the Discharge Plan Renewals for the following facilities:

Pump Station Name	County	OCD #	EXP.
Caprock	Lea County	GW-342	4-12-06
Edgewood	Santa Fe County	GW-340	4-16-06
Estancia	Torrance County	GW-339	"
Duran	Guadalupe County	GW-336	5-8-06
Huerfano	San Juan County	GW-335	"
Kutz	San Juan County	GW-334	"
Lybrook	Rio Arriba County	GW-337	4-10-06
Mesa	Chaves County	GW-338	5-17-06
San Luis	Sandoval County	GW-333	5-8-06
San Ysidro	Sandoval County	GW-332	"
White Lakes	Chaves County	GW-341	4-12-06

Should you have questions or need additional information, please contact Mr. Donald Fernald, Environmental Scientist at 505/599-2141 or Mr. Alvaro Parro, Environmental Manager-Pipelines at 713/880-6957.

Yours truly,

Shiver J. Nolan
Senior Compliance Administrator

sjn/ras
Enclosures
Copy to: Denny Foust, NMOC'D, Aztec



NEW MEXICO ENERGY, MINERALS and NATURAL RESOURCES DEPARTMENT

BILL RICHARDSON

Governor

Joanna Prukop

Cabinet Secretary

Mark E. Fesmire, P.E.

Director

Oil Conservation Division

December 22, 2005

Mr. Alvaro Parra
Enterprise Products Operating, L.P.
P.O. Box 4324
Houston, TX 77210-4324

RE: Discharge Permit Expirations

Dear Mr. Hurlburt:

The following discharge permits expire soon.

Permit Number	Facility	Expiration Date
GW-333	San Luis Pump Station	May 8, 2006
GW-336	Duran Pump Station	May 8, 2006
GW-335	Huerfano Pump Station	May 8, 2006
GW-334	Kutz Pump Station	May 8, 2006
GW-341	White Lakes Pump Station	April 19, 2006
GW-337	Lybrook Pump Station	April 16, 2006
GW-339	Estancia Pump Station	April 16, 2006
GW-338	Mesa Pump Station	April 13, 2006

Permit renewals should be submitted to the New Mexico Oil Conservation Division as soon as possible. Please address all future correspondence concerning these facilities to:

Ed Martin
New Mexico Oil Conservation Division
1220 S. St. Francis
Santa Fe, NM 87505

If you have any questions, contact me at (505) 476-3492 or ed.martin@state.nm.us

NEW MEXICO OIL CONSERVATION DIVISION

Edwin E. Martin
Environmental Bureau

ENTERPRISE PRODUCTS OPERATING, L.P.
P.O. BOX 1788
ROCK SPRINGS, WY 82902-1788
307-362-2703

ENTERPRISE®

August 26, 2003

RECEIVED

AUG 28 2003

**OIL CONSERVATION
DIVISION**

Mr. Jack Ford
State of New Mexico
Oil Conservation Division
1220 South St. Francis Drive
Santa Fe, NM 87505

RE: Transfer of Discharge Permits

Dear Mr. Ford:

Enterprise Products Company, L.P. is submitting this letter to notify NMOCD of the transfer for the OCD Discharge Plans listed below. On February 1, 2003 the owner remained as Mid-America Pipeline, however the operator changed from "The Williams Companies, Inc." to "Enterprise Products Operating, L.P".

Caprock	GW-342	Lybrook	GW-337
Duran	GW-336	Mesa	GW-338
Edgewood	GW-340	San Luis	GW-333
Estancia	GW-339	San Ysidro	GW-332
Huerfano	GW-335	White Lakes	GW-341
Kutz	GW-334		

Enterprise Products Operating, L.P agrees to abide by all commitments submitted in each of the above discharge plan renewal applications.

Please direct all future inquiries, regarding Discharge Plans to:

Enterprise Products Operating, L.P
ATTN: Alvaro Parra
PO Box 4324
Houston, TX 77210-4324
(713) 880-6957

Should you have any questions please call me at 307-362-2703 ext. 106.

Sincerely,

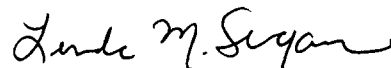

Linda Sugano
Environmental Specialist

cc: Alvaro Parra, Enterprise



Four Corners Area
Environmental Department
#188 CR 4900
Bloomfield, N.M. 87413

RECEIVED

DEC 07 2001

Environmental Bureau
Oil Conservation Division

December 7, 2001

Mr. Jack Ford
State of New Mexico
Oil Conservation Division
1220 South St. Francis Drive
Santa Fe, NM 87505

Re: Drain Line Testing Results at Various Williams Field Services Facilities

Dear Mr. Ford:

WFS conducted a facility review and drain line testing in accordance to the Oil Conservation Division (OCD) Discharge Plan requirements. Subsurface, non-pressurized process and wastewater lines were tested. The facility drain line testing reports enclosed with this letter. A review and testing summary is provided in the table below.

Facility	Permit #	Completion Date	Results	Comments
29-6#3 CDP	GW-198	9/13/2001	Passed	
32-9 CDP	GW-091	9/28/2001	Passed	
Blanco Compressor	GW-327	NA	NA	No drain lines to be tested.
Cedar Hill CDP	GW-087	9/19/2001	Passed	
Chaco Compressor	GW-331	NA	NA	No drain lines to be tested.
Coyote Springs Compressor	GW-250	9/12/2001	Passed	
Dogie Compressor	GW-330	NA	NA	No drain lines to be tested.
Hare Compressor	GW-343	8/27/2001	Passed	
Keblah Compressor	GW-329	NA	NA	No drain lines to be tested.
Kernaghan Compressor	GW-271	9/12/2001	Passed	
Kutz NGL Pump Station	GW-334	8/31/2001	Passed	UST leak detection sys. is OK
La Jara Compressor	GW-233	NA	NA	No drain lines to be tested.
Middle Mesa CDP	GW-064	10/9/2001	Passed	
Milagro Plant	GW-060	8/20/2001	Passed	
Pritchard Compressor	GW-274	9/6/2001	Passed	
Pump Mesa CDP	GW-063	10/23/2001	Passed	
Thompson Compressor	GW-328	NA	NA	No drain lines to be tested.

If you have any questions or require additional information, I can be reached at (505) 632-4634.

Sincerely;

A handwritten signature in black ink, appearing to read 'MJB' followed by a stylized flourish.

Mark J. Bareta
Senior Environmental Specialist

Attachments: Drain Line Testing Reports
xc: Denny Foust, Aztec OCD



October 29, 2001
AMEC Project No. 1-517-000089

Mr. Mark Bareta
Williams Field Services
188 CR 4900
Bloomfield, New Mexico 87413

**RE: Drain Line Testing
Williams Field Services Kutz NGL Compressor Station
San Juan County, New Mexico**

Dear Mr. Bareta,

AMEC Earth & Environmental, Inc. (AMEC) is pleased to provide Williams Field Services (WFS) with results of the underground storage tank leak detection system inspection at the WFS Kutz NGL Compressor Station located in rural San Juan County, New Mexico. Only visual inspection of the leak detection system through an operational check to confirm system operation is required according to the facilities' Oil Conservation Division (OCD) Ground Water Discharge Plan requirements.

An electronic leak detection system is installed on the underground storage tank at the Kutz NGL Compressor Station. As an operational check, there is a button on the system that can be depressed and if the system is operational, an indicator light will light up confirming system operation.

AMEC mobilized to the site and confirmed operation of the leak detection system on August 31, 2001. AMEC's on-site crew consisted of Bruce Hare (Site Supervisor) and a 3-man field crew.

Details of the leak detection system inspection are summarized in the attached Pressure Test Reports.

In keeping with WFS's policy, along with AMEC's own internal Health and Safety policies, AMEC's on-site employees attended daily safety meetings.

AMEC Earth & Environmental, Inc.
2060 Afton Place
Farmington, New Mexico, USA
Tel 1+505-327-7928
Fax 1+505-326-5721

www.amec.com

Williams Field Services
Drain Line Testing-Kutz NGL Compressor Station
Phase 6, Task 21
October 29, 2001



AMEC appreciates the opportunity to perform these services at the Kutz NGL Compressor Station for WFS. Should you have any questions, please feel free to contact our office at 327-7928.

Respectfully submitted,

AMEC Earth & Environmental, Inc.

A handwritten signature in black ink that reads "Robert Thompson". The signature is written in a cursive, flowing style.

Robert Thompson
Project Manager

Attachments: Daily Summary of Line Testing

Copies: Addressee (3)

Hydrostatic Line Testing Form



AMEC Project Number: 1517000064 Client: Williams Field Services

Task: 21 Facility Name: Kutz NGL compressor station

Test Description: Varified leak detection system is working properly

System Description: Approx. 100 Gal. U.S.T. Filled with Hoses NO visible Pipel.

Test Medium: N/A Test Pressure: N/A Test Date: 8-31-01

Test Requirements: Hydrostatic pressure test on all underground process/wastewater pipelines in accordance with the State of New Mexico, Energy, Minerals, and Natural Resources Department - Oil Conservation Division Best Management Practices minimum requirements. Perform a hydrostatic pressure test on underground process/wastewater pipelines at 3 pounds per square inch for a period of one hour.

Test Data:

Start	Stop	Pressure	Pass/Fail	Lines Tested

Review and Approvals:

<u>Morgan Killion</u> AMEC Representative Signature	<u>Morgan Killion</u> Printed Name	<u>8-31-01</u> Date
<u>Sam Walker</u> Client Representative Signature	<u>Sam Walker</u> Printed Name	<u>8-31-01</u> Date

AFFIDAVIT OF PUBLICATION

Ad No. 44251

STATE OF NEW MEXICO County of San Juan:

ALETHIA ROTH LISBERGER, being duly sworn says: That she is the Classified Manager of THE DAILY TIMES, a daily newspaper of general circulation published in English at Farmington, said county and state, and that the hereto attached Legal Notice was published in a regular and entire issue of the said DAILY TIMES, a daily newspaper duly qualified for the purpose within the meeting of Chapter 167 of the 1937 Session Laws of the State of New Mexico for publication on the following day(s):

Wednesday, April 4, 2001.

And the cost of the publication is \$111.97.

Alethia Rothlisberger

ON 4/6/01 ALETHIA ROTH LISBERGER appeared before me, whom I know personally to be the person who signed the above document.

Ginny Beck
My Commission Expires April 02, 2004

COPY OF PUBLICATION

918

Legals

NOTICE OF PUBLICATION

STATE OF NEW MEXICO ENERGY, MINERALS AND NATURAL RESOURCES DEPARTMENT OIL CONSERVATION DIVISION

Notice is hereby given that pursuant to the New Mexico Water Quality Control Commission Regulations, the following discharge plan application has been submitted to the Director of the Oil Conservation Division, 1220 South Saint Francis Drive, Santa Fe, New Mexico 87505, Telephone (505) 476-3440:

(GW-334) - Williams Field Service, Mark J. Barets, Senior Environmental Specialist, 188 CR 4900, Bloomfield, New Mexico 87413, has submitted a discharge plan application for their Kutz Pump Station located in the SW/4 NW/4, Section 13, Township 28 North, Range 11 West, NMPM, San Juan County, New Mexico. All effluents generated on site are collected in containment vessels prior to transport to an OCD approved off-site disposal facility. Groundwater most likely to be affected by an accidental discharge is at a depth ranging from 420 to 450 feet with a total dissolved solids concentrations ranging from 200 to 1000 mg/l. The discharge plan addresses how spill, leaks, and other accidental discharges to the surface will be managed.

(GW-335) - Williams Field Service, Mark J. Barets, Senior Environmental Specialist, 188 CR 4900, Bloomfield, New Mexico 87413, has submitted a discharge plan renewal application for their Huerfano Pump Station located in the NW/4 SW/4, Section 21, Township 26 North, Range 10 West, NMPM, San Juan County, New Mexico. All effluents generated on site are collected in containment vessels prior to transport to an OCD approved off-site disposal facility. Groundwater most likely to be affected by an accidental discharge is at a depth ranging from 500 to 1000 feet with a total dissolved solids concentrations ranging from 500 to 3000 mg/l. The discharge plan addresses how spill, leaks, and other accidental discharges to the surface will be managed.

Any interested person may obtain further information from the Oil Conservation Division and may submit written comments to the Director of the Oil Conservation Division at the address given above. The discharge plan application may be viewed at the above address between 8:00 a.m. and 4:00 p.m., Monday thru Friday. Prior to ruling on any proposed discharge plan or its modification, the Director of the Oil Conservation Division shall allow at least thirty (30) days after the date of publication of this notice during which comments may be submitted to him and public hearing may be requested by any interested person. Request for public hearing shall set forth the reasons why a hearing shall be held.

A hearing will be held if the director determines that there is significant public interest.

If no hearing is held, the Director will approve or disapprove the plan based on the information available. If a public hearing is held, the Director will approve the plan based on the information in the plan and information presented at the hearing.

GIVEN under the Seal of New Mexico Conservation Commission at Santa Fe, New Mexico, on this 23rd day of March, 2001.

STATE OF NEW MEXICO
OIL CONSERVATION DIVISION

SEAL

LORI WROTENBERY, Director

Legal No. 44251, published in The Daily Times, Farmington, New Mexico, Wednesday, April 4, 2001.

THE SANTA FE
NEW MEXICAN
Founded 1849

NEW MEXICO OIL CONSERVATION DIVISION

ATTN: ED MARTIN
2040 S. PACHECO
SANTA FE, NM 87505

NOTICE OF
PUBLICATION

STATE OF NEW MEXICO
ENERGY, MINERALS
AND NATURAL
RESOURCES
DEPARTMENT
OIL CONSERVATION
DIVISION

Notice is hereby given that pursuant to the New Mexico Water Quality Control Commission Regulations, the following discharge plan application has been submitted to the Director of the Oil Conservation Division, 1220 South Saint Francis Drive, Santa Fe, New Mexico 87505, Telephone (505) 476-3440:

(GW-334) Williams Field Service, Mark J. Baretts, Senior Environmental Specialist, 188 CR 4900, Bloomfield, New Mexico 87413, has submitted a discharge plan application for their Kutz Pump Station located in the SW/4 NW/4, Section 13, Township 28 North, Range 11 West, NMPM, San Juan County, New Mexico. All effluents generated on site are collected in containment vessels prior to transport to an OCD approved off-site disposal facility. Groundwater most likely to be affected by an accidental discharge is at a depth ranging from 420 to 450 feet with a total dissolved solids concentrations ranging from 200 to 1000 mg/l. The discharge plan addresses how spill, leaks, and other accidental discharges to the surface will be managed.

(GW-335) Williams Field Service, Mark J. Baretts, Senior Environmental Specialist, 188 CR 4900, Bloomfield, New Mexico 87413, has submitted a discharge plan renewal application for their Huerfano Pump Station located in the NW/4 SW/4, Section 21, Township 26 North, Range 10 West, NMPM, San Juan County, New Mexico. All effluents generated on site are collected in containment vessels prior to transport to an OCD approved off-site disposal facility.

Groundwater most likely to be affected by an accidental discharge is at a depth ranging from 500 to 1000 feet with a total dissolved solids concentrations ranging from 500 to 3000 mg/l. The discharge plan addresses how spill, leaks, and other accidental discharges to the surface will be managed.

Any interested person may obtain further information from the Oil Conservation Division and may submit written comments to the Director of the Oil Conservation Division at the address given above. The discharge plan application may be viewed at the above address between 8:00 a.m. and 4:00 p.m., Monday thru Friday. Prior to ruling on any proposed discharge plan or its modification, the Director of the Oil Conservation Division shall allow at least thirty (30) days after the date of publication of this notice during which comments may be submitted to him and public hearing may be requested by any interested person. Request for public hearing shall set forth the reasons why a hearing shall be held.

A hearing will be held if the Director determines that there is significant public interest.

If no hearing is held, the Director will approve or disapprove the plan based on the information available. If a public hearing is held, the Director will approve the plan based on the information in the plan and information presented at the hearing.

GIVEN under the Seal of New Mexico Conservation Commission at Santa Fe, New Mexico, on this 23rd day of March, 2001.

STATE OF NEW MEXICO
OIL CONSERVATION
DIVISION

LORI WROTENBERY,
Director

Legal #69098
Pub. April 5, 2001

AD NUMBER: 200140 ACCOUNT: 56689
LEGAL NO: 69098 P.O.#: 01199000033
233 LINES 1 time(s) at \$ 102.71
AFFIDAVITS: 5.25
TAX: 6.75
TOTAL: 114.71

AFFIDAVIT OF PUBLICATION

STATE OF NEW MEXICO
COUNTY OF SANTA FE

I, MM Weideman being first duly sworn declare and say that I am Legal Advertising Representative of THE SANTA FE NEW MEXICAN, a daily newspaper published in the English language, and having a general circulation in the Counties of Santa Fe and Los Alamos, State of New Mexico and being a Newspaper duly qualified to publish legal notices and advertisements under the provisions of Chapter 167 on Session Laws of 1937; that the publication #69098 a copy of which is hereto attached was published in said newspaper 1 day(s) between 04/05/2001 and 04/05/2001 and that the notice was published in the newspaper proper and not in any supplement; the first publication being on the 5 day of April, 2001 and that the undersigned has personal knowledge of the matter and things set forth in this affidavit.

/S/

MM Weideman

LEGAL ADVERTISEMENT REPRESENTATIVE

Subscribed and sworn to before me on this
5 day of April A.D., 2001

Notary

Laura E. Harding

Commission Expires

11/23/03

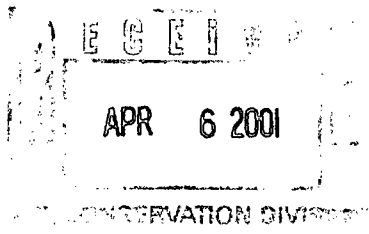

www.sfnewmexican.com

01-2021 • 505-983-3303 • fax: 505-984-1785 • P.O. Box 2048, Santa Fe, NM 87504-2048

Ford, Jack

From: Martin, Ed
Sent: Monday, April 02, 2001 7:52 AM
To: 'Santa Fe New Mexican'
Cc: Ford, Jack
Subject: Legal Notice

Santa Fe New Mexican

Attn: Betsy Perner

Hi, Betsy. Please publish the attached notice one time upon receipt of this request. Upon publication, forward to this office:

1. Publisher's affidavit
2. Invoice (Our P.O. # is 01199000033)

Please publish by April 6, 2001.

If you have any questions, please e-mail me or call 476-3492.

Thank you.

Public Notice G-334

Ford, Jack

From: Martin, Ed
Sent: Monday, April 02, 2001 7:47 AM
To: 'Farmington Daily Times'
Cc: Ford, Jack
Subject: Legal Notice

Farmington Daily Times
Attn: Alethia Rothlisberger

Please publish the attached notice one time immediately on receipt of this request.

Please send the following to this office:

1. Publisher's affidavit
2. Invoice (Our P.O. # is **01199000031**)

Please publish the notice no later than April 6, 2001.
If you have any questions, please e-mail me or call 505-476-3492.
Thank you.



NOTICE OF PUBLICATION

STATE OF NEW MEXICO ENERGY, MINERALS AND NATURAL RESOURCES DEPARTMENT OIL CONSERVATION DIVISION

Notice is hereby given that pursuant to the New Mexico Water Quality Control Commission Regulations, the following discharge plan application has been submitted to the Director of the Oil Conservation Division, 1220 South Saint Francis Drive, Santa Fe, New Mexico 87505, Telephone (505) 476-3440:

(GW-334) - Williams Field Service, Mark J. Barets, Senior Environmental Specialist, 188 CR 4900, Bloomfield, New Mexico 87413, has submitted a discharge plan application for their Kutz Pump Station located in the SW/4 NW/4, Section 13, Township 28 North, Range 11 West, NMPM, San Juan County, New Mexico. All effluents generated on site are collected in containment vessels prior to transport to an OCD approved off-site disposal facility. Groundwater most likely to be affected by an accidental discharge is at a depth ranging from 420 to 450 feet with a total dissolved solids concentrations ranging from 200 to 1000 mg/l. The discharge plan addresses how spill, leaks, and other accidental discharges to the surface will be managed.

(GW-335) - Williams Field Service, Mark J. Barets, Senior Environmental Specialist, 188 CR 4900, Bloomfield, New Mexico 87413, has submitted a discharge plan renewal application for their Huerfano Pump Station located in the NW/4 SW/4, Section 21, Township 26 North, Range 10 West, NMPM, San Juan County, New Mexico. All effluents generated on site are collected in containment vessels prior to transport to an OCD approved off-site disposal facility. Groundwater most likely to be affected by an accidental discharge is at a depth ranging from 500 to 1000 feet with a total dissolved solids concentrations ranging from 500 to 3000 mg/l. The discharge plan addresses how spill, leaks, and other accidental discharges to the surface will be managed.

Any interested person may obtain further information from the Oil Conservation Division and may submit written comments to the Director of the Oil Conservation Division at the address given above. The discharge plan application may be viewed at the above address between 8:00 a.m. and 4:00 p.m., Monday thru Friday. Prior to ruling on any proposed discharge plan or its modification, the Director of the Oil Conservation Division shall allow at least thirty (30) days after the date of publication of this notice during which comments may be submitted to him and public hearing may be requested by any interested person. Request for public hearing shall set forth the reasons why a hearing shall be held.

A hearing will be held if the director determines that there is significant public interest.

If no hearing is held, the Director will approve or disapprove the plan based on the information available. If a public hearing is held, the Director will approve the plan based on the information in the plan and information presented at the hearing.

GIVEN under the Seal of New Mexico Conservation Commission at Santa Fe, New Mexico, on
this 23rd day of March, 2001.

STATE OF NEW MEXICO
OIL CONSERVATION DIVISION

SEAL

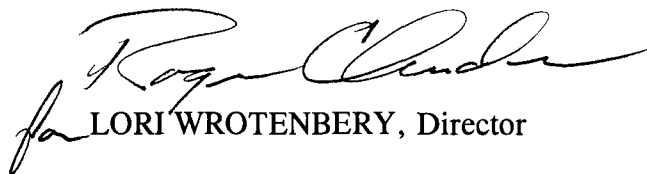
for LORI WROTENBERY, Director

NOTICE OF PUBLICATION

STATE OF NEW MEXICO ENERGY, MINERALS AND NATURAL RESOURCES DEPARTMENT OIL CONSERVATION DIVISION

Notice is hereby given that pursuant to the New Mexico Water Quality Control Commission Regulations, the following discharge plan application has been submitted to the Director of the Oil Conservation Division, 1220 South Saint Francis Drive, Santa Fe, New Mexico 87505, Telephone (505) 476-3440:

(GW-334) - Williams Field Service, Mark J. Barets, Senior Environmental Specialist, 188 CR 4900, Bloomfield, New Mexico 87413, has submitted a discharge plan application for their Kutz Pump Station located in the SW/4 NW/4, Section 13, Township 28 North, Range 11 West, NMPM, San Juan County, New Mexico. All effluents generated on site are collected in containment vessels prior to transport to an OCD approved off-site disposal facility. Groundwater most likely to be affected by an accidental discharge is at a depth ranging from 420 to 450 feet with a total dissolved solids concentrations ranging from 200 to 1000 mg/l. The discharge plan addresses how spill, leaks, and other accidental discharges to the surface will be managed.

(GW-335) - Williams Field Service, Mark J. Barets, Senior Environmental Specialist, 188 CR 4900, Bloomfield, New Mexico 87413, has submitted a discharge plan renewal application for their Huerfano Pump Station located in the NW/4 SW/4, Section 21, Township 26 North, Range 10 West, NMPM, San Juan County, New Mexico. All effluents generated on site are collected in containment vessels prior to transport to an OCD approved off-site disposal facility. Groundwater most likely to be affected by an accidental discharge is at a depth ranging from 500 to 1000 feet with a total dissolved solids concentrations ranging from 500 to 3000 mg/l. The discharge plan addresses how spill, leaks, and other accidental discharges to the surface will be managed.

Any interested person may obtain further information from the Oil Conservation Division and may submit written comments to the Director of the Oil Conservation Division at the address given above. The discharge plan application may be viewed at the above address between 8:00 a.m. and 4:00 p.m., Monday thru Friday. Prior to ruling on any proposed discharge plan or its modification, the Director of the Oil Conservation Division shall allow at least thirty (30) days after the date of publication of this notice during which comments may be submitted to him and public hearing may be requested by any interested person. Request for public hearing shall set forth the reasons why a hearing shall be held.

A hearing will be held if the director determines that there is significant public interest.

If no hearing is held, the Director will approve or disapprove the plan based on the information available. If a public hearing is held, the Director will approve the plan based on the information in the plan and information presented at the hearing.

GIVEN under the Seal of New Mexico Conservation Commission at Santa Fe, New Mexico, on
this 23rd day of March, 2001.

STATE OF NEW MEXICO
OIL CONSERVATION DIVISION

SEAL

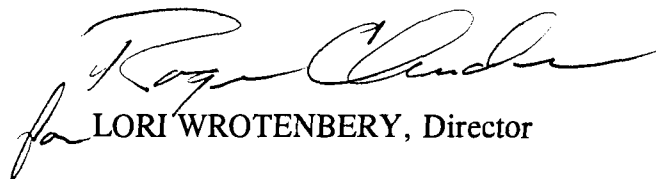
for LORI WROTENBERY, Director

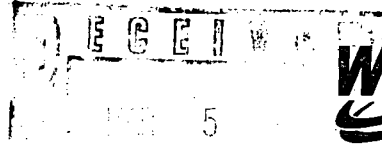

Environmental Affairs
188 CR 4900
Bloomfield, NM 87413
505/634-4956
505/632-4781 Fax

February 27, 2001

Mr. Jack Ford
New Mexico Oil Conservation Division
2040 South Pacheco
Santa Fe NM 87505

Re: Filing Fee for WFS Pump Stations

Dear Mr. Ford:

Enclosed please find check number 1000246268 for \$600.00 to cover the filling fee for the following Williams Field Services (WFS) Compressor Stations:

- Duran Pump Station
- Estancia Pump Station
- Lybrook Pump Station
- Edgewood Pump Station
- White Lakes Pump Station
- ~~Kutz~~ Pump Station

*1 UST
electric pumps + ~~no~~ storage
need DP?*

Williams Field Services apologizes for the inconvenience of not sending the entire amount the first time. If you have any questions or require additional information, please contact me at 505/634/4956.

Thank you,

Clara M Garcia
Environmental Compliance



Environmental Affairs
188 CR 4900
Bloomfield, NM 87413
505/634-4956
505/632-4781 Fax

February 16, 2001

Mr. Jack Ford
New Mexico Oil Conservation Division
2040 South Pacheco
Santa Fe NM 87505

Re: Discharge Plan Application and Filing Fee for WFS Pump Stations

Dear Mr. Ford:

Enclosed please find copies of Discharge Plan application and check number 1000235782 for \$500.00 to cover the filling fee for the following Williams Field Services (WFS) Compressor Stations:

- San Ysidro Pump Station
- Caprock Pump Station
- Huefano Pump Station
- Mesa Pump Station
- San Luis Pump Station
- Duran Pump Station
- Estancia Pump Station
- Lybrook Pump Station
- Edgewood Pump Station
- White Lakes Pump Station
- Kutz Pump Station

Williams Field Services appreciates your assistance in handling this application. If you have any questions or require additional information, please contact me at 505/634/4956.

Thank you,

Clara M Garcia
Environmental Compliance

Xc: Denny Foust, Aztec, OCD Dist III
Chris Williams, Hobbs, OCD Dist I
Tim Gum, Artesia, OCD Dist II

District I
1625 N. French Dr., Hobbs, NM 88240
District II
811 South First, Artesia, NM 88210
District III
1000 Rio Brazos Road, Aztec, NM 87410
District IV
2040 South Pacheco, Santa Fe, NM 87505

State of New Mexico
Energy Minerals and Natural Resources

Oil Conservation Division
2040 South Pacheco
Santa Fe, NM 87505

Revised March 17, 1999

Submit Original
Plus 1 Copy
to Santa Fe
1 Copy to Appropriate
District Office

**DISCHARGE PLAN APPLICATION FOR SERVICE COMPANIES,
GAS PLANTS, REFINERIES, COMPRESSOR, AND CRUDE OIL PUMP STATIONS**

(Refer to the OCD Guidelines for assistance in completing the application)

☐ New ☒ Renewal ☐ Modification

Gas-334

1. Type: Crude Pump Station (Kutz Station)
2. Operator: Williams Field Services Company
Address: 188 CR 4900, Bloomfield, NM 87413
Contact Person: Mark J. Bareta Phone: (505) 632-4634
3. Location: SW /4 NW /4 Section 13 Township 28 N Range 11W
Submit large scale topographic map showing exact location.
4. Attach the name, telephone number and address of the landowner of the facility site.
5. Attach the description of the facility with a diagram indicating location of fences, pits, dikes and tanks on the facility.
6. Attach a description of all materials stored or used at the facility.
7. Attach a description of present sources of effluent and waste solids. Average quality and daily volume of waste water must be included.
8. Attach a description of current liquid and solid waste collection/treatment/disposal procedures.
9. Attach a description of proposed modifications to existing collection/treatment/disposal systems.
10. Attach a routine inspection and maintenance plan to ensure permit compliance.
11. Attach a contingency plan for reporting and clean-up of spills or releases.
12. Attach geological/hydrological information for the facility. Depth to and quality of ground water must be included.
13. Attach a facility closure plan, and other information as is necessary to demonstrate compliance with any other OCD rules, regulations and/or orders.
14. CERTIFICATION

I hereby certify that the information submitted with this application is true and correct to the best of my knowledge and belief.

Name: Mark J. Bareta

Title: Senior Environmental Specialist

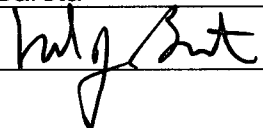
Signature: 

Date: 2/15/2001

DISCHARGE PLAN

**WILLIAMS ENERGY SERVICES
NATURAL GAS LIQUIDS PIPELINE SYSTEM
KUTZ PUMP STATION**

Williams Energy Services

February 2001

Table of Contents

I.	Type of Operation -----	1
II.	Legally Responsible Party-----	1
III.	Location of Facility-----	1
IV.	Landowner -----	1
V.	Facility Description-----	1
VI.	Source, Quantity, and Quality of Effluents and Waste Solids-----	1
VII.	Transfer, Storage, and Disposal of Process Fluids, Effluents, and Waste Solids-----	2
VIII.	Storm Water Plan -----	4
IX.	Inspection, Maintenance, and Reporting -----	5
X.	Spill/Leak Prevention and Reporting (Contingency Plans)-----	5
XI.	Site Characteristics -----	5
XII.	Facility Closure Plan -----	6

List of Tables

Table 1 - Source, Quantity, and Quality of Effluent and Waste Solids -----	2
Table 2 - Transfer, Storage, and Disposal of Process Fluids, Effluents, and Waste Solids -----	3

List of Figures - All figures follow Section XI

Figure 1 - Site Vicinity / Topographic Map
Figure 2 - Facility Plot Plan

List of Appendices

Appendix A – WES Spill Control Procedures
Appendix B – NMOCD Notification of Fire, Breaks, Spills, Leaks, and Blowouts

I. TYPE OF OPERATION

The Kutz Pump Station was built in 1972 to inject natural gas liquids from Kutz Plant into the Williams Natural Gas Liquids (NGL) Pipeline (formerly MAPCO).

II. LEGALLY RESPONSIBLE PARTY

Williams Energy Services (formerly MAPCO)
188 CR 4900
Bloomfield, NM 87413
(505) 632-4634

Contact Person:

Mark J. Bareta, Senior Environmental Specialist
Phone and Address, Same as Above

III. LOCATION OF FACILITY

The Kutz Pump Station is located in the SW/4 of NW/4 of Section 13, Township 28 North, Range 11 West, in ~~San Juan County~~ New Mexico, approximately 3.5 miles south of Bloomfield, New Mexico. A site location map is attached (USGS 7.5 Min. Quadrangle: Bloomfield, New Mexico) as Figure 1. The facility layout is illustrated in Figure 2. All figures are attached following Section XI of the text.

IV. LANDOWNER

Williams Energy Services (WES) is leasing the subject property from:

Bureau of Land Management
1235 N. La Plata Highway
Farmington, NM 87401
(505) 599-8900

V. FACILITY DESCRIPTION

This facility is ~~classified as a pipeline injection station~~ and is unmanned. Natural gas liquids are injected into the NGL pipeline by two electric-powered injection pumps. In addition, there are various support structures and ancillary equipment. Records related to facility operations are maintained at central office locations.

VI. SOURCE, QUANTITY, AND QUALITY OF EFFLUENTS AND WASTE SOLIDS

The source, quantity, and quality of effluent and waste solids generated at the compressor station are summarized in Table 1.

TABLE 1
SOURCE, QUANTITY, AND QUALITY OF EFFLUENT AND WASTE SOLIDS
KUTZ PUMP STATION

<u>PROCESS</u> <u>FLUID/WASTE</u>	<u>SOURCE</u>	<u>QUANTITY</u> <u>(Ranges)</u>	<u>QUALITY</u>
--------------------------------------	---------------	------------------------------------	----------------

*Fee schedule based
on Crude pump
Station*

Natural Gas Liquids	Pigging Operations	100-600 gal/year	No additives
---------------------	--------------------	------------------	--------------

VII. TRANSFER, STORAGE, AND DISPOSAL OF PROCESS FLUIDS, EFFLUENTS AND WASTE SOLIDS

~~Waste generated at this facility fall into the non-exempt category.~~ Waste management will be conducted as outlined in Table 2. Non-exempt waste management will be conducted in accordance with NMOCD requirements including the preparation of a Certificate of Waste Status for each non-exempt waste stream.

Non-exempt waste will be analyzed at a minimum for BTEX, TPH, RCRA D-List metals, ignitability, corrosivity, and reactivity to initially determine if such waste are hazardous as defined in 40 CFR Part 261. All wastes at the facility will be periodically surveyed for naturally occurring radioactive material (NORM) to determine if the concentrations of radium 226 exceed 30 picocuries per gram or if radiation exposure exceeds 50 microroentgens per hour. If affirmed, such materials will be handled and disposed in accordance with NMOCD NORM Regulations.

Barring facility modification and/or process changes, the classification of non-exempt waste by laboratory analyses will be made once during the approval period of this plan. Subsequent laboratory analyses will be performed at the generator's discretion (minimum of once every five years), or more frequently to comply with waste acceptance procedures of the disposal facility.

TABLE 2
TRANSFER, STORAGE, AND DISPOSAL OF PROCESS FLUIDS, EFFLUENTS, AND WASTE SOLIDS
KUTZ PUMP STATION

PROCESS FLUID/WASTE	STORAGE	CONTAINER CAPACITY (approximate)	CONTAINMENT/ SPILL PREVENTION	RCRA STATUS	DESCRIPTION OF FINAL DISPOSITION
Natural Gas Liquid	<u>Underground Storage Tank</u>	600 gallons	Dual-walled	Non -exempt	Saleable liquids may be sold to refinery or liquid may be disposed at a NMOCD- approved facility.

Table 2 describes the transfer, storage and disposal of process fluids, effluents, and waste solids expected to be generated at the site. The table also includes information regarding the type of container in which the waste stream will be stored, container capacity, and containment/spill prevention provisions.

VIII. STORM WATER PLAN

This storm water section was developed to provide a plan to monitor and mitigate impact to storm water runoff from the facility. It serves to satisfy storm water management concerns of the NMOCD. It is not intended to comply with 40 CFR Part 122, Storm Water Discharges as this facility is excluded in 122.26 (c) (1) (iii).

This section concentrates on the identification of potential pollutants, identification of personnel responsible for implementation, inspection and maintenance of the pollutant controls, and gives a description of structural controls to prevent storm water pollution.

Site Assessment and Facility Controls

An evaluation of the material used and stored on this site that may be exposed to storm water indicates that no materials would routinely be exposed to precipitation. There are no engineered storm water controls or conveyances; all storm water leaves the site by overland flow.

Any leakage or spill from the identified potential pollutant sources, if uncontained by existing berms, curbs, or emergency response actions, could flow overland to open off-site drainage ditches (arroyos) and thus impact storm water. In such an event, containment would occur by blocking the ditch or culvert downstream of the pollutant. Cleanup of the substance and implementation of mitigation measures could be conducted while protecting downstream storm watercourses.

Best Management Practices

Following are Best Management Practices (BMPs) to be implemented to prevent or mitigate pollution to storm water from facility operations:

- All waste materials and debris will be properly disposed of on an on-going basis in appropriate containers and locations for collection and removal from the site.
- Temporary storage of potential pollutant sources will be located in areas with appropriate controls for storm water protection. This would include ensuring all containers are sealed/covered and otherwise protected from contact with precipitation.
- Periodic inspection of channels and culverts shall be performed at least twice annually and after any major precipitation event.
- Sediment deposits and debris will be removed from the channels and culverts as necessary and any erosion damage at the outfall (if any) will be repaired or controlled.
- Conduct inspections of the facility on a regular basis as part of the preventive maintenance site check. Such inspections will include the visual assessment of corroded or damaged drums and tanks, broken or breached containment structures, collapsed or clogged drainages or drain lines.

Implementation of the BMPs will prevent or mitigate impact to storm water runoff from this facility.

IX. INSPECTION, MAINTENANCE AND REPORTING

WES and/or contract personnel will operate and maintain the pumping units at the facility. The facility will be monitored remotely for equipment malfunctions through NGL Pipeline Control and by regular site visits. The facility will be visited several times per week at a minimum, and an operator will be on call 24 hours per day, 7 days per week, 52 weeks per year.

In the event of a release of a reportable quantity, the operator reports the release to NGL Pipeline Control who immediately notifies the WES Environmental Affairs Department. WES Environmental Affairs then reports the release to the appropriate agencies. Records of spills, leaks, or other

pollutant discharges, if any, and inspections and maintenance activities will be maintained by WES for at least one year at area offices.

X. SPILL/LEAK PREVENTION AND REPORTING (CONTINGENCY PLANS)

The underground storage tank is constructed with a means of leak detection. WES corporate policy and procedure for the controlling and reporting of Discharges or Spills of Oil or Hazardous Substances is provided in Appendix A. Significant spills and leaks are reported to the NMOCD pursuant to NMOCD Rule 116 and WQCC 1-203 using the NMOCD form (see Appendix B).

XI. SITE CHARACTERISTICS

The Kutz Pump Station is located approximately 3.5 miles south of Bloomfield, New Mexico. The site elevation is approximately 5,800 feet above mean sea level. The natural ground surface topography slopes downward toward the west. The maximum relief over the site is approximately 15 feet.

Intermittent flow from the site will follow the unnamed drainage towards the west. The unnamed drainage meets the Kutz Wash approximately 1.5 miles west of the site. The Kutz drains approximately 3.5 miles north into the San Juan River. The San Juan River, at approximately 5,360 feet in elevation, is the nearest down-gradient perennial source of surface water to the site.

A review of the available hydrologic data^{1,2,3} for this area revealed that there are no water wells within a ¼ mile radius of the Kutz Compressor Station. The water-bearing unit in the area is the Nacimient Formation. This formation consists of a sequence of interbedded sandstone and mudstone. ~~Ground water depth at the site is estimated to be 420 to 450 feet below the surface. The total dissolved solids concentration of area ground water ranges from 200 to 1000 parts per million.~~

The 100-year 24-hour precipitation event at a regional weather station is 2.8 inches. This small amount of rainfall for the area should pose no flood hazards. Vegetation in the area consists predominantly of sagebrush and native grasses.

Flood Protection: Surface water runoff from the area surrounding the site will be diverted around the facility into the natural drainage path.

References

¹Stone, W.J., Lyford, F.P., Frenzel, P.F., Mizell, N.H., Padgett, E.T., 1983, Hydrology and Water Resources of San Juan Basin, New Mexico Bureau of Mines and Mineral Resources, Hydrologic Report 6.

²Online Climate Information, Western Regional Climate Center, 2000

³Online Well Reports and Downloads, New Mexico Office of the State Engineer, 2000.

XII. FACILITY CLOSURE PLAN

All reasonable and necessary measures will be taken to prevent the exceedence of WCQQ Section 3103 water quality standards should WES choose to permanently close the facility. WES will submit a detailed closure plan to the NMOCD prior to closure.

Generally, closure measures will include removal or closure in place of underground piping and other equipment. All wastes will be removed from the site and properly disposed in accordance with the

rules and regulations in place at the time of closure. When all fluids, contaminants, and equipment have been removed from the site, the site will be graded as close to the original contour as possible.

Should contaminated soil be discovered, any necessary reporting under NMOCD Rule 116 and WQCC Section 1203 will be made and clean-up activities will commence. Post-closure maintenance and monitoring plans would not be necessary unless contamination is encountered.

FIGURE 1

SITE VICINITY / TOPOGRAPHIC MAP

FIGURE 2

SITE PLOT PLAN

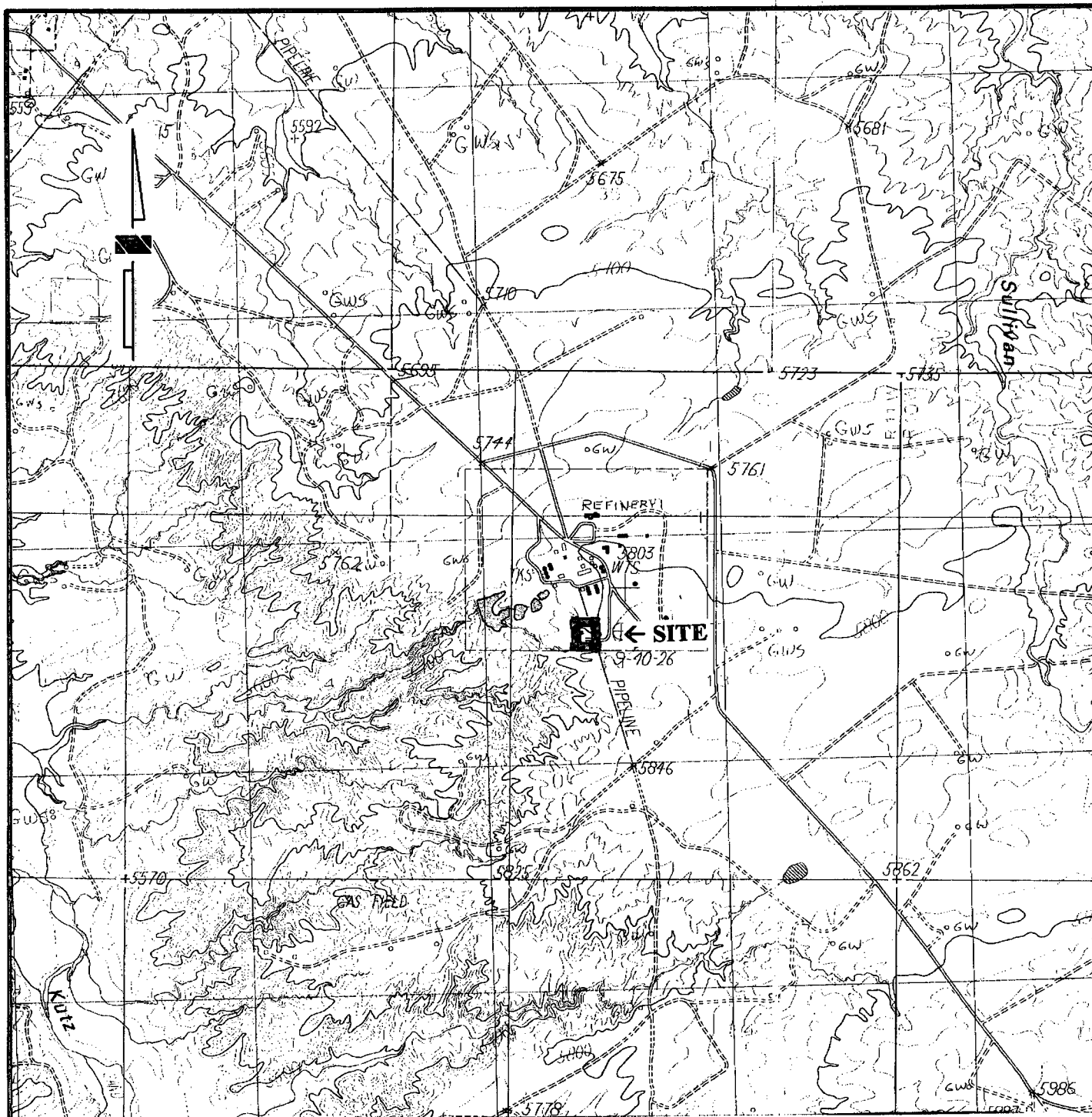

Source: USGS Bloomfield Quadrangle, New Mexico

Scale: 1" = 2,000'

William's

Figure 1 Site Vicinity / Topographic Map

Kutz Pump Station

Section 13, Township 28N Range 11W
San Juan County, New Mexico

KU-101

KUTZ PUMP STATION

PART OF THE NW 1/4 OF SECTION 13, T28N - R11W
SAN JUAN COUNTY, NEW MEXICO

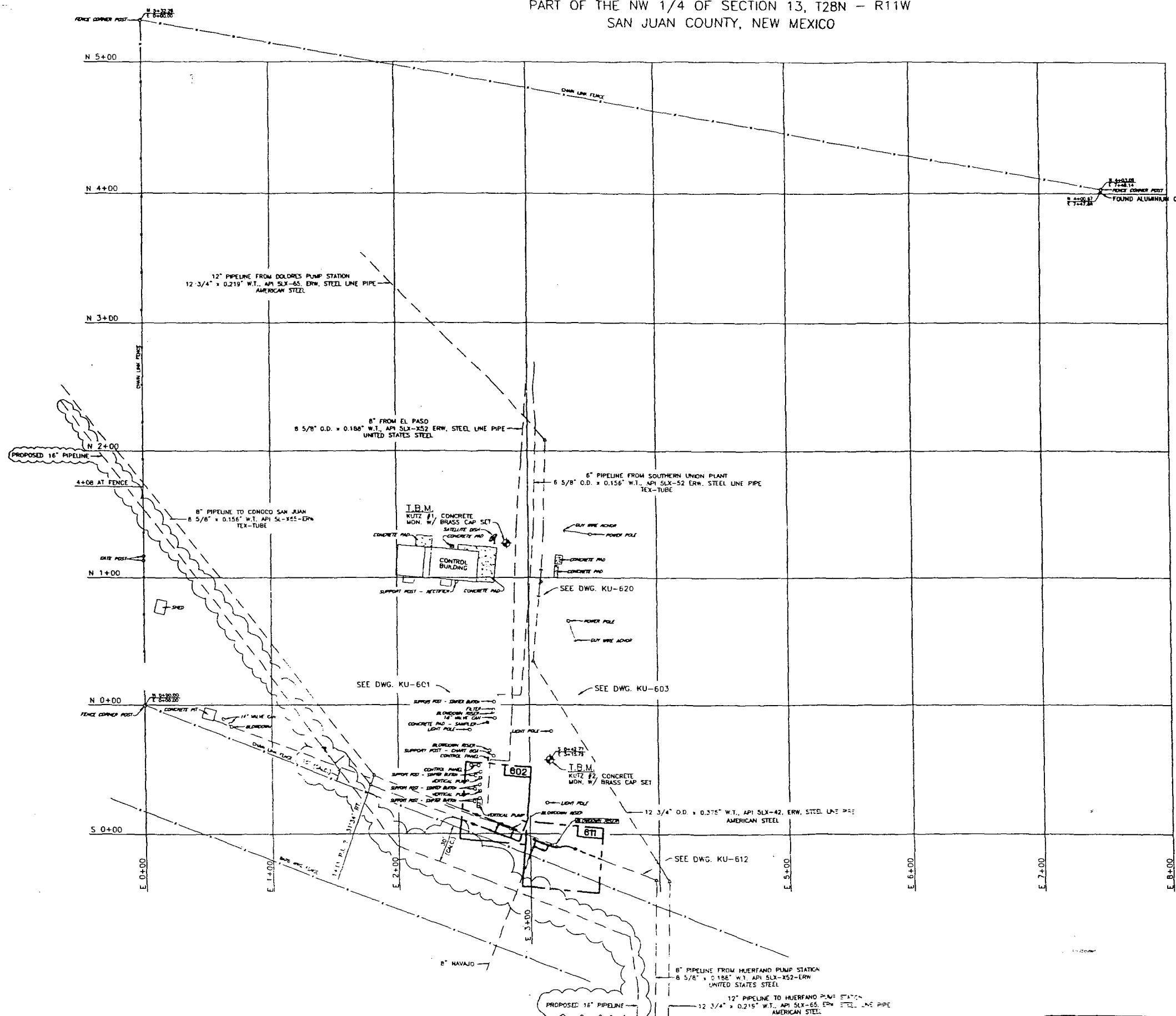

MID-AMERICA PIPELINE COMPANY
TULSA, OKLAHOMA

PIPING PLOT PLAN

KUTZ STATION

SAN JUAN CO. NEW MEXICO

REV. NO.	DATE	REVISIONS	PROJECT ENGINEER	DRAWN BY	CHECKED BY	APPROVED BY	SCALE	DRAWING NO.
1	01/14/93	REDRAWN FROM KU-100 & REVISED PER BLUELINE CONV., AFE:PPL-6000B		MW			1"=40'	KU-101

APPENDIX A

SPILL CONTROL PROCEDURES

	Reference (Book Title) Operations/Maintenance Field Services	Task/Document No. 21.10.020
	Section General/Safety	Regulation No./Reference
	Subject Discharges or Spills of Oil or Hazardous Substances; Preventing, Controlling and Reporting of	Effective Date 12/15/99

Back | Feedback | Index | Search Library

Hit "CTRL-F" to find text on this page.

► Document History (ISO9001)

▼ Document Body

1.0 PURPOSE AND SCOPE

- 1.1 To establish the policy and procedure for preventing, controlling and reporting of discharges or spills of oil or hazardous substances to the environment in accordance with Company practices and federal, state and local requirements, including Title 40 of the Code of Federal Regulations - Part 112 (Oil Pollution Prevention).
- 1.2 This document pertains to Company personnel, Company and non-company facilities. The spill prevention and control requirements in this Policy and Procedure are Federally mandated guidelines for oil pollution prevention. The Company policy is to also apply these standards, where appropriate, to facilities containing hazardous substances. This is a discretionary application of the standards; however, variations from the standards should be approved by the responsible Director.

2.0 CONTENTS

3.0 POLICY

3.1 GENERAL

- 3.1.1 All Company facilities which could discharge or spill, oil or hazardous substances which may affect natural resources or present an imminent and substantial danger to the public health or welfare including, but not limited to, fish, shellfish, wildlife, shorelines and beaches are subject to the provisions of this document.
- 3.1.2 Oil, for purpose of this document, means oil of any kind or in any form, including but not limited to petroleum hydrocarbon, fuel oil, Y grade, natural gas liquids, condensate, mixed products, sludge, oil refuse and oil mixed with wastes other than dredged spoil (earth and rock). LPG (propane, butane, ethane) is not considered to be oil.
- 3.1.3 Hazardous Substance, for purposes of this procedure, is defined as any chemical or

material that has or should have a Material Safety Data Sheet (MSDS); however, hazardous substances are further defined by the following environmental statutes:

- a. Section 101(N) and Section 102 of the Comprehensive Environmental Response, Compensation and Liability Act (CERCLA)
 - b. Section 307(a) and Section 311(b)(2)(A) of the Clean Water Act
 - c. Section 3001 of the Solid Waste Act (excluding items suspended by Congress)
 - d. Section 112 of the Clean Air Act
 - e. Section 7 of the Toxic Substance Control Act
- 3.1.4 The term hazardous substance does not include petroleum hydrocarbon, including crude oil or any fraction thereof and the term does not include natural gas, natural gas liquids (including condensate), liquefied natural gas or synthetic gas usable for fuel (or mixtures of natural gas and such synthetic gas).
- 3.1.5 Facilities which could discharge or spill, oil or hazardous substances into a watercourse must comply with the applicable federal, state or local laws and regulations. A discharge includes but is not limited to any spilling, leaking, pumping, pouring, emitting, emptying or dumping. A watercourse is any perennial or intermittent river, stream, gully, wash, lake or standing body of water capable of collecting or transporting an oil or hazardous substance.
- 3.1.6 Facilities which are subject to the requirements stated in this policy are as follows:
- a. Non-Transportation Related Facilities
 - (1) Storage or drip tanks and other aboveground containers (excluding pressurized or inline process vessels) having a capacity in excess of 660 gallons for each single container or an aggregate capacity of 1,321 gallons or more for multiple containers.
 - (2) Underground storage facilities having a total capacity in excess of 42,000 gallons.
 - b. Transportation Related Facilities
 - (1) All vehicles, pipeline facilities, loading/unloading facilities and other mobile facilities which transport oil or hazardous substances.
- 3.1.7 Each Company location which has facilities subject to paragraph C.1.1 shall have a site specific Spill Prevention Control and Countermeasure Plan (SPCC Plan) which identifies all facilities subject to 40 CFR 112. The plan shall identify all oil and hazardous substance storage vessels (as defined in a.(1) above) at the facility and the spill prevention measures in place to control discharges or spills. This plan shall also identify all regulatory agencies that must be notified in case of a spill.
- 3.1.8 The facility superintendent is responsible for spill prevention. His/her duties include,

but are not limited to, the following:

- a. Instructing personnel in the operation and maintenance of equipment to prevent the discharge of oil.
- b. Conduct annual briefings for operating personnel at intervals frequent enough to assure adequate understanding of the Spill Plan at that facility.
- c. Briefings should highlight and describe known discharges or spills and recently developed precautionary measures.

3.1.9 Each individual facility is checked annually by the superintendent or designee to determine the potential for discharges or spills of oil or hazardous substances in harmful quantities that violate water quality standards or which may cause a film, sheen or discoloration on the surface of water. All facilities which have the potential for discharging or spilling harmful quantities of oil or hazardous substances into a watercourse are required to have the following preventive measures:

- a. Examination of all tanks, valves and fittings, at least annually, to determine any maintenance requirements.
- b. All tank batteries should, as far as practicable, have a secondary means of containment for the entire contents of the largest single tank plus sufficient freeboard in the containment facility to allow for precipitation.
- c. An annual monitoring and inspection program to prevent accidental spills or discharges into watercourses. This includes annual inspection for faulty systems and monitoring line valves and liquid pipelines for leaks or blowouts.

3.1.10 Any field drainage ditches, road ditches, traps, sumps or skimmers should be inspected at regular scheduled intervals for accumulation of oil or other hazardous substances which may have escaped from small leaks. Any such accumulations should be removed.

3.2 BULK STORAGE TANKS

3.2.1 A tank should not be used for storage of oil or hazardous substances unless the material and construction of the tank is compatible with the oil or substance stored and conditions of storage such as pressure and temperature. Buried storage tanks must be protected from corrosion by coatings, cathodic protection or other methods compatible with local soil conditions. Aboveground tanks should be subject to visual inspection for system integrity.

3.2.2 The facility superintendent should evaluate tank level monitoring requirements to prevent tank overflow.

3.2.3 Leaks which result in loss of oil or hazardous substances from tank seams, gaskets, rivets and bolts sufficiently large to cause accumulation of oil or hazardous substances in diked areas should be promptly corrected.

3.2.4 Mobile or portable oil or hazardous substances storage tanks should be positioned or located to prevent the contents from reaching a watercourse. The mobile facilities should be located so their support structure will not be undermined by periodic flooding or washout.

3.3 FACILITY DRAINAGE

- 3.3.1 Make provisions for drainage from diked storage areas where necessary in areas with high precipitation levels. Drainage from diked areas should be restrained by valves or other means to prevent a discharge or spill. Diked areas should be emptied by pumps or ejectors which are manually activated. Valves used for the drainage of diked areas should be of manual, open-and-closed design.
- 3.3.2 Rain water may be drained from diked areas providing drainage water does not contain oil or hazardous substances that may cause a harmful discharge. Drain valves must be closed following drainage of diked areas.
- 3.3.3 When possible, drainage systems from undiked areas should flow into ponds, lagoons or catchment basins designed to retain oil or hazardous substances or return the substances to the facility. Any drainage system which is not designed to allow flow into ponds, lagoons or catchment basins should be equipped with a diversion system that could, in the event of a discharge or spill, contain the oil or hazardous substances on the Site.
- 3.3.4 The principal means of containing discharges or spills is the use of dikes which are constructed wherever regulated quantities of oil or hazardous substances have the potential of reaching a watercourse. The construction of dikes must meet the following requirements:
 - a. Capacity must be at least equivalent to the storage capacity of the largest tank of the battery plus sufficient freeboard to allow for precipitation or displacement by foreign materials.
 - b. Small dikes for temporary containment are constructed at valves where potential leaking of oil or hazardous substances may occur.
 - c. Any dike three feet or higher should have a minimum cross section of two feet at the top.Other means of containment or spill control include, but are not limited to:
- 3.3.5
 - a. Berms or retaining walls
 - b. Curbing
 - c. Culverting, gutters or other drainage systems
 - d. Weirs, booms or other barriers
 - e. Spill diversion ponds or retention ponds
 - f. Sorbent materials

3.4 TRANSFER OPERATIONS, PUMPING and IN-PLANT/STATION PROCESS

- 3.4.1 Aboveground valves and pipelines should be examined regularly by operating

personnel to determine whether there are any leaks from flange joints, expansion joints, valve glands and bodies, catch pans, pipeline supports, valve locks and metal surfaces.

3.5 FACILITY TANK CAR AND TANK TRUCK LOADING/UNLOADING RACK

- 3.5.1 Rack area drainage which does not flow into a catchment basin or treatment facility designed to handle spills should have a quick drainage system for use in tank truck loading and unloading areas. The containment system should have a maximum capacity of any single compartment of a truck loaded or unloaded in the station.
- 3.5.2 Aboveground piping that has potential for damage by vehicles entering the Site should be protected by logically placed warning signs or by concrete-filled pipe barriers.
- 3.5.3 Loading and unloading areas should be provided with an interlocked warning light, grounding shutdown, physical barrier system or warning signs to prevent vehicular departure before complete disconnect of flexible or fixed transfer lines. All drains and outlets of any truck should be closely examined for leakage prior to filling and departure. All drains and outlets that may allow leakage should be tightened, adjusted or replaced to prevent liquid leakage while in transit.

NOTE: LPG loading facilities and remote field loading of condensate are exempt from the C.5 requirements of this document.

4.0 PROCEDURE

4.1 Identifying, Containing and Initial Reporting of a Discharge or Spill of Oil or Hazardous Substance Any Employee

- 4.1.1 Upon noticing a discharge or spill of an oil or hazardous substance in any quantity shall immediately contain the release (if safe to do so) and notify the facility superintendent, dispatcher or other designee. Releases must be reported to gas control in the following three circumstances:

I. The Following Situations Always Require IMMEDIATE Reporting to Gas Control:

- 1. Release reaches or may reach surface water: (pond, lake, wash or ground water)
- 2. Release leaves Williams property
- 3. Release is of questionable nature (i.e., unknown product, unknown hazards)

II. Onsite Releases of Certain Common Industrial Materials Above 10 Gallon Threshold Are Reportable.

Releases that do not migrate off-site or reach surface water may require reporting as well. All releases of 10 gallons or greater of the following materials should be contained and promptly reported to Gas Control:

- Ammonia
- Antifreeze
- Amine

- Chromate Mixtures
- Condensate
- Glycol
- Lube Oil
- Methanol
- Sulfuric Acid
- Sodium Hydroxide
- Natural Gas Liquids
- Other Hydrocarbon Products
- Natural Gas (1 MMSCF)

III. Releases of Certain Other Materials Reportable:

Releases of the following materials above the indicated amount should be reported to gas control:

- PCB's (Concentration > 50 ppm) - any amount
- Mercaptan (Ethyl Mercaptan) - 1 lb.
- Mercury - 1 lb.
- Hydrogen Sulfide - 100 lbs.
- Pesticides - 1 lb.
- Other Material Not Listed - 1 lb.

NOTE 1: A release includes material released (intentionally or unintentionally) to air, water or soil. When notifying Gas Control of a Release, be prepared to provide information on the type of material spilled, amount released, weather conditions, time and date of release, person discovering release and measures taken to control the release.

NOTE 2: Refer to Attachment A for containment procedures.

Facility Superintendent, Controller or Designee

4.1.2 Contacts Gas Control immediately by telephone and provides the following information:

- a. Name of company facility and/or location of facility and nature of discharge or spill
- b. Description and quantity of emission or substance discharged
- c. Description of the circumstances causing the discharge or spill
- d. Name, title and telephone number of person initially reporting the discharge or spill and person reporting to Gas Control
- e. Action taken or being taken to mitigate and correct discharge or spill
- f. Water bodies or streams involved
- g. Time and duration of discharge or spill

h. Outside involvement during discharge or spill (public government agencies, etc. See Emergency Operating Procedure Manuals)

Gas Control Personnel

- 4.1.3 Advises Environmental Affairs departments immediately by telephone concerning the incident including any incidents reported by persons not employed with the Company.

NOTE: If Gas Control is contacted by a person not employed with the Company, the necessary information is obtained as indicated in D.1.2 and the Superintendent and Environmental Affairs are immediately contacted to begin containment and clean-up of the discharge or spill.

- 4.1.4 If Environmental Affairs cannot be contacted, notifies Director over Environmental Affairs.

Facility Superintendent

- 4.1.5 Coordinates containment and clean-up of discharge or spill, keeping the responsible Director Informed.

- 4.1.6 Coordinates containment and clean-up of discharge or spill, keeping the responsible Director Informed. If the discharge or spill is too large for Company personnel to contain, contacts qualified local contractors for assistance. (See Emergency Operating Procedure Manuals tab #11, contractors with available equipment and services).

- 4.1.7 Advises Environmental Affairs by telephone if emergency containment or clean-up assistance from a state agency or a response team from the U.S. Coast Guard is required.

Environmental Affairs

- 4.1.8 Assesses reporting requirements to state and federal agencies (contacts Legal Department and Right-of-Way Department, if appropriate). (See Emergency Operating Procedure Manuals).

- 4.1.9 Makes appropriate contacts with National Response Center and state and local agencies, when necessary.

- 4.1.10 If spill is significant, dispatches Environmental Specialist to scene to oversee cleanup and reporting responsibilities.

4.2 SUBMITTING WRITTEN NOTIFICATION OF A DISCHARGE OR SPILL

Facility Superintendent or Designee

- 4.2.1 Completes a written description of the incident as soon as possible after initial notification is given, which should include the following:

- a. Time and date of discharge or spill
- b. Facility name and location
- c. Type of material spilled
- d. Quantity of material spilled

e. Area affected

f. Cause of spill

g. Special circumstances

h. Corrective measures taken

i. Description of repairs made

j. Preventative measures taken to prevent recurrence.

4.2.2 Forwards the completed written description to Environmental Affairs. Retains a copy for future reference.

NOTE: Environmental Affairs, in coordination with the Legal Department, if necessary, submits written reports to government agencies.

ATTACHMENT A
DISCHARGE OR SPILL CONTAINMENT PROCEDURES AND MATERIALS

TYPE OF FACILITY WHERE THE DISCHARGE OR SPILL OCCURS	CONTAINMENT PROCEDURES	MATERIALS USED FOR CONTAINMENT
A. Oil Pipeline (as defined in C.1.4)	<p>1. Closes appropriate block valves.</p> <p>2. Contains Discharge or spill by: Ditching covering, applying sorbents, constructing an earthen dam or burning.</p> <p>3. If burning is required, obtains approval from the appropriate state air quality control government agencies before burning.</p>	<p>1.Straw</p> <p>2.Loose Earth</p> <p>3.Oil Sorbent 3M Brand</p> <p>4.Plain Wood chips</p> <p>5.Sorb-Oil Chips Banta Co.</p> <p>6.Sorb-Oil Swabs Banta Co.</p> <p>7.Sorb-Oil Mats Banta Co.</p> <p>8.Or Equivalent Materials</p>
B. Vehicle	<p>1. Contains discharge or spill by: ditching, covering surface with dirt, constructing earthen dams, apply sorbents or burning.</p> <p>2. Notifies immediately Environmental Affairs and if there is any imminent danger to local residents; notifies immediately the highway patrol or local police officials.</p>	

	<p>3. If burning is required, obtains approval from the appropriate state air quality control government agencies before burning.</p> <p>Note: Any vehicle carrying any hazardous or toxic substance will carry a shovel or other ditching device to contain a spill. If the vehicle has sufficient room, sorbent materials should also be carried.</p>
C. Bulk Storage Tanks or any other Facilities	<p>1. Contains discharge or spill by: ditching, covering, applying sorbents, constructing an earthen dam or burning.</p> <p>2. If burning is required, obtains approval from the appropriate state air quality control government agencies before burning.</p>

[Back](#) | [Feedback](#) | [Index](#) | [Search Library](#)

If you have questions, suggestions, comments or concerns regarding the SETS Library, please contact [Documentation Services](#).

APPENDIX B

NMOCD NOTIFICATION OF FIRE, BREAKS, SPILLS, LEAKS, AND BLOWOUTS

District I
1625 N. French Dr., Hobbs, NM 88240
District II
811 South First, Artesia, NM 88210
District III
1000 Rio Brazos Road, Aztec, NM 87410
District IV
2040 South Pacheco, Santa Fe, NM 87505

State of New Mexico
Energy Minerals and Natural Resources

Oil Conservation Division
2040 South Pacheco
Santa Fe, NM 87505

Form C-141
Revised March 17, 1999

Submit 2 Copies to appropriate
District Office in accordance
with Rule 116 on back
side of form

Release Notification and Corrective Action

OPERATOR

☐ Initial Report ☐ Final Report

Name of Company	Contact	
Address	Telephone No.	
Facility Name	Facility Type	
Surface Owner	Mineral Owner	Lease No.

LOCATION OF RELEASE

Unit Letter	Section	Township	Range	Feet from the	North/South Line	Feet from the	East/West Line	County
-------------	---------	----------	-------	---------------	------------------	---------------	----------------	--------

NATURE OF RELEASE

Type of Release	Volume of Release	Volume Recovered
Source of Release	Date and Hour of Occurrence	Date and Hour of Discovery
Was Immediate Notice Given? <input type="checkbox"/> Yes <input type="checkbox"/> No <input type="checkbox"/> Not Required	If YES, To Whom?	
By Whom?	Date and Hour	
Was a Watercourse Reached? <input type="checkbox"/> Yes <input type="checkbox"/> No	If YES, Volume Impacting the Watercourse.	
If a Watercourse was Impacted, Describe Fully.*		
Describe Cause of Problem and Remedial Action Taken.*		
Describe Area Affected and Cleanup Action Taken.*		
I hereby certify that the information given above is true and complete to the best of my knowledge and understand that pursuant to NMOCD rules and regulations all operators are required to report and/or file certain release notifications and perform corrective actions for releases which may endanger public health or the environment. The acceptance of a C-141 report by the NMOCD marked as "Final Report" does not relieve the operator of liability should their operations have failed to adequately investigate and remediate contamination that pose a threat to ground water, surface water, human health or the environment. In addition, NMOCD acceptance of a C-141 report does not relieve the operator of responsibility for compliance with any other federal, state, or local laws and/or regulations.		
Signature:	OIL CONSERVATION DIVISION	
Printed Name:	Approved by District Supervisor:	
Title:	Approval Date:	Expiration Date:
Date: Phone:	Conditions of Approval:	Attached <input type="checkbox"/>

* Attach Additional Sheets If Necessary



NEW MEXICO ENERGY, MINERALS
& NATURAL RESOURCES DEPARTMENT

OIL CONSERVATION DIVISION
2040 South Pacheco Street
Santa Fe, New Mexico 87505
(505) 827-7131

February 23, 2000

CERTIFIED MAIL
RETURN RECEIPT NO. Z-142-564-946

Ms. Ingrid Deklau
Williams Field Services, Inc.
P. O. Box 58900
Salt Lake City, Utah 84108

RE: Discharge Plan Requirement
Williams Field Services (formerly MAPCO) Kutz Pump Station
San Juan County, New Mexico

Dear Ms. Deklau:

Under the provisions of the New Mexico Water Quality Control Commission (WQCC) Regulations, Williams Field Services, Inc. is hereby notified that the filing of a discharge plan is required for the Williams Field Services, Inc. (formerly MAPCO) Kutz Pump Station located in Section 13, Township 28 North, Range 11 West, NMPM, San Juan County, New Mexico.

This facility was incorporated with a number of other pump stations under a discharge permit, GW-836, issued by the New Mexico Environment Department (NMED) to Mid-America Pipeline Company (MAPCO). Discharge plan GW-836 expired April 24, 1999. The NMED and the OCD made the determination that the Oil Conservation Division has jurisdiction over the environmental regulation of the MAPCO pipeline system and its ancillary facilities. With the notification by Williams Field Services, Inc. of the acquisition of assets by Williams, Inc. of the MAPCO liquid petroleum pipeline system an inspection of the facilities was performed by the OCD to determine if a single discharge plan would be adequate for this pipeline system and its pump station facilities. Subsequent to an inspection and evaluation of the facility it has been determined that a discharge plan will be required for the above captioned pump station.

This notification of discharge plan requirement is pursuant to Part 3104 and Part 3106 of the WQCC Regulations. The discharge plan, defined in Part 1101.N. of the WQCC Regulations, should cover all discharges of effluent or leachate at the facility or adjacent to the facility site. Included in the application should be plans for controlling spills and accidental discharges at the facility (including detection of leaks in below grade sumps, buried underground process tanks and/or piping), and closure plans for any pits or ponds whose use will be discontinued.

Enclosed is an application form for the above named facility. Two copies of your discharge plan application should be submitted to the OCD Santa Fe Office and one copy to the Aztec District Office for review purposes.

Section 3106 of the regulations requires a submittal of the discharge plan within 120 days of receipt of this notice unless an extension of this time period is sought and approved for good cause. Part 3106 also allows the discharge to continue without an approved discharge plan until 240 days after written notification by the Director of the OCD that a discharge plan is required. An extension of this time period may be sought and approved for good cause.

Pursuant to the New Mexico Water Quality Control Commission (WQCC) Regulation 3114 "every billable facility submitting a discharge plan for approval, modification or renewal shall pay the fees specified in this section to the Water Quality Management Fund". WQCC Rule 3114 became effective as of August 18, 1991, and is found on page 38 of the WQCC Rules and Regulations.

Every billable facility submitting a new discharge plan will be assessed a fee equal to the filing fee plus either a flat fee or discharge fee. The filing fee is fifty (\$50) dollars and shall be submitted with the discharge plan application (nonrefundable). The remainder of the "total fee" for pump stations falls under the "flat fee" category. Please submit all checks to the OCD Santa Fe office and payable to the **NMED-Water Quality Management**.

If there are any questions on this matter, please feel free to contact Mr. W. Jack Ford at (505) 827-7156 as he is assigned responsibility for review of service facility discharge plans.

Sincerely,



Roger C. Anderson
Oil Conservation Division

cc: OCD Aztec District Office

Z 142 564 946 OCD
FORD

US Postal Service
Receipt for Certified Mail
No Insurance Coverage Provided.
Do not use for International Mail (See reverse)

Sent to	F. Deklau
Street & Number	WFS
Post Office, State, & ZIP Code	SLC
Postage	\$
Certified Fee	
Special Delivery Fee	
Restricted Delivery Fee	
Return Receipt Showing to Whom & Date Delivered	
Return Receipt Showing to Whom, Date, & Addressee's Address	
TOTAL Postage & Fees	\$
Postmark or Date	FEB 23 2000 MAPROKETZ

PS Form 3800, April 1995