

1R - 181

# REPORTS

DATE:

9/30/1995

OIL CONSERVATION DIVISION  
RECEIVED

SEP 30 1995 8 52 AM

9-30-95

MOBIL PIPE LINE COMPANY  
P.O. BOX 670  
SEMINOLE TEXAS 79360

State Of New Mexico  
Oil Conservation Division  
310 Old Santa Fe Trail, Room 206  
Santa Fe, New Mexico 87503

SPILLED REPORTED : 3-9-95  
SE4/SEC 26/T17S/R35E  
LEA COUNTY  
MOBIL LEAK #315-95-15

In compliance with State of New Mexico guidelines for remediation of oil spills, the above referenced leak site has been cleaned through In-Situ remediation to TPH levels below the action levels required.

Attached is the test results for the site. The sample is an aggregate test of the site and the analysis was performed by an independent third party, using field test equipment.

A test taken of the buffalo wallow showed no signs of TPH or BTEX.  
The test hole that was drilled to check depth of contaminations was properly filled with cement.  
A copy of test results has been sent to Ronnie Humphrey with Texaco.

Please review the site and notify me at 915-688-1466 if any other action is deemed necessary.

Sincerely,



D.C. Ince  
Construction Tech

**R.E. ENVIRONMENTAL SERVICES INC.**

P.O. BOX 13418 ODESSA TX, 79768-3418 (915) 550-8522

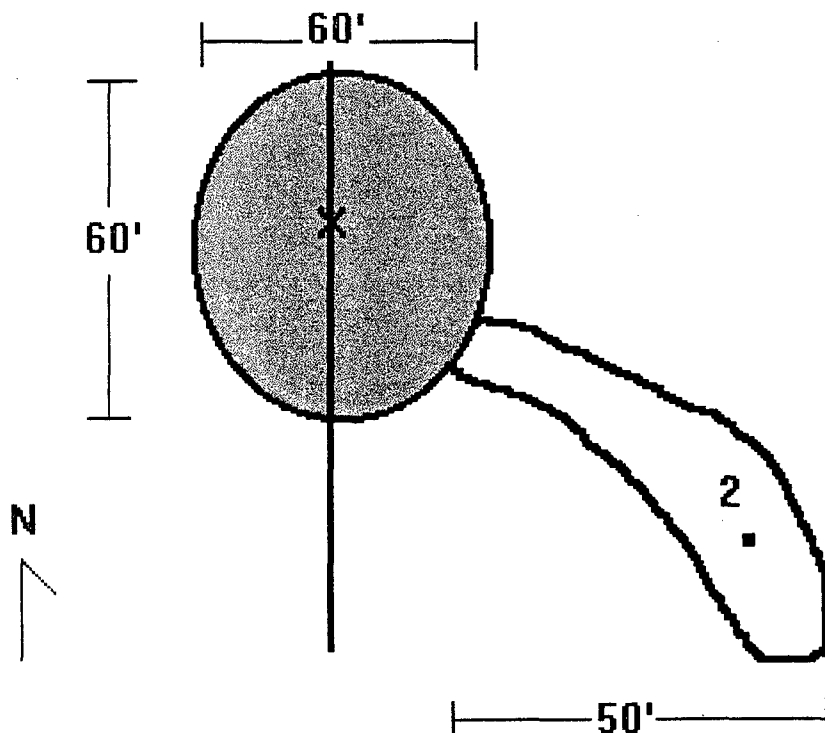

**X-LEAK ORIGIN & TEST POINT**

■ TEST POINT

— MOBIL LINE

***SPILL DESIGNATION #315-95-15***

***STARTING TEST RESULT 88,600ppm***

**TEST POINT**

#1

#1

#1

#1

#2

**RESULTS**

**52,000ppm@11'**

**44,800ppm@16'**

**33,000ppm@28'**

**17,900ppm@33'**

**692ppm@10'**



PHONE (915) 673-7001 \* 2111 BEECHWOOD \* ABILENE, TX 79603

PHONE (505) 393-2326 \* 101 E. MARLAND \* HOBBS, NM 88240

PHONE (505) 326-4669 \* 118 S. COMMERCIAL AVE. \* FARMINGTON, NM 87401

TPH/BTEX ANALYSIS REPORT

Company: RE Environmental Services  
Address: P.O. Box 13418  
City, State: Odessa, TX 79768

Date: 8/28/95  
Lab #: H2155

Project Name: Mobil Pipeline  
Location: Buckeye  
Sampled by: KB  
Analyzed by: MG  
Sample Type: Water

Date: 8/25/95 Time: 11:30  
Date: 8/26/95 Time: various  
Sample Condition: Intact

Units: ppm

\*\*\*\*\*

Samp #	Field Code	TRPHC	BENZENE	TOLUENE	ETHYL BENZENE	TOTAL XYLENES
1	Buckeye	3.05	<0.001	<0.001	<0.001	<0.001

QC Recovery	430	100.7	93.8	109.8	335
QC Spike	440	100	100	100	300
Accuracy	102%	101%	94%	110%	111%
Air Blank	***	<0.001	<0.001	<0.001	<0.001

Methods - GAS CHROMATOGRAPHY; INFRARED SPECTROSCOPY  
- EPA SW-846; 8020, 418.1, 3540, 3510 OR 3550

Manuel Garbalena  
Manuel Garbalena

8-28-95  
Date

**R.E. ENVIRONMENTAL SERVICES INC.**

**P.O. BOX 13418 ODESSA TX, 79768-3418 (915) 550-8522**

---

Mobil Pipe Line  
P.O. Box 670  
Seminole, Tx. 79360

Dear Sirs:

Enclosed is a complete summary for the remediation on Spill Designation #315-95-15. We started with approximately 1700 cubic yards of contaminated soil that was left piled in the spill area. We loaded the soil on dump trucks and spread it over approximately two miles of nearby lease roads. The contaminated soil was then blended with the caliche on the road to lower the TPH level of the contaminated soil. Due to the high level of the contaminated soil and the fact that the contaminated soil had caused the roads to be a little softer Mobil Pipe Line decided to haul in 1500 cubic yards of caliche from a near by pit. This enabled us to achieve a level TPH twice as low as the acceptable state level. We were also able to cap the road and leave the area in much better shape than it was before we came. A plat map is enclosed showing the test results and the location of the tests. Stakes were driven every 1/5 of a mile on the side of the road to mark the location of the test. We appreciate this opportunity to be of service to Mobil Pipe Line and hope we have made all the people who use the road happy due to the fact that the road is much easier to travel down now.

Sincerely,

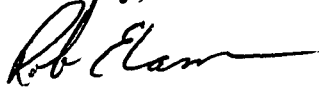

Rob Elam



Robert Eckols

**R.E. ENVIRONMENTAL SERVICES INC.**

P.O. BOX 13418 ODESSA TX, 79768-3418 (915) 550-8522

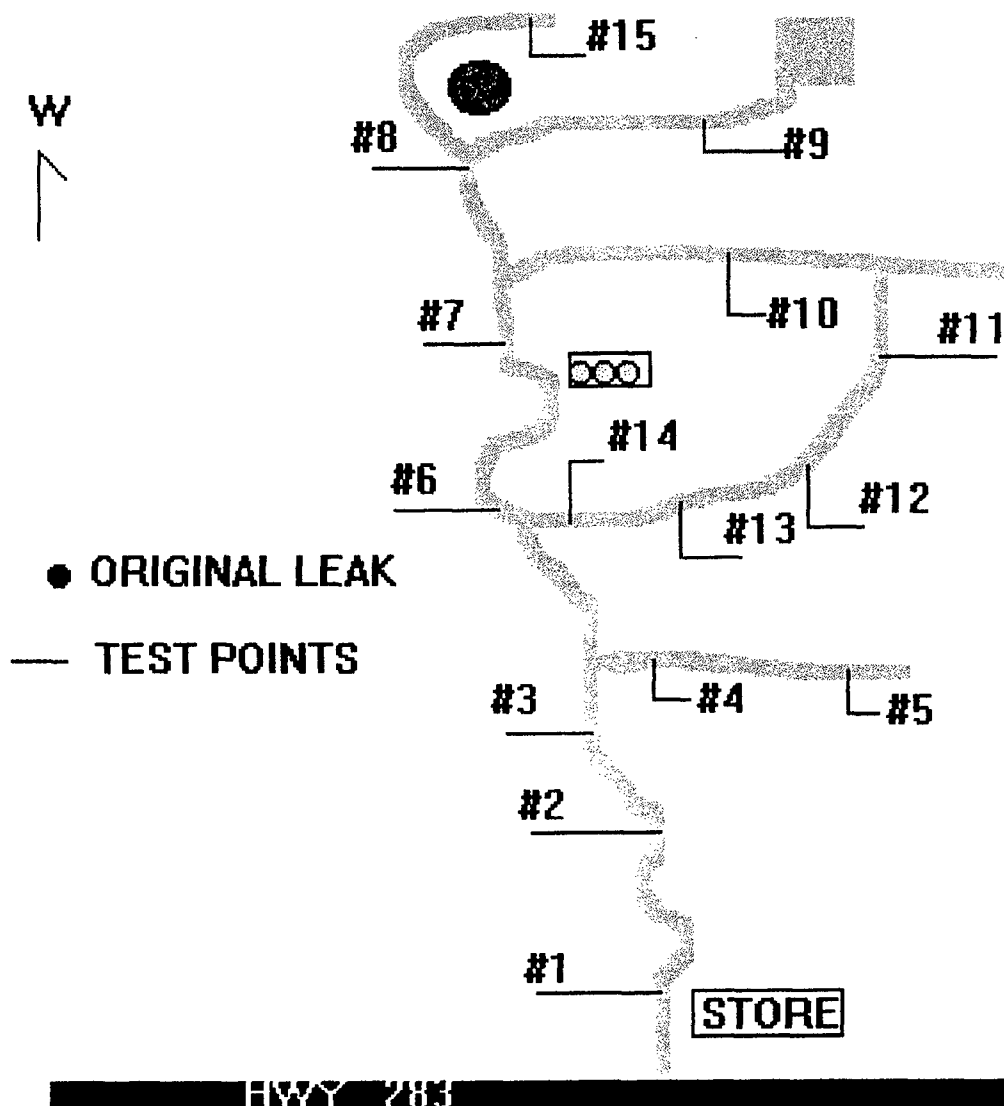

**MOBIL PIPE LINE SPILL DESIGNATION # 315-95-**

**TEST RESULTS**

#1- 27ppm	#8- 3130ppm
#2- 30ppm	#9- 1180ppm
#3- 2820ppm	#10- 2020ppm
#4- 691ppm	#11- 8ppm
#5- 3190ppm	#12- 24ppm
#6- 2950ppm	#13- 459ppm
#7- 2930ppm	#14- 28ppm
#15- 9ppm	

EACH TEST POINT HAS A STAKE MARKING THE LOCATION (1/5 OF MILE BETWEEN EACH TEST)

**NOTIFICATION OF FIRE, BREAKS, SPILLS, LEAKS, AND BLOWOUTS**

NAME OF OPERATOR MOBIL US M & R					ADDRESS BOX 670 SEMINOLE, TEX. 79360			
REPORT OF	FIRE	BREAK	SPILL	LEAK XX	BLOWOUT		OTHER*	
TYPE OF FACILITY	DRLG WELL	PROD WELL	TANK BTTY	PIPE LINE XX	GASO PLNT	OIL RFY	OTHER*	
NAME OF FACILITY VACCUM GATHERING SYSTEM								
LOCATION OF FACILITY (QUARTER/QUARTER SECTION OR FOOTAGE DESCRIPTION)					SEC.	TWP.	RGE.	COUNT
					26	T17S	R34E	LEA
DISTANCE AND DIRECTION FROM NEAREST TOWN OR PROMINENT LANDMARK 1 MILE WEST OF BUCKEYE STORE								
DATE AND HOUR OF OCCURENCE UNKNOWN				DATE AND H 3-9-95 @ 9:00 AM OF DISCOVERY				
WAS IMMEDIATE NOTICE GIVEN?	YES XXXX	NO	NOT RE-QUIRED	IF YES, TO WHOM BONNIE				
BY WHOM D.C.INCE				DATE 3-9-95 AND HOUR 3:45 P. M.				
TYPE OF FLUID LOST CRUDE OIL			QUANTITY OF LOSS	VOLUME RE-		COVERED		
			900			0		
DID ANY FLUIDS REACH A WATERCOURSE?	YES	NO XX	QUANTITY					
IF YES, DESCRIBE FULLY**								
DESCRIBE CAUSE OF PROBLEM AND REMEDIAL ACTION TAKEN**								
EXTERNAL CORROSION LEAK, LINE HAS BEEN REPAIRED , OIL STAINED DIRT HAS BEEN BROUGHT TO THE SURFACE AND P ON PLASTIC FOR TESTING AND REMEDIATION								
DESCRIBE AREA AFFECTED AND CLEANUP ACTION TAKEN**								
DESCRIPTION OF AREA		FARMING	GRAZING		URBAN	OTHER*		
			X					
SURFACE CONDITIONS	SANDY	SANDY LOAM	CLAY	ROCKY	WET	DRY		
				X				
DESCRIBE GENERAL CONDITIONS PREVAILING (TEMPERATURE, PRECIPITATION, ETC.)**								
CLAM , DRY , AND WARM								
I HERBY CERTIFY THAT THE INFORMATION ABOVE IS TRUE AND COMPLETE TO THE BEST OF MY KNOWLEDGE AND BELIEF								
SIGNED D.C. Ince				TITLE CONSTRUCTION TECH.		DATE '3-9-95		

\*SPECIFY

\*\*ATTACH ADDITIONAL SHEETS IF NECESSARY

MOBIL LEAK # 315-95-15

Final  
Revision



# ARDINAL LABORATORIES

PHONE (915) 873-7001 • 2111 BEECHWOOD • ABILENE, TX 79603

PHONE (505) 393-2326 • 101 E. MARLAND • HOBBS, NM 88240

PHONE (505) 326-4669 • 118 S. COMMERCIAL AVE. • FARMINGTON, NM 87401

## BTEX ANALYSIS REPORT

Company: Mobil Pipeline  
Address: PO Box 670  
City, State: Seminole, TX 79360

Date: 5/18/95  
Lab #: H2041

Project Name: not given  
Location: Buckeye, New Mexico  
Sampled by: DI Date: 5/16/95 Time: various  
Analyzed by: HM Date: 5/17/95 Time: 11:40  
Sample Type: soil Sample Condition: intact Units: mg/kg

\*\*\*\*\*

Samp #	Field Code	BENZENE	IGNITABILITY (Degrees F)
1	<del>315-95-15</del>	<del>1.656</del>	>140
2	315-95-15	1.656	>140
3	<del>315-95-15</del>	<del>1.656</del>	>140

QC Recovery	0.960
QC Spike	0.878
Accuracy	109.3%
Air Blank	<0.001

Methods - GAS CHROMATOGRAPHY  
- EPA SW-846; 8020

Hope S. Moreno  
Hope S. Moreno

5-18-95  
Date



DISTRICT I  
P.O. Box 1980, Hobbs, NM 88240

DISTRICT II  
P.O. Drawer DD, Artesia, NM 88210

DISTRICT III  
1000 Rio Brazos Rd., Aztec, NM 87410

OIL CONSERVATION DIVISION  
310 Old Santa Fe Trail, Room 206  
Santa Fe, New Mexico 87501

WELL API NO.

5. Indicate Type of Lease

STATE ☐

6. State Oil & Gas Lease No.

7. Lease Name or Unit Agreement No.

8. Well No.

9. Pool name or Wildcat

SUNDRY NOTICES AND REPORTS ON WELLS  
(DO NOT USE THIS FORM FOR PROPOSALS TO DRILL OR TO DEEPEN OR PLUG BACK TO A  
DIFFERENT RESERVOIR. USE "APPLICATION FOR PERMIT"  
(FORM C-101) FOR SUCH PROPOSALS.)

1. Type of Well:

OIL  
WELL ☐

GAS  
WELL ☐

OTHER 4" Gathering Line

2. Name of Operator

Mobil Pipeline Co.

3. Address of Operator

P.O. BOX 670 Seminole, Texas 79360

4. Well Location

Unit Letter \_\_\_\_\_ : \_\_\_\_\_ Feet From The \_\_\_\_\_ Line and \_\_\_\_\_ Feet From The \_\_\_\_\_

Section 26

Township T17S

Range R34E

NMPM

10. Elevation (Show whether DF, RKB, RT, GR, etc.)

11.

Check Appropriate Box to Indicate Nature of Notice, Report, or Other Data

NOTICE OF INTENTION TO:

SUBSEQUENT REPORT OF:

PERFORM REMEDIAL WORK ☒

PLUG AND ABANDON ☐

REMEDIAL WORK ☐

ALTERING CASING ☐

TEMPORARILY ABANDON ☐

CHANGE PLANS ☐

COMMENCE DRILLING OPNS. ☐

PLUG AND ABANDON ☐

PULL OR ALTER CASING ☐

CASING TEST AND CEMENT JOB ☐

OTHER: ☐

OTHER: ☐

12. Describe Proposed or Completed Operations (Clearly state all pertinent details, and give pertinent dates, including estimated date of starting any proposed work) SEE RULE 1103.

See Attached

I hereby certify that the information above is true and complete to the best of my knowledge and belief.

SIGNATURE: D.C. Ince

TITLE Construction tech DATE 6-1

TYPE OR PRINT NAME D.C. Ince

TELEPHONE NO. 915-758-2

(This space for State Use)

ORIGINAL SIGNED BY JERRY SEXTON  
DISTRICT I SUPERVISOR

JUN 16

APPROVED BY \_\_\_\_\_ TITLE \_\_\_\_\_ DATE \_\_\_\_\_

CONDITIONS OF APPROVAL, IF ANY:

**PLAN OF INTENT OF REMEDIATION  
MOBIL USM&R**

**MOBIL PIPELINE LEAK NUMBER 315-95-15, DATED 3-9-95, IN VACUUM  
GATHERING SYSTEM, BUCKEYE NEW MEXICO.  
SOUTHEAST QUARTER/SEC. 26/T17/R35E OF LEA COUNTY.**

**REMEDIATION WORK PERFORMED:** The contaminated soil has been removed to a depth of 30 feet and placed on plastic. A composite sample of the contaminated soil has been tested for benzene and ignitability. A copy of the result is attached, the result being within acceptable limits.

The large hole has been backfilled with fresh dirt, for safety, with the approval from New Mexico Oil Commission.

**PLAN OF CONTINUED REMEDIATION :** We plan to drill a test hole to determine maximum depth of contamination. Documentation will be made of location and concentration of all non removed contamination. A perforated pipe with a vent on top will be installed in the test hole to continually vent sub contamination.

All remaining contaminated soil will then be blended to meet the .5% New Mexico guidelines and spread on adjacent roads. The land owner, which is the State of New Mexico Land Commission, agreed to this procedure.

**TESTING :** All testing will be done by independent contractor.

**WORK PERFORMED:** All work and testing will be done by Mid Tex Construction Company, out of Odessa, Texas, 915-381-2710

Once started, remediation will be taken to closure within two weeks.

The sub vent will be monitored and closed when appropriate.

Sincerely,



David C. Ince  
Construction Tech.

STATE OF NEW MEXICO  
NMOCD District I

INTER-OFFICE MEMO

To file: Mobil Pipe Line Co.

P.O. Box 670  
SEMINOLE TX 79360

Date: August 24, 1995  
Time: 9:00 am

Telephone call: \_\_\_\_\_ Meeting: \_\_\_\_\_ Other: X On Site

Person called or attending:

David Ince - Mobil Pipeline  
Rob Elam-Contractor  
Wayne Price-NMOCD  
Buddy Hill-NMOCD  
Harrison Drilling Co.

REFERENCE: Mobil Pipeline Co. Leak  
1 mile due west of Buckeye NM store.  
sec 26-Ts17s-R34e MPL 4" crude line  
crosses over the top of GPM's 12"  
A8 line.

Subject: Soil Boring to determine vertical extent of  
contamination.

Comments:

Started drilling soil boring using hollow stem auger, hit hard caliche rock, determined that hole was at south edge of where leak occurred. Moved rig over and drilled thru backfill to 40 feet. Took soil sample with split spoon, dry light brown fine sand with traces of caliche. Ran field tests for TPH = 10 ppm, BTEX PID = 50 ppm. Drilled down to 45 feet and sampled, same matrix as found at 40', ran field test for TPH = 8 ppm, BTEX = 38 ppm. (see sketch attached for location of bore hole.

Called Bill Olson NMOCD Santa Fe, discussed eliminating installing the proposed vapor recovery well and closing hole. Hole is to be filled from bottom to top with Type I-II cement with 3-5 % bentonite.

Discussed issue of road spreading, Texaco had made complaint to NMOCD Jerry Sexton District supervisor, Buddy Hill NMOCD field inspector relayed message to Mobil's David Ince and Wayne Price.

David Ince to discuss road spreading issue with NM State Land Office and Texaco.

Mobil will make sure any soil placed on roads will be remediated per NMOCD guidelines levels and all plastic and large rocks will be removed, roads to be watered, blade and contoured for drainage. Also Mobil will make sure they have permission of area operators. If necessary Mobil is willing to remove soil from roads. Mobil is to call NMOCD for permission if they move any soil off lease roads and when they add water.

Mobil to submit final report to Bill Olson and copies to the NMOCD Hobbs office on all activities of this project. Mobil's report will contain the following information at a minimum.

1. A map showing where the soil was placed and sufficient analytical results to verify the soil is below NMOCD guideline limits.
2. The results of the soil boring and closure report per Mobil's "Plan of Intent of Remediation" work plan submitted on June 12, 1995.
3. Mobil to sample water in buffalo wallow for TPH and BTEX using EPA methods.

2:45 pm Meeting with Jerry Sexton NMOCD Supervisor.

Mobil should not put any more soil on Texaco's roads and if the material placed on the lease roads causes problems during rains etc, then Mobil will be asked to correct.

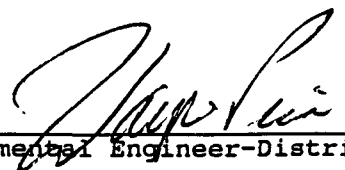
Wayne Price   
NMOCD Environmental Engineer-District I

8/25/95

CC: Jerry Sexton-District I Supervisor  
Gary Wink-NMOCD Field Rep. II  
Bill Olson-NMOCD Santa Fe  
David Ince-Mobil Pipe Line Co.  
Eric Nelson-NM State Land Office(Hobbs)

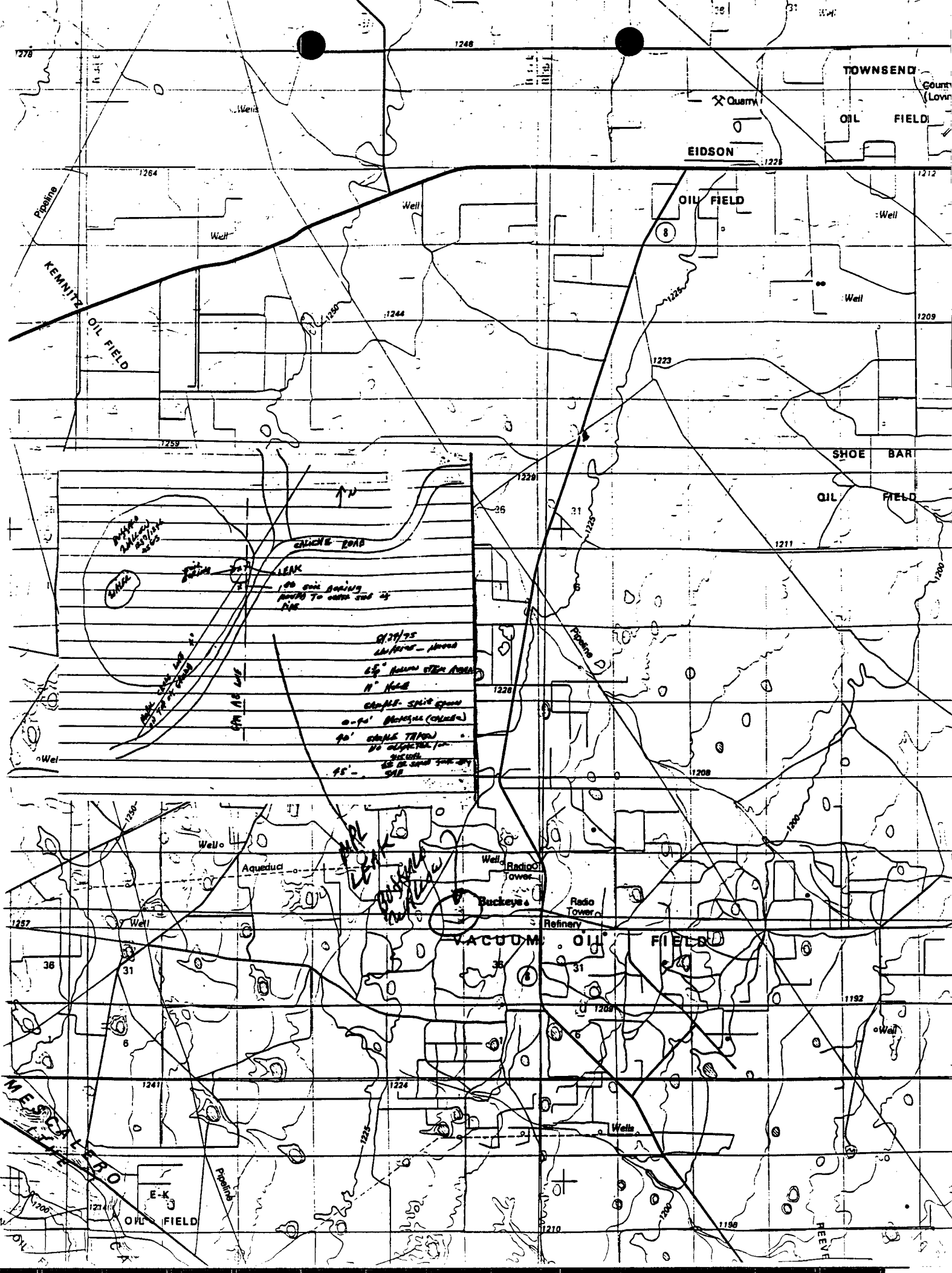

1248

TOWNSEND

County Lovin

OIL FIELD

EIDSON

OIL FIELD

SHOE BAR

OIL FIELD

VACUUM OIL FIELD

MESQUITE BO

OIL FIELD

REEVE

WELL 31  
100' sand graining  
100' To center and 1/2  
DNE  
CHUCK ROAD  
LEAK  
PIPELINE  
AQUEDUC  
BUCKEYE  
REFINERY  
MESQUITE BO  
OIL FIELD  
TOWNSEND  
EIDSON  
SHOE BAR  
VACUUM OIL FIELD  
REEVE

1278  
1264  
1259  
1244  
1223  
1221  
1220  
1212  
1209  
1228  
1226  
1225  
1224  
1223  
1222  
1221  
1220  
1219  
1218  
1217  
1216  
1215  
1214  
1213  
1212  
1211  
1210  
1209  
1208  
1207  
1206  
1205  
1204  
1203  
1202  
1201  
1200  
1199  
1198  
1197  
1196  
1195  
1194  
1193  
1192  
1191  
1190  
1189  
1188  
1187  
1186  
1185  
1184  
1183  
1182  
1181  
1180  
1179  
1178  
1177  
1176  
1175  
1174  
1173  
1172  
1171  
1170  
1169  
1168  
1167  
1166  
1165  
1164  
1163  
1162  
1161  
1160  
1159  
1158  
1157  
1156  
1155  
1154  
1153  
1152  
1151  
1150  
1149  
1148  
1147  
1146  
1145  
1144  
1143  
1142  
1141  
1140  
1139  
1138  
1137  
1136  
1135  
1134  
1133  
1132  
1131  
1130  
1129  
1128  
1127  
1126  
1125  
1124  
1123  
1122  
1121  
1120  
1119  
1118  
1117  
1116  
1115  
1114  
1113  
1112  
1111  
1110  
1109  
1108  
1107  
1106  
1105  
1104  
1103  
1102  
1101  
1100  
1099  
1098  
1097  
1096  
1095  
1094  
1093  
1092  
1091  
1090  
1089  
1088  
1087  
1086  
1085  
1084  
1083  
1082  
1081  
1080  
1079  
1078  
1077  
1076  
1075  
1074  
1073  
1072  
1071  
1070  
1069  
1068  
1067  
1066  
1065  
1064  
1063  
1062  
1061  
1060  
1059  
1058  
1057  
1056  
1055  
1054  
1053  
1052  
1051  
1050  
1049  
1048  
1047  
1046  
1045  
1044  
1043  
1042  
1041  
1040  
1039  
1038  
1037  
1036  
1035  
1034  
1033  
1032  
1031  
1030  
1029  
1028  
1027  
1026  
1025  
1024  
1023  
1022  
1021  
1020  
1019  
1018  
1017  
1016  
1015  
1014  
1013  
1012  
1011  
1010  
1009  
1008  
1007  
1006  
1005  
1004  
1003  
1002  
1001  
1000  
999  
998  
997  
996  
995  
994  
993  
992  
991  
990  
989  
988  
987  
986  
985  
984  
983  
982  
981  
980  
979  
978  
977  
976  
975  
974  
973  
972  
971  
970  
969  
968  
967  
966  
965  
964  
963  
962  
961  
960  
959  
958  
957  
956  
955  
954  
953  
952  
951  
950  
949  
948  
947  
946  
945  
944  
943  
942  
941  
940  
939  
938  
937  
936  
935  
934  
933  
932  
931  
930  
929  
928  
927  
926  
925  
924  
923  
922  
921  
920  
919  
918  
917  
916  
915  
914  
913  
912  
911  
910  
909  
908  
907  
906  
905  
904  
903  
902  
901  
900  
899  
898  
897  
896  
895  
894  
893  
892  
891  
890  
889  
888  
887  
886  
885  
884  
883  
882  
881  
880  
879  
878  
877  
876  
875  
874  
873  
872  
871  
870  
869  
868  
867  
866  
865  
864  
863  
862  
861  
860  
859  
858  
857  
856  
855  
854  
853  
852  
851  
850  
849  
848  
847  
846  
845  
844  
843  
842  
841  
840  
839  
838  
837  
836  
835  
834  
833  
832  
831  
830  
829  
828  
827  
826  
825  
824  
823  
822  
821  
820  
819  
818  
817  
816  
815  
814  
813  
812  
811  
810  
809  
808  
807  
806  
805  
804  
803  
802  
801  
800  
799  
798  
797  
796  
795  
794  
793  
792  
791  
790  
789  
788  
787  
786  
785  
784  
783  
782  
781  
780  
779  
778  
777  
776  
775  
774  
773  
772  
771  
770  
769  
768  
767  
766  
765  
764  
763  
762  
761  
760  
759  
758  
757  
756  
755  
754  
753  
752  
751  
750  
749  
748  
747  
746  
745  
744  
743  
742  
741  
740  
739  
738  
737  
736  
735  
734  
733  
732  
731  
730  
729  
728  
727  
726  
725  
724  
723  
722  
721  
720  
719  
718  
717  
716  
715  
714  
713  
712  
711  
710  
709  
708  
707  
706  
705  
704  
703  
702  
701  
700  
699  
698  
697  
696  
695  
694  
693  
692  
691  
690  
689  
688  
687  
686  
685  
684  
683  
682  
681  
680  
679  
678  
677  
676  
675  
674  
673  
672  
671  
670  
669  
668  
667  
666  
665  
664  
663  
662  
661  
660  
659  
658  
657  
656  
655  
654  
653  
652  
651  
650  
649  
648  
647  
646  
645  
644  
643  
642  
641  
640  
639  
638  
637  
636  
635  
634  
633  
632  
631  
630  
629  
628  
627  
626  
625  
624  
623  
622  
621  
620  
619  
618  
617  
616  
615  
614  
613  
612  
611  
610  
609  
608  
607  
606  
605  
604  
603  
602  
601  
600  
599  
598  
597  
596  
595  
594  
593  
592  
591  
590  
589  
588  
587  
586  
585  
584  
583  
582  
581  
580  
579  
578  
577  
576  
575  
574  
573  
572  
571  
570  
569  
568  
567  
566  
565  
564  
563  
562  
561  
560  
559  
558  
557  
556  
555  
554  
553  
552  
551  
550  
549  
548  
547  
546  
545  
544  
543  
542  
541  
540  
539  
538  
537  
536  
535  
534  
533  
532  
531  
530  
529  
528  
527  
526  
525  
524  
523  
522  
521  
520  
519  
518  
517  
516  
515  
514  
513  
512  
511  
510  
509  
508  
507  
506  
505  
504  
503  
502  
501  
500  
499  
498  
497  
496  
495  
494  
493  
492  
491  
490  
489  
488  
487  
486  
485  
484  
483  
482  
481  
480  
479  
478  
477  
476  
475  
474  
473  
472  
471  
470  
469  
468  
467  
466  
465  
464  
463  
462  
461  
460  
459  
458  
457  
456  
455  
454  
453  
452  
451  
450  
449  
448  
447  
446  
445  
444  
443  
442  
441  
440  
439  
438  
437  
436  
435  
434  
433  
432  
431  
430  
429  
428  
427  
426  
425  
424  
423  
422  
421  
420  
419  
418  
417  
416  
415  
414  
413  
412  
411  
410  
409  
408  
407  
406  
405  
404  
403  
402  
401  
400  
399  
398  
397  
396  
395  
394  
393  
392  
391  
390  
389  
388  
387  
386  
385  
384  
383  
382  
381  
380  
379  
378  
377  
376  
375  
374  
373  
372  
371  
370  
369  
368  
367  
366  
365  
364  
363  
362  
361  
360  
359  
358  
357  
356  
355  
354  
353  
352  
351  
350  
349  
348  
347  
346  
345  
344  
343  
342  
341  
340  
339  
338  
337  
336  
335  
334  
333  
332  
331  
330  
329  
328  
327  
326  
325  
324  
323  
322  
321  
320  
319  
318  
317  
316  
315  
314  
313  
312  
311  
310  
309  
308  
307  
306  
305  
304  
303  
302  
301  
300  
299  
298  
297  
296  
295  
294  
293  
292  
291  
290  
289  
288  
287  
286  
285  
284  
283  
282  
281  
280  
279  
278  
277  
276  
275  
274  
273  
272  
271  
270  
269  
268  
267  
266  
265  
264  
263  
262  
261  
260  
259  
258  
257  
256  
255  
254  
253  
252  
251  
250  
249  
248  
247  
246  
245  
244  
243  
242  
241  
240  
239  
238  
237  
236  
235  
234  
233  
232  
231  
230  
229  
228  
227  
226  
225  
224  
223  
222  
221  
220  
219  
218  
217  
216  
215  
214  
213  
212  
211  
210  
209  
208  
207  
206  
205  
204  
203  
202  
201  
200  
199  
198  
197  
196  
195  
194  
193  
192  
191  
190  
189  
188  
187  
186  
185  
184  
183  
182  
181  
180  
179  
178  
177  
176  
175  
174  
173  
172  
171  
170  
169  
168  
167  
166  
165  
164  
163  
162  
161  
160  
159  
158  
157  
156  
155  
154  
153  
152  
151  
150  
149  
148  
147  
146  
145  
144  
143  
142  
141  
140  
139  
138  
137  
136  
135  
134  
133  
132  
131  
130  
129  
128  
127  
126  
125  
124  
123  
122  
121  
120  
119  
118  
117  
116  
115  
114  
113  
112  
111  
110  
109  
108  
107  
106  
105  
104  
103  
102  
101  
100  
99  
98  
97  
96  
95  
94  
93  
92  
91  
90  
89  
88  
87  
86  
85  
84  
83  
82  
81  
80  
79  
78  
77  
76  
75  
74  
73  
72  
71  
70  
69  
68  
67  
66  
65  
64  
63  
62  
61  
60  
59  
58  
57  
56  
55  
54  
53  
52  
51  
50  
49  
48  
47  
46  
45  
44  
43  
42  
41  
40  
39  
38  
37  
36  
35  
34  
33  
32  
31  
30  
29  
28  
27  
26  
25  
24  
23  
22  
21  
20  
19  
18  
17  
16  
15  
14  
13  
12  
11  
10  
9  
8  
7  
6  
5  
4  
3  
2  
1  
0