

1R - 316

GENERAL CORRESPONDENCE

YEAR(S):

2002-



ALLSTATE ENVIRONMENTAL SERVICES, LLC



P.O BOX 11322
MIDLAND, TEXAS 79702
OFFICE: (915) 682-3547
FAX: (915) 682-4182

August 28, 2002

Mr. Wayne Price
New Mexico OCD
1220 S. Saint Francis Drive
Santa Fe, New Mexico 87505

SUBJECT: Saga Petroleum Todd Pit site – Near Milnesand, N. M.

Dear Mr. Price:

Included in this mailing is a panoramic photo of the site previously occupied by the "Todd Pit". This photo simply confirms that all debris has been hauled from the site and that it is in "pristine" condition.

For your information, work to clean up and restore the land occupied by the Saga U.D. Sawyer SWD pit, 5-1/2 miles east of Crossroads, is scheduled to begin Tuesday, September 3, 2002.

I can be contacted at 915-682-3547 (office), 915-528-5716 (cell) or by email at allstateenv@aol.com if you should have any questions regarding these two sites.

Sincerely,

C. H. Kerby

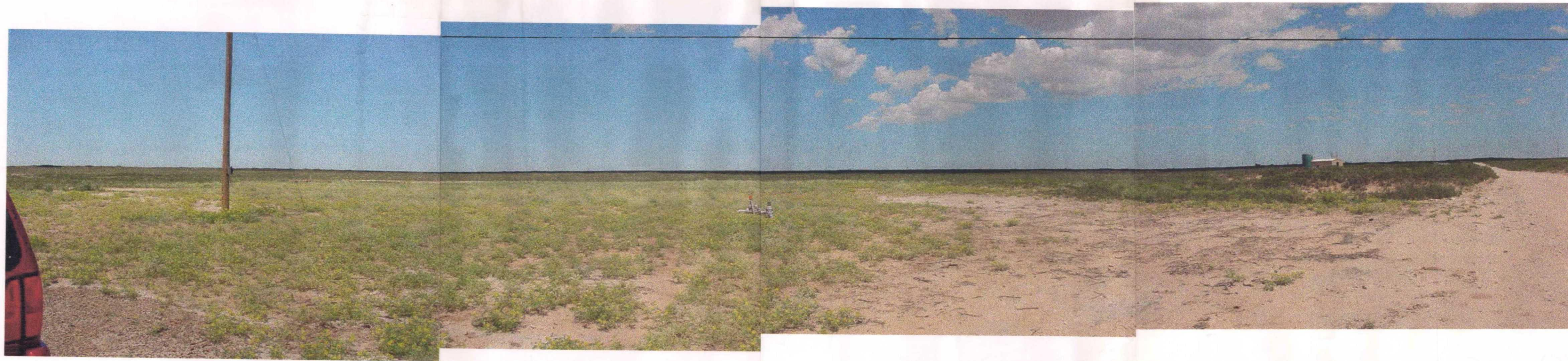

Price, Wayne

From: Price, Wayne
Sent: Thursday, March 28, 2002 2:41 PM
To: 'ALLSTATEENV@aol.com'
Subject: Saga Projects- 1R0316 Todd Lower San Andres Unit Pit; and 1R0337 UD Sawyer water pit

What is the status of the two projects?



ALLSTATE ENVIRONMENTAL SERVICES, LLC



P.O BOX 11322
MIDLAND, TEXAS 79702
OFFICE: (915) 682-3547
FAX: (915) 682-4182

March 4, 2002

Mr. Wayne Price
New Mexico OCD
1220 S. Saint Francis Drive
Santa Fe, New Mexico 87505

RECEIVED
MAR 12 2002
Environmental Bureau
Oil Conservation Division

Dear Mr. Price:

Included in this mailing is the closure report for the Saga Petroleum Todd Lower San Andres Unit Pit in Roosevelt County, New Mexico. As indicated in the report, the preliminary work (sampling) was begun in early May of 2001 with the bulk of the activities (excavation, confirmatory sampling, encapsulation, re-vegetation) completed in late May and early June.

Any concerns or questions regarding this site may be addressed to Randy Offield, Allstate Environmental Services, at 915-682-3547 or his e-mail address at allstateenv@aol.com.

Sincerely,

C. H. Kerby for Randy Offield

An Environmental Company

SOLIDIFICATION, BIOREMEDIATION, LAND FARMING, SOIL SHREDDING