

1R - 405

GENERAL CORRESPONDENCE

YEAR(S):

2004

Price, Wayne

From: Dan Erskine [DErskine@maximusa.com]
Sent: Tuesday, May 04, 2004 10:48 AM
To: Wayne Price (E-mail)
Subject: Sims #9

Wayne,

It is in SE of the NW Sec 24, T22S, R37E.

Or more precisely, (DMS) N32° 22' 44.8", W103° 7' 5.8".

Dan

Daniel W. Erskine, Ph.D.

Senior Geologist/ Geochemist

Maxim Technologies, Inc.

10601 Lomas NE

Albuquerque, NM 87112

Phone: 505-237-8440

FAX: 505-237-8656

<mailto:derskine@maximusa.com>

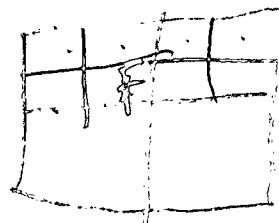

This email has been scanned by the MessageLabs Email Security System.
For more information please visit <http://www.messagelabs.com/email>

Price, Wayne

From: Clyde Yancey [CYancey@maximusa.com]
Sent: Monday, May 03, 2004 11:29 AM
To: Price, Wayne
Cc: Neal Goates (Neal.Goates@conocophillips.com)
Subject: Sims #9 Map

Wayne,

Per our conversation, please find attached a map showing the location of the Sims #9 location. Let me know if you have anyother questions.

Thanks
Clyde

Clyde L. Yancey, P.G.
Maxim Technologies, Inc.
10601 Lomas Blvd. NE, Suite 106
Albuquerque, NM 87112
(505) 237-8440

This email has been scanned by the MessageLabs Email Security System.
For more information please visit <http://www.messagelabs.com/email>

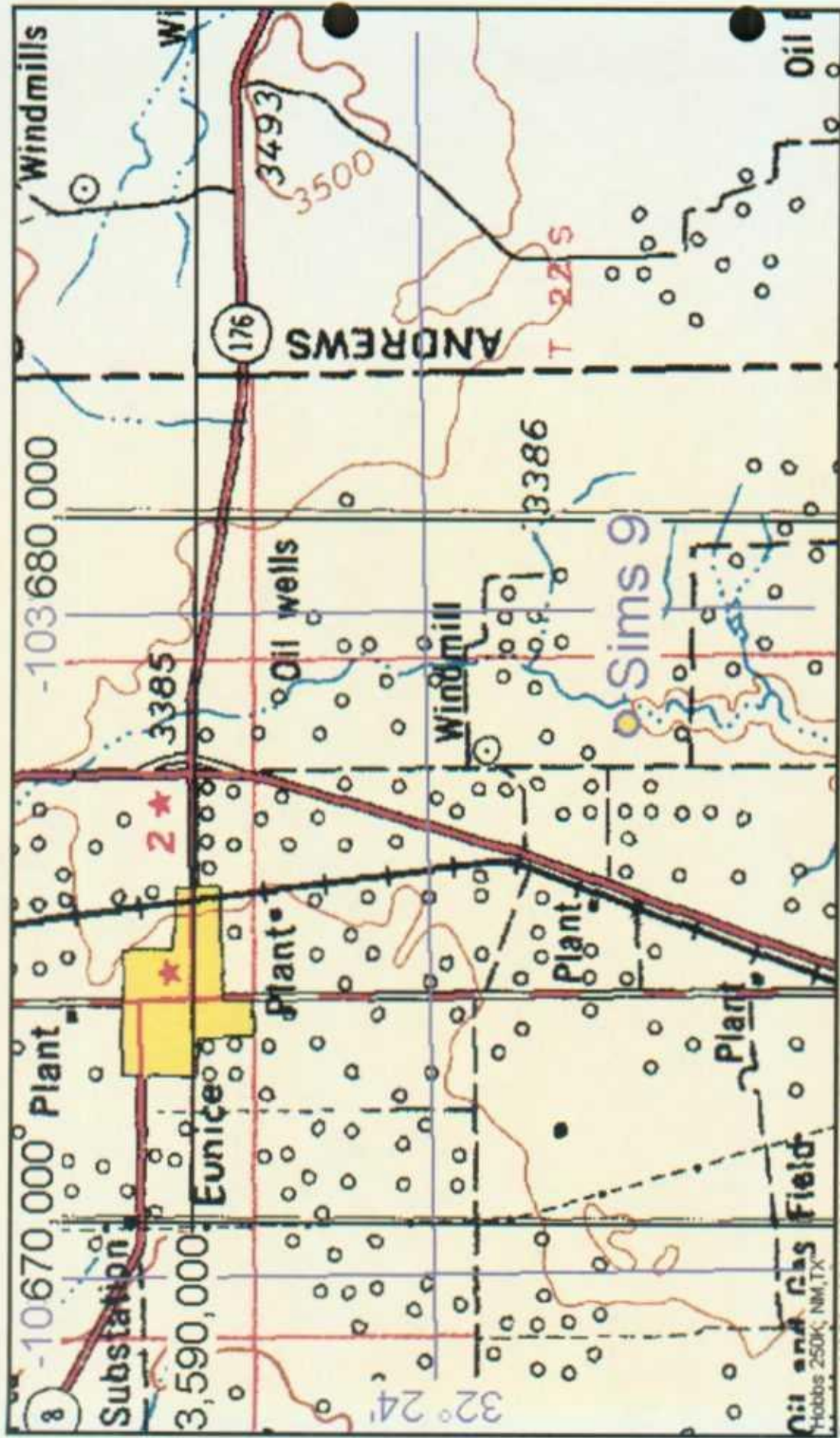

ConocoPhillips Sims 9 Well
Location.

Price, Wayne

From: Clyde Yancey [CYancey@maximusa.com]
Sent: Thursday, April 29, 2004 9:42 AM
To: Price, Wayne
Subject: RE: Simms #9

Wayne

Attached are two pics I would like for you to take a look at and when you have a few minutes, give me a call and I can bring you up to speed on the history of this site (at least as far as I know)

Thanks,
Clyde

Clyde L. Yancey, P.G.
Maxim Technologies, Inc.
10601 Lomas Blvd. NE, Suite 106
Albuquerque, NM 87112
(505) 237-8440

-----Original Message-----

From: Price, Wayne [mailto:WPrice@state.nm.us]
Sent: Tuesday, April 27, 2004 10:20 AM
To: 'cyancey@maximusa.com'
Cc: Neal Goates (E-mail)
Subject: Simms #9

Please provide a copy of the previous report and a summation of all activities as of to date. Were any waste taken off-site and where disposed of? Please include an area and site map, photos, location of significant equipment, features, MW's etc. Groundwater gradient, depth to water. Has this site been assigned an OCD case number?

Sincerely:

Wayne Price
New Mexico Oil Conservation Division
1220 S. Saint Francis Drive
Santa Fe, NM 87505
505-476-3487
fax: 505-476-3462
E-mail: WPRICE@state.nm.us

Confidentiality Notice: This e-mail, including all attachments is for the sole use of the intended recipient(s) and may contain confidential and privileged information. Any unauthorized review, use, disclosure or distribution is prohibited unless specifically provided under the New Mexico Inspection of Public Records Act. If you are not the intended recipient, please contact the sender and destroy all copies of this message. -- This email has been scanned by the MessageLabs Email Security System.

5/4/2004

This email has been scanned by the MessageLabs Email Security System.
For more information please visit <http://www.messagelabs.com/email>



Sims #9 Study Design

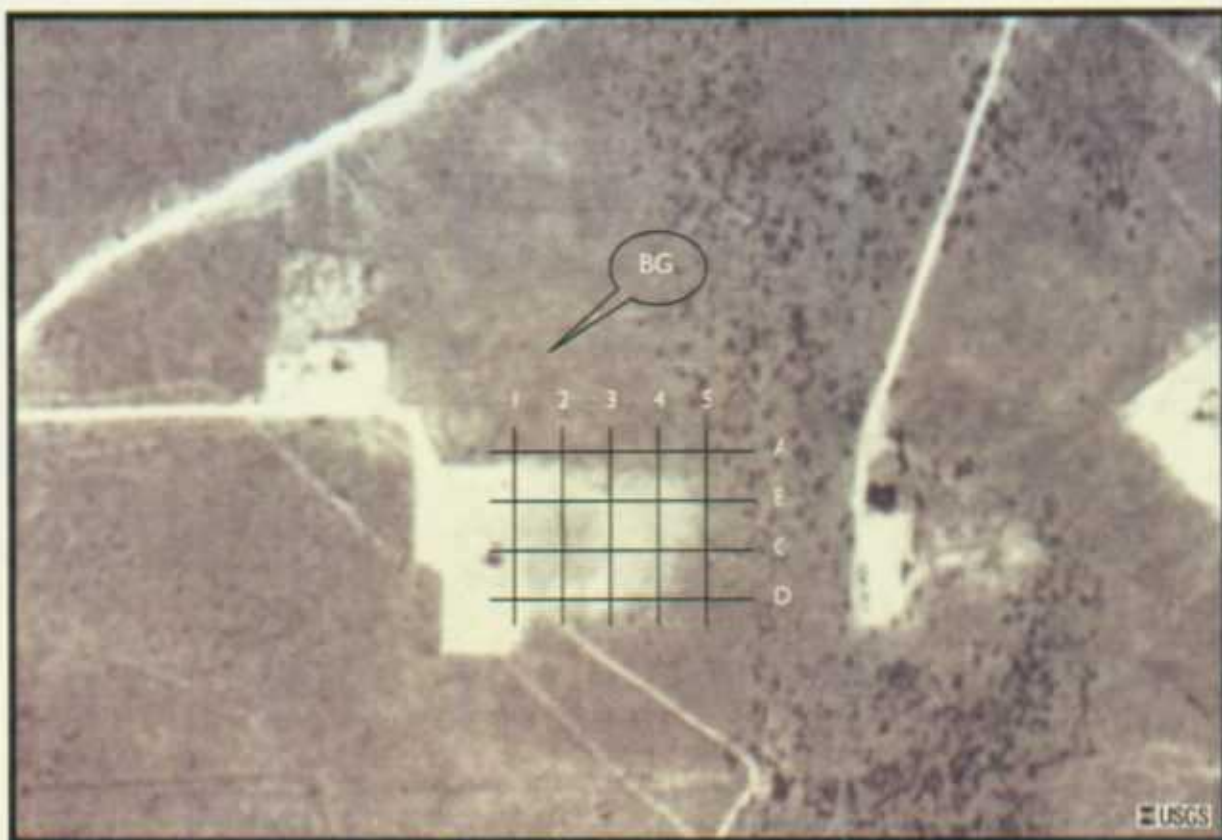

Source: USGS Terraserver-USA.com, Aerial Photo 11/1/1997, 8 km SE of Eunice, New Mexico, United States, 15 Jan 1996.

Sims #9 Study Design

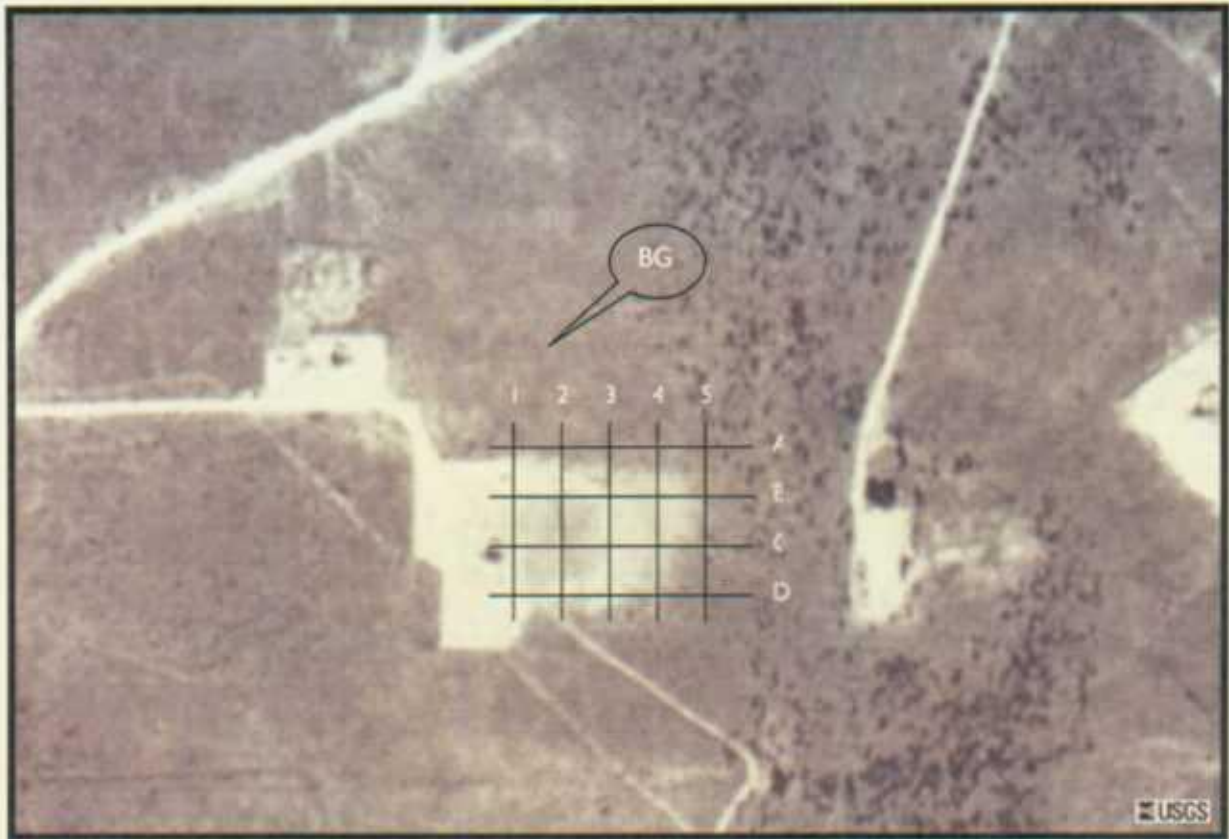

Source: USGS Terraserver-USA.com, Aerial Photo 11/1/1997, 8 km SE of Eunice, New Mexico, United States, 15 Jan 1996.

Price, Wayne

From: Price, Wayne
Sent: Tuesday, April 27, 2004 10:20 AM
To: 'cyancey@maximusa.com'
Cc: Neal Goates (E-mail)
Subject: Simms #9

Contacts: Clyde Yancey

Please provide a copy of the previous report and a summation of all activities as of to date. Were any waste taken off-site and where disposed of? Please include an area and site map, photos, location of significant equipment, features, MW's etc. Groundwater gradient, depth to water. Has this site been assigned an OCD case number?

Sincerely:

Wayne Price
New Mexico Oil Conservation Division
1220 S. Saint Francis Drive
Santa Fe, NM 87505
505-476-3487
fax: 505-476-3462
E-mail: WPRICE@state.nm.us