

1R - 426-8

REPORTS

DATE:

8/15/2003

1R-426-8

DISCLOSURE REPORT

**RICE OPERATING COMPANY
JUNCTION BOX DISCLOSURE* REPORT**

BOX LOCATION

| SWD SYSTEM | JUNCTION | UNIT | SECTION | TOWNSHIP | RANGE | COUNTY | BOX DIMENSIONS - FEET | | |
|------------|-----------|------|---------|----------|-------|--------|-----------------------|-------|-------|
| | | | | | | | Length | Width | Depth |
| BD | Hardy EOL | K | 20 | 21 S | 37 E | Lea | Moved 45 ft Northeast | | |

LAND TYPE: BLM _____ STATE _____ FEE LANDOWNER _____ Millard Deck _____ OTHER _____

Depth to Groundwater _____ 99 _____ feet NMOCD SITE ASSESSMENT RANKING SCORE: _____ 10 _____

Date Started _____ 4/30/2003 _____ Date Completed _____ 8/5/2003 _____ OCD Witness _____ No _____

Soil Excavated _____ 433 _____ cubic yards Excavation Length _____ 30 _____ Width _____ 30 _____ Depth _____ 13 _____ feet

Soil Disposed _____ 0 _____ cubic yards Offsite Facility _____ n/a _____ Location _____ n/a _____

FINAL ANALYTICAL RESULTS: Sample Date _____ 5/2/2003 _____ Sample Depth _____ 13 ft bgs _____

Procure 5-point composite sample of bottom and 4-point composite sample of sidewalls. TPH, BTEX and Chloride laboratory test results completed by using an approved lab and testing procedures pursuant to NMOCD guidelines.

| Sample Location | Benzene mg/kg | Toluene mg/kg | Ethyl Benzene mg/kg | Total Xylenes mg/kg | GRO mg/kg | DRO mg/kg | Chlorides mg/kg |
|-----------------|---------------|---------------|---------------------|---------------------|-----------|-----------|-----------------|
| SIDEWALLS | <0.025 | <0.025 | 0.059 | 0.196 | 133 | 2040 | 1060 |
| BOTTOM | <0.025 | 0.241 | 2.010 | 5.830 | 1390 | 6570 | 2480 |

General Description of Remedial Action: This junction was located directly north of an active facility. Vertical and lateral delineation yielded consistent chloride and TPH concentrations throughout the 24 x 24 x 13 ft deep excavation. Chloride impact increased with depth and NMOCD TPH guidelines were not met. The hole has been backfilled and the location identified for further consideration at a later date. A new watertight junction box has been built 45 feet northeast of this site.

CHLORIDE FIELD TESTS

| LOCATION | DEPTH (ft) | ppm |
|--------------|------------|------|
| Vertical | 3 | 400 |
| | 9 | 1100 |
| | 13 | 1700 |
| | | |
| 4 wall comp. | n/a | 1100 |
| bottom comp. | 13 | 2250 |
| | | |
| | | |
| | | |
| | | |

ADDITIONAL EVALUATION IS MEDIUM PRIORITY.

cc: lab results, chloride graph, diagram, photos

I HEREBY CERTIFY THAT THE INFORMATION ABOVE IS TRUE AND COMPLETE TO THE BEST OF MY KNOWLEDGE AND BELIEF.

DATE _____ 8/15/2003 _____ PRINTED NAME _____ Kristin Farris _____

SIGNATURE _____ *Kristin Farris* _____ TITLE _____ Project Scientist _____

*** This site is a "DISCLOSURE." It will be placed on a prioritized list of similar sites for further consideration.**

BD Hardy EOL



R O A D

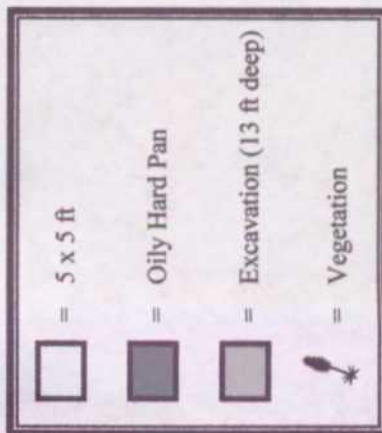
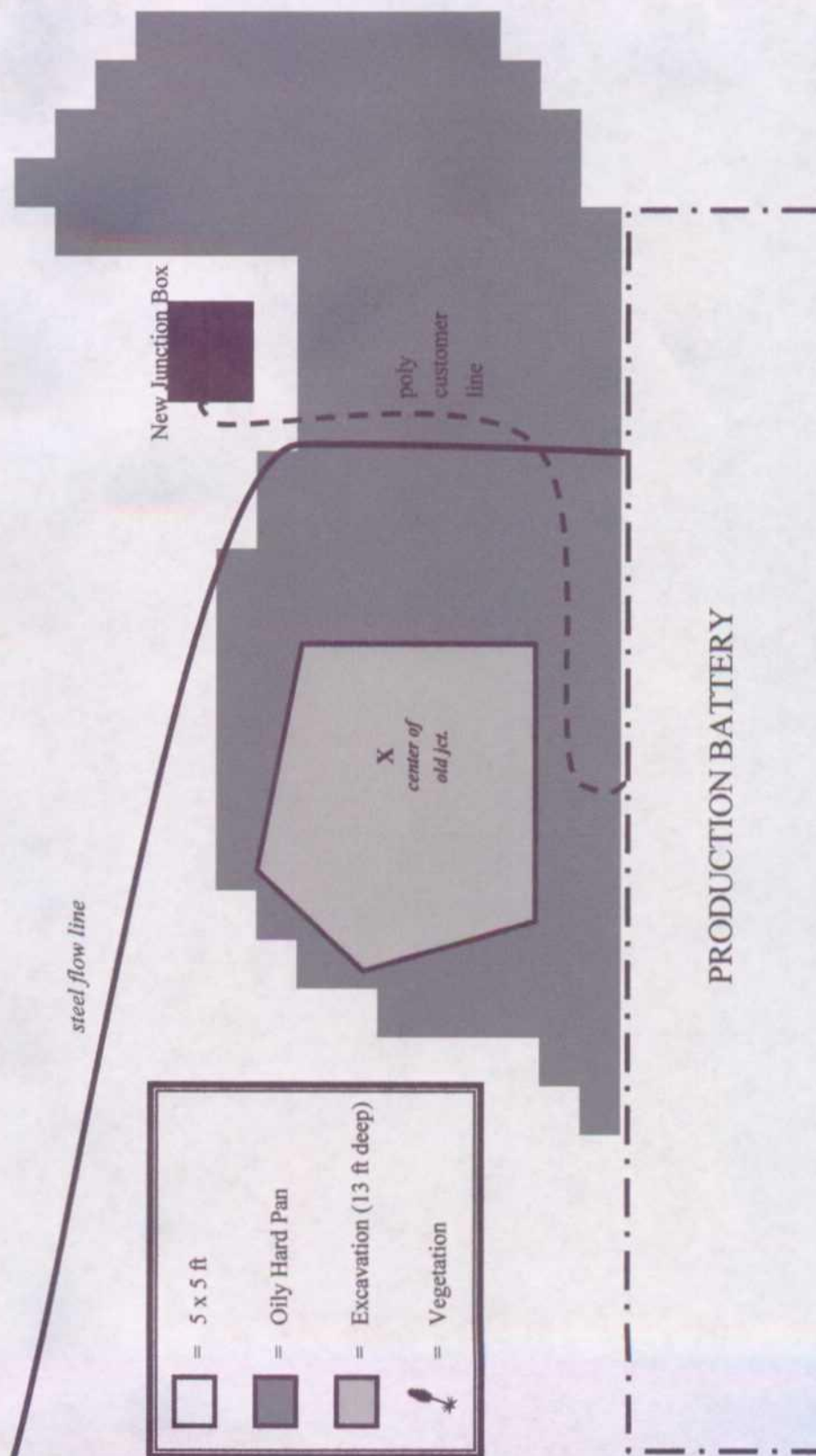

BD Hardy EOL

UL 'K', Sec. 20, T21S, R37E

| Depth bgs (ft) | [Cl ⁻] ppm |
|----------------|------------------------|
| 3 | 400 |
| 9 | 1100 |
| 13 | 1700 |

Groundwater = 99 ft

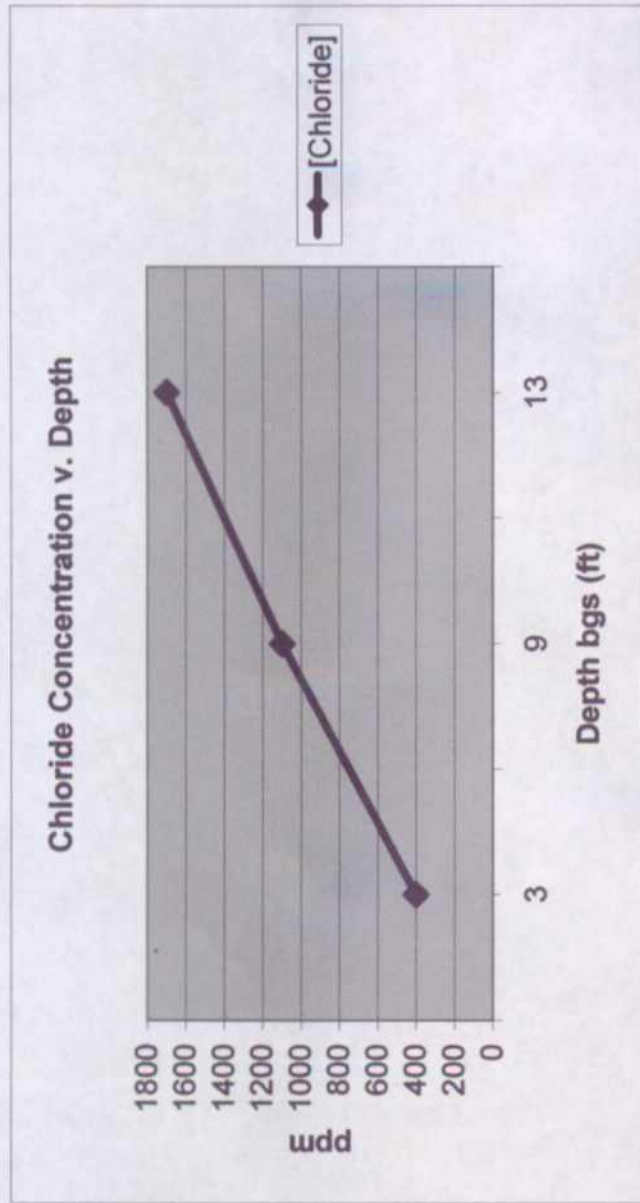

BD Hardy EOL



Junction Box Site with Old Plumbing (after NORM)



Excavation--May 2003



Final Excavation (looking Southeast)—May 2003



Backfilled with ID plate (looking East)—August 2003



Collection Area ~140 ft North of Old Junction Box Site (new box in left background)—8/7/2003

ANALYTICAL REPORT

Prepared for:

Kristin Farris
Rice Operating
122 W. Taylor
Hobbs, NM 88240

Project: Chevron Hardy EOL

PO#:

Order#: G0306411

Report Date: 05/08/2003

Certificates

US EPA Laboratory Code TX00158

ENVIRONMENTAL LAB OF TEXAS

SAMPLE WORK LIST

Rice Operating
122 W. Taylor
Hobbs, NM 88240
505-397-1471

Order#: G0306411
Project:
Project Name: Chevron Hardy EOL
Location: BD

The samples listed below were submitted to Environmental Lab of Texas and were received under chain of custody. Environmental Lab of Texas makes no representation or certification as to the method of sample collection, sample identification, or transportation/handling procedures used prior to the receipt of samples by Environmental Lab of Texas, unless otherwise noted.

| <u>Lab ID:</u> | <u>Sample :</u> | <u>Matrix:</u> | <u>Date / Time</u> <u>Collected</u> | <u>Date / Time</u> <u>Received</u> | <u>Container</u> | <u>Preservative</u> |
|----------------|---|----------------|--|---------------------------------------|------------------|---------------------|
| 0306411-01 | 5 pt. Bottom Comp. @ 13' | SOIL | 5/2/03 11:00 | 5/2/03 19:30 | 4 oz glass | Ice |
| | <u>Lab Testing:</u> 8015M 8021B/5030 BTEX Chloride | Rejected: No | | Temp: 4 C | | |
| 0306411-02 | Wall Comp. | SOIL | 5/2/03 11:00 | 5/2/03 19:30 | 4 oz glass | Ice |
| | <u>Lab Testing:</u> 8015M 8021B/5030 BTEX Chloride | Rejected: No | | Temp: 4 C | | |

ENVIRONMENTAL LAB OF TEXAS

ANALYTICAL REPORT

Kristin Farris
Rice Operating
122 W. Taylor
Hobbs, NM 88240

Order#: G0306411
Project:
Project Name: Chevron Hardy EOL
Location: BD

Lab ID: 0306411-01
Sample ID: 5 pt. Bottom Comp. @ 13'

8015M

| | | | | | | |
|-------------------------------|--------------------------------|--------------------------------|--------------------------------|----------------------------------|----------------|---------------|
| <u>Method</u> <u>Blank</u> | <u>Date</u> <u>Prepared</u> | <u>Date</u> <u>Analyzed</u> | <u>Sample</u> <u>Amount</u> | <u>Dilution</u> <u>Factor</u> | <u>Analyst</u> | <u>Method</u> |
| | | 5/5/03 | 1 | 5 | WL | 8015M |

| Parameter | Result mg/kg | RL |
|---------------|-----------------|------|
| GRO, C6-C12 | 1390 | 50.0 |
| DRO, >C12-C35 | 6570 | 50.0 |
| TOTAL, C6-C35 | 7960 | 50.0 |

| Surrogates | % Recovered | QC Limits (%) | |
|--------------------|-------------|---------------|-----|
| 1-Chlorooctane | 50% | 70 | 130 |
| 1-Chlorooctadecane | 21% | 70 | 130 |

8021B/5030 BTEX

| | | | | | | |
|-------------------------------|--------------------------------|--------------------------------|--------------------------------|----------------------------------|----------------|---------------|
| <u>Method</u> <u>Blank</u> | <u>Date</u> <u>Prepared</u> | <u>Date</u> <u>Analyzed</u> | <u>Sample</u> <u>Amount</u> | <u>Dilution</u> <u>Factor</u> | <u>Analyst</u> | <u>Method</u> |
| 0005460-02 | | 5/7/03 14:04 | 1 | 25 | CK | 8021B |

| Parameter | Result mg/kg | RL |
|--------------|-----------------|-------|
| Benzene | <0.025 | 0.025 |
| Toluene | 0.241 | 0.025 |
| Ethylbenzene | 2.01 | 0.025 |
| p/m-Xylene | 3.70 | 0.025 |
| o-Xylene | 2.13 | 0.025 |

| Surrogates | % Recovered | QC Limits (%) | |
|--------------------|-------------|---------------|-----|
| aaa-Toluene | 99% | 80 | 120 |
| Bromofluorobenzene | 108% | 80 | 120 |

DL = Diluted out N/A = Not Applicable RL = Reporting Limit

Page 1 of 2

ENVIRONMENTAL LAB OF TEXAS

ANALYTICAL REPORT

Kristin Farris
Rice Operating
122 W. Taylor
Hobbs, NM 88240

Order#: G0306411
Project:
Project Name: Chevron Hardy EOL
Location: BD

Lab ID: 0306411-02
Sample ID: Wall Comp.

8015M

| Method <u>Blank</u> | Date <u>Prepared</u> | Date <u>Analyzed</u> | Sample <u>Amount</u> | Dilution <u>Factor</u> | Analyst | Method |
|------------------------|-------------------------|-------------------------|-------------------------|---------------------------|---------|--------|
| | | 5/5/03 | 1 | 5 | WL | 8015M |

| Parameter | Result mg/kg | RL |
|---------------|-----------------|------|
| GRO, C6-C12 | 133 | 50.0 |
| DRO, >C12-C35 | 2040 | 50.0 |
| TOTAL, C6-C35 | 2173 | 50.0 |

| Surrogates | % Recovered | QC Limits (%) | |
|--------------------|-------------|---------------|-----|
| 1-Chlorooctane | 38% | 70 | 130 |
| 1-Chlorooctadecane | 17% | 70 | 130 |

8021B/5030 BTEX

| Method <u>Blank</u> | Date <u>Prepared</u> | Date <u>Analyzed</u> | Sample <u>Amount</u> | Dilution <u>Factor</u> | Analyst | Method |
|------------------------|-------------------------|-------------------------|-------------------------|---------------------------|---------|--------|
| 0005460-02 | | 5/7/03 14:25 | 1 | 25 | CK | 8021B |

| Parameter | Result mg/kg | RL |
|--------------|-----------------|-------|
| Benzene | <0.025 | 0.025 |
| Toluene | <0.025 | 0.025 |
| Ethylbenzene | 0.059 | 0.025 |
| p/m-Xylene | 0.141 | 0.025 |
| o-Xylene | 0.055 | 0.025 |

| Surrogates | % Recovered | QC Limits (%) | |
|--------------------|-------------|---------------|-----|
| aaa-Toluene | 80% | 80 | 120 |
| Bromofluorobenzene | 93% | 80 | 120 |

Approval:

Raland K. Tuttle 5-09-03
Raland K. Tuttle, Lab Director, QA Officer
Celey D. Keene, Org. Tech. Director
Jeanne McMurrey, Inorg. Tech. Director
Sandra Riezugbe, Lab Tech.
Sara Molina, Lab Tech.

Date

DL = Diluted out N/A = Not Applicable RL = Reporting Limit

Page 2 of 2

ENVIRONMENTAL LAB OF TEXAS

ANALYTICAL REPORT

Kristin Farris
Rice Operating
122 W. Taylor
Hobbs, NM 88240

Order#: G0306411
Project:
Project Name: Chevron Hardy EOL
Location: BD

Lab ID: 0306411-01
Sample ID: 5 pt. Bottom Comp. @ 13'

Test Parameters

| <u>Parameter</u> | <u>Result</u> | <u>Units</u> | <u>Dilution Factor</u> | <u>RL</u> | <u>Method</u> | <u>Date Analyzed</u> | <u>Analyst</u> |
|------------------|---------------|--------------|----------------------------|-----------|---------------|--------------------------|----------------|
| Chloride | 2480 | mg/kg | 1 | 20 | 9253 | 5/6/03 | SB |

Lab ID: 0306411-02
Sample ID: Wall Comp.

Test Parameters

| <u>Parameter</u> | <u>Result</u> | <u>Units</u> | <u>Dilution Factor</u> | <u>RL</u> | <u>Method</u> | <u>Date Analyzed</u> | <u>Analyst</u> |
|------------------|---------------|--------------|----------------------------|-----------|---------------|--------------------------|----------------|
| Chloride | 1060 | mg/kg | 1 | 20 | 9253 | 5/6/03 | SB |

Approval:

Raland K. Tuttle 5-09-03
Raland K. Tuttle, Lab Director, QA Officer
Celey D. Keene, Org. Tech. Director
Jeanne McMurrey, Inorg. Tech. Director
Sandra Biezugbe, Lab Tech.
Sara Molina, Lab Tech.

RL = Reporting Limit N/A = Not Applicable

Page 1 of 1

ENVIRONMENTAL LAB OF TEXAS

QUALITY CONTROL REPORT

8015M

Order#: G0306411

| BLANK | SOIL | LAB-ID # | Sample Concentr. | Spike Concentr. | QC Test Result | Pct (%) Recovery | RPD |
|---------------------|------|------------|---------------------|--------------------|-------------------|---------------------|------|
| TOTAL, C6-C35-mg/kg | | 0005438-02 | | | <10.0 | | |
| CONTROL | SOIL | LAB-ID # | Sample Concentr. | Spike Concentr. | QC Test Result | Pct (%) Recovery | RPD |
| TOTAL, C6-C35-mg/kg | | 0005438-03 | | 952 | 924 | 97.1% | |
| CONTROL DUP | SOIL | LAB-ID # | Sample Concentr. | Spike Concentr. | QC Test Result | Pct (%) Recovery | RPD |
| TOTAL, C6-C35-mg/kg | | 0005438-04 | | 952 | 945 | 99.3% | 2.2% |
| SRM | SOIL | LAB-ID # | Sample Concentr. | Spike Concentr. | QC Test Result | Pct (%) Recovery | RPD |
| TOTAL, C6-C35-mg/kg | | 0005438-05 | | 1000 | 890 | 89.0% | |

ENVIRONMENTAL LAB OF TEXAS**QUALITY CONTROL REPORT****8021B/5030 BTEX****Order#: G0306411**

| BLANK | SOIL | LAB-ID # | Sample Concentr. | Spike Concentr. | QC Test Result | Pct (%) Recovery | RPD |
|--------------------|------|------------|------------------|-----------------|----------------|------------------|-------|
| Benzene-mg/kg | | 0005460-02 | | | <0.025 | | |
| Toluene-mg/kg | | 0005460-02 | | | <0.025 | | |
| Ethylbenzene-mg/kg | | 0005460-02 | | | <0.025 | | |
| p/m-Xylene-mg/kg | | 0005460-02 | | | <0.025 | | |
| o-Xylene-mg/kg | | 0005460-02 | | | <0.025 | | |
| MS | SOIL | LAB-ID # | Sample Concentr. | Spike Concentr. | QC Test Result | Pct (%) Recovery | RPD |
| Benzene-mg/kg | | 0306423-02 | 0 | 0.1 | 0.094 | 94.0% | |
| Toluene-mg/kg | | 0306423-02 | 0 | 0.1 | 0.090 | 90.0% | |
| Ethylbenzene-mg/kg | | 0306423-02 | 0 | 0.1 | 0.087 | 87.0% | |
| p/m-Xylene-mg/kg | | 0306423-02 | 0 | 0.2 | 0.183 | 91.5% | |
| o-Xylene-mg/kg | | 0306423-02 | 0 | 0.1 | 0.090 | 90.0% | |
| MSD | SOIL | LAB-ID # | Sample Concentr. | Spike Concentr. | QC Test Result | Pct (%) Recovery | RPD |
| Benzene-mg/kg | | 0306423-02 | 0 | 0.1 | 0.105 | 105.0% | 11.1% |
| Toluene-mg/kg | | 0306423-02 | 0 | 0.1 | 0.103 | 103.0% | 13.5% |
| Ethylbenzene-mg/kg | | 0306423-02 | 0 | 0.1 | 0.102 | 102.0% | 15.9% |
| p/m-Xylene-mg/kg | | 0306423-02 | 0 | 0.2 | 0.211 | 105.5% | 14.2% |
| o-Xylene-mg/kg | | 0306423-02 | 0 | 0.1 | 0.101 | 101.0% | 11.5% |
| SRM | SOIL | LAB-ID # | Sample Concentr. | Spike Concentr. | QC Test Result | Pct (%) Recovery | RPD |
| Benzene-mg/kg | | 0005460-05 | | 0.1 | 0.094 | 94.0% | |
| Toluene-mg/kg | | 0005460-05 | | 0.1 | 0.096 | 96.0% | |
| Ethylbenzene-mg/kg | | 0005460-05 | | 0.1 | 0.095 | 95.0% | |
| p/m-Xylene-mg/kg | | 0005460-05 | | 0.2 | 0.197 | 98.5% | |
| o-Xylene-mg/kg | | 0005460-05 | | 0.1 | 0.090 | 90.0% | |

ENVIRONMENTAL LAB OF TEXAS

QUALITY CONTROL REPORT

Test Parameters

Order#: G0306411

| | | | | | | | |
|----------------|------|------------|---------------------|--------------------|-------------------|---------------------|------|
| BLANK | SOIL | LAB-ID # | Sample Concentr. | Spike Concentr. | QC Test Result | Pct (%) Recovery | RPD |
| Chloride-mg/kg | | 0005442-01 | | | <20.0 | | |
| MS | SOIL | LAB-ID # | Sample Concentr. | Spike Concentr. | QC Test Result | Pct (%) Recovery | RPD |
| Chloride-mg/kg | | 0306411-01 | 2480 | 500 | 2960 | 96.0% | |
| MSD | SOIL | LAB-ID # | Sample Concentr. | Spike Concentr. | QC Test Result | Pct (%) Recovery | RPD |
| Chloride-mg/kg | | 0306411-01 | 2480 | 500 | 2980 | 100.0% | 0.7% |
| SRM | SOIL | LAB-ID # | Sample Concentr. | Spike Concentr. | QC Test Result | Pct (%) Recovery | RPD |
| Chloride-mg/kg | | 0005442-04 | | 5000 | 4960 | 99.2% | |

CASE NARRATIVE

ENVIRONMENTAL LAB OF TEXAS

Prepared for:

Rice Operating
122 W. Taylor
Hobbs, NM 88240

Order#: G0306411**Project:** Chevron Hardy EOL

The following samples were received as indicated below and on the attached Chain of Custody record. All analyses were performed within the holding time and with acceptable quality control results unless otherwise noted.

| SAMPLE ID | LAB ID | MATRIX | Date Collected | Date Received |
|--------------------|------------|--------|----------------|---------------|
| 5 pt. Bottom Comp. | 0306411-01 | SOIL | 05/02/2003 | 05/02/2003 |
| Wall Comp. | 0306411-02 | SOIL | 05/02/2003 | 05/02/2003 |

Surrogate recoveries on 8015M TPH are outside of control limits due to dilution (G0306411-01, 02).

The enclosed results of analyses are representative of the samples as received by the laboratory. Environmental Lab of Texas makes no representations or certifications as to the methods of sample collection, sample identification, or transportation handling procedures used prior to our receipt of samples. To the best of my knowledge, the information contained in this report is accurate and complete.

Approved By:

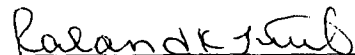

Environmental Lab of Texas I, Ltd.

Date:

5-09-03

12600 West I-20 East
Odessa, Texas 79763

Phone: 915-563-1800
Fax: 915-563-1713

CHAIN OF CUSTODY RECORD AND ANALYSIS REQUEST

Kristen Harris

Rice

122 W Taylor

Hebbes, Wm 88240

Fax No:

15

Cleveron Hardy ELL

20

| | | |
|---------------------------|---|---|
| Sample Containers Intact? | Y | N |
| Temperature Upon Receipt: | | |
| Laboratory Comments: | | |

Y
Z

Laboratory Comments:

| Date | Time |
|------|------|
|------|------|

Received by:

Date _____

Time

| Date | Time |
|------|------|
|------|------|

Received by JELOT:

Date _____

Time

Relinquished by
[Signature]

| Date | Time |
|--------|-------|
| 5-2-03 | 19:30 |

Kick back

Date
5-02-03

Time
1936