

**3R - 3**

---

# **REPORTS**

**DATE:**

**1997**

---

District I  
P.O. Box 1980, Hobbs, NM  
District II  
P.O. Drawer DD, Artesia, NM 88211  
District III  
1000 Rio Brazos Rd, Aztec, NM 87410

State of New Mexico  
Energy, Minerals and Natural Resources Department

OIL CONSERVATION DIVISION  
P.O. Box 2088  
Santa Fe, New Mexico 87504-2088

SUBMIT 1 COPY TO  
APPROPRIATE  
DISTRICT OFFICE  
AND 1 COPY TO  
SANTA FE OFFICE

PIT REMEDIATION AND CLOSURE REPORT

OK

Operator: Amoco Production Company Telephone: (505) - 326-9200

Address: 200 Amoco Court, Farmington, New Mexico 87401

Facility Or: BOLACK B LS 5  
Well Name

Location: Unit or Qtr/Qtr Sec J Sec 33 T28N R8W County SAN JUAN

Pit Type: Separator ☒ Dehydrator ☐ Other ☐

Land Type: BLM ☒, State ☐, Fee ☐, Other ☐

Pit Location: Pit dimensions: length 11', width 9', depth 8'  
(Attach diagram)

Reference: wellhead ☒, other ☐

Footage from reference: 25'

Direction from reference: 50 Degrees East North ☐  
of  
☒ West South ☒

Depth To Ground Water:

(Vertical distance from  
contaminants to seasonal  
high water elevation of  
ground water)

Less than 50 feet (20 points)

50 feet to 99 feet (10 points)

Greater than 100 feet (0 Points) 10

Wellhead Protection Area:

(Less than 200 feet from a private  
domestic water source, or; less than  
1000 feet from all other water sources)

Yes (20 points)

No (0 points) 0

Distance To Surface Water:

(Horizontal distance to perennial  
lakes, ponds, rivers, streams, creeks,  
irrigation canals and ditches)

Less than 200 feet (20 points)

200 feet to 1000 feet (10 points)

Greater than 1000 feet (0 points) 0

RANKING SCORE (TOTAL POINTS):

10

Date Remediation Started: \_\_\_\_\_ Date Completed: 8-26-94

Remediation Method: Excavation ☒ Approx. cubic yards 18  
(Check all appropriate sections) Landfarmed ☒ Insitu Bioremediation \_\_\_\_\_  
Other \_\_\_\_\_

Remediation Location: Onsite ☒ Offsite \_\_\_\_\_  
(ie. landfarmed onsite, name and location of offsite facility)

General Description Of Remedial Action: \_\_\_\_\_  
Excavation

Ground Water Encountered: No \_\_\_\_\_ Yes ☒ Depth 8'

Final Pit: Sample location see Attached Documents  
Closure Sampling: \_\_\_\_\_  
(if multiple samples, attach sample results and diagram of sample locations and depths)

Sample depth 8'  
Sample date 8-26-94 Sample time \_\_\_\_\_

Sample Results

Benzene(ppm) ND  
Total BTEX(ppm) ND  
Field headspace(ppm) \_\_\_\_\_  
TPH \_\_\_\_\_

Ground Water Sample: Yes ☒ No \_\_\_\_\_ (If yes, attach sample results)

I HEREBY CERTIFY THAT THE INFORMATION ABOVE IS TRUE AND COMPLETE TO THE BEST OF MY KNOWLEDGE AND BELIEF

DATE 9/13/94

SIGNATURE

B. Shaw

PRINTED NAME  
AND TITLE

Buddy D. Shaw  
ENVIRONMENTAL COORDINATOR





# ON SITE TECHNOLOGIES, LTD.

## AROMATIC VOLATILE ORGANICS

Attn: *R. E. O'Neill*  
Company: *Blagg Engineering*  
Address: *P.O. Box 87*  
City, State: *Bloomfield, NM 87413*

Date: *9/7/94*  
Lab ID: *1846*  
Sample ID: *2893*  
Job No. *2-1000*

Project Name: *Bolack B LS #5*  
Project Location: *PW 1 @ GW (8')*  
Sampled by: *REO* Date: *8/26/94*  
Analyzed by: *DLA* Date: *9/7/94*  
Sample Matrix: *Liquid*

Time: *7:50*

### Aromatic Volatile Organics

Component	Measured Concentration ug/L	Detection Limit Concentration ug/L
<i>Benzene</i>	<i>ND</i>	<i>0.2</i>
<i>Toluene</i>	<i>ND</i>	<i>0.2</i>
<i>Ethylbenzene</i>	<i>ND</i>	<i>0.2</i>
<i>m,p-Xylene</i>	<i>ND</i>	<i>0.2</i>
<i>o-Xylene</i>	<i>ND</i>	<i>0.2</i>
<i>TOTAL</i>		<i>0 ug/L</i>

*ND - Not Detectable*

**Method** - SW-846 EPA Method 8020 Aromatic Volatile Organics by Gas Chromatography

Approved by: *Da G*

Date: *9/7/94*

CLIENT: <u>AMOCO</u>	BLAGG ENGINEERING, INC. P.O. BOX 87, BLOOMFIELD, NM 87413 (505) 632-1199	LOCATION NO: <u>80067</u> C.D.C. NO: <u>ANAITAS</u>
----------------------	--	--

## FIELD REPORT: LANDFARM/COMPOST PILE CLOSURE VERIFICATION

LOCATION: <u>BOLACK B L S 5</u> LEASE: <u>NM-012202</u> QUAD/UNIT: <u>J</u> SEC: <u>33</u> TWP: <u>28 N</u> RNG: <u>8 W</u> BM: N.M. CNTY: S.J. ST: N.M. QTR/FOOTAGE: <u>1650' FSL. 1750' FEL.</u> CONTRACTOR: <u>MOSS</u>	DATE STARTED: <u>5-16-96</u> DATE FINISHED: _____ ENVIRONMENTAL SPECIALIST: <u>R.E.D.</u>
--	---

### SOIL REMEDIATION:

REMEDIATION SYSTEM: LANDFARM APPROX. CUBIC YARDAGE: 18  
 LAND USE: RANGE

### FIELD NOTES & REMARKS:

DEPTH TO GROUNDWATER: 250' NEAREST WATER SOURCE: >1000' NEAREST SURFACE WATER: >1000'  
 NMOCB RANKING SCORE: 20 NMOCB TPH CLOSURE STD: 100 PPM

SOIL CONSISTS OF A DRY SILTY SAND - NO STAIN, NO ODOR.

### FIELD 418.1 CALCULATIONS

SAMPLE I.D.	LAB No:	WEIGHT (g)	mL. FREON	DILUTION	READING	CALC. ppm

CLOSE C.F.

### SKETCH/SAMPLE LOCATIONS

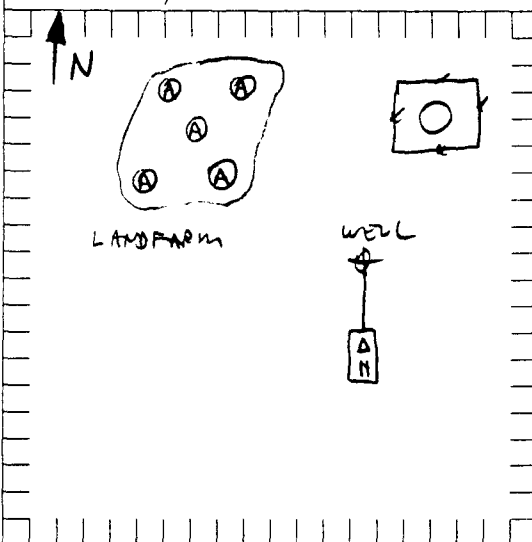

### OVM RESULTS

SAMPLE ID	FIELD HEADSPACE PID (ppm)
COMP. A	0

### LAB SAMPLES

SAMPLE ID	ANALYSIS	TIME	RESULTS
COMP. A	8015	0925	19.4

### SCALE

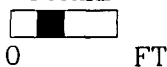

TRAVEL NOTES: CALLOUT: \_\_\_\_\_ ONSITE: 5-16-96 0920

**TOTAL VOLATILE PETROLEUM HYDROCARBONS**

**Gasoline Range Organics**

**Blagg Engineering, Inc.**

Project ID: Bolack B LS 5  
Sample Matrix: Soil  
Preservative: Cool  
Condition: Intact

Report Date: 06/05/96  
Date Sampled: 05/16/96  
Date Received: 05/16/96  
Date Extracted: 05/29/96  
Date Analyzed: 05/30/96

Sample ID	Lab ID	Concentration (mg/kg)	Detection Limit (mg/kg)
Comp. A	3620	ND	19.0

ND- Analyte not detected at the stated detection limit.

<b>Quality Control:</b>	<u>Surrogate</u>	<u>% Recovery</u>	<u>Acceptance Limits</u>
	Trifluorotoluene	85%	50 - 150%

**Reference:** Method for the Determination of Gasoline Range Organics,  
State of Tennessee, Department of Environment and Conservation, Division  
of Underground Storage Tanks.

**Comments:**

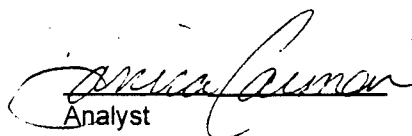
  
Analyst

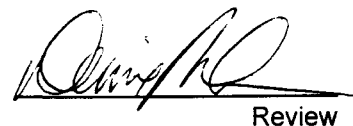
  
Review

## TOTAL RECOVERABLE PETROLEUM HYDROCARBONS

## Diesel Range Organics

**Blagg Engineering, Inc.**

Project ID: Bolack B LS 5  
Sample Matrix: Soil  
Preservative: Cool  
Condition: Intact

Report Date:	06/05/96
Date Sampled:	05/16/96
Date Received:	05/16/96
Date Extracted:	05/29/96
Date Analyzed:	05/30/96

Sample ID	Lab ID	Concentration (mg/kg)	Detection Limit (mg/kg)
Comp. A	3620	19.4	18.4

ND- Analyte not detected at the stated detection limit.

<b>Quality Control:</b>	<u>Surrogate</u>	<u>% Recovery</u>	<u>Acceptance Limits</u>
	o - Terphenyl	102%	50 - 150%

**Reference:** EPA Method 8015A, modified. "Nonhalogenated Volatile Organics by Gas Chromatography." Test Methods for Evaluating Solid Waste. Physical/Chemical Methods, SW-846, 3rd Ed, Final Update I, July, 1992. USEPA.

**Comments:**

*Tamara Palmer*  
Analyst

Review



UNITED STATES  
DEPARTMENT OF THE INTERIOR  
BUREAU OF LAND MANAGEMENT

FORM APPROVED  
Budget Bureau No. 1004-0135  
Expires: March 31, 1993

**SUNDRY NOTICES AND REPORTS ON WELLS**

Do not use this form for proposals to drill or to deepen or reentry to a different reservoir.  
Use "APPLICATION FOR PERMIT—" for such proposals

**SUBMIT IN TRIPLICATE**

1. Type of Well

☐ Oil Well ☒ Gas Well ☐ Other

2. Name of Operator

Amoco Production Company

3. Address and Telephone No.

200 Amoco Court, Farmington, N.M. 87401 Tel: (505) 326-9200

4. Location of Well (Footage, Sec., T., R., M., or Survey Description)

NW 1/4 SE 1/4, SEC. 33, T 28 N, R 8 W, NMPM  
1650' FSL / 1750' FEL

5. Lease Designation and Serial No.

NM - 012202

6. If Indian, Allottee or Tribe Name

7. If Unit or CA, Agreement Designation

8. Well Name and No.

BOLACK B LS 5

9. API Well No.

3004511712

10. Field and Pool, or Exploratory Area

PICTURE CLIFFS

11. County or Parish, State

SAN JUAN, NM

12. CHECK APPROPRIATE BOX(S) TO INDICATE NATURE OF NOTICE, REPORT, OR OTHER DATA

TYPE OF SUBMISSION

- ☐ Notice of Intent  
☒ Subsequent Report  
☐ Final Abandonment Notice

TYPE OF ACTION

- ☐ Abandonment  
☐ Recompletion  
☐ Plugging Back  
☐ Casing Repair  
☐ Altering Casing  
☒ Other Pit closure  
☐ Change of Plans  
☐ New Construction  
☐ Non-Routine Fracturing  
☐ Water Shut-Off  
☐ Conversion to Injection  
☐ Dispose Water

(Note: Report results of multiple completion on Well Completion or Recompletion Report and Log form.)

13. Describe Proposed or Completed Operations (Clearly state all pertinent details, and give pertinent dates, including estimated date of starting any proposed work. If well is directionally drilled, give subsurface locations and measured and true vertical depths for all markers and zones pertinent to this work.)\*

Pit closure verification - see attached documentation.

14. I hereby certify that the foregoing is true and correct

Signed

B. Shaw

Title

Enviro. Coordinator

Date

9/13/94

(This space for Federal or State office use)

Approved by

Conditions of approval, if any:

Title

Date

Title 18 U.S.C. Section 1001, makes it a crime for any person knowingly and willfully to make to any department or agency of the United States any false, fictitious or fraudulent statements or representations as to any matter within its jurisdiction.

\*See Instruction on Reverse Side