

AP - 007

APPROVALS

YEAR(S):

2007-1998

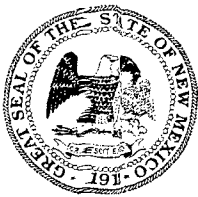

NEW MEXICO ENERGY, MINERALS and NATURAL RESOURCES DEPARTMENT

BILL RICHARDSON

Governor

Joan naPrukop

Cabinet Secretary

Mark E. Fesmire, P.E.

Director

Oil Conservation Division

February 20, 2007

Ms. Camille Reynolds
Plains Pipeline, L.P.
3112 W. Hwy 82
Lovington, NM 88260

RE: Darr Angell #4 Release Site
OCD FILE #AP-07
Request to Backfill Excavation
12 Miles Northeast of Lovington, New Mexico

Dear Ms. Reynolds:

The New Mexico Oil Conservation Division (OCD) has reviewed Plains Pipeline, L.P. requests to backfill the subject site excavation with a blend of bio-remediated and clean soil.

Plains Pipeline, L.P. had submitted a "Site Restoration Work Plan and Proposed Soil Closure Strategy (Work Plan)" in November of 2005. According to your request, on completion of the excavation activities, soil samples were collected from the sidewalls of the excavation and submitted to the laboratory for determination of total petroleum hydrocarbons (TPH). The laboratory analytical results indicated the sidewalls of the excavation were below NMOCD regulatory levels and the excavation activities ceased. The excavation was lined with a synthetic liner in accordance with the approved Work Plan. The stockpiled soil was placed in an onsite soil cell and to allowed to bioremediate. As proposed in the Work Plan, the soil within the soil cell was sampled periodically to determine the TPH levels within the soil cell. Analytical results indicated the soil within the cell was above NMOCD regulatory levels with respect to TPH. In the fall of 2006, approximately 500 cubic yards (cy) of non-impacted soil was transported to the site and blended with excavated soil contained in the soil cell. Fertilizer was added to the soil cell to augment the bioremediation of the hydrocarbon impacted soil. Accompanying your request was an analytical report, of which the results of soil samples collected in January 2007 indicated the TPH concentrations within the soil cell ranged from 54.1 to 216 mg/K TPH. In January 2006, discussions between Plains representatives and the landowner (Mr. Darr Angell) produced an agreement allowing Plains to place excavated soil as is, in the existing excavation and on top of the synthetic liner.

As the project has commenced as planned and pursuant to that plan and the concurrent approval of the landowner, your request to backfill the subject excavation is hereby approved.

NMOCD approval of this backfill proposal does not relieve Plains Pipeline, L.P. of liability should its operations at this site prove harmful to public health or the environment. Nor does it relieve Plains Petroleum, L.P. of its responsibility to comply with the rules and regulations of any other federal, state, county or local governmental agency. All other conditions of AP-07 will remain in full force and effect.

Allocation Plan-07
Request to Backfill Excavation
Plains Pipeline, L.P.
February 20, 2007
Page 2

NEW MEXICO OIL CONSERVATION DIVISION

A handwritten signature in black ink, appearing to read "Ben Stone", written over the printed name.

Ben Stone
Environmental Bureau

Cc: NMOCD Hobbs



NEW MEXICO ENERGY, MINERALS and NATURAL RESOURCES DEPARTMENT

BILL RICHARDSON

Governor

Joanna Prukop

Cabinet Secretary

Mark E. Fesmire, P.E.

Director

Oil Conservation Division

April 5, 2006

Ms. Camille Reynolds
Plains Pipeline
3112 West Highway 82
Lovington, NM 88260

RE: 1. 2005 Annual Monitoring Report and
2. Site Restoration Work Plan and Proposed Soil Closure Strategy Report
Both Being for the Darr Angell No. 2 Release Site Located in the
SW/4 SE/4 of Section 11, Township 15 South, Range 37 East and
NW/4 NE/4 of Section 14, Township 15 South, Range 37 East
Lea County, New Mexico
Plains EMS No. LF-1999-62
NMOCD File Number AP-007

Dear Ms. Reynolds:

The New Mexico Oil Conservation Division has received and reviewed the above two reports submitted on behalf of Plains Pipeline (Plains) by NOVA Safety and Environmental. These reports are hereby accepted and approved with the following understandings and conditions:

1. In reference to report #1 above, quarterly monitoring and sampling will continue at the site throughout 2006. Results of these activities will be reported to the NMOCD in the 2006 Annual Report, due in this office by April 1, 2007.
2. In reference to report #2 above:
 - a. Backfilling of the excavation is approved per the description of activities shown under the heading "Soil Closure Strategy" in the report.
 - b. Plains will submit a Soil Closure Report to the NMOCD documenting the final closure as to soil issues at the site.
 - c. Upon receipt and review of this Soil Closure Report, NMOCD will either approve or disapprove soil closure at this site, with the understanding that groundwater issues still exist and must be addressed separately.

Darr Angell #2
AP-009
April 5, 2006
Page 2 of 2

NMOCD approval of these reports does not relieve Plains of liability should its operations at this site prove to have been harmful to public health or the environment. Nor does it relieve Plains of its responsibility to comply with the rules and regulations of any other governmental agency.

If you have any questions, contact me at (505) 476-3492 or ed.martin@state.nm.us

NEW MEXICO OIL CONSERVATION DIVISION

A handwritten signature in black ink, appearing to read "Ed Martin".

Edwin E. Martin
Environmental Bureau

Copy: NMOCD, Hobbs
Curt Stanley, NOVA



NEW MEXICO ENERGY, MINERALS and NATURAL RESOURCES DEPARTMENT

BILL RICHARDSON

Governor

Joanna Prukop

Cabinet Secretary

January 27, 2005

Mark E. Fesmire, P.E.

Director

Oil Conservation Division

Ms. Camille Reynolds
Plains Marketing, L.P.
3514 Lovington Hwy.
Hobbs, NM 88240

Dear Ms. Reynolds:

The New Mexico Oil Conservation Division (NMOCD) has received the "Plains All American Enhanced Product Recovery Work Plan", dated October 27, 2004, for the Darr Angell #1 Release Site (NMOCD reference AP-007). This work plan is approved with the following conditions:

1. Any tank receiving liquids from the total fluid pumps being added to the recovery system must be equipped with an automatic shut-off device to prevent overflow.
2. It is understood by the NMOCD that the tanks receiving liquids will be bermed as stated in the work plan. Be advised that this is mandatory.
3. The oversight of the operation by Nova Safety and Environmental personnel, as stated in the work plan, will be followed consistently and for the duration of the project. That is, visits are to take place on Mondays, Wednesdays and Fridays. The NMOCD must be notified if this visitation frequency is modified.
4. After the extracted crude oil is injected into the Plains pipeline system, the water must be disposed of at an NMOCD-approved facility.

Be advised that NMOCD approval of this work plan does not relieve Plains Marketing, L.P. or Plains All American of liability should their operations at this site prove harmful to the environment or public health. Nor does it relieve them of their responsibility to comply with the rules and regulations of any other governmental agency.

If you have any questions, contact me at 505-476-3492 or emartin@state.nm.us

NEW MEXICO OIL CONSERVATION DIVISION

Edwin E. Martin
Environmental Engineer

Cc: Chris Williams, NMOCD Hobbs



NEW MEXICO ENERGY, MINERALS and NATURAL RESOURCES DEPARTMENT

BILL RICHARDSON

Governor

Joanna Prukop

Cabinet Secretary

Mark E. Fesmire, P.E.

Director

Oil Conservation Division

October 14, 2004

Mr. Jeffrey P. Dann
Plains All American L.P.
P.O. Box 4648
Houston, TX 77210-4648

DARR ANGELL #1
AP-7

Dear Mr. Dann:

The New Mexico Oil Conservation Division (NMOCD) has received your letter, dated September 20, 2004, identifying the need for additional groundwater monitor and/or recovery wells at various sites. This request is hereby approved.

This approval does not relieve Plains Marketing, L.P. of any future liability at these sites should it prove that Plains' operations have caused harm to public health or the environment. Nor does it relieve Plains of its obligation to comply with the rules and regulations of any other governmental agency.

If you have any questions, contact me at (505) 476-3492 or emartin@state.nm.us

NEW MEXICO OIL CONSERVATION DIVISION

Edwin E. Martin
Environmental Bureau

Cc: Larry Johnson, NMOCD, Hobbs
Camille Reynolds, Plains, Midland

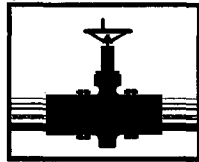

PLAINS

MARKETING, L.P.

September 20, 2004

Mr. Ed Martin
New Mexico Oil Conservation Division
Environmental Bureau
1220 South St. Francis Drive
Santa Fe, New Mexico 87505

Re: Plains Marketing, L.P. (formerly Link Energy) Remediation Sites
Various Locations in Lea County

Dear Mr. Martin:

Based on the results of our ongoing groundwater monitoring and sampling program at several of our remediation and groundwater monitoring sites in Lea County, we have identified the need for additional groundwater monitor and/or recovery wells at the flowing sites.

Site Name	Plains EMS No.	Site Location	Number of Wells
Jct 34 to Lea	2002-10286	Section 21, T20S, R37E	3
Livingston Line-Bob McCasland	2001-11043	Section 3, T21S, R37E	2
Hugh Gathering	2002-10235	Section 11, T21S, R37E	1
C. S. Cayler	2002-10250	Section 6, T17S, R37E	5
Lovington Deep 6-Inch	2002-1-312	Section 6, T21S, R36E	6
Kimbrough Sweet	2000-10757	Section 3, T18S, R37E	2
8" Moore to Jal #1	2002-10270	Section 16, T17S, R37E	3
8" Moore to Jal #2	2002-10273	Section 16, T17S, R37E	3
Darr Angell #1	Darr Angell #1	Section 11, T15S, R37E	1
Darr Angell #4	2001-10876	Section 2/11, T15S, R37E	2
Red Byrd #1	Red Byrd #1	Section 1, T19S, R36E	5
HDO 90-23	HDO 90-23	Section 6, T20S, R37E	2
Monument 6" Pipeline	2001-11056	Section 5, T20S, R37E	3
Texaco Skelly F	2002-11229	Section 21, T20S, R37E	1
SPS-11	SPS-11	Section 18, T18S, R36E	2
Monument #11	TNM Mon #11	Section 30, T19S, R37E	2
Monument #2	TNM Mon #2	Section 6, T20S, R37E	1
Monument #17	TNM Mon #17	Section 29, T19S, R37E	1
Monument #18	TNM Mon #18	Section 7, T20S, R37E	2
98-05A	TNM 98-05A	Section 26, T21S, R37E	1
LF-59	LF-59	Section 32, T19S, R37E	2

The proposed well locations are illustrated on the attached site maps. Plains requests your approval of the proposed monitor well locations at the above-referenced sites. We anticipate commencement of drilling activities the week of October 4, 2004.

Should you have any questions or comments concerning this information, please contact me at (713) 646-4657.

Sincerely,

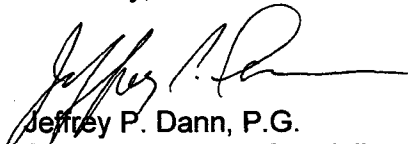

Jeffrey P. Dann, P.G.
Sr. Environmental Specialist
Plains All American

CC: Larry Johnson, NMOCD, Hobbs, NM
Camille Reynolds, Plains
Todd Choban, Nova
Pat McCasland, EPI

File: c:\jeff-files\OCD-DrillingSchOct2004

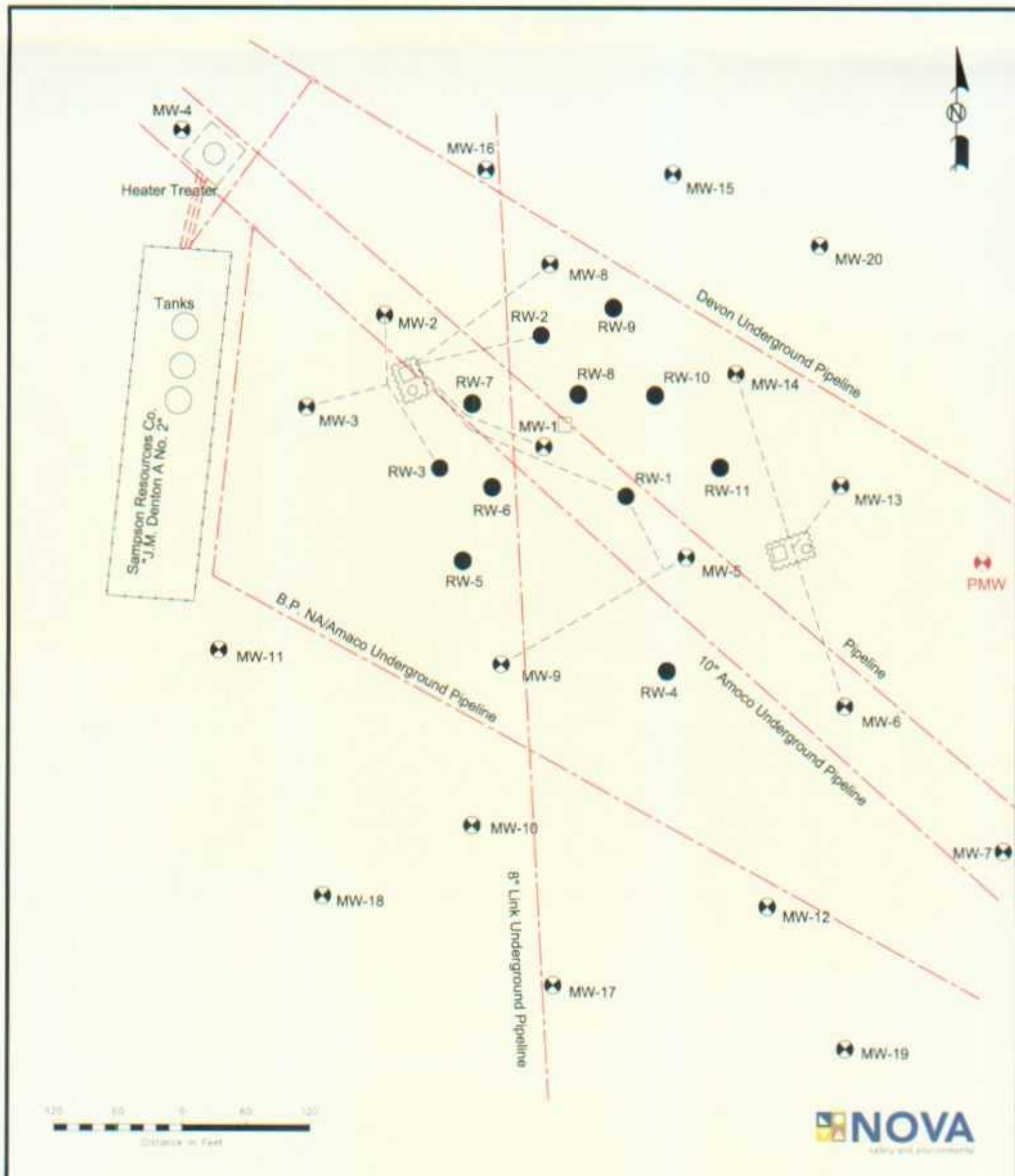
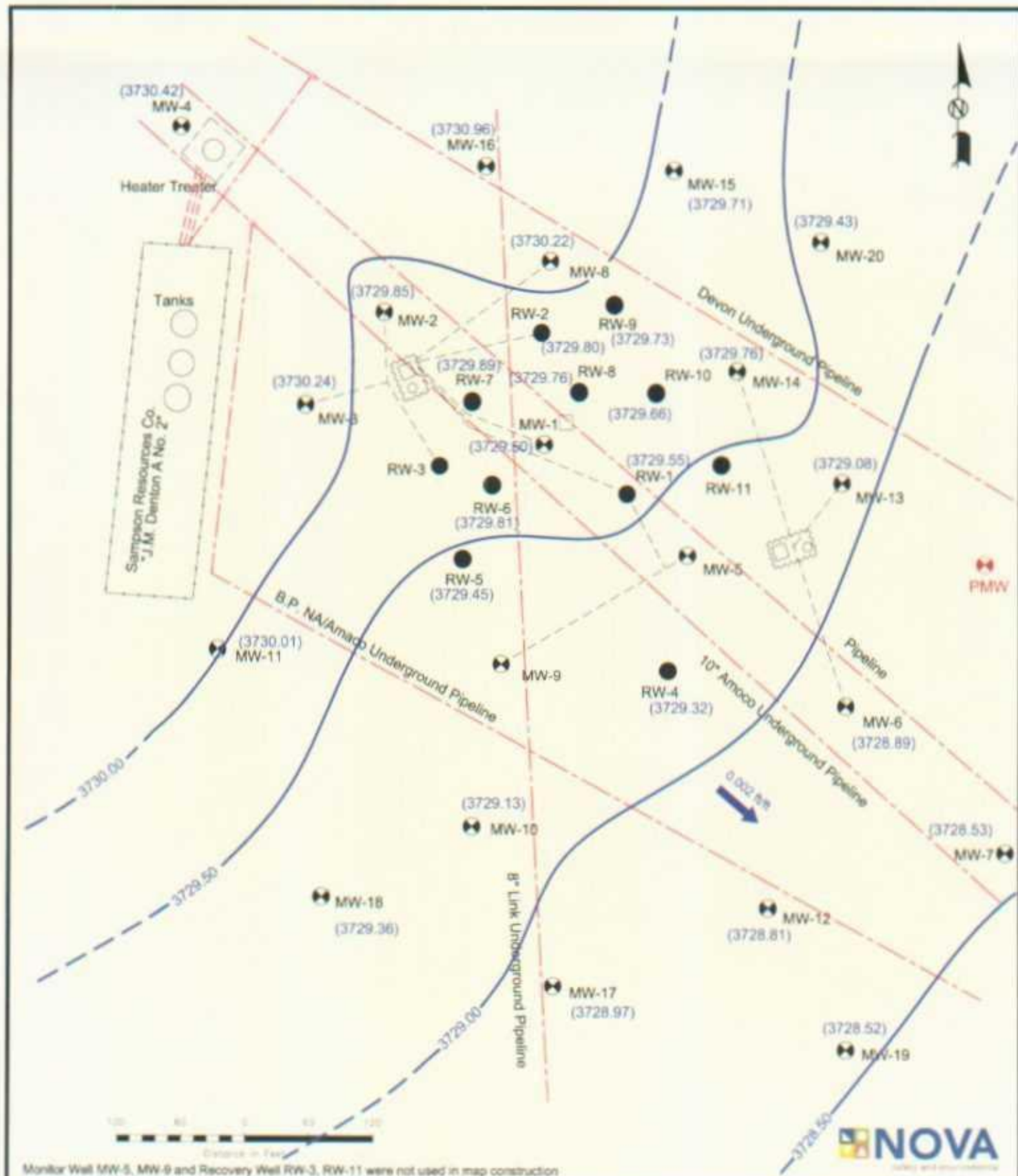

Figure 2
Site Map

Plains Pipeline, L.P.
Darr Angell #1
Lea County, NM

NOVA Safety and Environmental

NW1/4 SE1/4 Sec 11 T15S R37E	33° 01' 36.0"N 103° 10' 00.7"W
Scale: 1"=120'	Prep By: CS
September 2, 2004	Checked By: TKC



<p>LEGEND</p> <p>Monitoring Well Location</p> <p>Recovery Well Location</p> <p>Product/Recovery Line</p> <p>Shed</p> <p>Poly Tank</p> <p>Groundwater Gradient Direction and Magnitude</p> <p>Groundwater Elevation Contour Line (Feet)</p> <p>Bermed Containment Area</p>	<p>Proposed Monitor Well</p> <p>PMW</p>
---	---

Figure 2D
Inferred Groundwater
Gradient Map (12-09-03)

Plains Pipeline, L.P.
Darr Angell #1
Lea County, NM

NOVA Safety and Environmental		
NW1/4 SE1/4 Sec 11 T15S R37E	33° 01' 36.0"N 103° 10' 00.7"W	
Scale: 1"=120'	Prep By: CS	Checked By: TKC
March 30, 2004		



NEW MEXICO ENERGY, MINERALS and NATURAL RESOURCES DEPARTMENT

BILL RICHARDSON

Governor

Joanna Prukop

Cabinet Secretary

Mark E. Fesmire, P.E.

Director

Oil Conservation Division

October 14, 2004

Mr. Jeffrey P. Dann
Plains All American L.P.
P.O. Box 4648
Houston, TX 77210-4648

*DARR ANGLE #4
AP-7*

Dear Mr. Dann:

The New Mexico Oil Conservation Division (NMOCD) has received your letter, dated September 20, 2004, identifying the need for additional groundwater monitor and/or recovery wells at various sites. This request is hereby approved.

This approval does not relieve Plains Marketing, L.P. of any future liability at these sites should it prove that Plains' operations have caused harm to public health or the environment. Nor does it relieve Plains of its obligation to comply with the rules and regulations of any other governmental agency.

If you have any questions, contact me at (505) 476-3492 or emartin@state.nm.us

NEW MEXICO OIL CONSERVATION DIVISION

Edwin E. Martin
Environmental Bureau

Cc: Larry Johnson, NMOCD, Hobbs
Camille Reynolds, Plains, Midland

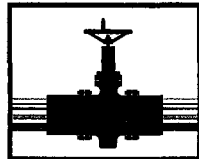

PLAINS
MARKETING, L.P.

September 20, 2004

Mr. Ed Martin
New Mexico Oil Conservation Division
Environmental Bureau
1220 South St. Francis Drive
Santa Fe, New Mexico 87505

Re: Plains Marketing, L.P. (formerly Link Energy) Remediation Sites
Various Locations in Lea County

Dear Mr. Martin:

Based on the results of our ongoing groundwater monitoring and sampling program at several of our remediation and groundwater monitoring sites in Lea County, we have identified the need for additional groundwater monitor and/or recovery wells at the flowing sites.

Site Name	Plains EMS No.	Site Location	Number of Wells
Jct 34 to Lea	2002-10286	Section 21, T20S, R37E	3
Livingston Line-Bob McCasland	2001-11043	Section 3, T21S, R37E	2
Hugh Gathering	2002-10235	Section 11, T21S, R37E	1
C. S. Caylor	2002-10250	Section 6, T17S, R37E	5
Lovington Deep 6-Inch	2002-1-312	Section 6, T21S, R36E	6
Kimbrough Sweet	2000-10757	Section 3, T18S, R37E	2
8" Moore to Jal #1	2002-10270	Section 16, T17S, R37E	3
8" Moore to Jal #2	2002-10273	Section 16, T17S, R37E	3
Darr Angell #1	Darr Angell #1	Section 11, T15S, R37E	1
Darr Angell #4	2001-10876	Section 2/11, T15S, R37E	2
Red Byrd #1	Red Byrd #1	Section 1, T19S, R36E	5
HDO 90-23	HDO 90-23	Section 6, T20S, R37E	2
Monument 6" Pipeline	2001-11056	Section 5, T20S, R37E	3
Texaco Skelly F	2002-11229	Section 21, T20S, R37E	1
SPS-11	SPS-11	Section 18, T18S, R36E	2
Monument #11	TNM Mon #11	Section 30, T19S, R37E	2
Monument #2	TNM Mon #2	Section 6, T20S, R37E	1
Monument #17	TNM Mon #17	Section 29, T19S, R37E	1
Monument #18	TNM Mon #18	Section 7, T20S, R37E	2
98-05A	TNM 98-05A	Section 26, T21S, R37E	1
LF-59	LF-59	Section 32, T19S, R37E	2

The proposed well locations are illustrated on the attached site maps. Plains requests your approval of the proposed monitor well locations at the above-referenced sites. We anticipate commencement of drilling activities the week of October 4, 2004.

Should you have any questions or comments concerning this information, please contact me at (713) 646-4657.

Sincerely,

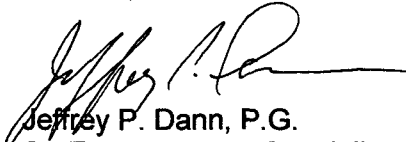

Jeffrey P. Dann, P.G.
Sr. Environmental Specialist
Plains All American

CC: Larry Johnson, NMOCD, Hobbs, NM
Camille Reynolds, Plains
Todd Choban, Nova
Pat McCasland, EPI

File: c:\jeff-files\OCD-DrillingSchOct2004

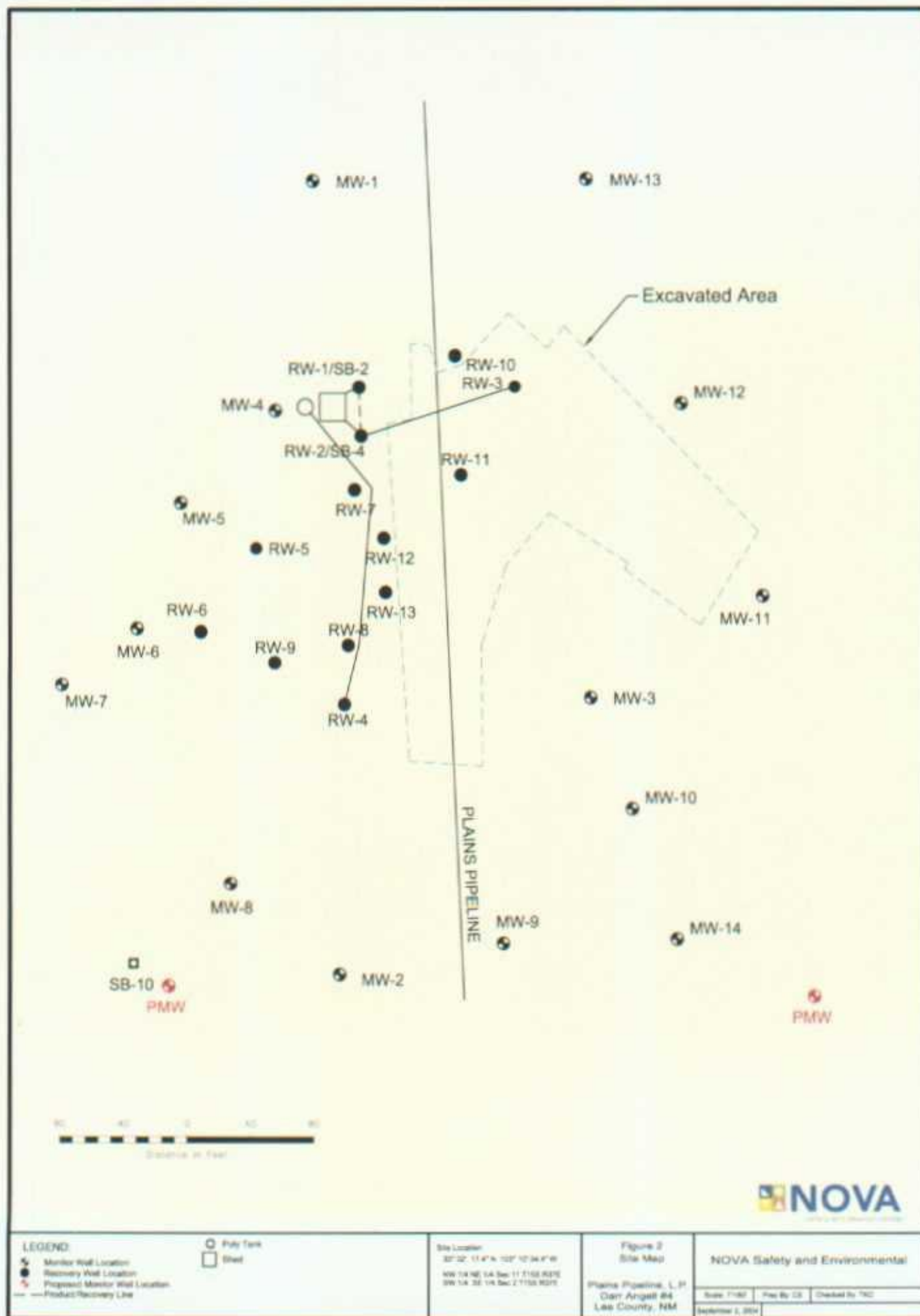

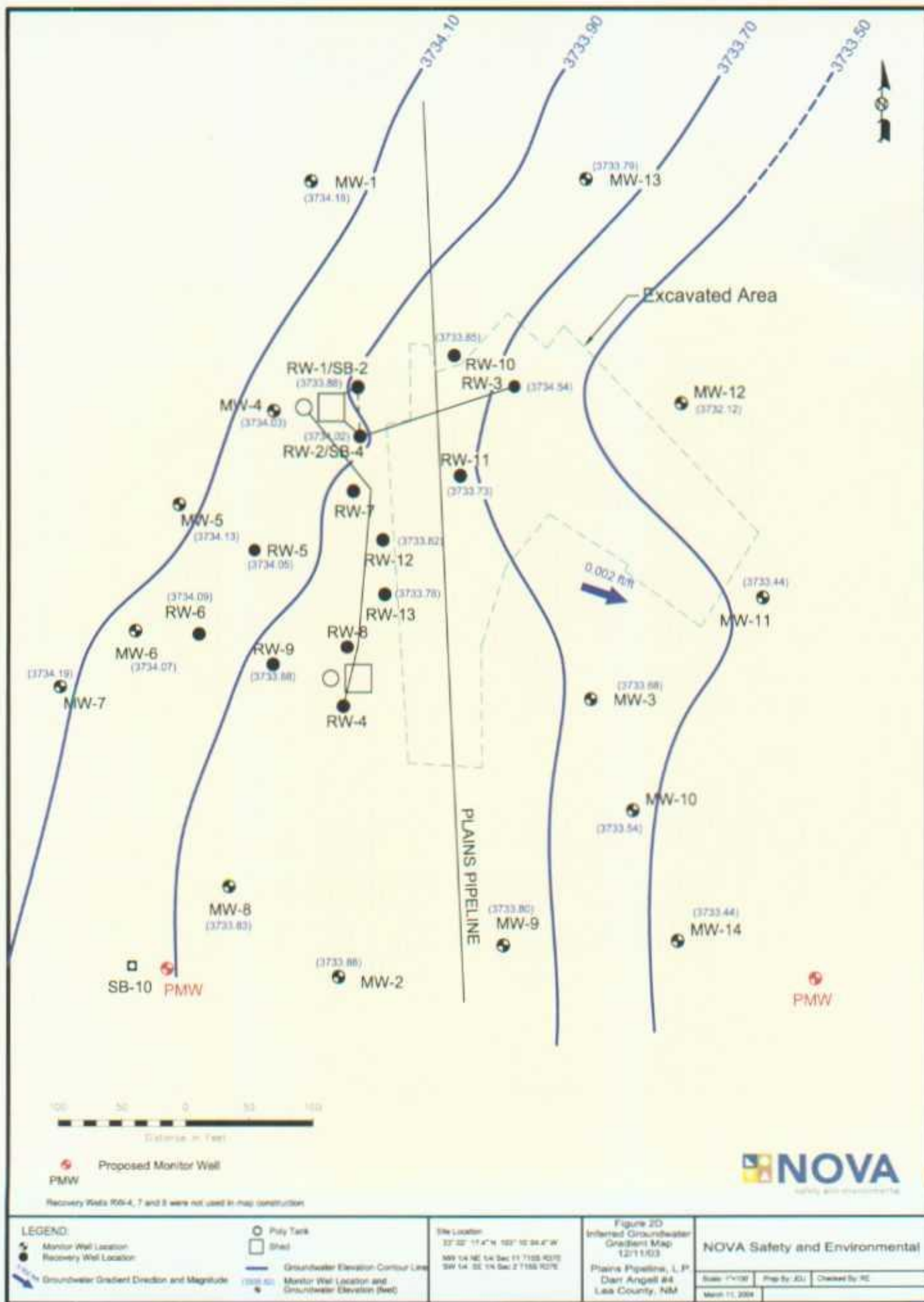



STATE OF NEW MEXICO
ENERGY, MINERALS AND NATURAL RESOURCES DEPARTMENT

OIL CONSERVATION DIVISION
2040 S. PACHECO
SANTA FE, NEW MEXICO 87505
(505) 827-7131

July 20, 1999

CERTIFIED MAIL
RETURN RECEIPT NO: Z-274-520-682

Ms. Lennah Frost
EOTT Energy Pipeline Limited Partnership
P.O. Box 1660
Midland, Texas 79702

**RE: STAGE 1 GROUND WATER ABATEMENT PLAN (AP-7)
DARR ANGEL RANCH**

Dear Ms. Frost:

The New Mexico Oil Conservation Division (OCD) has completed a review of the following EOTT Energy Pipeline Limited Partnership (EOTT) documents:

- June 9, 1999 "STAGE 1 GROUNDWATER ABATEMENT PLAN (AP-7), DARR ANGELL RANCH".
- April 20, 1999 "DENTON GATHERING AREA LEAKSITE - DARR ANGEL RANCH, SEC 11, T-15-S, R-37-E, LEA COUNTY, NEW MEXICO".
- February 23, 1999 "DENTON GATHERING AREA LEAKSITE - DARR ANGEL RANCH, SEC 11, T-15-S, R-37-E, LEA COUNTY, NEW MEXICO".

These documents contain EOTT's Stage 1 Investigation Proposal for determining the extent of soil and ground water contamination resulting from a crude oil spill at EOTT's Darr Angel Ranch leak site including interim recovery of free phase product from the ground water. The documents also contain proof of public notification of the Stage 1 Investigation Proposal.

The OCD has not received any response to the public notification of the Stage 1 Investigation Proposal. The above referenced Stage 1 Investigation Proposal is **approved** with the following conditions:

1. EOTT shall install an additional monitor well at the location shown on figure 5 (attached).

2. EOTT shall complete all monitor wells as follows:
 - a. At least 15 feet of well screen shall be placed across the water table interface with 5 feet of the well screen above the water table and 10 feet of the well screen below the water table.
 - b. An appropriately sized gravel pack shall be set in the annulus around the well screen from the bottom of the hole to 2-3 feet above the top of the well screen.
 - c. A 2-3 foot bentonite plug shall be placed above the gravel pack.
 - d. The remainder of the hole shall be grouted to the surface with cement containing 3-5% bentonite.
 - e. A concrete pad and locking well cover shall be placed around the well at the surface.
 - f. The well shall be developed after construction using EPA approved procedures.
3. No less than 48 hours after the wells are developed, ground water from all monitor wells shall be purged, sampled and analyzed for concentrations of benzene, toluene, ethylbenzene, xylene, polycyclic aromatic hydrocarbons (PAH) and New Mexico Water Quality Control Commission (WQCC) metals using EPA approved methods and quality assurance/quality control (QA/QC) procedures.
4. All below grade lines used for conveying fluids from recovery wells to the above ground storage tank shall be pressure tested to 3 psi above operating pressure prior to operation.
5. All wastes generated shall be disposed of at an OCD approved facility.
6. EOTT shall submit the results of the Stage 1 investigation to the OCD in a comprehensive report. The report shall be submitted to the OCD Santa Fe Office by September 20, 1999 with a copy provided to the OCD Hobbs District Office and shall include:
 - a. A description of all investigation, remediation and monitoring activities which have occurred including conclusions and recommendations.
 - b. A geologic/lithologic log and well completion diagram for each monitor well.
 - c. A water table potentiometric map showing the location of the spills, excavated areas, monitor wells, and any other pertinent site features as well as the direction and magnitude of the hydraulic gradient.
 - d. Isopleth maps for contaminants of concern which were observed during the investigations.
 - e. A free product thickness map.

- f. Summary tables of all soil ground water quality sampling results and copies of all recent laboratory analytical data sheets and associated QA/QC data taken within the past year.
 - g. The disposition of all wastes generated.
 - h. The results of any below grade line testing.
7. EOTT shall notify the OCD at least 24 hours in advance of all scheduled activities such that the OCD has the opportunity to witness the events and split samples.

Please be advised that OCD approval does not limit EOTT to the proposed work plan should the investigation actions fail to adequately define the extent of contamination related to EOTT's activities, or if contamination exists which is outside the scope of the work plan. In addition, OCD approval does not relieve EOTT of responsibility for compliance with any other federal, state or local laws and regulations.

If you have any questions or comments, please contact Bill Olson of my staff at (505) 827-7154 .

Sincerely,



Roger C. Anderson
Environmental Bureau Chief

attachment

xc/w attachment: Chris Williams, OCD Hobbs District Office

Z 274 520 682

US Postal Service

Receipt for Certified Mail

No Insurance Coverage Provided.

Do not use for International Mail (*See reverse*)

Sent to	
Street & Number	
Post Office, State, & ZIP Code	
Postage	\$
Certified Fee	\$
Special Delivery Fee	
Restricted Delivery Fee	
Return Receipt Showing to Whom & Date Delivered	
Return Receipt Showing to Whom, Date, & Addressee's Address	
TOTAL Postage & Fees	\$
Postmark or Date	

PS Form 3800, April 1995

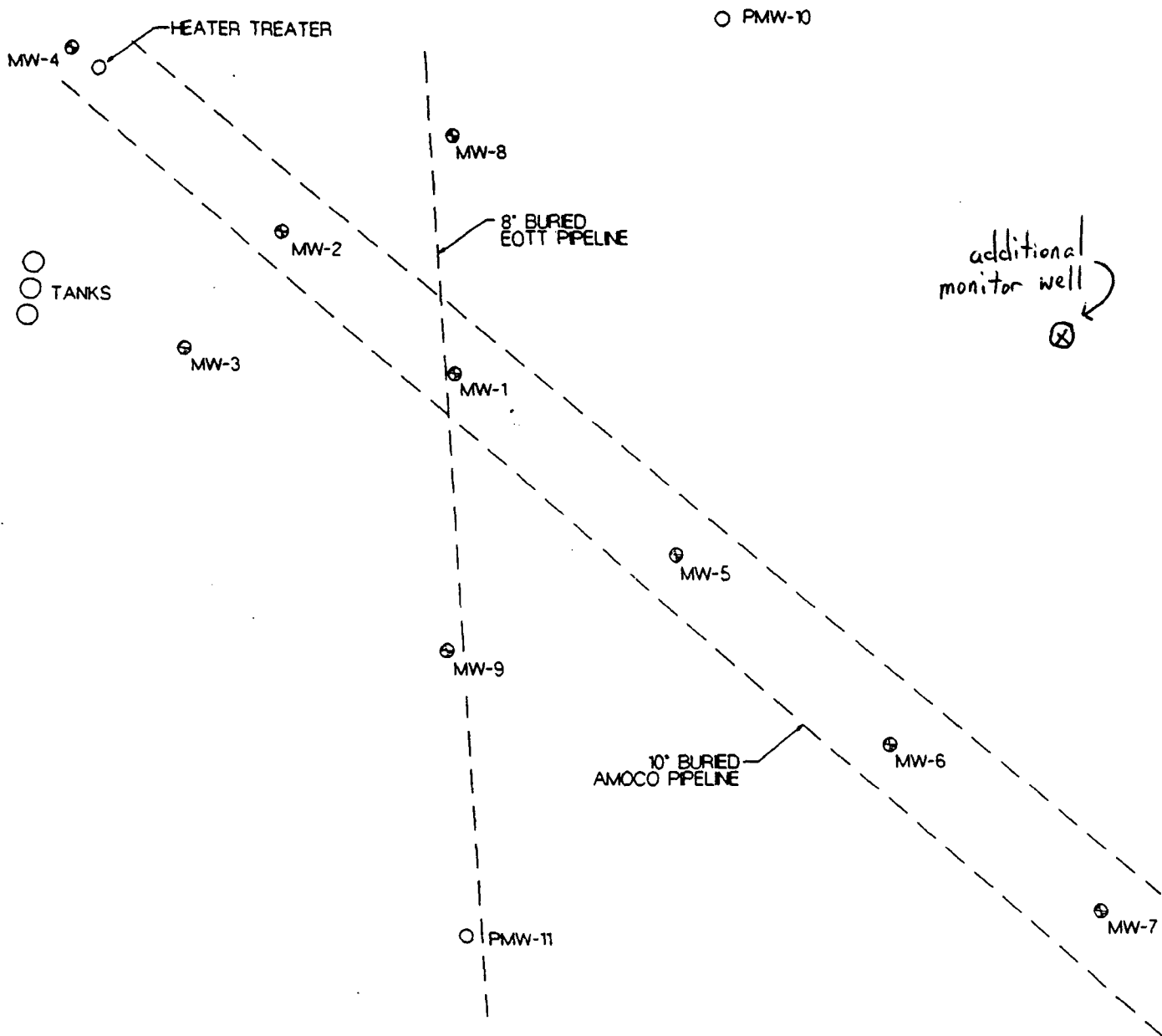

LEGEND

- ⊕ MW-1 APPROXIMATE MONITORING WELL LOCATION AND NUMBER
- PMW PROPOSED MONITOR WELL LOCATIONS

0 120
FEET



BY: **DESIGN SERVICES**
1202 CO RD. 114 W
MIDLAND, TEXAS 79706
OFFICE: 1915170-7733
PAGER: 1915167-3429

TITLE:
PROPOSED MONITORING WELL
LOCATION MAP
LOVINGTON, NEW MEXICO

DWN:
CHKD:
DATE: 2-9-99

DES:
APPD:
REV:

PROJECT NO: 18861
EOTT ENERGY CORP.
LOVINGTON, NM.

FIGURE 5



NEW MEXICO ENERGY, MINERALS
& NATURAL RESOURCES DEPARTMENT

OIL CONSERVATION DIVISION
2040 South Pacheco Street
Santa Fe, New Mexico 87505
(505) 827-7131

October 30, 1998

CERTIFIED MAIL
RETURN RECEIPT NO. Z-274-520-576

Ms. Lennah Frost
EOTT Energy Pipeline Limited Partnership
P.O. Box 1660
Midland, Texas 79702

**RE: DARR ANGEL RANCH LEAK SITE
ABATEMENT PLAN AP-7**

Dear Ms. Frost:

The New Mexico Oil Conservation Division (OCD) has reviewed EOTT Energy Pipeline Limited Partnership's (EOTT) October 2, 1998 "DENTON GATHERING AREA LEAKSITE - DARR ANGEL RANCH, SEC 11, T-15-S, R-37-E, LEA COUNTY, NEW MEXICO". This document contains a request for an extension of the deadline for filing a Stage 1 Abatement Plan for ground water contamination resulting from a crude oil pipeline spill from EOTT's Denton Gathering Line on the Darr Angel Ranch. The extension is requested while EOTT conducts additional investigations at the site.

The above referenced request is approved. EOTT will submit to the OCD by November 30, 1998 a Stage 1 abatement plan investigation proposal pursuant to OCD Rule 19.E.1. and OCD Rule 19.E.3. Please be aware that EOTT's Stage 1 abatement plan proposal to be submitted for OCD approval covers all aspects of site investigation including submission of a final investigation report. The investigation actions currently being undertaken by EOTT are not approved by the OCD. Therefore, if these investigation actions are not satisfactory they will need to be redone.

If you have any questions, please contact Bill Olson of my staff at (505) 827-7154.

Sincerely,

Roger C. Anderson
Environmental Bureau Chief

xc: Chris Williams, OCD Hobbs District Supervisor

Z 274 520 576

US Postal Service
Receipt for Certified Mail
No Insurance Coverage Provided.
Do not use for International Mail (*See reverse*)

Sent to	
Street & Number	
Post Office, State, & ZIP Code	
Postage	\$
Certified Fee	
Special Delivery Fee	
Restricted Delivery Fee	
Return Receipt Showing to Whom & Date Delivered	
Return Receipt Showing to Whom, Date, & Addressee's Address	
TOTAL Postage & Fees	\$
Postmark or Date	

PS Form 3800, April 1995