

AP - 020

**STAGE 1 & 2
WORKPLANS**

DATE:

Nov. 19, 2001

OIL CONSERVATION DIV.
01 NOV 26 PM 3:44

November 19, 2001

NMOCD Environmental Bureau
ATTN: Mr. William C. Olson
P.O. Box 6429
1220 S. Saint Francis Drive
Santa Fe, NM 87504

RE: MNA Enterprise Ltd.
Abatement Plan AP-20
W.F. Hanagan SWD Line

Mr. Olson:

Pursuant to your letter dated 11.2.2001, MNA is submitting an abatement plan for your review and approval. We appreciate your time in this matter and will proceed with the investigation upon your approval.

If you have any questions or need additional information, please call.

Sincerely,

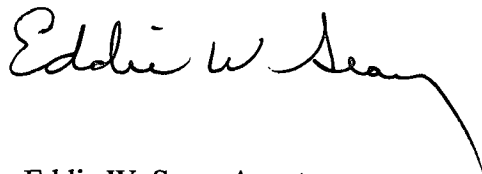

Eddie W. Seay, Agent
601 W. Illinois
Hobbs, NM 88242
(505)392-2236

ABATEMENT PLAN

The site is a leak on a 2" SWD line located in the SE/4 of SW/4 of Section 12, Township 25, Range 36 E. Hanagan lease, NW of Jal, NM.

The investigation will consist of the following:

- 1) Research and review all available geological and hydrology data within the area.
- 2) MNA plan to acquire the service of a drilling machine to core and collect soil and water samples. Soil samples will be taken on five foot intervals until we reach the shallow groundwater at approximately twenty-one feet.

Soil samples will be obtained using a split spoon sampling tool. Samples will be analyzed for BTEX, TPH, Cations, Anions and Bromide.

Water samples will be obtained after drilling into the water formation by using a 1 1/2 in. disposable bailer. The samples will be analyzed for BTEX, TPH, Cations, Anions and Bromide.

MNA plan to do at least two borings at the site and maybe more depending on the field screening results. One boring will be near Eott's GP9 site where they identified groundwater contamination and another upgradient to the pipeline leaks for background confirmation. The results of these borings will determine additional sampling sites.

- 3) All safety and sampling procedures will be followed during this investigation.
- 4) The OCD will be notified of all field activities so they may witness and/or split samples.
- 5) Prior to any field activities, the landowner, Mr. Osborn, will be notified for permission and his witness, if he desires.
- 6) All results of testing and investigation will be sent to the OCD.

Please let us know if there is any corrections or additions to this plan.

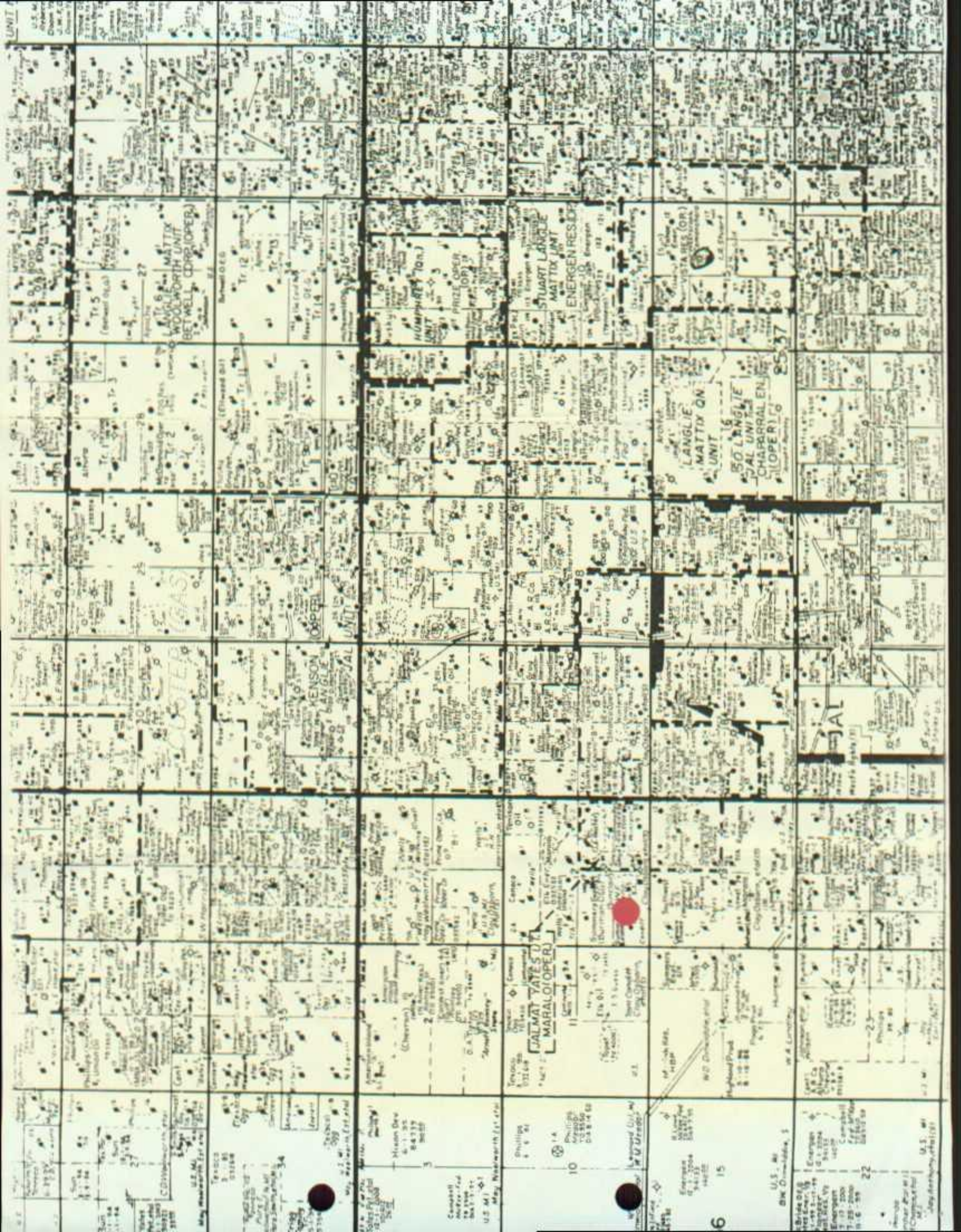

New Mexico Office of the State Engineer
Well Reports and Downloads

Township: Range: Sections:

NAD27 X: Y: Zone: Search Radius:

County: Basin: Number: Suffix:

Owner Name: (First) (Last) ☐ Non-Domestic ☐ Domestic ☒ All

Well / Surface Data Report

Avg Depth to Water Report

Water Column Report

Clear Form

WATERS Menu

Help

AVERAGE DEPTH OF WATER REPORT 11/14/2001

Bsn	Tws	Rng	Sec	Zone	X	Y	Wells	(Depth Water in Feet)		
								Min	Max	Avg

No Records found, try again

