

NSP

11/2/98

DOYLE HARTMAN

Oil Operator

3811 TURTLE CREEK BLVD., SUITE 200
DALLAS, TEXAS 75219

(214) 520-1800

(214) 520-0811 FAX

October 7, 1997

13

New Mexico Oil Conservation Division
2040 S. Pacheco
Santa Fe, New Mexico 87505

Attn: Mr. Michael Stogner, Chief Hearing Officer

Re: Administrative Application for a 155.78-acre Non-standard Jalmat P.U.
R.W. Cowden "B" No. 4 Well
W/2 SW/4, SE/4 SW/4, SW/4 SE/4
Section 30, T-23-S, R-37-E
Lea County, New Mexico
(155.78 acres)

Dear Mr. Stogner:

Doyle Hartman, Oil Operator is currently in the process of filing a C-101 for the drilling of the R.W. Cowden "B" No. 4 replacement Jalmat gas well, to be situated at a standard Jalmat gas well location consisting of 1650' FSL and 660' FWL Section 30, T-23-S, R-37-E. Therefore, we hereby respectfully request approval for an expanded 155.78-acre non-standard Jalmat proration unit consisting of the W/2 SW/4, SE/4 SW/4, and SW/4 SE/4 Section 30, T-23-S, R-37-E, with the newly drilled Cowden "B" No. 4 well to be the sole producer dedicated to the expanded 155.78-acre R. W. Cowden "B" Jalmat proration unit.

The additional 80 acres consisting of the SE/4 SW/4 and SW/4 SE/4 Section 30, that are to be combined with the present 75.78-acre Cowden "B" Jalmat proration unit consisting of the W/2 SW/4 Section 30, are currently non-producing and non-dedicated, but were previously a part of the 120-acre R.W. Cowden "A" WN No. 1 Jalmat proration unit comprised of the S/2 SE/4 and SE/4 SW/4 Section 30, T-23-S, R-37-E. Effective January 1, 1995, 100% of the ownership of the R. W. Cowden "A" WN No. 1 wellbore (P-30-23S-37E), along with Jalmat leasehold rights corresponding to the E/2 SE/4 Section 30, T-23-S, R-37-E, were assigned, by Doyle and Margaret Hartman, to the Clay Group, with Roca Production, Inc. being designated as operator, on behalf of the Clay Group, of the R.W. Cowden "A" WN No. 1 Jalmat well (C-104 dated 2/1/95 enclosed herewith). However, since January 1, 1995, Doyle Hartman, Oil Operator has retained 100% of the leasehold ownership as to the severed and non-producing non-dedicated 80-acre portion of the former 120-acre R.W. Cowden "A" WN No. 1 proration unit.

New Mexico Oil Conservation Division
October 7, 1998
Page 2

Approval of the proposed 155.78-acre R.W. Cowden "B" No. 4 Jalmat proration unit will facilitate the efficient and effective recovery of any remaining recoverable Jalmat reserves underlying the proposed 155.78-acre proration unit, which reserves are not currently recoverable by the marginal R.W. Cowden "B" No. 1 well (production history enclosed). Approval of this application will also minimize any drilling risks associated with further Jalmat development and will also prevent economic waste, while protecting correlative rights, by eliminating the need for drilling a second well on the presently non-producing non- dedicated 80 acres consisting of the SE/4 SW/4 and SW/4 SE/4 Section 30.

Notice of this administrative non-standard proration unit application is being concurrently sent by certified mail to all offsetting Jalmat operators, which operators are listed on the ownership tabulation enclosed herewith.

Very truly yours,

DOYLE HARTMAN, OIL OPERATOR

A handwritten signature in black ink, appearing to read "Doyle Hartman", with a long horizontal stroke extending to the right.

Doyle Hartman

/ao
Enclosures

cc:

Lori Wrotenbery, Director
New Mexico Oil Conservation Division
2040 S. Pacheco
Santa Fe, NM 87505

Chris Williams, Supervisor
NMOCD, District I
P.O. Box 1980
Hobbs, NM 88241

New Mexico Oil Conservation Division
October 7, 1998
Page 3

VIA CERTIFIED MAIL No. Z 034 697 180
RETURN RECEIPT REQUESTED

Richard P. Frazier, President
Gruy Petroleum Management Company
600 E. Las Colinas Boulevard, Suite 1200
Irving, Texas 75039

VIA CERTIFIED MAIL No. Z 034 697 181
RETURN RECEIPT REQUESTED

John E. Lodge, Manager, Land Department
ARCO Permian
600 N. Marienfeld
Midland, TX 79702

VIA CERTIFIED MAIL No. Z 034 697 182
RETURN RECEIPT REQUESTED

James C. Brown
Roca Production, Inc.
550 W. Texas, Suite 1255
Midland, TX 79701

VIA CERTIFIED MAIL No. Z 034 697 183
RETURN RECEIPT REQUESTED

Mr. Ted Collins
Collins & Ware, Inc.
508 W. Wall Avenue, Suite 1200
Midland, TX 79701

VIA CERTIFIED MAIL No. Z 034 697 184
RETURN RECEIPT REQUESTED

Mr. Steve Burleson
Lewis B. Burleson, Inc.
600 Centineal Tower
Midland, TX 79702

James A. Davidson
214 W. Texas, Suite 710
Midland, TX 79701

New Mexico Oil Conservation Division

October 7, 1998

Page 4

DOYLE HARTMAN, Oil Operator

Don Mashburn, Engineer

Steve Hartman, Engineer

Shiela Potts, Geologist

Linda Land, Controller

Cindy Brooks, Accountant

Acreage Ownership Plat
T-23-S, R-36-E & R-37-E
Jalmat Gas Pool

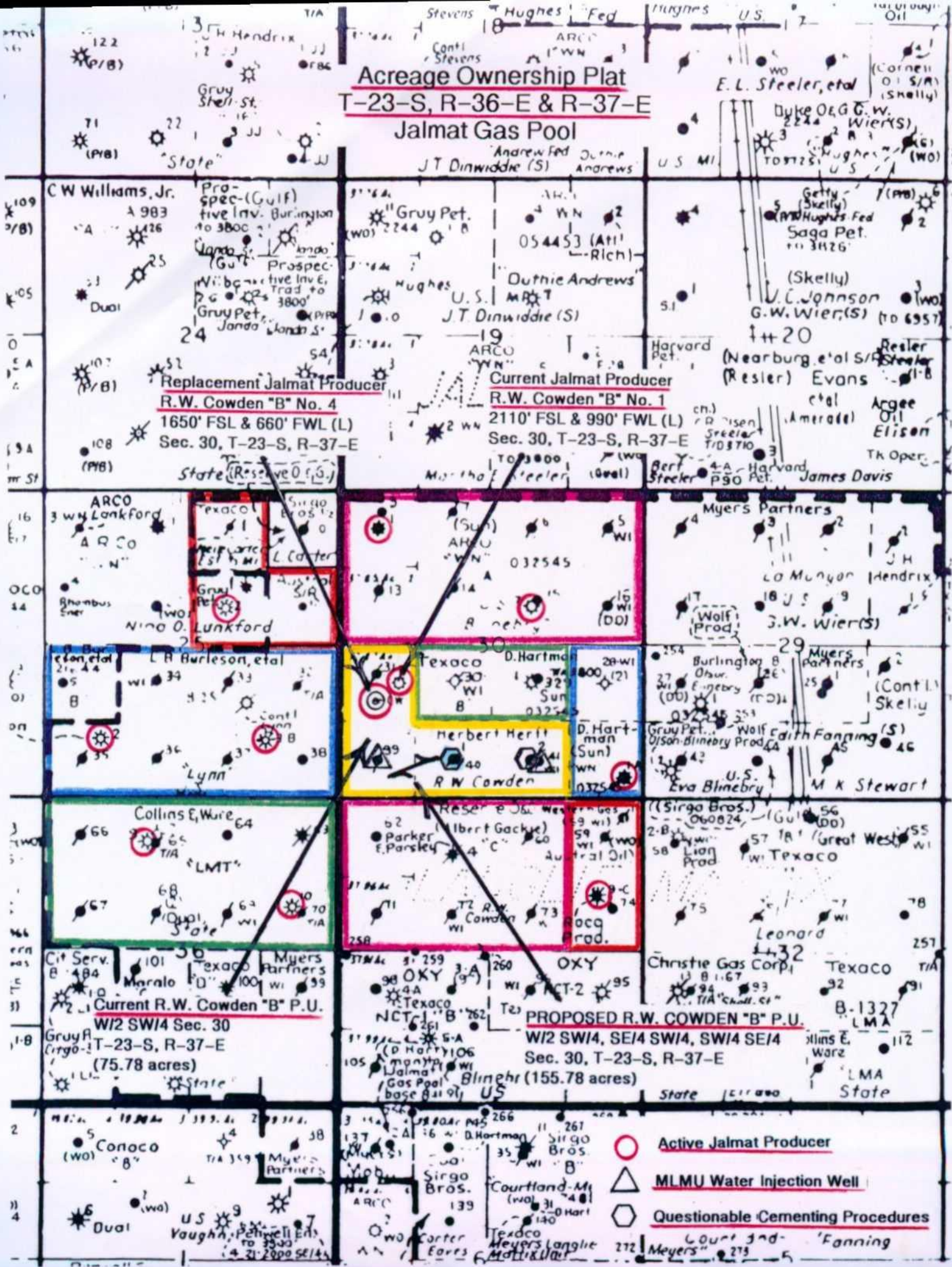

List of Offset Jalmat Tracts

To The Proposed

Doyle Hartman

R.W. Cowden "B" Proration Unit

W/2 SW/4, SE/4 SW/4, SW/4 SE/4

Section 30, T-23-S, R-37-E

(155.78 acres)

Offset Jalmat Tracts				Active Jalmat Dedications		
Tract No.	Color Code	Operator	Acreage Description	Acres (AFL)	Well(s)	Location
1	Orange	Gruy Petroleum Management, Inc.	NW/4 NE/4, S/2 NE/4 Sec. 25, T-23-S, R-36-E	120 (0.75)	Lankford No. 2	G-25-23S-36E
2	Pink	Arco Permian	N/2 Section 30 T-23-S, R-37-E	320 (2.0)	Eva E. Blinbry WN No. 2 Eva E. Blinbry WN No. 7	D-30-23S-37E G-30-23S-37E
3	Green	Doyle Hartman	NE/4 SW/4, NW/4 SE/4 Sec. 30, T-23-S, R-37-E	80 (0.5)		
4	Blue	Roca Petroleum, Inc.	E/2 SE/4 Section 30 T-23-S, R-37-E	80 (0.5)	R.W. Cowden "A" WN No. 1	P-30-23S-37E
5	Orange	Roca Petroleum, Inc.	E/2 NE/4 Section 31 T-23-S, R-37-E	80 (0.5)	R.W. Cowden "C" No. 9	H-31-23S-37E
6	Pink	Doyle Hartman	W/2 NE/4, NW/4 Sec. 31, T-23-S, R-37-E	240 (1.5)		
7	Green	Collins & Ware	N/2 Section 36 T-23-S, R-36-E	320 (2.0)	State "LMT" No. 9 State "LMT" No. 10	C-36-23S-36E H-36-23S-36E
8	Blue	Lewis B. Burleson, Inc.	S/2 Section 25 T-23-S, R-36-E	320 (2.0)	Lynn "B-25" No. 2 Lynn "B-25" No. 3	M-25-23S-36E P-25-23S-36E

DISTRICT I
P.O. Box 1980, Hobbs, NM 88241-1980

State of New Mexico

Energy, Minerals and Natural Resources Department

Form C-102
Revised February 10, 1994
Submit to Appropriate District Office
State Lease - 4 Copies
Fee Lease - 3 Copies

DISTRICT II
P.O. Drawer DD, Artesia, NM 88211-0710

DISTRICT III
1000 Rio Brazos Rd., Aztec, NM 87410

DISTRICT IV
P.O. Box 2088, Santa Fe, N.M. 87504-2088

OIL CONSERVATION DIVISION

P.O. Box 2088
Santa Fe, New Mexico 87504-2088

☐ AMENDED REPORT

WELL LOCATION AND ACREAGE DEDICATION PLAT

API Number	Pool Code 79240	Pool Name Jalmat (Tansill-Yates-Seven Rivers) Gas Pool
Property Code 5041	Property Name COWDEN B	Well Number 4
OGRID No. 6473	Operator Name DOYLE HARTMAN	Elevation 3352'

Surface Location

UL or lot No.	Section	Township	Range	Lot Idn	Feet from the	North/South line	Feet from the	East/West line	County
3	30	23 S	37 E		1650	SOUTH	660	WEST	LEA

Bottom Hole Location If Different From Surface

UL or lot No.	Section	Township	Range	Lot Idn	Feet from the	North/South line	Feet from the	East/West line	County
Dedicated Acres 155.78	Joint or Infill N*	Consolidation Code 0 (JOA)	Order No.						

NO ALLOWABLE WILL BE ASSIGNED TO THIS COMPLETION UNTIL ALL INTERESTS HAVE BEEN CONSOLIDATED
OR A NON-STANDARD UNIT HAS BEEN APPROVED BY THE DIVISION

	<p>OPERATOR CERTIFICATION</p> <p>I hereby certify the information contained herein is true and complete to the best of my knowledge and belief.</p> <p></p> <p>Signature</p> <p>Steve Hartman</p> <p>Printed Name</p> <p>Engineer</p> <p>Title</p> <p>10-06-98</p> <p>Date</p>
	<p>SURVEYOR CERTIFICATION</p> <p>I hereby certify that the well location shown on this plat was plotted from field notes of actual surveys made by me or under my supervision, and that the same is true and correct to the best of my belief.</p> <p>OCTOBER 1, 1998</p> <p>Date Surveyed</p> <p>Signature of Surveyor</p> <p>Professional Surveyor</p> <p>NEW MEXICO</p> <p>98-11-1319</p> <p>Certificate No. RONALD E. JOHNSON 3239 12641</p>

* Note: Cowden "B" No. 1 to be plugged and abandoned upon completion and connection of Cowden "B" No. 4.

District I
PO Box 1960, Hobbs, NM 88241-1960
District II
PO Drawer DD, Artesia, NM 88211-0719
District III
1000 Rio Bravo Rd., Alamogordo, NM 87410
District IV
PO Box 2088, Santa Fe, NM 87504-2088

State of New Mexico
Energy, Minerals & Natural Resources Department
CONSERVATION DIVISION
PO Box 2088
Santa Fe, NM 87504-2088

Form C-107
Revised February 10, 1994
Instructions on back
Submit to Appropriate District Office
5 Copies

☐ AMENDED REPORT

I. REQUEST FOR ALLOWABLE AND AUTHORIZATION TO TRANSPORT

Operator name and Address Roca Production, Inc. P.O. Box 10139, Midland, Texas 79702		OGRID Number
		Reason for Filing Code CH
API Number 30-0 25-10899	Pool Name Jalmat (T-Y-7R)	Pool Code 79240
Property Code 005040	Property Name R.W. Cowden "A" WN	Well Number 1

II. Surface Location

UL or lot no. P	Section 30	Township 23S	Range 37E	Lot Idn	Feet from the 330	North/South Line South	Feet from the 330	East/West line East	County Lea
--------------------	---------------	-----------------	--------------	---------	----------------------	---------------------------	----------------------	------------------------	---------------

Bottom Hole Location

UL or lot no.	Section	Township	Range	Lot Idn	Feet from the	North/South line	Feet from the	East/West line	County
Lee Code	Producing Method Code	Gas Connection Date	C-129 Permit Number	C-129 Effective Date	C-129 Expiration Date				

III. Oil and Gas Transporters

Transporter OGRID	Transporter Name and Address	POD	O/G	POD ULSTR Location and Description
020809	Sid Richardson Carbon & Gasoline Company 201 Main St Ft Worth, Tx 76102	1070430	G	

IV. Produced Water

POD	POD ULSTR Location and Description
-----	------------------------------------

V. Well Completion Data

Spud Date	Ready Date	TD	PBTD	Perforations
Hole Size	Casing & Tubing Size	Depth Set	Sacks Cement	

VI. Well Test Data

Date New Oil	Gas Delivery Date	Test Date	Test Length	Tbg. Pressure	Cog. Pressure
Choke Size	Oil	Water	Gas	AOF	Test Method

* I hereby certify that the rules of the Oil Conservation Division have been complied with and that the information given above is true and complete to the best of my knowledge and belief. Signature:		OIL CONSERVATION DIVISION	
Printed name:		Approved by:	
Title:		Title:	
Date:		Approval Date:	
Phone:			
* If this is a change of operator fill in the OGRID number and name of the previous operator			
006473	Don L. Mashburn	Engineer	2-1-95
Previous Operator Signature	Printed Name	Title	Date

File
cc: Carolyn

APPLICATION OF GETTY OIL COMPANY
TO EXPAND ITS MYERS LANGLIE-MATTIX
UNIT WATER FLOOD PROJECT IN THE
LANGLIE-MATTIX POOL IN LEA COUNTY,
NEW MEXICO.

ORDER WFX NO. 460

ADMINISTRATIVE ORDER
OF THE OIL CONSERVATION DIVISION

Under the provisions of Rule 701-E, Getty Oil Company has made application to the Division on April 10, 1978, for permission to expand its Myers Langlie Mattix Unit Project in the Langlie-Mattix Pool in Lea County, New Mexico.

NOW, on this 11th day of May, 1978, the Division Director finds:

1. That application has been filed in due form.
2. That satisfactory information has been provided that no offset operators objected.
3. That the proposed injection wells are eligible for conversion to water injection under the terms of Orders No. R-4680.
4. That the proposed expansion of the above-referenced water flood project will not cause waste nor impair correlative rights.
5. That the application should be approved.

IT IS THEREFORE ORDERED:

That the applicant, Getty Oil Company, be and the same is hereby authorized to inject water into the Queen formation through plastic-lined tubing set in a packer within approximately 100 feet of the injection interval in the following described wells for purposes of secondary recovery, to wit:

Myers Langlie Mattix Unit Well No.	Unit	Section	Location Township	Range
✓5	A	30	23S	37E
✓22	K	28	23S	37E
✓30	K	30	23S	37E
✓32	I	25	23S	37E
✓75	E	32	23S	37E
✓77	G	32	23S	37E
✓84	F	34	23S	37E
✓87	I	33	23S	37E
✓93	K	32	23S	37E
✓111	O	32	23S	37E
✓117	M	34	23S	37E
✓130	A	5	24S	37E
✓163	I	4	24S	37E
✓167	I	5	24S	37E
✓181	M	4	24S	37E
✓189	M	2	24S	37E
✓226	E	11	24S	37E

ORDER WFX NO. 460

Langlie Mattix Unit Well No.	Unit	Location		
		Section	Township	Range
✓15	G	30	23S	37E
<u>41</u>	O	30	23S	37E
<u>59</u>	A	31	23S	37E
<u>81</u>	G	33	23S	37E
<u>126</u>	A	4	24S	37E
<u>128</u>	C	4	24S	37E
<u>148</u>	G	4	24S	37E
<u>165</u>	K	4	24S	37E
<u>183</u>	O	4	24S	37E
<u>185</u>	M	3	24S	37E
<u>204</u>	C	7	24S	37E
<u>212</u>	G	7	24S	37E

IT IS FURTHER ORDERED:

That the operator shall take all steps necessary to ensure that the injected water enters only the proposed injection interval and is not permitted to escape to other formations or onto the surface.

That no injection will be permitted within one-half mile of the following wells:

George P. Livermore, Inc.	R. W. Cowden No. 2, Unit O, 30-23S-37E
George P. Livermore, Inc.	R. W. Cowden No. 4, Unit N, 30-23S-37E
Western Gas Company	Cowden No. 1, Unit A, 31-23S-37E
Resler & Sheldon	Fanning No. 2, Unit B, 33-23S-37E
Western Equipment Co.	Dalport Hair No. 1, Unit L, 11-24S-37E
R. Olsen Oil Company	Steeler No. 1, Unit M, 20-23S-37E

Upon satisfactory showing that the operator has re-entered and re-plugged the above wells in a manner prescribed by the Division District Office, injection will be permitted in all wells

That the casing-tubing annulus shall be loaded with an inert fluid and equipped with a pressure gauge at the surface or left open to the atmosphere to facilitate detection of leakage in the casing, tubing, or packer.

That the injection well or system shall be equipped with a pop-off valve or device which will limit the wellhead pressure to a maximum of 900 pounds per square inch; provided however that the Division Director may administratively authorize a pressure limitation in excess of the above upon the operator's establishing that such higher pressure will not result in fracturing of confining strata.

That the operator shall notify the supervisor of the Division's District Office before injection is commenced through said well;

-3-

ORDER WFX NO. 460

That the operator shall immediately notify the Supervisor of the Division's District Office of the failure of the tubing, casing, or packer in said wells or the leakage of water from or around said wells and shall take such steps as may be timely or necessary to correct such failure or leakage.

DONE at Santa Fe, New Mexico, on the day and year herein-above designated.

STATE OF NEW MEXICO
OIL CONSERVATION COMMISSION

JOE D. RAMEY
Division Director

SEAL

COWDEN "B" #1
JALMAT (TANSILL YATES SEVEN RIVERS) YS
L-30 T-23S R-37E
DOYLE HARTMAN OIL OPERATOR

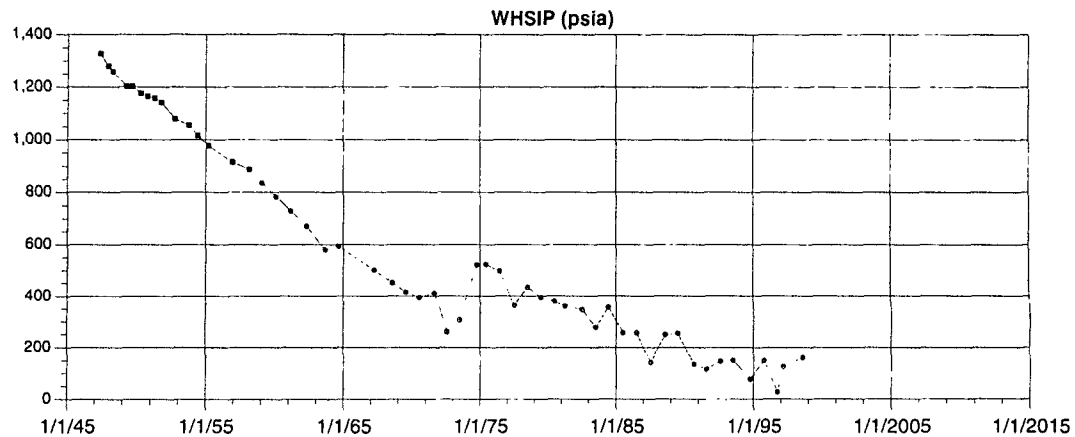
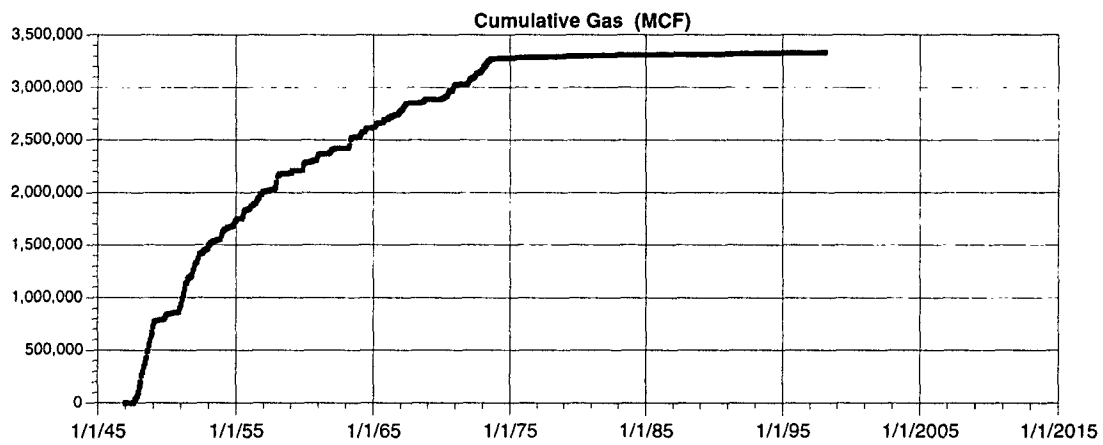
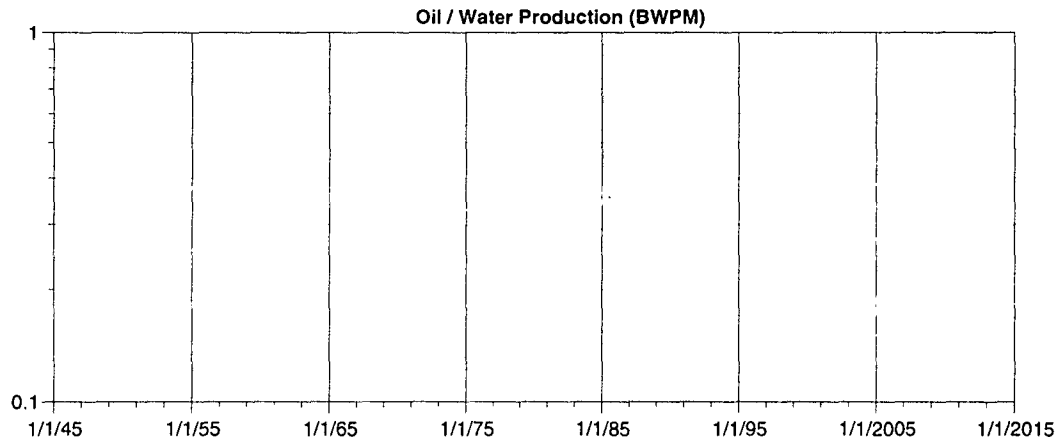
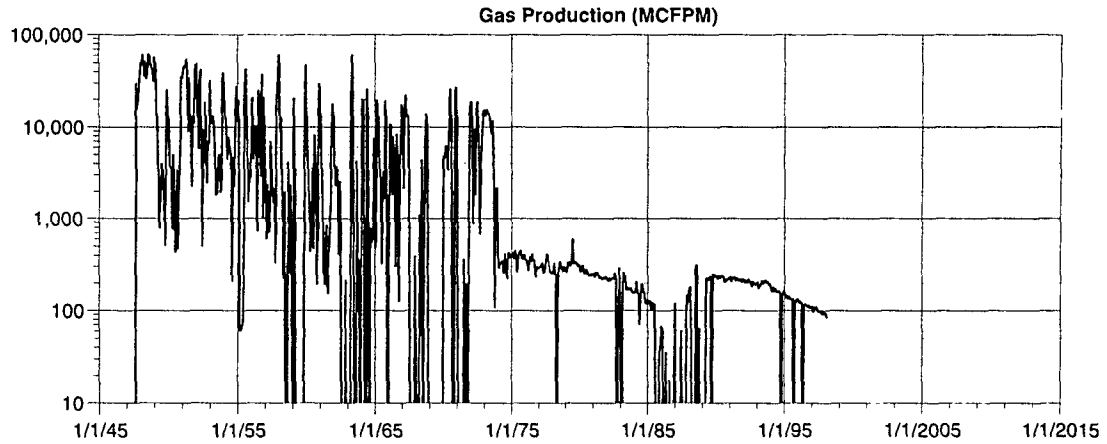

DISTRICT I
P.O. Box 1880, Hobbs, NM 88241-1880

DISTRICT II
P.O. Drawer 88, Artesia, NM 88211-0718

DISTRICT III
1000 Rio Brazos Rd., Aztec, NM 87410

DISTRICT IV
P.O. Box 2088, Santa Fe, N.M. 87504-2088

State of New Mexico
Energy, Minerals and Natural Resources Department

Form C-102
Revised February 10, 1984
Submit to Appropriate District Office
State Lease - 4 Copies
Fee Lease - 3 Copies

OIL CONSERVATION DIVISION

P.O. Box 2088
Santa Fe, New Mexico 87504-2088

☐ AMENDED REPORT

WELL LOCATION AND ACREAGE DEDICATION PLAT

API Number	Pool Code 79240	Pool Name Jalmat (Tansill-Yates-Seven Rivers) Gas Pool
Property Code 5041	Property Name RW COWDEN B	Well Number 4
OGED No. 6473	Operator Name DOYLE HARTMAN	Elevation 3352'

Surface Location

UL or lot No. 3	Section 30	Township 23 S	Range 37 E	Lot Idn	Feet from the 1650	North/South Line SOUTH	Feet from the 660	East/West line WEST	County LEA
--------------------	---------------	------------------	---------------	---------	-----------------------	---------------------------	----------------------	------------------------	---------------

Bottom Hole Location If Different From Surface

UL or lot No.	Section	Township	Range	Lot Idn	Feet from the	North/South Line	Feet from the	East/West line	County
Dedicated Acres 75.78	Joint or Infill N*	Consolidation Code O (JOA)	Order No. 75.78 Acre P.U. Approved by Order R-441 (4/16/54)						

NO ALLOWABLE WILL BE ASSIGNED TO THIS COMPLETION UNTIL ALL INTERESTS HAVE BEEN CONSOLIDATED
OR A NON-STANDARD UNIT HAS BEEN APPROVED BY THE DIVISION

<p>LOT 1 37.81 AC.</p> <p>LOT 2 37.85 AC.</p> <p>LOT 3 37.87 AC.</p> <p>LOT 4 37.91 AC.</p>	<p>EXISTING WELL AND 80-ACRE P.U. Cowden "B" No. 1* 2110' FSL & 990' FWL (L) Sec. 30, T-23-S, R-37-E (R-441/4-16-54)</p> <p>PROPOSED WELL Cowden "B" No. 4 1650' FSL & 1860' FWL (L) Section 30, T-23-S, R-37-E</p>	<p>OPERATOR CERTIFICATION</p> <p>I hereby certify that the information contained herein is true and complete to the best of my knowledge and belief.</p> <p><i>Steve Hartman</i> Signature</p> <p>Steve Hartman Printed Name</p> <p>Engineer Title</p> <p>10/5/98 Date</p> <p>SURVEYOR CERTIFICATION</p> <p>I hereby certify that the well location shown on this plat was plotted from field notes of actual surveys made by me or under my supervision and that the same is true and correct to the best of my belief.</p> <p>OCTOBER 1, 1998</p> <p>Date Surveyed Signature: Gary Edson Professional Surveyor</p> <p>NEW MEXICO 98-11-1389</p> <p>Certificate No. RONALD E. EDSON 3239 GARY EDSON 12841</p>
---	---	--

*Note: Cowden "B" No. 1 to be plugged and abandoned upon completion and connection of Cowden "B" No. 4.

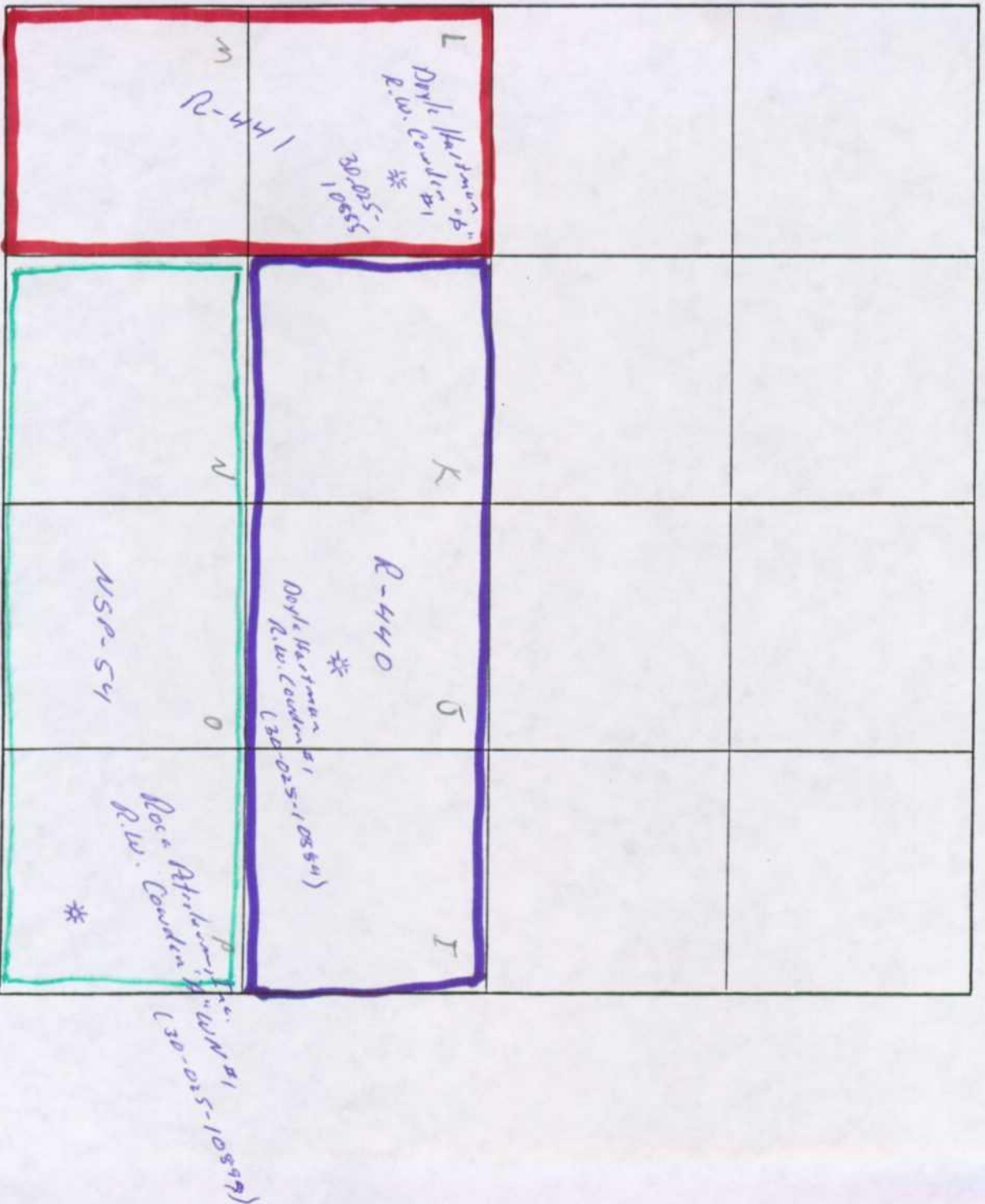

SECTION 30

TOWNSHIP 23 South

RANGE 37E