

NEW MEXICO OIL CONSERVATION COMMISSION
WELL LOCATION AND ACREAGE DEDICATION PLAT

Form C-102
Supersedes C-128
Effective 1-1-65

MAR 25 1983

All distances must be from the outer boundaries of the Section

Operator CHALFONT OIL & GAS COMPANY		Lease Kaiser Steel		Well No. CONSERVATION DIVISION 1	
Unit Letter 0	Section 13	Township T29N	Range R21E	County SANTA FE	
Actual Footage Location of Well: 740 feet from the South line and 1700 feet from the EAST line					
Ground Level Elev. 6786'	Producing Formation Dakota-Morrison		Pool Wildcat	Dedicated Acreage: 40 Acres	

1. Outline the acreage dedicated to the subject well by colored pencil or hachure marks on the plat below.
2. If more than one lease is dedicated to the well, outline each and identify the ownership thereof (both as to working interest and royalty). SINGLE LEASE
3. If more than one lease of different ownership is dedicated to the well, have the interests of all owners been consolidated by communitization, unitization, force-pooling, etc?

Yes No If answer is "yes," type of consolidation _____

If answer is "no," list the owners and tract descriptions which have actually been consolidated. (Use reverse side of this form if necessary.) _____

No allowable will be assigned to the well until all interests have been consolidated (by communitization, unitization, forced-pooling, or otherwise) or until a non-standard unit, eliminating such interests, has been approved by the Commission.

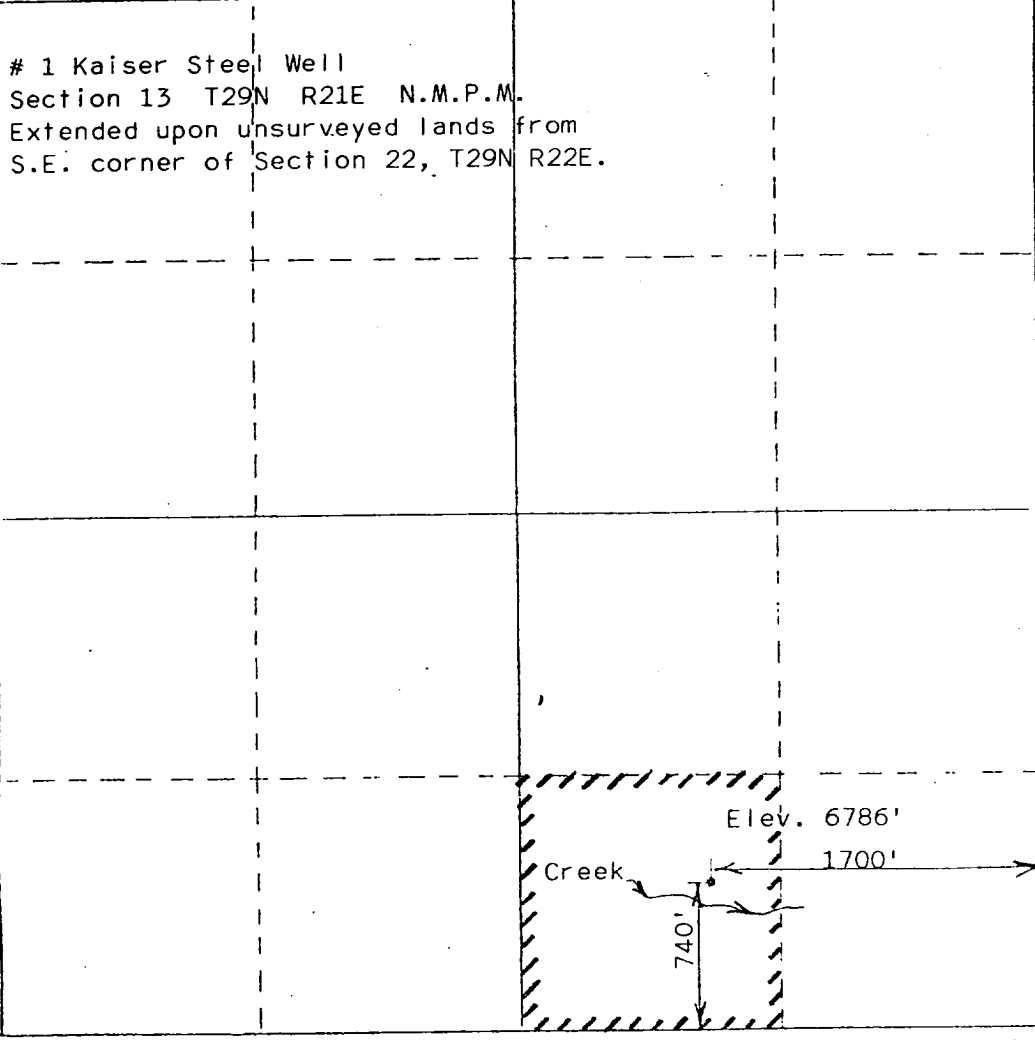

CERTIFICATION

I hereby certify that the information contained herein is true and complete to the best of my knowledge and belief.

Jerry W. Long
Name
JERRY W. LONG

Position
Agent

Company
CHALFONT OIL & GAS COMPANY

Date
March 23, 1983

I hereby certify that the well location shown on this plat was plotted from field notes of actual surveys made by me or under my supervision, and that the same is true and correct to the best of my knowledge and belief.

October 21, 1982
Date Surveyed
Bill E. Adams
Registered Professional Engineer
and/or Land Surveyor

Certificate No.
LSNM 4002

