

MAR 31 1981

NEW MEXICO OIL CONSERVATION COMMISSION

API # 30-D19-20060

Permit Application Form  
Revised 11-75

NO. OF COPIES RECEIVED	
DISTRIBUTION	
SANTA FE	
FILE	✓
U.S.G.S.	
LAND OFFICE	
OPERATOR	

5A. Indicate whether the well is:  
 STATE  FEDERAL   
 5. State Oil & Gas Lease No.  
 LG 1896

APPLICATION FOR PERMIT TO DRILL, DEEPEN, OR PLUG BACK

1a. Type of Work  
 b. Type of Well DRILL  DEEPEN  PLUG BACK   
 OIL WELL  GAS WELL  OTHER   
 SINGLE ZONE  MULTIPLE ZONE   
 2. Name of Operator  
 Public Lands Exploration Co., Inc.  
 3. Address of Operator  
 4835 LBJ Freeway, Suite 635, Dallas, Texas 75274  
 4. Location of Well  
 UNIT LETTER C LOCATED 660 FEET FROM THE North LINE  
 AND 2310 FEET FROM THE West LINE OF SEC. 16 TWP. 11N RGE. 26E NMPM  
 7. Permit Agreement Name  
 8. Name of Lease Owner  
 Joan-State  
 9. Well No.  
 2  
 10. Field and Sect. or Section  
 Wildcat  
 12. County  
 Guadalupe  
 13. Depth of Well  
 900'  
 14. Formation  
 Chinle  
 15. Rotary or C.C.P.  
 Rotary  
 21. Elevations (Show whether DE, RT, etc.)  
 4738 ft.  
 21A. Risk & Status Plug. Bond  
 Blanket  
 21B. Drilling Contractor  
 F. Rhymes Drilling Co.  
 22. Approx. Date work will start  
 March 31, 1981

PROPOSED CASING AND CEMENT PROGRAM

SIZE OF HOLE	SIZE OF CASING	WEIGHT PER FOOT	SETTING DEPTH	SACKS OF CEMENT	EST. TOP
11"	8 5/8"	24	30	14	Surface
7 7/8"	4 1/2"	11.6	. 900	360	Surface

This well will be drilled with air. Blowout preventers will not be installed as a number of wells have been drilled in the field and no high pressure zones have been encountered. Oil zones encountered were saturated with an inactive oil that tested 15 degrees API gravity.

APPROVAL VALID FOR 90 DAYS  
 PERMIT EXPIRES 6-30-81  
 UNLESS DRILLING UNDERWAY

OIL CONSERVATION COMMISSION TO BE NOTIFIED  
 WITHIN 24 HOURS OF BEGINNING OPERATIONS

IN ABOVE SPACE DESCRIBE PROPOSED PROGRAM; IF PROPOSAL IS TO DEEPEN OR PLUG BACK, GIVE DATA ON PRESENT PRODUCTIVE ZONE AND PROPOSED NEW PRODUCTIVE ZONE. GIVE BLOWOUT PREVENTER PROGRAM, IF ANY.

I hereby certify that the information above is true and complete to the best of my knowledge and belief.

Signed Charles C Joy Title Agent Date March 27, 1981

(This space for State Use)

APPROVED BY Carl Ulvog TITLE SUPERVISOR REG. DISTRICT REG. DISTRICT SUPERVISOR DATE 4/1/81

CONDITIONS OF APPROVAL, IF ANY:

NEW MEXICO OIL CONSERVATION COMMISSION  
WELL LOCATION AND ACREAGE DEDICATION PLAT

MAR 31 1981  
Form O-102  
Revised 1-1-78  
Effective 1-1-65

OIL CONSERVATION DIVISION

All distances must be from the outer boundaries of the Section.

Owner Public Lands Exploration Inc.		Lease Jones State		SAN Well No. 2	
Well Letter "C"	Section 16	Township 11 N	Range 26 E	County Guadalupe	
Well Location of Well: 660 feet from the North line and 2310 feet from the West line					
Well Level Elev. 4738.0	Producing Formation Chinle		Pool Wildcat	Dedicated Acreage: 40 Acres	

1. Outline the acreage dedicated to the subject well by colored pencil or hachure marks on the plat below.
2. If more than one lease is dedicated to the well, outline each and identify the ownership thereof (both as to working interest and royalty).
3. If more than one lease of different ownership is dedicated to the well, have the interests of all owners been consolidated by communitization, unitization, force-pooling, etc?

Yes  No If answer is "yes," type of consolidation \_\_\_\_\_

If answer is "no," list the owners and tract descriptions which have actually been consolidated. (Use reverse side of this form if necessary.) \_\_\_\_\_

No allowable will be assigned to the well until all interests have been consolidated (by communitization, unitization, forced-pooling, or otherwise) or until a non-standard unit, eliminating such interests, has been approved by the Commission.

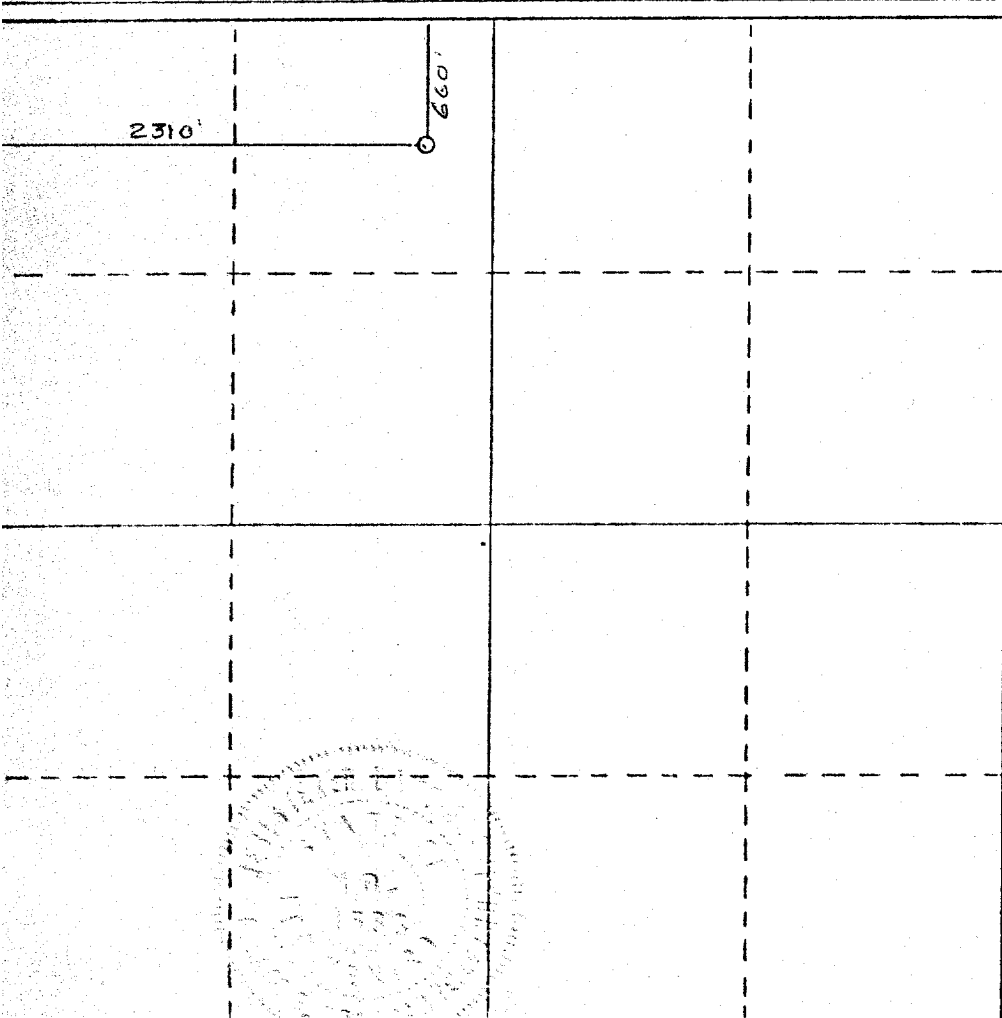

CERTIFICATION	
I hereby certify that the information contained herein is true and complete to the best of my knowledge and belief.	
Name	Charles C Joy
Position	Agent
Company	Public Lands Exploration
Date	March 27, 1981
I hereby certify that the well location shown on this plat was plotted from field notes of actual surveys made by me or under my supervision, and that the same is true and correct to the best of my knowledge and belief.	
Date Surveyed	March 24, 1981
Registered Professional Engineer and/or Land Surveyor	W. B. Ballard
License No.	L.S. 1566