

API # 30-053-20008

NEW MEXICO OIL CONSERVATION COMMISSION

Form C-101  
Revised 1-1-65

NO. OF COPIES RECEIVED	
DISTRIBUTION	
SANTA FE	
FILE	<input checked="" type="checkbox"/>
U.S.G.S.	
LAND OFFICE	
OPERATOR	

5A. Indicate Type of Lease  
STATE  FEE

5. State Oil & Gas Lease No.

APPLICATION FOR PERMIT TO DRILL, DEEPEN, OR PLUG BACK

1a. Type of Work DRILL <input checked="" type="checkbox"/> DEEPEN <input type="checkbox"/> PLUG BACK <input type="checkbox"/>		7. Unit Agreement Name	
b. Type of Well OIL WELL <input checked="" type="checkbox"/> GAS WELL <input type="checkbox"/> OTHER <input type="checkbox"/>		8. Farm or Lease Name SFP-Davis Pueblo	
2. Name of Operator Whigham, Inc.		9. Well No. 2	
3. Address of Operator P.O. Box 1996, Farmington, New Mexico 87401		10. Field and Pool, or Wildcat Wildcat	
4. Location of Well UNIT LETTER <b>F X</b> LOCATED <u>2310</u> FEET FROM THE <u>North</u> LINE AND <u>2310</u> FEET FROM THE <u>West</u> LINE OF SEC. <u>35</u> TWP. <u>1N</u> RGE. <u>6W</u> NMPM		12. County Socorro	
19. Proposed Depth 900		19A. Formation Dakota	20. Rotary or C.T. Rotary
21. Elevations (Show whether DF, RT, etc.) 7008 GR	21A. Kind & Status Plug. Bond One Well	21B. Drilling Contractor Stewart Bros.	22. Approx. Date Work will start April 30, 1979

PROPOSED CASING AND CEMENT PROGRAM

SIZE OF HOLE	SIZE OF CASING	WEIGHT PER FOOT	SETTING DEPTH	SACKS OF CEMENT	EST. TOP
8-3/4"	7"	16#	30'	Suff. to Circ.	Surface
5" & 6-1/4"	4-1/2"	10.50#	1500'	50 sx	

We propose to set 1 joint of 7" surface casing. We will drill a 5-inch hole to approx. 900 feet to test the Dakota Formation. If no shows are encountered, the test will be plugged and abandoned. If productive possibilities are indicated, we will ream the 5-inch hole to 6-1/4" and run 4-1/2" - 10.50# casing to through indicated pay zone. We will not use a BOP as per our letter of April 16, 1979.

OIL CONSERVATION COMMISSION TO BE NOTIFIED  
WITHIN 24 HOURS OF BEGINNING OPERATIONS

APPROVAL VALID FOR 90 DAYS  
PERMIT EXPIRES 7/30/79  
UNLESS DRILLING UNDERWAY

IN ABOVE SPACE DESCRIBE PROPOSED PROGRAM: IF PROPOSAL IS TO DEEPEN OR PLUG BACK, GIVE DATA ON PRESENT PRODUCTIVE ZONE AND PROPOSED NEW PRODUCTIVE ZONE. GIVE BLOWOUT PREVENTER PROGRAM, IF ANY.

I hereby certify that the information above is true and complete to the best of my knowledge and belief.

Signed [Signature] Title President Date 4/20/79

(This space for State Use)

APPROVED BY Carl Ullvog TITLE SENIOR PETROLEUM GEOLOGIST DATE 5/1/79

CONDITIONS OF APPROVAL, IF ANY:  
COLLECT AND SACK SAMPLES FOR  
NEW MEXICO BUREAU OF MINES, SOCORRO  
AT AT LEAST TEN FOOT INTERVALS

OIL CONSERVATION DIVISION

P. O. BOX 2088

SANTA FE, NEW MEXICO 87501

Form C-107  
Revised 10-1-78

STATE OF NEW MEXICO  
ENERGY AND MINERALS DEPARTMENT

All distances must be from the outer boundaries of the Section.

Operator <b>TOM WHIGHAM</b>		Lease <b>SFP-DAVIS PUEBLO</b>			Well No. <b>2</b>
Unit Letter <b>F</b>	Section <b>35</b>	Township <b>1N</b>	Range <b>6W</b>	County <b>Socorro</b>	
Actual Footage Location of Well: <b>2310</b> feet from the <b>North</b> line and <b>2310</b> feet from the <b>West</b> line					
Ground Level Elev. <b>7008</b>	Producing Formation <b>Unknown</b>		Pool	Dedicated Acreage:  Acres	

1. Outline the acreage dedicated to the subject well by colored pencil or hachure marks on the plat below.
2. If more than one lease is dedicated to the well, outline each and identify the ownership thereof (both as to working interest and royalty).
3. If more than one lease of different ownership is dedicated to the well, have the interests of all owners been consolidated by communitization, unitization, force-pooling, etc.?

Yes  No If answer is "yes," type of consolidation \_\_\_\_\_

If answer is "no," list the owners and tract descriptions which have actually been consolidated. (Use reverse side of this form if necessary.) \_\_\_\_\_

No allowable will be assigned to the well until all interests have been consolidated (by communitization, unitization, forced-pooling, or otherwise) or until a non-standard unit, eliminating such interests, has been approved by the Commission.

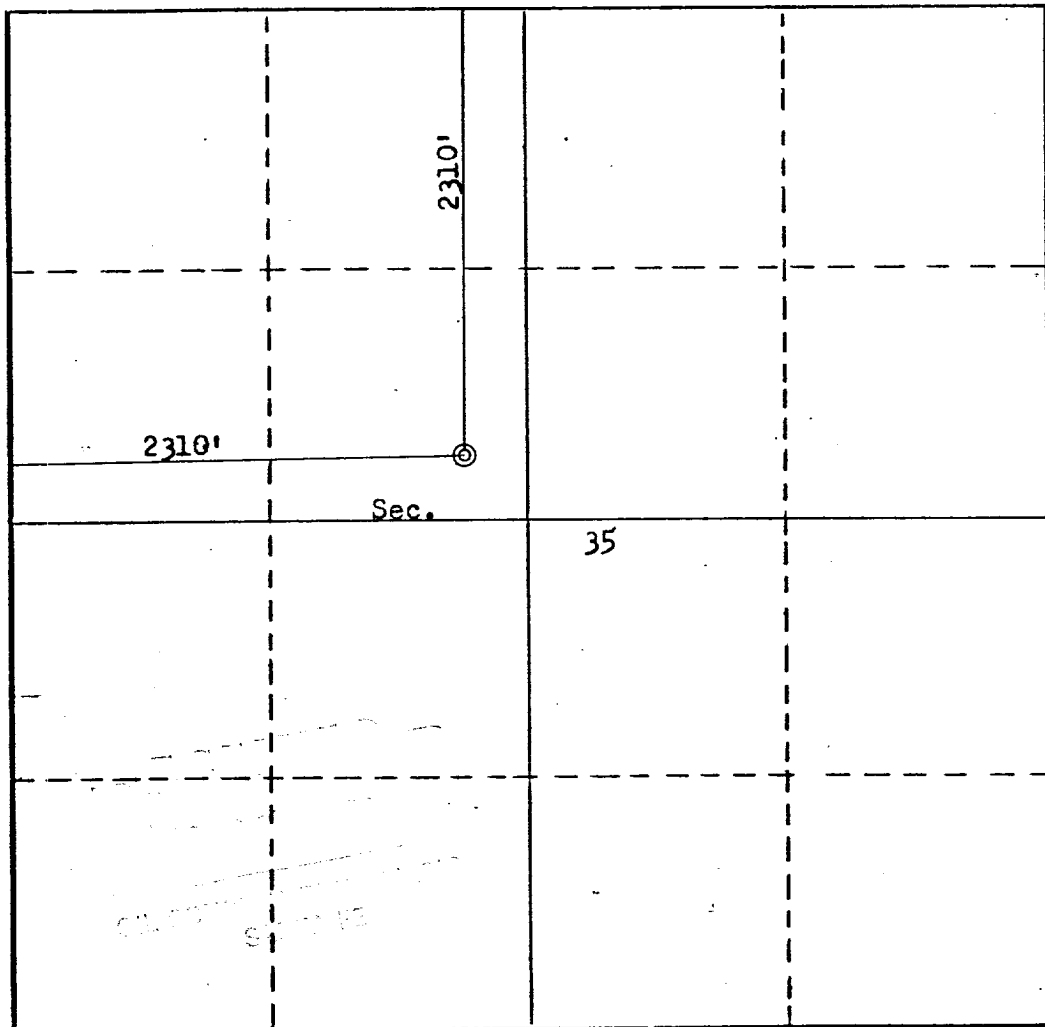

CERTIFICATION

I hereby certify that the information contained herein is true and complete to the best of my knowledge and belief.

Name: *T. S. Whigham*  
Position: **President**

Company: **Whigham, Inc.**

Date: **April 20, 1979**

I hereby certify that the well location shown on this plat was plotted from field notes of actual surveys made by me or under my supervision, and that the same is true and correct to the best of my knowledge and belief.

Date Surveyed: **April 20, 1979**  
Registered Professional Engineer and/or Land Surveyor  
*Fred S. Kerr, Jr.*  
Certificate No. **3950**

