

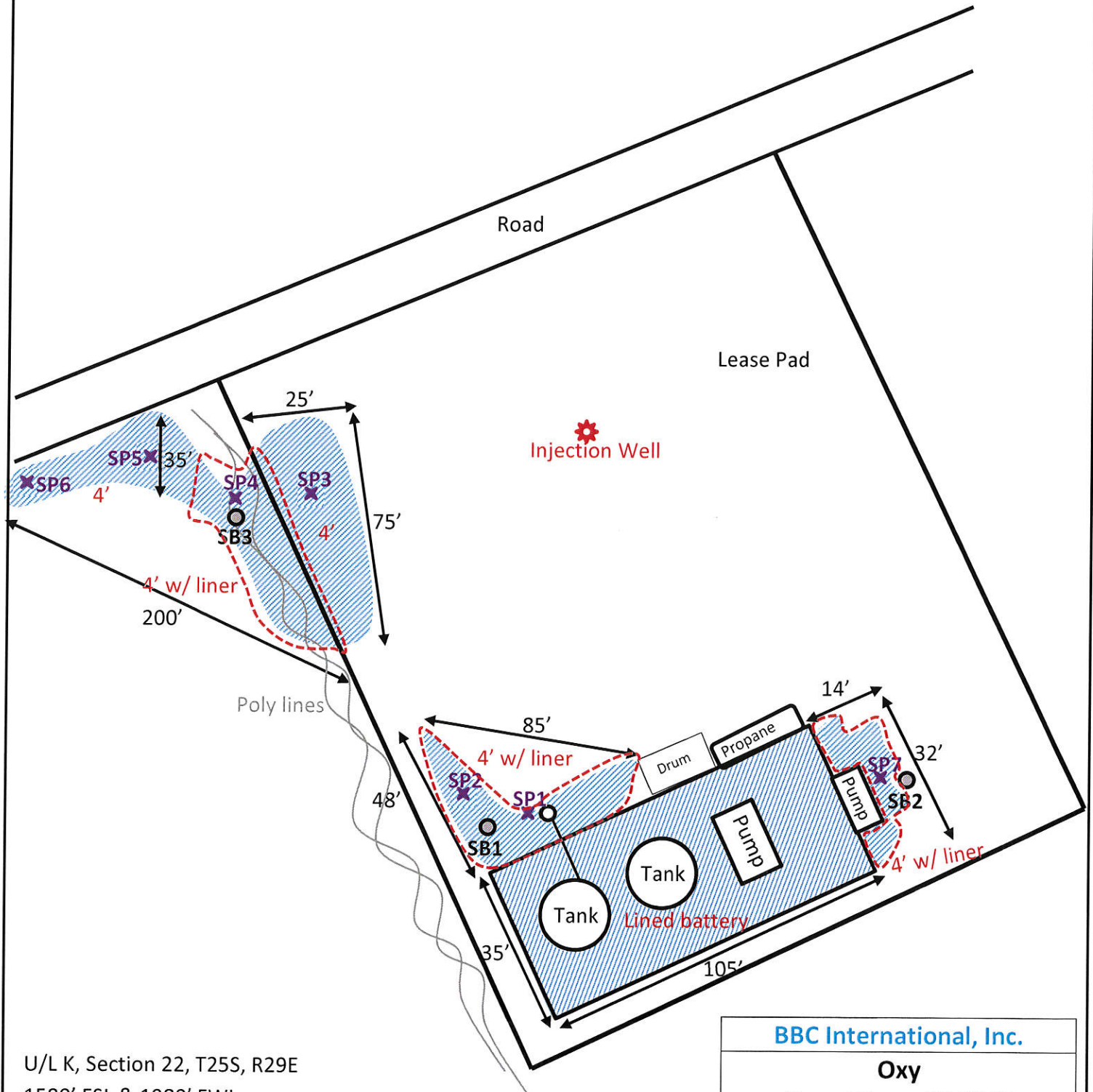

Oxy
Corral Draw #2



U/L K, Section 22, T25S, R29E
1580' FSL & 1980' FWL
Eddy County, NM
N 32.11249° W 103.97449°
API# 30-015-21425

BBC International, Inc.

**Oxy
Corral Draw #2 SWD**

Date: 02/26/2014

DRWG by: K. Purvis

NOT TO SCALE

File: Oxy 2014

Groundwater Plot

Oxy Corral Draw #2

County
Eddy

Unit Letter
K

Section
22

Township
25S

Range
29E

Trend Map 150'

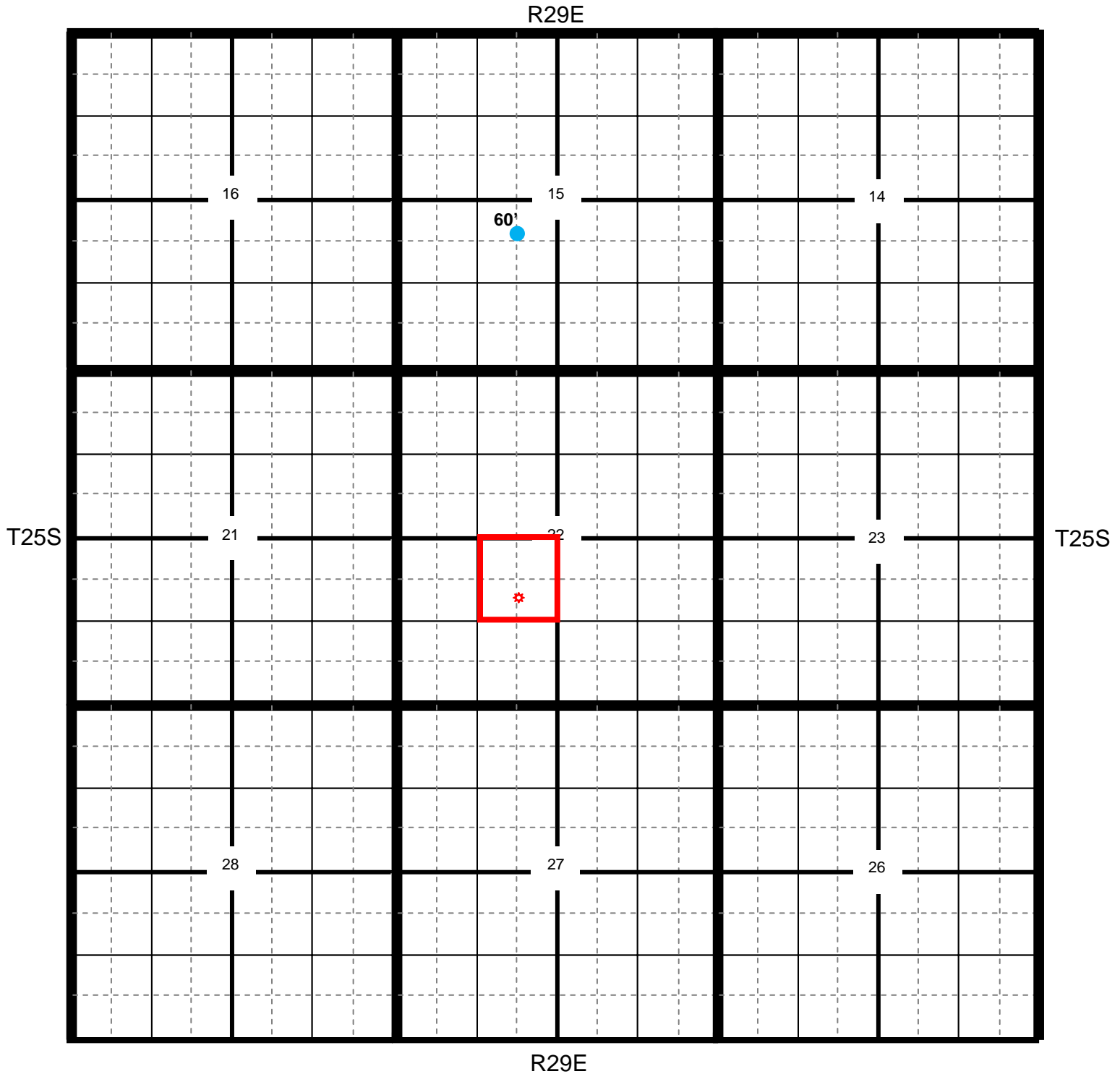

★ Location

● OCD

● USGS

● SEO

● All Databases

Oxy Corral Draw #2

County Eddy Unit Letter K Section 22 Township 25S Range 29E

Trend Map 150'

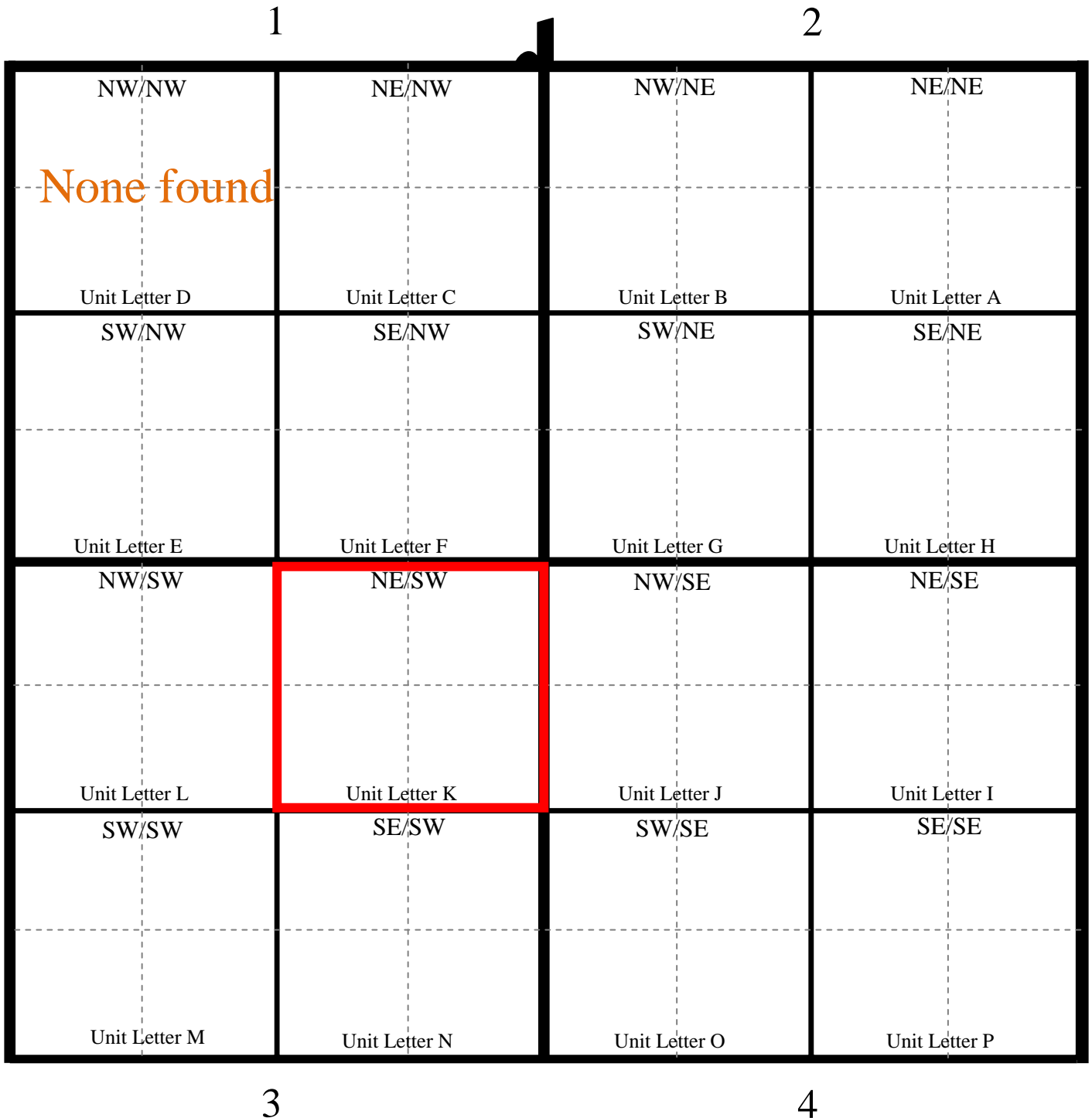

**Laboratory Analytical Results Summary
Corral Draw #2**

		Sample	SP1 @ 1'	SP1 @ 4'	SP1 @ 8'	SP1 @ 12'	SP1 @ 18'
Analyte	Method	Date	3/20/14	3/20/14	3/20/14	3/20/14	3/20/14
			mg/Kg	mg/Kg	mg/Kg	mg/Kg	mg/Kg
Benzene	BTEX 8021B		<0.050	n/a	n/a	n/a	n/a
Toluene	BTEX 8021B		<0.050	n/a	n/a	n/a	n/a
Ethylbenzene	BTEX 8021B		<0.050	n/a	n/a	n/a	n/a
Total Xylenes	BTEX 8021B		<0.150	n/a	n/a	n/a	n/a
Total BTEX	BTEX 8021B		<0.300	n/a	n/a	n/a	n/a
Chloride	SM4500Cl-B		656	2440	1760	2320	2560
GRO	TPH 8015M		<10.0	n/a	n/a	n/a	n/a
DRO	TPH 8015M		<10.0	n/a	n/a	n/a	n/a

		Sample	SP2 @ 1'	SP2 @ 4'	SP2 @ 8'	SP2 @ 12'	SP2 @ 18'
Analyte	Method	Date	3/24/14	3/24/14	3/24/14	3/24/14	3/24/14
			mg/Kg	mg/Kg	mg/Kg	mg/Kg	mg/Kg
Benzene	BTEX 8021B		<0.050	n/a	n/a	n/a	n/a
Toluene	BTEX 8021B		<0.050	n/a	n/a	n/a	n/a
Ethylbenzene	BTEX 8021B		<0.050	n/a	n/a	n/a	n/a
Total Xylenes	BTEX 8021B		<0.150	n/a	n/a	n/a	n/a
Total BTEX	BTEX 8021B		<0.300	n/a	n/a	n/a	n/a
Chloride	SM4500Cl-B		624	2680	3680	3280	3120
GRO	TPH 8015M		<10.0	n/a	n/a	n/a	n/a
DRO	TPH 8015M		<10.0	n/a	n/a	n/a	n/a

		Sample	SP3 @ 1'	SP3 @ 4'	SP3 @ 8'	SP3 @ 12'	SP3 @ 16'
Analyte	Method	Date	3/24/14	3/24/14	3/25/14	3/25/14	3/25/14
			mg/Kg	mg/Kg	mg/Kg	25-Mar	mg/Kg
Benzene	BTEX 8021B		<0.050	n/a	n/a	n/a	n/a
Toluene	BTEX 8021B		<0.050	n/a	n/a	n/a	n/a
Ethylbenzene	BTEX 8021B		<0.050	n/a	n/a	n/a	n/a
Total Xylenes	BTEX 8021B		<0.150	n/a	n/a	n/a	n/a
Total BTEX	BTEX 8021B		<0.300	n/a	n/a	n/a	n/a
Chloride	SM4500Cl-B		40000	10100	864	384	176
GRO	TPH 8015M		<10.0	n/a	n/a	n/a	n/a
DRO	TPH 8015M		<10.0	n/a	n/a	n/a	n/a

		Sample	SP4 @ 1'	SP4 @ 4'	SP4 @ 8'	SP4 @ 12'	SP4 @ 18'
Analyte	Method	Date	3/25/14	3/25/14	3/25/14	3/25/14	3/25/14
			mg/Kg	mg/Kg	mg/Kg	mg/Kg	mg/Kg
Benzene	BTEX 8021B		<0.050	n/a	n/a	n/a	n/a
Toluene	BTEX 8021B		<0.050	n/a	n/a	n/a	n/a
Ethylbenzene	BTEX 8021B		<0.050	n/a	n/a	n/a	n/a
Total Xylenes	BTEX 8021B		<0.150	n/a	n/a	n/a	n/a
Total BTEX	BTEX 8021B		<0.300	n/a	n/a	n/a	n/a
Chloride	SM4500Cl-B		4880	10300	5600	4640	3840
GRO	TPH 8015M		<10.0	n/a	n/a	n/a	n/a
DRO	TPH 8015M		<10.0	n/a	n/a	n/a	n/a

Laboratory Analytical Results Summary
Corral Draw #2

		Sample	SP5 @ 1'	SP5 @ 4'	SP5 @ 8'	SP5 @ 12'	SP5 @ 15'
Analyte	Method	Date	3/26/14	3/26/14	3/26/14	3/26/14	3/26/14
			mg/Kg	mg/Kg	mg/Kg	mg/Kg	mg/Kg
Benzene	BTEX 8021B		<0.050	n/a	n/a	n/a	n/a
Toluene	BTEX 8021B		<0.050	n/a	n/a	n/a	n/a
Ethylbenzene	BTEX 8021B		<0.050	n/a	n/a	n/a	n/a
Total Xylenes	BTEX 8021B		<0.150	n/a	n/a	n/a	n/a
Total BTEX	BTEX 8021B		<0.300	n/a	n/a	n/a	n/a
Chloride	SM4500Cl-B		2000	8640	992	720	256
GRO	TPH 8015M		<10.0	n/a	n/a	n/a	n/a
DRO	TPH 8015M		<10.0	n/a	n/a	n/a	n/a

		Sample	SP6 @ 1'	SP6 @ 4'	SP6 @ 8'	SP6 @ 12'	SP6 @ 15'
Analyte	Method	Date	3/26/14	3/26/14	3/26/14	3/26/14	3/26/14
			mg/Kg	mg/Kg	mg/Kg	mg/Kg	mg/Kg
Benzene	BTEX 8021B		<0.050	n/a	n/a	n/a	n/a
Toluene	BTEX 8021B		<0.050	n/a	n/a	n/a	n/a
Ethylbenzene	BTEX 8021B		<0.050	n/a	n/a	n/a	n/a
Total Xylenes	BTEX 8021B		<0.150	n/a	n/a	n/a	n/a
Total BTEX	BTEX 8021B		<0.300	n/a	n/a	n/a	n/a
Chloride	SM4500Cl-B		1600	8200	976	720	208
GRO	TPH 8015M		<10.0	n/a	n/a	n/a	n/a
DRO	TPH 8015M		<10.0	n/a	n/a	n/a	n/a

		Sample	SP7 @ 1'	SP7 @ 4'	SP7 @ 8'	SP7 @ 12'	SP7 @ 18'
Analyte	Method	Date	3/27/14	3/27/14	3/27/14	3/27/14	3/27/14
			mg/Kg	mg/Kg	mg/Kg	mg/Kg	mg/Kg
Benzene	BTEX 8021B		<0.050	n/a	n/a	n/a	n/a
Toluene	BTEX 8021B		<0.050	n/a	n/a	n/a	n/a
Ethylbenzene	BTEX 8021B		<0.050	n/a	n/a	n/a	n/a
Total Xylenes	BTEX 8021B		<0.150	n/a	n/a	n/a	n/a
Total BTEX	BTEX 8021B		<0.300	n/a	n/a	n/a	n/a
Chloride	SM4500Cl-B		416	9600	12800	11000	12200
GRO	TPH 8015M		<10.0	n/a	n/a	n/a	n/a
DRO	TPH 8015M		<10.0	n/a	n/a	n/a	n/a

Laboratory Analytical Results Summary
Corral Draw #2

		Sample	SB1 @ 18'	SB1 @ 25'	SB1 @ 30'	SB1 @ 35'	SB1 @ 43'	SB1 @ 51'	SB1 @ 54'	SB1 @ 56'
Analyte	Method	Date	7/1/14	7/1/14	7/1/14	7/1/14	7/1/14	7/1/14	7/1/14	7/1/14
			mg/Kg	mg/Kg	mg/Kg	mg/Kg	mg/Kg	mg/Kg	mg/Kg	mg/Kg
Chloride	SM4500Cl-B		4000	2960	2600	2440	1120	272	176	128

		Sample	SB2 @ 23'	SB2 @ 28'	SB2 @ 33'	SB2 @ 38'	SB2 @ 43'	SB2 @ 46'
Analyte	Method	Date	7/1/14	7/1/14	7/1/14	7/1/14	7/1/14	7/1/14
			mg/Kg	mg/Kg	mg/Kg	mg/Kg	mg/Kg	mg/Kg
Chloride	SM4500Cl-B		7120	6960	640	288	272	144

		Sample	SB3 @ 23'	SB3 @ 28'	SB3 @ 33'	SB3 @ 38'	SB3 @ 40'
Analyte	Method	Date	7/1/14	7/1/14	7/1/14	7/1/14	7/1/14
			mg/Kg	mg/Kg	mg/Kg	mg/Kg	mg/Kg
Chloride	SM4500Cl-B		3600	3600	272	112	176

April 04, 2014

Cliff Brunson

BBC International, Inc.

P.O. Box 805

Hobbs, NM 88241

RE: CORRAL DRAW #2

Enclosed are the results of analyses for samples received by the laboratory on 03/28/14 12:00.

Cardinal Laboratories is accredited through Texas NELAP under certificate number T104704398-13-5. Accreditation applies to drinking water, non-potable water and solid and chemical materials. All accredited analytes are denoted by an asterisk (*). For a complete list of accredited analytes and matrices visit the TCEQ website at www.tceq.texas.gov/field/qa/lab_accred_certif.html.

Cardinal Laboratories is accredited through the State of Colorado Department of Public Health and Environment for:

Method EPA 552.2	Haloacetic Acids (HAA-5)
Method EPA 524.2	Total Trihalomethanes (TTHM)
Method EPA 524.4	Regulated VOCs (V1, V2, V3)

Accreditation applies to public drinking water matrices.

This report meets NELAP requirements and is made up of a cover page, analytical results, and a copy of the original chain-of-custody. If you have any questions concerning this report, please feel free to contact me.

Sincerely,



Celey D. Keene

Lab Director/Quality Manager

Analytical Results For:

BBC International, Inc.
Cliff Brunson
P.O. Box 805
Hobbs NM, 88241
Fax To: (575) 397-0397

Received:	03/28/2014	Sampling Date:	03/20/2014
Reported:	04/04/2014	Sampling Type:	Soil
Project Name:	CORRAL DRAW #2	Sampling Condition:	Cool & Intact
Project Number:	NONE GIVEN	Sample Received By:	Jodi Henson
Project Location:	MALAGA, NM		

Sample ID: SP 1 @ 1' (H400930-01)

BTEX 8021B			mg/kg		Analyzed By: MS				
Analyte	Result	Reporting Limit	Analyzed	Method Blank	BS	% Recovery	True Value QC	RPD	Qualifier
Benzene*	<0.050	0.050	04/01/2014	ND	2.28	114	2.00	8.45	
Toluene*	<0.050	0.050	04/01/2014	ND	2.18	109	2.00	8.38	
Ethylbenzene*	<0.050	0.050	04/01/2014	ND	2.13	106	2.00	8.60	
Total Xylenes*	<0.150	0.150	04/01/2014	ND	6.26	104	6.00	7.23	
Total BTEX	<0.300	0.300	04/01/2014	ND					

Surrogate: 4-Bromofluorobenzene (PID) 110 % 89.4-126

Chloride, SM4500Cl-B			mg/kg		Analyzed By: AP				
Analyte	Result	Reporting Limit	Analyzed	Method Blank	BS	% Recovery	True Value QC	RPD	Qualifier
Chloride	656	16.0	04/02/2014	ND	400	100	400	0.00	

TPH 8015M			mg/kg		Analyzed By: ms				
Analyte	Result	Reporting Limit	Analyzed	Method Blank	BS	% Recovery	True Value QC	RPD	Qualifier
GRO C6-C10	<10.0	10.0	04/01/2014	ND	208	104	200	5.39	
DRO >C10-C28	<10.0	10.0	04/01/2014	ND	217	109	200	2.49	

Surrogate: 1-Chlorooctane 95.4 % 65.2-140

Surrogate: 1-Chlorooctadecane 96.6 % 63.6-154

Sample ID: SP 1 @ 4' (H400930-02)

Chloride, SM4500Cl-B			mg/kg		Analyzed By: AP				
Analyte	Result	Reporting Limit	Analyzed	Method Blank	BS	% Recovery	True Value QC	RPD	Qualifier
Chloride	2440	16.0	04/02/2014	ND	400	100	400	3.92	

Cardinal Laboratories

*=Accredited Analyte

PLEASE NOTE: Liability and Damages. Cardinal's liability and client's exclusive remedy for any claim arising, whether based in contract or tort, shall be limited to the amount paid by client for analyses. All claims, including those for negligence and any other cause whatsoever shall be deemed waived unless made in writing and received by Cardinal within thirty (30) days after completion of the applicable service. In no event shall Cardinal be liable for incidental or consequential damages, including, without limitation, business interruptions, loss of use, or loss of profits incurred by client, its subsidiaries, affiliates or successors arising out of or related to the performance of the services hereunder by Cardinal, regardless of whether such claim is based upon any of the above stated reasons or otherwise. Results relate only to the samples identified above. This report shall not be reproduced except in full with written approval of Cardinal Laboratories.



Celey D. Keene, Lab Director/Quality Manager

Analytical Results For:

BBC International, Inc.
Cliff Brunson
P.O. Box 805
Hobbs NM, 88241
Fax To: (575) 397-0397

Received: 03/28/2014
Reported: 04/04/2014
Project Name: CORRAL DRAW #2
Project Number: NONE GIVEN
Project Location: MALAGA, NM

Sampling Date: 03/20/2014
Sampling Type: Soil
Sampling Condition: Cool & Intact
Sample Received By: Jodi Henson

Sample ID: SP 1 @ 8' (H400930-03)

Chloride, SM4500Cl-B		mg/kg		Analyzed By: AP					
Analyte	Result	Reporting Limit	Analyzed	Method Blank	BS	% Recovery	True Value QC	RPD	Qualifier
Chloride	1760	16.0	04/02/2014	ND	400	100	400	3.92	

Sample ID: SP 1 @ 12' (H400930-04)

Chloride, SM4500Cl-B		mg/kg		Analyzed By: AP					
Analyte	Result	Reporting Limit	Analyzed	Method Blank	BS	% Recovery	True Value QC	RPD	Qualifier
Chloride	2320	16.0	04/02/2014	ND	400	100	400	3.92	

Sample ID: SP 1 @ 18' (H400930-05)

Chloride, SM4500Cl-B		mg/kg		Analyzed By: AP					
Analyte	Result	Reporting Limit	Analyzed	Method Blank	BS	% Recovery	True Value QC	RPD	Qualifier
Chloride	2560	16.0	04/02/2014	ND	400	100	400	3.92	

Cardinal Laboratories

*=Accredited Analyte

PLEASE NOTE: Liability and Damages. Cardinal's liability and client's exclusive remedy for any claim arising, whether based in contract or tort, shall be limited to the amount paid by client for analyses. All claims, including those for negligence and any other cause whatsoever shall be deemed waived unless made in writing and received by Cardinal within thirty (30) days after completion of the applicable service. In no event shall Cardinal be liable for incidental or consequential damages, including, without limitation, business interruptions, loss of use, or loss of profits incurred by client, its subsidiaries, affiliates or successors arising out of or related to the performance of the services hereunder by Cardinal, regardless of whether such claim is based upon any of the above stated reasons or otherwise. Results relate only to the samples identified above. This report shall not be reproduced except in full with written approval of Cardinal Laboratories.



Celey D. Keene, Lab Director/Quality Manager

Analytical Results For:

BBC International, Inc.
Cliff Brunson
P.O. Box 805
Hobbs NM, 88241
Fax To: (575) 397-0397

Received:	03/28/2014	Sampling Date:	03/24/2014
Reported:	04/04/2014	Sampling Type:	Soil
Project Name:	CORRAL DRAW #2	Sampling Condition:	Cool & Intact
Project Number:	NONE GIVEN	Sample Received By:	Jodi Henson
Project Location:	MALAGA, NM		

Sample ID: SP 2 @ 1' (H400930-06)

BTEx 8021B		mg/kg		Analyzed By: MS					
Analyte	Result	Reporting Limit	Analyzed	Method Blank	BS	% Recovery	True Value QC	RPD	Qualifier
Benzene*	<0.050	0.050	04/01/2014	ND	2.28	114	2.00	8.45	
Toluene*	<0.050	0.050	04/01/2014	ND	2.18	109	2.00	8.38	
Ethylbenzene*	<0.050	0.050	04/01/2014	ND	2.13	106	2.00	8.60	
Total Xylenes*	<0.150	0.150	04/01/2014	ND	6.26	104	6.00	7.23	
Total BTEx	<0.300	0.300	04/01/2014	ND					

Surrogate: 4-Bromofluorobenzene (PID) 110 % 89.4-126

Chloride, SM4500CI-B		mg/kg		Analyzed By: AP					
Analyte	Result	Reporting Limit	Analyzed	Method Blank	BS	% Recovery	True Value QC	RPD	Qualifier
Chloride	624	16.0	04/02/2014	ND	400	100	400	3.92	

TPH 8015M		mg/kg		Analyzed By: ms					
Analyte	Result	Reporting Limit	Analyzed	Method Blank	BS	% Recovery	True Value QC	RPD	Qualifier
GRO C6-C10	<10.0	10.0	04/01/2014	ND	208	104	200	5.39	
DRO >C10-C28	<10.0	10.0	04/01/2014	ND	217	109	200	2.49	

Surrogate: 1-Chlorooctane 93.6 % 65.2-140

Surrogate: 1-Chlorooctadecane 90.0 % 63.6-154

Sample ID: SP 2 @ 4' (H400930-07)

Chloride, SM4500Cl-B		mg/kg		Analyzed By: AP					
Analyte	Result	Reporting Limit	Analyzed	Method Blank	BS	% Recovery	True Value QC	RPD	Qualifier
Chloride	2680	16.0	04/02/2014	ND	400	100	400	3.92	

Cardinal Laboratories

*=Accredited Analyte

PLEASE NOTE: Liability and Damages. Cardinal's liability and client's exclusive remedy for any claim arising, whether based in contract or tort, shall be limited to the amount paid by client for analyses. All claims, including those for negligence and any other cause whatsoever shall be deemed waived unless made in writing and received by Cardinal within thirty (30) days after completion of the applicable service. In no event shall Cardinal be liable for incidental or consequential damages, including, without limitation, business interruptions, loss of use, or loss of profits incurred by client, its subsidiaries, affiliates or successors arising out of or related to the performance of the services hereunder by Cardinal, regardless of whether such claim is based upon any of the above stated reasons or otherwise. Results relate only to the samples identified above. This report shall not be reproduced except in full with written approval of Cardinal Laboratories.



Celey D. Keene, Lab Director/Quality Manager

Analytical Results For:

 BBC International, Inc.
 Cliff Brunson
 P.O. Box 805
 Hobbs NM, 88241
 Fax To: (575) 397-0397

Received:	03/28/2014	Sampling Date:	03/24/2014
Reported:	04/04/2014	Sampling Type:	Soil
Project Name:	CORRAL DRAW #2	Sampling Condition:	Cool & Intact
Project Number:	NONE GIVEN	Sample Received By:	Jodi Henson
Project Location:	MALAGA, NM		

Sample ID: SP 2 @ 8' (H400930-08)

Chloride, SM4500Cl-B		mg/kg		Analyzed By: AP					
Analyte	Result	Reporting Limit	Analyzed	Method Blank	BS	% Recovery	True Value QC	RPD	Qualifier
Chloride	3680	16.0	04/02/2014	ND	400	100	400	3.92	

Sample ID: SP 2 @ 12' (H400930-09)

Chloride, SM4500Cl-B		mg/kg		Analyzed By: AP					
Analyte	Result	Reporting Limit	Analyzed	Method Blank	BS	% Recovery	True Value QC	RPD	Qualifier
Chloride	3280	16.0	04/02/2014	ND	400	100	400	3.92	

Sample ID: SP 2 @ 18' (H400930-10)

Chloride, SM4500Cl-B		mg/kg		Analyzed By: AP					
Analyte	Result	Reporting Limit	Analyzed	Method Blank	BS	% Recovery	True Value QC	RPD	Qualifier
Chloride	3120	16.0	04/02/2014	ND	400	100	400	3.92	

Cardinal Laboratories

*=Accredited Analyte

PLEASE NOTE: Liability and Damages. Cardinal's liability and client's exclusive remedy for any claim arising, whether based in contract or tort, shall be limited to the amount paid by client for analyses. All claims, including those for negligence and any other cause whatsoever shall be deemed waived unless made in writing and received by Cardinal within thirty (30) days after completion of the applicable service. In no event shall Cardinal be liable for incidental or consequential damages, including, without limitation, business interruptions, loss of use, or loss of profits incurred by client, its subsidiaries, affiliates or successors arising out of or related to the performance of the services hereunder by Cardinal, regardless of whether such claim is based upon any of the above stated reasons or otherwise. Results relate only to the samples identified above. This report shall not be reproduced except in full with written approval of Cardinal Laboratories.



Celey D. Keene, Lab Director/Quality Manager

Analytical Results For:

BBC International, Inc.
Cliff Brunson
P.O. Box 805
Hobbs NM, 88241
Fax To: (575) 397-0397

Received:	03/28/2014	Sampling Date:	03/24/2014
Reported:	04/04/2014	Sampling Type:	Soil
Project Name:	CORRAL DRAW #2	Sampling Condition:	Cool & Intact
Project Number:	NONE GIVEN	Sample Received By:	Jodi Henson
Project Location:	MALAGA, NM		

Sample ID: SP3 @ 1' (H400930-11)

BTEx 8021B		mg/kg		Analyzed By: MS					
Analyte	Result	Reporting Limit	Analyzed	Method Blank	BS	% Recovery	True Value QC	RPD	Qualifier
Benzene*	<0.050	0.050	04/01/2014	ND	2.28	114	2.00	8.45	
Toluene*	<0.050	0.050	04/01/2014	ND	2.18	109	2.00	8.38	
Ethylbenzene*	<0.050	0.050	04/01/2014	ND	2.13	106	2.00	8.60	
Total Xylenes*	<0.150	0.150	04/01/2014	ND	6.26	104	6.00	7.23	
Total BTEx	<0.300	0.300	04/01/2014	ND					

Surrogate: 4-Bromofluorobenzene (PID) 111 % 89.4-126

Chloride, SM4500CI-B		mg/kg		Analyzed By: AP					
Analyte	Result	Reporting Limit	Analyzed	Method Blank	BS	% Recovery	True Value QC	RPD	Qualifier
Chloride	40000	16.0	04/02/2014	ND	400	100	400	3.92	

TPH 8015M		mg/kg		Analyzed By: ms					
Analyte	Result	Reporting Limit	Analyzed	Method Blank	BS	% Recovery	True Value QC	RPD	Qualifier
GRO C6-C10	<10.0	10.0	04/01/2014	ND	208	104	200	5.39	
DRO >C10-C28	<10.0	10.0	04/01/2014	ND	217	109	200	2.49	

Surrogate: 1-Chlorooctane 91.3 % 65.2-140

Surrogate: 1-Chlorooctadecane 89.4 % 63.6-154

Sample ID: SP3 @ 4' (H400930-12)

Chloride, SM4500Cl-B		mg/kg		Analyzed By: AP					
Analyte	Result	Reporting Limit	Analyzed	Method Blank	BS	% Recovery	True Value QC	RPD	Qualifier
Chloride	10100	16.0	04/02/2014	ND	400	100	400	3.92	

Cardinal Laboratories

*=Accredited Analyte

PLEASE NOTE: Liability and Damages. Cardinal's liability and client's exclusive remedy for any claim arising, whether based in contract or tort, shall be limited to the amount paid by client for analyses. All claims, including those for negligence and any other cause whatsoever shall be deemed waived unless made in writing and received by Cardinal within thirty (30) days after completion of the applicable service. In no event shall Cardinal be liable for incidental or consequential damages, including, without limitation, business interruptions, loss of use, or loss of profits incurred by client, its subsidiaries, affiliates or successors arising out of or related to the performance of the services hereunder by Cardinal, regardless of whether such claim is based upon any of the above stated reasons or otherwise. Results relate only to the samples identified above. This report shall not be reproduced except in full with written approval of Cardinal Laboratories.



Celey D. Keene, Lab Director/Quality Manager

Analytical Results For:

 BBC International, Inc.
 Cliff Brunson
 P.O. Box 805
 Hobbs NM, 88241
 Fax To: (575) 397-0397

Received:	03/28/2014	Sampling Date:	03/25/2014
Reported:	04/04/2014	Sampling Type:	Soil
Project Name:	CORRAL DRAW #2	Sampling Condition:	Cool & Intact
Project Number:	NONE GIVEN	Sample Received By:	Jodi Henson
Project Location:	MALAGA, NM		

Sample ID: SP3 @ 8' (H400930-13)

Chloride, SM4500Cl-B		mg/kg		Analyzed By: AP						
Analyte	Result	Reporting Limit	Analyzed	Method Blank	BS	% Recovery	True Value QC	RPD	Qualifier	
Chloride	864	16.0	04/02/2014	ND	400	100	400	3.92		

Sample ID: SP3 @ 12' (H400930-14)

Chloride, SM4500Cl-B		mg/kg		Analyzed By: AP					
Analyte	Result	Reporting Limit	Analyzed	Method Blank	BS	% Recovery	True Value QC	RPD	Qualifier
Chloride	384	16.0	04/02/2014	ND	400	100	400	3.92	

Sample ID: SP3 @ 16' (H400930-15)

Chloride, SM4500Cl-B		mg/kg		Analyzed By: AP					
Analyte	Result	Reporting Limit	Analyzed	Method Blank	BS	% Recovery	True Value QC	RPD	Qualifier
Chloride	176	16.0	04/02/2014	ND	400	100	400	3.92	

Cardinal Laboratories

*=Accredited Analyte

PLEASE NOTE: Liability and Damages. Cardinal's liability and client's exclusive remedy for any claim arising, whether based in contract or tort, shall be limited to the amount paid by client for analyses. All claims, including those for negligence and any other cause whatsoever shall be deemed waived unless made in writing and received by Cardinal within thirty (30) days after completion of the applicable service. In no event shall Cardinal be liable for incidental or consequential damages, including, without limitation, business interruptions, loss of use, or loss of profits incurred by client, its subsidiaries, affiliates or successors arising out of or related to the performance of the services hereunder by Cardinal, regardless of whether such claim is based upon any of the above stated reasons or otherwise. Results relate only to the samples identified above. This report shall not be reproduced except in full with written approval of Cardinal Laboratories.



Celey D. Keene, Lab Director/Quality Manager

Analytical Results For:

BBC International, Inc.
Cliff Brunson
P.O. Box 805
Hobbs NM, 88241
Fax To: (575) 397-0397

Received:	03/28/2014	Sampling Date:	03/25/2014
Reported:	04/04/2014	Sampling Type:	Soil
Project Name:	CORRAL DRAW #2	Sampling Condition:	Cool & Intact
Project Number:	NONE GIVEN	Sample Received By:	Jodi Henson
Project Location:	MALAGA, NM		

Sample ID: SP4 @ 1' (H400930-16)

BTEx 8021B		mg/kg		Analyzed By: MS						
Analyte	Result	Reporting Limit	Analyzed	Method Blank	BS	% Recovery	True Value QC	RPD	Qualifier	
Benzene*	<0.050	0.050	04/02/2014	ND	2.64	132	2.00	4.76		
Toluene*	<0.050	0.050	04/02/2014	ND	2.55	128	2.00	5.08		
Ethylbenzene*	<0.050	0.050	04/02/2014	ND	2.51	126	2.00	4.96		
Total Xylenes*	<0.150	0.150	04/02/2014	ND	7.31	122	6.00	5.65		
Total BTEX	<0.300	0.300	04/02/2014	ND						

Surrogate: 4-Bromofluorobenzene (PID) 113 % 89.4-126

Chloride, SM4500Cl-B		mg/kg		Analyzed By: AP					
Analyte	Result	Reporting Limit	Analyzed	Method Blank	BS	% Recovery	True Value QC	RPD	Qualifier
Chloride	4880	16.0	04/02/2014	ND	400	100	400	3.92	

TPH 8015M		mg/kg		Analyzed By: ms					
Analyte	Result	Reporting Limit	Analyzed	Method Blank	BS	% Recovery	True Value QC	RPD	Qualifier
GRO C6-C10	<10.0	10.0	04/01/2014	ND	208	104	200	5.39	
DRO >C10-C28	<10.0	10.0	04/01/2014	ND	217	109	200	2.49	

Surrogate: 1-Chlorooctane 82.7 % 65.2-140

Surrogate: 1-Chlorooctadecane 76.1 % 63.6-154

Sample ID: SP4 @ 4' (H400930-17)

Chloride, SM4500Cl-B		mg/kg		Analyzed By: AP						
Analyte	Result	Reporting Limit	Analyzed	Method Blank	BS	% Recovery	True Value QC	RPD	Qualifier	
Chloride	10300	16.0	04/02/2014	ND	400	100	400	3.92		

Cardinal Laboratories

*=Accredited Analyte

PLEASE NOTE: Liability and Damages. Cardinal's liability and client's exclusive remedy for any claim arising, whether based in contract or tort, shall be limited to the amount paid by client for analyses. All claims, including those for negligence and any other cause whatsoever shall be deemed waived unless made in writing and received by Cardinal within thirty (30) days after completion of the applicable service. In no event shall Cardinal be liable for incidental or consequential damages, including, without limitation, business interruptions, loss of use, or loss of profits incurred by client, its subsidiaries, affiliates or successors arising out of or related to the performance of the services hereunder by Cardinal, regardless of whether such claim is based upon any of the above stated reasons or otherwise. Results relate only to the samples identified above. This report shall not be reproduced except in full with written approval of Cardinal Laboratories.



Celey D. Keene, Lab Director/Quality Manager

Analytical Results For:

BBC International, Inc.
Cliff Brunson
P.O. Box 805
Hobbs NM, 88241
Fax To: (575) 397-0397

Received: 03/28/2014
Reported: 04/04/2014
Project Name: CORRAL DRAW #2
Project Number: NONE GIVEN
Project Location: MALAGA, NM

Sampling Date: 03/25/2014
Sampling Type: Soil
Sampling Condition: Cool & Intact
Sample Received By: Jodi Henson

Sample ID: SP4 @ 8' (H400930-18)

Chloride, SM4500CI-B		mg/kg		Analyzed By: AP						
Analyte	Result	Reporting Limit	Analyzed	Method Blank	BS	% Recovery	True Value QC	RPD	Qualifier	
Chloride	5600	16.0	04/02/2014	ND	400	100	400	3.92		

Sample ID: SP4 @ 12' (H400930-19)

Chloride, SM4500CI-B		mg/kg		Analyzed By: AP					
Analyte	Result	Reporting Limit	Analyzed	Method Blank	BS	% Recovery	True Value QC	RPD	Qualifier
Chloride	4640	16.0	04/02/2014	ND	400	100	400	3.92	

Sample ID: SP4 @ 18' (H400930-20)

Chloride, SM4500CI-B		mg/kg		Analyzed By: AP					
Analyte	Result	Reporting Limit	Analyzed	Method Blank	BS	% Recovery	True Value QC	RPD	Qualifier
Chloride	3840	16.0	04/02/2014	ND	400	100	400	3.92	

Cardinal Laboratories

*=Accredited Analyte

PLEASE NOTE: Liability and Damages. Cardinal's liability and client's exclusive remedy for any claim arising, whether based in contract or tort, shall be limited to the amount paid by client for analyses. All claims, including those for negligence and any other cause whatsoever shall be deemed waived unless made in writing and received by Cardinal within thirty (30) days after completion of the applicable service. In no event shall Cardinal be liable for incidental or consequential damages, including, without limitation, business interruptions, loss of use, or loss of profits incurred by client, its subsidiaries, affiliates or successors arising out of or related to the performance of the services hereunder by Cardinal, regardless of whether such claim is based upon any of the above stated reasons or otherwise. Results relate only to the samples identified above. This report shall not be reproduced except in full with written approval of Cardinal Laboratories.



Celey D. Keene, Lab Director/Quality Manager

Analytical Results For:

BBC International, Inc.
Cliff Brunson
P.O. Box 805
Hobbs NM, 88241
Fax To: (575) 397-0397

Received:	03/28/2014	Sampling Date:	03/26/2014
Reported:	04/04/2014	Sampling Type:	Soil
Project Name:	CORRAL DRAW #2	Sampling Condition:	Cool & Intact
Project Number:	NONE GIVEN	Sample Received By:	Jodi Henson
Project Location:	MALAGA, NM		

Sample ID: SP5 @ 1' (H400930-21)

BTX 8021B			mg/kg		Analyzed By: MS				
Analyte	Result	Reporting Limit	Analyzed	Method Blank	BS	% Recovery	True Value QC	RPD	Qualifier
Benzene*	<0.050	0.050	04/02/2014	ND	2.64	132	2.00	4.76	
Toluene*	<0.050	0.050	04/02/2014	ND	2.55	128	2.00	5.08	
Ethylbenzene*	<0.050	0.050	04/02/2014	ND	2.51	126	2.00	4.96	
Total Xylenes*	<0.150	0.150	04/02/2014	ND	7.31	122	6.00	5.65	
Total BTX	<0.300	0.300	04/02/2014	ND					

Surrogate: 4-Bromofluorobenzene (PID) 112 % 89.4-126

Chloride, SM4500CI-B			mg/kg		Analyzed By: AP				
Analyte	Result	Reporting Limit	Analyzed	Method Blank	BS	% Recovery	True Value QC	RPD	Qualifier
Chloride	2000	16.0	04/02/2014	ND	400	100	400	3.92	

TPH 8015M			mg/kg		Analyzed By: ms				
Analyte	Result	Reporting Limit	Analyzed	Method Blank	BS	% Recovery	True Value QC	RPD	Qualifier
GRO C6-C10	<10.0	10.0	04/01/2014	ND	208	104	200	5.39	
DRO >C10-C28	<10.0	10.0	04/01/2014	ND	217	109	200	2.49	

Surrogate: 1-Chlorooctane 95.3 % 65.2-140

Surrogate: 1-Chlorooctadecane 95.1 % 63.6-154

Sample ID: SP5 @ 4' (H400930-22)

Chloride, SM4500CI-B			mg/kg		Analyzed By: AP				
Analyte	Result	Reporting Limit	Analyzed	Method Blank	BS	% Recovery	True Value QC	RPD	Qualifier
Chloride	8640	16.0	04/02/2014	ND	432	108	400	0.00	

Cardinal Laboratories

*=Accredited Analyte

PLEASE NOTE: Liability and Damages. Cardinal's liability and client's exclusive remedy for any claim arising, whether based in contract or tort, shall be limited to the amount paid by client for analyses. All claims, including those for negligence and any other cause whatsoever shall be deemed waived unless made in writing and received by Cardinal within thirty (30) days after completion of the applicable service. In no event shall Cardinal be liable for incidental or consequential damages, including, without limitation, business interruptions, loss of use, or loss of profits incurred by client, its subsidiaries, affiliates or successors arising out of or related to the performance of the services hereunder by Cardinal, regardless of whether such claim is based upon any of the above stated reasons or otherwise. Results relate only to the samples identified above. This report shall not be reproduced except in full with written approval of Cardinal Laboratories.



Celey D. Keene, Lab Director/Quality Manager

Analytical Results For:

 BBC International, Inc.
 Cliff Brunson
 P.O. Box 805
 Hobbs NM, 88241
 Fax To: (575) 397-0397

Received:	03/28/2014	Sampling Date:	03/26/2014
Reported:	04/04/2014	Sampling Type:	Soil
Project Name:	CORRAL DRAW #2	Sampling Condition:	Cool & Intact
Project Number:	NONE GIVEN	Sample Received By:	Jodi Henson
Project Location:	MALAGA, NM		

Sample ID: SP5 @ 8' (H400930-23)

Chloride, SM4500Cl-B		mg/kg		Analyzed By: AP						
Analyte	Result	Reporting Limit	Analyzed	Method Blank	BS	% Recovery	True Value QC	RPD	Qualifier	
Chloride	992	16.0	04/02/2014	ND	432	108	400	0.00		

Sample ID: SP5 @ 12' (H400930-24)

Chloride, SM4500Cl-B		mg/kg		Analyzed By: AP					
Analyte	Result	Reporting Limit	Analyzed	Method Blank	BS	% Recovery	True Value QC	RPD	Qualifier
Chloride	720	16.0	04/02/2014	ND	432	108	400	0.00	

Sample ID: SP5 @ 15' (H400930-25)

Chloride, SM4500Cl-B		mg/kg		Analyzed By: AP					
Analyte	Result	Reporting Limit	Analyzed	Method Blank	BS	% Recovery	True Value QC	RPD	Qualifier
Chloride	256	16.0	04/02/2014	ND	432	108	400	0.00	

Cardinal Laboratories

*=Accredited Analyte

PLEASE NOTE: Liability and Damages. Cardinal's liability and client's exclusive remedy for any claim arising, whether based in contract or tort, shall be limited to the amount paid by client for analyses. All claims, including those for negligence and any other cause whatsoever shall be deemed waived unless made in writing and received by Cardinal within thirty (30) days after completion of the applicable service. In no event shall Cardinal be liable for incidental or consequential damages, including, without limitation, business interruptions, loss of use, or loss of profits incurred by client, its subsidiaries, affiliates or successors arising out of or related to the performance of the services hereunder by Cardinal, regardless of whether such claim is based upon any of the above stated reasons or otherwise. Results relate only to the samples identified above. This report shall not be reproduced except in full with written approval of Cardinal Laboratories.



Celey D. Keene, Lab Director/Quality Manager

Analytical Results For:

BBC International, Inc.
Cliff Brunson
P.O. Box 805
Hobbs NM, 88241
Fax To: (575) 397-0397

Received:	03/28/2014	Sampling Date:	03/26/2014
Reported:	04/04/2014	Sampling Type:	Soil
Project Name:	CORRAL DRAW #2	Sampling Condition:	Cool & Intact
Project Number:	NONE GIVEN	Sample Received By:	Jodi Henson
Project Location:	MALAGA, NM		

Sample ID: SP6 @ 1' (H400930-26)

BTEx 8021B		mg/kg		Analyzed By: MS					
Analyte	Result	Reporting Limit	Analyzed	Method Blank	BS	% Recovery	True Value QC	RPD	Qualifier
Benzene*	<0.050	0.050	04/02/2014	ND	2.64	132	2.00	4.76	
Toluene*	<0.050	0.050	04/02/2014	ND	2.55	128	2.00	5.08	
Ethylbenzene*	<0.050	0.050	04/02/2014	ND	2.51	126	2.00	4.96	
Total Xylenes*	<0.150	0.150	04/02/2014	ND	7.31	122	6.00	5.65	
Total BTEX	<0.300	0.300	04/02/2014	ND					

Surrogate: 4-Bromofluorobenzene (PID) 112 % 89.4-126

Chloride, SM4500Cl-B		mg/kg		Analyzed By: AP					
Analyte	Result	Reporting Limit	Analyzed	Method Blank	BS	% Recovery	True Value QC	RPD	Qualifier
Chloride	1600	16.0	04/02/2014	ND	432	108	400	0.00	

TPH 8015M		mg/kg		Analyzed By: ms					
Analyte	Result	Reporting Limit	Analyzed	Method Blank	BS	% Recovery	True Value QC	RPD	Qualifier
GRO C6-C10	<10.0	10.0	04/01/2014	ND	208	104	200	5.39	
DRO >C10-C28	<10.0	10.0	04/01/2014	ND	217	109	200	2.49	

Surrogate: 1-Chlorooctane 99.3 % 65.2-140

Surrogate: 1-Chlorooctadecane 94.0 % 63.6-154

Sample ID: SP6 @ 4' (H400930-27)

Chloride, SM4500Cl-B		mg/kg		Analyzed By: AP					
Analyte	Result	Reporting Limit	Analyzed	Method Blank	BS	% Recovery	True Value QC	RPD	Qualifier
Chloride	8200	16.0	04/02/2014	ND	432	108	400	0.00	

Cardinal Laboratories

*=Accredited Analyte

PLEASE NOTE: Liability and Damages. Cardinal's liability and client's exclusive remedy for any claim arising, whether based in contract or tort, shall be limited to the amount paid by client for analyses. All claims, including those for negligence and any other cause whatsoever shall be deemed waived unless made in writing and received by Cardinal within thirty (30) days after completion of the applicable service. In no event shall Cardinal be liable for incidental or consequential damages, including, without limitation, business interruptions, loss of use, or loss of profits incurred by client, its subsidiaries, affiliates or successors arising out of or related to the performance of the services hereunder by Cardinal, regardless of whether such claim is based upon any of the above stated reasons or otherwise. Results relate only to the samples identified above. This report shall not be reproduced except in full with written approval of Cardinal Laboratories.



Celey D. Keene, Lab Director/Quality Manager

Analytical Results For:

 BBC International, Inc.
 Cliff Brunson
 P.O. Box 805
 Hobbs NM, 88241
 Fax To: (575) 397-0397

Received:	03/28/2014	Sampling Date:	03/26/2014
Reported:	04/04/2014	Sampling Type:	Soil
Project Name:	CORRAL DRAW #2	Sampling Condition:	Cool & Intact
Project Number:	NONE GIVEN	Sample Received By:	Jodi Henson
Project Location:	MALAGA, NM		

Sample ID: SP6 @ 8' (H400930-28)

Chloride, SM4500Cl-B		mg/kg		Analyzed By: AP						
Analyte	Result	Reporting Limit	Analyzed	Method Blank	BS	% Recovery	True Value QC	RPD	Qualifier	
Chloride	976	16.0	04/02/2014	ND	432	108	400	0.00		

Sample ID: SP6 @ 12' (H400930-29)

Chloride, SM4500Cl-B		mg/kg		Analyzed By: AP					
Analyte	Result	Reporting Limit	Analyzed	Method Blank	BS	% Recovery	True Value QC	RPD	Qualifier
Chloride	720	16.0	04/02/2014	ND	432	108	400	0.00	

Sample ID: SP6 @ 15' (H400930-30)

Chloride, SM4500Cl-B		mg/kg		Analyzed By: AP					
Analyte	Result	Reporting Limit	Analyzed	Method Blank	BS	% Recovery	True Value QC	RPD	Qualifier
Chloride	208	16.0	04/02/2014	ND	432	108	400	0.00	

Cardinal Laboratories

*=Accredited Analyte

PLEASE NOTE: Liability and Damages. Cardinal's liability and client's exclusive remedy for any claim arising, whether based in contract or tort, shall be limited to the amount paid by client for analyses. All claims, including those for negligence and any other cause whatsoever shall be deemed waived unless made in writing and received by Cardinal within thirty (30) days after completion of the applicable service. In no event shall Cardinal be liable for incidental or consequential damages, including, without limitation, business interruptions, loss of use, or loss of profits incurred by client, its subsidiaries, affiliates or successors arising out of or related to the performance of the services hereunder by Cardinal, regardless of whether such claim is based upon any of the above stated reasons or otherwise. Results relate only to the samples identified above. This report shall not be reproduced except in full with written approval of Cardinal Laboratories.



Celey D. Keene, Lab Director/Quality Manager

Analytical Results For:

BBC International, Inc.
Cliff Brunson
P.O. Box 805
Hobbs NM, 88241
Fax To: (575) 397-0397

Received:	03/28/2014	Sampling Date:	03/27/2014
Reported:	04/04/2014	Sampling Type:	Soil
Project Name:	CORRAL DRAW #2	Sampling Condition:	Cool & Intact
Project Number:	NONE GIVEN	Sample Received By:	Jodi Henson
Project Location:	MALAGA, NM		

Sample ID: SP7 @ 1' (H400930-31)

BTEx 8021B		mg/kg		Analyzed By: MS						
Analyte	Result	Reporting Limit	Analyzed	Method Blank	BS	% Recovery	True Value QC	RPD	Qualifier	
Benzene*	<0.050	0.050	04/02/2014	ND	2.64	132	2.00	4.76		
Toluene*	<0.050	0.050	04/02/2014	ND	2.55	128	2.00	5.08		
Ethylbenzene*	<0.050	0.050	04/02/2014	ND	2.51	126	2.00	4.96		
Total Xylenes*	<0.150	0.150	04/02/2014	ND	7.31	122	6.00	5.65		
Total BTEX	<0.300	0.300	04/02/2014	ND						

Surrogate: 4-Bromofluorobenzene (PID) 110 % 89.4-126

Chloride, SM4500Cl-B		mg/kg		Analyzed By: AP					
Analyte	Result	Reporting Limit	Analyzed	Method Blank	BS	% Recovery	True Value QC	RPD	Qualifier
Chloride	416	16.0	04/02/2014	ND	432	108	400	0.00	

TPH 8015M		mg/kg		Analyzed By: ms					
Analyte	Result	Reporting Limit	Analyzed	Method Blank	BS	% Recovery	True Value QC	RPD	Qualifier
GRO C6-C10	<10.0	10.0	04/01/2014	ND	208	104	200	5.39	
DRO >C10-C28	<10.0	10.0	04/01/2014	ND	217	109	200	2.49	

Surrogate: 1-Chlorooctane 108 % 65.2-140

Surrogate: 1-Chlorooctadecane 102 % 63.6-154

Sample ID: SP7 @ 4' (H400930-32)

Chloride, SM4500Cl-B		mg/kg		Analyzed By: AP					
Analyte	Result	Reporting Limit	Analyzed	Method Blank	BS	% Recovery	True Value QC	RPD	Qualifier
Chloride	9600	16.0	04/02/2014	ND	432	108	400	0.00	

Cardinal Laboratories

*=Accredited Analyte

PLEASE NOTE: Liability and Damages. Cardinal's liability and client's exclusive remedy for any claim arising, whether based in contract or tort, shall be limited to the amount paid by client for analyses. All claims, including those for negligence and any other cause whatsoever shall be deemed waived unless made in writing and received by Cardinal within thirty (30) days after completion of the applicable service. In no event shall Cardinal be liable for incidental or consequential damages, including, without limitation, business interruptions, loss of use, or loss of profits incurred by client, its subsidiaries, affiliates or successors arising out of or related to the performance of the services hereunder by Cardinal, regardless of whether such claim is based upon any of the above stated reasons or otherwise. Results relate only to the samples identified above. This report shall not be reproduced except in full with written approval of Cardinal Laboratories.



Celey D. Keene, Lab Director/Quality Manager

Analytical Results For:

BBC International, Inc.
Cliff Brunson
P.O. Box 805
Hobbs NM, 88241
Fax To: (575) 397-0397

Received: 03/28/2014
Reported: 04/04/2014
Project Name: CORRAL DRAW #2
Project Number: NONE GIVEN
Project Location: MALAGA, NM

Sampling Date: 03/27/2014
Sampling Type: Soil
Sampling Condition: Cool & Intact
Sample Received By: Jodi Henson

Sample ID: SP7 @ 8' (H400930-33)

Chloride, SM4500Cl-B		mg/kg		Analyzed By: AP						
Analyte	Result	Reporting Limit	Analyzed	Method Blank	BS	% Recovery	True Value QC	RPD	Qualifier	
Chloride	12800	16.0	04/02/2014	ND	432	108	400	0.00		

Sample ID: SP7 @ 12' (H400930-34)

Chloride, SM4500Cl-B		mg/kg		Analyzed By: AP					
Analyte	Result	Reporting Limit	Analyzed	Method Blank	BS	% Recovery	True Value QC	RPD	Qualifier
Chloride	11000	16.0	04/02/2014	ND	432	108	400	0.00	

Sample ID: SP7 @ 18' (H400930-35)

Chloride, SM4500Cl-B		mg/kg		Analyzed By: AP						
Analyte	Result	Reporting Limit	Analyzed	Method Blank	BS	% Recovery	True Value QC	RPD	Qualifier	
Chloride	12200	16.0	04/02/2014	ND	432	108	400	0.00		

Cardinal Laboratories

*=Accredited Analyte

PLEASE NOTE: Liability and Damages. Cardinal's liability and client's exclusive remedy for any claim arising, whether based in contract or tort, shall be limited to the amount paid by client for analyses. All claims, including those for negligence and any other cause whatsoever shall be deemed waived unless made in writing and received by Cardinal within thirty (30) days after completion of the applicable service. In no event shall Cardinal be liable for incidental or consequential damages, including, without limitation, business interruptions, loss of use, or loss of profits incurred by client, its subsidiaries, affiliates or successors arising out of or related to the performance of the services hereunder by Cardinal, regardless of whether such claim is based upon any of the above stated reasons or otherwise. Results relate only to the samples identified above. This report shall not be reproduced except in full with written approval of Cardinal Laboratories.



Celey D. Keene, Lab Director/Quality Manager

Notes and Definitions

ND	Analyte NOT DETECTED at or above the reporting limit
RPD	Relative Percent Difference
**	Samples not received at proper temperature of 6°C or below.
***	Insufficient time to reach temperature.
-	Chloride by SM4500Cl-B does not require samples be received at or below 6°C Samples reported on an as received basis (wet) unless otherwise noted on report

Cardinal Laboratories

*=Accredited Analyte

PLEASE NOTE: Liability and Damages. Cardinal's liability and client's exclusive remedy for any claim arising, whether based in contract or tort, shall be limited to the amount paid by client for analyses. All claims, including those for negligence and any other cause whatsoever shall be deemed waived unless made in writing and received by Cardinal within thirty (30) days after completion of the applicable service. In no event shall Cardinal be liable for incidental or consequential damages, including, without limitation, business interruptions, loss of use, or loss of profits incurred by client, its subsidiaries, affiliates or successors arising out of or related to the performance of the services hereunder by Cardinal, regardless of whether such claim is based upon any of the above stated reasons or otherwise. Results relate only to the samples identified above. This report shall not be reproduced except in full with written approval of Cardinal Laboratories.



Celey D. Keene, Lab Director/Quality Manager



ARDINAL LABORATORIES

101 East Marland, Hobbs, NM 88240
(505) 393-2326 FAX (505) 393-2476

CHAIN-OF-CUSTODY AND ANALYSIS REQUEST

BILL TO

ANALYSIS REQUEST

P.O. #:

Company:

Attn:

Address:

City:

State:

Phone #:

Fax #:

Company Name: BBC International, Inc.

Project Manager: Cliff Brunson

Address: P.O. Box 805

City: Hobbs

Phone #: 575-397-6388

Project #:

Project Name:

Project Location:

Sample Name:

FOR LAB USE ONLY

Lab I.D.

Sample I.D.

Relinquished By:

Delivered By: (Circle One)

Sampler - UPS - Bus - Other:

Cardinal cannot accept verbal changes. Please fax written changes to 505-393-2476

PLEASE NOTE: Liability and Damages. Cardinal's liability and client's exclusive remedy for any claim arising from this contract or for, shall be limited to the amount paid by the client for the analysis. All claims including those for negligence and any other cause whatsoever shall be deemed waived unless made in writing and received by Cardinal within 30 days after completion of the applicable service. In no event shall Cardinal be liable for incidental or consequential damages, including without limitation, business interruptions, loss of use, or loss of profits incurred by client, its subsidiaries, affiliates or successors arising out of or related to the performance of services hereunder by Cardinal, regardless of whether such claim is based upon any of the above stated reasons or otherwise.

Relinquished By:

Delivered By: (Circle One)

Sampler - UPS - Bus - Other:

Cardinal cannot accept verbal changes. Please fax written changes to 505-393-2476

PLEASE NOTE: Liability and Damages. Cardinal's liability and client's exclusive remedy for any claim arising from this contract or for, shall be limited to the amount paid by the client for the analysis. All claims including those for negligence and any other cause whatsoever shall be deemed waived unless made in writing and received by Cardinal within 30 days after completion of the applicable service. In no event shall Cardinal be liable for incidental or consequential damages, including without limitation, business interruptions, loss of use, or loss of profits incurred by client, its subsidiaries, affiliates or successors arising out of or related to the performance of services hereunder by Cardinal, regardless of whether such claim is based upon any of the above stated reasons or otherwise.

Relinquished By:

Delivered By: (Circle One)

Sampler - UPS - Bus - Other:

Cardinal cannot accept verbal changes. Please fax written changes to 505-393-2476

BILL TO		ANALYSIS REQUEST									
P.O. #:											
Company:											
Attn:											
Address:											
City:											
State:											
Phone #:											
Fax #:											
Project #:											
Project Name:											
Project Location:											
Sample Name:											
FOR LAB USE ONLY											
Lab I.D.											
Sample I.D.											
Relinquished By:											
Delivered By: (Circle One)											
Sampler - UPS - Bus - Other:											
Cardinal cannot accept verbal changes. Please fax written changes to 505-393-2476											



ARDINAL LABORATORIES

101 East Marland, Hobbs, NM 88240
(505) 393-2326 FAX (505) 393-2476

CHAIN-OF-CUSTODY AND ANALYSIS REQUEST

214

Company Name: BBC International, Inc.

Project Manager: Cliff Brunson

Address: P.O. Box 805

City: Hobbs

Phone #: 575-397-6388

Project #:

Project Name: Correl Draw #2

Project Location: M2/292 Wm

Sample Name: 1st Drills

P.O. #:

Company:

Attn:

Address:

City:

State:

Phone #:

Fax #:

BILL TO

ANALYSIS REQUEST

Lab I.D.

Sample I.D.

Lab I.D.	Sample I.D.	(G)RAB OR (C)OMP.	# CONTAINERS	MATRIX					DATE	TIME	ANALYSIS REQUEST									
				GROUNDWATER	WASTEWATER	SOIL	OIL	SLUDGE	OTHER :											
H40830	SP301	G-1	1							3-24	225	CL-								
11	04	G-1	1							3-24	251	BTEX								
12	06	G-1	1							3-25	923	TPH								
13	012	G-1	1																	
14	016	G-1	1																	
15	04	G-1	1																	
16	08	G-1	1																	
17	012	G-1	1																	
18	016	G-1	1																	
19	04	G-1	1																	
20	08	G-1	1																	

PLEASE NOTE: Liability and Damages. Cardinal's liability and its exclusive remedy for any claim arising whether based in contract or tort, shall be limited to the amount paid by the client for the analyses. All claims, including those for negligence and any other cause whatsoever shall be deemed waived unless made in writing and received by Cardinal within 30 days after completion of the applicable service. In no event shall Cardinal be liable for incidental or consequential damages, including without limitation, business interruptions, loss of use, or loss of profits incurred by client, its subsidiaries, affiliates or successors arising out of or related to the performance of services hereunder by Cardinal, regardless of whether such claim is based upon any of the above stated reasons or otherwise.

Relinquished By:

Date: 3-25-04 Received By:

Phone Result:

Fax Result:

Yes

No

Add'l Phone #:

Add'l Fax #:

REMARKS:

Relinquished By:

Date: 3-25-04 Received By:

Phone Result:

Fax Result:

Yes

No

Add'l Phone #:

Add'l Fax #:

REMARKS:

Delivered By: (Circle One)

5.60

Sample Condition
Cool ☒ Intact ☒
Yes ☒ No ☒

CHECKED BY: (initials)

Sampler - UPS - Bus - Other:

5.60

Sample Condition
Cool ☒ Intact ☒
Yes ☒ No ☒

CHECKED BY: (initials)

† Cardinal cannot accept verbal changes. Please fax written changes to 505-393-2476

#54



ARDINAL LABORATORIES

101 East Marland, Hobbs, NM 88240
(505) 393-2326 FAX (505) 393-2476

CHAIN-OF-CUSTODY AND ANALYSIS REQUEST

3/4

Company Name: BBC International, Inc.

Project Manager: Cliff Brunson

Address: P.O. Box 805

City: Hobbs

Phone #: 575-397-6388

Project #:

Project Name:

Project Location:

Sample Name:

P.O. #:

Company:

Attn:

Address:

City:

State:

Phone #:

Fax #:

BILL TO

ANALYSIS REQUEST

Lab I.D.	Sample I.D.	(G)RAB OR (C)OMP.	# CONTAINERS	MATRIX	PRESERV	SAMPLING	DATE	TIME	CL-TPH-BTEX
H008930	SP5001	G-1	1	GROUNDWATER			3-26	840	
21	004	G-1	1	WASTEWATER			915	1005	
22	008	G-1	1	SOIL				1100	
23	012	G-1	1	OIL				1148	
24	015	G-1	1	SLUDGE				1259	
25	015	G-1	1	OTHER:				115	
26	015	G-1	1	ACID/BASE:				141	
27	015	G-1	1	ICE / COOL				212	
28	015	G-1	1	OTHER:				300	

PLEASE NOTE: Liability and Damages. Cardinal's liability and client's exclusive remedy for any claim arising whether based in contract or tort, shall be limited to the amount paid by the client for the analyses. All claims, including those for negligence and any other cause whatsoever shall be deemed waived unless made in writing and received by Cardinal within 30 days after completion of the applicable service. In no event shall Cardinal be liable for incidental or consequential damages, including without limitation, business interruptions, loss of use, or loss of profits incurred by client, its subsidiaries, affiliates or successors arising out of or related to the performance of services hereunder by Cardinal, regardless of whether such claim is based upon any of the above stated reasons or otherwise.

Relinquished By:

Date: 3/20/14

Time:

Received By: Heidi Bender

Phone Result:

Yes ☐ No ☐

Add'l Phone #:

Add'l Fax #:

Relinquished By:

Date:

Time:

Received By:

Sample Condition

Cool ☐ Intact ☐

Yes ☐ No ☐

CHECKED BY:

Initials

Delivered By: (Circle One)

Sampler - UPS - Bus - Other:

S.60

54

† Cardinal cannot accept verbal changes. Please fax written changes to 505-393-2476

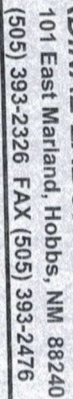

~~1/4~~

Page 20 of 20

† Cardinal cannot accept verbal changes. Please fax written changes to 505-398-2476

July 10, 2014

Cliff Brunson

BBC International, Inc.

P.O. Box 805

Hobbs, NM 88241

RE: CORRAL DRAW #2

Enclosed are the results of analyses for samples received by the laboratory on 07/07/14 10:17.

Cardinal Laboratories is accredited through Texas NELAP under certificate number T104704398-13-5. Accreditation applies to drinking water, non-potable water and solid and chemical materials. All accredited analytes are denoted by an asterisk (*). For a complete list of accredited analytes and matrices visit the TCEQ website at www.tceq.texas.gov/field/qa/lab_accred_certif.html.

Cardinal Laboratories is accredited through the State of Colorado Department of Public Health and Environment for:

Method EPA 552.2	Haloacetic Acids (HAA-5)
Method EPA 524.2	Total Trihalomethanes (TTHM)
Method EPA 524.4	Regulated VOCs (V1, V2, V3)

Accreditation applies to public drinking water matrices.

This report meets NELAP requirements and is made up of a cover page, analytical results, and a copy of the original chain-of-custody. If you have any questions concerning this report, please feel free to contact me.

Sincerely,



Celey D. Keene

Lab Director/Quality Manager

Analytical Results For:

 BBC International, Inc.
 Cliff Brunson
 P.O. Box 805
 Hobbs NM, 88241
 Fax To: (575) 397-0397

Received:	07/07/2014	Sampling Date:	07/01/2014
Reported:	07/10/2014	Sampling Type:	Soil
Project Name:	CORRAL DRAW #2	Sampling Condition:	Cool & Intact
Project Number:	NONE GIVEN	Sample Received By:	Jodi Henson
Project Location:	MALAGA, NM		

Sample ID: SB 1 @ 18' (H402044-01)

Chloride, SM4500Cl-B		mg/kg		Analyzed By: AP					
Analyte	Result	Reporting Limit	Analyzed	Method Blank	BS	% Recovery	True Value QC	RPD	Qualifier
Chloride	4000	16.0	07/09/2014	ND	400	100	400	0.00	

Sample ID: SB 1 @ 25' (H402044-02)

Chloride, SM4500Cl-B		mg/kg		Analyzed By: AP					
Analyte	Result	Reporting Limit	Analyzed	Method Blank	BS	% Recovery	True Value QC	RPD	Qualifier
Chloride	2960	16.0	07/09/2014	ND	400	100	400	0.00	

Sample ID: SB 1 @ 30' (H402044-03)

Chloride, SM4500Cl-B		mg/kg		Analyzed By: AP					
Analyte	Result	Reporting Limit	Analyzed	Method Blank	BS	% Recovery	True Value QC	RPD	Qualifier
Chloride	2600	16.0	07/09/2014	ND	400	100	400	0.00	

Sample ID: SB 1 @ 35' (H402044-04)

Chloride, SM4500Cl-B		mg/kg		Analyzed By: AP					
Analyte	Result	Reporting Limit	Analyzed	Method Blank	BS	% Recovery	True Value QC	RPD	Qualifier
Chloride	2440	16.0	07/09/2014	ND	400	100	400	0.00	

Cardinal Laboratories

*=Accredited Analyte

PLEASE NOTE: Liability and Damages. Cardinal's liability and client's exclusive remedy for any claim arising, whether based in contract or tort, shall be limited to the amount paid by client for analyses. All claims, including those for negligence and any other cause whatsoever shall be deemed waived unless made in writing and received by Cardinal within thirty (30) days after completion of the applicable service. In no event shall Cardinal be liable for incidental or consequential damages, including, without limitation, business interruptions, loss of use, or loss of profits incurred by client, its subsidiaries, affiliates or successors arising out of or related to the performance of the services hereunder by Cardinal, regardless of whether such claim is based upon any of the above stated reasons or otherwise. Results relate only to the samples identified above. This report shall not be reproduced except in full with written approval of Cardinal Laboratories.



Celey D. Keene, Lab Director/Quality Manager

Analytical Results For:

BBC International, Inc.
Cliff Brunson
P.O. Box 805
Hobbs NM, 88241
Fax To: (575) 397-0397

Received:	07/07/2014	Sampling Date:	07/01/2014
Reported:	07/10/2014	Sampling Type:	Soil
Project Name:	CORRAL DRAW #2	Sampling Condition:	Cool & Intact
Project Number:	NONE GIVEN	Sample Received By:	Jodi Henson
Project Location:	MALAGA, NM		

Sample ID: SB 1 @ 43' (H402044-05)

Chloride, SM4500Cl-B		mg/kg		Analyzed By: AP					
Analyte	Result	Reporting Limit	Analyzed	Method Blank	BS	% Recovery	True Value QC	RPD	Qualifier
Chloride	1120	16.0	07/09/2014	ND	400	100	400	0.00	

Sample ID: SB 1 @ 51' (H402044-06)

Chloride, SM4500CI-B		mg/kg		Analyzed By: AP					
Analyte	Result	Reporting Limit	Analyzed	Method Blank	BS	% Recovery	True Value QC	RPD	Qualifier
Chloride	272	16.0	07/09/2014	ND	400	100	400	0.00	

Sample ID: SB 1 @ 54' (H402044-07)

Chloride, SM4500CI-B		mg/kg		Analyzed By: AP					
Analyte	Result	Reporting Limit	Analyzed	Method Blank	BS	% Recovery	True Value QC	RPD	Qualifier
Chloride	176	16.0	07/09/2014	ND	400	100	400	0.00	

Sample ID: SB 1 @ 56' (H402044-08)

Chloride, SM4500CI-B		mg/kg		Analyzed By: AP					
Analyte	Result	Reporting Limit	Analyzed	Method Blank	BS	% Recovery	True Value QC	RPD	Qualifier
Chloride	128	16.0	07/09/2014	ND	400	100	400	0.00	

Sample ID: SB 2 @ 23' (H402044-09)

Chloride, SM4500Cl-B		mg/kg		Analyzed By: AP					
Analyte	Result	Reporting Limit	Analyzed	Method Blank	BS	% Recovery	True Value QC	RPD	Qualifier
Chloride	7120	16.0	07/09/2014	ND	400	100	400	0.00	

Cardinal Laboratories

*=Accredited Analyte

PLEASE NOTE: Liability and Damages. Cardinal's liability and client's exclusive remedy for any claim arising, whether based in contract or tort, shall be limited to the amount paid by client for analyses. All claims, including those for negligence and any other cause whatsoever shall be deemed waived unless made in writing and received by Cardinal within thirty (30) days after completion of the applicable service. In no event shall Cardinal be liable for incidental or consequential damages, including, without limitation, business interruptions, loss of use, or loss of profits incurred by client, its subsidiaries, affiliates or successors arising out of or related to the performance of the services hereunder by Cardinal, regardless of whether such claim is based upon any of the above stated reasons or otherwise. Results relate only to the samples identified above. This report shall not be reproduced except in full with written approval of Cardinal Laboratories.



Celey D. Keene, Lab Director/Quality Manager

Analytical Results For:

BBC International, Inc.
Cliff Brunson
P.O. Box 805
Hobbs NM, 88241
Fax To: (575) 397-0397

Received: 07/07/2014
Reported: 07/10/2014
Project Name: CORRAL DRAW #2
Project Number: NONE GIVEN
Project Location: MALAGA, NM

Sampling Date: 07/01/2014
Sampling Type: Soil
Sampling Condition: Cool & Intact
Sample Received By: Jodi Henson

Sample ID: SB 2 @ 28' (H402044-10)

Chloride, SM4500Cl-B		mg/kg		Analyzed By: AP						
Analyte	Result	Reporting Limit	Analyzed	Method Blank	BS	% Recovery	True Value QC	RPD	Qualifier	
Chloride	6960	16.0	07/09/2014	ND	400	100	400	0.00		

Sample ID: SB 2 @ 33' (H402044-11)

Chloride, SM4500CI-B		mg/kg		Analyzed By: AP					
Analyte	Result	Reporting Limit	Analyzed	Method Blank	BS	% Recovery	True Value QC	RPD	Qualifier
Chloride	640	16.0	07/09/2014	ND	400	100	400	0.00	

Sample ID: SB 2 @ 38' (H402044-12)

Chloride, SM4500Cl-B		mg/kg		Analyzed By: AP					
Analyte	Result	Reporting Limit	Analyzed	Method Blank	BS	% Recovery	True Value QC	RPD	Qualifier
Chloride	288	16.0	07/10/2014	ND	416	104	400	3.92	

Sample ID: SB 2 @ 43' (H402044-13)

Chloride, SM4500Cl-B		mg/kg		Analyzed By: AP					
Analyte	Result	Reporting Limit	Analyzed	Method Blank	BS	% Recovery	True Value QC	RPD	Qualifier
Chloride	272	16.0	07/10/2014	ND	416	104	400	3.92	

Sample ID: SB 2 @ 46' (H402044-14)

Chloride, SM4500Cl-B		mg/kg		Analyzed By: AP					
Analyte	Result	Reporting Limit	Analyzed	Method Blank	BS	% Recovery	True Value QC	RPD	Qualifier
Chloride	144	16.0	07/10/2014	ND	416	104	400	3.92	

Cardinal Laboratories

*=Accredited Analyte

PLEASE NOTE: Liability and Damages. Cardinal's liability and client's exclusive remedy for any claim arising, whether based in contract or tort, shall be limited to the amount paid by client for analyses. All claims, including those for negligence and any other cause whatsoever shall be deemed waived unless made in writing and received by Cardinal within thirty (30) days after completion of the applicable service. In no event shall Cardinal be liable for incidental or consequential damages, including, without limitation, business interruptions, loss of use, or loss of profits incurred by client, its subsidiaries, affiliates or successors arising out of or related to the performance of the services hereunder by Cardinal, regardless of whether such claim is based upon any of the above stated reasons or otherwise. Results relate only to the samples identified above. This report shall not be reproduced except in full with written approval of Cardinal Laboratories.



Celey D. Keene, Lab Director/Quality Manager

Analytical Results For:

BBC International, Inc.
Cliff Brunson
P.O. Box 805
Hobbs NM, 88241
Fax To: (575) 397-0397

Received: 07/07/2014
Reported: 07/10/2014
Project Name: CORRAL DRAW #2
Project Number: NONE GIVEN
Project Location: MALAGA, NM

Sampling Date: 07/01/2014
Sampling Type: Soil
Sampling Condition: Cool & Intact
Sample Received By: Jodi Henson

Sample ID: SB 3 @ 23' (H402044-15)

Chloride, SM4500Cl-B		mg/kg		Analyzed By: AP					
Analyte	Result	Reporting Limit	Analyzed	Method Blank	BS	% Recovery	True Value QC	RPD	Qualifier
Chloride	3600	16.0	07/10/2014	ND	416	104	400	3.92	

Sample ID: SB 3 @ 28' (H402044-16)

Chloride, SM4500Cl-B		mg/kg		Analyzed By: AP					
Analyte	Result	Reporting Limit	Analyzed	Method Blank	BS	% Recovery	True Value QC	RPD	Qualifier
Chloride	3600	16.0	07/10/2014	ND	416	104	400	3.92	

Sample ID: SB 3 @ 33' (H402044-17)

Chloride, SM4500Cl-B		mg/kg		Analyzed By: AP						
Analyte	Result	Reporting Limit	Analyzed	Method Blank	BS	% Recovery	True Value QC	RPD	Qualifier	
Chloride	272	16.0	07/10/2014	ND	416	104	400	3.92		

Sample ID: SB 3 @ 38' (H402044-18)

Chloride, SM4500Cl-B		mg/kg		Analyzed By: AP					
Analyte	Result	Reporting Limit	Analyzed	Method Blank	BS	% Recovery	True Value QC	RPD	Qualifier
Chloride	112	16.0	07/10/2014	ND	416	104	400	3.92	

Sample ID: SB 3 @ 40' (H402044-19)

Chloride, SM4500Cl-B		mg/kg		Analyzed By: AP					
Analyte	Result	Reporting Limit	Analyzed	Method Blank	BS	% Recovery	True Value QC	RPD	Qualifier
Chloride	176	16.0	07/10/2014	ND	416	104	400	3.92	

Cardinal Laboratories

*=Accredited Analyte

PLEASE NOTE: Liability and Damages. Cardinal's liability and client's exclusive remedy for any claim arising, whether based in contract or tort, shall be limited to the amount paid by client for analyses. All claims, including those for negligence and any other cause whatsoever shall be deemed waived unless made in writing and received by Cardinal within thirty (30) days after completion of the applicable service. In no event shall Cardinal be liable for incidental or consequential damages, including, without limitation, business interruptions, loss of use, or loss of profits incurred by client, its subsidiaries, affiliates or successors arising out of or related to the performance of the services hereunder by Cardinal, regardless of whether such claim is based upon any of the above stated reasons or otherwise. Results relate only to the samples identified above. This report shall not be reproduced except in full with written approval of Cardinal Laboratories.



Celey D. Keene, Lab Director/Quality Manager

Notes and Definitions

ND	Analyte NOT DETECTED at or above the reporting limit
RPD	Relative Percent Difference
**	Samples not received at proper temperature of 6°C or below.
***	Insufficient time to reach temperature.
-	Chloride by SM4500Cl-B does not require samples be received at or below 6°C Samples reported on an as received basis (wet) unless otherwise noted on report

Cardinal Laboratories

*=Accredited Analyte

PLEASE NOTE: Liability and Damages. Cardinal's liability and client's exclusive remedy for any claim arising, whether based in contract or tort, shall be limited to the amount paid by client for analyses. All claims, including those for negligence and any other cause whatsoever shall be deemed waived unless made in writing and received by Cardinal within thirty (30) days after completion of the applicable service. In no event shall Cardinal be liable for incidental or consequential damages, including, without limitation, business interruptions, loss of use, or loss of profits incurred by client, its subsidiaries, affiliates or successors arising out of or related to the performance of the services hereunder by Cardinal, regardless of whether such claim is based upon any of the above stated reasons or otherwise. Results relate only to the samples identified above. This report shall not be reproduced except in full with written approval of Cardinal Laboratories.



Celey D. Keene, Lab Director/Quality Manager

ORDINAL LABORATORIES

101 East Marland, Hobbs, NM 88240
(505) 393-2326 FAX (505) 393-2476

CHAIN-OF-CUSTODY AND ANALYSIS REQUEST

[illegible]

ORDINAL LABORATORIES

101 East Marland, Hobbs, NM 88240
(505) 393-2326 FAX (505) 393-2476

CHAIN-OF-CUSTODY AND ANALYSIS REQUEST

[illegible]

District I
1625 N. French Dr., Hobbs, NM 88240
District II
811 S. First St., Artesia, NM 88210
District III
1000 Rio Brazos Road, Aztec, NM 87410
District IV
1220 S. St. Francis Dr., Santa Fe, NM 87505

State of New Mexico
Energy Minerals and Natural Resources

Oil Conservation Division
1220 South St. Francis Dr.
Santa Fe, NM 87505

Form C-141
Revised August 8, 2011

Submit 1 Copy to appropriate District Office in
accordance with 19.15.29 NMAC.

Release Notification and Corrective Action

OPERATOR

☒ Initial Report ☐ Final Report

Name of Company	Oxy Permian Ltd.	Contact	Chancey Summers
Address	1017 W. Stanolind Rd, Hobbs, NM 88240	Telephone No.	(575) 397-8216
Facility Name	Corral Draw #2	Facility Type	SWD
Surface Owner	BLM	Mineral Owner	API No.

LOCATION OF RELEASE

Unit Letter	Section	Township	Range	Feet from the	North/South Line	Feet from the	East/West Line	County
K	22	25S	29E	1580	South	1980	West	Eddy County, NM

Latitude N 32.11249° Longitude W 103.97449°

NATURE OF RELEASE

Type of Release	Skim oil and Produced water	Volume of Release	Unknown	Volume Recovered	0 bbls
Source of Release	Pumps and Flow lines	Date and Hour of Occurrence	Unknown	Date and Hour of Discovery	
Was Immediate Notice Given?	<input type="checkbox"/> Yes <input checked="" type="checkbox"/> No <input type="checkbox"/> Not Required	If YES, To Whom?	Mike Bratcher, NMOCD and Jennifer VanCuren, BLM		
By Whom?		Date and Hour			
Was a Watercourse Reached?	<input type="checkbox"/> Yes <input checked="" type="checkbox"/> No	If YES, Volume Impacting the Watercourse.			

If a Watercourse was Impacted, Describe Fully.*

Describe Cause of Problem and Remedial Action Taken.*

Various leaks caused by pumps and flow lines on this site have caused an unknown amount of skim oil and produced water to leak onto the ground. No fluids were recovered and pumps and flow lines have been repaired or replaced.

Describe Area Affected and Cleanup Action Taken.*

The affected areas are inside the lined battery around the tanks (35' x 105'), Northeast of the lined battery around a pump (14' x 32'), Northwest of the lined battery just west of the drum (48' x 85'), and further Northwest of the battery near the road traveling off location (200' x 35'). Remediation will be completed in accordance with a remediation plan approved by NMOCD and the BLM.

I hereby certify that the information given above is true and complete to the best of my knowledge and understand that pursuant to NMOCD rules and regulations all operators are required to report and/or file certain release notifications and perform corrective actions for releases which may endanger public health or the environment. The acceptance of a C-141 report by the NMOCD marked as "Final Report" does not relieve the operator of liability should their operations have failed to adequately investigate and remediate contamination that pose a threat to ground water, surface water, human health or the environment. In addition, NMOCD acceptance of a C-141 report does not relieve the operator of responsibility for compliance with any other federal, state, or local laws and/or regulations.

Signature:	<u>OIL CONSERVATION DIVISION</u>		
Printed Name: Chancey Summers	Approved by Environmental Specialist:		
Title: HES Specialist	Approval Date:	Expiration Date:	
E-mail Address: Chancey.Summers@oxy.com	Conditions of Approval:		Attached <input type="checkbox"/>
Date: 7-26-14 Phone: (575) 397-8216			

* Attach Additional Sheets If Necessary