

R. T. HICKS CONSULTANTS, LTD.

901 Rio Grande Blvd NW ▲ Suite F-142 ▲ Albuquerque, NM 87104 ▲ 505.266.5004 ▲ Fax: 505.266-0745

November 25, 2014

Mr. Mike Bratcher
NMOCD District 2
811 S. First Street
Artesia, New Mexico 88210
Via Email and US Mail

RE: Murchison – Hackberry State #1 Release
Final C-141/Closure Request

Dear Mr. Bratcher:

On behalf of Murchison Oil and Gas, R.T Hicks Consultants submits the attached final C-141 form and requests closure of the regulatory file associated with the above-referenced release. This form has been revised to reflect work conducted at the site after the denial of the previous submission by NMOCD on September 16, 2014.

Delineation occurred on July 30, 2014 using a backhoe to collect soil samples from the release area. All samples were collected on the location pad and select samples were analyzed at Hall Environmental Analysis Laboratory in Albuquerque for chloride, BTEX, and GRO/DRO/MRO. As shown in figure 1, vertical delineation revealed that chloride concentrations virtually dissipate at 5 feet below surface. Elevated chloride concentrations in the subsurface samples at sample point #3 near the separator indicate that this release is *not* the source. Lateral delineation in each direction suggests that the extent of chloride impact was limited to the footprint of the release.

Delineation data was submitted on September 11, 2014 but on September 16, NMOCD required excavation of the affected area. On September 30, 2014, two excavations were dug within the footprint of the release. The first excavation was 40 x 23 x 2-feet, centered around sample point #1 east of the tank. A composite of the excavation floor yielded lab analysis of 580 mg/kg chloride. The second excavation was in the area of sample point #2 and was 8 x 15 x 2-feet. The floor of this area was 430 mg/kg chloride. Approximately 120 cubic yards of material was removed



Excavation facing west 9/30/2014

from the site. The excavations were backfilled using pad material scraped from east side of location surface, downsizing the footprint of the pad.

As shown on Figures 2 and 3, data from the Office of the State Engineer demonstrate that depth to groundwater exceeds 100 feet and the distance to mapped surface water body is nearly 1 mile. The nearest known water well is more than 1 mile distant. The bulk of chloride-affected material was removed and our understanding of how regulated constituents migrate from the source through the environment allow us to conclude that the residual salt on the location pose no threat to fresh water, public health, or the environment.

Please contact me with any questions regarding this closure request. Thank you.

Sincerely,

R.T. Hicks Consultants

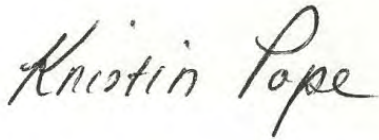
A handwritten signature in cursive script that reads "Kristin Pope". The signature is written in dark ink on a light-colored background.

Kristin Pope

Copy: Murchison Oil & Gas, State Land Office

Enclosures: Final C-141, Figure 1 (delineation), Figure 2 (groundwater map), Figure 3 (surface water), Lab Reports, Email communication

District I
1625 N. French Dr., Hobbs, NM 88240
District II
811 S. First St., Artesia, NM 88210
District III
1000 Rio Brazos Road, Aztec, NM 87410
District IV
1220 S. St. Francis Dr., Santa Fe, NM 87505

State of New Mexico
Energy Minerals and Natural Resources

Oil Conservation Division
1220 South St. Francis Dr.
Santa Fe, NM 87505

Form C-141
Revised August 8, 2011

Submit 1 Copy to appropriate District Office in
accordance with 19.15.29 NMAC.

Release Notification and Corrective Action

OPERATOR

☐ Initial Report ☒ Final Report

Name of Company	Murchison Oil & Gas, Inc.	Contact	Greg Boans
Address	1100 Mira Vista Blvd, Plano, TX 75093	Telephone No.	(575) 628-3932
Facility Name	Hackberry State #1	Facility Type	Production Battery
Surface Owner	State of New Mexico	Mineral Owner	API No. 30-015-34803

LOCATION OF RELEASE

Unit Letter	Section	Township	Range	Feet from the	North/South Line	Feet from the	East/West Line	County
O	17	18S	23E	660	South	1980	East	Eddy

Latitude 32° 44' 32.2" N Longitude 104° 42' 39.8" W

NATURE OF RELEASE

Type of Release	Produced Water	Volume of Release	155 bbls	Volume Recovered	0 bbls
Source of Release	Open-top fiberglass tank	Date and Hour of Occurrence	After 3:00 pm on 5/19/2014	Date and Hour of Discovery	5/20/2014 4:00 pm
Was Immediate Notice Given?	<input checked="" type="checkbox"/> Yes <input type="checkbox"/> No <input type="checkbox"/> Not Required	If YES, To Whom? In person to Mike Bratcher			
By Whom?	Chace Walls	Date and Hour	5/21/2014 4:15 pm		
Was a Watercourse Reached?	<input type="checkbox"/> Yes <input checked="" type="checkbox"/> No	If YES, Volume Impacting the Watercourse.			

If a Watercourse was Impacted, Describe Fully.*

n/a

Describe Cause of Problem and Remedial Action Taken.*

Fluid was lost due to a failure of the nipple on the backside of a 200-bbl open-top fiberglass tank. A vacuum truck was dispatched to the location but no standing fluid remained at the time of its arrival. The nipple on the tank was replaced.

Describe Area Affected and Cleanup Action Taken.*

Produced water leaked out of the tank and onto the location, affecting approximately 4,000 square feet, all of which was contained on the location pad. Vertical and lateral delineation of chloride concentrations confirm that this release poses no threat to fresh water, public health, or the environment. A directive from NMOCD required excavation of the areas affected by the release. On 9/30/2014, approximately 120 cubic yards of material was removed from two areas—immediately north of the tank and due east of the tank. These excavations were backfilled using pad material scraped from east side of location surface, downsizing the footprint of the pad.

Attached: delineation table, lab reports, sample map, groundwater map, emails

I hereby certify that the information given above is true and complete to the best of my knowledge and understand that pursuant to NMOCD rules and regulations all operators are required to report and/or file certain release notifications and perform corrective actions for releases which may endanger public health or the environment. The acceptance of a C-141 report by the NMOCD marked as "Final Report" does not relieve the operator of liability should their operations have failed to adequately investigate and remediate contamination that pose a threat to ground water, surface water, human health or the environment. In addition, NMOCD acceptance of a C-141 report does not relieve the operator of responsibility for compliance with any other federal, state, or local laws and/or regulations.

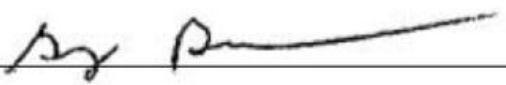
Signature: 		OIL CONSERVATION DIVISION	
Printed Name: Greg Boans		Approved by Environmental Specialist:	
Title: Production Superintendent	Approval Date:	Expiration Date:	
E-mail Address: gboans@jdmii.com	Conditions of Approval:		Attached <input type="checkbox"/>
Date: 11/25/2014	Phone: (575) 628-3932		

* Attach Additional Sheets If Necessary

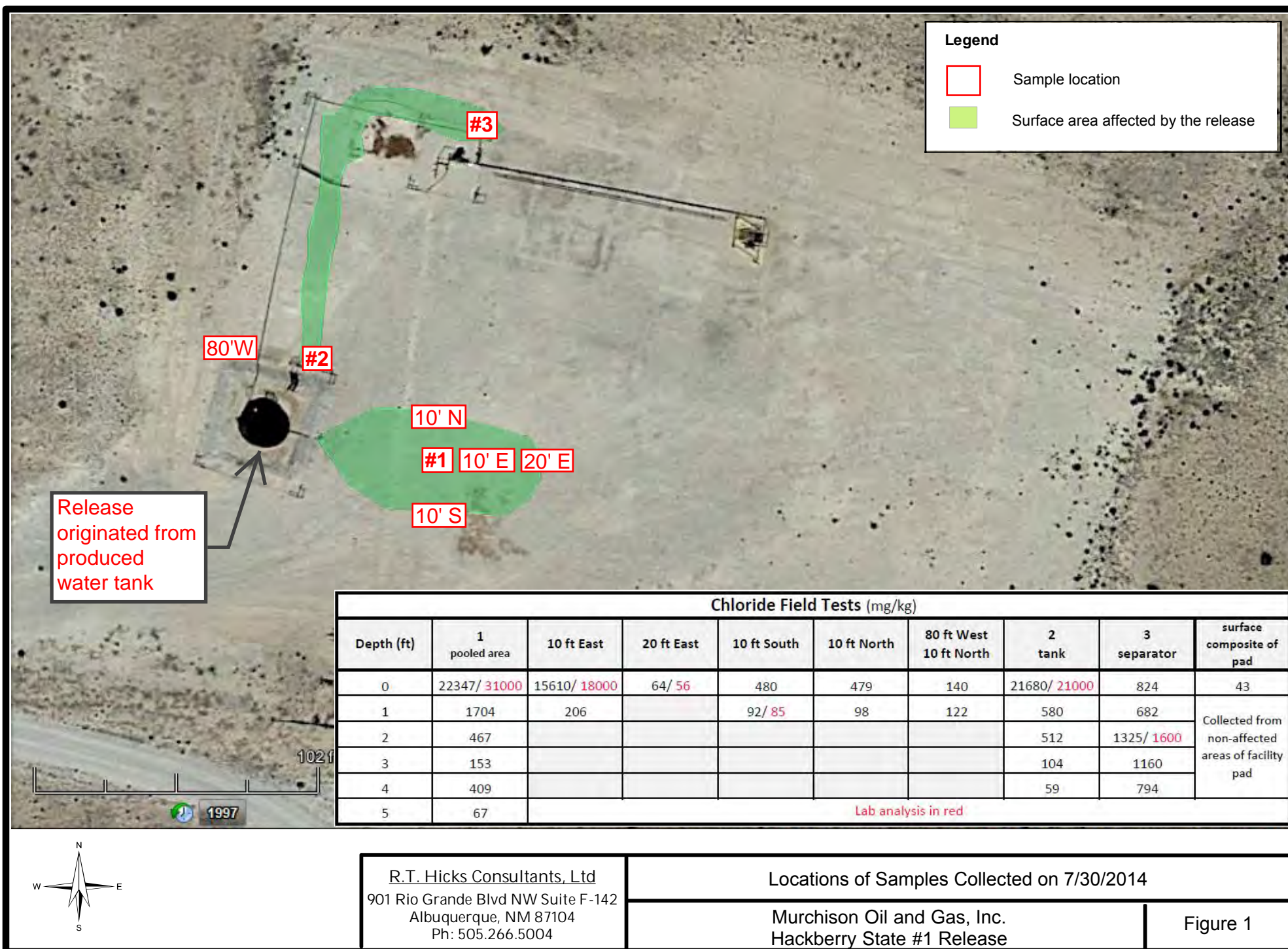

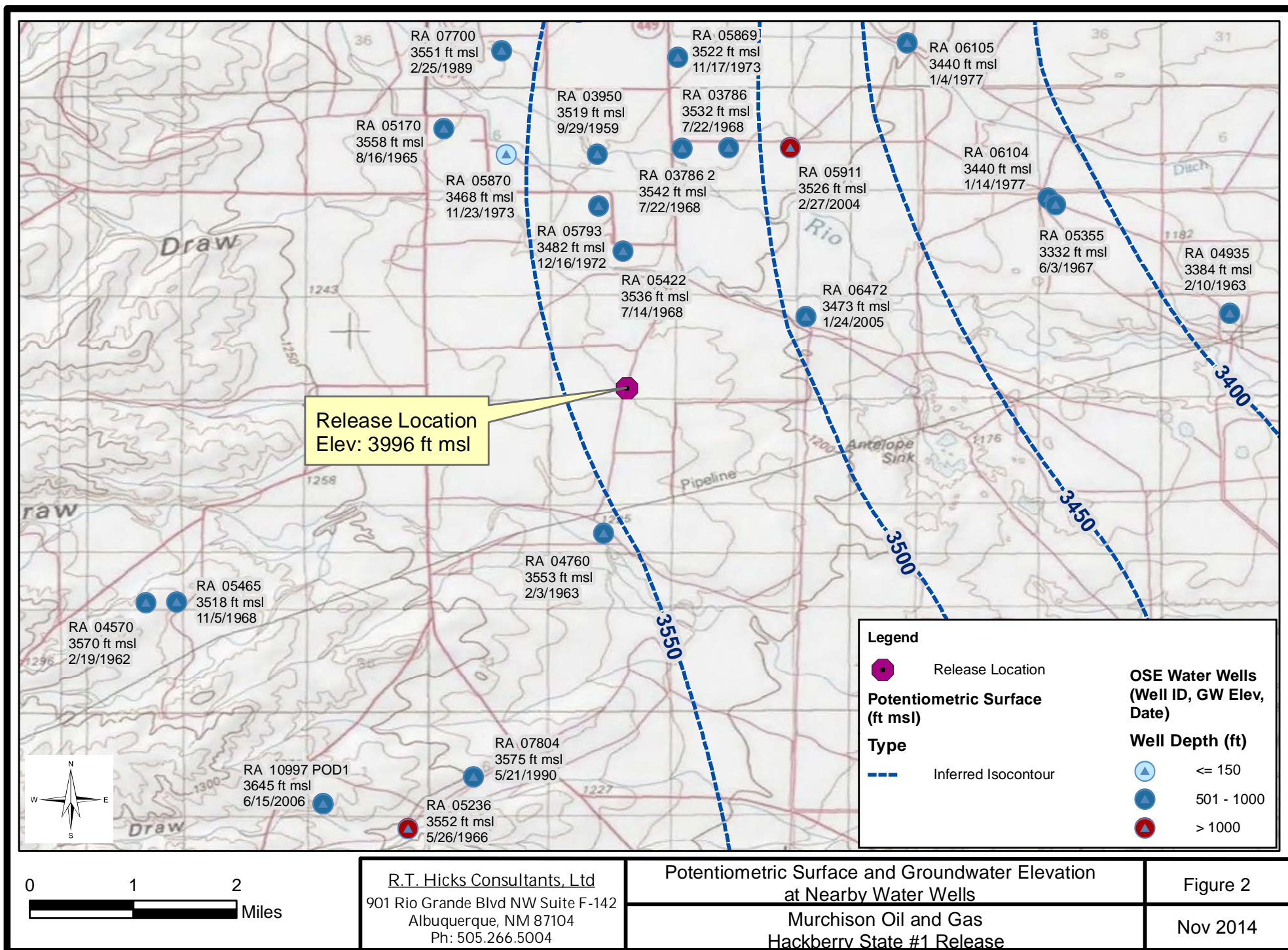

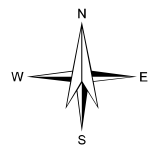
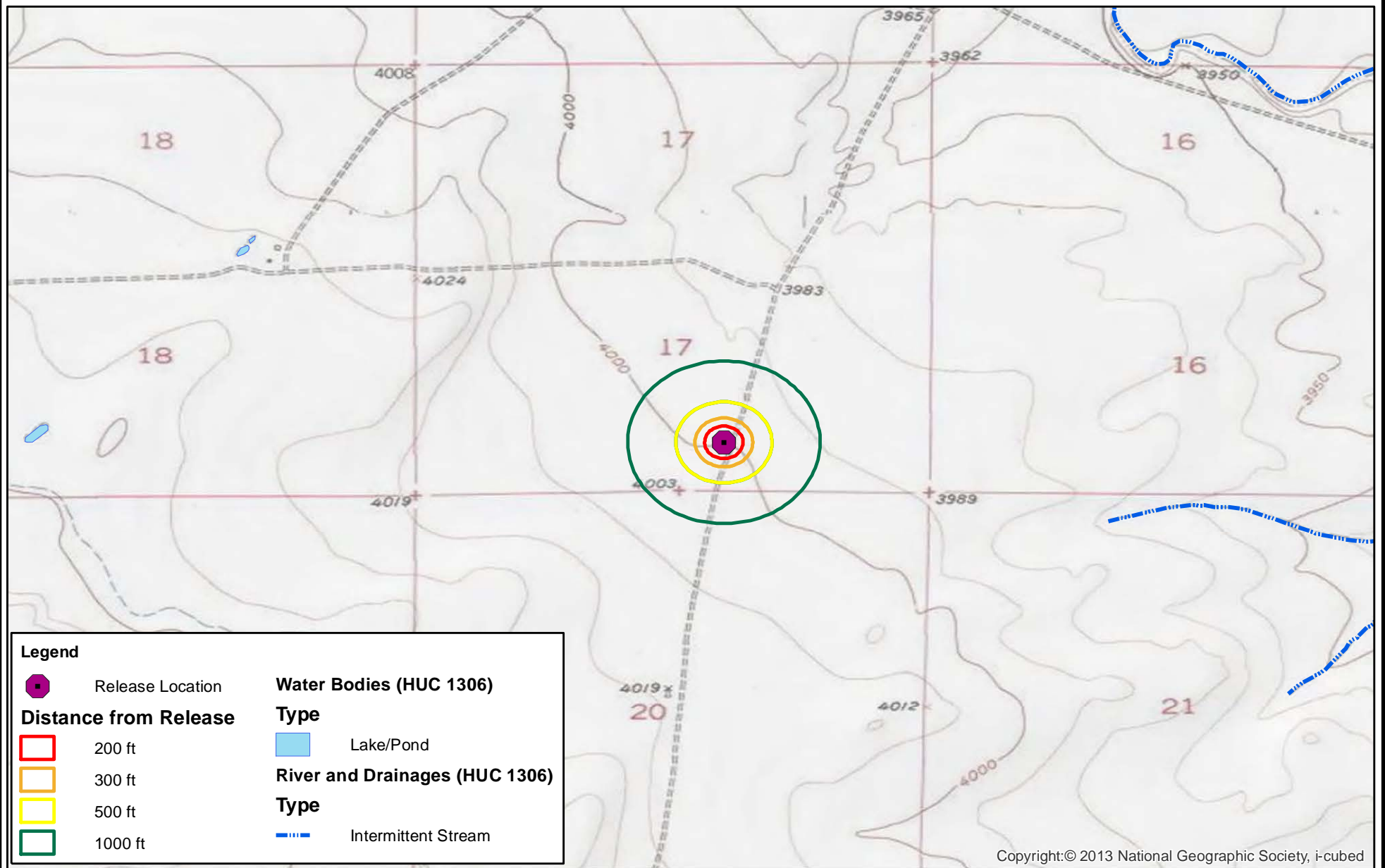

0 1,000 2,000
Feet

R.T. Hicks Consultants, Ltd
901 Rio Grande Blvd NW Suite F-142
Albuquerque, NM 87104
Ph: 505.266.5004

Surface Water and Topography

Murchison Oil and Gas
Hackberry State #1 Release

Figure 3

Nov 2014



Hall Environmental Analysis Laboratory
4901 Hawkins NE
Albuquerque, NM 87109
TEL: 505-345-3975 FAX: 505-345-4107
Website: www.hallenvironmental.com

October 14, 2014

Kristin Pope

R.T. Hicks Consultants, LTD

901 Rio Grande Blvd. NW

Suite F-142

Albuquerque, NM 87104

TEL: (505) 266-5004

FAX (505) 266-0745

RE: Murchison-Hackberry #1 Release

OrderNo.: 1410344

Dear Kristin Pope:

Hall Environmental Analysis Laboratory received 2 sample(s) on 10/7/2014 for the analyses presented in the following report.

These were analyzed according to EPA procedures or equivalent. To access our accredited tests please go to www.hallenvironmental.com or the state specific web sites. In order to properly interpret your results it is imperative that you review this report in its entirety. See the sample checklist and/or the Chain of Custody for information regarding the sample receipt temperature and preservation. Data qualifiers or a narrative will be provided if the sample analysis or analytical quality control parameters require a flag. When necessary, data qualifiers are provided on both the sample analysis report and the QC summary report, both sections should be reviewed. All samples are reported, as received, unless otherwise indicated. Lab measurement of analytes considered field parameters that require analysis within 15 minutes of sampling such as pH and residual chlorine are qualified as being analyzed outside of the recommended holding time.

Please don't hesitate to contact HEAL for any additional information or clarifications.

ADHS Cert #AZ0682 -- NMED-DWB Cert #NM9425 -- NMED-Micro Cert #NM0190

Sincerely,

A handwritten signature in black ink, appearing to read 'Andy Freeman', is written over a horizontal line.

Andy Freeman

Laboratory Manager

4901 Hawkins NE

Albuquerque, NM 87109

Hall Environmental Analysis Laboratory, Inc.

Analytical Report

Lab Order **1410344**

Date Reported: **10/14/2014**

CLIENT: R.T. Hicks Consultants, LTD

Client Sample ID: #1 Excavation @ 2' BGS

Project: Murchison-Hackberry #1 Release

Collection Date: 9/30/2014 11:28:00 AM

Lab ID: 1410344-001

Matrix: SOIL

Received Date: 10/7/2014 9:50:00 AM

Analyses	Result	RL	Qual	Units	DF	Date Analyzed	Batch
EPA METHOD 300.0: ANIONS						Analyst: LGP	
Chloride	580	30		mg/Kg	20	10/8/2014 1:58:13 PM	15789

Refer to the QC Summary report and sample login checklist for flagged QC data and preservation information.

Qualifiers:	*	Value exceeds Maximum Contaminant Level.	B	Analyte detected in the associated Method Blank	Page 1 of 3
	E	Value above quantitation range	H	Holding times for preparation or analysis exceeded	
	J	Analyte detected below quantitation limits	ND	Not Detected at the Reporting Limit	
	O	RSD is greater than RSDlimit	P	Sample pH greater than 2.	
	R	RPD outside accepted recovery limits	RL	Reporting Detection Limit	
	S	Spike Recovery outside accepted recovery limits			

Hall Environmental Analysis Laboratory, Inc.

Analytical Report

Lab Order **1410344**

Date Reported: **10/14/2014**

CLIENT: R.T. Hicks Consultants, LTD

Client Sample ID: #2 Excavation @ 2' BGS

Project: Murchison-Hackberry #1 Release

Collection Date: 9/30/2014 10:50:00 AM

Lab ID: 1410344-002

Matrix: SOIL

Received Date: 10/7/2014 9:50:00 AM

Analyses	Result	RL	Qual	Units	DF	Date Analyzed	Batch
EPA METHOD 300.0: ANIONS						Analyst: LGP	
Chloride	430	30		mg/Kg	20	10/8/2014 2:10:37 PM	15789

Refer to the QC Summary report and sample login checklist for flagged QC data and preservation information.

Qualifiers:	*	Value exceeds Maximum Contaminant Level.	B	Analyte detected in the associated Method Blank	Page 2 of 3
	E	Value above quantitation range	H	Holding times for preparation or analysis exceeded	
	J	Analyte detected below quantitation limits	ND	Not Detected at the Reporting Limit	
	O	RSD is greater than RSDlimit	P	Sample pH greater than 2.	
	R	RPD outside accepted recovery limits	RL	Reporting Detection Limit	
	S	Spike Recovery outside accepted recovery limits			

QC SUMMARY REPORT

Hall Environmental Analysis Laboratory, Inc.

WO#: 1410344

14-Oct-14

Client: R.T. Hicks Consultants, LTD
Project: Murchison-Hackberry #1 Release

Sample ID	MB-15789		SampType: MBLK		TestCode: EPA Method 300.0: Anions					
Client ID:	PBS		Batch ID: 15789		RunNo: 21767					
Prep Date:	10/8/2014		Analysis Date: 10/8/2014		SeqNo: 639352		Units: mg/Kg			
Analyte	Result	PQL	SPK value	SPK Ref Val	%REC	LowLimit	HighLimit	%RPD	RPDLimit	Qual
Chloride	ND	1.5								

Sample ID	LCS-15789		SampType: LCS		TestCode: EPA Method 300.0: Anions					
Client ID:	LCSS		Batch ID: 15789		RunNo: 21767					
Prep Date:	10/8/2014		Analysis Date: 10/8/2014		SeqNo: 639353		Units: mg/Kg			
Analyte	Result	PQL	SPK value	SPK Ref Val	%REC	LowLimit	HighLimit	%RPD	RPDLimit	Qual
Chloride	14	1.5	15.00	0	90.9	90	110			

Qualifiers:

* Value exceeds Maximum Contaminant Level.
E Value above quantitation range
J Analyte detected below quantitation limits
O RSD is greater than RSDlimit
R RPD outside accepted recovery limits
S Spike Recovery outside accepted recovery limits

B Analyte detected in the associated Method Blank
H Holding times for preparation or analysis exceeded
ND Not Detected at the Reporting Limit
P Sample pH greater than 2.
RL Reporting Detection Limit

Sample Log-In Check List

Client Name: RT HICKS

Work Order Number: 1410344

ReptNo: 1

Received by/date:

umg

10/07/14

Logged By: Ashley Gallegos

10/7/2014 9:50:00 AM

Ag

Completed By: Ashley Gallegos

10/7/2014 5:35:54 PM

Ag

Reviewed By:

CS

10/08/14

Chain of Custody

1. Custody seals intact on sample bottles?

Yes ☐

No ☐

Not Present ☒

2. Is Chain of Custody complete?

Yes ☒

No ☐

Not Present ☐

3. How was the sample delivered?

Client

Log In

4. Was an attempt made to cool the samples?

Yes ☐

No ☒

NA ☐

Not required

5. Were all samples received at a temperature of >0° C to 6.0°C

Yes ☐

No ☒

NA ☐

Not required

6. Sample(s) in proper container(s)?

Yes ☒

No ☐

7. Sufficient sample volume for indicated test(s)?

Yes ☒

No ☐

8. Are samples (except VOA and ONG) properly preserved?

Yes ☒

No ☐

9. Was preservative added to bottles?

Yes ☐

No ☒

NA ☐

10. VOA vials have zero headspace?

Yes ☐

No ☐

No VOA Vials ☒

11. Were any sample containers received broken?

Yes ☐

No ☒

of preserved
bottles checked
for pH:

12. Does paperwork match bottle labels?

(Note discrepancies on chain of custody)

Yes ☒

No ☐

(<2 or >12 unless noted)

13. Are matrices correctly identified on Chain of Custody?

Yes ☒

No ☐

Adjusted?

14. Is it clear what analyses were requested?

Yes ☒

No ☐

15. Were all holding times able to be met?

(If no, notify customer for authorization.)

Yes ☒

No ☐

Checked by:

Special Handling (if applicable)

16. Was client notified of all discrepancies with this order?

Yes ☐

No ☐

NA ☒

Person Notified:

Date

By Whom:

Via:

☐ eMail

☐ Phone

☐ Fax

☐ In Person

Regarding:

Client Instructions:

17. Additional remarks:

18. Cooler Information

Cooler No	Temp °C	Condition	Seal Intact	Seal No	Seal Date	Signed By
1	21.5	Good	Not Present			



Hall Environmental Analysis Laboratory
4901 Hawkins NE
Albuquerque, NM 87109
TEL: 505-345-3975 FAX: 505-345-4107
Website: www.hallenvironmental.com

August 08, 2014

Kristin Pope

R.T. Hicks Consultants, LTD

901 Rio Grande Blvd. NW

Suite F-142

Albuquerque, NM 87104

TEL: (505) 266-5004

FAX (505) 266-0745

RE: Murchison - Hackberry St. #1 Release

OrderNo.: 1408023

Dear Kristin Pope:

Hall Environmental Analysis Laboratory received 6 sample(s) on 8/1/2014 for the analyses presented in the following report.

These were analyzed according to EPA procedures or equivalent. To access our accredited tests please go to www.hallenvironmental.com or the state specific web sites. In order to properly interpret your results it is imperative that you review this report in its entirety. See the sample checklist and/or the Chain of Custody for information regarding the sample receipt temperature and preservation. Data qualifiers or a narrative will be provided if the sample analysis or analytical quality control parameters require a flag. When necessary, data qualifiers are provided on both the sample analysis report and the QC summary report, both sections should be reviewed. All samples are reported, as received, unless otherwise indicated. Lab measurement of analytes considered field parameters that require analysis within 15 minutes of sampling such as pH and residual chlorine are qualified as being analyzed outside of the recommended holding time.

Please don't hesitate to contact HEAL for any additional information or clarifications.

ADHS Cert #AZ0682 -- NMED-DWB Cert #NM9425 -- NMED-Micro Cert #NM0190

Sincerely,

A handwritten signature in black ink, appearing to read 'Andy Freeman', is written over a horizontal line.

Andy Freeman

Laboratory Manager

4901 Hawkins NE

Albuquerque, NM 87109

Hall Environmental Analysis Laboratory, Inc.

Analytical Report

Lab Order **1408023**Date Reported: **8/8/2014****CLIENT:** R.T. Hicks Consultants, LTD**Client Sample ID:** #1 @surface**Project:** Murchison - Hackberry St. #1 Release**Collection Date:** 7/29/2014 8:40:00 AM**Lab ID:** 1408023-001**Matrix:** SOIL**Received Date:** 8/1/2014 8:45:00 AM

Analyses	Result	RL	Qual	Units	DF	Date Analyzed	Batch
EPA METHOD 8015D: DIESEL RANGE ORGANICS							Analyst: BCN
Diesel Range Organics (DRO)	40	9.8		mg/Kg	1	8/5/2014 8:32:18 AM	14572
Motor Oil Range Organics (MRO)	85	49		mg/Kg	1	8/5/2014 8:32:18 AM	14572
Surr: DNOP	85.4	57.9-140		%REC	1	8/5/2014 8:32:18 AM	14572
EPA METHOD 300.0: ANIONS							Analyst: JRR
Chloride	31000	1500		mg/Kg	1E	8/6/2014 1:08:55 PM	14585
EPA METHOD 8260B: VOLATILES SHORT LIST							Analyst: KJH
Benzene	ND	0.048		mg/Kg	1	8/5/2014 4:44:27 PM	14583
Toluene	ND	0.048		mg/Kg	1	8/5/2014 4:44:27 PM	14583
Ethylbenzene	ND	0.048		mg/Kg	1	8/5/2014 4:44:27 PM	14583
Xylenes, Total	ND	0.095		mg/Kg	1	8/5/2014 4:44:27 PM	14583
Surr: 1,2-Dichloroethane-d4	89.0	70-130		%REC	1	8/5/2014 4:44:27 PM	14583
Surr: 4-Bromofluorobenzene	80.8	70-130		%REC	1	8/5/2014 4:44:27 PM	14583
Surr: Dibromofluoromethane	91.6	70-130		%REC	1	8/5/2014 4:44:27 PM	14583
Surr: Toluene-d8	96.8	70-130		%REC	1	8/5/2014 4:44:27 PM	14583
EPA METHOD 8015D MOD: GASOLINE RANGE							Analyst: KJH
Gasoline Range Organics (GRO)	ND	4.8		mg/Kg	1	8/5/2014 4:44:27 PM	14583
Surr: BFB	113	61.2-137		%REC	1	8/5/2014 4:44:27 PM	14583

Refer to the QC Summary report and sample login checklist for flagged QC data and preservation information.

Qualifiers:	*	Value exceeds Maximum Contaminant Level.	B	Analyte detected in the associated Method Blank	Page 1 of 10
	E	Value above quantitation range	H	Holding times for preparation or analysis exceeded	
	J	Analyte detected below quantitation limits	ND	Not Detected at the Reporting Limit	
	O	RSD is greater than RSDlimit	P	Sample pH greater than 2.	
	R	RPD outside accepted recovery limits	RL	Reporting Detection Limit	
	S	Spike Recovery outside accepted recovery limits			

Hall Environmental Analysis Laboratory, Inc.

Analytical Report

Lab Order 1408023

Date Reported: 8/8/2014

CLIENT: R.T. Hicks Consultants, LTD

Client Sample ID: #2@surface

Project: Murchison - Hackberry St. #1 Release

Collection Date: 7/29/2014 9:00:00 AM

Lab ID: 1408023-002

Matrix: SOIL

Received Date: 8/1/2014 8:45:00 AM

Analyses	Result	RL	Qual	Units	DF	Date Analyzed	Batch
EPA METHOD 8015D: DIESEL RANGE ORGANICS							Analyst: BCN
Diesel Range Organics (DRO)	67	10		mg/Kg	1	8/5/2014 9:37:11 AM	14572
Motor Oil Range Organics (MRO)	140	50		mg/Kg	1	8/5/2014 9:37:11 AM	14572
Surr: DNOP	102	57.9-140		%REC	1	8/5/2014 9:37:11 AM	14572
EPA METHOD 300.0: ANIONS							Analyst: JRR
Chloride	21000	3000		mg/Kg	2E	8/6/2014 1:21:19 PM	14585
EPA METHOD 8260B: VOLATILES SHORT LIST							Analyst: KJH
Benzene	ND	0.049		mg/Kg	1	8/5/2014 6:08:50 PM	14583
Toluene	ND	0.049		mg/Kg	1	8/5/2014 6:08:50 PM	14583
Ethylbenzene	ND	0.049		mg/Kg	1	8/5/2014 6:08:50 PM	14583
Xylenes, Total	ND	0.098		mg/Kg	1	8/5/2014 6:08:50 PM	14583
Surr: 1,2-Dichloroethane-d4	87.0	70-130		%REC	1	8/5/2014 6:08:50 PM	14583
Surr: 4-Bromofluorobenzene	82.1	70-130		%REC	1	8/5/2014 6:08:50 PM	14583
Surr: Dibromofluoromethane	89.1	70-130		%REC	1	8/5/2014 6:08:50 PM	14583
Surr: Toluene-d8	89.4	70-130		%REC	1	8/5/2014 6:08:50 PM	14583
EPA METHOD 8015D MOD: GASOLINE RANGE							Analyst: KJH
Gasoline Range Organics (GRO)	ND	4.9		mg/Kg	1	8/5/2014 6:08:50 PM	14583
Surr: BFB	107	61.2-137		%REC	1	8/5/2014 6:08:50 PM	14583

Refer to the QC Summary report and sample login checklist for flagged QC data and preservation information.

Qualifiers:	*	Value exceeds Maximum Contaminant Level.	B	Analyte detected in the associated Method Blank	Page 2 of 10
	E	Value above quantitation range	H	Holding times for preparation or analysis exceeded	
	J	Analyte detected below quantitation limits	ND	Not Detected at the Reporting Limit	
	O	RSD is greater than RSDlimit	P	Sample pH greater than 2.	
	R	RPD outside accepted recovery limits	RL	Reporting Detection Limit	
	S	Spike Recovery outside accepted recovery limits			

Hall Environmental Analysis Laboratory, Inc.

Analytical Report

Lab Order **1408023**Date Reported: **8/8/2014****CLIENT:** R.T. Hicks Consultants, LTD**Client Sample ID:** #3@2'**Project:** Murchison - Hackberry St. #1 Release**Collection Date:** 7/29/2014 11:11:00 AM**Lab ID:** 1408023-003**Matrix:** SOIL**Received Date:** 8/1/2014 8:45:00 AM

Analyses	Result	RL	Qual	Units	DF	Date Analyzed	Batch
EPA METHOD 8015D: DIESEL RANGE ORGANICS							Analyst: BCN
Diesel Range Organics (DRO)	ND	10		mg/Kg	1	8/5/2014 9:58:34 AM	14572
Motor Oil Range Organics (MRO)	ND	50		mg/Kg	1	8/5/2014 9:58:34 AM	14572
Surr: DNOP	112	57.9-140		%REC	1	8/5/2014 9:58:34 AM	14572
EPA METHOD 300.0: ANIONS							Analyst: JRR
Chloride	1600	150		mg/Kg	100	8/6/2014 1:33:44 PM	14585
EPA METHOD 8260B: VOLATILES SHORT LIST							Analyst: KJH
Benzene	ND	0.047		mg/Kg	1	8/5/2014 6:36:52 PM	14583
Toluene	ND	0.047		mg/Kg	1	8/5/2014 6:36:52 PM	14583
Ethylbenzene	ND	0.047		mg/Kg	1	8/5/2014 6:36:52 PM	14583
Xylenes, Total	ND	0.094		mg/Kg	1	8/5/2014 6:36:52 PM	14583
Surr: 1,2-Dichloroethane-d4	87.7	70-130		%REC	1	8/5/2014 6:36:52 PM	14583
Surr: 4-Bromofluorobenzene	85.8	70-130		%REC	1	8/5/2014 6:36:52 PM	14583
Surr: Dibromofluoromethane	89.7	70-130		%REC	1	8/5/2014 6:36:52 PM	14583
Surr: Toluene-d8	93.6	70-130		%REC	1	8/5/2014 6:36:52 PM	14583
EPA METHOD 8015D MOD: GASOLINE RANGE							Analyst: KJH
Gasoline Range Organics (GRO)	ND	4.7		mg/Kg	1	8/5/2014 6:36:52 PM	14583
Surr: BFB	113	61.2-137		%REC	1	8/5/2014 6:36:52 PM	14583

Refer to the QC Summary report and sample login checklist for flagged QC data and preservation information.

Qualifiers:	*	Value exceeds Maximum Contaminant Level.	B	Analyte detected in the associated Method Blank	Page 3 of 10
	E	Value above quantitation range	H	Holding times for preparation or analysis exceeded	
	J	Analyte detected below quantitation limits	ND	Not Detected at the Reporting Limit	
	O	RSD is greater than RSDlimit	P	Sample pH greater than 2.	
	R	RPD outside accepted recovery limits	RL	Reporting Detection Limit	
	S	Spike Recovery outside accepted recovery limits			

Hall Environmental Analysis Laboratory, Inc.

Analytical Report

Lab Order **1408023**

Date Reported: **8/8/2014**

CLIENT: R.T. Hicks Consultants, LTD

Client Sample ID: 10'E@surface

Project: Murchison - Hackberry St. #1 Release

Collection Date: 7/29/2014 9:15:00 AM

Lab ID: 1408023-004

Matrix: SOIL

Received Date: 8/1/2014 8:45:00 AM

Analyses	Result	RL	Qual	Units	DF	Date Analyzed	Batch
EPA METHOD 300.0: ANIONS							Analyst: JRR
Chloride	18000	3000		mg/Kg	2E	8/6/2014 1:46:09 PM	14585

Refer to the QC Summary report and sample login checklist for flagged QC data and preservation information.

Qualifiers:	*	Value exceeds Maximum Contaminant Level.	B	Analyte detected in the associated Method Blank	Page 4 of 10
	E	Value above quantitation range	H	Holding times for preparation or analysis exceeded	
	J	Analyte detected below quantitation limits	ND	Not Detected at the Reporting Limit	
	O	RSD is greater than RSDlimit	P	Sample pH greater than 2.	
	R	RPD outside accepted recovery limits	RL	Reporting Detection Limit	
	S	Spike Recovery outside accepted recovery limits			

Hall Environmental Analysis Laboratory, Inc.

Analytical Report

Lab Order **1408023**

Date Reported: **8/8/2014**

CLIENT: R.T. Hicks Consultants, LTD

Client Sample ID: 20'E@surface

Project: Murchison - Hackberry St. #1 Release

Collection Date: 7/29/2014 10:30:00 AM

Lab ID: 1408023-005

Matrix: SOIL

Received Date: 8/1/2014 8:45:00 AM

Analyses	Result	RL	Qual	Units	DF	Date Analyzed	Batch
EPA METHOD 300.0: ANIONS							Analyst: LGP
Chloride	56	30		mg/Kg	20	8/4/2014 5:22:14 PM	14585

Refer to the QC Summary report and sample login checklist for flagged QC data and preservation information.

Qualifiers:	*	Value exceeds Maximum Contaminant Level.	B	Analyte detected in the associated Method Blank	Page 5 of 10
	E	Value above quantitation range	H	Holding times for preparation or analysis exceeded	
	J	Analyte detected below quantitation limits	ND	Not Detected at the Reporting Limit	
	O	RSD is greater than RSDlimit	P	Sample pH greater than 2.	
	R	RPD outside accepted recovery limits	RL	Reporting Detection Limit	
	S	Spike Recovery outside accepted recovery limits			

Hall Environmental Analysis Laboratory, Inc.

Analytical Report

Lab Order **1408023**

Date Reported: **8/8/2014**

CLIENT: R.T. Hicks Consultants, LTD

Client Sample ID: 10'S@1'

Project: Murchison - Hackberry St. #1 Release

Collection Date: 7/29/2014 9:22:00 AM

Lab ID: 1408023-006

Matrix: SOIL

Received Date: 8/1/2014 8:45:00 AM

Analyses	Result	RL	Qual	Units	DF	Date Analyzed	Batch
EPA METHOD 300.0: ANIONS							Analyst: LGP
Chloride	85	30		mg/Kg	20	8/4/2014 5:34:39 PM	14585

Refer to the QC Summary report and sample login checklist for flagged QC data and preservation information.

Qualifiers:	*	Value exceeds Maximum Contaminant Level.	B	Analyte detected in the associated Method Blank	Page 6 of 10
	E	Value above quantitation range	H	Holding times for preparation or analysis exceeded	
	J	Analyte detected below quantitation limits	ND	Not Detected at the Reporting Limit	
	O	RSD is greater than RSDlimit	P	Sample pH greater than 2.	
	R	RPD outside accepted recovery limits	RL	Reporting Detection Limit	
	S	Spike Recovery outside accepted recovery limits			

QC SUMMARY REPORT

Hall Environmental Analysis Laboratory, Inc.

WO#: 1408023

08-Aug-14

Client: R.T. Hicks Consultants, LTD

Project: Murchison - Hackberry St. #1 Release

Sample ID	MB-14585	SampType:	MBLK	TestCode:	EPA Method 300.0: Anions					
Client ID:	PBS	Batch ID:	14585	RunNo:	20370					
Prep Date:	8/4/2014	Analysis Date:	8/4/2014	SeqNo:	592455	Units:	mg/Kg			
Analyte	Result	PQL	SPK value	SPK Ref Val	%REC	LowLimit	HighLimit	%RPD	RPDLimit	Qual
Chloride	ND	1.5								

Sample ID	LCS-14585	SampType:	LCS	TestCode:	EPA Method 300.0: Anions					
Client ID:	LCSS	Batch ID:	14585	RunNo:	20370					
Prep Date:	8/4/2014	Analysis Date:	8/4/2014	SeqNo:	592456	Units:	mg/Kg			
Analyte	Result	PQL	SPK value	SPK Ref Val	%REC	LowLimit	HighLimit	%RPD	RPDLimit	Qual
Chloride	14	1.5	15.00	0	92.9	90	110			

Qualifiers:

* Value exceeds Maximum Contaminant Level.
E Value above quantitation range
J Analyte detected below quantitation limits
O RSD is greater than RSDlimit
R RPD outside accepted recovery limits
S Spike Recovery outside accepted recovery limits

B Analyte detected in the associated Method Blank
H Holding times for preparation or analysis exceeded
ND Not Detected at the Reporting Limit
P Sample pH greater than 2.
RL Reporting Detection Limit

QC SUMMARY REPORT

Hall Environmental Analysis Laboratory, Inc.

WO#: 1408023

08-Aug-14

Client: R.T. Hicks Consultants, LTD

Project: Murchison - Hackberry St. #1 Release

Sample ID	MB-14572		SampType: MBLK		TestCode: EPA Method 8015D: Diesel Range Organics					
Client ID:	PBS		Batch ID: 14572		RunNo: 20327					
Prep Date:	8/4/2014		Analysis Date: 8/4/2014		SeqNo: 591198		Units: mg/Kg			
Analyte	Result	PQL	SPK value	SPK Ref Val	%REC	LowLimit	HighLimit	%RPD	RPDLimit	Qual
Diesel Range Organics (DRO)	ND	10								
Motor Oil Range Organics (MRO)	ND	50								
Surr: DNOP	11		10.00		107	57.9	140			

Sample ID	LCS-14572		SampType: LCS		TestCode: EPA Method 8015D: Diesel Range Organics					
Client ID:	LCSS		Batch ID: 14572		RunNo: 20327					
Prep Date:	8/4/2014		Analysis Date: 8/4/2014		SeqNo: 591199		Units: mg/Kg			
Analyte	Result	PQL	SPK value	SPK Ref Val	%REC	LowLimit	HighLimit	%RPD	RPDLimit	Qual
Diesel Range Organics (DRO)	54	10	50.00	0	108	68.6	130			
Surr: DNOP	5.4		5.000		109	57.9	140			

Sample ID	1408023-001AMS		SampType: MS		TestCode: EPA Method 8015D: Diesel Range Organics					
Client ID:	#1@surface		Batch ID: 14572		RunNo: 20364					
Prep Date:	8/4/2014		Analysis Date: 8/5/2014		SeqNo: 592232		Units: mg/Kg			
Analyte	Result	PQL	SPK value	SPK Ref Val	%REC	LowLimit	HighLimit	%RPD	RPDLimit	Qual
Diesel Range Organics (DRO)	100	10	49.90	39.81	120	40.1	152			
Surr: DNOP	4.9		4.990		98.9	57.9	140			

Sample ID	1408023-001AMSD		SampType:	MSD		TestCode:	EPA Method 8015D: Diesel Range Organics				
Client ID:	#1@surface		Batch ID:	14572		RunNo:	20364				
Prep Date:	8/4/2014		Analysis Date:	8/5/2014		SeqNo:	592233		Units: mg/Kg		
Analyte	Result	PQL	SPK value	SPK Ref Val	%REC	LowLimit	HighLimit	%RPD	RPDLimit	Qual	
Diesel Range Organics (DRO)	85	10	49.90	39.81	91.3	40.1	152	15.4	32.1		
Surr: DNOP	4.9		4.990		99.2	57.9	140	0	0		

Qualifiers:

- | | |
|---|--|
| * Value exceeds Maximum Contaminant Level. | B Analyte detected in the associated Method Blank |
| E Value above quantitation range | H Holding times for preparation or analysis exceeded |
| J Analyte detected below quantitation limits | ND Not Detected at the Reporting Limit |
| O RSD is greater than RSDlimit | P Sample pH greater than 2. |
| R RPD outside accepted recovery limits | RL Reporting Detection Limit |
| S Spike Recovery outside accepted recovery limits | |

QC SUMMARY REPORT

Hall Environmental Analysis Laboratory, Inc.

WO#: 1408023

08-Aug-14

Client: R.T. Hicks Consultants, LTD

Project: Murchison - Hackberry St. #1 Release

Sample ID	mb-14583		SampType: MBLK		TestCode: EPA Method 8260B: Volatiles Short List					
Client ID:	PBS		Batch ID: 14583		RunNo: 20375					
Prep Date:	8/4/2014		Analysis Date: 8/5/2014		SeqNo: 592931		Units: mg/Kg			
Analyte	Result	PQL	SPK value	SPK Ref Val	%REC	LowLimit	HighLimit	%RPD	RPDLimit	Qual
Benzene	ND	0.050								
Toluene	ND	0.050								
Ethylbenzene	ND	0.050								
Xylenes, Total	ND	0.10								
Surr: 1,2-Dichloroethane-d4	0.45		0.5000		89.6	70	130			
Surr: 4-Bromofluorobenzene	0.43		0.5000		85.4	70	130			
Surr: Dibromofluoromethane	0.44		0.5000		87.9	70	130			
Surr: Toluene-d8	0.47		0.5000		94.8	70	130			

Sample ID	lcs-14583		SampType: LCS		TestCode: EPA Method 8260B: Volatiles Short List					
Client ID:	LCSS		Batch ID: 14583		RunNo: 20375					
Prep Date:	8/4/2014		Analysis Date: 8/5/2014		SeqNo: 592936		Units: mg/Kg			
Analyte	Result	PQL	SPK value	SPK Ref Val	%REC	LowLimit	HighLimit	%RPD	RPDLimit	Qual
Benzene	0.99	0.050	1.000	0	99.0	70	130			
Toluene	0.99	0.050	1.000	0	99.4	60.1	120			
Surr: 1,2-Dichloroethane-d4	0.43		0.5000		86.6	70	130			
Surr: 4-Bromofluorobenzene	0.41		0.5000		82.7	70	130			
Surr: Dibromofluoromethane	0.43		0.5000		86.9	70	130			
Surr: Toluene-d8	0.46		0.5000		92.6	70	130			

Qualifiers:

* Value exceeds Maximum Contaminant Level.
E Value above quantitation range
J Analyte detected below quantitation limits
O RSD is greater than RSDlimit
R RPD outside accepted recovery limits
S Spike Recovery outside accepted recovery limits

B Analyte detected in the associated Method Blank
H Holding times for preparation or analysis exceeded
ND Not Detected at the Reporting Limit
P Sample pH greater than 2.
RL Reporting Detection Limit

QC SUMMARY REPORT

Hall Environmental Analysis Laboratory, Inc.

WO#: 1408023

08-Aug-14

Client: R.T. Hicks Consultants, LTD

Project: Murchison - Hackberry St. #1 Release

Sample ID	mb-14583		SampType: MBLK		TestCode: EPA Method 8015D Mod: Gasoline Range					
Client ID:	PBS		Batch ID: 14583		RunNo: 20375					
Prep Date:	8/4/2014		Analysis Date: 8/5/2014		SeqNo: 592993		Units: mg/Kg			
Analyte	Result	PQL	SPK value	SPK Ref Val	%REC	LowLimit	HighLimit	%RPD	RPDLimit	Qual
Gasoline Range Organics (GRO)	ND	5.0								
Surr: BFB	530		500.0		106	61.2	137			

Sample ID	lcs-14583		SampType: LCS		TestCode: EPA Method 8015D Mod: Gasoline Range					
Client ID:	LCSS		Batch ID: 14583		RunNo: 20375					
Prep Date:	8/4/2014		Analysis Date: 8/5/2014		SeqNo: 592994		Units: mg/Kg			
Analyte	Result	PQL	SPK value	SPK Ref Val	%REC	LowLimit	HighLimit	%RPD	RPDLimit	Qual
Gasoline Range Organics (GRO)	29	5.0	25.00	0	117	80	120			
Surr: BFB	550		500.0		110	61.2	137			

Sample ID	1408023-001ams		SampType: MS		TestCode: EPA Method 8015D Mod: Gasoline Range					
Client ID:	#1@surface		Batch ID: 14583		RunNo: 20375					
Prep Date:	8/4/2014		Analysis Date: 8/5/2014		SeqNo: 592997		Units: mg/Kg			
Analyte	Result	PQL	SPK value	SPK Ref Val	%REC	LowLimit	HighLimit	%RPD	RPDLimit	Qual
Gasoline Range Organics (GRO)	36	4.7	23.74	0.8302	146	58	134			S
Surr: BFB	530		474.8		112	61.2	137			

Sample ID	1408023-001amsd		SampType: MSD		TestCode: EPA Method 8015D Mod: Gasoline Range					
Client ID:	#1@surface		Batch ID: 14583		RunNo: 20375					
Prep Date:	8/4/2014		Analysis Date: 8/5/2014		SeqNo: 592998		Units: mg/Kg			
Analyte	Result	PQL	SPK value	SPK Ref Val	%REC	LowLimit	HighLimit	%RPD	RPDLimit	Qual
Gasoline Range Organics (GRO)	35	4.7	23.72	0.8302	143	58	134	2.39	20	S
Surr: BFB	530		474.4		113	61.2	137	0	0	

Sample ID	MB-14583MK		SampType: MBLK		TestCode: EPA Method 8015D Mod: Gasoline Range					
Client ID:	PBS		Batch ID: R20375		RunNo: 20375					
Prep Date:	8/4/2014		Analysis Date: 8/5/2014		SeqNo: 593004		Units: %REC			
Analyte	Result	PQL	SPK value	SPK Ref Val	%REC	LowLimit	HighLimit	%RPD	RPDLimit	Qual
Surr: BFB	530		500.0		106	61.2	137			

Sample ID	LCS-14583MK		SampType: LCS		TestCode: EPA Method 8015D Mod: Gasoline Range					
Client ID:	LCSS		Batch ID: R20375		RunNo: 20375					
Prep Date:	8/4/2014		Analysis Date: 8/5/2014		SeqNo: 593008		Units: %REC			
Analyte	Result	PQL	SPK value	SPK Ref Val	%REC	LowLimit	HighLimit	%RPD	RPDLimit	Qual
Surr: BFB	550		500.0		110	61.2	137			

Qualifiers:

- | | |
|---|--|
| * Value exceeds Maximum Contaminant Level. | B Analyte detected in the associated Method Blank |
| E Value above quantitation range | H Holding times for preparation or analysis exceeded |
| J Analyte detected below quantitation limits | ND Not Detected at the Reporting Limit |
| O RSD is greater than RSDlimit | P Sample pH greater than 2. |
| R RPD outside accepted recovery limits | RL Reporting Detection Limit |
| S Spike Recovery outside accepted recovery limits | |

Sample Log-In Check List

Client Name: RT HICKS

Work Order Number: 1408023

RcptNo: 1

Received by/date:

MG 08/01/14

Logged By:

Celina Sessa

8/1/2014 8:45:00 AM

Celina Sessa

Completed By:

Celina Sessa

8/1/2014 3:49:21 PM

Celina Sessa

Reviewed By:



08/04/14

Chain of Custody

1. Custody seals intact on sample bottles? Yes ☐ No ☐ Not Present ☒
2. Is Chain of Custody complete? Yes ☒ No ☐ Not Present ☐
3. How was the sample delivered? FedEx

Log In

4. Was an attempt made to cool the samples? Yes ☒ No ☐ NA ☐
5. Were all samples received at a temperature of >0° C to 6.0°C Yes ☒ No ☐ NA ☐
6. Sample(s) in proper container(s)? Yes ☒ No ☐
7. Sufficient sample volume for indicated test(s)? Yes ☒ No ☐
8. Are samples (except VOA and ONG) properly preserved? Yes ☒ No ☐
9. Was preservative added to bottles? Yes ☐ No ☒ NA ☐
10. VOA vials have zero headspace? Yes ☐ No ☐ No VOA Vials ☒
11. Were any sample containers received broken? Yes ☐ No ☒
12. Does paperwork match bottle labels?
(Note discrepancies on chain of custody) Yes ☒ No ☐
13. Are matrices correctly identified on Chain of Custody? Yes ☒ No ☐
14. Is it clear what analyses were requested? Yes ☒ No ☐
15. Were all holding times able to be met?
(If no, notify customer for authorization.) Yes ☒ No ☐

of preserved
bottles checked
for pH:

(<2 or >12 unless noted)

Adjusted?

Checked by:

Special Handling (if applicable)

16. Was client notified of all discrepancies with this order? Yes ☐ No ☐ NA ☒

Person Notified:

Date:

By Whom:

Via:

☐ eMail

☐ Phone

☐ Fax

☐ In Person

Regarding:

Client Instructions:

17. Additional remarks:

18. Cooler Information

Cooler No	Temp °C	Condition	Seal Intact	Seal No	Seal Date	Signed By
1	2.4	Good	Yes			

From: [Bratcher, Mike, EMNRD](#)
To: [Kristin Pope](#)
Cc: ["Randy Hicks"; ccottrell@jdmii.com; "Chace Walls"; gboans@jdmii.com; Martin, Ed; Patterson, Heather, EMNRD](#)
Subject: RE: Final C-141/Closure Request: Murchison - Hackberry St. #1 Release
Date: Thursday, October 02, 2014 9:11:11 AM

RE: Murchison O&G * Hackberry St. 1 * 30-015-34803 * O-17-18s-23e
NMOCD Tracking: **2RP-2347** * Date of release: 5/19/14

Kristin,

You are approved to commence backfill operations at the above referenced release site. Backfilling at this point will be "at risk" to some degree, pending the lab results. I would not expect it to be an issue, but just be advised.

Thanks,

Mike Bratcher
NMOCD District 2
811 S. First Street
Artesia, NM 88210
O: 575-748-1283 X108
C: 575-626-0857
F: 575-748-9720

From: Kristin Pope [<mailto:kristin@rthicksconsult.com>]
Sent: Thursday, October 02, 2014 7:01 AM
To: Bratcher, Mike, EMNRD
Cc: 'Randy Hicks'; ccottrell@jdmii.com; 'Chace Walls'; gboans@jdmii.com; Martin, Ed; Patterson, Heather, EMNRD
Subject: RE: Final C-141/Closure Request: Murchison - Hackberry St. #1 Release

Mr. Bratcher:

Excavation was completed at this site on Tuesday, September 30. There were 2 excavations:

1. The area east of the tank (labeled as sample point #1 on the attached figure) was excavated to 40 x 23 x 2-ft to remove the bulk of the chloride-affected material. A composite sample from the excavated surface at 2-ft BGS yielded 631 mg/kg Chloride using a field test.
2. The area of the release just north of the tank (sample point #2) was excavated to 8 x 15 x 2-ft and a composite of the excavated surface was 494 mg/kg Chloride via field test.

We will request laboratory analyses for chloride on select samples. All lab and field test results will be presented in the final C-141 submission. The excavated soil is currently staged on top of a 20-mil liner on the location with an earthen berm surrounding. Based on the field test results, we would like to begin backfilling the excavation with clean material as soon as possible. Please let me know if you have any questions about this excavation. Thank you.

Kristin Pope
R.T. Hicks Consultants
Carlsbad Field Office
575.302.6755

From: Kristin Pope [<mailto:kristin@rthicksconsult.com>]
Sent: Tuesday, September 30, 2014 7:00 AM
To: 'Bratcher, Mike, EMNRD'
Cc: 'Randy Hicks'; ccottrell@jdmii.com; 'Chace Walls'; gboans@jdmii.com; 'Martin, Ed'; 'Patterson, Heather, EMNRD'
Subject: RE: Final C-141/Closure Request: Murchison - Hackberry St. #1 Release

Mr. Bratcher:

Thanks to you and Ms. Patterson for meeting with us last week. As we agreed, based on previous delineation data, not all of the green footprint area shown on the submitted map will require excavation. The One-Call was placed for this work immediately after the meeting, but scheduling has been a bit difficult. A break in the contractor's schedule opened up and a backhoe has become available to perform this work today.

As also discussed during the meeting, we believe the 7/29/2014 delineation data provides sufficient correlation between field and lab tests for chloride and therefore, we agreed that lab confirmation at this event is not necessary.

I will call you today with an update on these activities and field test results. Please call me if you have any questions regarding this work.

Thanks again.

Kristin Pope
R.T. Hicks Consultants
Carlsbad Field Office
575.302.6755

From: Bratcher, Mike, EMNRD [<mailto:mike.bratcher@state.nm.us>]
Sent: Tuesday, September 16, 2014 12:57 PM
To: Kristin Pope
Cc: Randy Hicks; ccottrell@jdmii.com; Chace Walls; gboans@jdmii.com; Martin, Ed; Patterson, Heather, EMNRD
Subject: RE: Final C-141/Closure Request: Murchison - Hackberry St. #1 Release

RE: Murchison Oil & Gas * Hackberry St 001 * 30-015-34803 * Eddy County
NMOCD Tracking Number: **2RP-2347** * Date of release: 5/9/14

Ms. Pope,

Your proposal to defer clean-up of the above referenced release to the time of plug and

abandonment of the well, is **denied**. The Form C-141 marked Final Report, is also **denied**. OCD will require, at a minimum, one foot of material be removed across the areas identified in green on your site map (Figure 1). The excavated material is to be disposed of at an OCD approved disposal facility.

Due to recent and ongoing rains that have occurred in the area since the last sampling event, confirmation samples will now be required in the excavated areas, with the lab results submitted to OCD for review and approval, prior to backfilling. Work at this site is to commence as soon as weather permits. Please notify the District 2 office 48 hours prior to commencement of remedial activities.

OCD approval does not relieve the operator of liability should their operations fail to adequately investigate and remediate contamination that may pose a threat to ground water, surface water, human health or the environment. In addition, OCD approval does not relieve the operator of responsibility for compliance with any other federal, state, local laws and/or regulations.

If you have any questions or concerns, and for notification, please contact me.

Mike Bratcher
NMOCD District 2
811 S. First Street
Artesia, NM 88210
O: 575-748-1283 X108
C: 575-626-0857
F: 575-748-9720

From: Kristin Pope [<mailto:kristin@rthicksconsult.com>]
Sent: Thursday, September 11, 2014 11:35 AM
To: Bratcher, Mike, EMNRD
Cc: Randy Hicks; ccottrell@jdmii.com; Chace Walls; gboans@jdmii.com; Martin, Ed
Subject: Final C-141/Closure Request: Murchison - Hackberry St. #1 Release

Mr. Bratcher:

On behalf of Murchison Oil and Gas, please find the attached closure request and submission of the final C-141 form for the **Hackberry State #1 release** located near Hope. I will be going through Artesia this afternoon and will deliver a hard copy to your office.

We appreciate your attention to this and all of our projects. Please contact me with any questions regarding this closure request.

Thank you.

Kristin Pope
R.T. Hicks Consultants

Carlsbad Field Office

575.302.6755

From: [Kristin Pope](#)
To: ["Bratcher, Mike, EMNRD"](#)
Cc: ["Patterson, Heather, EMNRD"](#); ["Greg Boans"](#); ["Chace Walls"](#); ["Randy Hicks"](#); ["Griswold, Jim, EMNRD"](#)
Subject: RE: Hackberry State 1 Release
Date: Friday, August 22, 2014 3:22:00 PM
Attachments: [Hackberry_Fig.pdf](#)
[LAB Delineation_07.29.14.pdf](#)

Mr. Bratcher:

On behalf of Murchison, please find the attached figure showing the chloride delineation results of the Hackberry #1 release and the laboratory report. We used the largest pooling area, sample point #1, as our baseline and all lateral measurements are from #1.

Kristin Pope
R.T. Hicks Consultants
Carlsbad Field Office
575.302.6755

From: Kristin Pope [mailto:kristin@rthicksconsult.com]
Sent: Monday, July 28, 2014 7:34 AM
To: 'Bratcher, Mike, EMNRD'
Cc: 'Patterson, Heather, EMNRD'; 'Greg Boans'; 'Chace Walls'; 'Randy Hicks'; 'Griswold, Jim, EMNRD'
Subject: RE: Hackberry State 1 Release

Mr. Bratcher,

Delineation of this release will be conducted on Wednesday, July 30, 2014 beginning around 8am. A backhoe will be used to collect samples under the direction of R.T. Hicks Consultants. Please contact me with any questions about this event. Thanks.

Kristin Pope
R.T. Hicks Consultants
Carlsbad Field Office
575.302.6755

From: Bratcher, Mike, EMNRD [mailto:mike.bratcher@state.nm.us]
Sent: Wednesday, July 16, 2014 9:09 AM
To: Kristin Pope
Cc: Patterson, Heather, EMNRD; Greg Boans; Chace Walls; Randy Hicks; Griswold, Jim, EMNRD
Subject: RE: Hackberry State 1 Release

Ms. Pope,

OCD will require a complete vertical and horizontal delineation of the site utilizing conventional methods, ie, obtaining representative samples from all impacted areas and having those samples

analyzed at an OCD approved lab. The delineation process is to commence not later than July 31, 2014 and continue until the delineation is complete. OCD is to be notified 48 hours prior to commencement of the delineation process. The results of the lab analyses are to be provided to OCD upon completion by the lab. This should be accomplished, and OCD should have the analytical data, not later than August 22, 2014. Murchison may then have until September 15, 2014 to submit a proposal for remediation of the site. This provides for the 60 day extension as requested, and provides OCD with the required data. OCD will not consider any type of risk-based closure for the site without the delineation data.

If you have any questions or concerns, and for notification, please contact me.

Mike Bratcher
NMOCD District 2
811 S. First Street
Artesia, NM 88210
O: 575-748-1283 X108
C: 575-626-0857
F: 575-748-9720

From: Kristin Pope [<mailto:kristin@rthicksconsult.com>]
Sent: Tuesday, July 15, 2014 12:55 PM
To: Bratcher, Mike, EMNRD
Cc: Patterson, Heather, EMNRD; Greg Boans; Chace Walls; Randy Hicks
Subject: RE: Hackberry State 1 Release

Mr. Bratcher,

On behalf of Murchison, we respectfully request a 60-day extension to submit a proposed plan. We are in the process of working with BLM to develop a protocol for a similar situation. We hope to apply this protocol to all facilities to satisfy NMOCD, SLO, and BLM and 60 more days should give us enough time to finalize this plan.

Depth to groundwater is approximately 450 ft with the nearest well a bit more than a mile away from the Hackberry State #1. The release was confined to the location. We believe an extension of 60 days will not endanger freshwater, public health, or the environment. We appreciate your consideration of this request. Thank you.

Kristin Pope
R.T. Hicks Consultants
Carlsbad Field Office
575.302.6755

From: Bratcher, Mike, EMNRD [<mailto:mike.bratcher@state.nm.us>]
Sent: Tuesday, June 17, 2014 9:10 AM
To: Greg Boans; 'Kristin Pope' (kristin@rthicksconsult.com)
Cc: Patterson, Heather, EMNRD

Subject: Hackberry State 1 Release

RE: Murchison O&G * Hackberry St. 001 * 30-015-34803 * O-17-18s-23e * Eddy County, New Mexico

155 bbl net produced water release on 5/19/2014

Mr. Boans,

NMOCD is in receipt of an Initial Report form C-141 for the above referenced produced fluid release. The C-141 will not be approved as submitted. It will be accepted for record and entered into OCD database, showing as an open non-compliance issue. OCD will require Murchison to perform a vertical and horizontal delineation of the site, and submit a remediation proposal based on the delineation results and site ranking. The form C-141 will be processed today, June 17, 2014. Murchison will have 30 days to complete the delineation and submit a proposal.

If you have any questions or concerns, please contact me.

Mike Bratcher
NMOCD District 2
811 S. First Street
Artesia, NM 88210
O: 575-748-1283 X108
C: 575-626-0857
F: 575-748-9720