

**U/L A, Section 33, T23S, R29E  
Eddy County, NM  
N 32.26731° W 103.98449° at stake  
API#30-015-41557**

<b>BBC International, Inc.</b>	
<b>Oxy</b>	
<b>Cypress 33 Federal #6H</b>	
Date: 11/17/14	DRWG by: K. Purvis
<i>NOT TO SCALE</i>	File: Oxy 2014





# Groundwater Plot

## Oxy Cypress 33 Federal #6H

County  
Eddy

Unit Letter  
A

Section  
33

Township  
23S

Range  
29E

Trend Map 50'-75'

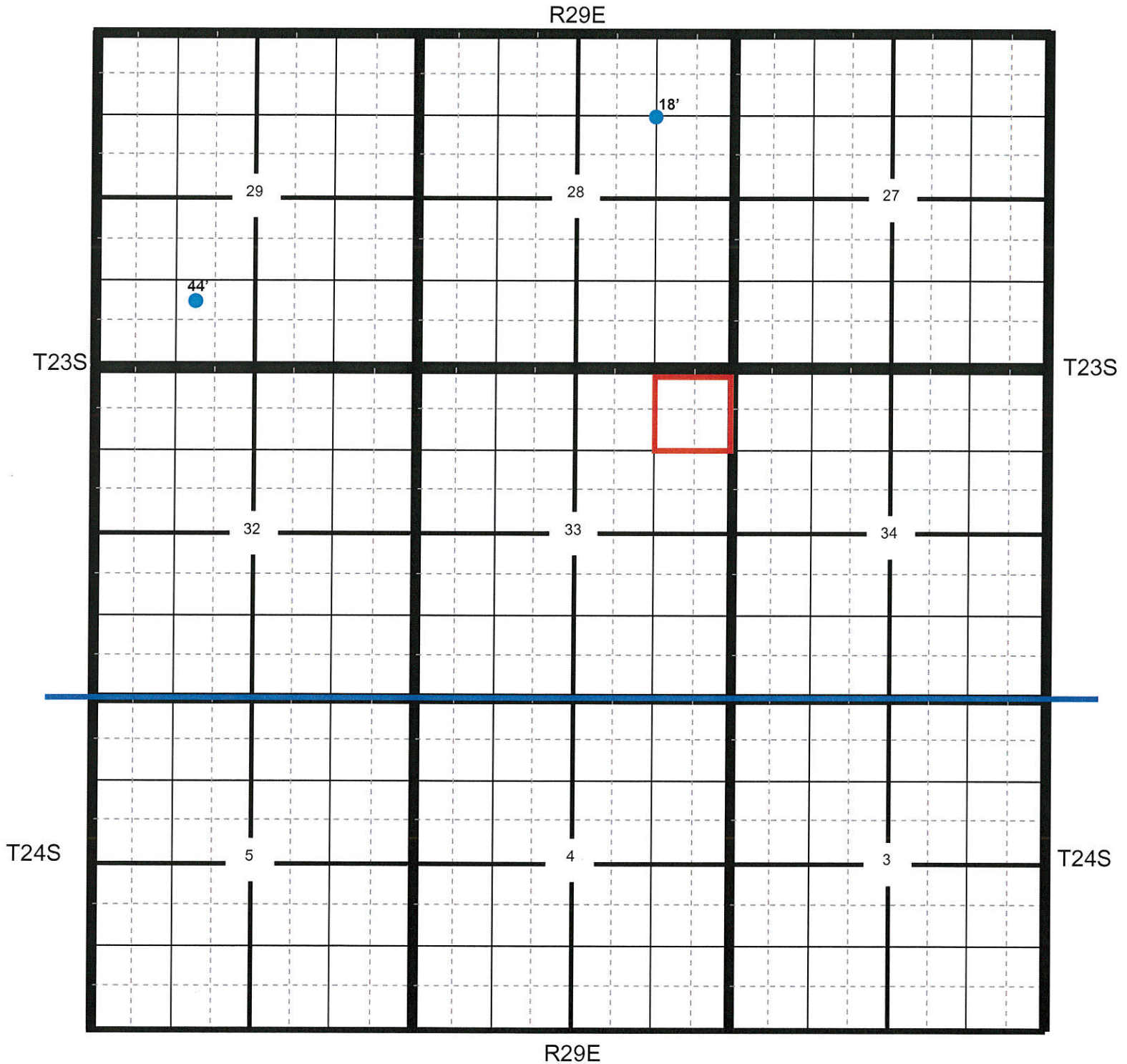

Location

OCD

USGS

SEO

All Databases

## Oxy Cypress 33 Federal #6H

**County**  
Eddy

**Unit Letter**  
A

**Section**  
33

**Township**  
23S

**Range**  
29E

Trend Map 50'-75'

1

2

NW/NW <b>None found</b>	NE/NW	NW/NE	NE/NE
Unit Letter D	Unit Letter C	Unit Letter B	Unit Letter A
SW/NW	SE/NW	SW/NE	SE/NE
Unit Letter E	Unit Letter F	Unit Letter G	Unit Letter H
NW/SW	NE/SW	NW/SE	NE/SE
Unit Letter L	Unit Letter K	Unit Letter J	Unit Letter I
SW/SW	SE/SW	SW/SE	SE/SE
Unit Letter M	Unit Letter N	Unit Letter O	Unit Letter P

3

4

📍 Location

🟠 OCD

🟢 USGS

🟡 SEO

🟣 All Databases

**Laboratory Analytical Results Summary**  
**Cypress 33 Fed #6H (11-6-14)**

		Sample	SP1 @ 1'	SP1 @ 2'
Analyte	Method	Date	3/5/15	3/5/15
			mg/Kg	mg/Kg
Benzene	BTEX 8021B		<0.050	<0.050
Toluene	BTEX 8021B		<0.050	<0.050
Ethylbenzene	BTEX 8021B		<0.050	<0.050
Total Xylenes	BTEX 8021B		<0.150	<0.150
Total BTEX	BTEX 8021B		<0.300	<0.300
Chloride	SM4500Cl-B		240	<16.0
GRO	TPH 8015M		<10.0	<10.0
DRO	TPH 8015M		<10.0	<10.0

		Sample	SP2 @ 1'	SP2 @ 2'	SP2 @ 3'
Analyte	Method	Date	3/5/15	3/5/15	3/5/15
			mg/Kg	mg/Kg	mg/Kg
Benzene	BTEX 8021B		<0.050	<0.050	<0.050
Toluene	BTEX 8021B		<0.050	<0.050	<0.050
Ethylbenzene	BTEX 8021B		<0.050	<0.050	<0.050
Total Xylenes	BTEX 8021B		0.249	<0.150	<0.150
Total BTEX	BTEX 8021B		<0.300	<0.300	<0.300
Chloride	SM4500Cl-B		1630	256	<16.0
GRO	TPH 8015M		10.8	<10.0	<10.0
DRO	TPH 8015M		431	<10.0	<10.0

		Sample	SP3 @ 1'	SP3 @ 2'	SP3 @ 3'
Analyte	Method	Date	3/5/15	3/5/15	3/5/15
			mg/Kg	mg/Kg	mg/Kg
Benzene	BTEX 8021B		<0.050	<0.050	<0.050
Toluene	BTEX 8021B		0.077	<0.050	<0.050
Ethylbenzene	BTEX 8021B		0.087	<0.050	<0.050
Total Xylenes	BTEX 8021B		1.23	<0.150	<0.150
Total BTEX	BTEX 8021B		1.4	<0.300	<0.300
Chloride	SM4500Cl-B		2840	272	64
GRO	TPH 8015M		32.6	<10.0	<10.0
DRO	TPH 8015M		2090	272	<10.0

		Sample	SP4 @ 1'	SP4 @ 2'	SP2 @ 3'
Analyte	Method	Date	3/6/15	3/6/15	3/5/15
			mg/Kg	mg/Kg	mg/Kg
Benzene	BTEX 8021B		<0.050	<0.050	<0.050
Toluene	BTEX 8021B		<0.050	<0.050	<0.050
Ethylbenzene	BTEX 8021B		<0.050	<0.050	<0.050
Total Xylenes	BTEX 8021B		<0.150	<0.150	<0.150
Total BTEX	BTEX 8021B		<0.300	<0.300	<0.300
Chloride	SM4500Cl-B		6320	208	64
GRO	TPH 8015M		11	<10.0	<10.0
DRO	TPH 8015M		372	<10.0	<10.0



PHONE (575) 393-2326 ° 101 E. MARLAND ° HOBBS, NM 88240

---

March 11, 2015

Cliff Brunson

BBC International, Inc.

P.O. Box 805

Hobbs, NM 88241

RE: CYPRESS 33 FEDERAL #6H

Enclosed are the results of analyses for samples received by the laboratory on 03/06/15 10:20.

Cardinal Laboratories is accredited through Texas NELAP under certificate number T104704398-13-5. Accreditation applies to drinking water, non-potable water and solid and chemical materials. All accredited analytes are denoted by an asterisk (\*). For a complete list of accredited analytes and matrices visit the TCEQ website at [www.tceq.texas.gov/field/qa/lab\\_accred\\_certif.html](http://www.tceq.texas.gov/field/qa/lab_accred_certif.html).

Cardinal Laboratories is accredited through the State of Colorado Department of Public Health and Environment for:

Method EPA 552.2	Haloacetic Acids (HAA-5)
Method EPA 524.2	Total Trihalomethanes (TTHM)
Method EPA 524.4	Regulated VOCs (V1, V2, V3)

Accreditation applies to public drinking water matrices.

This report meets NELAP requirements and is made up of a cover page, analytical results, and a copy of the original chain-of-custody. If you have any questions concerning this report, please feel free to contact me.

Sincerely,

Caley D. Keene

Lab Director/Quality Manager



**Analytical Results For:**

BBC International, Inc.  
Cliff Brunson  
P.O. Box 805  
Hobbs NM, 88241  
Fax To: (575) 397-0397

Received: 03/06/2015  
Reported: 03/11/2015  
Project Name: CYPRESS 33 FEDERAL #6H  
Project Number: OXY  
Project Location: RAWHIDE RD

Sampling Date: 03/04/2015  
Sampling Type: Soil  
Sampling Condition: Cool & Intact  
Sample Received By: Jodi Henson

**Sample ID: SP 1 @ 1' (H500624-01)**

BTX 8021B		mg/kg		Analyzed By: ms						
Analyte	Result	Reporting Limit	Analyzed	Method Blank	BS	% Recovery	True Value QC	RPD	Qualifier	
Benzene*	<0.050	0.050	03/10/2015	ND	2.06	103	2.00	5.50		
Toluene*	<0.050	0.050	03/10/2015	ND	1.86	93.2	2.00	5.62		
Ethylbenzene*	<0.050	0.050	03/10/2015	ND	2.18	109	2.00	5.78		
Total Xylenes*	<0.150	0.150	03/10/2015	ND	6.03	100	6.00	5.94		
Total BTX	<0.300	0.300	03/10/2015	ND						

Surrogate: 4-Bromofluorobenzene (PID) 116 % 61-154

Chloride, SM4500Cl-B		mg/kg		Analyzed By: AP						
Analyte	Result	Reporting Limit	Analyzed	Method Blank	BS	% Recovery	True Value QC	RPD	Qualifier	
Chloride	240	16.0	03/09/2015	ND	400	100	400	3.92		

TPH 8015M		mg/kg		Analyzed By: MS					
Analyte	Result	Reporting Limit	Analyzed	Method Blank	BS	% Recovery	True Value QC	RPD	Qualifier
GRO C6-C10	<10.0	10.0	03/09/2015	ND	209	104	200	4.63	
DRO >C10-C28	<10.0	10.0	03/09/2015	ND	220	110	200	4.65	

Surrogate: 1-Chlorooctane 83.1 % 47.2-157

Surrogate: 1-Chlorooctadecane 91.9 % 52.1-176

Cardinal Laboratories

\*=Accredited Analyte

PLEASE NOTE: Liability and Damages. Cardinal's liability and client's exclusive remedy for any claim arising, whether based in contract or tort, shall be limited to the amount paid by client for analyses. All claims, including those for negligence and any other cause whatsoever shall be deemed waived unless made in writing and received by Cardinal within thirty (30) days after completion of the applicable service. In no event shall Cardinal be liable for incidental or consequential damages, including, without limitation, business interruptions, loss of use, or loss of profits incurred by client, its subsidiaries, affiliates or successors arising out of or related to the performance of the services hereunder by Cardinal, regardless of whether such claim is based upon any of the above stated reasons or otherwise. Results relate only to the samples identified above. This report shall not be reproduced except in full with written approval of Cardinal Laboratories.



Celey D. Keene, Lab Director/Quality Manager

**Analytical Results For:**

BBC International, Inc.  
Cliff Brunson  
P.O. Box 805  
Hobbs NM, 88241  
Fax To: (575) 397-0397

Received:	03/06/2015	Sampling Date:	03/04/2015
Reported:	03/11/2015	Sampling Type:	Soil
Project Name:	CYPRESS 33 FEDERAL #6H	Sampling Condition:	Cool & Intact
Project Number:	OXY	Sample Received By:	Jodi Henson
Project Location:	RAWHIDE RD		

**Sample ID: SP 1 @ 2' (H500624-02)**

BTEx 8021B			mg/kg		Analyzed By: ms					
Analyte	Result	Reporting Limit	Analyzed	Method Blank	BS	% Recovery	True Value QC	RPD	Qualifier	
Benzene*	<0.050	0.050	03/10/2015	ND	2.06	103	2.00	5.50		
Toluene*	<0.050	0.050	03/10/2015	ND	1.86	93.2	2.00	5.62		
Ethylbenzene*	<0.050	0.050	03/10/2015	ND	2.18	109	2.00	5.78		
Total Xylenes*	<0.150	0.150	03/10/2015	ND	6.03	100	6.00	5.94		
Total BTEX	<0.300	0.300	03/10/2015	ND						

Surrogate: 4-Bromofluorobenzene (PIE) 116 % 61-154

Chloride, SM4500Cl-B			mg/kg		Analyzed By: AP					
Analyte	Result	Reporting Limit	Analyzed	Method Blank	BS	% Recovery	True Value QC	RPD	Qualifier	
Chloride	<16.0	16.0	03/09/2015	ND	400	100	400	3.92		

TPH 8015M		mg/kg		Analyzed By: MS					
Analyte	Result	Reporting Limit	Analyzed	Method Blank	BS	% Recovery	True Value QC	RPD	Qualifier
GRO C6-C10	<10.0	10.0	03/09/2015	ND	209	104	200	4.63	
DRO >C10-C28	<10.0	10.0	03/09/2015	ND	220	110	200	4.65	

Surrogate: 1-Chlorooctane 85.3 % 47.2-157

Surrogate: 1-Chlorooctadecane 91.9 % 52.1-176

Cardinal Laboratories

\*=Accredited Analyte

PLEASE NOTE: Liability and Damages. Cardinal's liability and client's exclusive remedy for any claim arising, whether based in contract or tort, shall be limited to the amount paid by client for analyses. All claims, including those for negligence and any other cause whatsoever shall be deemed waived unless made in writing and received by Cardinal within thirty (30) days after completion of the applicable service. In no event shall Cardinal be liable for incidental or consequential damages, including, without limitation, business interruptions, loss of use, or loss of profits incurred by client, its subsidiaries, affiliates or successors arising out of or related to the performance of the services hereunder by Cardinal, regardless of whether such claim is based upon any of the above stated reasons or otherwise. Results relate only to the samples identified above. This report shall not be reproduced except in full with written approval of Cardinal Laboratories.



Celey D. Keene, Lab Director/Quality Manager

**Analytical Results For:**

BBC International, Inc.  
Cliff Brunson  
P.O. Box 805  
Hobbs NM, 88241  
Fax To: (575) 397-0397

Received:	03/06/2015	Sampling Date:	03/04/2015
Reported:	03/11/2015	Sampling Type:	Soil
Project Name:	CYPRESS 33 FEDERAL #6H	Sampling Condition:	Cool & Intact
Project Number:	OXY	Sample Received By:	Jodi Henson
Project Location:	RAWHIDE RD		

**Sample ID: SP 2 @ 1' (H500624-03)**

BTEX 8021B		mg/kg		Analyzed By: ms					
Analyte	Result	Reporting Limit	Analyzed	Method Blank	BS	% Recovery	True Value QC	RPD	Qualifier
Benzene*	<0.050	0.050	03/10/2015	ND	2.06	103	2.00	5.50	
Toluene*	<0.050	0.050	03/10/2015	ND	1.86	93.2	2.00	5.62	
Ethylbenzene*	<0.050	0.050	03/10/2015	ND	2.18	109	2.00	5.78	
<b>Total Xylenes*</b>	<b>0.249</b>	0.150	03/10/2015	ND	6.03	100	6.00	5.94	
Total BTEX	<0.300	0.300	03/10/2015	ND					

Surrogate: 4-Bromofluorobenzene (PID) 124 % 61-154

Chloride, SM4500Cl-B		mg/kg		Analyzed By: AP					
Analyte	Result	Reporting Limit	Analyzed	Method Blank	BS	% Recovery	True Value QC	RPD	Qualifier
Chloride	1630	16.0	03/09/2015	ND	400	100	400	3.92	

TPH 8015M		mg/kg		Analyzed By: MS					
Analyte	Result	Reporting Limit	Analyzed	Method Blank	BS	% Recovery	True Value QC	RPD	Qualifier
GRO C6-C10	10.8	10.0	03/09/2015	ND	209	104	200	4.63	
DRO >C10-C28	431	10.0	03/09/2015	ND	220	110	200	4.65	

Surrogate: 1-Chlorooctane 95.1 % 47.2-157

Surrogate: 1-Chlorooctadecane 102 % 52.1-176

Cardinal Laboratories

\*=Accredited Analyte

PLEASE NOTE: Liability and Damages. Cardinal's liability and client's exclusive remedy for any claim arising, whether based in contract or tort, shall be limited to the amount paid by client for analyses. All claims, including those for negligence and any other cause whatsoever shall be deemed waived unless made in writing and received by Cardinal within thirty (30) days after completion of the applicable service. In no event shall Cardinal be liable for incidental or consequential damages, including, without limitation, business interruptions, loss of use, or loss of profits incurred by client, its subsidiaries, affiliates or successors arising out of or related to the performance of the services hereunder by Cardinal, regardless of whether such claim is based upon any of the above stated reasons or otherwise. Results relate only to the samples identified above. This report shall not be reproduced except in full with written approval of Cardinal Laboratories.



Celey D. Keene, Lab Director/Quality Manager



**Analytical Results For:**

BBC International, Inc.  
Cliff Brunson  
P.O. Box 805  
Hobbs NM, 88241  
Fax To: (575) 397-0397

Received: 03/06/2015  
Reported: 03/11/2015  
Project Name: CYPRESS 33 FEDERAL #6H  
Project Number: OXY  
Project Location: RAWHIDE RD

Sampling Date: 03/04/2015  
Sampling Type: Soil  
Sampling Condition: Cool & Intact  
Sample Received By: Jodi Henson

**Sample ID: SP 2 @ 2' (H500624-04)**

BTEX 8021B			mg/kg		Analyzed By: ms					
Analyte	Result	Reporting Limit	Analyzed	Method Blank	BS	% Recovery	True Value QC	RPD	Qualifier	
Benzene*	<0.050	0.050	03/10/2015	ND	2.06	103	2.00	5.50		
Toluene*	<0.050	0.050	03/10/2015	ND	1.86	93.2	2.00	5.62		
Ethylbenzene*	<0.050	0.050	03/10/2015	ND	2.18	109	2.00	5.78		
Total Xylenes*	<0.150	0.150	03/10/2015	ND	6.03	100	6.00	5.94		
Total BTEX	<0.300	0.300	03/10/2015	ND						

Surrogate: 4-Bromofluorobenzene (PIC) 114 % 61-154

Chloride, SM4500Cl-B			mg/kg		Analyzed By: AP				
Analyte	Result	Reporting Limit	Analyzed	Method Blank	BS	% Recovery	True Value QC	RPD	Qualifier
Chloride	256	16.0	03/09/2015	ND	400	100	400	3.92	

TPH 8015M		mg/kg		Analyzed By: MS						
Analyte	Result	Reporting Limit	Analyzed	Method Blank	BS	% Recovery	True Value QC	RPD	Qualifier	
GRO C6-C10	<10.0	10.0	03/09/2015	ND	209	104	200	4.63		
DRO >C10-C28	<10.0	10.0	03/09/2015	ND	220	110	200	4.65		

Surrogate: 1-Chlorooctane 91.0 % 47.2-157

Surrogate: 1-Chlorooctadecane 96.8 % 52.1-176

Cardinal Laboratories

\*=Accredited Analyte

PLEASE NOTE: Liability and Damages. Cardinal's liability and client's exclusive remedy for any claim arising, whether based in contract or tort, shall be limited to the amount paid by client for analyses. All claims, including those for negligence and any other cause whatsoever shall be deemed waived unless made in writing and received by Cardinal within thirty (30) days after completion of the applicable service. In no event shall Cardinal be liable for incidental or consequential damages, including, without limitation, business interruptions, loss of use, or loss of profits incurred by client, its subsidiaries, affiliates or successors arising out of or related to the performance of the services hereunder by Cardinal, regardless of whether such claim is based upon any of the above stated reasons or otherwise. Results relate only to the samples identified above. This report shall not be reproduced except in full with written approval of Cardinal Laboratories.



Celey D. Keene, Lab Director/Quality Manager

### Analytical Results For:

BBC International, Inc.  
Cliff Brunson  
P.O. Box 805  
Hobbs NM, 88241  
Fax To: (575) 397-0397

Received: 03/06/2015  
Reported: 03/11/2015  
Project Name: CYPRESS 33 FEDERAL #6H  
Project Number: OXY  
Project Location: RAWHIDE RD

Sampling Date: 03/04/2015  
Sampling Type: Soil  
Sampling Condition: Cool & Intact  
Sample Received By: Jodi Henson

### Sample ID: SP 2 @ 3' (H500624-05)

BTEX 8021B			mg/kg		Analyzed By: ms				
Analyte	Result	Reporting Limit	Analyzed	Method Blank	BS	% Recovery	True Value QC	RPD	Qualifier
Benzene*	<0.050	0.050	03/10/2015	ND	2.06	103	2.00	5.50	
Toluene*	<0.050	0.050	03/10/2015	ND	1.86	93.2	2.00	5.62	
Ethylbenzene*	<0.050	0.050	03/10/2015	ND	2.18	109	2.00	5.78	
Total Xylenes*	<0.150	0.150	03/10/2015	ND	6.03	100	6.00	5.94	
Total BTEX	<0.300	0.300	03/10/2015	ND					

Surrogate: 4-Bromofluorobenzene (PIC) 114 % 61-154

Chloride, SM4500CI-B			mg/kg		Analyzed By: AP				
Analyte	Result	Reporting Limit	Analyzed	Method Blank	BS	% Recovery	True Value QC	RPD	Qualifier
Chloride	<16.0	16.0	03/09/2015	ND	416	104	400	3.77	

TPH 8015M			mg/kg		Analyzed By: MS				
Analyte	Result	Reporting Limit	Analyzed	Method Blank	BS	% Recovery	True Value QC	RPD	Qualifier
GRO C6-C10	<10.0	10.0	03/09/2015	ND	209	104	200	4.63	
DRO >C10-C28	<10.0	10.0	03/09/2015	ND	220	110	200	4.65	

Surrogate: 1-Chlorooctane 91.4 % 47.2-157

Surrogate: 1-Chlorooctadecane 93.6 % 52.1-176

Cardinal Laboratories

\*=Accredited Analyte

PLEASE NOTE: Liability and Damages. Cardinal's liability and client's exclusive remedy for any claim arising, whether based in contract or tort, shall be limited to the amount paid by client for analyses. All claims, including those for negligence and any other cause whatsoever shall be deemed waived unless made in writing and received by Cardinal within thirty (30) days after completion of the applicable service. In no event shall Cardinal be liable for incidental or consequential damages, including, without limitation, business interruptions, loss of use, or loss of profits incurred by client, its subsidiaries, affiliates or successors arising out of or related to the performance of the services hereunder by Cardinal, regardless of whether such claim is based upon any of the above stated reasons or otherwise. Results relate only to the samples identified above. This report shall not be reproduced except in full with written approval of Cardinal Laboratories.



Celey D. Keene, Lab Director/Quality Manager

**Analytical Results For:**

BBC International, Inc.  
Cliff Brunson  
P.O. Box 805  
Hobbs NM, 88241  
Fax To: (575) 397-0397

Received:	03/06/2015	Sampling Date:	03/04/2015
Reported:	03/11/2015	Sampling Type:	Soil
Project Name:	CYPRESS 33 FEDERAL #6H	Sampling Condition:	Cool & Intact
Project Number:	OXY	Sample Received By:	Jodi Henson
Project Location:	RAWHIDE RD		

**Sample ID: SP 3 @ 1' (H500624-06)**

BTX 8021B		mg/kg		Analyzed By: ms					
Analyte	Result	Reporting Limit	Analyzed	Method Blank	BS	% Recovery	True Value QC	RPD	Qualifier
Benzene*	<0.050	0.050	03/10/2015	ND	2.06	103	2.00	5.50	
Toluene*	0.077	0.050	03/10/2015	ND	1.86	93.2	2.00	5.62	
Ethylbenzene*	0.087	0.050	03/10/2015	ND	2.18	109	2.00	5.78	
Total Xylenes*	1.23	0.150	03/10/2015	ND	6.03	100	6.00	5.94	
Total BTX	1.40	0.300	03/10/2015	ND					

Surrogate: 4-Bromofluorobenzene (PIE) 152 % 61-154

Chloride, SM4500Cl-B		mg/kg		Analyzed By: AP					
Analyte	Result	Reporting Limit	Analyzed	Method Blank	BS	% Recovery	True Value QC	RPD	Qualifier
Chloride	2840	16.0	03/09/2015	ND	416	104	400	3.77	

TPH 8015M		mg/kg		Analyzed By: MS					
Analyte	Result	Reporting Limit	Analyzed	Method Blank	BS	% Recovery	True Value QC	RPD	Qualifier
GRO C6-C10	32.6	10.0	03/09/2015	ND	209	104	200	4.63	
DRO >C10-C28	2090	10.0	03/09/2015	ND	220	110	200	4.65	

Surrogate: 1-Chlorooctane 102 % 47.2-157

Surrogate: 1-Chlorooctadecane 120 % 52.1-176

Cardinal Laboratories

\*=Accredited Analyte

PLEASE NOTE: Liability and Damages. Cardinal's liability and client's exclusive remedy for any claim arising, whether based in contract or tort, shall be limited to the amount paid by client for analyses. All claims, including those for negligence and any other cause whatsoever shall be deemed waived unless made in writing and received by Cardinal within thirty (30) days after completion of the applicable service. In no event shall Cardinal be liable for incidental or consequential damages, including, without limitation, business interruptions, loss of use, or loss of profits incurred by client, its subsidiaries, affiliates or successors arising out of or related to the performance of the services hereunder by Cardinal, regardless of whether such claim is based upon any of the above stated reasons or otherwise. Results relate only to the samples identified above. This report shall not be reproduced except in full with written approval of Cardinal Laboratories.



Celey D. Keene, Lab Director/Quality Manager

**Analytical Results For:**

BBC International, Inc.  
Cliff Brunson  
P.O. Box 805  
Hobbs NM, 88241  
Fax To: (575) 397-0397

Received:	03/06/2015	Sampling Date:	03/04/2015
Reported:	03/11/2015	Sampling Type:	Soil
Project Name:	CYPRESS 33 FEDERAL #6H	Sampling Condition:	Cool & Intact
Project Number:	OXY	Sample Received By:	Jodi Henson
Project Location:	RAWHIDE RD		

**Sample ID: SP 3 @ 2' (H500624-07)**

BTEX 8021B		mg/kg		Analyzed By: ms						
Analyte	Result	Reporting Limit	Analyzed	Method Blank	BS	% Recovery	True Value QC	RPD	Qualifier	
Benzene*	<0.050	0.050	03/10/2015	ND	2.06	103	2.00	5.50		
Toluene*	<0.050	0.050	03/10/2015	ND	1.86	93.2	2.00	5.62		
Ethylbenzene*	<0.050	0.050	03/10/2015	ND	2.18	109	2.00	5.78		
Total Xylenes*	<0.150	0.150	03/10/2015	ND	6.03	100	6.00	5.94		
Total BTEX	<0.300	0.300	03/10/2015	ND						

Surrogate: 4-Bromofluorobenzene (PIC) 118 % 61-154

Chloride, SM4500Cl-B		mg/kg		Analyzed By: AP					
Analyte	Result	Reporting Limit	Analyzed	Method Blank	BS	% Recovery	True Value QC	RPD	Qualifier
Chloride	272	16.0	03/09/2015	ND	416	104	400	3.77	

TPH 8015M		mg/kg		Analyzed By: MS					
Analyte	Result	Reporting Limit	Analyzed	Method Blank	BS	% Recovery	True Value QC	RPD	Qualifier
GRO C6-C10	<10.0	10.0	03/09/2015	ND	209	104	200	4.63	
DRO >C10-C28	272	10.0	03/09/2015	ND	220	110	200	4.65	

Surrogate: 1-Chlorooctane 95.0 % 47.2-157

Surrogate: 1-Chlorooctadecane 103 % 52.1-176

Cardinal Laboratories

\*=Accredited Analyte

PLEASE NOTE: Liability and Damages. Cardinal's liability and client's exclusive remedy for any claim arising, whether based in contract or tort, shall be limited to the amount paid by client for analyses. All claims, including those for negligence and any other cause whatsoever shall be deemed waived unless made in writing and received by Cardinal within thirty (30) days after completion of the applicable service. In no event shall Cardinal be liable for incidental or consequential damages, including, without limitation, business interruptions, loss of use, or loss of profits incurred by client, its subsidiaries, affiliates or successors arising out of or related to the performance of the services hereunder by Cardinal, regardless of whether such claim is based upon any of the above stated reasons or otherwise. Results relate only to the samples identified above. This report shall not be reproduced except in full with written approval of Cardinal Laboratories.



Celey D. Keene, Lab Director/Quality Manager



**Analytical Results For:**

BBC International, Inc.  
Cliff Brunson  
P.O. Box 805  
Hobbs NM, 88241  
Fax To: (575) 397-0397

Received:	03/06/2015	Sampling Date:	03/04/2015
Reported:	03/11/2015	Sampling Type:	Soil
Project Name:	CYPRESS 33 FEDERAL #6H	Sampling Condition:	Cool & Intact
Project Number:	OXY	Sample Received By:	Jodi Henson
Project Location:	RAWHIDE RD		

**Sample ID: SP 3 @ 3' (H500624-08)**

BTEX 8021B		mg/kg		Analyzed By: ms						
Analyte	Result	Reporting Limit	Analyzed	Method Blank	BS	% Recovery	True Value QC	RPD	Qualifier	
Benzene*	<0.050	0.050	03/10/2015	ND	2.07	103	2.00	4.02		
Toluene*	<0.050	0.050	03/10/2015	ND	1.91	95.7	2.00	2.62		
Ethylbenzene*	<0.050	0.050	03/10/2015	ND	2.18	109	2.00	4.58		
Total Xylenes*	<0.150	0.150	03/10/2015	ND	5.95	99.1	6.00	5.80		
Total BTEX	<0.300	0.300	03/10/2015	ND						

Surrogate: 4-Bromofluorobenzene (PIC) 114 % 61-154

Chloride, SM4500Cl-B		mg/kg		Analyzed By: AP					
Analyte	Result	Reporting Limit	Analyzed	Method Blank	BS	% Recovery	True Value QC	RPD	Qualifier
Chloride	64.0	16.0	03/09/2015	ND	416	104	400	3.77	

TPH 8015M		mg/kg		Analyzed By: MS						
Analyte	Result	Reporting Limit	Analyzed	Method Blank	BS	% Recovery	True Value QC	RPD	Qualifier	
GRO C6-C10	<10.0	10.0	03/09/2015	ND	209	104	200	4.63		
DRO >C10-C28	<10.0	10.0	03/09/2015	ND	220	110	200	4.65		

Surrogate: 1-Chlorooctane 90.5 % 47.2-157

Surrogate: 1-Chlorooctadecane 99.7 % 52.1-176

Cardinal Laboratories

\*=Accredited Analyte

PLEASE NOTE: Liability and Damages. Cardinal's liability and client's exclusive remedy for any claim arising, whether based in contract or tort, shall be limited to the amount paid by client for analyses. All claims, including those for negligence and any other cause whatsoever shall be deemed waived unless made in writing and received by Cardinal within thirty (30) days after completion of the applicable service. In no event shall Cardinal be liable for incidental or consequential damages, including, without limitation, business interruptions, loss of use, or loss of profits incurred by client, its subsidiaries, affiliates or successors arising out of or related to the performance of the services hereunder by Cardinal, regardless of whether such claim is based upon any of the above stated reasons or otherwise. Results relate only to the samples identified above. This report shall not be reproduced except in full with written approval of Cardinal Laboratories.



Celey D. Keene, Lab Director/Quality Manager

**Analytical Results For:**

BBC International, Inc.  
Cliff Brunson  
P.O. Box 805  
Hobbs NM, 88241  
Fax To: (575) 397-0397

Received:	03/06/2015	Sampling Date:	03/05/2015
Reported:	03/11/2015	Sampling Type:	Soil
Project Name:	CYPRESS 33 FEDERAL #6H	Sampling Condition:	Cool & Intact
Project Number:	OXY	Sample Received By:	Jodi Henson
Project Location:	RAWHIDE RD		

**Sample ID: SP 4 @ 1' (H500624-09)**

BTEx 8021B		mg/kg		Analyzed By: ms						
Analyte	Result	Reporting Limit	Analyzed	Method Blank	BS	% Recovery	True Value QC	RPD	Qualifier	
Benzene*	<0.050	0.050	03/10/2015	ND	2.07	103	2.00	4.02		
Toluene*	<0.050	0.050	03/10/2015	ND	1.91	95.7	2.00	2.62		
Ethylbenzene*	<0.050	0.050	03/10/2015	ND	2.18	109	2.00	4.58		
Total Xylenes*	<0.150	0.150	03/10/2015	ND	5.95	99.1	6.00	5.80		
Total BTEX	<0.300	0.300	03/10/2015	ND						

Surrogate: 4-Bromofluorobenzene (PIE) 119 % 61-154

Chloride, SM4500Cl-B		mg/kg		Analyzed By: AP						
Analyte	Result	Reporting Limit	Analyzed	Method Blank	BS	% Recovery	True Value QC	RPD	Qualifier	
Chloride	6320	16.0	03/09/2015	ND	416	104	400	3.77		

TPH 8015M		mg/kg		Analyzed By: MS					
Analyte	Result	Reporting Limit	Analyzed	Method Blank	BS	% Recovery	True Value QC	RPD	Qualifier
GRO C6-C10	11.0	10.0	03/09/2015	ND	209	104	200	4.63	
DRO >C10-C28	372	10.0	03/09/2015	ND	220	110	200	4.65	

Surrogate: 1-Chlorooctane 90.6 % 47.2-157

Surrogate: 1-Chlorooctadecane 88.2 % 52.1-176

Cardinal Laboratories

\*=Accredited Analyte

PLEASE NOTE: Liability and Damages. Cardinal's liability and client's exclusive remedy for any claim arising, whether based in contract or tort, shall be limited to the amount paid by client for analyses. All claims, including those for negligence and any other cause whatsoever shall be deemed waived unless made in writing and received by Cardinal within thirty (30) days after completion of the applicable service. In no event shall Cardinal be liable for incidental or consequential damages, including, without limitation, business interruptions, loss of use, or loss of profits incurred by client, its subsidiaries, affiliates or successors arising out of or related to the performance of the services hereunder by Cardinal, regardless of whether such claim is based upon any of the above stated reasons or otherwise. Results relate only to the samples identified above. This report shall not be reproduced except in full with written approval of Cardinal Laboratories.



Celey D. Keene, Lab Director/Quality Manager

**Analytical Results For:**

BBC International, Inc.  
Cliff Brunson  
P.O. Box 805  
Hobbs NM, 88241  
Fax To: (575) 397-0397

Received:	03/06/2015	Sampling Date:	03/05/2015
Reported:	03/11/2015	Sampling Type:	Soil
Project Name:	CYPRESS 33 FEDERAL #6H	Sampling Condition:	Cool & Intact
Project Number:	OXY	Sample Received By:	Jodi Henson
Project Location:	RAWHIDE RD		

**Sample ID: SP 4 @ 2' (H500624-10)**

BTX 8021B		mg/kg		Analyzed By: ms						
Analyte	Result	Reporting Limit	Analyzed	Method Blank	BS	% Recovery	True Value QC	RPD	Qualifier	
Benzene*	<0.050	0.050	03/10/2015	ND	2.07	103	2.00	4.02		
Toluene*	<0.050	0.050	03/10/2015	ND	1.91	95.7	2.00	2.62		
Ethylbenzene*	<0.050	0.050	03/10/2015	ND	2.18	109	2.00	4.58		
Total Xylenes*	<0.150	0.150	03/10/2015	ND	5.95	99.1	6.00	5.80		
Total BTX	<0.300	0.300	03/10/2015	ND						

Surrogate: 4-Bromofluorobenzene (PIC) 116 % 61-154

Chloride, SM4500Cl-B		mg/kg		Analyzed By: AP					
Analyte	Result	Reporting Limit	Analyzed	Method Blank	BS	% Recovery	True Value QC	RPD	Qualifier
Chloride	208	16.0	03/09/2015	ND	416	104	400	3.77	

TPH 8015M		mg/kg		Analyzed By: MS					
Analyte	Result	Reporting Limit	Analyzed	Method Blank	BS	% Recovery	True Value QC	RPD	Qualifier
GRO C6-C10	<10.0	10.0	03/09/2015	ND	209	104	200	4.63	
DRO >C10-C28	<10.0	10.0	03/09/2015	ND	220	110	200	4.65	

Surrogate: 1-Chlorooctane 84.3 % 47.2-157

Surrogate: 1-Chlorooctadecane 89.5 % 52.1-176

Cardinal Laboratories

\*=Accredited Analyte

PLEASE NOTE: Liability and Damages. Cardinal's liability and client's exclusive remedy for any claim arising, whether based in contract or tort, shall be limited to the amount paid by client for analyses. All claims, including those for negligence and any other cause whatsoever shall be deemed waived unless made in writing and received by Cardinal within thirty (30) days after completion of the applicable service. In no event shall Cardinal be liable for incidental or consequential damages, including, without limitation, business interruptions, loss of use, or loss of profits incurred by client, its subsidiaries, affiliates or successors arising out of or related to the performance of the services hereunder by Cardinal, regardless of whether such claim is based upon any of the above stated reasons or otherwise. Results relate only to the samples identified above. This report shall not be reproduced except in full with written approval of Cardinal Laboratories.



Celey D. Keene, Lab Director/Quality Manager

**Analytical Results For:**

BBC International, Inc.  
Cliff Brunson  
P.O. Box 805  
Hobbs NM, 88241  
Fax To: (575) 397-0397

Received:	03/06/2015	Sampling Date:	03/05/2015
Reported:	03/11/2015	Sampling Type:	Soil
Project Name:	CYPRESS 33 FEDERAL #6H	Sampling Condition:	Cool & Intact
Project Number:	OXY	Sample Received By:	Jodi Henson
Project Location:	RAWHIDE RD		

**Sample ID: SP 4 @ 3' (H500624-11)**

BTEX 8021B		mg/kg		Analyzed By: ms						
Analyte	Result	Reporting Limit	Analyzed	Method Blank	BS	% Recovery	True Value QC	RPD	Qualifier	
Benzene*	<0.050	0.050	03/10/2015	ND	2.07	103	2.00	4.02		
Toluene*	<0.050	0.050	03/10/2015	ND	1.91	95.7	2.00	2.62		
Ethylbenzene*	<0.050	0.050	03/10/2015	ND	2.18	109	2.00	4.58		
Total Xylenes*	<0.150	0.150	03/10/2015	ND	5.95	99.1	6.00	5.80		
Total BTEX	<0.300	0.300	03/10/2015	ND						

Surrogate: 4-Bromofluorobenzene (PIL) 114 % 61-154

Chloride, SM4500Cl-B		mg/kg		Analyzed By: AP					
Analyte	Result	Reporting Limit	Analyzed	Method Blank	BS	% Recovery	True Value QC	RPD	Qualifier
Chloride	64.0	16.0	03/09/2015	ND	416	104	400	3.77	

TPH 8015M		mg/kg		Analyzed By: MS						
Analyte	Result	Reporting Limit	Analyzed	Method Blank	BS	% Recovery	True Value QC	RPD	Qualifier	
GRO C6-C10	<10.0	10.0	03/09/2015	ND	209	104	200	4.63		
DRO >C10-C28	<10.0	10.0	03/09/2015	ND	220	110	200	4.65		

Surrogate: 1-Chlorooctane 83.2 % 47.2-157

Surrogate: 1-Chlorooctadecane 87.7 % 52.1-176

Cardinal Laboratories

\*=Accredited Analyte

PLEASE NOTE: Liability and Damages. Cardinal's liability and client's exclusive remedy for any claim arising, whether based in contract or tort, shall be limited to the amount paid by client for analyses. All claims, including those for negligence and any other cause whatsoever shall be deemed waived unless made in writing and received by Cardinal within thirty (30) days after completion of the applicable service. In no event shall Cardinal be liable for incidental or consequential damages, including, without limitation, business interruptions, loss of use, or loss of profits incurred by client, its subsidiaries, affiliates or successors arising out of or related to the performance of the services hereunder by Cardinal, regardless of whether such claim is based upon any of the above stated reasons or otherwise. Results relate only to the samples identified above. This report shall not be reproduced except in full with written approval of Cardinal Laboratories.



Celey D. Keene, Lab Director/Quality Manager



**Notes and Definitions**

ND	Analyte NOT DETECTED at or above the reporting limit
RPD	Relative Percent Difference
**	Samples not received at proper temperature of 6°C or below.
***	Insufficient time to reach temperature.
-	Chloride by SM4500Cl-B does not require samples be received at or below 6°C Samples reported on an as received basis (wet) unless otherwise noted on report

---

Cardinal Laboratories

\*=Accredited Analyte

PLEASE NOTE: Liability and Damages. Cardinal's liability and client's exclusive remedy for any claim arising, whether based in contract or tort, shall be limited to the amount paid by client for analyses. All claims, including those for negligence and any other cause whatsoever shall be deemed waived unless made in writing and received by Cardinal within thirty (30) days after completion of the applicable service. In no event shall Cardinal be liable for incidental or consequential damages, including, without limitation, business interruptions, loss of use, or loss of profits incurred by client, its subsidiaries, affiliates or successors arising out of or related to the performance of the services hereunder by Cardinal, regardless of whether such claim is based upon any of the above stated reasons or otherwise. Results relate only to the samples identified above. This report shall not be reproduced except in full with written approval of Cardinal Laboratories.



---

Celey D. Keene, Lab Director/Quality Manager



## CHAIN-OF-CUSTODY AND ANALYSIS REQUEST

† Cardinal cannot accept verbal changes. Please fax written changes to 505-393-2476





District I  
1625 N. French Dr., Hobbs, NM 88240  
District II  
1301 W. Grand Avenue, Artesia, NM 88210  
District III  
1000 Rio Brazos Road, Aztec, NM 87410  
District IV  
1220 S. St. Francis Dr., Santa Fe, NM 87505

State of New Mexico  
Energy Minerals and Natural Resources

Oil Conservation Division  
1220 South St. Francis Dr.  
Santa Fe, NM 87505

Form C-141  
Revised October 10, 2003

Submit 2 Copies to appropriate  
District Office in accordance  
with Rule 116 on back  
side of form

## Release Notification and Corrective Action

### OPERATOR

☒ Initial Report ☐ Final Report

Name of Company	Oxy Permian Ltd.	Contact	CJ Summers
Address	1017 W. Stanolind Rd, Hobbs, NM	Telephone No.	(575) 397-8216
Facility Name	Cypress 33 Federal #6H	Facility Type	Well location
Surface Owner	BLM	Mineral Owner	API No. 30-015-41557

### LOCATION OF RELEASE

Unit Letter	Section	Township	Range	Feet from the	North/South Line	Feet from the	East/West Line	County
A	33	23S	29E	466	North	1040	East	Eddy

Latitude N 32.26685° Longitude W 103.98463°

### NATURE OF RELEASE

Type of Release	Oil	Volume of Release	10 bbls	Volume Recovered	0 bbls
Source of Release	Excess pressure caused the stuffing box packing on the well head to blow off	Date and Hour of Occurrence	11/06/2014	Date and Hour of Discovery	
Was Immediate Notice Given?	<input checked="" type="checkbox"/> Yes <input type="checkbox"/> No <input type="checkbox"/> Not Required	If YES, To Whom?	Mike Bratcher, Heather Patterson-NMOCD; Sol Hughes-BLM		
By Whom?	Kathy Purvis, BBC International	Date and Hour	11/07/2014 @ 9:42 am		
Was a Watercourse Reached?	<input type="checkbox"/> Yes <input checked="" type="checkbox"/> No	If YES, Volume Impacting the Watercourse.			

If a Watercourse was Impacted, Describe Fully.\*

Describe Cause of Problem and Remedial Action Taken.\*

Excess pressure caused the stuffing box packing on the well head to blow off and leak 10 bbls of oil onto the ground. No fluids were recovered and the stuffing box packing was replaced.

Describe Area Affected and Cleanup Action Taken.\*

The affected area is approximately 50' x 150' on location. Remediation will be completed in accordance a remediation plan approved by NMOCD and the BLM.

I hereby certify that the information given above is true and complete to the best of my knowledge and understand that pursuant to NMOCD rules and regulations all operators are required to report and/or file certain release notifications and perform corrective actions for releases which may endanger public health or the environment. The acceptance of a C-141 report by the NMOCD marked as "Final Report" does not relieve the operator of liability should their operations have failed to adequately investigate and remediate contamination that pose a threat to ground water, surface water, human health or the environment. In addition, NMOCD acceptance of a C-141 report does not relieve the operator of responsibility for compliance with any other federal, state, or local laws and/or regulations.

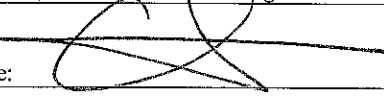
Signature: 	<u>OIL CONSERVATION DIVISION</u>		
Printed Name: Chancey Summers	Approved by District Supervisor:		
Title: HES Specialist	Approval Date:	Expiration Date:	
E-mail Address: Chancey.Summers@oxy.com	Conditions of Approval:		Attached <input type="checkbox"/>
Date: 11/13/14	Phone: (575) 397-8216		

\* Attach Additional Sheets If Necessary