



PHONE (575) 397-6388 • FAX (575) 397- 0397 • 1324 W. MARLAND • P.O. BOX 805 • HOBBS, NM 88241-0805
E-MAIL: cbrunson@bbcinternational.com

OXY – HARROUN 15 #12

REMEDIATION PLAN

OXY will excavate the spill area as depicted on the following site diagram. The entire spill area will be surface scraped a depth of 6 inches. The entire site will be backfilled with clean soil.

All excavated materials will be disposed of at an NMOCD-approved disposal facility.

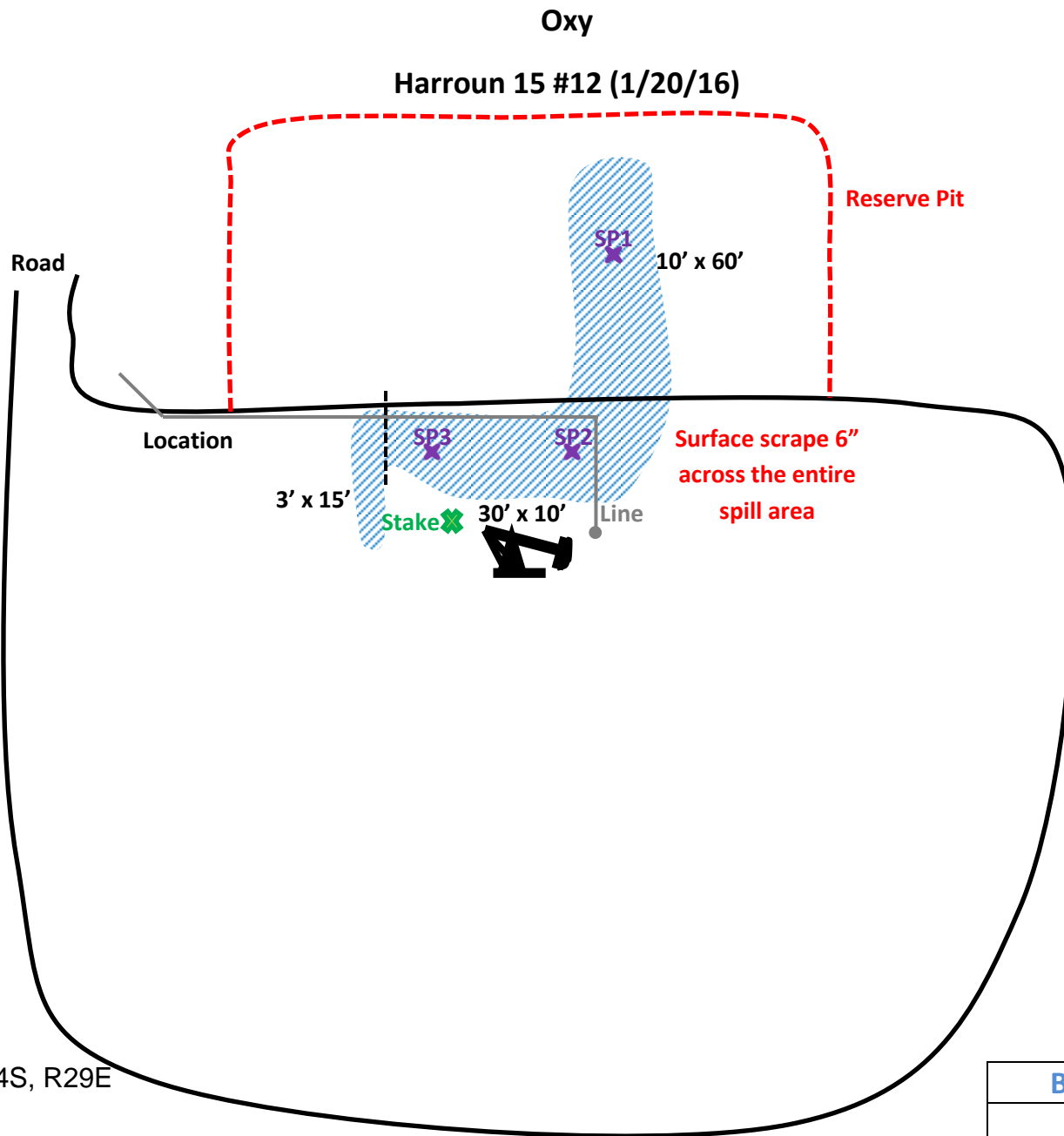

U/L N, Section 15, T24S, R29E

Eddy County, NM

N 32.21124° W 103.97459°

API#30-015-32117

BBC International, Inc.

Oxy
Harroun 15 #12

Date: 02/08/16

DRWG by: K. Purvis

NOT TO SCALE

File: Oxy 2016

Groundwater Plot

Oxy Harroun 15 #12

County
Eddy

Unit Letter
N

Section
15

Township
24S

Range
29E

Trend Map 75'-100'

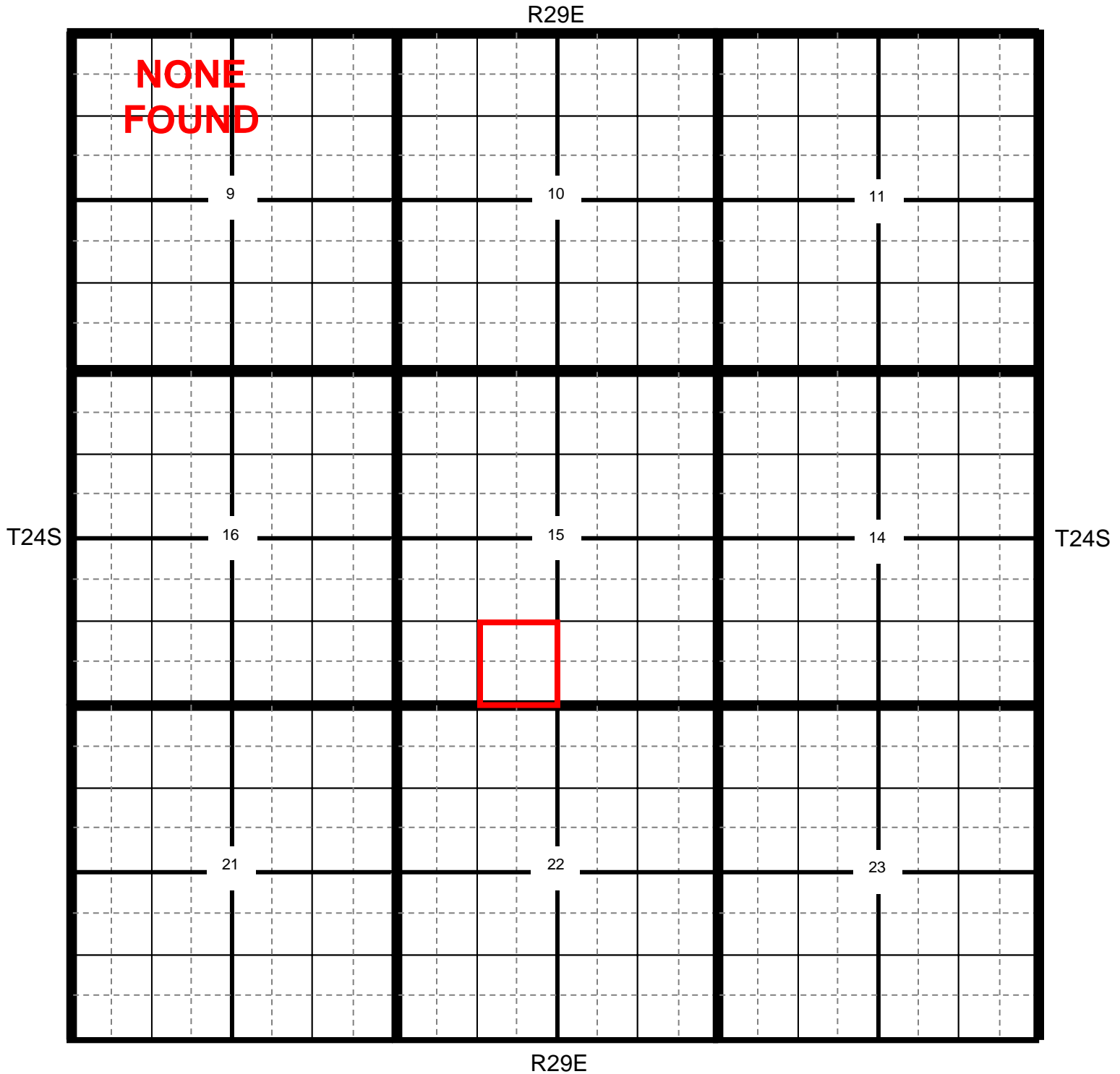

★ Location

● OCD

● USGS

● SEO

● All Databases

Section Quarters

Oxy Harroun 15 #12

County Eddy Unit Letter N Section 15 Township 24S Range 29E

Trend Map 75'-100'

1

2

NW/NW NONE FOUND Unit Letter D	NE/NW Unit Letter C	NW/NE Unit Letter B	NE/NE Unit Letter A
SW/NW Unit Letter E	SE/NW Unit Letter F	SW/NE Unit Letter G	SE/NE Unit Letter H
NW/SW Unit Letter L	NE/SW Unit Letter K	NW/SE Unit Letter J	NE/SE Unit Letter I
SW/SW Unit Letter M	SE/SW Unit Letter N	SW/SE Unit Letter O	SE/SE Unit Letter P

3

4

Sample	CL	odor	Type	Time	
1 Sp1 @ Surface	6000+	No.	dirt	830	
1'	6000+	No	dirt	845	
2'	6000+	No	dirt	900	1 N 32.21137
3'	6000+	No	dirt	910	W 103.97443
4'	6000+	No	dirt	920	
5'	6000+	No	dirt	940	
6'	6000+	No	dirt	955	
7'	6000+	No	dirt	1010	
Sp2 @ Surface	6000+	slight	caliche	1030	
1'	4000	No	dirt	1045	
2'	3500	No	dirt	1100	
3'	4500	No	dirt	1110	
4'	3000	No	dirt	1125	
5'	4000	No	clay dirt	1135	2 N 32.21124
6'	3200	No	clay-dirt	1150	W 103.97452
7'	2200	No	dirt	1200	
8'	1900	No	dirt	1235	
9'	1400	No	dirt	1245	
10'	800	No	dirt	100	
11'	800	No	dirt	120	
12'	4000	No-slight	dirt	140	
Backhoe Refusal-15'	1800	No	Mud	200	
Sp3 @ Surface	6000+	slight	cc	215	
1'	4000	No	dirt	230	
2'	3600	No	dirt	245	
3'	4400	No	dirt	300	3 N 32.21122
4'	3200	No	dirt	310	W 103.97467
5'	3800	No	clay dirt	320	
6'	3000	No	clay dirt	328	
7'	2400	No	dirt	335	
8'	1800	No	dirt	345	
9'	1400	No	dirt	355	
10'	900	No	dirt	410	

Harram

15

Stake

No

12

2/22/16 - PB

Sample	CL	ODOR	Type	Time
11	800	no	dirt	420
12	4000	slight-no	dirt	435
15	1800	no	mud	442

District I
1625 N. French Dr., Hobbs, NM 88240
District II
811 S. First St., Artesia, NM 88210
District III
1000 Rio Brazos Road, Aztec, NM 87410
District IV
1220 S. St. Francis Dr., Santa Fe, NM 87505

State of New Mexico
Energy Minerals and Natural Resources
Oil Conservation Division
1220 South St. Francis Dr.
Santa Fe, NM 87505

Form C-141
Revised August 8, 2011

Submit 1 Copy to appropriate District Office in
accordance with 19.15.29 NMAC.

Release Notification and Corrective Action

OPERATOR

☒ Initial Report ☐ Final Report

Name of Company	Oxy Permian Ltd.	Contact	Casey Summers
Address	6 Desta Drive, Midland, TX 79705	Telephone No.	(575) 513-8289
Facility Name	Harroun 15 #12	Facility Type	Well location
Surface Owner	Private-Henry McDonald	Mineral Owner	
		API No.	30-015-32117

LOCATION OF RELEASE

Unit Letter	Section	Township	Range	Feet from the	North/South Line	Feet from the	East/West Line	County
N	15	24S	29E					Eddy County, NM

Latitude N 32.21124° Longitude W 103.97459°

NATURE OF RELEASE

Type of Release	Oil and produced water	Volume of Release	3 bbls oil, 4 bbls produced water	Volume Recovered	0 bbls
Source of Release	Over-pressure of a 3" poly production line	Date and Hour of Occurrence	01/20/2016	Date and Hour of Discovery	
Was Immediate Notice Given?	<input type="checkbox"/> Yes <input type="checkbox"/> No <input checked="" type="checkbox"/> Not Required	If YES, To Whom?	Mike Bratcher, Heather Patterson-NMOCD		
By Whom?	Kathy Purvis @ BBC International	Date and Hour	01/22/2016 @ 12:19 pm		
Was a Watercourse Reached?	<input type="checkbox"/> Yes <input checked="" type="checkbox"/> No	If YES, Volume Impacting the Watercourse.			

If a Watercourse was Impacted, Describe Fully.*

Describe Cause of Problem and Remedial Action Taken.*

Over-pressure of a 3" poly production line caused 3 bbls of oil and 4 bbls of produced water to be spilled on to the ground. No fluids were recovered and the line was repaired/replaced.

Describe Area Affected and Cleanup Action Taken.*

The affected area is approximately 40' x 60' both on and off location. Remediation will be completed in accordance with a remediation plan approved by NMOCD.

I hereby certify that the information given above is true and complete to the best of my knowledge and understand that pursuant to NMOCD rules and regulations all operators are required to report and/or file certain release notifications and perform corrective actions for releases which may endanger public health or the environment. The acceptance of a C-141 report by the NMOCD marked as "Final Report" does not relieve the operator of liability should their operations have failed to adequately investigate and remediate contamination that pose a threat to ground water, surface water, human health or the environment. In addition, NMOCD acceptance of a C-141 report does not relieve the operator of responsibility for compliance with any other federal, state, or local laws and/or regulations.

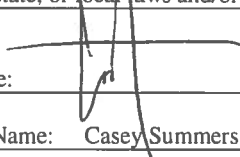
Signature: 		<u>OIL CONSERVATION DIVISION</u>	
Printed Name: Casey Summers		Approved by Environmental Specialist:	
Title: NM Environmental Advisor		Approval Date:	Expiration Date:
E-mail Address: Casey_Summers@oxy.com		Conditions of Approval:	
Date: 2-4-16 Phone: (575) 513-8289		Attached <input type="checkbox"/>	

* Attach Additional Sheets If Necessary