

talonlpe.com • 866.742.0742



Remediation Closure Report

Grandi 22-3 * 30-015-33922 * **2RP-3647**

Talon Project No. 700794.186.01

Prepared For:

Devon Energy Production Company,
6488 Seven Rivers Hwy
Artesia, New Mexico 88210

Prepared By:

Kimberly M. Wilson
Talon/LPE
408 West Texas
Artesia, New Mexico 88210

June 27, 2016

Mr. Mike Bratcher
NMOCD District 2
811 S. 1st Street
Artesia, NM 88210

Subject: **Remediation Closure Report**
 Devon Energy
 Grandi 22-3 * 30-015-33922 * 2RP-3647

Dear Mr. Bratcher,

Devon Energy has contracted Talon/LPE (Talon) to perform soil assessment and remediation services at the above referenced location. The results of our soil assessment and proposed remediation activities consist of the following.

Incident Date

April 20, 2016

Site Information

The Grandi 22-3 is located approximately four (4) miles southeast of Carlsbad, New Mexico. The legal location for the site is Section A, Township 22 South and Range 27 East in Eddy County, New Mexico. More specifically the latitude and longitude for the location are 32.3835716 North and 104.17298 West. See site plan in [Appendix I](#).

According to the soil survey provided by the United States Department of Agriculture Natural Resources Conservation Service, the soil in this area is made up of up of Reagan-Upton association with 0 to 9 percent slopes. Drainage courses in this area are normally dry.

Groundwater and Site Ranking

The New Mexico State Engineer web site indicates the nearest ground water data to be in S23-T22S-R27E. The ground water in the area is reported to be a depth of 40-feet below ground surface (bgs). The referenced groundwater data is presented in [Appendix II](#).

Therefore the ranking for this site is a **20** based on the following:

Depth to ground water	<50'
Wellhead Protection Area	>1000'
Distance to surface water body	>1000'

Based upon the site ranking of **20**, NMOCD Recommended Remedial Action Levels (RRAL) are 50 mg/kg for BTEX, 10 mg/kg for Benzene, 100 mg/kg for TPH and 1000 mg/kg for total chlorides.

Incident Description

On July 2, 2015 Blue Wally Construction submitted a OneCall ticket for installing a sprinkler system for a private home owner. Devon Energy's line locating department responded with a positive response by flagging the line and requesting in the notes that the construction company was to contact Devon so that a representative could be present at the time of the installation of the sprinklers. Blue Wally Construction failed to contact Devon Energy as requested and installed the sprinkler system. In March 2016, the home owner contacted Devon Energy believing that the line had developed a leak due to staining in his yard. Devon pressured the line on March 18, 2016 to identify exactly where the leak was located. On March 21, 2016 Devon excavated a small area around the line to identify how the line had failed. A cut into the Devon line was identified right underneath the sprinkler system line that was routed over the top of the Devon line. The coordinates are 32.383947, -104.168534. A site plan is presented in [Appendix I](#) which illustrates the impacted areas.

Remedial Actions Taken

The remediation activities were completed pursuant to the work plan approved by the NMOCD.

The impacted areas within the yard were excavated down to the rock shelf utilizing a roustabout crew to expose the utility lines.

A backhoe and roustabout crews were used to excavate the majority of the impacted area down to the rock shelf in the landowner's yard and around several utility lines.

The dead trees were removed and a trench was excavated along the tree line approximately 75-feet long by 6-feet deep and 3-feet wide utilizing a hammer-hoe.

A 2-foot clay liner was installed into the bottom of the excavation at the tree line and the entire excavated area was backfilled with new locally obtained top soil. The work area was contoured to match the surrounding landscape.

Closure

On behalf of Devon Energy Production Company we respectfully request that no further actions be required and that closure with respect to this release be granted. A Final C-141 is also attached.

Should you have any questions or if further information is required, please do not hesitate to contact our office at (575)-746-8768

Respectfully submitted,

TALON/LPE

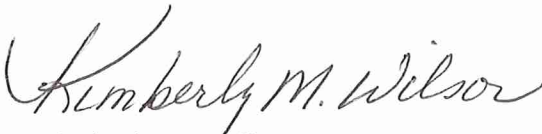

Kimberly M. Wilson
Project Manager



David J. Adkins
District Manager

APPENDIX I

SITE MAP



Scale in Feet

Legend

- Source Location
- Surface Soil Samples
- Pipeline
- Irrigation Line

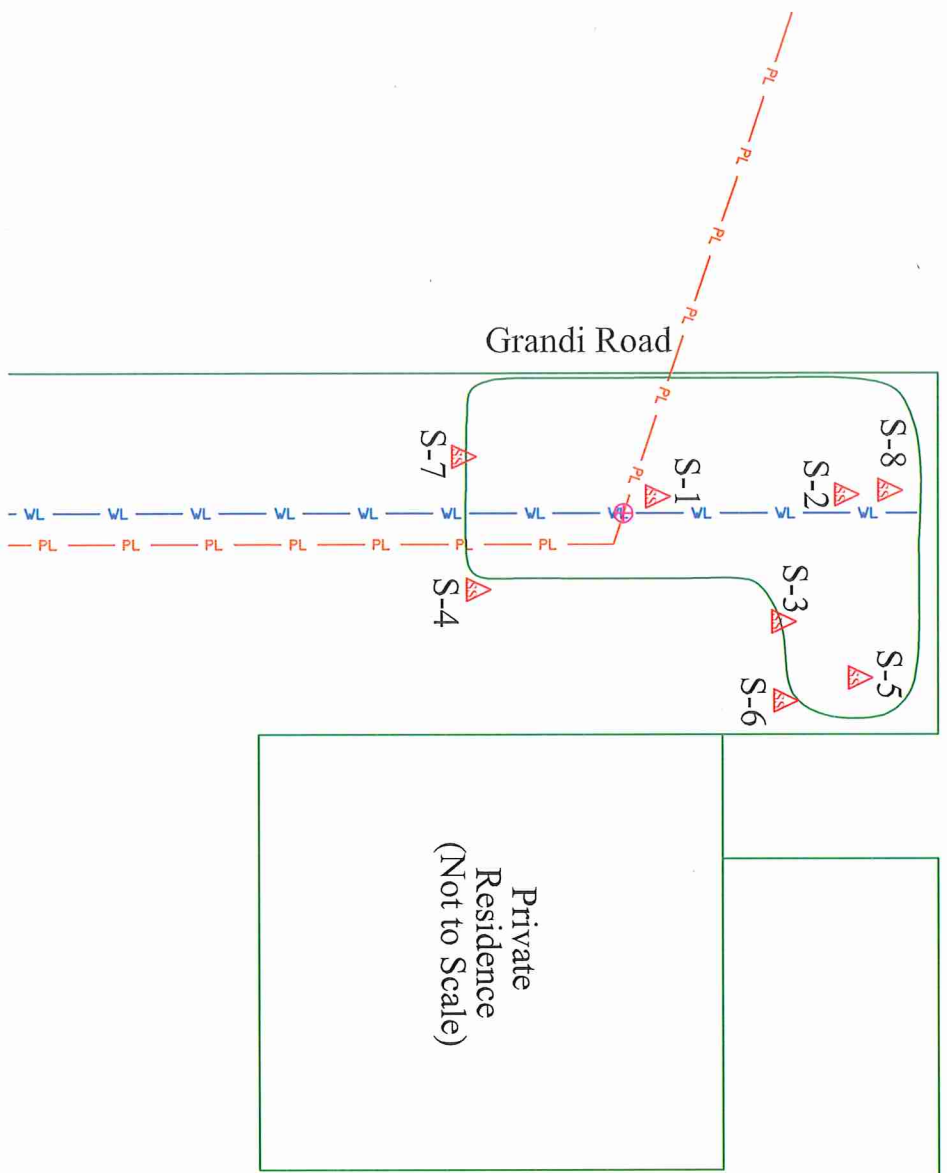

Date: 04/28/2016
Scale: 1" = 30'
Drawn By: SMM

Grandi 22-3 Line
Devon Energy Corporation
Eddy County, New Mexico
Site Plan

APPENDIX II
GROUNDWATER DATA



New Mexico Office of the State Engineer

Water Column/Average Depth to Water

(A CLW##### in the
POD suffix indicates the
POD has been replaced
& no longer serves a
water right file.)

(R=POD has
been replaced,
O=orphaned,
C=the file is
closed)

(quarters are 1=NW 2=NE 3=SW 4=SE)

(quarters are smallest to largest)

(NAD83 UTM in meters)

(In feet)

POD Number	POD Sub- Code	basin	County	Q 6	Q 4	Q 16	Sec	Tws	Rng	X	Y	Distance	Depth Well	Depth Water	Water Column
C 00043	C	ED		3	3	3	14	22S	27E	578256	3583557*	206	120		
C 01776	C	ED		3	1	23	22S	27E	578361	3582846*	515	157	40	117	
C 00231 A		ED		1	4	1	23	22S	27E	578666	3582951*	571	178	45	133
C 03063		ED		1	4	1	23	22S	27E	578666	3582951*	571	163	40	123

Average Depth to Water: 41 feet

Minimum Depth: 40 feet

Maximum Depth: 45 feet

Record Count: 4

UTMNAD83 Radius Search (in meters):

Easting (X): 578258

Northing (Y): 3583351

Radius: 1000

*UTM location was derived from PLSS - see Help

The data is furnished by the NMOSE/ISC and is accepted by the recipient with the expressed understanding that the OSE/ISC make no warranties, expressed or implied, concerning the accuracy, completeness, reliability, usability, or suitability for any particular purpose of the data.