

Closure Report

Site Description

Site Name:	Tex-Mack #202
Company:	COG Operating LLC
Legal Description:	U/L N, Section 2, T17S, R31E
County:	Eddy County, NM
GPS Coordinates:	N 32.85893° W 103.84364°

Release Data

Date of Release:	06/29/2016
Type of Release:	Produced water
Source of Release:	Produced water tank
Volume of Release:	10 bbls
Volume Recovered:	9 bbls

Remediation Specifications

Remediation Parameters:	Excavate the area of SP3 to a depth of 1.5 feet. Excavate the remaining area around SP1 and SP2 to a depth of 6 inches. Backfill the site with clean soil.	
Remediation Activities:	11/18/2016 to 11/21/2016	
Plan Sent to OCD:	11/21/2016	Email from Cliff Brunson to Mike Bratcher
OCD Approval of Plan:	11/29/2016	Email from Mike Bratcher to Cliff Brunson
Plan Sent to BLM:	n/a	n/a
BLM Approval of Plan:	n/a	n/a

Supporting Documentation

Initial C-141	Signed 07/07/2016
Final C-141	Signed 11/28/2016
Site Diagram	October 2016
Groundwater Plot	175'
TOPO Maps	October 2016
Lab Summary	10/14/2016 and 10/31/2016
Lab Analysis	10/14/2016 and 10/31/2016
Correspondence	Request and approval of remediation plan via email

Request for Closure

Based on the completion of the remediation plan as agreed upon, BBC International requests closure approval from NMOCD.

Cliff Brunson, President of BBC International Inc.

11/30/2016

District I
1625 N. French Dr., Hobbs, NM 88240
District II
811 S. First St., Artesia, NM 88210
District III
1000 Rio Brazos Road, Aztec, NM 87410
District IV
1220 S. St. Francis Dr., Santa Fe, NM 87505

State of New Mexico
Energy Minerals and Natural Resources

Oil Conservation Division
1220 South St. Francis Dr.
Santa Fe, NM 87505

Form C-141
Revised August 8, 2011

Submit 1 Copy to appropriate District Office in
accordance with 19.15.29 NMAC.

Release Notification and Corrective Action

Name of Company:		OPERATOR		<input checked="" type="checkbox"/> Initial Report	<input type="checkbox"/> Final Report
COG Operating LLC		Contact:	Robert McNeill		
Address: 600 West Illinois Avenue, Midland TX 79701		Telephone No.	432-683-7443		
Facility Name: TEX-MACK #202		Facility Type:	Tank Battery		
Surface Owner: State		Mineral Owner:	API No. 30-015-35914		

LOCATION OF RELEASE

Unit Letter	Section	Township	Range	Feet from the	North/South Line	Feet from the	East/West Line	County
N	02	17S	31E	990'	South	1650'	West	Eddy

Latitude 32.8590813 Longitude 103.8436432

NATURE OF RELEASE

Type of Release: Produced Water	Volume of Release: 10bbbls of Produced water	Volume Recovered: 9bbbls of Produced water
Source of Release: Produced Water Tank	Date and Hour of Occurrence: 06-29-2016 08:00am	Date and Hour of Discovery: 06-29-2016 08:00am
Was Immediate Notice Given? <input type="checkbox"/> Yes <input checked="" type="checkbox"/> No <input checked="" type="checkbox"/> Not Required	If YES, To Whom?	
By Whom?	Date and Hour:	
Was a Watercourse Reached? <input type="checkbox"/> Yes <input checked="" type="checkbox"/> No	If YES, Volume Impacting the Watercourse.	

If a Watercourse was Impacted, Describe Fully.*

Describe Cause of Problem and Remedial Action Taken.*

Murphy switch failed. Replaced Murphy switch.

Describe Area Affected and Cleanup Action Taken.*

A vacuum truck was dispatched to remove all freestanding fluids. Concho will have the spill site inspected for any possible contamination from the release and we will present a remediation work plan to the NMOCD for approval prior to any significant remediation work.

I hereby certify that the information given above is true and complete to the best of my knowledge and understand that pursuant to NMOCD rules and regulations all operators are required to report and/or file certain release notifications and perform corrective actions for releases which may endanger public health or the environment. The acceptance of a C-141 report by the NMOCD marked as "Final Report" does not relieve the operator of liability should their operations have failed to adequately investigate and remediate contamination that pose a threat to ground water, surface water, human health or the environment. In addition, NMOCD acceptance of a C-141 report does not relieve the operator of responsibility for compliance with any other federal, state, or local laws and/or regulations.

Signature:		OIL CONSERVATION DIVISION	
Printed Name: Robert Grubbs Jr.		Approved by Environmental Specialist:	
Title: Senior Environmental Coordinator	Approval Date:	Expiration Date:	
E-mail Address: rgrubbs@concho.com	Conditions of Approval:		Attached <input type="checkbox"/>
Date: July 7, 2016	Phone: 432-683-7443		

* Attach Additional Sheets If Necessary

District I
1625 N. French Dr., Hobbs, NM 88240
District II
811 S. First St., Artesia, NM 88210
District III
1000 Rio Brazos Road, Aztec, NM 87410
District IV
1220 S. St. Francis Dr., Santa Fe, NM 87505

State of New Mexico
Energy Minerals and Natural Resources

Oil Conservation Division
1220 South St. Francis Dr.
Santa Fe, NM 87505

Form C-141
Revised August 8, 2011

Submit 1 Copy to appropriate District Office in
accordance with 19.15.29 NMAC.

Release Notification and Corrective Action

OPERATOR

☐ Initial Report ☒ Final Report

Name of Company: COG Operating LLC	Contact: Robert McNeill
Address: 600 West Illinois Avenue, Midland, TX 79701	Telephone No. 432-685-4304
Facility Name: Tex-Mack #202	Facility Type: Tank Battery

Surface Owner: State	Mineral Owner: State	API No. 30-015-35914
----------------------	----------------------	----------------------

LOCATION OF RELEASE

Unit Letter	Section	Township	Range	Feet from the	North/South Line	Feet from the	East/West Line	County
N	2	17S	31E	990	South	1650	West	Eddy County, NM

Latitude N 32.85893° Longitude W 103.84364°

NATURE OF RELEASE

Type of Release: Produced water	Volume of Release: 10 bbls	Volume Recovered: 9 bbls
Source of Release: Produced water tank	Date and Hour of Occurrence 06/29/2016 @ 8:00 am	Date and Hour of Discovery 06/29/2016 @ 6:00 am
Was Immediate Notice Given? <input type="checkbox"/> Yes <input type="checkbox"/> No <input checked="" type="checkbox"/> Not Required	If YES, To Whom?	
By Whom?	Date and Hour:	
Was a Watercourse Reached? <input type="checkbox"/> Yes <input checked="" type="checkbox"/> No	If YES, Volume Impacting the Watercourse.	

If a Watercourse was Impacted, Describe Fully.*

Describe Cause of Problem and Remedial Action Taken.*

Failure of a Murphy switch caused a leak of 10 bbls of produced water. A vacuum truck recovered 9 bbls of produced water and the Murphy switch was replaced.

Describe Area Affected and Cleanup Action Taken.*

The affected area included an 80' x 6' area inside the firewall just north of the tanks. The site was sampled and a remediation plan was created. Remediation was completed in accordance with the remediation plan approved by Mike Bratcher of NMOCD.

I hereby certify that the information given above is true and complete to the best of my knowledge and understand that pursuant to NMOCD rules and regulations all operators are required to report and/or file certain release notifications and perform corrective actions for releases which may endanger public health or the environment. The acceptance of a C-141 report by the NMOCD marked as "Final Report" does not relieve the operator of liability should their operations have failed to adequately investigate and remediate contamination that pose a threat to ground water, surface water, human health or the environment. In addition, NMOCD acceptance of a C-141 report does not relieve the operator of responsibility for compliance with any other federal, state, or local laws and/or regulations.

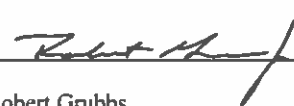
Signature: 		OIL CONSERVATION DIVISION	
Printed Name: Robert Grubbs		Approved by Environmental Specialist:	
Title: Senior Environmental Coordinator		Approval Date:	Expiration Date:
E-mail Address: rgrubbs@concho.com		Conditions of Approval:	
Date: November 28, 2016 Phone: (432) 683-7443		Attached <input type="checkbox"/>	

* Attach Additional Sheets If Necessary



COG

Tex-Mack #202 (6/29/16)

Location

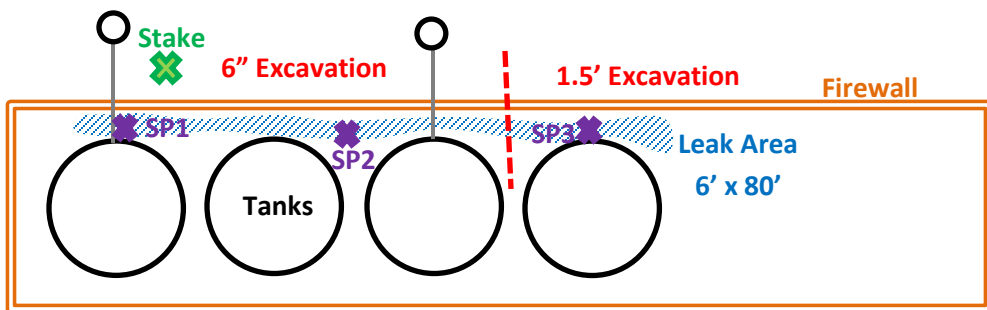

Road

U/L N, Section 2, T17S, R31E

Eddy County, NM

N 32.85893° W 103.84364°

API# 30-015-35914

BBC International, Inc.

COG

Tex-Mack #202

Date: 10/03/2016

DRWG by: K. Purvis

NOT TO SCALE

File: COG 2016



Groundwater Plot

COG Tex-Mack #202

County
Eddy

Unit Letter
N

Section
2

Township
17S

Range
31E

Trend Map 175'

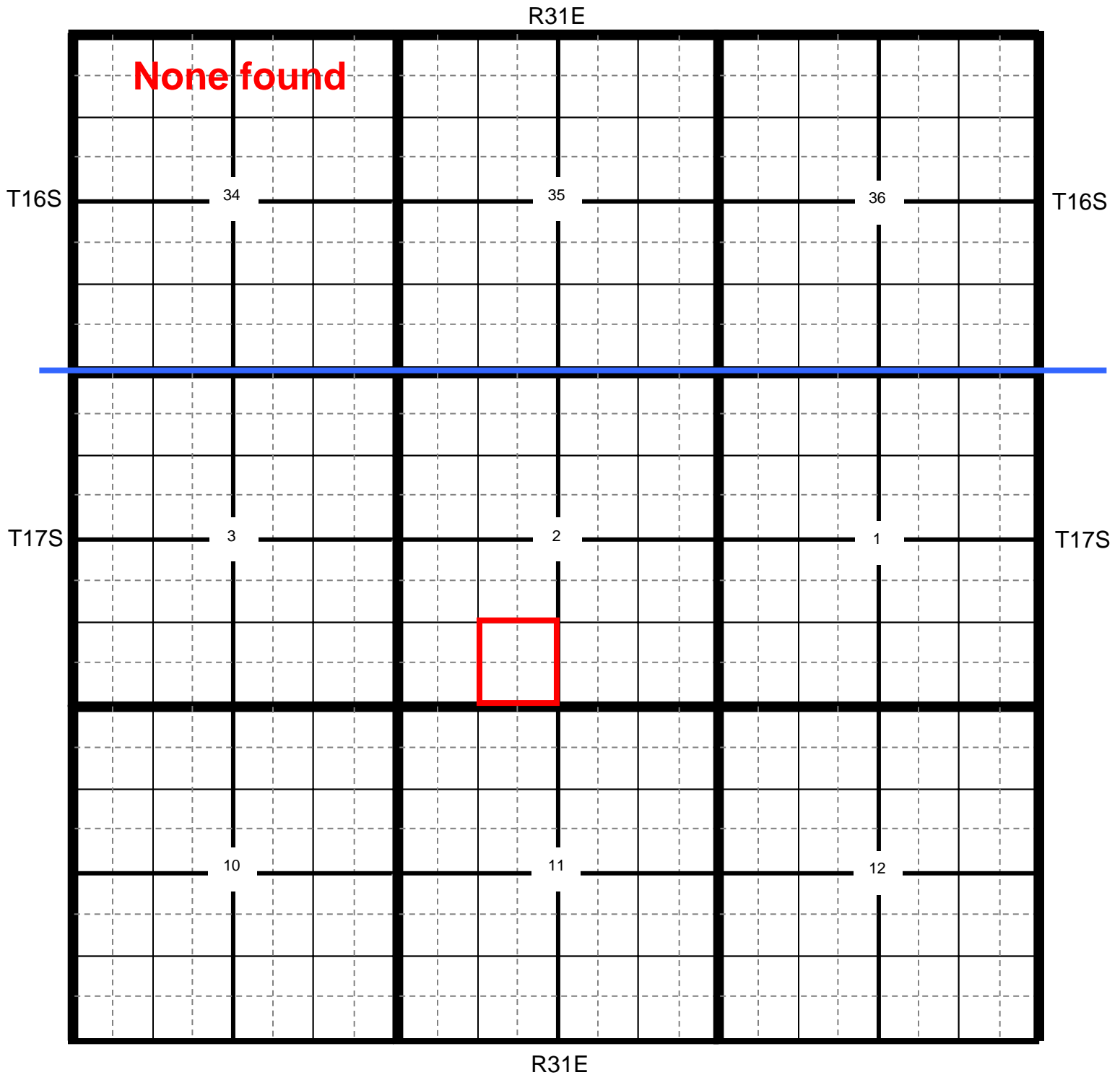

📍 Location

● OCD

● USGS

● SEO

● All Databases

COG Tex-Mack #202

County Eddy Unit Letter N Section 2 Township 17S Range 31E

Trend Map 175'

1

2

NW/NW None found	NE/NW	NW/NE	NE/NE
Unit Letter D	Unit Letter C	Unit Letter B	Unit Letter A
SW/NW	SE/NW	SW/NE	SE/NE
Unit Letter E	Unit Letter F	Unit Letter G	Unit Letter H
NW/SW	NE/SW	NW/SE	NE/SE
Unit Letter L	Unit Letter K	Unit Letter J	Unit Letter I
SW/SW	SE/SW	SW/SE	SE/SE
Unit Letter M	Unit Letter N	Unit Letter O	Unit Letter P

3

4

Tex-Mack #202

UNITED STATES
DEPARTMENT OF THE INTERIOR
GEOLOGICAL SURVEY

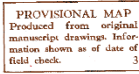

COG

Tex-Mack #202

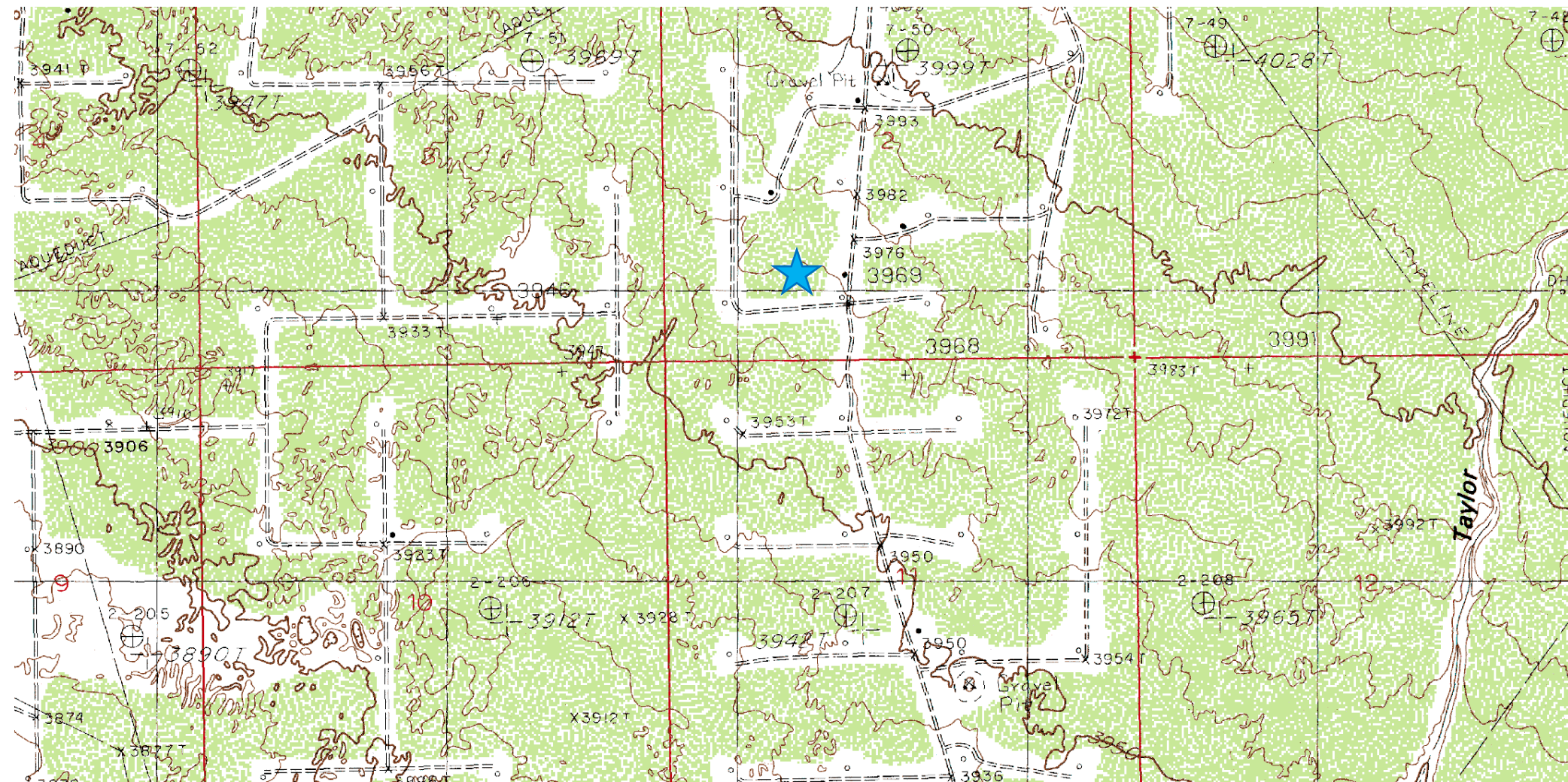

**Laboratory Analytical Results Summary
Tex-Mack #202**

		Sample	SP1 @ SURFACE	SP1 @ 1'
Analyte	Method	Date	10/14/16	10/14/16
			mg/Kg	mg/Kg
Benzene	BTEX 8021B		<0.050	n/a
Toluene	BTEX 8021B		0.059	n/a
Ethylbenzene	BTEX 8021B		0.05	n/a
Total Xylenes	BTEX 8021B		<0.150	n/a
Total BTEX	BTEX 8021B		<0.300	n/a
Chloride	SM4500Cl-B		80	64
GRO	TPH 8015M		<10.0	n/a
DRO	TPH 8015M		41	n/a

		Sample	SP2 @ SURFACE	SP2 @ 1'	SP2 @ 1.5'
Analyte	Method	Date	10/14/16	10/14/16	10/31/16
			mg/Kg	mg/Kg	mg/Kg
Benzene	BTEX 8021B		<0.050	n/a	n/a
Toluene	BTEX 8021B		0.051	n/a	n/a
Ethylbenzene	BTEX 8021B		<0.050	n/a	n/a
Total Xylenes	BTEX 8021B		<0.150	n/a	n/a
Total BTEX	BTEX 8021B		<0.300	n/a	n/a
Chloride	SM4500Cl-B		128	992	32
GRO	TPH 8015M		<10.0	n/a	n/a
DRO	TPH 8015M		<10.0	n/a	n/a

		Sample	SP3 @ SURFACE	SP3 @ 1'	SP3 @ 1.5'
Analyte	Method	Date	10/14/16	10/14/16	10/31/16
			mg/Kg	mg/Kg	mg/Kg
Benzene	BTEX 8021B		<0.050	n/a	<0.050
Toluene	BTEX 8021B		0.949	n/a	<0.050
Ethylbenzene	BTEX 8021B		2.02	n/a	<0.050
Total Xylenes	BTEX 8021B		4.02	n/a	<0.150
Total BTEX	BTEX 8021B		6.99	n/a	<0.300
Chloride	SM4500Cl-B		848	3920	32
GRO	TPH 8015M		394	n/a	<10.0
DRO	TPH 8015M		4860	n/a	<10.0



PHONE (575) 393-2326 ° 101 E. MARLAND ° HOBBS, NM 88240

October 24, 2016

Cliff Brunson

BBC International, Inc.

P.O. Box 805

Hobbs, NM 88241

RE: TEX-MACK

Enclosed are the results of analyses for samples received by the laboratory on 10/19/16 16:47.

Cardinal Laboratories is accredited through Texas NELAP under certificate number T104704398-16-8. Accreditation applies to drinking water, non-potable water and solid and chemical materials. All accredited analytes are denoted by an asterisk (*). For a complete list of accredited analytes and matrices visit the TCEQ website at www.tceq.texas.gov/field/qa/lab_accred_certif.html.

Cardinal Laboratories is accredited through the State of Colorado Department of Public Health and Environment for:

Method EPA 552.2	Haloacetic Acids (HAA-5)
Method EPA 524.2	Total Trihalomethanes (TTHM)
Method EPA 524.4	Regulated VOCs (V1, V2, V3)

Accreditation applies to public drinking water matrices.

This report meets NELAP requirements and is made up of a cover page, analytical results, and a copy of the original chain-of-custody. If you have any questions concerning this report, please feel free to contact me.

Sincerely,

A handwritten signature in black ink that reads "Celey D. Keene". The signature is written in a cursive, flowing style.

Celey D. Keene

Lab Director/Quality Manager

Analytical Results For:

BBC International, Inc.
Cliff Brunson
P.O. Box 805
Hobbs NM, 88241
Fax To: (575) 397-0397

Received: 10/19/2016
Reported: 10/24/2016
Project Name: TEX-MACK
Project Number: NONE GIVEN
Project Location: NOT GIVEN

Sampling Date: 10/14/2016
Sampling Type: Soil
Sampling Condition: Cool & Intact
Sample Received By: Jodi Henson

Sample ID: SP 1 @ SURFACE (H602349-01)

BTEX 8021B		mg/kg	Analyzed By: CK						
Analyte	Result	Reporting Limit	Analyzed	Method Blank	BS	% Recovery	True Value QC	RPD	Qualifier
Benzene*	<0.050	0.050	10/21/2016	ND	1.99	99.4	2.00	1.67	
Toluene*	0.059	0.050	10/21/2016	ND	2.24	112	2.00	1.57	
Ethylbenzene*	0.050	0.050	10/21/2016	ND	2.24	112	2.00	1.80	
Total Xylenes*	<0.150	0.150	10/21/2016	ND	6.76	113	6.00	1.70	
Total BTEX	<0.300	0.300	10/21/2016	ND					

Surrogate: 4-Bromofluorobenzene (PID) 99.9 % 73.6-140

Chloride, SM4500Cl-B		mg/kg	Analyzed By: AC						
Analyte	Result	Reporting Limit	Analyzed	Method Blank	BS	% Recovery	True Value QC	RPD	Qualifier
Chloride	80.0	16.0	10/24/2016	ND	400	100	400	0.00	

TPH 8015M		mg/kg	Analyzed By: CK						
Analyte	Result	Reporting Limit	Analyzed	Method Blank	BS	% Recovery	True Value QC	RPD	Qualifier
GRO C6-C10	<10.0	10.0	10/21/2016	ND	185	92.4	200	0.308	
DRO >C10-C28	41.0	10.0	10/21/2016	ND	200	100	200	1.39	

Surrogate: 1-Chlorooctane 104 % 35-147

Surrogate: 1-Chlorooctadecane 121 % 28-171

Sample ID: SP 1 @ 1' (H602349-02)

Chloride, SM4500Cl-B		mg/kg	Analyzed By: AC						
Analyte	Result	Reporting Limit	Analyzed	Method Blank	BS	% Recovery	True Value QC	RPD	Qualifier
Chloride	64.0	16.0	10/24/2016	ND	400	100	400	0.00	

Cardinal Laboratories

*=Accredited Analyte

PLEASE NOTE: Liability and Damages. Cardinal's liability and client's exclusive remedy for any claim arising, whether based in contract or tort, shall be limited to the amount paid by client for analyses. All claims, including those for negligence and any other cause whatsoever shall be deemed waived unless made in writing and received by Cardinal within thirty (30) days after completion of the applicable service. In no event shall Cardinal be liable for incidental or consequential damages, including, without limitation, business interruptions, loss of use, or loss of profits incurred by client, its subsidiaries, affiliates or successors arising out of or related to the performance of the services hereunder by Cardinal, regardless of whether such claim is based upon any of the above stated reasons or otherwise. Results relate only to the samples identified above. This report shall not be reproduced except in full with written approval of Cardinal Laboratories.



Celey D. Keene, Lab Director/Quality Manager

Analytical Results For:

BBC International, Inc.
Cliff Brunson
P.O. Box 805
Hobbs NM, 88241
Fax To: (575) 397-0397

Received: 10/19/2016
Reported: 10/24/2016
Project Name: TEX-MACK
Project Number: NONE GIVEN
Project Location: NOT GIVEN

Sampling Date: 10/14/2016
Sampling Type: Soil
Sampling Condition: Cool & Intact
Sample Received By: Jodi Henson

Sample ID: SP 2 @ SURFACE (H602349-03)

BTX 8021B		mg/kg		Analyzed By: CK					
Analyte	Result	Reporting Limit	Analyzed	Method Blank	BS	% Recovery	True Value QC	RPD	Qualifier
Benzene*	<0.050	0.050	10/21/2016	ND	1.99	99.4	2.00	1.67	
Toluene*	0.051	0.050	10/21/2016	ND	2.24	112	2.00	1.57	
Ethylbenzene*	<0.050	0.050	10/21/2016	ND	2.24	112	2.00	1.80	
Total Xylenes*	<0.150	0.150	10/21/2016	ND	6.76	113	6.00	1.70	
Total BTX	<0.300	0.300	10/21/2016	ND					

Surrogate: 4-Bromofluorobenzene (PID) 101 % 73.6-140

Chloride, SM4500CI-B		mg/kg		Analyzed By: AC					
Analyte	Result	Reporting Limit	Analyzed	Method Blank	BS	% Recovery	True Value QC	RPD	Qualifier
Chloride	128	16.0	10/24/2016	ND	400	100	400	0.00	

TPH 8015M		mg/kg		Analyzed By: CK					
Analyte	Result	Reporting Limit	Analyzed	Method Blank	BS	% Recovery	True Value QC	RPD	Qualifier
GRO C6-C10	<10.0	10.0	10/21/2016	ND	192	95.9	200	3.20	
DRO >C10-C28	<10.0	10.0	10/21/2016	ND	210	105	200	12.0	

Surrogate: 1-Chlorooctane 86.2 % 35-147

Surrogate: 1-Chlorooctadecane 104 % 28-171

Sample ID: SP 2 @ 1' (H602349-04)

Chloride, SM4500Cl-B		mg/kg		Analyzed By: AC						
Analyte	Result	Reporting Limit	Analyzed	Method Blank	BS	% Recovery	True Value QC	RPD	Qualifier	
Chloride	992	16.0	10/24/2016	ND	400	100	400	0.00		

Cardinal Laboratories

*=Accredited Analyte

PLEASE NOTE: Liability and Damages. Cardinal's liability and client's exclusive remedy for any claim arising, whether based in contract or tort, shall be limited to the amount paid by client for analyses. All claims, including those for negligence and any other cause whatsoever shall be deemed waived unless made in writing and received by Cardinal within thirty (30) days after completion of the applicable service. In no event shall Cardinal be liable for incidental or consequential damages, including, without limitation, business interruptions, loss of use, or loss of profits incurred by client, its subsidiaries, affiliates or successors arising out of or related to the performance of the services hereunder by Cardinal, regardless of whether such claim is based upon any of the above stated reasons or otherwise. Results relate only to the samples identified above. This report shall not be reproduced except in full with written approval of Cardinal Laboratories.



Celey D. Keene, Lab Director/Quality Manager

Analytical Results For:

BBC International, Inc.
Cliff Brunson
P.O. Box 805
Hobbs NM, 88241
Fax To: (575) 397-0397

Received: 10/19/2016
Reported: 10/24/2016
Project Name: TEX-MACK
Project Number: NONE GIVEN
Project Location: NOT GIVEN

Sampling Date: 10/14/2016
Sampling Type: Soil
Sampling Condition: Cool & Intact
Sample Received By: Jodi Henson

Sample ID: SP 3 @ SURFACE (H602349-05)

BTEx 8021B		mg/kg		Analyzed By: CK					
Analyte	Result	Reporting Limit	Analyzed	Method Blank	BS	% Recovery	True Value QC	RPD	Qualifier
Benzene*	<0.500	0.500	10/21/2016	ND	1.99	99.4	2.00	1.67	
Toluene*	0.949	0.500	10/21/2016	ND	2.24	112	2.00	1.57	
Ethylbenzene*	2.02	0.500	10/21/2016	ND	2.24	112	2.00	1.80	
Total Xylenes*	4.02	1.50	10/21/2016	ND	6.76	113	6.00	1.70	
Total BTEX	6.99	3.00	10/21/2016	ND					

Surrogate: 4-Bromofluorobenzene (PID) 118 % 73.6-140

Chloride, SM4500CI-B		mg/kg		Analyzed By: AC						
Analyte	Result	Reporting Limit	Analyzed	Method Blank	BS	% Recovery	True Value QC	RPD	Qualifier	
Chloride	848	16.0	10/24/2016	ND	400	100	400	0.00		

TPH 8015M		mg/kg		Analyzed By: CK				S-06	
Analyte	Result	Reporting Limit	Analyzed	Method Blank	BS	% Recovery	True Value QC	RPD	Qualifier
GRO C6-C10	394	50.0	10/21/2016	ND	192	95.9	200	3.20	
DRO >C10-C28	4860	50.0	10/21/2016	ND	210	105	200	12.0	

Surrogate: 1-Chlorooctane 157 % 35-147

Surrogate: 1-Chlorooctadecane 344 % 28-171

Sample ID: SP 3 @ 1' (H602349-06)

Chloride, SM4500Cl-B		mg/kg		Analyzed By: AC					
Analyte	Result	Reporting Limit	Analyzed	Method Blank	BS	% Recovery	True Value QC	RPD	Qualifier
Chloride	3920	16.0	10/24/2016	ND	400	100	400	0.00	

Cardinal Laboratories

*=Accredited Analyte

PLEASE NOTE: Liability and Damages. Cardinal's liability and client's exclusive remedy for any claim arising, whether based in contract or tort, shall be limited to the amount paid by client for analyses. All claims, including those for negligence and any other cause whatsoever shall be deemed waived unless made in writing and received by Cardinal within thirty (30) days after completion of the applicable service. In no event shall Cardinal be liable for incidental or consequential damages, including, without limitation, business interruptions, loss of use, or loss of profits incurred by client, its subsidiaries, affiliates or successors arising out of or related to the performance of the services hereunder by Cardinal, regardless of whether such claim is based upon any of the above stated reasons or otherwise. Results relate only to the samples identified above. This report shall not be reproduced except in full with written approval of Cardinal Laboratories.



Celey D. Keene, Lab Director/Quality Manager

Notes and Definitions

S-06	The recovery of this surrogate is outside control limits due to sample dilution required from high analyte concentration and/or matrix interference's.
QR-03	The RPD value for the sample duplicate or MS/MSD was outside if QC acceptance limits due to matrix interference. QC batch accepted based on LCS and/or LCSD recovery and/or RPD values.
QM-07	The spike recovery was outside acceptance limits for the MS and/or MSD. The batch was accepted based on acceptable LCS recovery.
ND	Analyte NOT DETECTED at or above the reporting limit
RPD	Relative Percent Difference
**	Samples not received at proper temperature of 6°C or below.
***	Insufficient time to reach temperature.
-	Chloride by SM4500Cl-B does not require samples be received at or below 6°C Samples reported on an as received basis (wet) unless otherwise noted on report

Cardinal Laboratories

*=Accredited Analyte

PLEASE NOTE: Liability and Damages. Cardinal's liability and client's exclusive remedy for any claim arising, whether based in contract or tort, shall be limited to the amount paid by client for analyses. All claims, including those for negligence and any other cause whatsoever shall be deemed waived unless made in writing and received by Cardinal within thirty (30) days after completion of the applicable service. In no event shall Cardinal be liable for incidental or consequential damages, including, without limitation, business interruptions, loss of use, or loss of profits incurred by client, its subsidiaries, affiliates or successors arising out of or related to the performance of the services hereunder by Cardinal, regardless of whether such claim is based upon any of the above stated reasons or otherwise. Results relate only to the samples identified above. This report shall not be reproduced except in full with written approval of Cardinal Laboratories.



Celey D. Keene, Lab Director/Quality Manager



ARDINAL LABORATORIES

101 East Marland, Hobbs, NM 88240
(505) 393-2326 FAX (505) 393-2476

CHAIN-OF-CUSTODY AND ANALYSIS REQUEST

Company Name: BBC International, Inc.		BILL TO		ANALYSIS REQUEST											
Project Manager: Cliff Brunson		P.O. #:													
Address: P.O. Box 805		Company:													
City: Hobbs		Attn:													
State: NM Zip: 88241		Address:													
Phone #: 575-397-6388 Fax #: 575-397-0397		City:													
Project #:		State:													
Project Name: Tex-Mark		Zip:													
Project Location:		Phone #:													
Sample Name: Pipe Brunson		Fax #:													
<small>FOR LAB USE ONLY</small>															
Lab I.D.	Sample I.D.	(G)RAB OR (C)OMP.	# CONTAINERS	MATRIX					PRESERV.	SAMPLING					
				GROUNDWATER											
				WASTEWATER											
				SOIL											
				OIL											
				SLUDGE											
				OTHER :											
				ACID/BASE:											
				ICE / COOL											
				OTHER :											
				DATE	TIME										
11002349	SP1 @ Surface	G	1	10/14/16	910	TPH									
2	SP1 @ 1'	G	1	10/14/16	935	BTEX									
3	SP2 @ Surface	G	1	10/14/16	1045	CL									
4	SP2 @ 1'	G	1	10/14/16	1110										
5	SP3 @ Surface	G	1	10/14/16	1110										
6	SP3 @ 1'	G	1	10/14/16	135										
<small>PLEASE NOTE: Liability and Damages: Cardinal's liability and client's exclusive remedy for any claim arising whether based in contract or tort, shall be limited to the amount paid by the client for the analyses. All claims including those for negligence and any other cause whatsoever shall be deemed waived unless made in writing and received by Cardinal within 30 days after completion of the applicable service. In no event shall Cardinal be liable for incidental or consequential damages, including without limitation, business interruptions, loss of use, or loss of profits incurred by client, its subsidiaries, affiliates or successors arising out of or related to the performance of services hereunder by Cardinal, regardless of whether such claim is based upon any of the above stated reasons or otherwise.</small>															
Relinquished By:	Date: 10/19/16	Received By:	Phone Result: <input type="checkbox"/> Yes <input type="checkbox"/> No	Add'l Phone #:											
Relinquished By:	Date:	Received By:	Fax Result: <input type="checkbox"/> Yes <input type="checkbox"/> No	Add'l Fax #:											
Delivered By: (Circle One)	Sample Condition	CHECKED BY:													
Sampler - UPS - Bus - Other:	Cool <input type="checkbox"/> Intact <input type="checkbox"/> Yes <input type="checkbox"/> No <input type="checkbox"/>	Initials													

† Cardinal cannot accept verbal changes. Please fax written changes to 505-393-2476



PHONE (575) 393-2326 ° 101 E. MARLAND ° HOBBS, NM 88240

November 10, 2016

Cliff Brunson

BBC International, Inc.

P.O. Box 805

Hobbs, NM 88241

RE: TEX-MACK #202

Enclosed are the results of analyses for samples received by the laboratory on 11/03/16 11:26.

Cardinal Laboratories is accredited through Texas NELAP under certificate number T104704398-16-8. Accreditation applies to drinking water, non-potable water and solid and chemical materials. All accredited analytes are denoted by an asterisk (*). For a complete list of accredited analytes and matrices visit the TCEQ website at www.tceq.texas.gov/field/qa/lab_accred_certif.html.

Cardinal Laboratories is accredited through the State of Colorado Department of Public Health and Environment for:

Method EPA 552.2	Haloacetic Acids (HAA-5)
Method EPA 524.2	Total Trihalomethanes (TTHM)
Method EPA 524.4	Regulated VOCs (V1, V2, V3)

Accreditation applies to public drinking water matrices.

This report meets NELAP requirements and is made up of a cover page, analytical results, and a copy of the original chain-of-custody. If you have any questions concerning this report, please feel free to contact me.

Sincerely,

A handwritten signature in black ink that reads "Celey D. Keene". The signature is written in a cursive, flowing style.

Celey D. Keene

Lab Director/Quality Manager

Analytical Results For:

BBC International, Inc.
Cliff Brunson
P.O. Box 805
Hobbs NM, 88241
Fax To: (575) 397-0397

Received: 11/03/2016
Reported: 11/10/2016
Project Name: TEX-MACK #202
Project Number: NONE GIVEN
Project Location: EDDY COUNTY, NM

Sampling Date: 10/31/2016
Sampling Type: Soil
Sampling Condition: Cool & Intact
Sample Received By: Jodi Henson

Sample ID: SP 2 @ 1.5' (H602479-01)

Chloride, SM4500Cl-B		mg/kg		Analyzed By: AC					
Analyte	Result	Reporting Limit	Analyzed	Method Blank	BS	% Recovery	True Value QC	RPD	Qualifier
Chloride	32.0	16.0	11/07/2016	ND	400	100	400	0.00	

Sample ID: SP 3 @ 1.5' (H602479-02)

Chloride, SM4500Cl-B		mg/kg		Analyzed By: AC					
Analyte	Result	Reporting Limit	Analyzed	Method Blank	BS	% Recovery	True Value QC	RPD	Qualifier
Chloride	32.0	16.0	11/07/2016	ND	400	100	400	0.00	

Cardinal Laboratories

*=Accredited Analyte

PLEASE NOTE: Liability and Damages. Cardinal's liability and client's exclusive remedy for any claim arising, whether based in contract or tort, shall be limited to the amount paid by client for analyses. All claims, including those for negligence and any other cause whatsoever shall be deemed waived unless made in writing and received by Cardinal within thirty (30) days after completion of the applicable service. In no event shall Cardinal be liable for incidental or consequential damages, including, without limitation, business interruptions, loss of use, or loss of profits incurred by client, its subsidiaries, affiliates or successors arising out of or related to the performance of the services hereunder by Cardinal, regardless of whether such claim is based upon any of the above stated reasons or otherwise. Results relate only to the samples identified above. This report shall not be reproduced except in full with written approval of Cardinal Laboratories.



Celey D. Keene, Lab Director/Quality Manager

Notes and Definitions

QR-03	The RPD value for the sample duplicate or MS/MSD was outside if QC acceptance limits due to matrix interference. QC batch accepted based on LCS and/or LCSD recovery and/or RPD values.
ND	Analyte NOT DETECTED at or above the reporting limit
RPD	Relative Percent Difference
**	Samples not received at proper temperature of 6°C or below.
***	Insufficient time to reach temperature.
-	Chloride by SM4500Cl-B does not require samples be received at or below 6°C Samples reported on an as received basis (wet) unless otherwise noted on report

Cardinal Laboratories

*=Accredited Analyte

PLEASE NOTE: Liability and Damages. Cardinal's liability and client's exclusive remedy for any claim arising, whether based in contract or tort, shall be limited to the amount paid by client for analyses. All claims, including those for negligence and any other cause whatsoever shall be deemed waived unless made in writing and received by Cardinal within thirty (30) days after completion of the applicable service. In no event shall Cardinal be liable for incidental or consequential damages, including, without limitation, business interruptions, loss of use, or loss of profits incurred by client, its subsidiaries, affiliates or successors arising out of or related to the performance of the services hereunder by Cardinal, regardless of whether such claim is based upon any of the above stated reasons or otherwise. Results relate only to the samples identified above. This report shall not be reproduced except in full with written approval of Cardinal Laboratories.



Celey D. Keene, Lab Director/Quality Manager



CARDINAL LABORATORIES

101 East Marland, Hobbs, NM 88240
(505) 393-2326 FAX (505) 393-2476

CHAIN-OF-CUSTODY AND ANALYSIS REQUEST

104

Company Name: BBC International, Inc.

Project Manager: Cliff Brunson

Address: P.O. Box 805

City: Hobbs

Phone #: 575-397-6388

Project #:

Project Name: Tex-Mack #202

Project Location: Eddy County, NM

Sampler Name: Price Brunson

FOR LAB USE ONLY

BILL TO

ANALYSIS REQUEST

P.O. #:

Company: *OG*

Attn: *Robert Grubbs*

Address:

City:

State:

Phone #:

Fax #:

Project #:

Project Name:

Project Location:

Sampler Name:

FOR LAB USE ONLY

Lab I.D.

Sample I.D.

SP2 @ 1.5' ✓

SP3 @ 1.5' ✓

61

61

GROUNDWATER

WASTEWATER

SOIL ✓

OIL ✓

SLUDGE

OTHER :

ACID/BASE:

ICE / COOL ✓

OTHER :

DATE

TIME

10/31/16

10:30 am

10/31/16

10:50 am

✓

✓

Relinquished By:

Date: 11/2/16

Time: 4:00pm

Received By:

Date: 11/3/16

Time: 11:26AM

Relinquished By:

Date: 11/3/16

Time: 11:26AM

Received By:

Date: 11/3/16

Time: 11:26AM

Relinquished By:

Date: 11/3/16

Time: 11:26AM

Received By:

Date: 11/3/16

Time: 11:26AM

Relinquished By:

Date: 11/3/16

Time: 11:26AM

Received By:

Date: 11/3/16

Time: 11:26AM

Relinquished By:

Date: 11/3/16

Time: 11:26AM

Received By:

Date: 11/3/16

Time: 11:26AM

Relinquished By:

Date: 11/3/16

Time: 11:26AM

Received By:

Date: 11/3/16

Time: 11:26AM

Relinquished By:

Date: 11/3/16

Time: 11:26AM

Received By:

Date: 11/3/16

Time: 11:26AM

Relinquished By:

Date: 11/3/16

Time: 11:26AM

Received By:

Date: 11/3/16

Time: 11:26AM



PHONE (575) 393-2326 ° 101 E. MARLAND ° HOBBS, NM 88240

November 14, 2016

Cliff Brunson

BBC International, Inc.

P.O. Box 805

Hobbs, NM 88241

RE: TEX-MACK #202

Enclosed are the results of analyses for samples received by the laboratory on 11/03/16 11:26.

Cardinal Laboratories is accredited through Texas NELAP under certificate number T104704398-16-8. Accreditation applies to drinking water, non-potable water and solid and chemical materials. All accredited analytes are denoted by an asterisk (*). For a complete list of accredited analytes and matrices visit the TCEQ website at www.tceq.texas.gov/field/qa/lab_accred_certif.html.

Cardinal Laboratories is accredited through the State of Colorado Department of Public Health and Environment for:

Method EPA 552.2	Haloacetic Acids (HAA-5)
Method EPA 524.2	Total Trihalomethanes (TTHM)
Method EPA 524.4	Regulated VOCs (V1, V2, V3)

Accreditation applies to public drinking water matrices.

This report meets NELAP requirements and is made up of a cover page, analytical results, and a copy of the original chain-of-custody. If you have any questions concerning this report, please feel free to contact me.

Sincerely,

A handwritten signature in black ink that reads "Celey D. Keene". The signature is written in a cursive, flowing style.

Celey D. Keene

Lab Director/Quality Manager

Analytical Results For:

BBC International, Inc.
Cliff Brunson
P.O. Box 805
Hobbs NM, 88241
Fax To: (575) 397-0397

Received: 11/03/2016
Reported: 11/14/2016
Project Name: TEX-MACK #202
Project Number: NONE GIVEN
Project Location: EDDY COUNTY, NM

Sampling Date: 10/31/2016
Sampling Type: Soil
Sampling Condition: Cool & Intact
Sample Received By: Jodi Henson

Sample ID: SP 2 @ 1.5' (H602479-01)

Chloride, SM4500CI-B			mg/kg		Analyzed By: AC				
Analyte	Result	Reporting Limit	Analyzed	Method Blank	BS	% Recovery	True Value QC	RPD	Qualifier
Chloride	32.0	16.0	11/07/2016	ND	400	100	400	0.00	

Sample ID: SP 3 @ 1.5' (H602479-02)

BTEX 8021B			mg/kg		Analyzed By: MS				
Analyte	Result	Reporting Limit	Analyzed	Method Blank	BS	% Recovery	True Value QC	RPD	Qualifier
Benzene*	<0.050	0.050	11/11/2016	ND	2.25	113	2.00	0.370	
Toluene*	<0.050	0.050	11/11/2016	ND	2.28	114	2.00	0.780	
Ethylbenzene*	<0.050	0.050	11/11/2016	ND	2.20	110	2.00	0.669	
Total Xylenes*	<0.150	0.150	11/11/2016	ND	6.65	111	6.00	0.572	
Total BTEX	<0.300	0.300	11/11/2016	ND					

Surrogate: 4-Bromofluorobenzene (PID) 110 % 73.6-140

Chloride, SM4500CI-B			mg/kg		Analyzed By: AC				
Analyte	Result	Reporting Limit	Analyzed	Method Blank	BS	% Recovery	True Value QC	RPD	Qualifier
Chloride	32.0	16.0	11/07/2016	ND	400	100	400	0.00	

TPH 8015M			mg/kg		Analyzed By: MS				
Analyte	Result	Reporting Limit	Analyzed	Method Blank	BS	% Recovery	True Value QC	RPD	Qualifier
GRO C6-C10	<10.0	10.0	11/10/2016	ND	173	86.3	200	1.84	
DRO >C10-C28	<10.0	10.0	11/10/2016	ND	180	90.2	200	0.365	

Surrogate: 1-Chlorooctane 85.2 % 35-147

Surrogate: 1-Chlorooctadecane 87.0 % 28-171

Cardinal Laboratories

*=Accredited Analyte

PLEASE NOTE: Liability and Damages. Cardinal's liability and client's exclusive remedy for any claim arising, whether based in contract or tort, shall be limited to the amount paid by client for analyses. All claims, including those for negligence and any other cause whatsoever shall be deemed waived unless made in writing and received by Cardinal within thirty (30) days after completion of the applicable service. In no event shall Cardinal be liable for incidental or consequential damages, including, without limitation, business interruptions, loss of use, or loss of profits incurred by client, its subsidiaries, affiliates or successors arising out of or related to the performance of the services hereunder by Cardinal, regardless of whether such claim is based upon any of the above stated reasons or otherwise. Results relate only to the samples identified above. This report shall not be reproduced except in full with written approval of Cardinal Laboratories.



Celey D. Keene, Lab Director/Quality Manager

Notes and Definitions

QR-03	The RPD value for the sample duplicate or MS/MSD was outside if QC acceptance limits due to matrix interference. QC batch accepted based on LCS and/or LCSD recovery and/or RPD values.
ND	Analyte NOT DETECTED at or above the reporting limit
RPD	Relative Percent Difference
**	Samples not received at proper temperature of 6°C or below.
***	Insufficient time to reach temperature.
-	Chloride by SM4500Cl-B does not require samples be received at or below 6°C Samples reported on an as received basis (wet) unless otherwise noted on report

Cardinal Laboratories

*=Accredited Analyte

PLEASE NOTE: Liability and Damages. Cardinal's liability and client's exclusive remedy for any claim arising, whether based in contract or tort, shall be limited to the amount paid by client for analyses. All claims, including those for negligence and any other cause whatsoever shall be deemed waived unless made in writing and received by Cardinal within thirty (30) days after completion of the applicable service. In no event shall Cardinal be liable for incidental or consequential damages, including, without limitation, business interruptions, loss of use, or loss of profits incurred by client, its subsidiaries, affiliates or successors arising out of or related to the performance of the services hereunder by Cardinal, regardless of whether such claim is based upon any of the above stated reasons or otherwise. Results relate only to the samples identified above. This report shall not be reproduced except in full with written approval of Cardinal Laboratories.



Celey D. Keene, Lab Director/Quality Manager

101 East Marland, Hobbs, NM 88240
(505) 393-2326 FAX (505) 393-2476

CHAIN-OF-CUSTODY AND ANALYSIS REQUEST

[illegible]

From: Bratcher, Mike, EMNRD
To: [Cliff Brunson](#); [Amber Groves](#)
Cc: [Patterson, Heather, EMNRD](#); [Robert Grubbs](#); [Ken Swinney](#); [Jennifer Gilkey](#); [Kathy Purvis](#); [Weaver, Crystal, EMNRD](#)
Subject: RE: COG Tex-Mack #202 - Remediation Plan
Date: Tuesday, November 29, 2016 2:51:36 PM

RE: COG * TEX-MACK 202 * **2RP-3768** * DOR: 6/29/16

Cliff,

Your proposal for remediation of the above referenced release is approved. Please advise once remedial activities have been scheduled.

OCD approval does not relieve the operator of liability should their operations fail to adequately investigate and remediate contamination that may pose a threat to ground water, surface water, human health or the environment. In addition, OCD approval does not relieve the operator of responsibility for compliance with any other federal, state, local laws and/or regulations.

If you have any questions or concerns, and for notification, please contact me.

Mike Bratcher
NMOCD District 2
811 S. First Street
Artesia, NM 88210
O: 575-748-1283 X108
C: 575-626-0857
F: 575-748-9720

From: Cliff Brunson [mailto:cbrunson@bbcinternational.com]
Sent: Monday, November 21, 2016 8:24 AM
To: Bratcher, Mike, EMNRD; Amber Groves
Cc: Patterson, Heather, EMNRD; Robert Grubbs; Ken Swinney; Jennifer Gilkey; Kathy Purvis
Subject: COG Tex-Mack #202 - Remediation Plan

Mike and Amber,

This e-mail is to confirm our discussion concerning the remediation plan for the COG Tex-Mack #202 release. I have attached the information packet that we used in our discussion with a cover page describing the remediation plan that we agreed upon.

If you would please reply via e-mail with your concurrence on this plan, it would be greatly appreciated.

Thanks, Cliff

Cliff P. Brunson, CEI, CRS
President
BBC International, Inc.
World-Wide Environmental Specialists
Mailing Address:
P. O. Box 805
Hobbs, NM 88241-0805 USA
Shipping Address:
1324 W. Marland St.
Hobbs, NM 88240 USA
Phone: (575) 397-6388
Fax: (575) 397-0397
E-Mail: cbrunson@bbcinternational.com



Confidentiality Notice: This electronic transmission (and any attached documents) is intended only for the person(s) to whom it is addressed and may contain information that is privileged, confidential, or otherwise protected from disclosure. If you have received this transmission in error, please immediately notify the sender by e-mail or by telephone call to (575) 397-6388 for handling instructions. Any disclosure or distribution of the contents of this transmission by anyone other than the named recipient(s) is strictly prohibited.









