

District I
1625 N. French Dr., Hobbs, NM 88240
District II
811 S. First St., Artesia, NM 88210
District III
1000 Rio Brazos Road, Aztec, NM 87410
District IV
1220 S. St. Francis Dr., Santa Fe, NM 87505

State of New Mexico
Energy Minerals and Natural
Resources Department

Oil Conservation Division
1220 South St. Francis Dr.
Santa Fe, NM 87505

Form C-141
Revised August 24, 2018
Submit to appropriate OCD District office

Incident ID	
District RP	
Facility ID	
Application ID	

Release Notification

Responsible Party

Responsible Party: Cimarex Energy Co. of Colorado	OGRID: 162683
Contact Name: Gloria Garza	Contact Telephone: 432.234.3204
Contact email: ggarza@cimarex.com	Incident # (assigned by OCD) NVV2003154113
Contact mailing address: 600 N Marienfeld Suite 600 Midland, TX 79701	

Location of Release Source

Latitude 32.498653 Longitude -103.655598
(NAD 83 in decimal degrees to 5 decimal places)

Site Name: Hat Mesa 10 Federal Com 2H	Site Type: Battery
Date Release Discovered: 1/23/2020	API# (if applicable) 30-025-40365

Unit Letter	Section	Township	Range	County
A	10	21S	32E	Lea

Surface Owner: ☐ State ☒ Federal ☐ Tribal ☐ Private (Name: _____)

Nature and Volume of Release

Material(s) Released (Select all that apply and attach calculations or specific justification for the volumes provided below)

<input checked="" type="checkbox"/> Crude Oil	Volume Released (bbls) 10 bbls	Volume Recovered (bbls) 10 bbls
<input checked="" type="checkbox"/> Produced Water	Volume Released (bbls) 13 bbls	Volume Recovered (bbls) 13 bbls
	Is the concentration of dissolved chloride in the produced water >10,000 mg/l?	<input type="checkbox"/> Yes <input type="checkbox"/> No
<input type="checkbox"/> Condensate	Volume Released (bbls)	Volume Recovered (bbls)
<input type="checkbox"/> Natural Gas	Volume Released (Mcf)	Volume Recovered (Mcf)
<input type="checkbox"/> Other (describe)	Volume/Weight Released (provide units)	Volume/Weight Recovered (provide units)

Cause of Release: A hole developed on the fire tube section of the heater treater due to corrosion.

All fluids released were contained inside of the lined containment and we recovered all fluids.
Pictures are attached identifying the containment is intact and holding fluid.
Update 2.4.2020 - pictures are attached showing containment is clean and intact.

State of New Mexico
Oil Conservation Division

Incident ID	
District RP	
Facility ID	
Application ID	

<p>Was this a major release as defined by 19.15.29.7(A) NMAC?</p> <p><input checked="" type="checkbox"/> Yes <input type="checkbox"/> No</p>	<p>If YES, for what reason(s) does the responsible party consider this a major release?</p> <p>The amount of fluid released was more than 25 barrels.</p>
<p>If YES, was immediate notice given to the OCD? By whom? To whom? When and by what means (phone, email, etc)?</p> <p>Gloria Garza reported the release to District 1 OCD, Jim Griswold and BLM on Friday January 24, 2020 by email.</p>	

Initial Response

The responsible party must undertake the following actions immediately unless they could create a safety hazard that would result in injury

<p><input checked="" type="checkbox"/> The source of the release has been stopped.</p> <p><input checked="" type="checkbox"/> The impacted area has been secured to protect human health and the environment.</p> <p><input checked="" type="checkbox"/> Released materials have been contained via the use of berms or dikes, absorbent pads, or other containment devices.</p> <p><input checked="" type="checkbox"/> All free liquids and recoverable materials have been removed and managed appropriately.</p>	
<p>If all the actions described above have <u>not</u> been undertaken, explain why:</p>	
<p>Per 19.15.29.8 B. (4) NMAC the responsible party may commence remediation immediately after discovery of a release. If remediation has begun, please attach a narrative of actions to date. If remedial efforts have been successfully completed or if the release occurred within a lined containment area (see 19.15.29.11(A)(5)(a) NMAC), please attach all information needed for closure evaluation.</p>	
<p>I hereby certify that the information given above is true and complete to the best of my knowledge and understand that pursuant to OCD rules and regulations all operators are required to report and/or file certain release notifications and perform corrective actions for releases which may endanger public health or the environment. The acceptance of a C-141 report by the OCD does not relieve the operator of liability should their operations have failed to adequately investigate and remediate contamination that pose a threat to groundwater, surface water, human health or the environment. In addition, OCD acceptance of a C-141 report does not relieve the operator of responsibility for compliance with any other federal, state, or local laws and/or regulations.</p>	
<p>Printed Name: <u>Gloria Garza</u></p> <p>Signature: <u></u></p> <p>email: <u>ggarza@cimarex.com</u></p>	<p>Title: <u>ESH Specialist</u></p> <p>Date: <u>3/3/2020</u></p> <p>Telephone: <u>432.234.3204</u></p>
<p><u>OCD Only</u></p> <p>Received by: _____ Date: _____</p>	

State of New Mexico
Oil Conservation Division

Incident ID	
District RP	
Facility ID	
Application ID	

Site Assessment/Characterization

This information must be provided to the appropriate district office no later than 90 days after the release discovery date.

What is the shallowest depth to groundwater beneath the area affected by the release?	52 _____ (ft bgs)
Did this release impact groundwater or surface water?	<input type="checkbox"/> Yes <input checked="" type="checkbox"/> No
Are the lateral extents of the release within 300 feet of a continuously flowing watercourse or any other significant watercourse?	<input type="checkbox"/> Yes <input checked="" type="checkbox"/> No
Are the lateral extents of the release within 200 feet of any lakebed, sinkhole, or playa lake (measured from the ordinary high-water mark)?	<input type="checkbox"/> Yes <input checked="" type="checkbox"/> No
Are the lateral extents of the release within 300 feet of an occupied permanent residence, school, hospital, institution, or church?	<input type="checkbox"/> Yes <input checked="" type="checkbox"/> No
Are the lateral extents of the release within 500 horizontal feet of a spring or a private domestic fresh water well used by less than five households for domestic or stock watering purposes?	<input type="checkbox"/> Yes <input checked="" type="checkbox"/> No
Are the lateral extents of the release within 1000 feet of any other fresh water well or spring?	<input type="checkbox"/> Yes <input checked="" type="checkbox"/> No
Are the lateral extents of the release within incorporated municipal boundaries or within a defined municipal fresh water well field?	<input type="checkbox"/> Yes <input checked="" type="checkbox"/> No
Are the lateral extents of the release within 300 feet of a wetland?	<input type="checkbox"/> Yes <input checked="" type="checkbox"/> No
Are the lateral extents of the release overlying a subsurface mine?	<input type="checkbox"/> Yes <input checked="" type="checkbox"/> No
Are the lateral extents of the release overlying an unstable area such as karst geology?	<input type="checkbox"/> Yes <input checked="" type="checkbox"/> No
Are the lateral extents of the release within a 100-year floodplain?	<input type="checkbox"/> Yes <input checked="" type="checkbox"/> No
Did the release impact areas not on an exploration, development, production, or storage site?	<input type="checkbox"/> Yes <input checked="" type="checkbox"/> No

Attach a comprehensive report (electronic submittals in .pdf format are preferred) demonstrating the lateral and vertical extents of soil contamination associated with the release have been determined. Refer to 19.15.29.11 NMAC for specifics.

Characterization Report Checklist: *Each of the following items must be included in the report.*

- ☐ Scaled site map showing impacted area, surface features, subsurface features, delineation points, and monitoring wells.
- ☐ Field data
- ☐ Data table of soil contaminant concentration data
- ☐ Depth to water determination
- ☐ Determination of water sources and significant watercourses within 1/2-mile of the lateral extents of the release
- ☐ Boring or excavation logs
- ☐ Photographs including date and GIS information
- ☐ Topographic/Aerial maps
- ☐ Laboratory data including chain of custody

If the site characterization report does not include completed efforts at remediation of the release, the report must include a proposed remediation plan. That plan must include the estimated volume of material to be remediated, the proposed remediation technique, proposed sampling plan and methods, anticipated timelines for beginning and completing the remediation. The closure criteria for a release are contained in Table 1 of 19.15.29.12 NMAC, however, use of the table is modified by site- and release-specific parameters.

State of New Mexico
Oil Conservation Division

Incident ID	
District RP	
Facility ID	
Application ID	

I hereby certify that the information given above is true and complete to the best of my knowledge and understand that pursuant to OCD rules and regulations all operators are required to report and/or file certain release notifications and perform corrective actions for releases which may endanger public health or the environment. The acceptance of a C-141 report by the OCD does not relieve the operator of liability should their operations have failed to adequately investigate and remediate contamination that pose a threat to groundwater, surface water, human health or the environment. In addition, OCD acceptance of a C-141 report does not relieve the operator of responsibility for compliance with any other federal, state, or local laws and/or regulations.

Printed Name: Gloria Garza Title: ESH Specialist

Signature: gloria garza Date: 3/3/20

email: ggarza@cimarex.com Telephone: 432.571.7800

OCD Only

Received by: Date:

Page 3 of 11
Received by OCD: 3/3/2020 4:45:59 PM

State of New Mexico
Oil Conservation Division

Incident ID	
District RP	
Facility ID	
Application ID	

Closure

The responsible party must attach information demonstrating they have complied with all applicable closure requirements and any conditions or directives of the OCD. This demonstration should be in the form of a comprehensive report (electronic submittals in .pdf format are preferred) including a scaled site map, sampling diagrams, relevant field notes, photographs of any excavation prior to backfilling, laboratory data including chain of custody documents of final sampling, and a narrative of the remedial activities. Refer to 19.15.29.12 NMAC.

Closure Report Attachment Checklist: *Each of the following items must be included in the closure report.*

- ☐ A scaled site and sampling diagram as described in 19.15.29.11 NMAC
- ☐ Photographs of the remediated site prior to backfill or photos of the liner integrity if applicable (Note: appropriate OCD District office must be notified 2 days prior to liner inspection)
- ☐ Laboratory analyses of final sampling (Note: appropriate ODC District office must be notified 2 days prior to final sampling)
- ☐ Description of remediation activities

I hereby certify that the information given above is true and complete to the best of my knowledge and understand that pursuant to OCD rules and regulations all operators are required to report and/or file certain release notifications and perform corrective actions for releases which may endanger public health or the environment. The acceptance of a C-141 report by the OCD does not relieve the operator of liability should their operations have failed to adequately investigate and remediate contamination that pose a threat to groundwater, surface water, human health or the environment. In addition, OCD acceptance of a C-141 report does not relieve the operator of responsibility for compliance with any other federal, state, or local laws and/or regulations. The responsible party acknowledges they must substantially restore, reclaim, and re-vegetate the impacted surface area to the conditions that existed prior to the release or their final land use in accordance with 19.15.29.13 NMAC including notification to the OCD when reclamation and re-vegetation are complete.

Printed Name: Gloria Garza _____ Title: ESH Specialist _____
Signature: Gloria Garza _____ Date: 3/3/2020 _____
email: ggarza@cimarex.com _____ Telephone: 432.571.7800

OCD Only

Received by: _____ Date: _____

Closure approval by the OCD does not relieve the responsible party of liability should their operations have failed to adequately investigate and remediate contamination that poses a threat to groundwater, surface water, human health, or the environment nor does not relieve the responsible party of compliance with any other federal, state, or local laws and/or regulations.

Closure Approved by: _____ Date: _____

Printed Name: _____ Title: _____

SW

W

NW

N

210

240

270

300

330

0

☉ 277°W (T) LAT: 32.498655 LON: -103.655151 ±16ft ▲ 3785ft

CIMAREX ENERGY CO.

HAT MESA 10 FED #2

SEC. 10, T21S, R32E

660' FNL & 330' FEL

API #30-025-40365

LEA CO., NM

NM-362177

● Hat Mesa

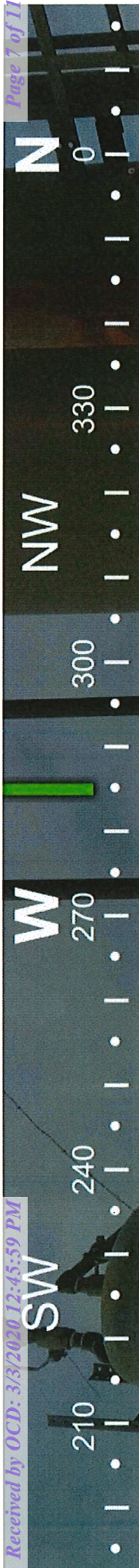

☉ 285°W (T) LAT: 32.498644 LON: -103.655562 ±16ft ▲ 3794ft



SW

W

NW

N

210

240

270

300

330

0

☉ 277°W (T) LAT: 32.498640 LON: -103.655588 ±16ft ▲ 3792ft





☉ 6°N (T) LAT: 32.498588 LON: -103.655603 ±16ft ▲ 3792ft



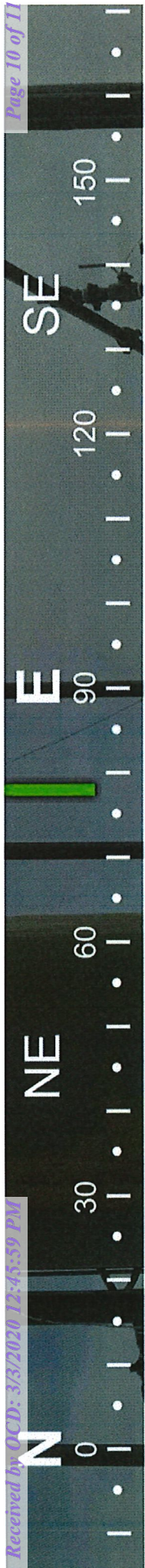

☉ 78°E (T) LAT: 32.498629 LON: -103.655615 ±16ft ▲ 3793ft



E

SE

S

SW

90

120

150

180

210

240

☉ 164°S (T) LAT: 32.498693 LON: -103.655612 ±16ft ▲ 3793ft

