

1625 N. French Dr., Hobbs, NM 88240  
District II  
1301 W. Grand Avenue, Artesia, NM 88210  
District III  
1000 Rio Brazos Road, Aztec, NM 87410  
District IV  
1220 S. St. Francis Dr., Santa Fe, NM 87505

Energy Minerals and Natural Resources

Oil Conservation Division  
1220 South St. Francis Dr.  
Santa Fe, NM 87505

RECEIVED

SEP 14 2004

OCD-ARTESIA

Form C-101  
March 4, 2004

Submit to appropriate District Office  
State Lease - 6 Copies  
Fee Lease - 5 Copies

☐ AMENDED REPORT

**APPLICATION FOR PERMIT TO DRILL, RE-ENTER, DEEPEN, PLUGBACK, OR ADD A ZONE**

<sup>1</sup> Operator Name and Address Yates Petroleum Corporation 105 South Fourth Street Artesia, NM 88210		<sup>2</sup> OGRID Number 025575 API Number 30-005-63431	
<sup>3</sup> Property Code 12706	<sup>5</sup> Property Name Sacra SA		<sup>6</sup> Well No. 20

**7 Surface Location**

UL or lot no.	Section	Township	Range	Lot Idn	Feet from the	North/South line	Feet from the	East/West line	County
J	35	6S	25E		1980'	South	1980'	East	Chaves

**8 Proposed Bottom Hole Location If Different From**

UL or lot no.	Section	Township	Range	Lot Idn	Feet from the	North/South line
<sup>9</sup> Proposed Pool 1 Cottonwood Ranch Penn						

NOTIFY OCD OF SPUD & TIME TO WITNESS CEMENTING OF SURFACE & INTERMEDIATE CASING

**Drilling Pit Location and Other Information**

UL or lot no.	Section	Township	Range	Lot Idn	Feet from the	North/South line	Feet from the	East/West line	County
N	35	6S	25E		1980'	South	1980'	East	Chaves
Depth to ground water N/A				Distance from nearest fresh water well N/A			Distance from nearest surface water N/A		
<sup>11</sup> Work Type Code N		<sup>12</sup> Well Type Code G		<sup>13</sup> Cable/Rotary Rotary		<sup>14</sup> Lease Type Code P		<sup>15</sup> Ground Level Elevation 3698'	
<sup>16</sup> Multiple No		<sup>17</sup> Proposed Depth 5220'		<sup>18</sup> Formation Granite Wash		<sup>19</sup> Contractor Not determined		<sup>20</sup> Spud Date ASAP	

**21 Proposed Casing and Cement Program**

Hole Size	Casing Size	Casing weight/foot	Setting Depth	Sacks of Cement	Estimated TOC
14 3/4	11 3/4	42	900'	550	Surface
11	8 5/8	24	1500'	250	Surface
7 7/8	5 1/2	15.5	5220'	500	TOC-3100***

22 Describe the proposed program. If this application is to DEEPEN or PLUG BACK, give the data on the present productive zone and proposed new productive zone. Describe the blowout prevention program, if any. Use additional sheets if necessary.

\*8 5/8" will only be set if lost circulation is encountered. \*\* Cement to cover all oil, gas and water bearing zones.

Yates Petroleum Corporation proposes to drill and test the Granite Wash/Intermediate formations. Approximately 900' of surface casing will be set and cement circulated to shut off gravel and cavings. If commercial, production casing will be run and cemented, perforate and stimulate as needed for production. **MUD PROGRAM:** 0-900' FW/Gel/Paper/LCM; 900'-3600' Cut Brine/Brine; 3600'-5220' Starch/Salt Gel. **BOPE PROGRAM:** A 2000# BOPE will be installed on the 11 3/4" casing and tested daily for operational.

The State Engineers Web Site has been accessed for the captioned well. There were no records found of ground water depth, water well, or any indication of any surface water in the area surrounding this well location.

Sources at Yates Petroleum Corporation have relayed information to me that they believe there will not be enough H2S anticipated from the surface to the Granite Wash Formation to even meet the OCD's minimum requirements for the submission of a contingency plan per Rule 118.

23 I hereby certify that the information given above is true and complete to the best of my knowledge and belief. I further certify that the drilling pit will be constructed according to NMOC guidelines ☐, a general permit ☒, or an (attached) alternative OCD-approved plan ☐.

Signature:



Printed name: Robert Asher

Title: Regulatory Agent

E-mail Address: debbiec@ypcn.com

Date: September 10, 2004

Phone: (505) 748-1471

OIL CONSERVATION DIVISION

Approved by:

TIM W. GUM

DISTRICT II SUPERVISOR

Title:  
Approval Date: SEP 15 2004 Expiration Date: SEP 15 2005

Conditions of Approval:  
Attached ☐

CEMENT TO COVER ALL OIL,  
GAS AND WATER BEARING  
ZONES

**District I**

1625 N. French Dr., Hobbs, NM 88240

**District II**

811 South First, Artesia, NM 88210

**District III**

1000 Rio Brazos Rd., Aztec, NM 87410

**District IV**

1220 S. St. Francis Dr., Santa Fe, NM 87505

State of New Mexico

Energy, Minerals &amp; Natural Resources Department

Form C-102

Revised August 15, 2000

## OIL CONSERVATION DIVISION

1220 South St. Francis Dr.

Santa Fe, NM 87505

Submit to Appropriate District Office

State Lease - 4 Copies

Fee Lease - 3 Copies

☐

AMENDED REPORT

## WELL LOCATION AND ACREAGE DEDICATION PLAT

<sup>1</sup> API Number		<sup>2</sup> Pool Code		<sup>3</sup> Pool Name <b>Cotton Ranch Penn</b>	
<sup>4</sup> Property Code		<sup>5</sup> Property Name <b>Sacra "SA"</b>			<sup>6</sup> Well Number <b>20</b>
<sup>7</sup> OGRID No. <b>025575</b>		<sup>8</sup> Operator Name <b>Yates Petroleum Corporation</b>			<sup>9</sup> Elevation <b>3698</b>

<sup>10</sup> Surface Location

UL or lot no. <b>J</b>	Section <b>35</b>	Township <b>6S</b>	Range <b>25E</b>	Lot Idn	Feet from the <b>1980</b>	North/South line <b>South</b>	Feet from the <b>1980</b>	East/West line <b>East</b>	County <b>Chaves</b>
---------------------------	----------------------	-----------------------	---------------------	---------	------------------------------	----------------------------------	------------------------------	-------------------------------	-------------------------

<sup>11</sup> Bottom Hole Location If Different From Surface

UL or lot no.	Section	Township	Range	Lot Idn	Feet from the	North/South line	Feet from the	East/West line	County
<sup>12</sup> Dedicated Acres <b>320</b>		<sup>13</sup> Joint or Infill		<sup>14</sup> Consolidation Code		<sup>15</sup> Order No.			

NO ALLOWABLE WILL BE ASSIGNED TO THIS COMPLETION UNTIL ALL INTERESTS HAVE BEEN CONSOLIDATED OR A NON-STANDARD UNIT HAS BEEN APPROVED BY THE DIVISION

<sup>16</sup>				<sup>17</sup> OPERATOR CERTIFICATION	
				I hereby certify that the information contained herein is true and complete to the best of my knowledge and belief.	
					
				Signature	
				<b>Robert Asher</b>	
				Printed Name	
				<b>Regulatory Agent</b>	
				Title	
				<b>09/01/2004</b>	
				Date	
				<sup>18</sup> SURVEYOR CERTIFICATION	
				I hereby certify that the well location shown on this plat was plotted from field notes of actual surveys made by me or under my supervision, and that the same is true and correct to the best of my belief.	
				REFER TO ORIGINAL PLAT	
				Date of Survey	
				Signature and Seal of Professional Surveyor:	
				Certificate Number	

Sacra "SA" #3		Fee		1980'	
660'		660'		1980'	
660'		330'		660'	
				Sacra "SA" #4	



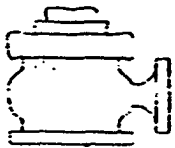

# Yates Petroleum Corporation

BOP-2

## Typical 2,000 psi Pressure System Schematic Double Ram Preventer Stack

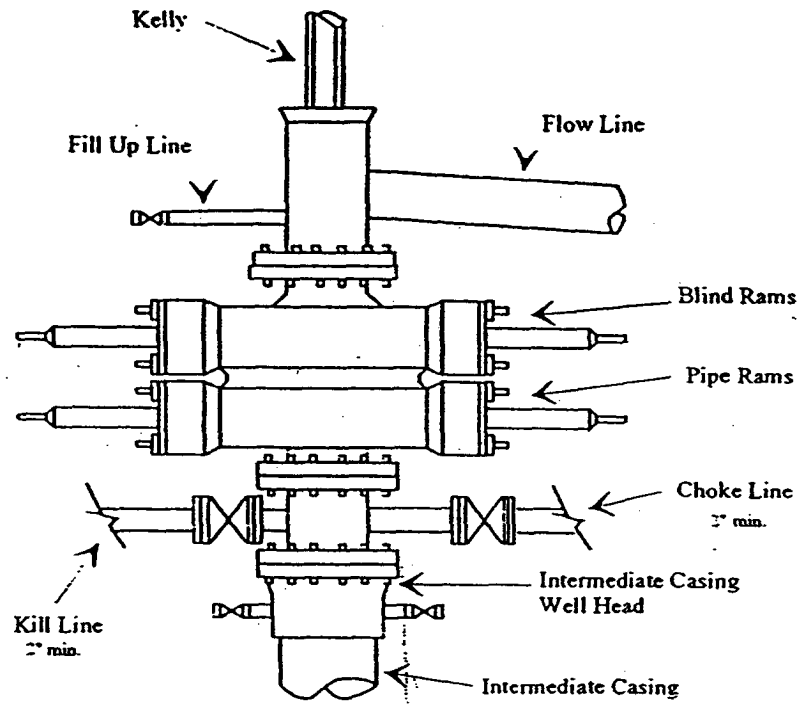

Typical 2,000 psi choke manifold assembly with at least these minimum features

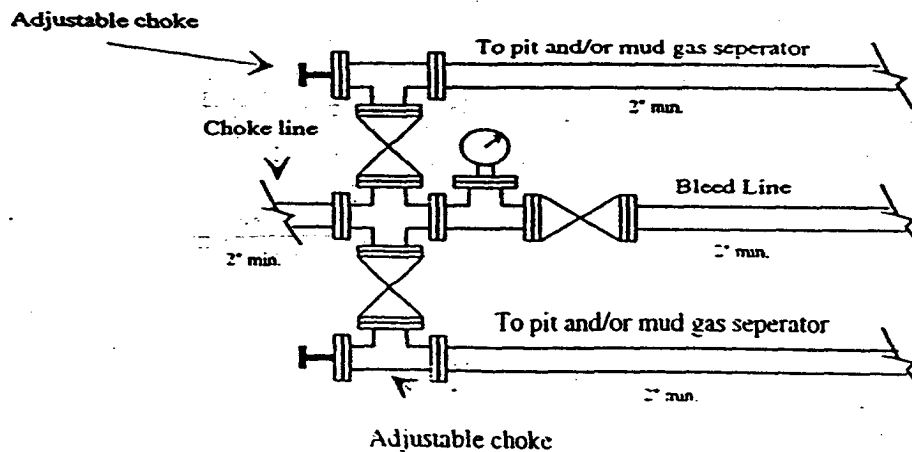

SECTION 35, TOWNSHIP 6 SOUTH, RANGE 25 EAST, NMPM, CHAVES COUNTY, NEW MEXICO.

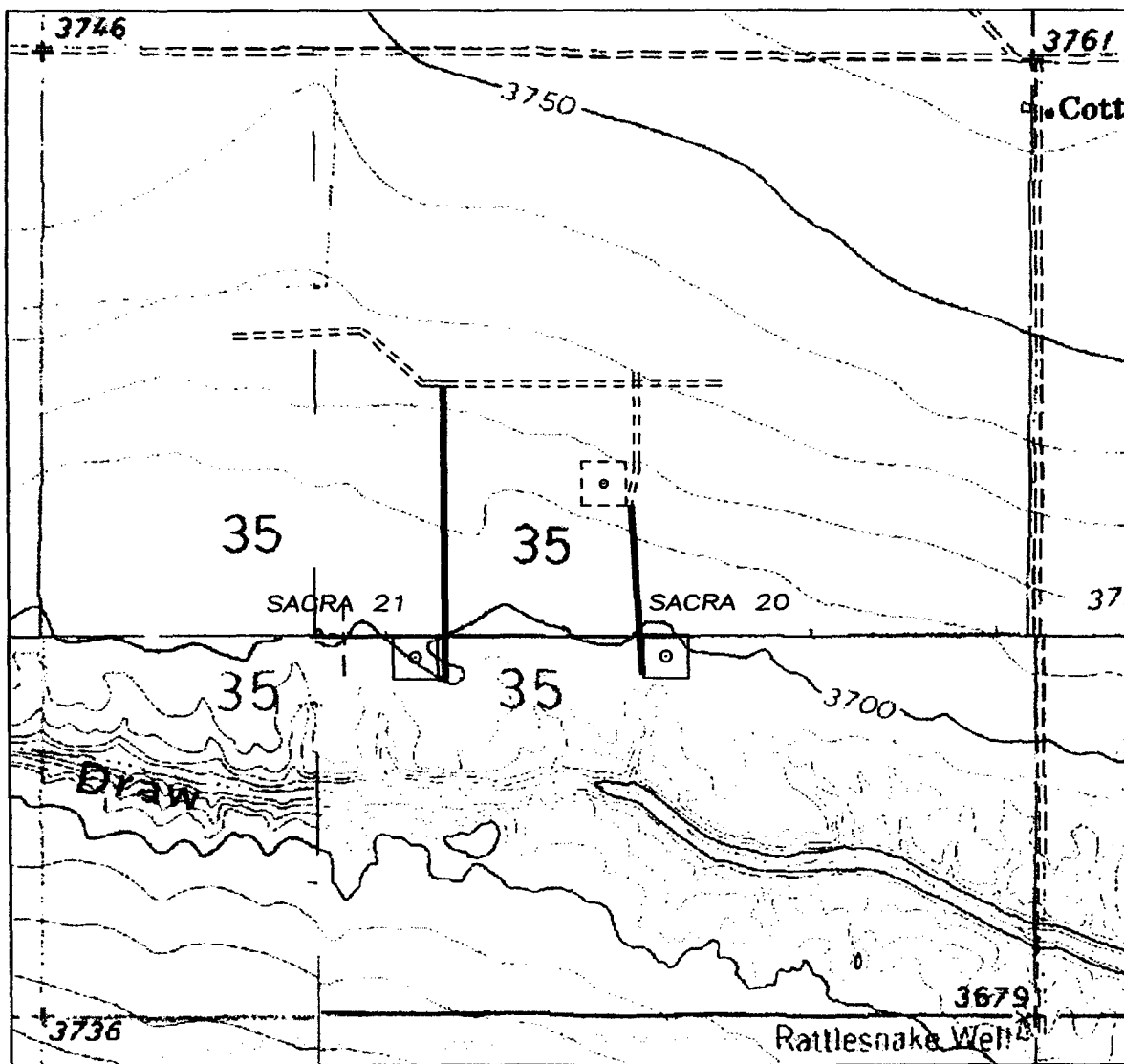

1000' 0 1000' 2000'  
Scale 1" = 1000'

THE PREPARATION OF THIS PLAT AND THE PERFORMANCE OF THE SURVEY UPON WHICH IT IS BASED WERE DONE UNDER MY DIRECTION AND THE PLAT ACCURATELY DEPICTS THE RESULTS OF SAID SURVEY AND MEET THE REQUIREMENTS OF THE STANDARDS FOR LAND SURVEYS IN NEW MEXICO AS ADOPTED BY THE NEW MEXICO STATE BOARD OF REGISTRATION FOR PROFESSIONAL ENGINEERS AND LAND SURVEYORS.

3640  
HERSCHEL L. JONES R.L.S. No. 3640

GENERAL SURVEYING COMPANY P.O. BOX 1928  
LOVINGTON, NEW MEXICO 88260

## YATES PETROLEUM CORP.

LEASE ROAD TO ACCESS THE YATES SACRA  
"SA" #20 & 21, LOCATED IN SECTION 35,  
TOWNSHIP 6 SOUTH, RANGE 25 EAST, NMPM,  
CHAVES COUNTY, NEW MEXICO.

Survey Date: 10/11/2001	Sheet 1 of 1 Sheets
Drawn By: Ed Blevins	W.O. Number
Date: 10/12/01	Scale 1" = 1000' SACRA