



UNITED STATES
DEPARTMENT OF THE INTERIOR
BUREAU OF LAND MANAGEMENT

APPLICATION FOR PERMIT TO DRILL OR REENTER

1a. Type of Work: <input checked="" type="checkbox"/> DRILL <input type="checkbox"/> REENTER		5. Lease Serial No. NMNM12211
1b. Type of Well: <input type="checkbox"/> Oil Well <input checked="" type="checkbox"/> Gas Well <input type="checkbox"/> Other <input checked="" type="checkbox"/> Single Zone <input type="checkbox"/> Multiple Zone		6. If Indian, Allottee or Tribe Name
2. Name of Operator MARBOB ENERGY CORPORATION		7. If Unit or CA Agreement, Name and No.
Contact: MELANIE PARKER E-Mail: marbob@marbob.com		8. Lease Name and Well No. BLIND SQUIRREL FEDERAL 1
3a. Address P O BOX 227 ARTESIA, NM 88211-0227	3b. Phone No. (include area code) Ph: 505.748.3303 Fx: 505.746.2523	9. API Well No. 30-015-33672
4. Location of Well (Report location clearly and in accordance with any State requirements. *) At surface NWSW 1980FSL 990FWL At proposed prod. zone NWSW 1980FSL 990FWL		10. Field and Pool, or Exploratory SHUGART-MORROW
14. Distance in miles and direction from nearest town or post office*		11. Sec., T., R., M., or Blk. and Survey or Area Sec 33 T18S R31E Mer NMP
15. Distance from proposed location to nearest property or lease line, ft. (Also to nearest drig. unit line, if any)		12. County or Parish EDDY
16. No. of Acres in Lease 680.00		13. State NM
17. Spacing Unit dedicated to this well 320.00		
18. Distance from proposed location to nearest well, drilling, completed, applied for, on this lease, ft.		20. BLM/BIA Bond No. on file
19. Proposed Depth 12400 MD		
21. Elevations (Show whether DF, KB, RT, GL, etc.) 3592 GL		23. Estimated duration 21 DAYS
22. Approximate date work will start 09/26/2004		

RECEIVED

SEP 29 2004

24. Attachments

CAPITAN CONTROLLED WATER BASIN

The following, completed in accordance with the requirements of Onshore Oil and Gas Order No. 1, shall be attached to this form:

- Well plat certified by a registered surveyor.
- A Drilling Plan.
- A Surface Use Plan (if the location is on National Forest System Lands, the SUPO shall be filed with the appropriate Forest Service Office).
- Bond to cover the operations unless covered by an existing bond on file (see Item 20 above).
- Operator certification
- Such other site specific information and/or plans as may be required by the authorized officer.

25. Signature (Electronic Submission)	Name (Printed/Typed) MELANIE PARKER	Date 08/26/2004
Title AUTHORIZED REPRESENTATIVE		
Approved by (Signature) /s/ Joe G. Lara	Name (Printed/Typed) /s/ Joe G. Lara	Date SEP 27 2004
Title FIELD MANAGER		
Office CARLSBAD FIELD OFFICE		

Application approval does not warrant or certify the applicant holds legal or equitable title to those rights in the subject lease which would entitle the applicant to conduct operations thereon.

Conditions of approval, if any, are attached.

APPROVAL FOR 1 YEAR

Title 18 U.S.C. Section 1001 and Title 43 U.S.C. Section 1212, make it a crime for any person knowingly and willfully to make to any department or agency of the United States any false, fictitious or fraudulent statements or representations as to any matter within its jurisdiction.

Additional Operator Remarks (see next page)

Electronic Submission #34829 verified by the BLM Well Information System

For MARBOB ENERGY CORPORATION, sent to the Carlsbad

Committed to AFMSS for processing by ARMANDO LOPEZ on 08/27/2004 (04AL0344AE)

APPROVAL SUBJECT TO
GENERAL REQUIREMENTS
AND SPECIAL STIPULATIONS
ATTACHED

** BLM REVISED ** BLM REVISED ** BLM REVISED ** BLM REVISED ** BLM REVISED **

District I
1625 N. French Dr., Hobbs, NM 88240
District II
1301 W. Grand Avenue, Artesia, NM 88210
District III
1000 Rio Brazos Road, Aztec, NM 87410
District IV
1220 S. St. Francis Dr., Santa Fe, NM 87505

State of New Mexico
Energy Minerals and Natural Resources

Oil Conservation Division
1220 South St. Francis Dr.
Santa Fe, NM 87505

Form C-144
March 12, 2004

For drilling and production facilities, submit to
appropriate NMOCD District Office.
For downstream facilities, submit to Santa Fe
office

Pit or Below-Grade Tank Registration or Closure

Is pit or below-grade tank covered by a "general plan"? Yes ☒ No ☐

Type of action: Registration of a pit or below-grade tank ☒ Closure of a pit or below-grade tank ☐

Operator: **Marbob Energy Corporation**

Telephone: **505-748-3303**

e-mail address: **marbob@marbob.com**

Address: **PO Box 227, Artesia, NM 88211-0227**

Facility or well name: **Blind Squirrel Federal No. 1**

API #: _____ U/L or Qtr/Qtr **NWSW** Sec **33** T **18S** R **31E**

County: **Eddy**

Latitude _____ Longitude _____

NAD: 1927 ☐ 1983 ☐ Surface Owner Federal ☒ State ☐ Private ☐ Indian ☐

Pit

Type: Drilling ☒ Production ☐ Disposal ☐

Workover ☐ Emergency ☐

Lined ☒ Unlined ☐

Liner type: Synthetic ☒ Thickness **12** mil Clay ☐ Volume

_____ bbl

Below-grade tank

Volume: _____ bbl Type of fluid: _____

Construction material: _____

Double-walled, with leak detection? Yes ☐ If not, explain why not.

Depth to ground water (vertical distance from bottom of pit to seasonal high water elevation of ground water.)

Less than 50 feet

50 feet or more, but less than 100 feet

☒ 100 feet or more

(20 points)

(10 points)

(0 points) **0 points**

Wellhead protection area: (Less than 200 feet from a private domestic water source, or less than 1000 feet from all other water sources.)

Yes

☒ No

(20 points)

(0 points) **0 points**

Distance to surface water: (horizontal distance to all wetlands, playas, irrigation canals, ditches, and perennial and ephemeral watercourses.)

Less than 200 feet

200 feet or more, but less than 1000 feet

☒ 1000 feet or more

(20 points)

(10 points)

(0 points) **0 points**

Ranking Score (Total Points)

0 points

If this is a pit closure: (1) attach a diagram of the facility showing the pit's relationship to other equipment and tanks. (2) Indicate disposal location:

onsite ☐ offsite ☐ If offsite, name of facility _____

(3) Attach a general description of remedial action taken including remediation start date and end date. (4) Groundwater encountered: No ☐ Yes ☐ If yes, show depth below ground surface _____ ft. and attach sample results. (5) Attach soil sample results and a diagram of sample locations and excavations.

I hereby certify that the information above is true and complete to the best of my knowledge and belief. I further certify that the above-described pit or below-grade tank has been/will be constructed or closed according to NMOCD guidelines ☐, a general permit ☒, or an (attached) alternative OCD-approved plan ☐.

Date: **October 19, 2004**

Printed Name/Title: **Melanie J. Parker / Land Department**

Signature: 

Your certification and NMOCD approval of this application/closure does not relieve the operator of liability should the contents of the pit or tank contaminate ground water or otherwise endanger public health or the environment. Nor does it relieve the operator of its responsibility for compliance with any other federal, state, or local laws and/or regulations.

Approval:

Date: **OCT 19 2004**

Printed Name/Title: _____

Signature: 

DISTRICT I
1225 N. FRANCH DR., BOHNS, NM 88240

DISTRICT II
1301 W. GRAND AVENUE, ARTESIA, NM 88210

DISTRICT III
1000 Rio Brazos Rd., Aztec, NM 87410

DISTRICT IV
1225 S. ST. FRANCIS DR., SANTA FE, NM 87505

State of New Mexico
Energy, Minerals and Natural Resources Department

OIL CONSERVATION DIVISION
1220 SOUTH ST. FRANCIS DR.
Santa Fe, New Mexico 87505

Form C-102
Revised JUNE 10, 2003
Submit to Appropriate District Office
State Lease - 4 Copies
Fee Lease - 3 Copies

WELL LOCATION AND ACREAGE DEDICATION PLAT

☐ AMENDED REPORT

API Number	Pool Code 85300	Pool Name Shugart Morrow (Gas)
Property Code	Property Name BLIND SQUIREL FEDERAL	Well Number 1
OCRD No. 14049	Operator Name MARBOB ENERGY CORPORATION	Elevation 3592'

Surface Location

UL or lot No.	Section	Township	Range	Lot Idn	Feet from the	North/South line	Feet from the	East/West line	County
L	33	18-S	31-E		1980'	SOUTH	990'	WEST	EDDY

Bottom Hole Location If Different From Surface

UL or lot No.	Section	Township	Range	Lot Idn	Feet from the	North/South line	Feet from the	East/West line	County
Dedicated Acres 320	Joint or Infill	Consolidation Code	Order No.						

NO ALLOWABLE WILL BE ASSIGNED TO THIS COMPLETION UNTIL ALL INTERESTS HAVE BEEN CONSOLIDATED
OR A NON-STANDARD UNIT HAS BEEN APPROVED BY THE DIVISION

	<p>OPERATOR CERTIFICATION</p> <p>I hereby certify the the information contained herein is true and complete to the best of my knowledge and belief.</p> <p><i>Melanie J. Parker</i> Signature</p> <p>Melanie J. Parker Printed Name</p> <p>Land Department Title</p> <p>08/18/04 Date</p> <p>SURVEYOR CERTIFICATION</p> <p>I hereby certify that the well location shown on this plat was plotted from field notes of actual surveys made by me or under my supervision, and that the same is true and correct to the best of my belief.</p> <p>JULY 1, 2004</p> <p>Date Surveyed</p> <p><i>Melanie J. Parker</i> Signature</p> <p>Professional Surveyor</p> <p>NEW MEXICO 04.11.0827 7/7/04</p> <p>Certificate No. 6024 EDDY 12841</p>
--	---

LOCATION VERIFICATION MAP

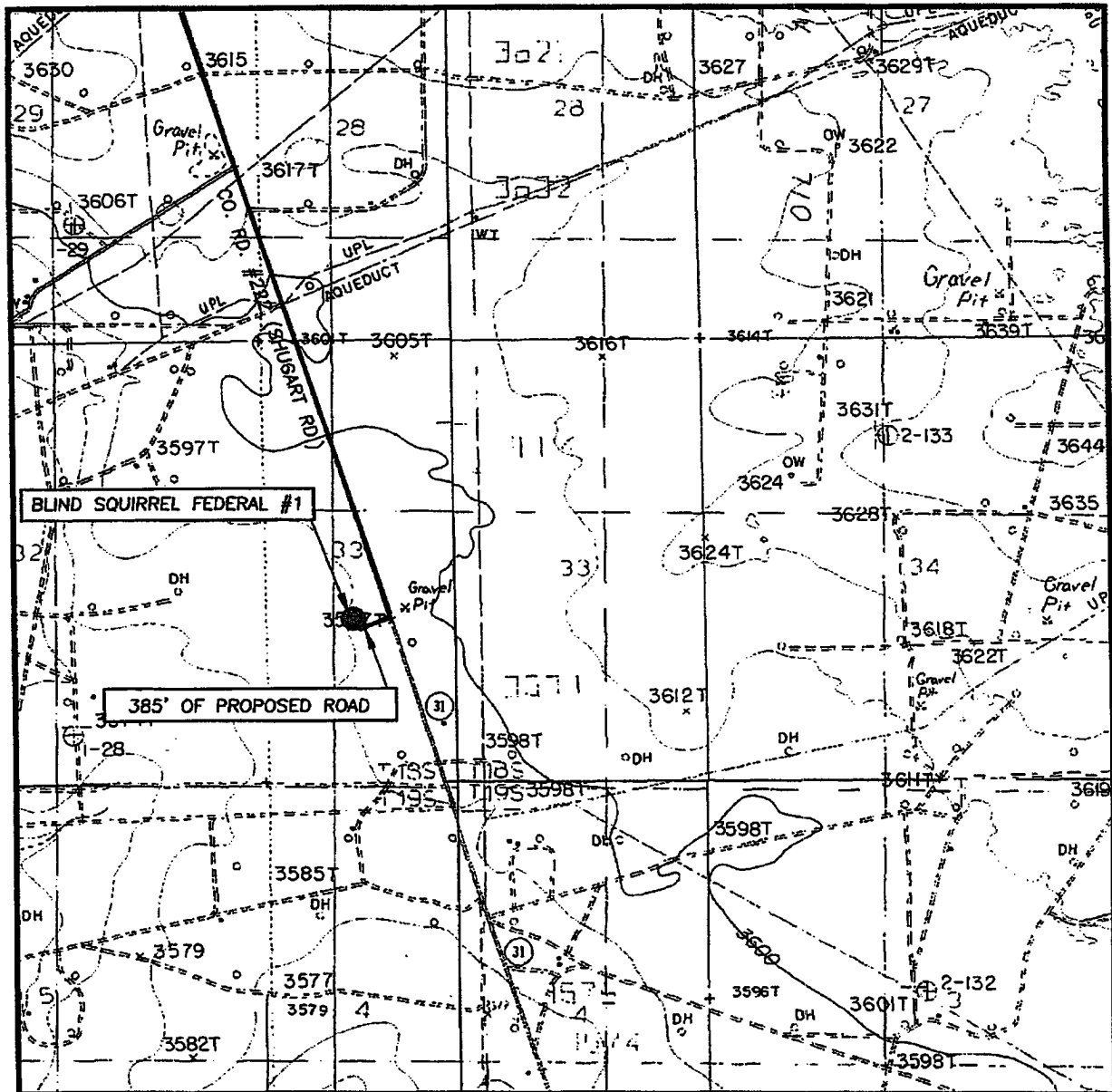

SCALE: 1" = 2000'

CONTOUR INTERVAL:
GREENWOOD LAKE, N.M. - 10'

SEC. 33 TWP. 18-S RGE. 31-E

SURVEY N.M.P.M.

COUNTY EDDY

DESCRIPTION 1980' FSL & 990' FWL

ELEVATION 3592'

OPERATOR MARBOB ENERGY CORPORATION

LEASE BLIND SQUIRREL FEDERAL

U.S.G.S. TOPOGRAPHIC MAP
GREENWOOD LAKE, N.M.

— Road

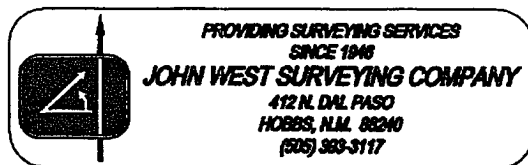

Exhibit Two

MARBOB ENERGY CORPORATION
DRILLING AND OPERATIONS PROGRAM

Blind Squirrel Federal #1
1980' FSL & 990' FWL, Unit L
Section 33, T18S, R31E
Eddy County, New Mexico

In conjunction with Form 3160-3, Application for Permit to Drill subject well, Marbob Energy Corporation submits the following ten items of pertinent information in accordance with BLM requirements.

1. The geological surface formation is Permian.
2. The estimated tops of geologic markers are as follows:

Rustler	664'	Delaware	4340'
Top of Salt	850'	Bone Spring	6500'
Base of Salt	2220'	Wolfcamp	9900'
Yates	2700'	Strawn	10800'
Queen	3330'	Atoka	11150'
San Andres	4070'	Morrow	11750'
		TD	12400'

3. The estimated depths at which anticipated water, oil or gas formations are expected to be encountered:

Yates	2700'	Oil
Queen	3330'	Oil
Delaware	4340'	Oil
Bone Spring	6500'	Oil
Wolfcamp	9900'	Oil
Strawn	10800'	Oil
Atoka	11150'	Gas
Morrow	11750'	Gas

No other formations are expected to give up oil, gas, or fresh water in measurable quantities. The surface fresh water sands will be protected by setting 13 3/8" casing at 700' and circulating cement back to surface. Any shallower zones above TD which contain commercial quantities of oil and/or gas will have cement circulated across them by inserting a float shoe joint into the 5 1/2" production casing which will be run at TD to sufficiently cover all known oil and gas horizons above 200'.

4. Proposed Casing Program:

Hole Size	Interval	OD Casing	Wt	Grade
17 1/2"	0 - 700'	13 3/8"	48#	H-40
12 1/4"	0 - 4350'	8 5/8"	32#	J-55
7 7/8"	0 - 12400'	5 1/2"	17#	S95/P-110

Proposed Cement Program:

WITNESS 13 3/8" Surface Casing: Cement w/ 700 sx Class C. Circulate to surface. WITNESS

8 5/8" Intermediate Casing: Cement w/ 1100 sx Class C. Attempt to tie in to 13 3/8" csg.

5 1/2" Production Casing: Cement w/ 750 sx Class C. Will bring TOC 200' above all oil and gas bearing zones.

5. Pressure Control Equipment: See Exhibit 1. Marbob proposes to nipple up on the 13 3/8" casing with a 2M system, testing it to 1000# with rig pumps, then nipple up on the 8 5/8" casing with a 5M system, tested to 5000# before drilling out.

6. Mud Program: The applicable depths and properties of this system are as follows:

Depth	Type	Weight (ppg)	Viscosity (sec)	Waterloss (cc)
0 - 700'	Fresh Wtr	8.4 - 9.2	32 - 36	N.C.
700 - 4350'	Cut Brine	9.9 - 10.2	28 - 32	N.C.
4350 - 12500'	Fresh Wtr	8.4 - 8.6	28 - 32	N.C.

7. Auxiliary Equipment: Kelly Cock; Sub with full opening valve on floor; and drill pipe connections.

8. Testing, Logging and Coring Program:

No drillstem tests are anticipated.

The electric logging program will consist of Dual Laterolog Micro SFL, Spectral Density Dual Spaced Neutron Csg Log, and Depth Control Log.

No conventional coring is anticipated.

9. No abnormal pressures or temperatures are anticipated.

10. Anticipated starting date: As soon as possible after approval.

MARBOB ENERGY CORPORATION

HYDROGEN SULFIDE DRILLING OPERATIONS PLAN

I. HYDROGEN SULFIDE TRAINING

All personnel, whether regularly assigned, contracted, or employed on an unscheduled basis, will receive training from a qualified instructor in the following areas prior to commencing drilling operations on this well:

- A. The hazards and characteristics of hydrogen sulfide (H₂S).
- B. The proper use and maintenance of personal protective equipment and life support systems.
- C. The proper use of H₂S detectors, alarms, warning systems, briefing areas, evacuation procedures, and prevailing winds.
- D. The proper techniques for first aid and rescue procedures.

In addition, supervisory personnel will be trained in the following areas:

- A. The effects of H₂S on metal components. If high tensile tubulars are to be used, personnel will be trained in their special maintenance requirements.
- B. Corrective action and shut-in procedures when drilling or reworking a well and blowout prevention and well control procedures.
- C. The contents and requirements of the H₂S Drilling Operations Plan and the Public Protection Plan.

There will be an initial training session just prior to encountering a known or probable H₂S zone (within 3 days or 500 feet) and weekly H₂S and well control drills for all personnel in each crew. The initial training session shall include a review of the site specific H₂S Drilling Operations Plan and the Public Protection Plan. This plan shall be available at the well site. All personnel will be required to carry documentation that they have received the proper training.

II. H₂S SAFETY EQUIPMENT AND SYSTEMS

Note: All H₂S safety equipment and systems will be installed, tested, and operational when drilling reaches a depth of 500 feet above, or three days prior to penetrating the first zone containing or reasonably expected to contain H₂S.

A. Well Control Equipment:

Flare line.

Choke manifold.

Blind rams and pipe rams to accommodate all pipe sizes with properly sized closing unit.

Auxiliary equipment to include: annular preventer, mud-gas separator, rotating head.

B. Protective equipment for essential personnel:

Mark II Surviveair 30-minute units located in the dog house and at briefing areas.

C. H₂S detection and monitoring equipment:

2 - portable H₂S monitor positioned on location for best coverage and response. These units have warning lights and audible sirens when H₂S levels of 20 ppm are reached.

D. Visual warning systems:

Caution/Danger signs shall be posted on roads providing direct access to location. Signs will be painted a high visibility yellow with black lettering of sufficient size to be readable at a reasonable distance from the immediate location. Bilingual signs will be used, when appropriate. See example attached.

E. Mud Program:

The mud program has been designed to minimize the volume of H₂S circulated to the surface.

A mud-gas separator will be utilized.

F. Metallurgy:

All drill strings, casings, tubing, wellhead, blowout preventers, drilling spool, kill lines, choke manifold and lines, and valves shall be suitable for H₂S service.

G. Communication:

Company vehicles equipped with cellular telephone and 2-way radio.

W A R N I N G

**YOU ARE ENTERING AN H₂S AREA
AUTHORIZED PERSONNEL ONLY**

- 1. BEARDS OR CONTACT LENSES NOT ALLOWED**
- 2. HARD HATS REQUIRED**
- 3. SMOKING IN DESIGNATED AREAS ONLY**
- 4. BE WIND CONSCIOUS AT ALL TIMES**
- 5. CK WITH MARBOB FOREMAN AT MAIN OFFICE**

MARBOB ENERGY CORPORATION

1-505-748-3303

BOPE SCHEMATIC

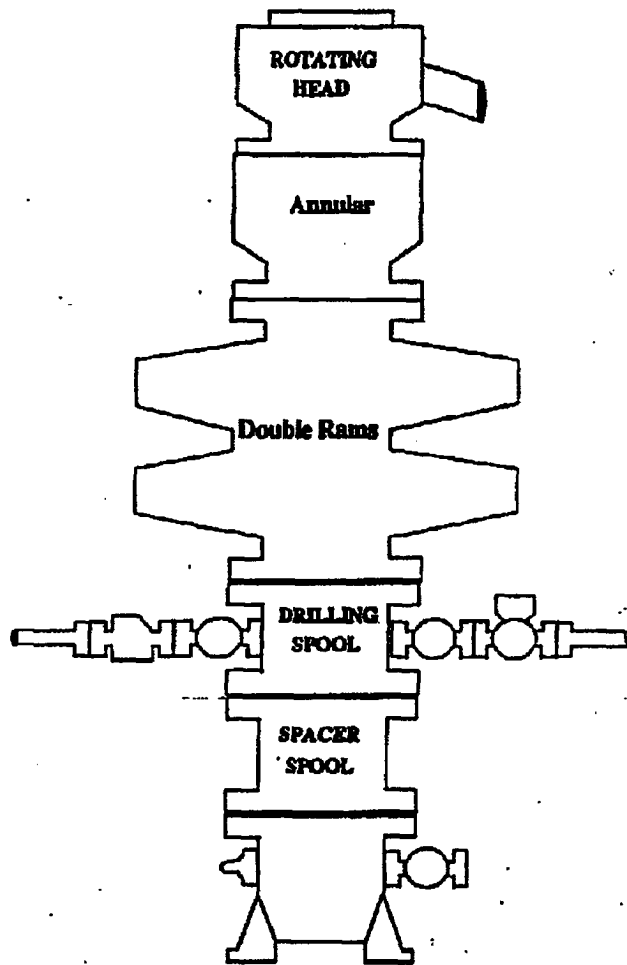

Choke Manifold

