

N.M. Oil Cons. DIV-Dist. 2
UNITED STATES
DEPARTMENT OF THE INTERIOR
BUREAU OF LAND MANAGEMENT
1301 W. Grand Avenue
Artesia, NM 88210

FORM APPROVED
OMB NO. 1004-0135
Expires: November 30, 2000

SUNDRY NOTICES AND REPORTS ON WELLS
Do not use this form for proposals to drill or to re-enter an abandoned well. Use form 3160-3 (APD) for such proposals.

SUBMIT IN TRIPLICATE - Other instructions on reverse side.

1. Type of Well <input type="checkbox"/> Oil Well <input checked="" type="checkbox"/> Gas Well <input type="checkbox"/> Other		5. Lease Serial No. NMNM8431	
2. Name of Operator CHESAPEAKE OPERATING INC 147179		6. If Indian, Allottee or Tribe Name	
3a. Address P O BOX 18496 OKLAHOMA CITY, OK 73154-0496		7. If Unit or CA/Agreement, Name and/or No.	
3b. Phone No. (include area code) Ph: 405.767.4275 Fx: 405.879.9583		8. Well Name and No. TYRELL 13 FEDERAL COM 4 34454	
4. Location of Well (Footage, Sec., T., R., M., or Survey Description) Sec 13 T10S R25E NENE 660FNL 800FEL		9. API Well No. 30-005-63703	
RECEIVED OCT - 1 2004 BOD-ARTESIA		10. Field and Pool, or Exploratory PECOS SLOPE	
		11. County or Parish, and State CHAVES COUNTY, NM	

12. CHECK APPROPRIATE BOX(ES) TO INDICATE NATURE OF NOTICE, REPORT, OR OTHER DATA

TYPE OF SUBMISSION	TYPE OF ACTION
<input type="checkbox"/> Notice of Intent	<input type="checkbox"/> Acidize
<input checked="" type="checkbox"/> Subsequent Report	<input type="checkbox"/> Deepen
<input type="checkbox"/> Final Abandonment Notice	<input type="checkbox"/> Fracture Treat
	<input type="checkbox"/> Production (Start/Resume)
	<input type="checkbox"/> Reclamation
	<input type="checkbox"/> Recombine
	<input type="checkbox"/> Temporarily Abandon
	<input type="checkbox"/> Water Shut-Off
	<input type="checkbox"/> Well Integrity
	<input checked="" type="checkbox"/> Other
	Change to Original PD
	<input type="checkbox"/> Water Disposal

13. Describe Proposed or Completed Operation (clearly state all pertinent details, including estimated starting date of any proposed work and approximate duration thereof. If the proposal is to deepen directionally or recompleat horizontally, give subsurface locations and measured and true vertical depths of all pertinent markers and zones. Attach the Bond under which the work will be performed or provide the Bond No. on file with BLM/BIA. Required subsequent reports shall be filed within 30 days following completion of the involved operations. If the operation results in a multiple completion or recompleat in a new interval, a Form 3160-4 shall be filed once testing has been completed. Final Abandonment Notices shall be filed only after all requirements, including reclamation, have been completed, and the operator has determined that the site is ready for final inspection.)

Well name changed from Tyrell 13 Federal 4 to Tyrell 13 Federal Com 4 per BLM request.

Attached please find revised Exhibit A-3 Survey Plat.

(CHK PN 819483)

14. I hereby certify that the foregoing is true and correct. Electronic Submission #36601 verified by the BLM Well Information System For CHESAPEAKE OPERATING INC, sent to the Roswell Committed to AFMSS for processing by ARMANDO LOPEZ on 09/23/2004 (04AL0522SE)	
Name (Printed/Typed) LINDA GOOD	Title AUTHORIZED REPRESENTATIVE
Signature (Electronic Submission)	Date 09/23/2004

THIS SPACE FOR FEDERAL OR STATE OFFICE USE

Approved By DAVID R GLASS For Larry D. Bray	Title ACTING ASST FIELD MANAGER	Date 09/27/00
Conditions of approval, if any, are attached. Approval of this notice does not warrant or certify that the applicant holds legal or equitable title to those rights in the subject lease which would entitle the applicant to conduct operations thereon.		Office Roswell

Title 18 U.S.C. Section 1001 and Title 43 U.S.C. Section 1212, make it a crime for any person knowingly and willfully to make to any department or agency of the United States any false, fictitious or fraudulent statements or representations as to any matter within its jurisdiction.

**** BLM REVISED ** BLM REVISED ** BLM REVISED ** BLM REVISED ** BLM REVISED ****

Revisions to Operator-Submitted EC Data for Sundry Notice #36601

	Operator Submitted	BLM Revised (AFMSS)
Sundry Type:	APDCH SR	APDCH SR
Lease:	NMNM08431	NMNM8431
Agreement:		
Operator:	CHESAPEAKE OPERATING, INC. P.O. BOX 18496 OKLAHOMA CITY, OK 73154-0496 Ph: 405.767.4275 Fx: 405.879.9583	CHESAPEAKE OPERATING INC P O BOX 18496 OKLAHOMA CITY, OK 73154-0496 Ph: 405.879.9406
Admin Contact:	LINDA GOOD AUTHORIZED REPRESENTATIVE E-Mail: lgood@chkenenergy.com Ph: 405.767.4275 Fx: 405.879.9583	LINDA GOOD AUTHORIZED REPRESENTATIVE E-Mail: lgood@chkenenergy.com Ph: 405.767.4275 Fx: 405.879.9583
Tech Contact:		
Location:		
State:	NM	NM
County:	CHAVES	CHAVES
Field/Pool:	PECOS SLOPE	PECOS SLOPE
Well/Facility:	TYRELL 13 FEDERAL COM 4 Sec 13 T10S R25E NENE 660FNL 800FEL	TYRELL 13 FEDERAL COM 4 Sec 13 T10S R25E NENE 660FNL 800FEL

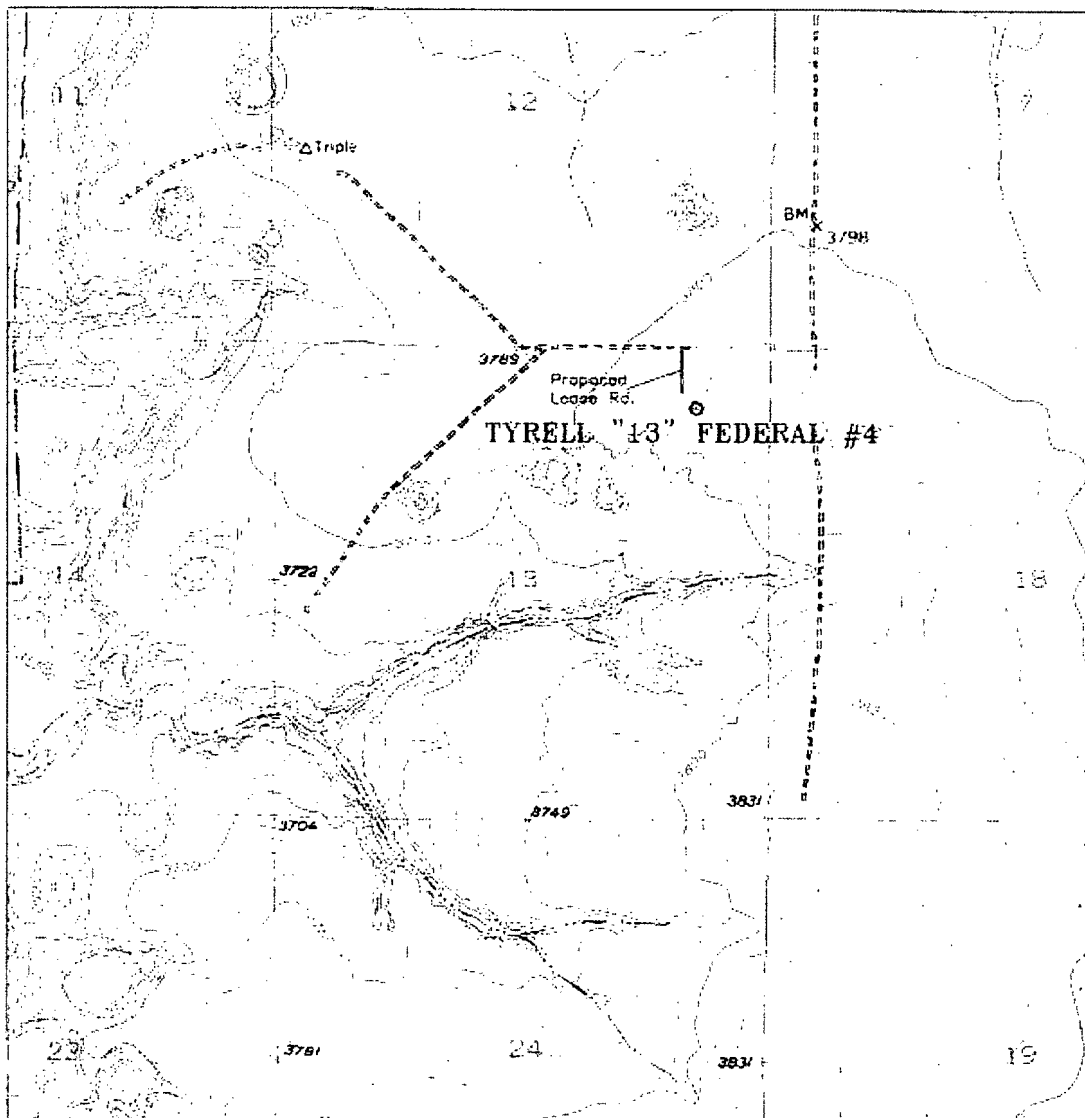

TYRELL "13" FEDERAL #4

Located at 660' FNL and 800' FEL
 Section 13, Township 10 South, Range 25 East,
 N31.P.M., CHAVES County, New Mexico.

Surveys

For more information
 call 1-800-368-1111

Box 101, 1786
 1121 N. High County Rd.
 Hobbs, N.M. 88241
 (505) 337-7115 - Office
 (505) 337-7074 - Fax
 24-hour fax line

Acres Surveyed: 100.00
 Survey Date: 07/10/99
 Survey #: 2000
 Date: 07/10/99

**CHESAPEAKE
 OPERATING
 INC.**

Exhibit A-3