

N.M. Oil Cons. DIV-Dist. 2

1301 W. Grand Avenue

Artesia, NM 88210

FORM APPROVED
OMB No. 1004-0136
Expires January 31, 2004

UNITED STATES
DEPARTMENT OF THE INTERIOR
BUREAU OF LAND MANAGEMENT

APPLICATION FOR PERMIT TO DRILL OR REENTER

1a. Type of Work: <input checked="" type="checkbox"/> DRILL <input type="checkbox"/> REENTER		5. Lease Serial No. NMLC028793A 028784-A	
1b. Type of Well: <input checked="" type="checkbox"/> Oil Well <input type="checkbox"/> Gas Well <input type="checkbox"/> Other <input checked="" type="checkbox"/> Single Zone <input type="checkbox"/> Multiple Zone		6. If Indian, Allottee or Tribe Name	
2. Name of Operator Marbob Energy Corporation		7. If Unit or CA Agreement, Name and No. NMNM88525X	
3a. Address PO Box 227, Artesia, NM 88211-0227		8. Lease Name and Well No. Burch Keely Unit #964	
3b. Phone No. (include area code) 505-748-3303 505-746-2523 Fax		9. API Well No. 30-015- 33809	
4. Location of Well (Report location clearly and in accordance with any State requirements. *) At surface 660' South and 830' East At proposed prod. zone		10. Field and Pool, or Exploratory Grayburg Jackson SR Q Grbg SA	
14. Distance in miles and direction from nearest town or post office* OCD-ARTESIA		11. Sec., T., R., M., or Blk. and Survey or Area Sec. 13, T. 17S, R. 29E	
15. Distance from proposed* location to nearest property or lease line, ft. (Also to nearest drig. unit line, if any)		12. County or Parish Eddy	
16. No. of Acres in lease		13. State NM	
17. Spacing Unit dedicated to this well 40			
18. Distance from proposed location* to nearest well, drilling, completed, applied for, on this lease, ft. 4800'		20. BLM/BIA Bond No. on file	
21. Elevations (Show whether DF, KDB, RT, GL, etc.) 3630' GL		22. Approximate date work will start* 09/09/04	
		23. Estimated duration 14 days	

24. Attachments

ROSWELL CONTROLLED WATER BASIN

The following, completed in accordance with the requirements of Onshore Oil and Gas Order No. 1, shall be attached to this form:

- | | |
|---|--|
| 1. Well plat certified by a registered surveyor. | 4. Bond to cover the operations unless covered by an existing bond on file (see Item 20 above). |
| 2. A Drilling Plan. | 5. Operator certification. |
| 3. A Surface Use Plan (if the location is on National Forest System Lands, the SUPO shall be filed with the appropriate Forest Service Office). | 6. Such other site specific information and/or plans as may be required by the authorized officer. |

25. Signature 	Name (Printed Typed) William Miller	Date 08/09/04
Title Land Department		
Approved by (Signature) /s/ Joe G. Lara	Name (Printed Typed) /s/ Joe G. Lara	Date 13 SEP 2004
Title FIELD MANAGER	Office CARLSBAD FIELD OFFICE	

Application approval does not warrant or certify that the applicant holds legal or equitable title to those rights in the subject lease which would entitle the applicant to conduct operations thereon.

Conditions of approval, if any, are attached.

APPROVAL FOR 1 YEAR

Title 18 U.S.C. Section 1001 and Title 43 U.S.C. Section 1212, make it a crime for any person knowingly and willfully to make to any department or agency of the United States any false, fictitious or fraudulent statements or representations as to any matter within its jurisdiction.

*(Instructions on reverse)

APPROVAL SUBJECT TO
GENERAL REQUIREMENTS
AND SPECIAL STIPULATIONS
ATTACHED

Witness Surface Casing.

If earthen pits are used in
association with the drilling of this
well, an OCD pit permit must be
obtained prior to pit construction.

DISTRICT II
P.O. Drawer DD, Artesia, NM 88211-0719

OIL CONSERVATION DIVISION

P.O. Box 2088

Santa Fe, New Mexico 87504-2088

DISTRICT III
1000 Rio Brazos Rd., Aztec, NM 87410

DISTRICT IV
P.O. BOX 2088, SANTA FE, N.M. 87504-2088

WELL LOCATION AND ACREAGE DEDICATION PLAT

☐ AMENDED REPORT

API Number	Pool Code	Pool Name
	28509	GRBG JACKSON SR Q GRBG SA
Property Code	Property Name	Well Number
006497	BURCH KEELY UNIT	964
OGRID No.	Operator Name	Elevation
14049	MARBOB ENERGY CORPORATION	3630'

Surface Location

UL or lot No.	Section	Township	Range	Lot Idn	Feet from the	North/South line	Feet from the	East/West line	County
P	13	17-S	29-E		660'	SOUTH	830'	EAST	EDDY

Bottom Hole Location If Different From Surface

UL or lot No.	Section	Township	Range	Lot Idn	Feet from the	North/South line	Feet from the	East/West line	County
Dedicated Acres 40	Joint or Infill	Consolidation Code		Order No.					

NO ALLOWABLE WILL BE ASSIGNED TO THIS COMPLETION UNTIL ALL INTERESTS HAVE BEEN CONSOLIDATED
OR A NON-STANDARD UNIT HAS BEEN APPROVED BY THE DIVISION

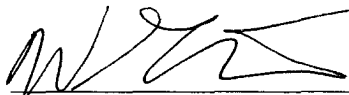
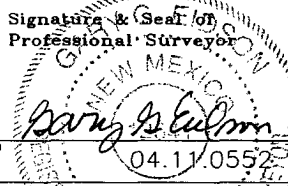
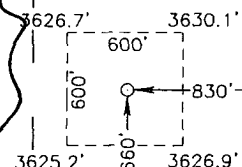
	<p>OPERATOR CERTIFICATION</p> <p>I hereby certify the the information contained herein is true and complete to the best of my knowledge and belief.</p> <p></p> <p>Signature</p> <p><u>WILLIAM A. MILLER</u></p> <p>Printed Name</p> <p><u>LAND DERPARTMENT</u></p> <p>Title</p> <p><u>JULY 27, 2004</u></p> <p>Date</p>
	<p>SURVEYOR CERTIFICATION</p> <p>I hereby certify that the well location shown on this plat was plotted from field notes of actual surveys made by me or under my supervision, and that the same is true and correct to the best of my belief.</p> <p><u>MAY 20, 2004</u></p> <p>Date Surveyed</p> <p><u>JR</u></p> <p>Signature & Seal of Professional Surveyor</p> <p></p> <p><u>5/28/04</u></p> <p>Certificate No. <u>GARY EIDSEN</u></p> <p><u>12841</u></p>
	<p>WELL LOCATION</p> <p></p>
	<p>WELL IDENTIFICATION</p> <p><u>WELL IDENTIFICATION</u></p> <p><u>WELL IDENTIFICATION</u></p>

DRILLING PROGRAM

**Burch Keely Unit No. 964
660' FSL and 830' FEL
Section 13-17S-29E
Eddy County, New Mexico**

10. Anticipated Starting Date and Duration of Operations

Starting date will be scheduled upon approval.

Duration of Operations: Once commenced, the drilling operations should be completed in approximately 21 days. If the well is productive, an additional 30 to 60 days will be required for completion and testing of the well.

SURFACE USE AND OPERATING PLAN

**Burch Keely Unit No. 964
660' FSL and 660' FEL
Section 13-17S-29E
Eddy County, New Mexico**

- 1.(c) Directions to Locations: From the intersection of U.S. Hwy 82 and Co. Rd #215 go north on Co. Rd #215 0.6 miles. Turn right onto caliche road and go 0.85 miles east. Location is 60' north.**
- 2. No new access road will be necessary**
- 4.(a) If productive, this well will use Satellite "C".**

BOPE SCHEMATIC

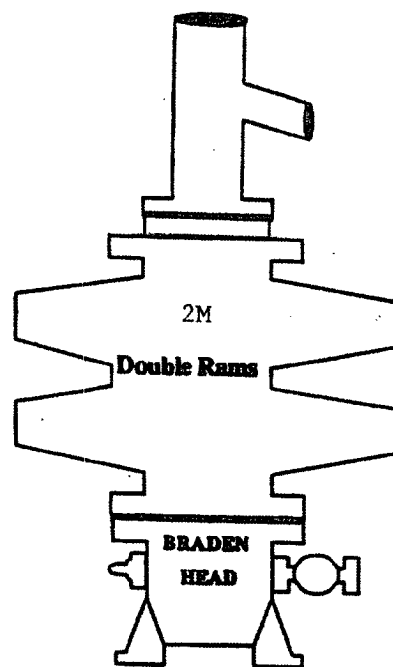
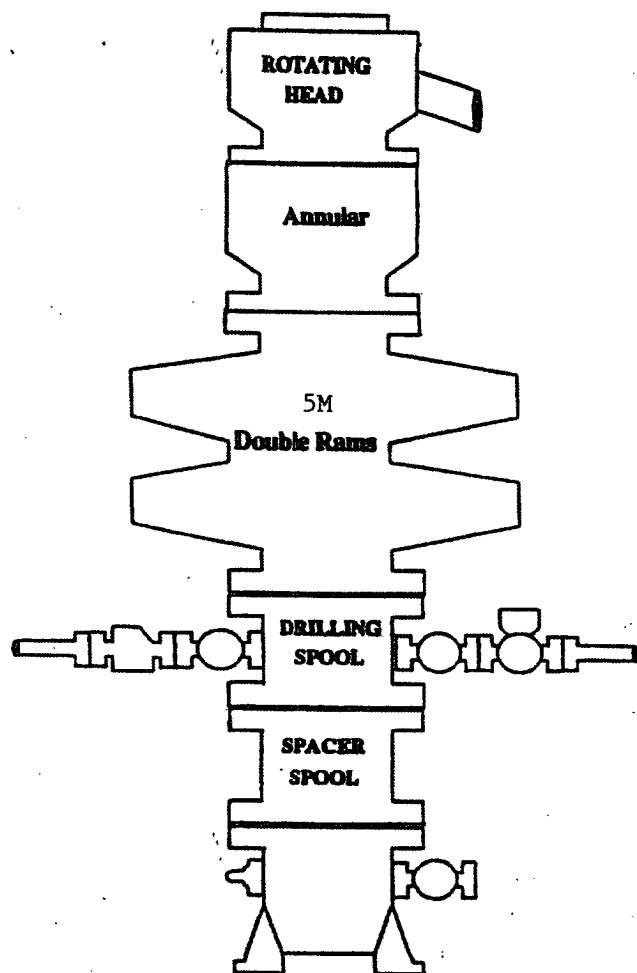

ONSHORE OIL AND GAS ORDER NO. 2

- 2M system:
- Annular preventer, or, double ram, or two rams with one being blind and one being a pipe ram *
 - Kill line (2 inch minimum)
 - 1 kill line valve (2 inch minimum)
 - 1 choke line valve
 - 2 chokes (refer to diagram in Attachment 1)
 - Upper kelly cock valve with handle available
 - Safety valve and subs to fit all drill strings in use
 - Pressure gauge on choke manifold
 - 2 inch minimum choke line
 - Fill-up line above the uppermost preventer.
- Violation: Minor (all items unless marked by asterisk).
Corrective Action: Install the equipment as specified.
Normal Abatement Period: 24 hours.

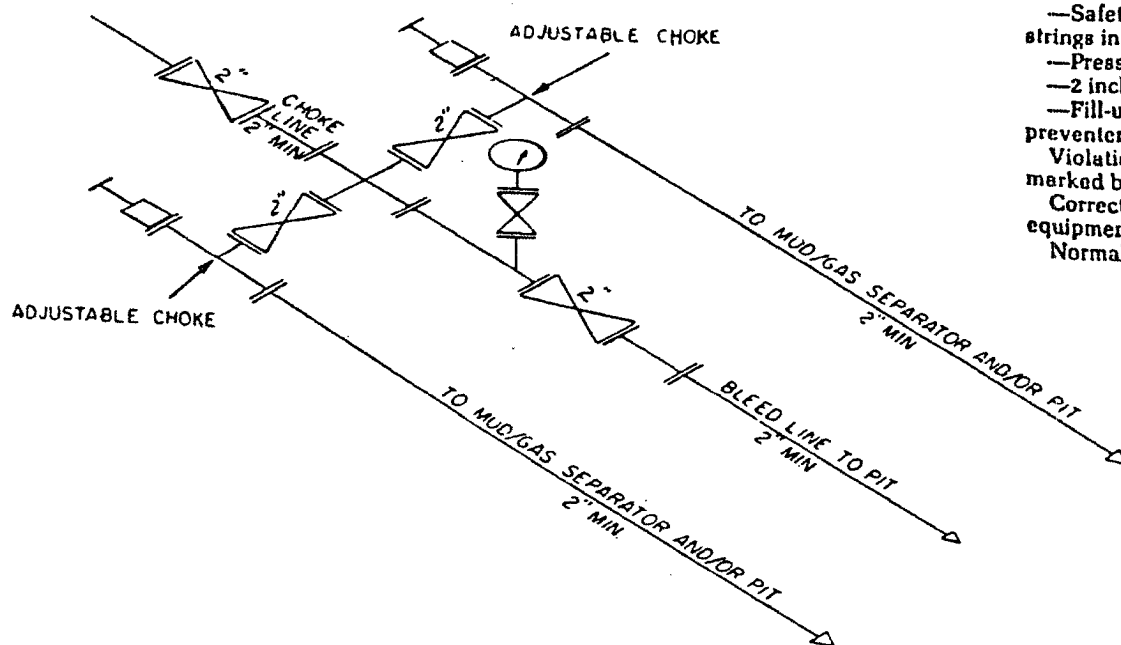

2M CHOKE MANIFOLD EQUIPMENT — CONFIGURATION OF CHOKES

MAY VARY

Exhibit One

Form 3160-5
(June 1990)

UNITED STATES
DEPARTMENT OF THE INTERIOR
BUREAU OF LAND MANAGEMENT

JUN 21 1999

FORM APPROVED
Budget Bureau No. 1004-0135
Expires: March 31, 1993

SUNDRY NOTICES AND REPORTS ON WELLS

Do not use this form for proposals to drill or to deepen or reentry to a different reservoir.
Use "APPLICATION FOR PERMIT-" for such proposals

SUBMIT IN TRIPLICATE

1. Type of Well

☒ Oil Well ☐ Gas Well ☐ Other

2. Name of Operator

MARBOB ENERGY CORPORATION

3. Address and Telephone No.

P.O. BOX 227, ARTESIA, NM 88210 505-748-3303

4. Location of Well (Footage, Sec., T., R., M., or Survey Description)

T17S-R29E
T17S-R30E
T17S-R31E

5. Lease Designation and Serial No.

6. If Indian, Allottee or Tribe Name

7. If Unit or CA, Agreement Designation

8. Well Name and No.

9. API Well No.

10. Field and Pool, or Exploratory Area

11. County or Parish, State

EDDY CO., NM

12. CHECK APPROPRIATE BOX(s) TO INDICATE NATURE OF NOTICE, REPORT, OR OTHER DATA

TYPE OF SUBMISSION

- ☐ Notice of Intent
☐ Subsequent Report
☐ Final Abandonment Notice

TYPE OF ACTION

- ☐ Abandonment
☐ Recompletion
☐ Plugging Back
☐ Casing Repair
☐ Altering Casing
☒ Other TEST BOPS
- ☐ Change of Plans
☐ New Construction
☐ Non-Routine Fracturing
☐ Water Shut-Off
☐ Conversion to Injection
☐ Dispose Water

(Note: Report results of multiple completion on Well Completion or Recompletion Report and Log form.)

13. Describe Proposed or Completed Operations (Clearly state all pertinent details, and give pertinent dates, including estimated date of starting any proposed work. If well is directionally drilled, give subsurface locations and measured and true vertical depths for all markers and zones pertinent to this work.)

DUE TO THE LOW BOTTOM HOLE PRESSURE OF FORMATIONS ABOVE 6000', WE ARE REQUESTING BLANKET APPROVAL FOR WELLS IN THE ABOVE LOCATIONS TO TEST BOPS ON SURFACE CASING TO 1000#

THIS SUNDRY IS APPROVED FOR MARBOB TO HAVE A BLANKET APPROVAL FOR TESTING BOPS.

HOWEVER, THE OPERATOR WILL STATE ON EACH APD THIS APPLIES TO IN ORDER TO

REMIND AND/OR BRING NOTICE TO THE BLM OFFICE AND ENGINEER REVIEWING THE APD

THAT THE WELL'S BOPE TESTING IS COVERED BY A BLANKET APPROVAL FOR THESE LOCATIONS

14. I hereby certify that the foregoing is true and correct

Signed Robin Coleman

Title PRODUCTION ANALYST

Date 05/25/99

(This space for Federal or State office use)

Approved by Gary Smith
Conditions of approval, if any:

Title PETROLEUM ENGINEER

Date JUN 16 1999

Title 18 U.S.C. Section 1001, makes it a crime for any person knowingly and willfully to make to any department or agency of the United States any false, fictitious or fraudulent statements or representations as to any matter within its jurisdiction.

SEP 09 1999



United States Department of the Interior

BUREAU OF LAND MANAGEMENT

Roswell Field Office
2909 West Second St.
Roswell, New Mexico 88201
www.nm.blm.gov



IN REPLY REFER TO:
NMNM-88525X
3180 (06200)

Marbob Energy Corporation
Attention: Johnny Gray
P. O. Box 227
Artesia, NM 88210

SEP 07 1999

Gentlemen:

With regard to our telephone conversation of September 2, 1999, a review of our records has found discrepancies in the casing requirements section of the conditions of approval for your APD's. As per our meeting on July 7, 1999, our office had agreed with your recommended casing procedures for shallow wells of 6000 ft. or less in T. 17 S., Rgs. 29, 30 and 31 E., NMPM. In order to correct the discrepancies, this letter states the language to be used for the conditions of approval casing requirements for all your existing APD's

Conditions of Approval-Drilling amended as follows:

II. Casing requirements in T. 17 S., Rgs. 29, 30 and 31 E. for shallow wells less than 6,000 ft.

1. 8-5/8 inch surface casing should be set at approximately ____ ft. in the Rustler Anhydrite or in the case the salt occurs at a shallower depth above the top of the salt. The surface casing shoe shall be set in the anhydrite to ensure adequate sealing. The operator is required to use an excess of 100% cement volume to fill annulus. If cement does not circulate to surface the operator may then use ready mix cement to fill the remaining annulus.
2. The minimum required fill of cement behind the 5 1/2 inch production casing is to place the top of the cement 200 ft. above the top of the uppermost hydrocarbon bearing interval or to the base of the salt.

These requirements supercede those issued in your existing, approved APD's for the shallow wells located in T. 17 S., Rgs. 29, 30 and 31 E., NMPM. If you have any question regarding this matter please call John S. Simitz at (505) 627-0288 or Armando A. Lopez at (505) 627-0248.

Sincerely,

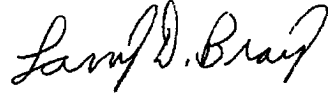
A handwritten signature in cursive script, reading "Larry D. Bray".

Larry D. Bray
Acting Assistant Field Office Manager,
Lands and Minerals

LOCATION VERIFICATION MAP

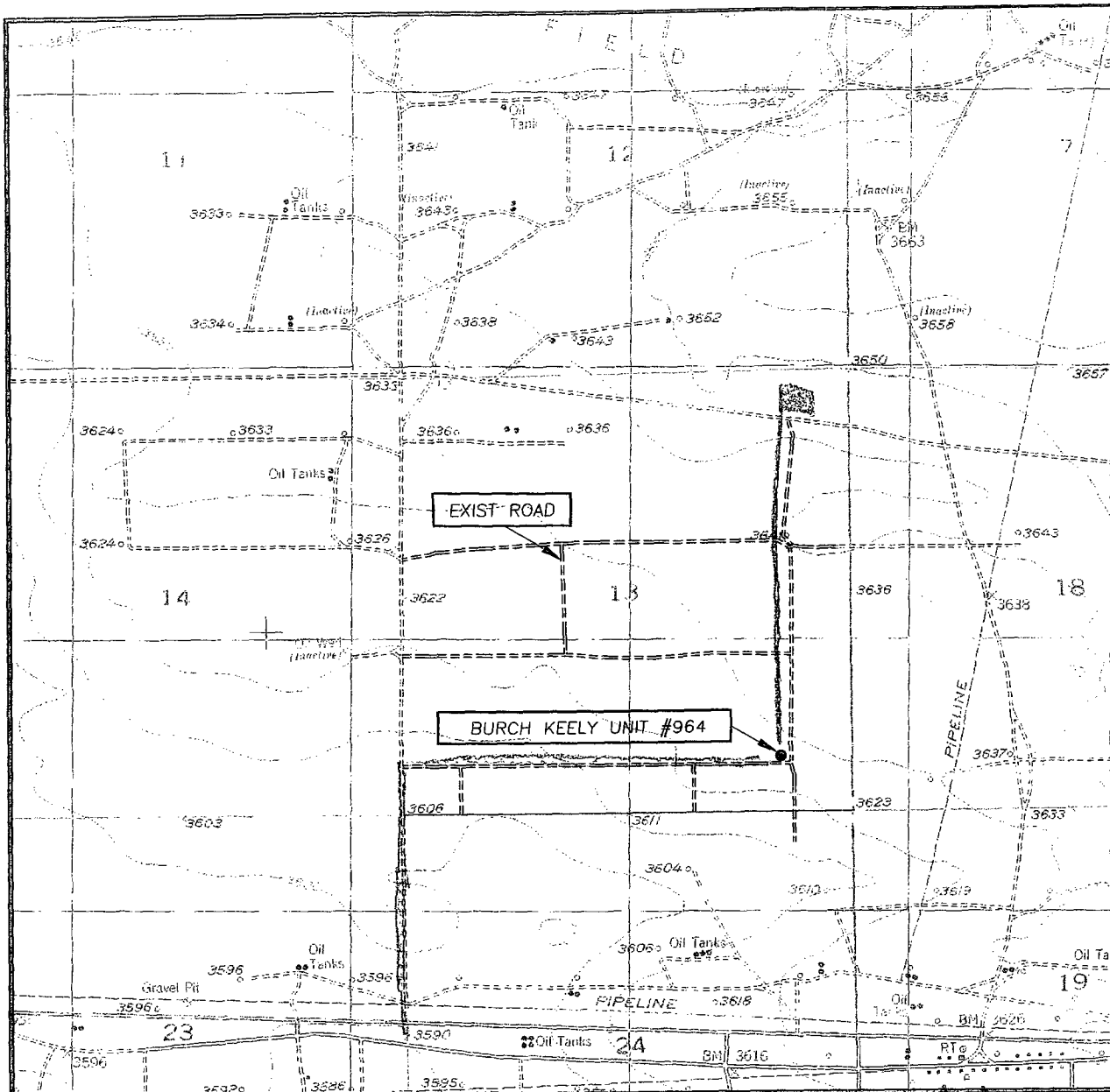

SCALE: 1" = 2000'

CONTOUR INTERVAL:
RED LAKE SE, N.M. - 10'

SEC. 13 TWP. 17-S RGE. 29-E

SURVEY N.M.P.M.

COUNTY EDDY

DESCRIPTION 660' FSL & 830' FEL

ELEVATION 3630'

OPERATOR MARBOB ENERGY CORPORATION

LEASE BURCH KEELY UNIT

U.S.G.S. TOPOGRAPHIC MAP
RED LAKE SE, N.M.

 Access Road

 Flow Line

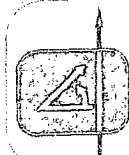

PROVIDING SURVEYING SERVICES
SINCE 1946
JOHN WEST SURVEYING COMPANY
412 N. DAL PASO
HOBBS, N.M. 88240
(505) 393-3117

Well Site Lay-Out Plat

