

DISTRICT I
1625 N. French Dr., Hobbs, NM 88240

DISTRICT II
301 W. Grand Avenue, Artesia, NM 88210

DISTRICT III
1000 Rio Brazos Rd., Aztec, NM 87410

DISTRICT IV
1220 S. St. Francis Dr., Santa Fe, NM 87505

State of New Mexico
Energy, Minerals and Natural Resources Department

Form C-102
Revised July 16, 2010

Submit one copy to appropriate
District Office

OIL CONSERVATION DIVISION
1220 South St. Francis Dr.
Santa Fe, New Mexico 87505

WELL LOCATION AND ACREAGE DEDICATION PLAT

☐ AMENDED REPORT

API Number 30-015-39143	Pool Code 96047	Pool Name POKER LAKE SW (DELAWARE)
Property Code 306402 ✓	Property Name POKER LAKE UNIT	Well Number 357H ✓
OGRID No. 260737 ✓	Operator Name ✓ BOPCO, L.P.	Elevation 3466'

Surface Location

UL or lot No.	Section	Township	Range	Lot Idn	Feet from the	North/South line	Feet from the	East/West line	County
J	28	24 S	31 E		1695	SOUTH	2280	EAST	EDDY, ✓

Bottom Hole Location If Different From Surface

UL or lot No.	Section	Township	Range	Lot Idn	Feet from the	North/South line	Feet from the	East/West line	County
O	20	24 S	31 E		910	SOUTH	1425	EAST	EDDY
Dedicated Acres		Joint or Infill		Consolidation Code		Order No.			

NO ALLOWABLE WILL BE ASSIGNED TO THIS COMPLETION UNTIL ALL INTERESTS HAVE BEEN CONSOLIDATED
OR A NON-STANDARD UNIT HAS BEEN APPROVED BY THE DIVISION

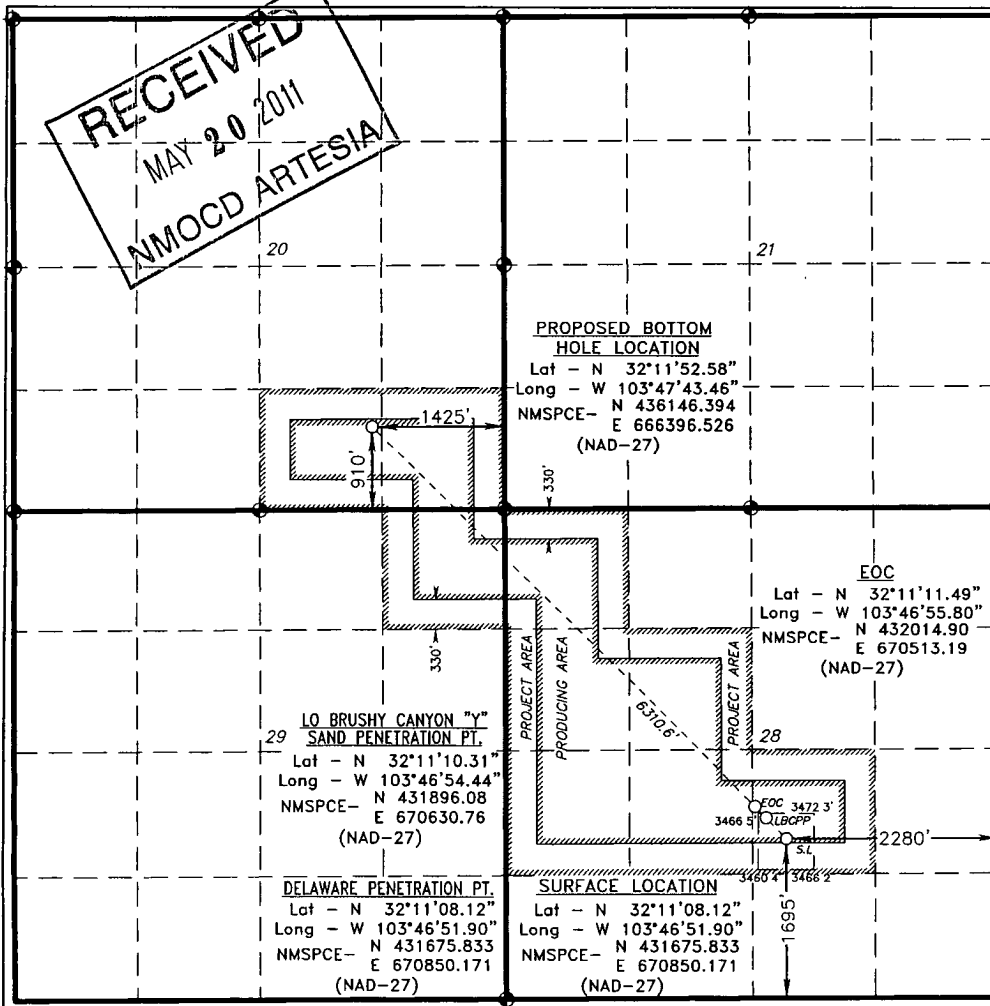

OPERATOR CERTIFICATION I hereby certify that the information contained herein is true and complete to the best of my knowledge and belief, and that this organization either owns a working interest or unleased mineral interest in the land including the proposed bottom hole location or has a right to drill this well at this location pursuant to a contract with an owner of such a mineral or working interest, or to a voluntary pooling agreement or a compulsory pooling order heretofore entered by the Division. <i>Jeremy Braden</i> 2-14-11 Signature _____ Date _____ Printed Name Jeremy Braden Email Address JDBraden@basspet.com	
SURVEYOR CERTIFICATION I hereby certify that the well location shown on this plat was plotted from field notes of actual surveys made by me or under my supervision, and that the same is true and correct to the best of my belief. GARY L. JONES 2010 Date Surveyed _____ Signature & Seal of Professional Surveyor _____ Certificate No. Gary L. Jones 7977 BASIN SURVEYS 23801	