

District I
1625 N. French Dr., Hobbs, NM 88240
District II
1301 W. Grand Avenue, Artesia, NM 88210
District III
1000 Rio Brazos Road, Aztec, NM 87410
District IV
1220 S. St. Francis Dr., Santa Fe, NM 87505

State of New Mexico
Energy Minerals and Natural
Resources

Oil Conservation Division
1220 South St. Francis Dr.
Santa Fe, NM 87505

Form C-144
June 1, 2004

For drilling and production facilities, submit
to appropriate NMOCD District Office.
For downstream facilities, submit to Santa Fe
office

Pit or Below-Grade Tank Registration or Closure

Is pit or below-grade tank covered by a "general plan"? Yes X No ☐

Type of action: Registration of a pit or below-grade tank ☐ Closure of a pit or below-grade tank X

Operator: Yates Petroleum Corporation Telephone: 505-748-4500 e-mail address: mikes@ypc.com
Address: 105. South 4th street, Artesia, N.M. 88210
Facility or well name: Rita TZ Fed. #5 API #: 30-005-63594 U/L or Qtr/Qtr N Sec 4 T 8s R 26e
County: Chaves Latitude 33.64375 Longitude 104.30405 NAD: 1927 ☐ 1983 X
Surface Owner: Federal X State Private Indian ☐

RECEIVED

MAR 28 2005

MOBIL ARTEZIA

Pit

Type: Drilling X Production ☐ Disposal ☐
Work over ☐ Emergency ☐
Lined X Unlined ☐
Liner type: Synthetic X 12 mil. Thickness NA mil Clay ☐
Pit Volume 15,000 bbl

Below-grade tank

Volume: _____ bbl Type of fluid: _____
Construction material: _____
Double-walled, with leak detection? Yes ☐ If not, explain why not.

Depth to ground water (vertical distance from bottom of pit to seasonal high water elevation of ground water.)

| | |
|---|--------------|
| Less than 50 feet | (20 points) |
| 50 feet or more, but less than 100 feet | (10 points) |
| 100 feet or more | (0 points)X |

Wellhead protection area: (Less than 200 feet from a private domestic water source, or less than 1000 feet from all other water sources.)

| | |
|-----|--------------|
| Yes | (20 points) |
| No | (0 points)X |

Distance to surface water: (horizontal distance to all wetlands, playas, irrigation canals, ditches, and perennial and ephemeral watercourses.)

| | |
|---|-------------|
| Less than 200 feet | (20 points) |
| 200 feet or more, but less than 1000 feet | (10 points) |
| 1000 feet or more | (0 points) |

Ranking Score (Total Points) 0 Points

If this is a pit closure: (1) Attach a diagram of the facility showing the pit's relationship to other equipment and tanks. (2) Indicate disposal location: (check the onsite box if you are burying in place) onsite X offsite ☐ If offsite, name of facility _____. (3) Attach a general description of remedial action taken including remediation start date and end date. (4) Groundwater encountered: No ☐ Yes ☐ If yes, show depth below ground surface _____ ft. and attach sample results. (5) Attach soil sample results and a diagram of sample locations and excavations.

Additional Comments: Closure workplan for Encapsulation trench. The drilling pit contents will be mixed to stiffen the pit contents. Encapsulation trench will be excavated and lined with a 12 mil. Synthetic liner on former drilling pit site. Drilling pit contents will then be emplaced into the encapsulation trench. A 20 mil. Synthetic liner will then be placed over the pit contents with a min. of a 3' over lap of the under laying trench area. The encapsulation trenches will then backfilled back to grade using a min. of 3' of clean soil and like material. A one call & 48 hour notice will be provide to the Oil Conservation Division before pit closure actions began.

Pit Closure actions to begin by NA. Ending date NA. Mud seed will be applied to former pit area.

I hereby certify that the information above is true and complete to the best of my knowledge and belief. I further certify that the above-described pit or below-grade tank has been/will be constructed or closed according to NMOCD guidelines ☐, a general permit X, or an (attached) alternative OCD-approved plan ☐.

Date: 3/25/2005

Printed Name/Title Dan Dolan/ Regulatory agent

Signature

Your certification and NMOCD approval of this application/closure does not relieve the operator of liability should the contents of the pit or tank contaminate ground water or otherwise endanger public health or the environment. Nor does it relieve the operator of its responsibility for compliance with any other federal, state, or local laws and/or regulations.

Approval:

Printed Name/Title

Signature

MAR 29 2005
Date:

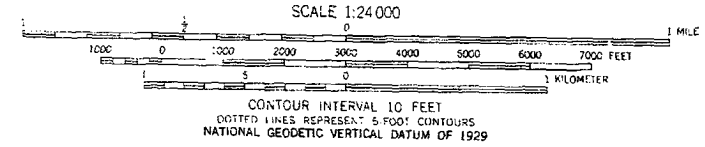
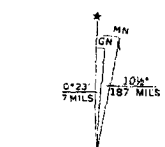
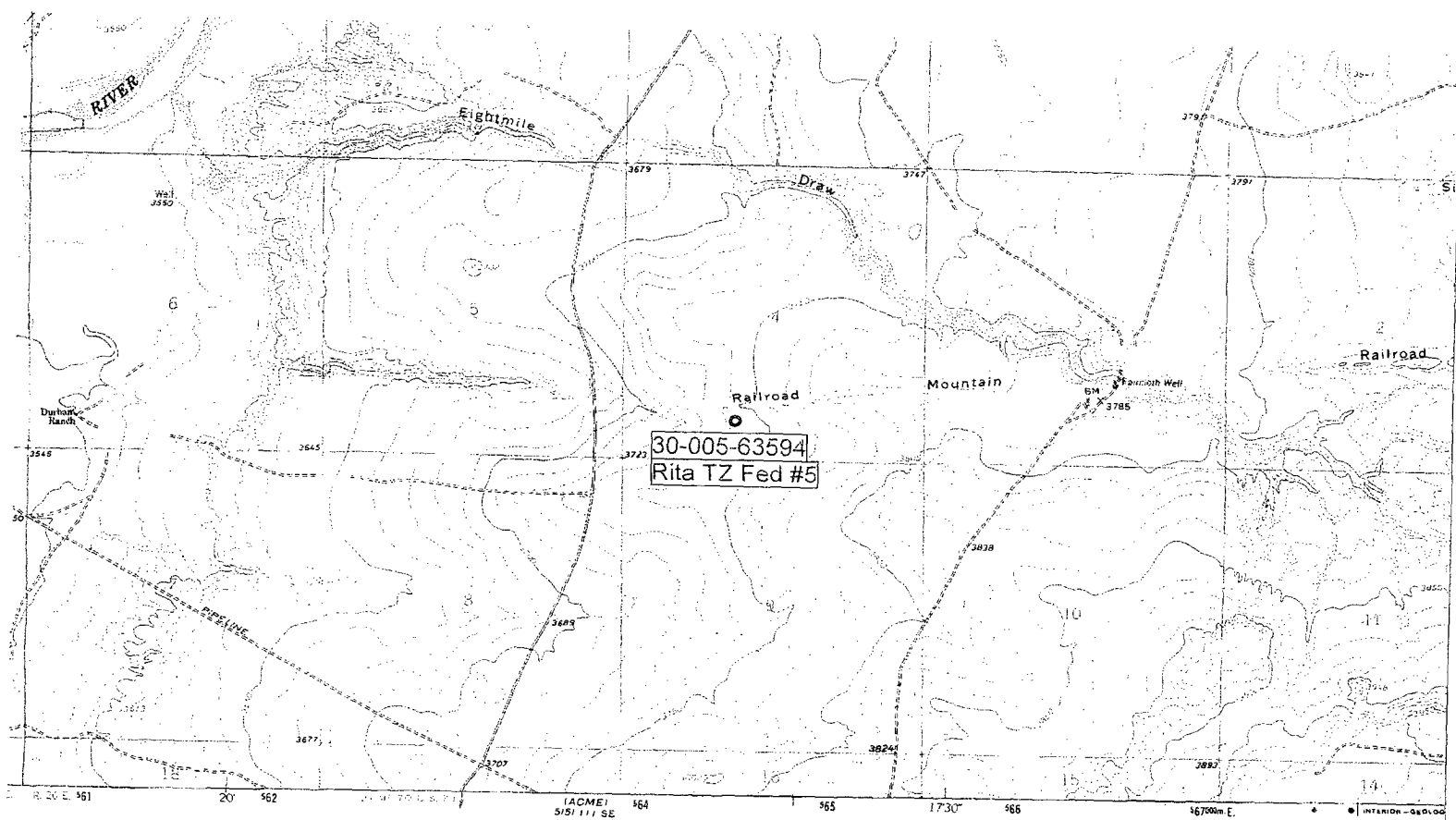

THIS MAP COMPLIES WITH NATIONAL MAP ACCURACY STANDARDS
FOR SALE BY U. S. GEOLOGICAL SURVEY, DENVER, COLORADO 80225, OR RESTON, VIRGINIA 22092
A FOLDER DESCRIBING TOPOGRAPHIC MAPS AND SYMBOLS IS AVAILABLE ON REQUEST

New Mexico Office of the State Engineer
Well Reports and Downloads

Township: 08S Range: 26E Sections:

NAD27 X: Y: Zone: Search Radius:

County: Basin: Number: Suffix:

Owner Name: (First) (Last) ☐ Non-Domestic ☐ Domestic
☒ All

Well / Surface Data Report

Avg Depth to Water Report

Water Column Report

Clear Form

WATERS Menu

Help

AVERAGE DEPTH OF WATER REPORT 03/25/2005

| Bsn | Tws | Rng | Sec | Zone | X | Y | Wells | (Depth Water in Feet) | | |
|-----|-----|-----|-----|------|---|---|-------|-----------------------|-----|-----|
| | | | | | | | | Min | Max | Avg |
| RA | 08S | 26E | 06 | | | | 1 | 12 | 12 | 12 |
| RA | 08S | 26E | 23 | | | | 1 | 150 | 150 | 150 |

Record Count: 2