

Submit 3 Copies To Appropriate District  
Office  
District I  
1625 N French Dr , Hobbs, NM 88240  
District II  
1301 W Grand Ave., Artesia, NM 88210  
District III  
1000 Rio Brazos Rd , Aztec, NM 87410  
District IV  
1220 S St Francis Dr., Santa Fe, NM  
87505

State of New Mexico  
Energy, Minerals and Natural Resources

Form C-103  
May 27, 2004

OIL CONSERVATION DIVISION  
1220 South St. Francis Dr.  
Santa Fe, NM 87505

<b>SUNDRY NOTICES AND REPORTS ON WELLS</b> (DO NOT USE THIS FORM FOR PROPOSALS TO DRILL OR TO DEEPEN OR PLUG BACK TO A DIFFERENT RESERVOIR USE "APPLICATION FOR PERMIT" (FORM C-101) FOR SUCH PROPOSALS)		WELL API NO. 30-015-38223 ✓
1. Type of Well: Oil Well <input checked="" type="checkbox"/> Gas Well <input type="checkbox"/> Other <input type="checkbox"/>		5. Indicate Type of Lease STATE <input checked="" type="checkbox"/> FEE <input type="checkbox"/>
2. Name of Operator Yates Petroleum Corporation ✓		6. State Oil & Gas Lease No. VB-679
3. Address of Operator 105 S. 4 <sup>th</sup> Street, Artesia, NM 88210		7. Lease Name or Unit Agreement Name Buho BQH State ✓
4. Well Location Unit Letter <u>A</u> : <u>480</u> feet from the <u>North</u> line and <u>75</u> feet from the <u>East</u> line Section <u>35</u> Township <u>26S</u> Range <u>28E</u> NMPM <u>Eddy</u> County		8. Well Number 1H ✓
11. Elevation (Show whether DR, RKB, RT, GR, etc.) 3001'		9. OGRID Number 025575 ✓
Pit or Below-grade Tank Application <input type="checkbox"/> or Closure <input type="checkbox"/>		
Pit type _____ Depth to Groundwater _____ Distance from nearest fresh water well _____ Distance from nearest surface water _____		
Pit Liner Thickness: _____ mil Below-Grade Tank: Volume _____ bbls; Construction Material _____		

12. Check Appropriate Box to Indicate Nature of Notice, Report or Other Data

<b>NOTICE OF INTENTION TO:</b>		<b>SUBSEQUENT REPORT OF:</b>	
PERFORM REMEDIAL WORK <input type="checkbox"/>	PLUG AND ABANDON <input type="checkbox"/>	REMEDIAL WORK <input type="checkbox"/>	ALTERING CASING <input type="checkbox"/>
TEMPORARILY ABANDON <input type="checkbox"/>	CHANGE PLANS <input checked="" type="checkbox"/>	COMMENCE DRILLING OPNS. <input type="checkbox"/>	PLUG AND ABANDON <input type="checkbox"/>
PULL OR ALTER CASING <input type="checkbox"/>	MULTIPLE COMPL <input type="checkbox"/>	CASING/CEMENT JOB <input type="checkbox"/>	
OTHER: <input type="checkbox"/>		OTHER: <input type="checkbox"/>	

13. Describe proposed or completed operations. (Clearly state all pertinent details, and give pertinent dates, including estimated date of starting any proposed work). SEE RULE 1103. For Multiple Completions: Attach wellbore diagram of proposed completion or recompletion.

Yates Petroleum Corporation respectfully requests permission to alter the intermediate setting depth and production casing for this well as follows:

12 1/4" hole drilled to 2660' where 9 5/8" 36# casing will be set and cemented with 910sx. TOC=0'  
8 3/4" production hole drilled to 6564' then kicked off and drilled at 12"/100' to 7309' MD (7042' TVD), hole then reduced to 8 1/2" and drilled to 11,778' MD (7093' TVD) 5 1/2" 20# casing will then be run with a packer port system in the lateral and an SF cementer tool just above the curve at approx. 6400'. Production casing will be cemented from 6400' up to 2100' with 1200sx.

Attached is the current directional plan.

Bottom Hole Location for this well is: Section 36, 26S-28E, (480' FNL, 330' FEL), Unit Letter A

Thank-you,

I hereby certify that the information above is true and complete to the best of my knowledge and belief. I further certify that any pit or below-grade tank has been/will be constructed or closed according to NMOCD guidelines ☐, a general permit ☒ or an (attached) alternative OGD approved plan ☐.

SIGNATURE Jeremiah Mullen TITLE Well Planning Technician DATE 9/2/11

Type or print name Jeremiah Mullen E-mail address: jmulen@yatespetroleum.com Telephone No. 575-748-4378

**For State Use Only**  
APPROVED BY: David Gray TITLE Field Supervisor DATE 9-8-11  
Conditions of Approval (if any):

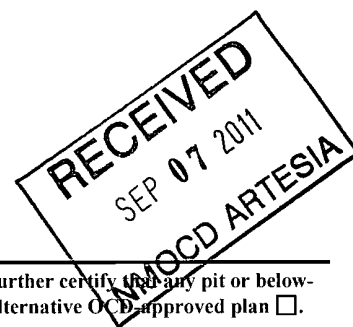



Project: Eddy County  
Site: BUHO "BQH" STATE  
Well: 1H  
Wellbore: OH  
Plan: Plan #2 (1H/OH)



Azimuths to Grid North  
True North: -0.15°  
Magnetic North: 7.61°

Magnetic Field  
Strength: 48412.6snT  
Dip Angle: 59.89°  
Date: 8/30/2011  
Model: IGRF2010

**PATHFINDER**<sup>®</sup>  
A Schlumberger Company

PROJECT DETAILS: Eddy County  
Geodetic System: US State Plane 1983  
Datum: North American Datum 1983  
Ellipsoid: GRS 1980  
Zone: New Mexico Eastern Zone  
System Datum: Mean Sea Level  
Local North: Grid

SECTION DETAILS										
Sec	MD	Inc	Azi	TVD	+N/-S	+E/-W	Dleg	TFace	VSect	Target
1	0.00	0.00	0.00	0.00	0.00	0.00	0.00	0.00	0.00	
2	6564.56	0.00	0.00	6564.56	0.00	0.00	0.00	0.00	0.00	
3	7309.11	89.35	89.45	7041.99	4.53	471.99	12.00	89.45	472.02	
4	11778.25	89.35	89.45	7093.00	47.41	4940.63	0.00	0.00	4940.66	PBHL "BOHO 1H"

#### WELL DETAILS: 1H

Ground Elevation: 3001.00  
RKB Elevation: KB = 26.5' @ 3027.50usft (PATRIOT 5)  
Rig Name: PATRIOT 5

+N/-S	+E/-W	Northing	Easting	Latitude	Longitude	Slot
0.00	0.00	365765.031	629291.945	32° 0' 18.903 N	104° 2' 58.498 W	

#### WELLBORE TARGET DETAILS (MAP CO-ORDINATES)

Name	TVD	+N/-S	+E/-W	Northing	Easting	Shape
PBHL "BOHO 1H"	7093.00	47.41	4940.63	365812.446	634232.579	Point

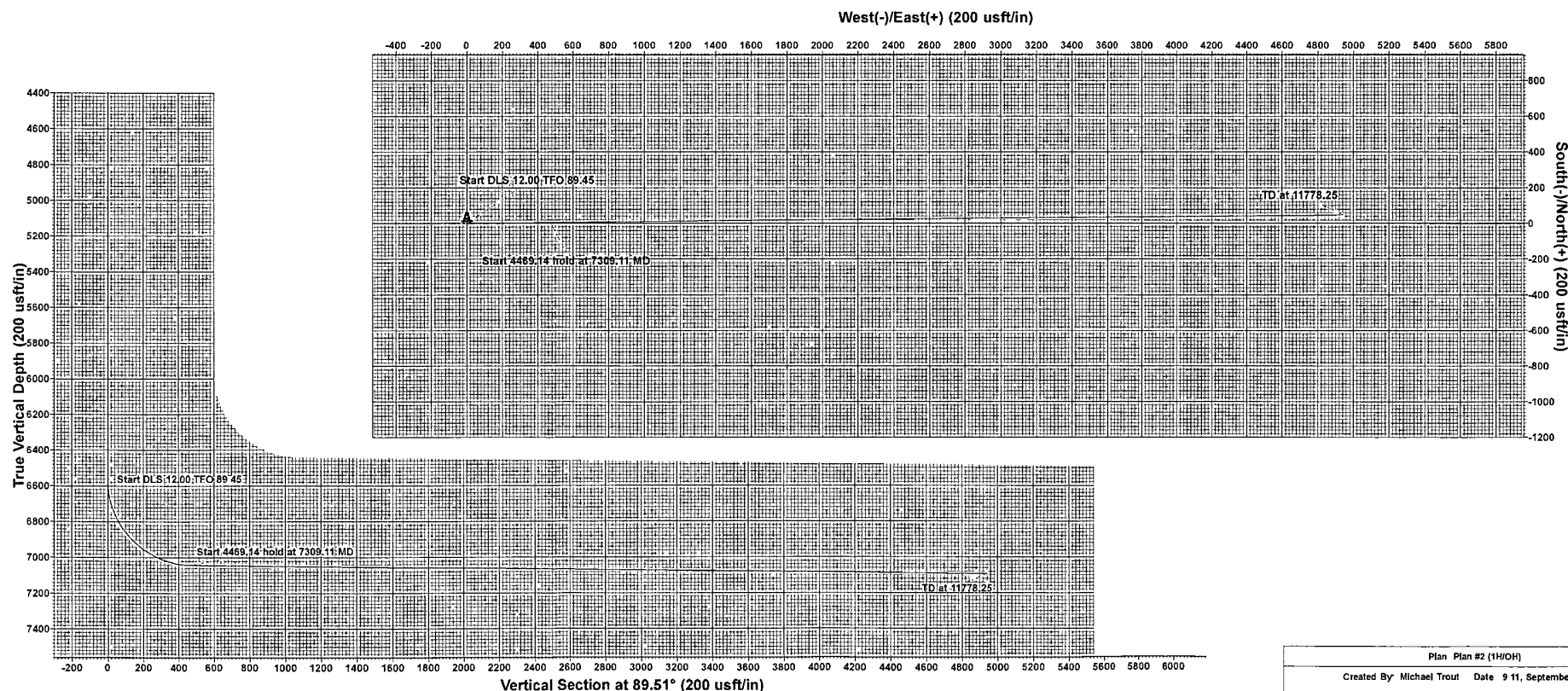

Plan: Plan #2 (1H/OH)

Created By: Michael Trout Date: 9/11, September 01 2011

Checked: \_\_\_\_\_ Date: \_\_\_\_\_