

# N.M. Oil Cons. DIV-Dist. 2

UNITED STATES  
DEPARTMENT OF THE INTERIOR  
BUREAU OF LAND MANAGEMENT  
1801 W. Grand Avenue  
Artesia, NM 88210

## WELL COMPLETION OR RECOMPLETION REPORT AND LOG

FORM APPROVED  
OMB NO. 1004-0137  
Expires: November 30, 2000

5. Lease Serial No.  
**NM 0107697**

6. If Indian, Allottee or Tribe Name

7. Unit or CA Agreement Name and No.

8. Lease Name and Well No.  
**Radar 24 Federal #1**

9. API Well No.  
**30-015-31357**

10. Field and Pool, or Exploratory  
**Lusk; Bone Spring, W.**

11. Sec., T., R., M., on Block and Survey or Area  
**24, 19S, 31E**

12. County or Parish  
**Eddy**

13. State  
**NM**

14. Date Spudded  
**10/04/00**

15. Date T.D. Reached  
**09/01/04**

16. Date Completed  
 D & A  Ready to Prod.  
**9/1/04**

17. Elevations (DF, RKB, RT, GL)\*  
**3540 GL**

18. Total Depth: MD **12750** TVD **12750**

19. Plug Back T.D.: MD **9815'** TVD **9815'**

20. Depth Bridge Plug Set: MD **9850'** TVD **9850'**

21. Type Electric & Other Mechanical Logs Run (Submit copy of each)

22. Was well cored?  No  Yes (Submit analysis)  
Was DST run?  No  Yes (Submit report)  
Directional Survey?  No  Yes (Submit copy)

**RECEIVED**  
**APR 19 2005**  
**UBB-ARTESIA**

23. Casing and Liner Record (Report all strings set in well)

Hole Size	Size/Grade	Wt. (#/ft.)	Top (MD)	Bottom (MD)	Stage Cementer Depth	No. of Sks. & Type of Cement	Slurry Vol. (BBL)	Cement Top*	Amount Pulled
17 1/2	13 5/8	48	0	832	---	778 C		Surface	0
12 1/4	8 5/8	K24, 32	0	4505	2533	1925 C		Surface	0
7 7/8	5 1/2	P, L17	0	12750	9504	1900 C&H		2630 T.S.	0
	2 7/8			9450					

24. Tubing Record

Size	Depth Set (MD)	Packer Depth (MD)	Size	Depth Set (MD)	Packer Depth (MD)	Size	Depth Set (MD)	Packer Depth (MD)

25. Producing Intervals

Formation	Top	Bottom	Perforated Interval	Size	No. Holes	Perf. Status
A) Bone Spring	7268	7283	7268-83'	0.40"	18	Open
B) Bone Spring	8535	8545	8535-45'	0.40"	22	Open
C) Bone Spring	9657	9670	9657-70'	0.40"	28	Open
D) Bone Spring	9682	9696	9682-96'	0.40"	30	Open

27. Acid, Fracture, Treatment, Cement Squeeze, Etc.

Depth Interval	Amount and Type of Material

28. Production - Interval A

Date First Produced	Test Date	Hours Tested	Test Production	Oil BBL	Gas MCF	Water BBL	Oil Gravity Corr. API	Gas Gravity	Production Method
9/1	9/1	24	→	5	2	11			pumping
Choke Size	Tbg. Press. Flwg. SI	Csg. Press.	24 Hr. Rate	Oil BBL	Gas MCF	Water BBL	Gas : Oil Ratio	Well Status	
--	35	35	→	5	2	11		pumping	

**ACCEPTED FOR RECORD**  
**APR 15 2005**  
**LES BABYAK**  
**PETROLEUM ENGINEER**

28a. Production - Interval B

Date First Produced	Test Date	Hours Tested	Test Production	Oil BBL	Gas MCF	Water BBL	Oil Gravity Corr. API	Gas Gravity	Production Method
			→						
Choke Size	Tbg. Press. Flwg. SI	Csg. Press.	24 Hr. Rate	Oil BBL	Gas MCF	Water BBL	Gas : Oil Ratio	Well Status	
			→						

(See instructions and spaces for additional data on reverse side)

28b. Production - Interval C

Date First Produced	Test Date	Hours Tested	Test Production	Oil BBL	Gas MCF	Water BBL	Oil Gravity Corr. API	Gas Gravity	Production Method
			→						
Choke Size	Tbg. Press. Flwg. SI	Csg. Press.	24 Hr. Rate	Oil BBL	Gas MCF	Water BBL	Gas : Oil Ratio	Well Status	
			→						

28c. Production - Interval D

Date First Produced	Test Date	Hours Tested	Test Production	Oil BBL	Gas MCF	Water BBL	Oil Gravity Corr. API	Gas Gravity	Production Method
			→						
Choke Size	Tbg. Press. Flwg. SI	Csg. Press.	24 Hr. Rate	Oil BBL	Gas MCF	Water BBL	Gas : Oil Ratio	Well Status	
			→						

29. Disposition of Gas (Sold, used for fuel, vented, etc.)

30. Summary of Porous Zones (Include Aquifers):

Show all important zones of porosity and contents thereof: Cored intervals and all drill-stem tests, including depth interval tested, cushion used, time tool open, flowing and shut-in pressures and recoveries.

Formation	Top	Bottom	Descriptions, Contents, etc.	31. Formation (Log) Markers	
				Name	Top Meas. Depth
Bone Spring	9830	10047	Oil Gas & Water	Top Salt	840
Strawn	11210	11500	Oil Gas & Water	Base Salt	2310
Morrow	12440	12454	Gas	Yates	2490
				Delaware	5290
				Bone Spring	7040
				Wolfcamp	10480
				Strawn	11275
				Atoka	11550
				Morrow	11897

32. Additional remarks (include plugging procedure):

A C.I.B.P. was set at 9850' w/35' of cement on top.

33. Circle enclosed attachments:

- 1. Electrical/Mechanical Logs (1 full set req'd.)
- 2. Geologic Report
- 3. DST Report
- 4. Directional Survey
- 5. Sundry Notice for plugging and cement verification
- 6. Core Analysis
- 7. Other:

34. I hereby certify that the foregoing and attached information is complete and correct as determined from all available records (see attached instructions)\*

Name (please print) Larry Scott Title President

Signature *Larry Scott* Date 4/13/05

Title 18 U.S.C. Section 1001 and Title 43 U.S.C. Section 1212, make it a crime for any person knowingly and willfully to make to any department or agency of the United States any false, fictitious or fraudulent statements or representations as to any matter within its jurisdiction.

RECEIVED

STRICT II  
 Drawer DD Artesia, NM 82211-0715

OIL CONSERVATION DIVISION

P.O. Box 2088  
 Santa Fe, New Mexico 87504-2088

AMENDED REPORT

STRICT III  
 30 Rio Brazos Rd., Artesia, NM 87410

STRICT IV  
 P.O. Box 2088, SANTA FE, N.M. 87504-2088

WELL LOCATION AND ACREAGE DEDICATION PLAT

API Number 30-015-31357	Pool Code 41540	Pool Name Lusk Delaware West
Property Code 26688	Property Name RADAR "24" FEDERAL	Well Number 1
OGRID No. 013645	Operator Name LYNX PETROLEUM CONSULTANTS, INC.	Elevation 3540

Surface Location

UL or lot No.	Section	Township	Range	Lot Idn	Feet from the	North/South line	Feet from the	East/West line	County
C	24	19 S	31 E		660	NORTH	1980	WEST	EDDY

Bottom Hole Location If Different From Surface

UL or lot No.	Section	Township	Range	Lot Idn	Feet from the	North/South line	Feet from the	East/West line	County

Dedicated Acres 40	Joint or Infill	Consolidation Code	Order No.
-----------------------	-----------------	--------------------	-----------

NO ALLOWABLE WILL BE ASSIGNED TO THIS COMPLETION UNTIL ALL INTERESTS HAVE BEEN CONSOLIDATED OR A NON-STANDARD UNIT HAS BEEN APPROVED BY THE DIVISION

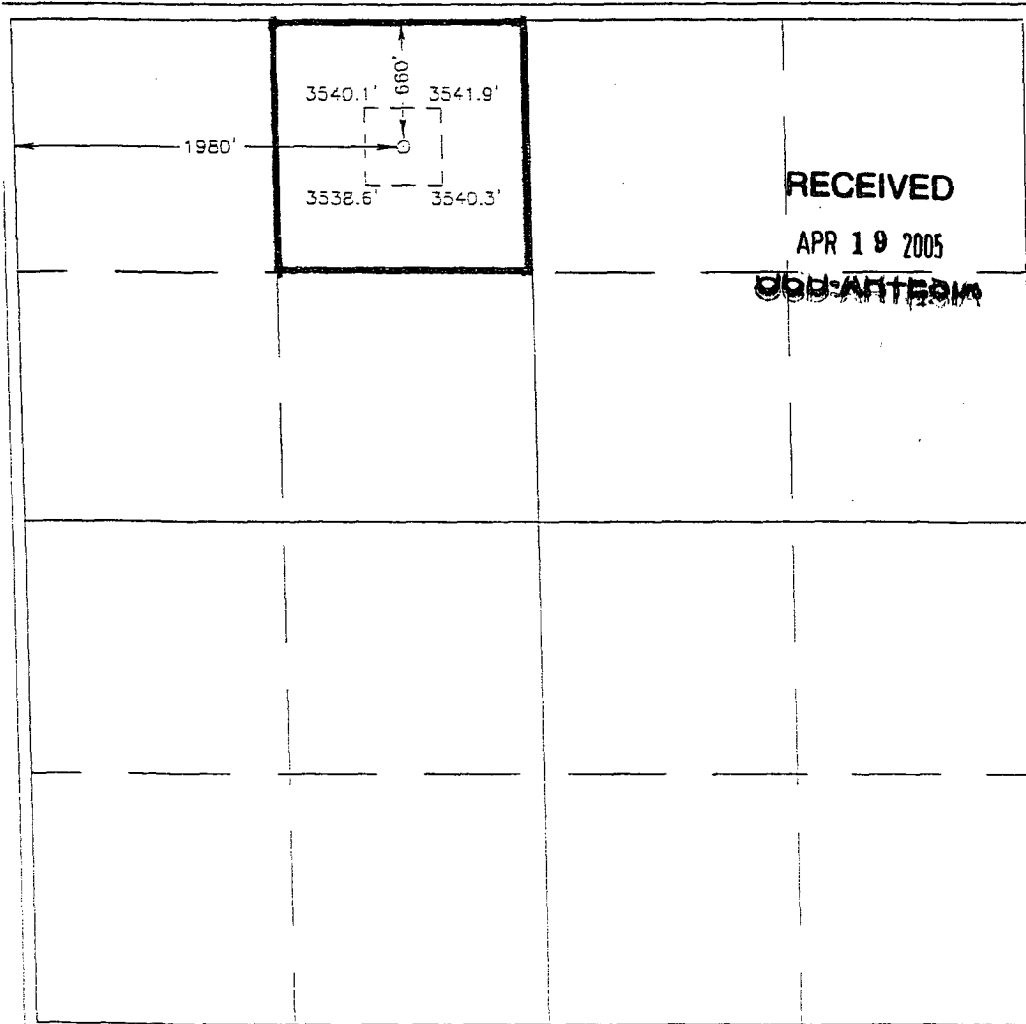

RECEIVED  
 APR 19 2005  
 OCS/ART/DEM

OPERATOR CERTIFICATION

I hereby certify that the information contained herein is true and complete to the best of my knowledge and belief.

*Larry R. Scott*  
 Signature  
 Larry Scott  
 Printed Name  
 President  
 Title  
 12/8/04  
 Date

SURVEYOR CERTIFICATION

I hereby certify that the well location shown on this plat was plotted from field notes of actual surveys made by me or under my supervision and that the same is true and correct to the best of my belief.

JULY 18, 2000  
 Date Surveyed  
 DC  
 Signature & Seal of  
 Professional Surveyor

*Ronald J. Edson* 7/19/00  
 Certificate No. RONALD J. EDSON 3239  
 GARY EDSON 1254  
 MACON McDONALD 12185