

RECEIVED

SEP 07 2012

NMOCD ARTESIA

UNITED STATES  
DEPARTMENT OF THE INTERIOR  
BUREAU OF LAND MANAGEMENT

OCD Artesia

FORM APPROVED  
OMB No 1004-0137  
Expires October 31, 2014

## APPLICATION FOR PERMIT TO DRILL OR REENTER

|  |  |   |  |
|--|--|---|--|
| 1a Type of work. <input checked="" type="checkbox"/> DRILL <input type="checkbox"/> REENTER  |  | 5 Lease Serial No<br>NM-048344  |  |
| 1b Type of Well <input checked="" type="checkbox"/> Oil Well <input type="checkbox"/> Gas Well <input type="checkbox"/> Other <input checked="" type="checkbox"/> Single Zone <input type="checkbox"/> Multiple Zone |  | 6 If Indian, Allottee or Tribe Name<br>TCS 9/12/2012  |  |
| 2 Name of Operator OXY USA WTP LIMITED PARTNERSHIP   |  | 7 If Unit or CA Agreement, Name and No  |  |
| 3a Address P.O. BOX 4294<br>HOUSTON, TX 77210  |  | 8 Lease Name and Well No<br>PIGLET 21 FEDERAL #13   |  |
| 3b Phone No (include area code)<br>713-513-6640  |  | 9 API Well No<br>39440  |  |
| 4 Location of Well (Report location clearly and in accordance with any State requirements *)<br>At surface 965' FNL & 1038' FEL<br>At proposed prod. zone  |  | 10 Field and Pool, or Exploratory<br>ARTESIA, GLORIETA-YESO (O) 30-015-40670                                  |  |
| 11 Sec, T R M or Blk and Survey or Area<br>A, SEC 21, T17S, R28E   |  | 12 County or Parish<br>EDDY   |  |
| 13 State<br>NM   |  | 14 Distance in miles and direction from nearest town or post office<br>12 miles East of Artesia, N.M.         |  |
| 15 Distance from proposed* 965' location to nearest property or lease line, ft (Also to nearest drig. unit line, if any)   |  | 16 No of acres in lease<br>400  |  |
| 17 Spacing Unit dedicated to this well<br>40   |  | 18 Distance from proposed location* 206' to nearest well, drilling, completed, applied for, on this lease, ft |  |
| 19 Proposed Depth<br>5300' MD/TVD  |  | 20 BLM/BIA Bond No on file<br>ES0136  |  |
| 21 Elevations (Show whether DF, KDB, RT, GL, etc)<br>3602'   |  | 22 Approximate date work will start*<br>09/30/2012  |  |
| 23 Estimated duration<br>10 DAYS   |  | 24 Attachments  |  |

The following, completed in accordance with the requirements of Onshore Oil and Gas Order No 1, must be attached to this form

- Well plat certified by a registered surveyor.
- A Drilling Plan.
- A Surface Use Plan (if the location is on National Forest System Lands, the SUPO must be filed with the appropriate Forest Service Office)
- Bond to cover the operations unless covered by an existing bond on file (see Item 20 above).
- Operator certification
- Such other site specific information and/or plans as may be required by the BLM.

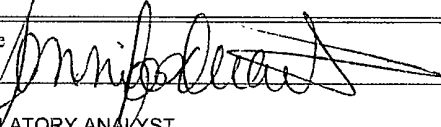
|  |   |                    |
|--|---|--------------------|
| 25. Signature<br> | Name (Printed/Typed)<br>JENNIFER DUARTE (jennifer_duarte@oxy.com) | Date<br>05/21/2012 |
| Title<br>REGULATORY ANALYST  |   |                    |

|   |  |                      |
|---|--|----------------------|
| Approved by (Signature)<br>/s/ Don Peterson | Name (Printed/Typed)<br>/s/ Don Peterson | Date<br>SEP - 6 2012 |
| Title<br>FIELD MANAGER                      |  |                      |
| Office<br>CARLSBAD FIELD OFFICE             |  |                      |

Application approval does not warrant or certify that the applicant holds legal or equitable title to those rights in the subject lease which would entitle the applicant to conduct operations thereon.  
Conditions of approval, if any, are attached

APPROVAL FOR TWO YEARS

Title 18 U.S.C. Section 1001 and Title 43 U.S.C. Section 1212, make it a crime for any person knowingly and willfully to make to any department or agency of the United States any false, fictitious or fraudulent statements or representations as to any matter within its jurisdiction.

(Continued on page 2)

\*(Instructions on page 2)

Roswell Controlled Water Basin

NMOCA: Must be in compliance  
w/ Rule 5.9 before placing well  
on production  
SEE ATTACHED FOR  
CONDITIONS OF APPROVAL

Approval Subject to General Requirements  
& Special Stipulations Attached

### OPERATOR CERTIFICATION

I hereby certify that I, or someone under my direct supervision, have inspected the drill site and access route proposed herein; that I am familiar with the conditions that presently exist; that I have full knowledge of State and Federal laws applicable to this operation; that the statements made in this APD package are, to the best of my knowledge, true and correct; and that the work associated with the operations proposed herein will be performed in conformity with this APD package and the terms and conditions under which it is approved. I also certify that I, or the company I represent, am responsible for the operations conducted under this application. These statements are subject to the provisions of 18 U.S.C. 1001 for the filing of false statements. Executed this 21<sup>st</sup> day of May, 2012.

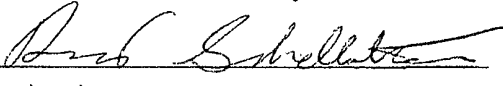
Name: David Schellstede   
Position: Reservoir Management Team Leader  
Address: 5 Greenway Plaza, Suite 110, Houston, TX 77046  
Telephone: 713-366-5013  
E-mail: (optional): david\_schellstede@oxy.com  
Company: OXY USA WTP Limited Partnership  
Field Representative (if not above signatory): Dusty Weaver  
Address (If different from above): P.O. Box 50250 Midland, TX 79710  
Telephone (if different from above): 432-685-5723  
E-mail (if different from above): calvin\_weaver@oxy.com

DISTRICT I  
1625 N. French Dr., Hobbs, NM 88240  
Phone: (575) 393-6161 Fax: (575) 393-0720

DISTRICT II  
611 S. First St., Artesia, NM 88210  
Phone: (575) 748-1283 Fax: (575) 748-9720

DISTRICT III  
1000 Rio Arriba Road, Aztec, NM 87410  
Phone: (505) 334-6178 Fax: (505) 334-6170

DISTRICT IV  
1220 S. St. Francis Dr., Santa Fe, NM 87505  
Phone: (505) 476-3460 Fax: (505) 476-3462

State of New Mexico  
Energy, Minerals & Natural Resources Department  
OIL CONSERVATION DIVISION  
1220 South St. Francis Dr.  
Santa Fe, New Mexico 87505

Form C-102  
Revised August 1, 2011  
Submit one copy to appropriate  
District Office

AMENDED REPORT

WELL LOCATION AND ACREAGE DEDICATION PLAT

|                                   |   |  |
|-----------------------------------|---|--|
| API Number<br><b>30-015-70670</b> | Pool Code<br><b>96830</b>                               | Pool Name<br><b>Artesia, Glorieta-Yeso (O)</b> |
| Property Code<br><b>39440</b>     | Property Name<br><b>PIGLET 21 FEDERAL</b>               | Well Number<br><b>13</b>                       |
| GRID No<br><b>192463</b>          | Operator Name<br><b>OXY USA WTP Limited Partnership</b> | Elevation<br><b>3602'</b>                      |

Surface Location

| UL or lot No. | Section | Township | Range | Lot Idn | Feet from the | North/South line | Feet from the | East/West line | County |
|---------------|---------|----------|-------|---------|---------------|------------------|---------------|----------------|--------|
| A             | 21      | 17-S     | 28-E  |         | 965           | NORTH            | 1038          | EAST           | EDDY   |

Bottom Hole Location If Different From Surface

| UL or lot No. | Section | Township | Range | Lot Idn | Feet from the | North/South line | Feet from the | East/West line | County |
|---------------|---------|----------|-------|---------|---------------|------------------|---------------|----------------|--------|
|               |         |          |       |         |               |                  |               |                |        |

|                              |                 |                    |                              |
|------------------------------|-----------------|--------------------|------------------------------|
| Dedicated Acres<br><b>40</b> | Joint or Infill | Consolidation Code | Order No.<br><b>9/6 5300</b> |
|------------------------------|-----------------|--------------------|------------------------------|

NO ALLOWABLE WILL BE ASSIGNED TO THIS COMPLETION UNTIL ALL INTERESTS HAVE BEEN CONSOLIDATED OR A NON-STANDARD UNIT HAS BEEN APPROVED BY THE DIVISION

|  |  |   |
|--|--|---|
| <p>GEODETIC COORDINATES<br/>NAD 27 NME</p> <p>SURFACE LOCATION<br/>Y=563633.1 N<br/>X=548628.4 E<br/>LAT.=32.824315° N<br/>LONG.=104.175032° W</p>                   | <p>DETAIL</p> <p>3597.2' 3597.7'</p> <p>600'</p> <p>600'</p> <p>3598.1' 3597.2'</p> <p>1038'</p> <p>SEE DETAIL</p> | <p>OPERATOR CERTIFICATION</p> <p>I hereby certify that the information herein is true and complete to the best of my knowledge and belief, and that this organization either owns a working interest or unleased mineral interest in the land including the proposed bottom hole location or has a right to drill this well at this location pursuant to a contract with an owner of such mineral or working interest, or to a voluntary pooling agreement or a compulsory pooling order heretofore entered by the division.</p> <p><i>Jennifer Duarte</i> 7/13/12<br/>Signature Date</p> <p>Jennifer Duarte<br/>Printed Name</p> <p>jennifer_duarte@oxy.com<br/>E-mail Address</p> |
| <p>OPERATOR: Please do not report production under this pool id code until OCD confirms perfs and appropriate pool designation on completion and C104 approvals.</p> |  | <p>SURVEYOR CERTIFICATION</p> <p>I hereby certify that the well location shown on this plat was plotted from field notes of actual surveys made by me or under my supervision, and that the same is true and correct to the best of my belief.</p> <p>APRIL 27, 2012<br/>Date of Survey</p> <p><i>Ronald J. Eidson</i><br/>Signature &amp; Seal of Professional Surveyor</p> <p>RONALD J. EIDSON<br/>NEW MEXICO<br/>3239<br/>REGISTERED PROFESSIONAL SURVEYOR<br/>Certificate Number 12641<br/>Eidson 3239<br/>ACR WSC W.O. 12.11.0692</p>  |

# APD DATA – DRILLING PLAN –

OPERATOR NAME / NUMBER: OXY USA WTP Limited Partnership

LEASE NAME / NUMBER: Piglet 21 Federal 13

STATE: NM COUNTY: Eddy

SURFACE LOCATION: 965' FNL & 1038' FEL, Sec 21, T17S, R28E

C-102 PLAT APPROX GR ELEV: 3602'

EST KB ELEV: 3616' (14' KB)

## 1. GEOLOGIC NAME OF SURFACE FORMATION

a. Permian

## 2. ESTIMATED TOPS OF GEOLOGICAL MARKERS & DEPTHS OF ANTICIPATED FRESH WATER, OIL OR GAS

| Formation           | TV Depth Top | Expected Fluids |
|---------------------|--------------|-----------------|
| Rustler             | 100          | Fresh Water     |
| Top of Salt         | 310          | -               |
| Base of Salt        | 390          | -               |
| Yates               | 410          | -               |
| Seven Rivers        | 604          | -               |
| Queen               | 1170         | -               |
| Grayburg            | 1640         | Oil             |
| San Andres          | 1749         | Oil/Water       |
| Glorietta           | 3350         | Oil             |
| Paddock             | 3440         | Oil             |
| Blinberry           | 3900         | Oil             |
| Tubb – Base of Yeso | 4820         | Oil             |
| Drinkard            | 4965         | -               |
| TD                  | 5300         | TD              |

A. Fresh Water formations will be covered with the 16" conductor pipe, which will be set at 120' prior to spud.

GREATEST PROJECTED TD 5300' MD / 5300' TVD OBJECTIVE: Yeso

## 3. CASING PROGRAM

Surface Casing: 9.625" casing set at ± 450' MD/ 450' TVD in a 12.25" hole filled with 8.4 ppg mud

| Interval | Length | Wt | Gr   | Condition | Cplg | Coll Rating (psi) | Burst Rating (psi) | Jt Str (M-lbs) | ID (in) | Drift (in) | SF Coll | SF Burst | SF Ten |
|----------|--------|----|------|-----------|------|-------------------|--------------------|----------------|---------|------------|---------|----------|--------|
| 0'- 450' | 450'   | 36 | J-55 | New       | ST&C | 2020              | 3520               | 394            | 8.921   | 8.765      | 13.33   | 1.97     | 27.91  |

Using offset well information and Oxy Yeso State wells as reference, we have found lost circulation at depths up to 350'.

We would like to cover these zones by setting surface casing in the Yates before continuing. We also need to have surface casing at this depth in order to have sufficient kick tolerance to drill to TD.

Production Casing: 5.5" casing set at ± 5300' MD / 5300' TVD in a 7.875" hole filled with 9.2 ppg mud

| Interval  | Length | Wt | Gr   | Condition | Cplg | Coll Rating (psi) | Burst Rating (psi) | Jt Str (M-lbs) | ID (in) | Drift (in) | SF Coll | SF Burst | SF Ten |
|-----------|--------|----|------|-----------|------|-------------------|--------------------|----------------|---------|------------|---------|----------|--------|
| 0'- 5300' | 5300'  | 17 | L-80 | New       | LT&C | 6290              | 7740               | 338            | 4.892   | 4.767      | 2.48    | 3.86     | 4.37   |

Collapse and burst loads calculated using Stress Check with actual anticipated loads.

#### 4. CEMENT PROGRAM:

*\*See COA*

##### Surface Interval

| Interval                                      | Amount<br>sx | Ft of<br>Fill | Type  | Gal/Sk | PPG  | Ft <sup>3</sup> /sk | 24 Hr<br>Comp |
|---|--------------|---------------|---|--------|------|---------------------|---------------|
| <b>Surface (TOC: 0' - 450')</b>               |              |               |   |        |      |                     |               |
| <b>Lead:</b><br>0' - 450'<br>(150%<br>Excess) | 150          | 0'            | Premium Plus Cement:<br>94 lbm/sk Premium Plus Cement, 10<br>lbm/sk Cal-Seal 60, 0.125 lbm/sk Poly-E-<br>Flake, 10 lbm/sk Kol-Seal, 1 % Calcium<br>Chloride - Flake | 7.46   | 14.2 | 1.67                | 1290 psi      |
| <b>Tail:</b><br>0' - 450'<br>(150%<br>Excess) | 250          | 450'          | Premium Plus Cement:<br>94 lbm/sk Premium Plus Cement, 2 %<br>Calcium Chloride - Flake  | 6.39   | 14.8 | 1.35                | 2500 psi      |

##### Production Interval

| Interval   | Amount<br>sx | Ft of<br>Fill | Type   | Gal/Sk | PPG  | Ft <sup>3</sup> /sk | 24 Hr<br>Comp |
|--|--------------|---------------|--|--------|------|---------------------|---------------|
| <b>Production (TOC: 0' - 5300')</b>                |              |               |  |        |      |                     |               |
| <b>Lead:</b><br>0' - 3000'<br>(125 %<br>Excess)    | 600          | 3000'         | Halliburton Light Premium Plus:<br>5% Salt, 3 lbm/sk Kol-Seal, 0.125 lb/sx<br>Poly_E_Flake | 9.95   | 12.9 | 1.89                | 530 psi       |
| <b>Tail:</b><br>3000' - 5300'<br>(125 %<br>Excess) | 735          | 2300'         | 50/50 Poz Premium Plus:<br>3% Salt, 0.4% Halad @-322, 0.125 lb/sx<br>Poly E_Flake          | 5.64   | 14.5 | 1.24                | 980 psi       |

#### 5. PRESSURE CONTROL EQUIPMENT

**Surface: 0 - 450'** None.

**Production: 0 - 5300'** the minimum working pressure of the blowout preventer (BOP) and related equipment (BOPE) required to drill below the surface casing shoe shall be 3000 (3M) psi (including annular).

- The 11" 3000 psi blowout prevention equipment will be installed and operational after setting the 9 5/8" surface casing and the 9 5/8" SOW x 11" 3K conventional wellhead;
- The BOP and ancillary BOPE will be tested by a third party upon installation to the 9 5/8" 36# J-55 surface casing. All equipment will be tested to 250/3000 psi for 10 minutes except the annular, which will be tested to 70% of working pressure (2100 psi).
- The pipe rams will be functionally tested during each 24 hour period; the blind rams will be functionally tested on each trip out of the hole. These functional tests will be documented on the Daily Driller's Log. Other accessory equipment (BOPE) will include a safety valve and subs as needed to fit all drill strings, and a 2" kill line and 3 " choke line having a 3000 psi WP rating.
- See attached BOP & Choke manifold diagrams.
- Oxy requests a variance if Savanna 415 is used to drill this well to use a co-flex line between the BOP and choke manifold. See attached schematic.

Manufacturer: Hebei Ouya Ltd.

Serial Number: 1642343-04

Length: 39" Size: 3"

Ends: flanges

WP rating: 3000 psi

Anchors required by manufacturer: No

*See  
COA \**

## 6. MUD PROGRAM:

| Depth     | Mud Wt<br>ppg | Vis<br>Sec | Fluid Loss | Type System            |
|-----------|---------------|------------|------------|------------------------|
| 0 – 450'  | 9.6 – 10.0    | 27 – 30    | NC         | Fresh Water            |
| 450' – TD | 9.2 – 9.4     | 27 – 40    | 10 -20     | Brine Water / Salt Gel |

Remarks: Pump high viscosity sweeps as needed for hole cleaning. The mud system will be monitored visually/manually as well as with an electronic PVT. The necessary mud products for additional weight and fluid loss control will be on location at all times.

- A. Appropriately weighted mud will be used to isolate potential gas, oil, and water zones until such time as casing can be cemented into place for zonal isolation.

## 7. AUXILIARY WELL CONTROL AND MONITORING EQUIPMENT

- a. A Kelly cock will be in the drill string at all times.
- b. A full opening drill pipe stabbing valve having the appropriate connections will be on the rig floor unobstructed and readily accessible at all times.

## 8. LOGGING / CORING AND TESTING PROGRAM:

- A. Mud Logger: None.
- B. DST's: None.
- C. Open Hole Logs as follows: Triple combo for production section.

*\*See COA*

## 9. POTENTIAL HAZARDS:

- A. H2S detection equipment will be in operation after drilling out the surface casing shoe until the production casing has been cemented. Breathing equipment will be on location from drilling out the surface shoe until production casing is cemented. If H2S is encountered the operator will comply with Onshore Order #6.
- B. The bottomhole pressure is anticipated to be 2536 psi.
- C. No abnormal temperatures or pressures are anticipated. All personnel will be familiar with all aspects of safe operation of equipment being used to drill this well. Adequate flare lines will be installed off the mud/gas separator where gas may be flared safely.

## 10. ANTICIPATED STARTING DATE AND DURATION OF OPERATIONS

Road and location construction will begin after the BLM has approved the APD. Anticipated spud date will be as soon as possible after BLM approval and as soon as a rig will be available. Move in operations and drilling is expected to take 15 days. If production casing is run, then an additional 30 days will be needed to complete the well and construct surface facilities and/or lay flow lines in order to place well on production.

## 11. COMPANY PERSONNEL:

| Name            | Title                        | Office Phone |
|-----------------|------------------------------|--------------|
| Carlos Mercado  | Drilling Engineer            | 713-366-5418 |
| Luis Tarazona   | Drilling Engineer Supervisor | 713-366-5771 |
| Roger Allen     | Drilling Superintendent      | 713-215-7617 |
| Douglas Chester | Drilling Manager             | 713-366-5194 |

### BOP Diagram.

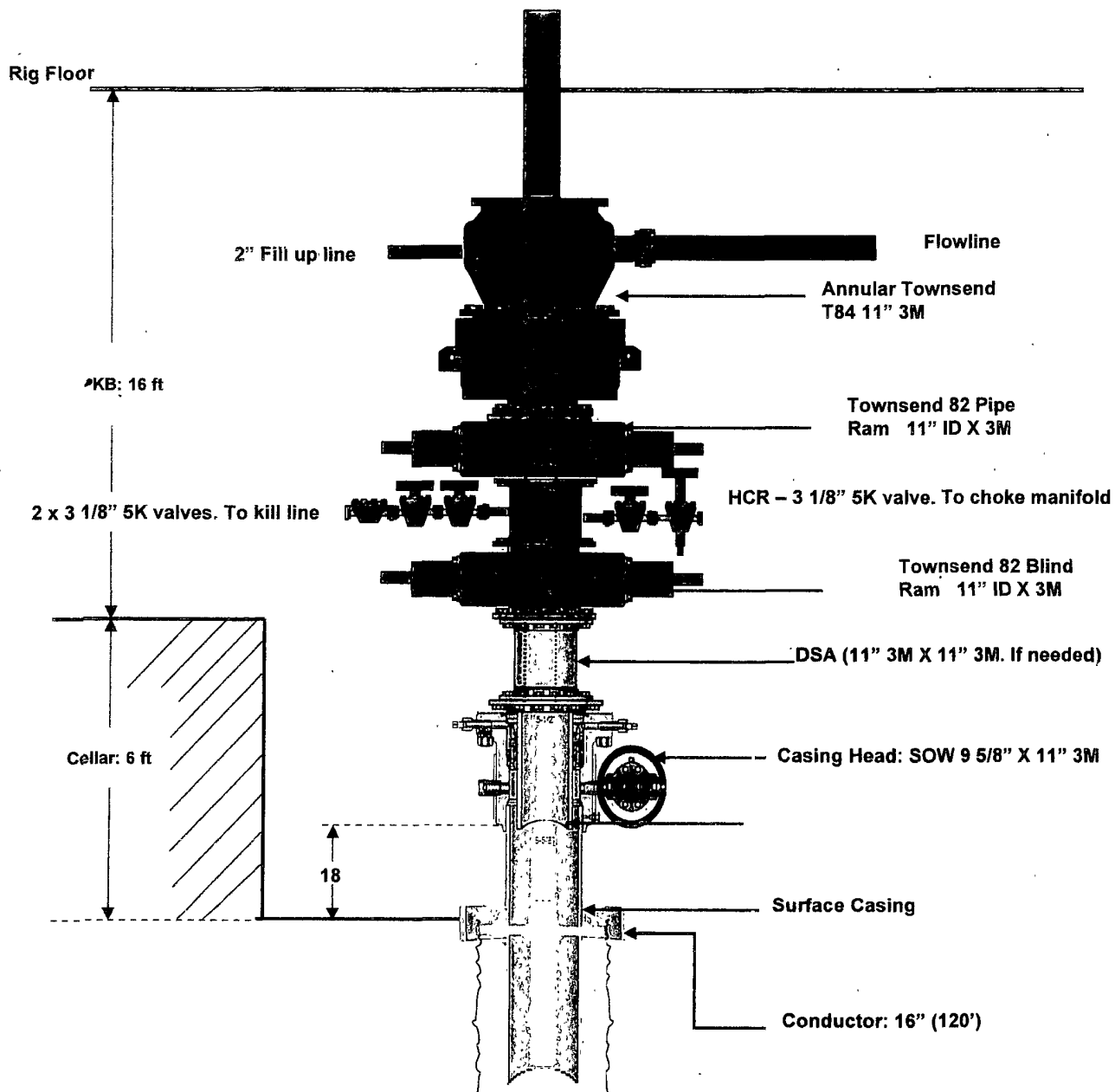

**3-1/8" x 2-1/16" 3000# NACE TRIM SINGLE GUT CHOKE & KILL MANIFOLD SYSTEM**

**August-06**

| ITEM | I.D. NO.       | DESCRIPTION  |
|------|----------------|--|
| 1    | 9053           | 2-1/16" 5000# BLIND FLANGE   |
| 2    | AR0605004      | 2-1/16" 5000# STUDDED CROSS  |
| 3    | AS0606009      | 2-1/16" 5000# CNV NACE TRIM GATE VALVE                                   |
| 4    | 9053           | 2-1/16" 5000# x 2" L.P. COMPANION FLANGE                                 |
| 5    | Q7082          | 2-1/16" 3000# x 8.562" O.A.L. FLANGED SPACER SPOOL                       |
| 6    | AS0606003      | 2-1/16" 5000# CNV NACE TRIM GATE VALVE                                   |
| 7    | A0445          | 3-1/8" x 3-1/8" x 2-1/16" x 2-1/16" 3000# STUDDED CROSS                  |
| 8    | AS0606119      | 3-1/8" 3000# CNV NACE TRIM GATE VALVE                                    |
| 9    | F3323          | 3-1/8" 3000# x 3" L.P. COMPANION FLANGE                                  |
| 10   | AS0606004      | 2-1/16" 5000# CNV NACE TRIM GATE VALVE                                   |
| 11   | Q7082          | 2-1/16" 3000# x 3.312" O.A.L. SOLID SPACER SPOOL                         |
| 12   | AR0605007      | 2-1/16" 5000# STUDDED CROSS  |
| 13   | AS0606005      | 2-1/16" 5000# CNV NACE TRIM GATE VALVE                                   |
| 14   | 9053           | 2-1/16" 5000# x 2" L.P. COMPANION FLANGE                                 |
| 15   | 9053           | 2-1/16" 5000# BLIND FLANGE   |
| 16   | AS0606007      | 2-1/16" 5000# CNV NACE TRIM GATE VALVE                                   |
| 17   | Q7082          | 2-1/16" 3000# x 7" O.A.L. DOUBLE STUDDED SPACER SPOOL                    |
| 18   | 1091200-1-1130 | 2-1/16" 5000# CORTEC "CM-2" ADJUSTABLE CHOKE c/w 2 x 0.75" CERAMIC DISCS |
| 19   | AS0606006      | 2-1/16" 5000# CNV NACE TRIM GATE VALVE                                   |
| 20   | A0441          | 3-1/8" x 3-1/8" x 2-1/16" x 2-1/16" x 2-1/16" 3000# 5- WAY STUDDED BLOCK |
| 21   | AS0606118      | 3-1/8" 3000# CNV NACE TRIM GATE VALVE                                    |
| 22   | 51209          | 3-1/8" 3000# x 10.5" O.A.L. FLANGED SPACER SPOOL                         |
| 23   | AS0606001      | 2-1/16" 5000# CNV NACE TRIM GATE VALVE                                   |
| 24   | Q7082          | 2-1/16" 3000# x 4.733" O.A.L. SOLID SPACER SPOOL                         |
| 25   | 1091200-1-1137 | 2-1/16" 5000# CORTEC "CM-2" ADJUSTABLE CHOKE c/w 2 x 0.75" CERAMIC DISCS |
| 26   | Q7082          | 2-1/16" 3000# x 7" O.A.L. DOUBLE STUDDED SPACER SPOOL                    |
| 27   | AS0606008      | 2-1/16" 5000# CNV NACE TRIM GATE VALVE                                   |
| 28   | AS0606002      | 2-1/16" 5000# CNV NACE TRIM GATE VALVE                                   |
| 29   | 9053           | 2-1/16" 5000# x 2" L.P. COMPANION FLANGE                                 |

**ONE**



## 3M CHOKE MANIFOLD CONFIGURATION

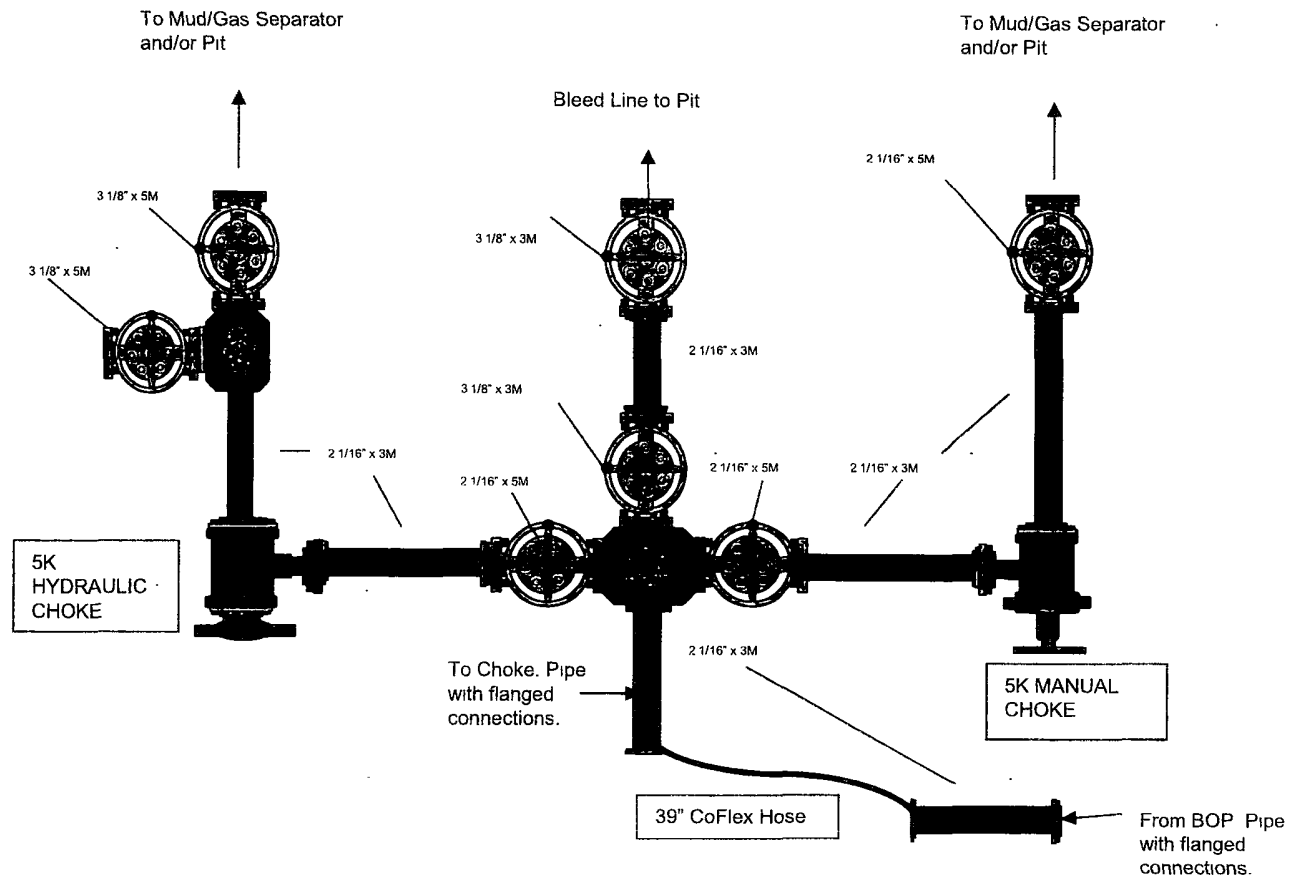

# 3M REMOTE KILL LINE SCHEMATIC

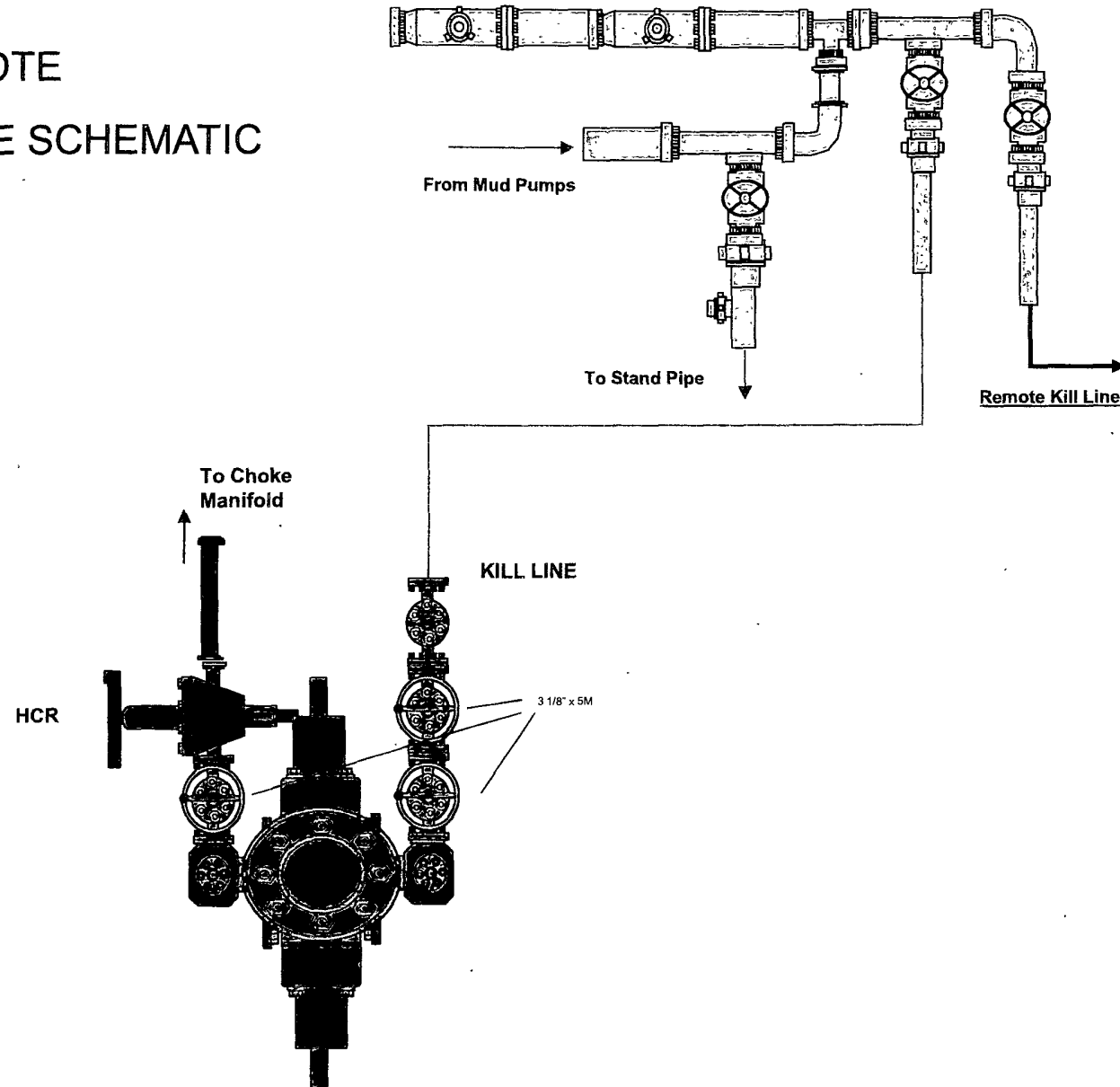

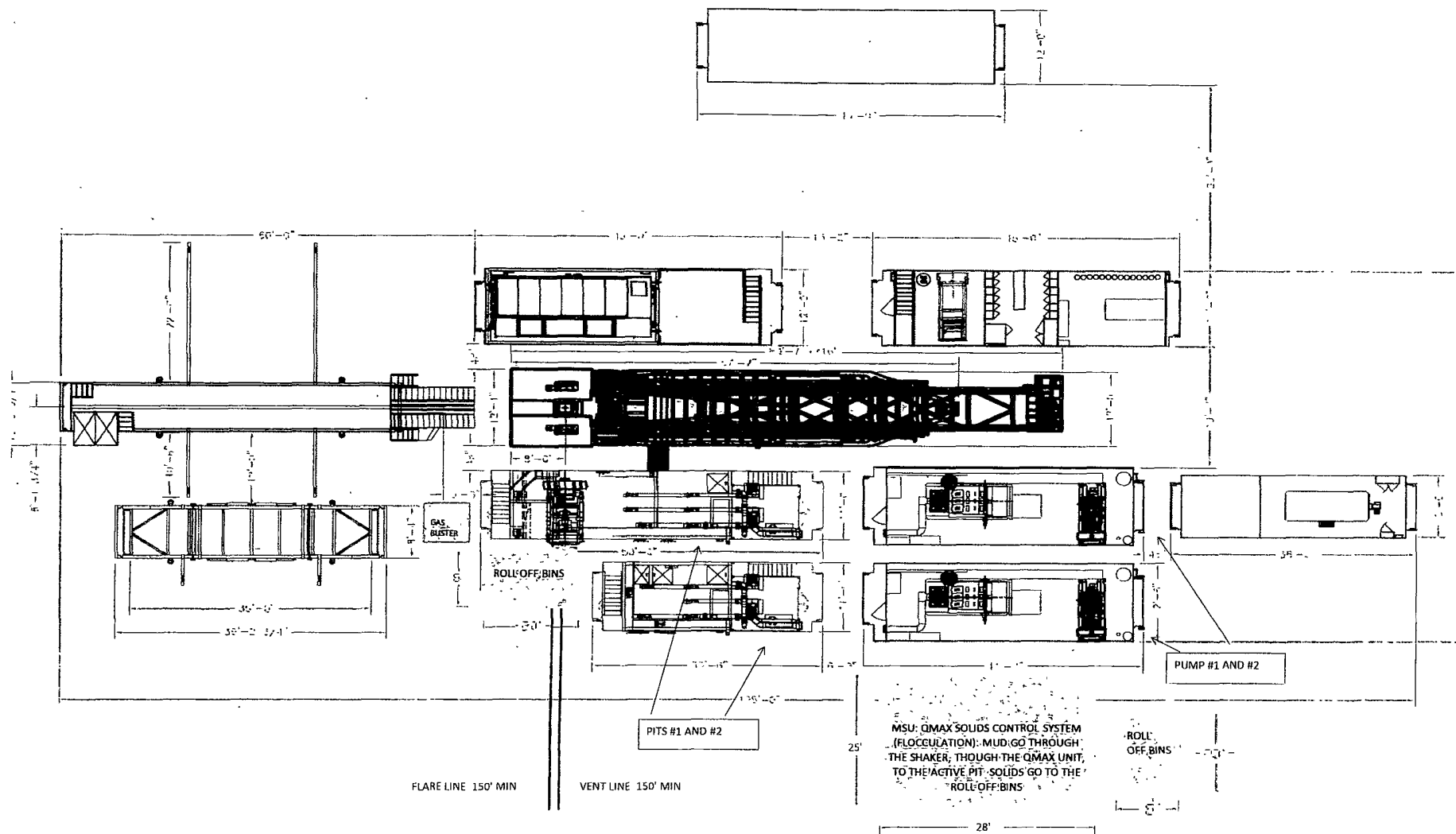



**TDS3000**

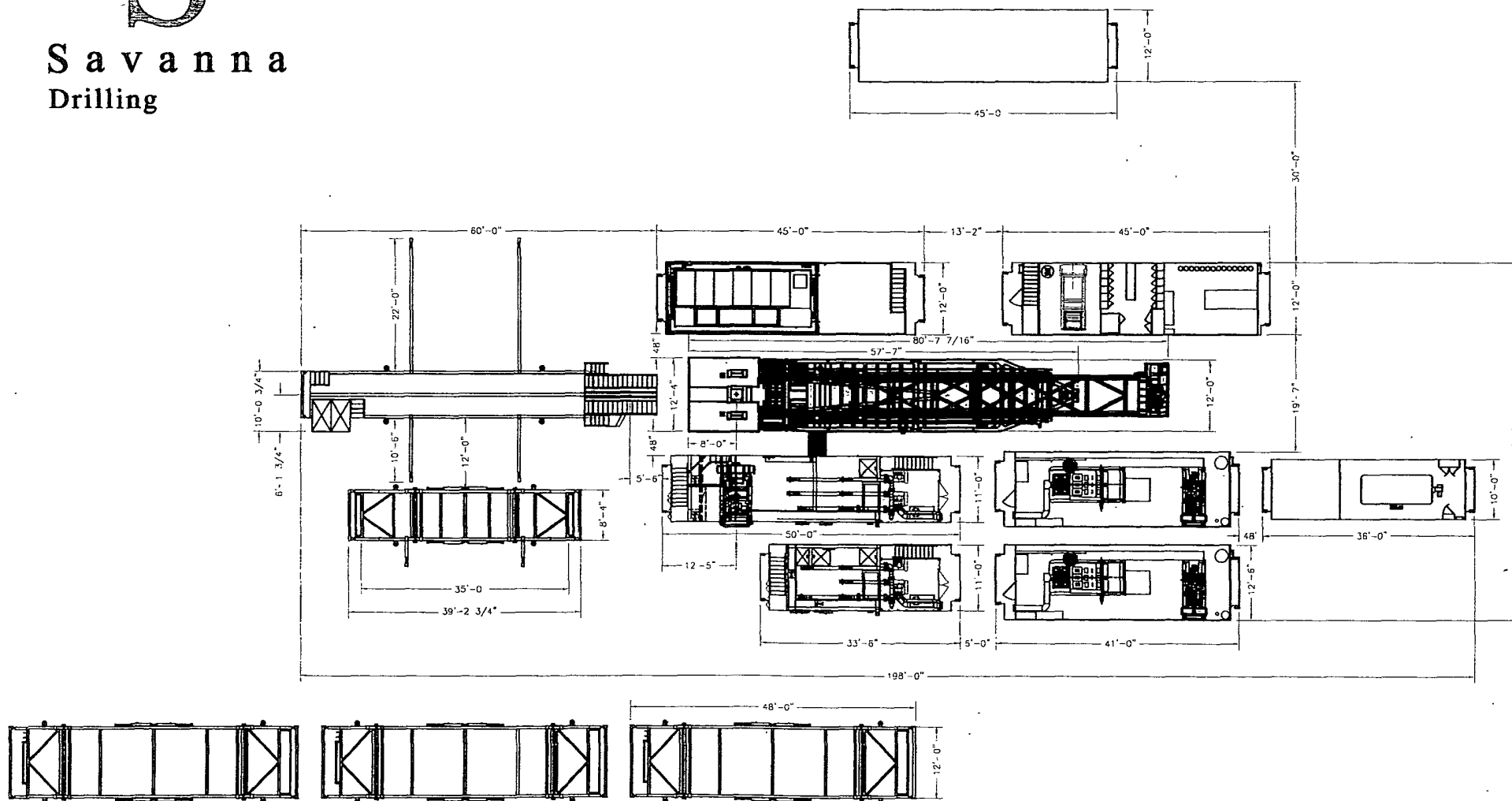

MANIFOLD

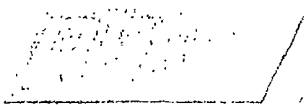

GEORGE MYER/KEMPER REBUILT

9727 47th Ave  
Edmonton, AB T6E 5M7  
780-437-2630

## Certificate of Compliance

Date: 2011-12-01  
Item Desc: REDL-SLIM-48x39IN-FIG1502  
Asset #: 1642343-04  
Chip ID: NOCHIPID  
Owner: Commercial Solutions INC (103867)

Test#:  
Initial Location:  
Site\2714 5 ST

Tested by: Dave Penner

Witnessed by: Ben Ahlskog

### Item Attributes:

|                   |                            |
|-------------------|----------------------------|
| Serial Number     | 1642343-04                 |
| Manufacturer      | HEBEI OUYA LTD.            |
| Application Group | SLIMHOLE                   |
| Model             | REDL-SLIMHOLE-3000-48      |
| Date of Mfr       |                            |
| Date Installed    | 2011-12-01                 |
| Locn Desc         |                            |
| Inside Dia.       | 3 IN                       |
| Length            | 39 IN                      |
| Working Pressure  | 3000 PSI                   |
| Test Pressure     | 4500 PSI                   |
| Coupling A        | 948HX+48B/FIG1502-HU-48    |
| Attach Method A   | Swaged                     |
| Coupling A Model  | GEORGE MYER/KEMPER REBUILT |
| Coupling B        | 948HX+48B/FIG1502-HU-48    |
| Attach Method B   | Swaged                     |
| Coupling B Model  | GEORGE MYER/KEMPER REBUILT |
| Distributor Ref # | 1642343-04                 |
| Factory Ref #     |                            |
| EndUser Ref #     |                            |
| Notes             | BUILT ON PO: JON           |

### Default Hose Certification

#### Test Notes

Hose passed all visual and physical inspections.

N/A

Continuity Test Results  
Continuity Ohm Reading  
Certification Result  
Generate Alert?  
Comments  
TimeStamp

PASS

2011-12-01 12:54:14 -07:00

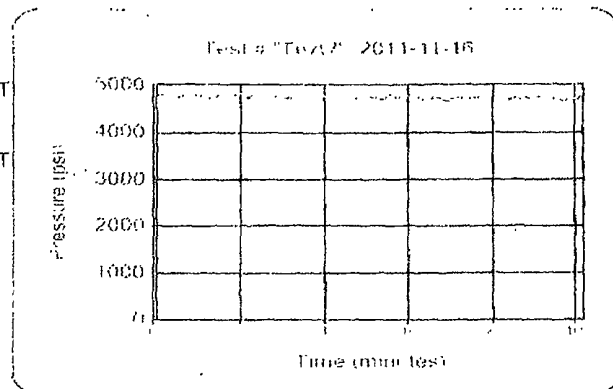

| REVISION |    |             |      |          |
|----------|----|-------------|------|----------|
| DATE     | BY | DESCRIPTION | DATE | APPROVED |

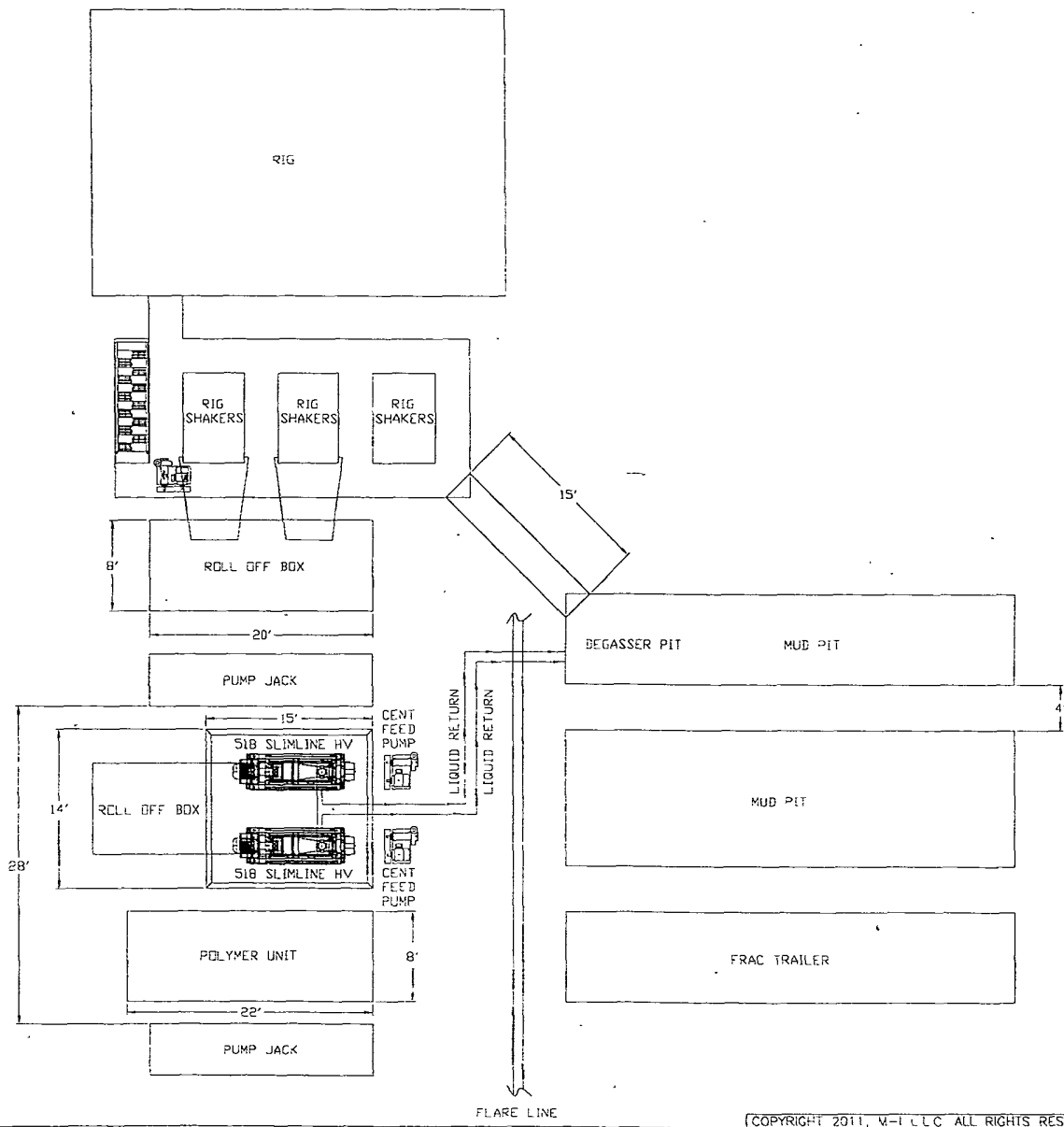

UNLESS OTHERWISE SPECIFIED:  
 DIMENSIONS ARE IN FEET  
 FINISHES ARE AS SHOWN  
 SURFACE SHALL BE TO  
 EXISTING GRADE UNLESS NOTED  
 TOLERANCES PER ASME Y14.5  
 UNLESS OTHERWISE SPECIFIED  
 DIMENSIONS ARE IN FEET  
 FINISHES ARE AS SHOWN  
 SURFACE SHALL BE TO  
 EXISTING GRADE UNLESS NOTED  
 TOLERANCES PER ASME Y14.5  
 UNLESS OTHERWISE SPECIFIED

3990 NORTH COURSE DRIVE HOUSTON, TEXAS 77072

H&P 345/OXY  
 SOLIDS CONTROL AND  
 DEWATERING PROPOSAL GA

|       |            |          |                  |       |        |
|-------|------------|----------|------------------|-------|--------|
| DATE  | 10-12-2011 | DWG NO.  | NALP-029-DWG-001 | REV   | -      |
| SCALE | NTS        | DRAWN BY | T. ANDERSON      | SHEET | 1 OF 1 |

**Savanna 415 - Vdoor South - No Road**  
**Piglet 21 Fed # 13**

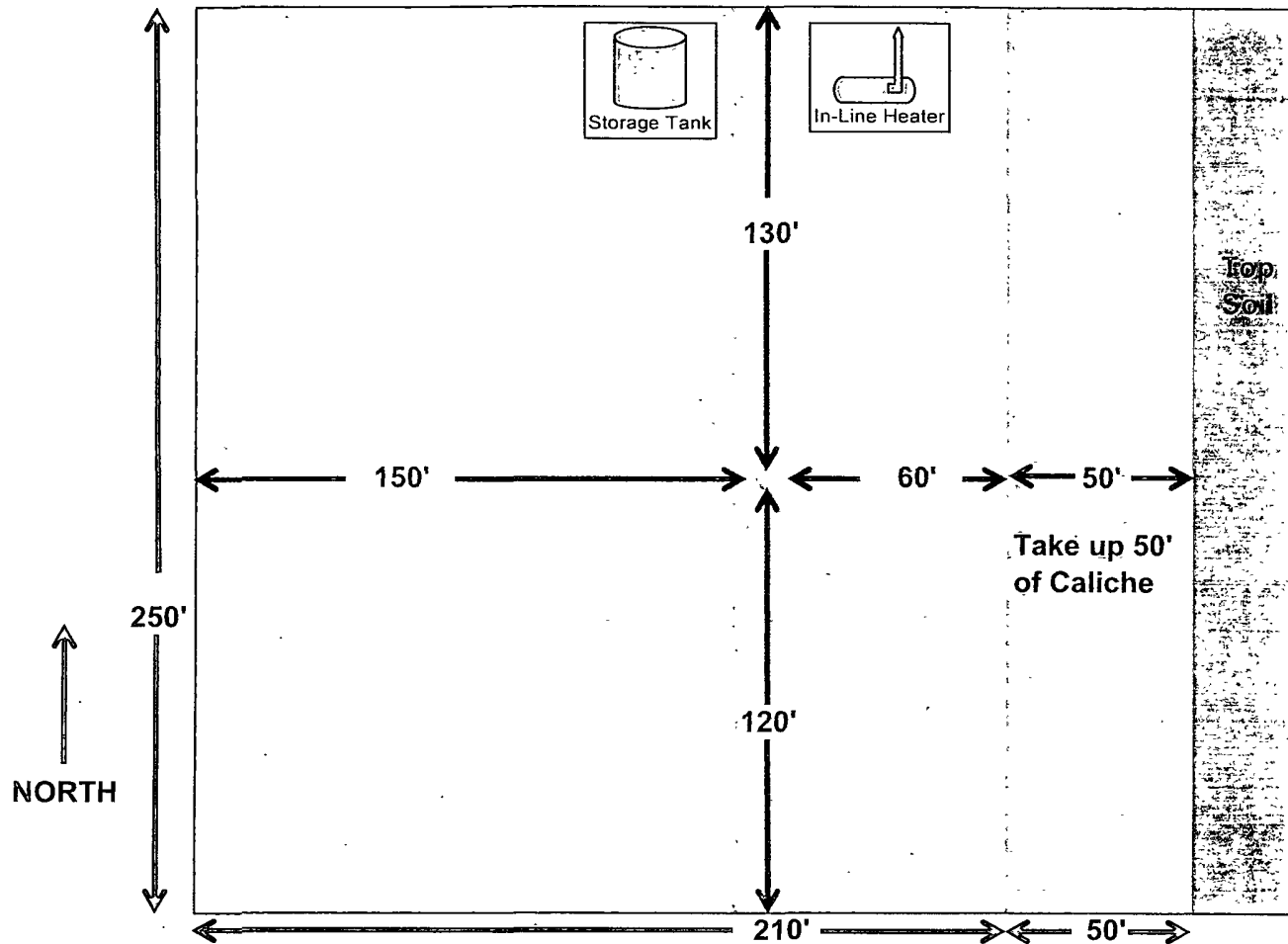

**Piglet 21 Fed # 13 Equipment List**

1 ea. In-Line Heater (30"x10').

1 ea. 300 bbl tank.

**Pipelines**

4" SDR 7 production flowline will be laid to the Piglet 21 Fed CTB

# Artesia Yesso Federal Unit #6 Facilities Layout

All Units in Feet

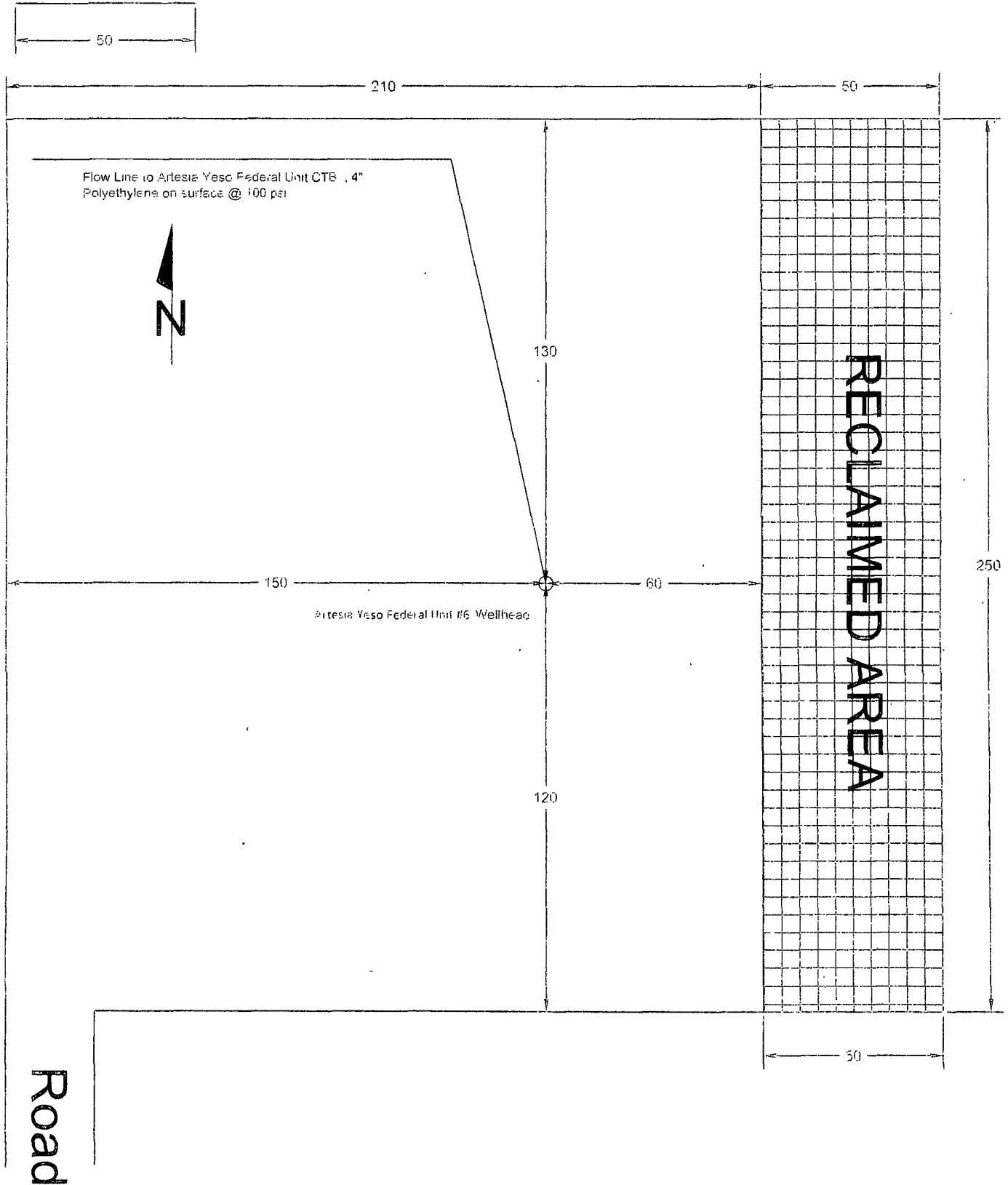



## PECOS DISTRICT CONDITIONS OF APPROVAL

|                       |                                    |
|-----------------------|------------------------------------|
| OPERATOR'S NAME:      | OXY USA                            |
| LEASE NO.:            | NM048344                           |
| WELL NAME & NO.:      | 13 Piglet 21 Federal               |
| SURFACE HOLE FOOTAGE: | 965' FNL & 1038' FEL               |
| BOTTOM HOLE FOOTAGE:  | ' FL & ' FL                        |
| LOCATION:             | Section 21, T.17 S., R.28 E., NMPM |
| COUNTY:               | Eddy County, New Mexico            |

### TABLE OF CONTENTS

Standard Conditions of Approval (COA) apply to this APD. If any deviations to these standards exist or special COAs are required, the section with the deviation or requirement will be checked below.

- ☐ **General Provisions**
- ☐ **Permit Expiration**
- ☐ **Archaeology, Paleontology, and Historical Sites**
- ☐ **Noxious Weeds**
- ☒ **Special Requirements**
  - ROW application for flowline**
  - Cave/Karst
- ☐ **Construction**
  - Notification
  - Topsoil
  - Closed Loop System
  - Federal Mineral Material Pits
  - Well Pads
  - Roads
- ☐ **Road Section Diagram**
- ☒ **Drilling**
  - High/Karst Cave Potential
  - Logging Requirements
  - Waste Material and Fluids
- ☐ **Production (Post Drilling)**
  - Well Structures & Facilities
  - Pipelines
  - Electric Lines
- ☐ **Interim Reclamation**
- ☐ **Final Abandonment & Reclamation**