

District I
1625 N. French Dr., Hobbs, NM 88240
District II
1301 W. Grand Avenue, Artesia, NM 88210
District III
1000 Rio Brazos Road, Aztec, NM 87410
District IV
1220 S. St. Francis Dr., Santa Fe, NM 87505

State of New Mexico
Energy Minerals and Natural Resources

Oil Conservation Division
1220 South St. Francis Dr.
Santa Fe, NM 87505

Form C-144
June 1, 2004

For drilling and production facilities, submit to appropriate NMOCD District Office.
For downstream facilities, submit to Santa Fe office

Pit or Below-Grade Tank Registration or Closure

Is pit or below-grade tank covered by a "general plan"? Yes ☒ No ☐
Type of action: Registration of a pit or below-grade tank ☐ Closure of a pit or below-grade tank ☒

Operator: <u>Yates Petroleum Corporation</u> Telephone: <u>505-748-4500</u> e-mail address: <u>mikes@ypc.com</u>		
Address: <u>105 South 4th Street, Artesia, N.M. 88210</u>		
Facility or well name: <u>Horn YG Federal Com 4</u> API #: <u>30-005-63680</u> U/L or Qtr/Qtr <u>I</u> Sec <u>7</u> T <u>8S</u> R <u>26E</u>		
County: <u>Chaves</u> Latitude <u>33.63207</u> Longitude <u>104.33013</u> NAD: 1927 <input type="checkbox"/> 1983 <input checked="" type="checkbox"/>		
Surface Owner: Federal <input checked="" type="checkbox"/> State <input type="checkbox"/> Private <input type="checkbox"/> Indian <input type="checkbox"/>		
Pit Type: Drilling <input checked="" type="checkbox"/> Production <input type="checkbox"/> Disposal <input type="checkbox"/> Work over <input type="checkbox"/> Emergency <input type="checkbox"/> Lined <input checked="" type="checkbox"/> Unlined <input type="checkbox"/> Liner type: Synthetic <input checked="" type="checkbox"/> Thickness <u>12</u> mil Clay <input type="checkbox"/> Pit Volume <u>12,000</u> bbl	Below-grade tank Volume: <input type="text"/> bbl Type of fluid: <input type="text"/> Construction material: <input type="text"/> Double-walled, with leak detection? Yes <input type="checkbox"/> If not, explain why not: <input type="text"/>	RECEIVED JUL 11 2005 DOB-ARTESIA
Depth to ground water (vertical distance from bottom of pit to seasonal high water elevation of ground water.)	Less than 50 feet 50 feet or more, but less than 100 feet 100 feet or more	(20 points) (10 points) XXXX (0 points)
Wellhead protection area: (Less than 200 feet from a private domestic water source, or less than 1000 feet from all other water sources.)	Yes No	(20 points) (0 points) XXXX
Distance to surface water: (horizontal distance to all wetlands, playas, irrigation canals, ditches, and perennial and ephemeral watercourses.)	Less than 200 feet 200 feet or more, but less than 1000 feet 1000 feet or more	(20 points) (10 points) (0 points) XXXX
Ranking Score (Total Points)		10 POINTS

If this is a pit closure: (1) Attach a diagram of the facility showing the pit's relationship to other equipment and tanks. (2) Indicate disposal location: (check the onsite box if you are burying in place) onsite ☒ offsite ☐ If offsite, name of facility NA. (3) Attach a general description of remedial action taken including remediation start date and end date.
(4) Groundwater encountered: No ☐ Yes ☐ If yes, show depth below ground surface ft. and attach sample results.
(5) Attach soil sample results and a diagram of sample locations and excavations.

Additional Comments: Closure work plan for encapsulation trench. The drilling pit contents will be mixed to stiffen the pit contents. Encapsulation trench will be excavated and lined with a 12 mil. Synthetic liner on former drilling pit site. Drilling pit contents will then be emplaced into the encapsulation trench. A 20 mil. Synthetic liner will then be placed over the pit contents with a min. of a 3' over lap of the underlying trench areas. The encapsulation trenches will then be backfilled back to grade using a min. of 3' of clean soil and like material. A one call & 48 hour notice will be provided to the Oil Conservation Division before pit closure actions begin.

Pit Closure actions to begin by NA. Ending date NA

I hereby certify that the information above is true and complete to the best of my knowledge and belief. I further certify that the above-described pit or below-grade tank has been/will be constructed or closed according to NMOCD guidelines ☐, a general permit ☒, or an (attached) alternative OCD-approved plan ☐.

Date: 07/08/2005

Printed Name/Title Dan Dolan / Regulatory Agent

Signature 

Your certification and NMOCD approval of this application/closure does not relieve the operator of liability should the contents of the pit or tank contaminate ground water or otherwise endanger public health or the environment. Nor does it relieve the operator of its responsibility for compliance with any other federal, state, or local laws and/or regulations.

Approval:

Field Supervisor

Printed Name/Title

Signature 

Date:

JUL 12 2005

New Mexico Office of the State Engineer
Well Reports and Downloads

Alonzo G. Federal Com 4

Township: 08S Range: 25E Sections:

NAD27 X: Y: Zone: Search Radius:

County: Basin: Number: Suffix:

Owner Name: (First) (Last) ☐ Non-Domestic ☐ Domestic
☒ All

Well / Surface Data Report

Avg Depth to Water Report

Water Column Report

Clear Form

WATERS Menu

Help

AVERAGE DEPTH OF WATER REPORT 07/08/2005

Bsn	Tws	Rng	Sec	Zone	X	Y	Wells	(Depth Water in Feet)		
								Min	Max	Avg
RA	08S	25E	01				1	68	68	68
RA	08S	25E	09				1	109	109	109
RA	08S	25E	10				1	21	21	21
RA	08S	25E	31				2	35	78	57
RA	08S	25E	36				1	35	35	35

Record Count: 6

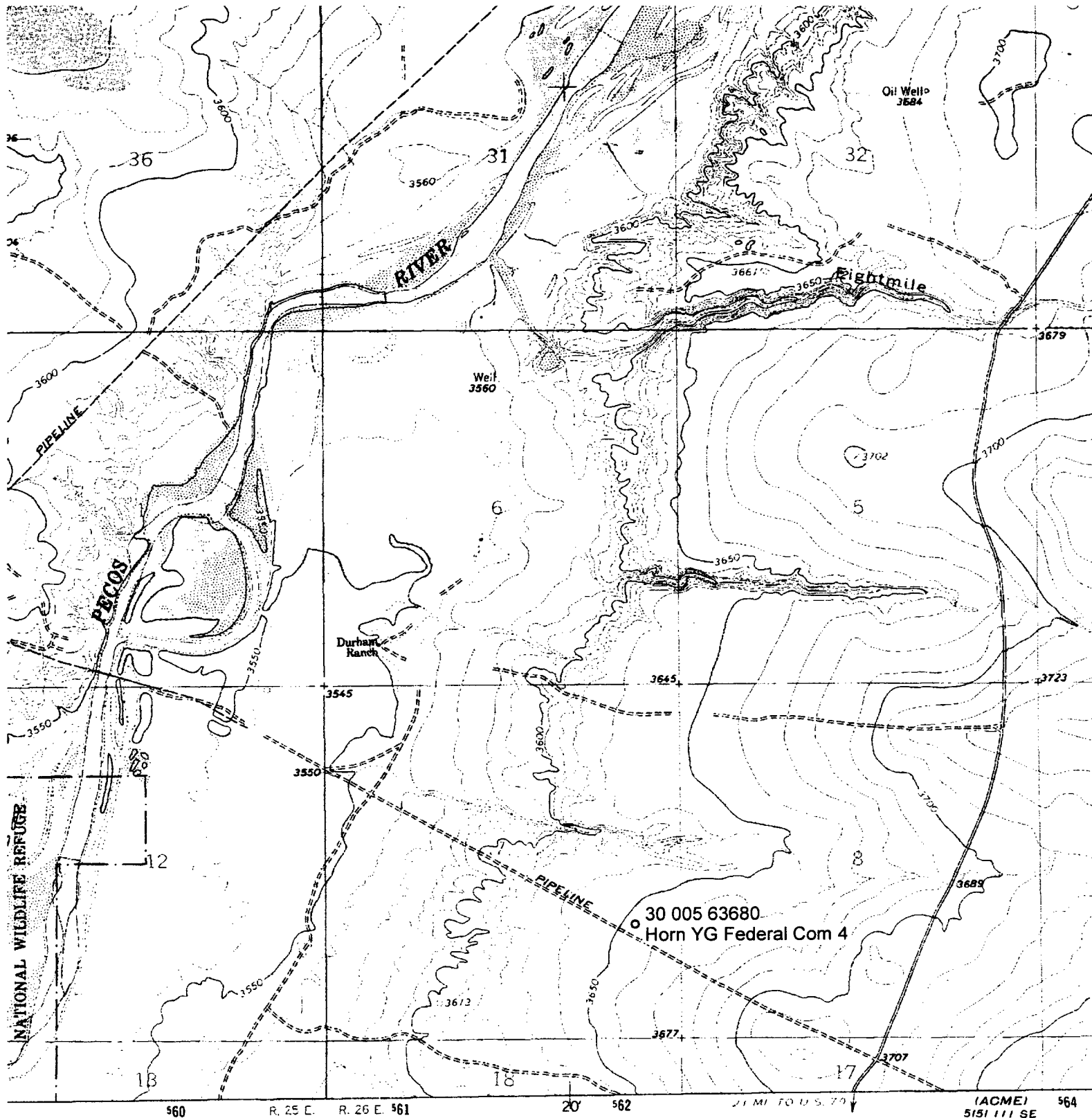

the Geological Survey

from aerial
1962

Contours based on New
30-meter Universal
shown in blue
in the predicted North
1 line 6 meters
red corner ticks

ice lines

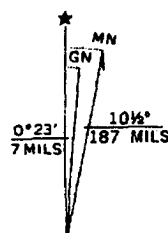

UTM GRID AND 1982 MAGNETIC NORTH
DECLINATION AT CENTER OF SHEET

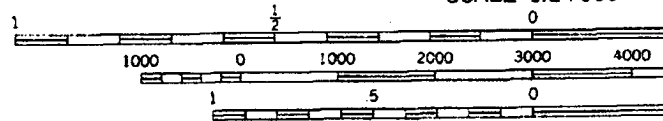

SCALE 1:24 000

CONTOUR INTERVAL 10 FE
DOTTED LINES REPRESENT 5-FOOT C
NATIONAL GEODETIC VERTICAL DATUM

THIS MAP COMPLIES WITH NATIONAL MAP ACC