

RECEIVED
UNITED STATES
DEPARTMENT OF THE INTERIOR
BUREAU OF LAND MANAGEMENT
JAN 07 2013
SUNDRY NOTICES AND REPORTS ON WELLS
Do not use this form for proposals to drill or to re-enter an abandoned well. Use Form 3160-2 (APD) for such proposals.

01788 NM, ARTESIA
811 S. FIRST STREET
ARTESIA, NM 88210

FORM APPROVED
OMB No. 1004-0137
Expires July 31, 2010

Please Serial No.
NM-10893
6. If Indian, Allottee or Tribe Name

SUBMIT IN TRIPLICATE - Other instructions on page 2.

1. Type of Well <input type="checkbox"/> Oil Well <input checked="" type="checkbox"/> Gas Well <input type="checkbox"/> Other		7. If Unit or CA/Agreement, Name and/or No.
2. Name of Operator Yates Petroleum Corporation		8. Well Name and No. Godfrey MP Federal #8
3a. Address 105 S. 4th Str., Artesia, NM 88210	3b. Phone No. (include area code) 575-748-1471	9. API Well No. 30-005-61312
4. Location of Well (Footage, Sec., T., R., M., OR Survey Description) 1980' FSL, 1980' FWL Sec 15-T7S-R25E (NESW)		10. Field and Pool or Exploratory Area Pecos Slope Abo
		11. County or Parish, State Chaves County

12. CHECK APPROPRIATE BOX(ES) TO INDICATE NATURE OF NOTICE, REPORT, OR OTHER DATA

TYPE OF SUBMISSION	TYPE OF ACTION			
<input type="checkbox"/> Notice of Intent	<input type="checkbox"/> Acidize	<input type="checkbox"/> Deepen	<input type="checkbox"/> Production (Start/Resume)	<input type="checkbox"/> Water Shut-Off
<input checked="" type="checkbox"/> Subsequent Report	<input type="checkbox"/> Alter Casing	<input type="checkbox"/> Fracture Treat	<input checked="" type="checkbox"/> Reclamation	<input type="checkbox"/> Well Integrity
<input type="checkbox"/> Final Abandonment Notice.	<input type="checkbox"/> Casing Repair	<input type="checkbox"/> New Construction	<input type="checkbox"/> Recomplete	<input checked="" type="checkbox"/> Other <u>Notice Letter</u>
	<input type="checkbox"/> Change Plans	<input type="checkbox"/> Plug and Abandon	<input type="checkbox"/> Temporarily Abandon	
	<input type="checkbox"/> Convert to Injection	<input type="checkbox"/> Plug Back	<input type="checkbox"/> Water Disposal	

13. Describe Proposed or Completed Operation: Clearly state all pertinent details, including estimated starting date of any proposed work and approximate duration thereof. If the proposal is to deepen directionally or recompleting horizontally, give subsurface locations and measured and true vertical depths of all pertinent markers and zones. Attach the Bond under which the work will be performed or provide the Bond No. on file with BLM/BIA. Required subsequent reports must be filed within 30 days following completion of the involved operations. If the operation results in a multiple completion or recompletion in a new interval, a Form 3160-4 must be filed once testing has been completed. Final Abandonment Notices must be filed only after all requirements, including reclamation, have been completed and the operator has determined that the site is ready for final inspection.

Re: NMNM-10893 Order No. 12TBS25W

Accepted for record
NMOCD *MB*

Environmental Problem No 1-Attached prior reclamation information, and re-seeded well pad on 8-30-12 using attached seed mix.

Environmental Problem No 2- Beth Skaggs contacted by Agave representative on 9-5-12. Any further communications regarding ROW will be address by Agave Pipeline.

Environmental Problem No 3- Access road reclaimed on 8-30-12 using same seed mix attached, and other items addressed completed.

ACCEPTED FOR RECORD

JAN 03 2013

14. I hereby certify that the foregoing is true and correct Name (Printed/Typed) Michelle Taylor		NAME <i>B Skaggs</i> NATURAL RESOURCE SPECIALIST	
Title Regulatory Reporting Mgr.		Date September 5, 2012	

THIS SPACE FOR FEDERAL OR STATE OFFICE USE

Approved by Conditions of approval, if any, are attached. Approval of this notice does not warrant or certify that the applicant holds legal or equitable title to those rights in the subject lease which would entitle the applicant to conduct operations thereon.	Title Office ROSWELL FIELD OFFICE	Date JAN 03 2013
--	--	----------------------------

Title 18 U.S.C. Section 1001 and Title 43 U.S.C. Section 1212, make it a crime for any person knowingly and willfully to make to any department or agency of the United States any false, fictitious or fraudulent statements or representations as to any matter within its jurisdiction

Curtis & Curtis, Inc.

4500 North Prince

Clovis, New Mexico 88101-9714

Phone: (575) 762-4759

Fax: (575) 763-4213

Sold To: B & B Backhoe
2708 West Ave
Artesia, NM 88210

Shipped *** SA
To:

Type: Sale	PO #:	Shipped: 01-Aug-11
Order #: 26309	Ordered: 01-Aug-11	Via: Customer
Spcl: .	Sold By: CH	FOB: FOB Clovis
DESCRIPTION		QUANTITY
Lot Code		
1	Sand Bluestem, Goldstriker 17312	SHIP 2.5 PLS
2	Little Bluestem, Pastura 17136	SHIP 2.5 PLS
3	Sideoats Grama, Vaughn 16670	SHIP 7.5 PLS
4	Sand Dropseed, Not Stated 16753	SHIP 7.5 PLS
5	Plains Bristlegrass, Not Stated 16692	SHIP 10.0 PLS
6	Desert Globe Mallow, Not Stated 17053	SHIP 2.5 PLS
7	Buckwheat, Mancan 16148	SHIP 2.5 PLS

5 Acre Sandy Plains CP-2 Mix, Package into 5 - 1 acre bags @
14.75 bulk pounds each.

A finance charge of 1.5% per month will be charged for account

We specialize in Investments that Grow.

Yates Petroleum Corp.
Pit Closure Report

Well Name	Godfrey MP Federal #8	Location	Sec 15-7S-25E
Contractor	Allicon/Wayne Grantham	Closure Type	P&A
Start Date	11/19/2007	Closure Date	12/14/2007

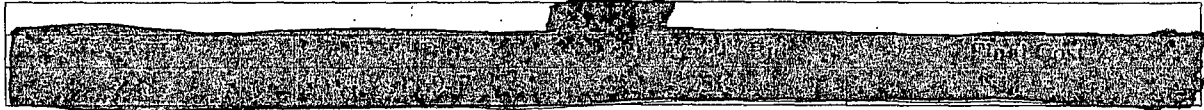

NOTES

STATUS

11/14/2007 Meet with BLM Rep. Paul Swartz on location. Went over the NOWO stipulations as required to close the P&A location. Mr. Swartz agreed to address the no vegetation over the closed drilling pit area by allowing the following actions. The closed drilling pit area will be disked, a 6" lift of soil taken from the location pad which will be placed over the DP area & disked into place. A second 6" lift of soil will be placed over the closed DP area & disked. The closed drilling pit area & the ripped location will be reseeded with the recommended BLM seed mixture for the site. There is a riser from the meter run which will require cut below ground level. The P&A marker is down on the ground & will require welding.

11/19/07 Start date with Alliacon/Wayne Grantham on location with equipment. The P&A marker were welded back in place. All above grade piping was cut below grade. The caliches was removed from the location & placed over the closed reserve pit area. The location was recon toured & a total of 18" of soil was placed onto the reserve pit area.

12/14/07 The location was ripped, 1/4 mile of the lease road was ripped, and Location and lease road were then reseeded. P&A location closure completed.

NO S. 10/10/07 RECEIVED

SEP 11 2007

MAIL ROOM

United States Department of the Interior



BUREAU OF LAND MANAGEMENT
Roswell Field Office
2909 West 2nd Street
Roswell, NM 88201-2019
September 6, 2007

CERTIFIED, RETURN RECEIPT REQUESTED.

RE: 7000 1530 0003 7692 0355

Yates Petroleum Corporation
105 S. 4th Street
Artesia, New Mexico 88210

Your federal property, Case: NM10893, API# 30005 61312, Well Name: Godfrey MP Federal #8 in T07S-R25E, NESW Sec 15, Chavez County, New Mexico is in need of preparation for surface disturbance reclamation. The listed guidelines (apply as appropriate) are intended to establish conditions that will enable and enhance natural recovery processes. The natural surface area disturbed by well operational activities and equipment is to blend into the surrounding terrain character and native plant community. The well marker is to be the only remaining surface evidence of past oil and gas exploration activity. That goal is to be achieved prior to Bureau of Land Management final approval of your surface abandonment efforts and may not be fully accomplished by compliance with this written order. The operator is responsible for monitoring reclamation progress and taking the necessary actions to ensure success.

1. CONTACT BLM
Paul R. Swartz, (505) 627-0258, three days prior to beginning work on this location, three days prior to prior to removal of heavy equipment from location.
2. EQUIPMENT
Remove associated well signs, tanks, treaters, separators, flow meters, electric meters, and all other above ground surface equipment. Empty and properly dispose of all the contents of vessels before movement is attempted.
3. PIPELINES AND FLOWLINES
All dormant pipeline risers, meters, and other above surface piping must be removed. Purge the contents of these lines prior to their removal with fresh water. Properly contain and dispose of those contents. The entire length of surface flowlines must be removed (from the location to the point of final destination). Inactive pipelines buried less than 24 inches are to be removed, and the ditch leveled. Unused pipelines buried 24 inches or more may be removed as above or purged of their contents with fresh water, cut off level with the line at both ends, welded shut, and the ditch leveled.
4. POWER LINES
Idle power lines and power poles (that have no immediate use in the area) must be removed (take up the conduit & lines buried less than 2 feet and level the ditch) back to the next active service power line junction.

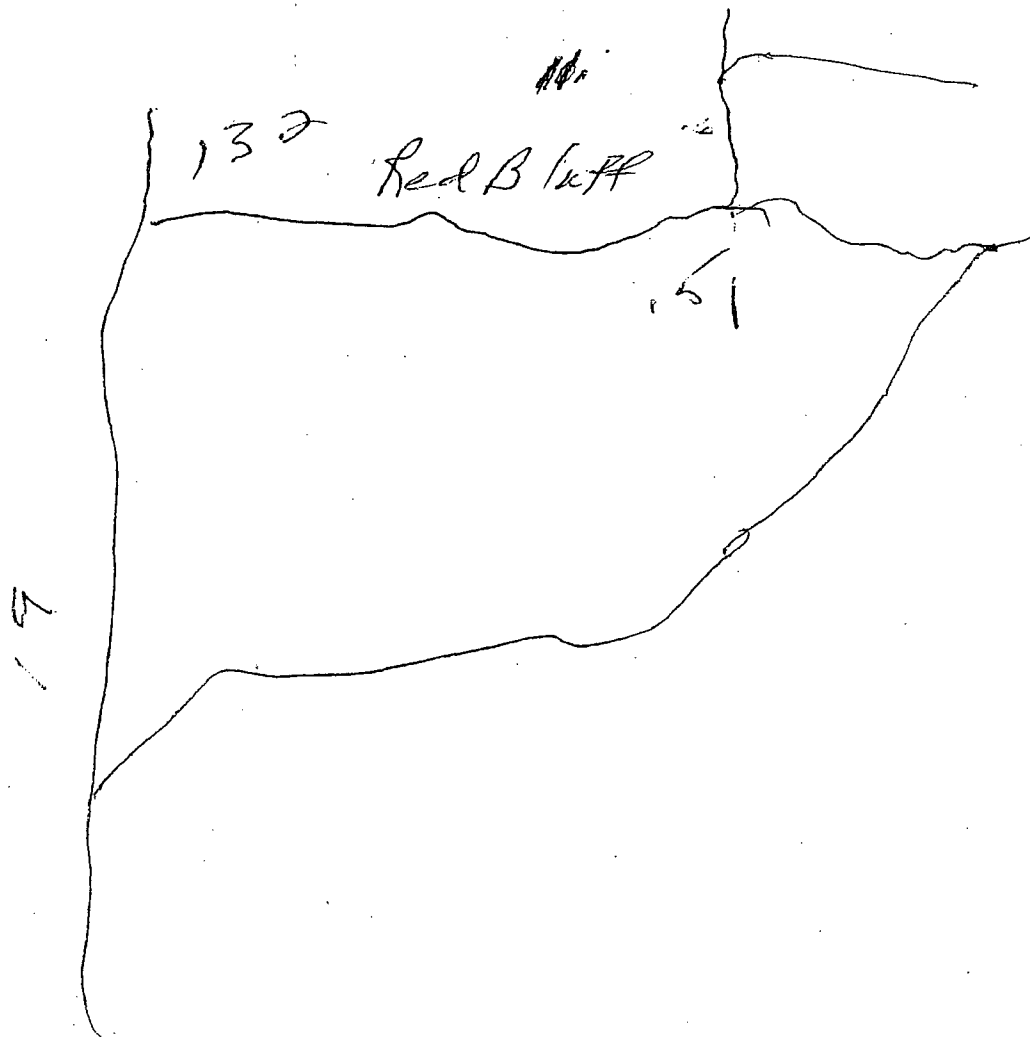

5. TRASH

Any and all posts, wire, concrete blocks, concrete slag, cables, thread protectors, equipment parts, anchor bolts, synthetic pit liner, other materials, and household trash on the surface area or within 2 feet of the area surface are to be removed and carried to an authorized landfill facility for disposal.

6. DRESS THE AREA

The operator must dispose of all soil that will inhibit native plant growth. This includes all soils affected by this well's drilling and operational activities. Reclaim to the Bureau of Land Management's APD Conditions of Approval and New Mexico Oil Commission Division standards. If permitted by NMOCD, (CERCLA) 42 USC 9605, (SARA) PL 99-499, and other applicable Federal and State Regulations, dry soil affected by this well's activity may be encapsulated in a 50' x 50' burial cell on this location. (Make it deep enough!) Take necessary precautions to prevent a pit liner from being ruptured. Contain the soil in 12 mil synthetic pit liner material. Place that material under, around, and folded over the top of the affected soil. Drape another sheet of the same material over the folds so as to shed water. This top sheet needs to be at least 3 feet below ground level. Submit GPS coordinates and elevations of the well bore and the top center of the encapsulated burial cell. Cover the burial cell with at least three feet of clean topsoil. Level, pack, and contour that topsoil to stabilize it to the surrounding area.

Strip caliche from the pad and any portion of this well's access road that will be obsolete for further use. Remove as much caliche as possible on the first pass. Caliche can be used to return this location to natural contours as fill, but not mixed with topsoil, nor used as topsoil. If not used as fill, it must be removed, to be used or properly stored. Dress the area (location, reserve pit and road) to natural soil character and contour of surrounding terrain. Reduce any cut-and-fill inclines to 1 to 3 (elevation to horizontal change) or less. Additional topsoil may be required.

Rip the final contour of the location and access road perpendicular to down slope drainage. Any large boulders pulled up during ripping are to be crushed, reburied on location, or removed. Install windrow(s) and/or erosion berm(s) on contour lines across the reclaimed area to help protect from loss of topsoil due to wind scouring or water erosion. The reclaimed area topsoil and plant growth must resemble that of surrounding undisturbed natural terrain. BLM may wish to inspect final dirt work prior to removal of reclamation equipment and witness the seeding process. Contact Joseph Navarro, (505) 627-0204, three days prior to seeding and confirm the seed mix and planting process.

7. RESEED THE AREA

Plant the area (using a drill equipped with a depth indicator set at ½ inch) with a soil appropriate certified weed free live seed mixture, use seed tested within nine months of planting in a container tagged in accordance with State law(s). Where drilling is not possible, the seed may be broadcast (doubling the pounds per acre) and the area raked or chained to cover the seed. Seeding should be timed to encourage germination and growth continuity.

Loamy, SD-3 Ecological Site, Loamy CP-2, and Gyp Upland CP-2

If one species is not available, increase all others proportionately. Use at least 4 species, including one forb. No less than 9.75 pounds per acre shall be applied.

<u>Common Name</u>	<u>Scientific Name</u>	<u>Lbs/Acre</u>
Blue grama,	(Bouteloua gracilis)	4.0
Sideoats grama,	(Bouteloua curtipendula)	1.0
Sand dropseed	(Sporobolus cryptandrus)	0.5
Vine mesquite	(Pañicum obtusum)	1.0
Plains bristlegrass	(Setaria macrostachya)	1.0
Indian blanketflower	(Gaillardia aristata)	0.5
Desert Globemallow or	(Sphaeralcea ambigua)	1.0
Scarlet Globemallow	(Sphaeralcea coccinea)	
Annual sunflower	(Helianthus annuus)	0.75
TOTAL POUNDS PURE LIVE SEED PER ACRE		9.75

Yates Petroleum Corporation is responsible for a diligent attempt to establish native growth on the disturbed surface area of this well. Noxious weed control may be necessary. Evaluation of seed growth may be made after the first growing season. The Authorized Officer reserves the right to require reseeding. If those attempts to replant (in satisfactory topsoil) fail due to lack of rain, the A O may waive this requirement. The expected eventual result is that the area will blend into the surrounding landform and vegetation such that the well marker is the only evidence of past oil and gas exploration activity.

8. PROTECT THE FINAL RECLAMATION WORK

All of the reclaimed surface areas must be adequately protected from trespass traffic by fence(s) and/or berm(s) long enough to eliminate traffic. Remove any cattle guard that serves only this well and rebuild the existing fence (a wire gate may be applicable) to facilitate protection of this reclamation work.

Authority Regulation(s): 43 CFR 3161.2, 43 CFR 3161.5-1(b), & 43 CFR 3162.1(a), 43 CFR 3162.3-4(c)
For regulation lookup quotes and forms, see: http://www.nm.blm.gov/oil_gas/og_index.html

A surface operating standard and guide line for oil and gas exploration and development "The Gold Book" may be requested on-line:

http://www.blm.gov/wo/st/en/prog/energy/oil_and_gas/best_management_practices/gold_book.html

Reference this number (0709PS01W) on Sundry Form 3160-5 briefly (include the well and burial cell GPS readings) describing your accomplishment of these **Written Orders**, mailed on or before **November 10, 2007**. Inspection and approval of the final surface abandonment reclamation will occur only after a Final Abandonment Notice is received by BLM.

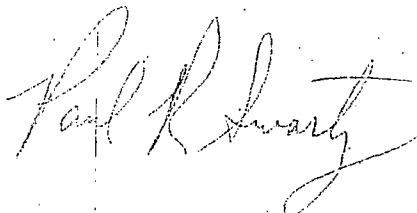

Paul R. Swartz
Petroleum Engineering Technician
505-627-0258 office
505-627-0207 fax
paul_swartz@nm.blm.gov

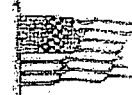

WARNING

The Authorized Officer has authority to issue a Written Order in accordance with (43 CFR 3163.2). Written Order correction and reporting time frames begin upon receipt of this Notice or 7 business dates after the date it is mailed, whichever is earlier. Each condition, within the text of this Notice, of concern must be corrected within the prescribed time from receipt of the Notice and reported to the Bureau of Land management office at the address shown above. All self-certified statements of compliance must be postmarked no later than the next business day after the prescribed day for resolution. If you do not comply as noted, you shall be issued an Incident of Noncompliance (INC) in accordance with 43 CFR 3163.1(a). Failure to comply with the INC may result in assessments as outlined in 43 CFR 3163.1 and may also incur civil penalties (43 CFR 3163.2).

Section 109(d)(1) of the Federal Oil and Gas Royalty Management Act of 1982, as implemented by the applicable provisions of the operating regulations at Title 43CFR 3163.2(f)(1), provides that any person who "knowingly or willfully" prepares, maintains, or submits, false, inaccurate, or misleading reports, notices, affidavits, record, data, or other written information required by this part shall be liable for a civil penalty of up to \$25,000 per violation for each day such violation continues, not to exceed a maximum of 20 days.

REVIEW AND APPEAL RIGHTS

Under provisions of 43 CFR 3165.3, you may request an Administrative Review of the decision described above, before the State Director. Such request, including supporting documents, must be filed in writing within 20 business days of receipt of this notice and must be filed with the State Director, Bureau of Land Management, P.O. Box 27115, Santa Fe, New Mexico 87502-0115. Such request shall not result in a suspension of the orders unless the reviewing official so determines. Procedures governing appeals from instructions, orders or decisions are contained in 43 CFR 3165.4 and 43 CFR 4.400 *et seq.* The State Director review decision may be appealed to the Interior Board of Land Appeals, 4015 Wilson Blvd., Arlington, VA 22203 (see 43 CFR 3165.4). Contact the above listed Bureau of Land Management office for further information.