

UNITED STATES  
DEPARTMENT OF THE INTERIOR  
BUREAU OF LAND MANAGEMENT

OCD Artesia

FORM APPROVED  
OMB No. 1004-0137  
Expires: October 31, 2014

**SUNDRY NOTICES AND REPORTS ON WELLS**  
**Do not use this form for proposals to drill or to re-enter an abandoned well. Use Form 3160-3 (APD) for such proposals.**

5. Lease Serial No.  
NM-558679.

6. If Indian, Allottee or Tribe Name

**SUBMIT IN TRIPLICATE - Other instructions on page 2.**

7. If Unit of CA/Agreement, Name and/or No.

1. Type of Well

☒ Oil Well ☐ Gas Well ☐ Other

8. Well Name and No.  
MATTHEWS 25 FEDERAL #1

2. Name of Operator  
LIME ROCK RESOURCES II A, L.P.

9. API Well No.  
30-015-40804

3a. Address  
1111 BAGBY STREET, SUITE 4600  
HOUSTON, TX. 77002

3b. Phone No. (include area code)  
713-292-9526 (SID ASHWORTH)

10. Field and Pool or Exploratory Area  
RED LAKE; GLORIETA-YESO, NORTHEAST

4. Location of Well (Footage, Sec., T., R., M., or Survey Description)  
SHL: 2130 FNL & 330 FWL, SECTION 25, T. 17 S., R. 27 E.  
BHL: 2310 FNL & 330 FWL, SECTION 25, T. 17 S., R. 27 E.

11. County or Parish, State  
EDDY, NM

**12. CHECK THE APPROPRIATE BOX(ES) TO INDICATE NATURE OF NOTICE, REPORT OR OTHER DATA**

TYPE OF SUBMISSION	TYPE OF ACTION			
<input checked="" type="checkbox"/> Notice of Intent	<input type="checkbox"/> Acidize	<input type="checkbox"/> Deepen	<input type="checkbox"/> Production (Start/Resume)	<input type="checkbox"/> Water Shut-Off
<input type="checkbox"/> Subsequent Report	<input type="checkbox"/> Alter Casing	<input type="checkbox"/> Fracture Treat	<input type="checkbox"/> Reclamation	<input type="checkbox"/> Well Integrity
<input type="checkbox"/> Final Abandonment Notice	<input type="checkbox"/> Casing Repair	<input type="checkbox"/> New Construction	<input type="checkbox"/> Recomplete	<input type="checkbox"/> Other _____
	<input checked="" type="checkbox"/> Change Plans	<input type="checkbox"/> Plug and Abandon	<input type="checkbox"/> Temporarily Abandon	
	<input type="checkbox"/> Convert to Injection	<input type="checkbox"/> Plug Back	<input type="checkbox"/> Water Disposal	

13. Describe Proposed or Completed Operation: Clearly state all pertinent details, including estimated starting date of any proposed work and approximate duration thereof. If the proposal is to deepen directionally or recomple horizontally, give subsurface locations and measured and true vertical depths of all pertinent markers and zones. Attach the Bond under which the work will be performed or provide the Bond No. on file with BLM/BIA. Required subsequent reports must be filed within 30 days following completion of the involved operations. If the operation results in a multiple completion or recomple in a new interval, a Form 3160-4 must be filed once testing has been completed. Final Abandonment Notices must be filed only after all requirements, including reclamation, have been completed and the operator has determined that the site is ready for final inspection.)

LIME ROCK RESOURCES PROPOSES TO CHANGE THE APD PLANS TO ADD A BATTERY ON THE WEST SIDE OF THE PAD OF THE MATTHEWS 25 FEDERAL #1 WELL LOCATION. SEE ATTACHED SCHEMATIC DRAWING OF THE FACILITY.

*Approval subject to Amending the IR plan (attached).*

Accepted for record

NMOCD *1/18/2013*

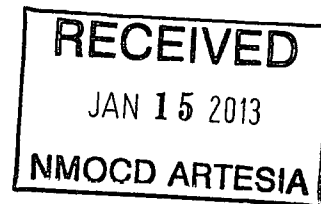

14. I hereby certify that the foregoing is true and correct. Name (Printed/Typed)

BARRY W. HUNT

Title PERMIT AGENT FOR LIME ROCK RESOURCES II A, L.P.

Signature

*Barry W. Hunt*

Date

*12/26/12*

**THIS SPACE FOR FEDERAL OR STATE OFFICE USE**

Approved by

*James R. Davis*

Title

*SEPS*

Date

*1-13-13*

Conditions of approval, if any, are attached. Approval of this notice does not warrant or certify that the applicant holds legal or equitable title to those rights in the subject lease which would entitle the applicant to conduct operations thereon.

Office

*AKO*

Title 18 U.S.C. Section 1001 and Title 43 U.S.C. Section 1212, make it a crime for any person knowingly and willfully to make to any department or agency of the United States any false, fictitious or fraudulent statements or representations as to any matter within its jurisdiction.

(Instructions on page 2)



# Rig Layout

## Interim Reclamation & Production Facilities

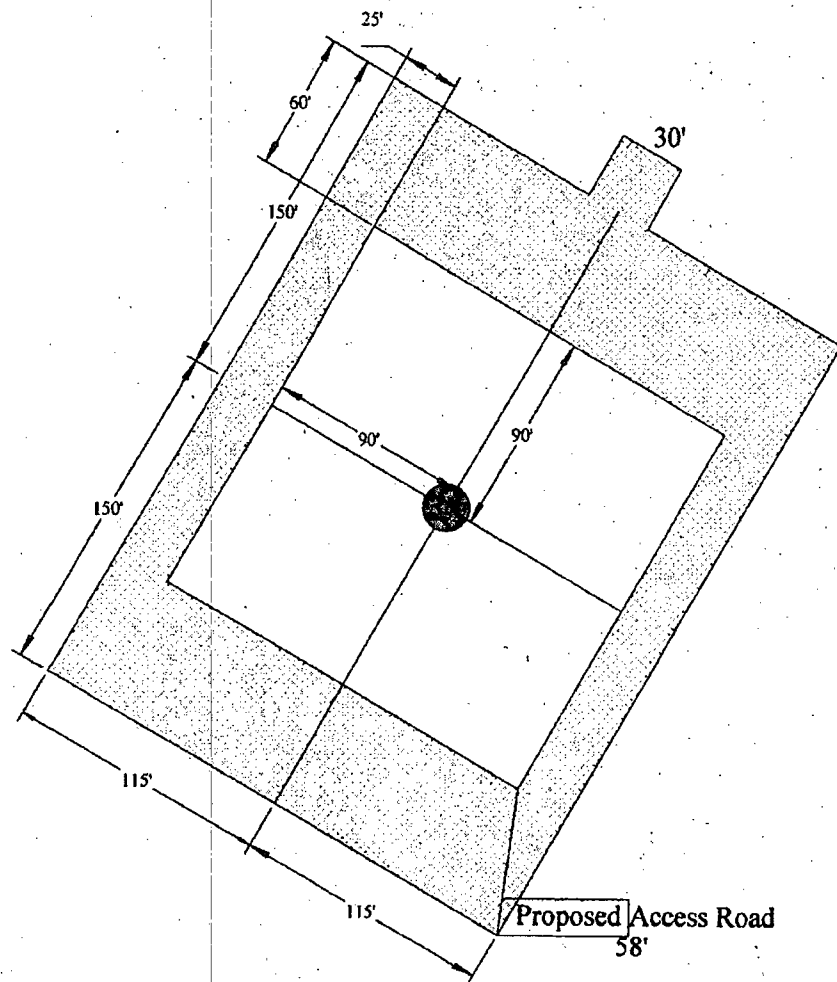

LIME ROCK RESOURCES II-A, L.P.  
MATTHEWS "25" FEDERAL #1

Well Bore

Production Facilities

North



Interim Reclamation

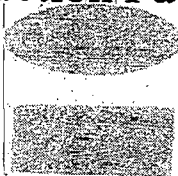

Flowline

