

DISTRICT I
1626 N. French Dr., Hobbs, NM 88240
DISTRICT II
1301 W. Grand Avenue, Artesia, NM 88210
DISTRICT III
1000 Rio Brazos Rd., Aztec, NM 87410
DISTRICT IV
1220 S. St. Francis Dr., Santa Fe, NM 87505

State of New Mexico
Energy, Minerals and Natural Resources Department

OIL CONSERVATION DIVISION
1220 South St. Francis Dr.
Santa Fe, New Mexico 87505

RECEIVED

FEB 27 2013

Form C-102
Revised: July 18, 2010
Submit one copy to appropriate
District Office

NMOC D ARTESIA

WELL LOCATION AND ACREAGE DEDICATION PLAT

☐ AMENDED REPORT

API Number 30-015-40499	Pool Code 97650	Pool Name WC Williams Sink (Bone Spring)
Property Code 305860	Property Name BIG EDDY UNIT	Well Number 251H
OGRID No. 260737	Operator Name BOPCO, L.P.	Elevation 3476'

Surface Location

UL or lot No. P	Section 35	Township 19 S	Range 31 E	Lot Idn	Feet from the 660	North/South line SOUTH	Feet from the 10	East/West line EAST	County EDDY
--------------------	---------------	------------------	---------------	---------	----------------------	---------------------------	---------------------	------------------------	----------------

Bottom Hole Location If Different From Surface

UL or lot No. P	Section 34	Township 19 S	Range 31 E	Lot Idn	Feet from the 653	North/South line SOUTH	Feet from the 1154	East/West line EAST	County EDDY
--------------------	---------------	------------------	---------------	---------	----------------------	---------------------------	-----------------------	------------------------	----------------

Dedicated Acres 200	Joint or Infill	Consolidation Code	Order No.
------------------------	-----------------	--------------------	-----------

NO ALLOWABLE WILL BE ASSIGNED TO THIS COMPLETION UNTIL ALL INTERESTS HAVE BEEN CONSOLIDATED
OR A NON-STANDARD UNIT HAS BEEN APPROVED BY THE DIVISION

PROPOSED BOTTOM
HOLE LOCATION
Lot - N 32°36'40.87"
Long - W 103°51'08.06"
NMSPCE - N 586457.2
E 648310.6
(NAD-27)

SURFACE LOCATION
BONE SPRING 2 PT
Lot - N 32°36'41.02"
Long - W 103°49'50.93"
NMSPCE - N 586502.312
E 654736.299
(NAD-27)

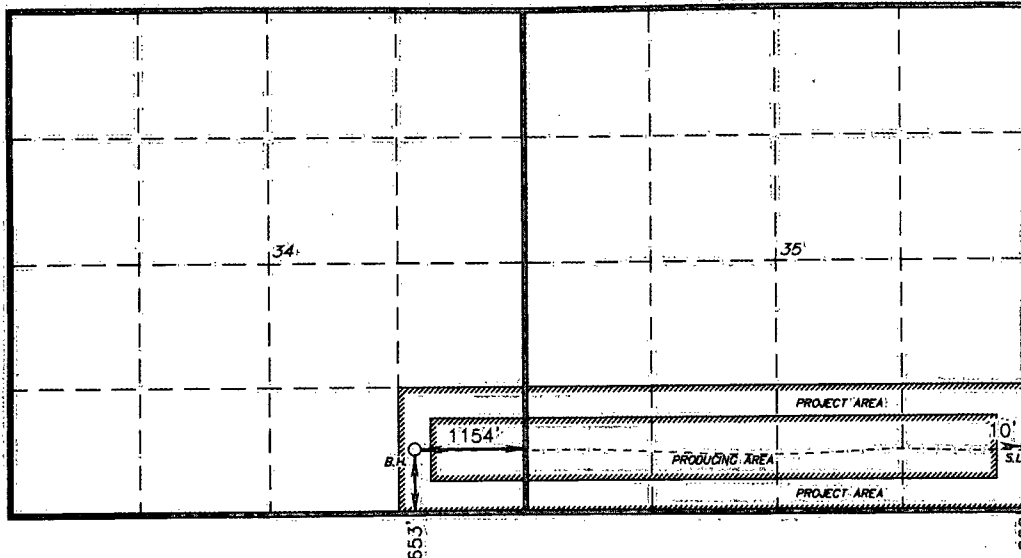

CERTIFICATION IS FOR SURFACE
LOCATION ONLY.

OPERATOR CERTIFICATION

I hereby certify that the information contained herein is true and complete to the best of my knowledge and belief, and that this organization either owns a working interest or unleased mineral interest in the land including the proposed bottom hole location or has a right to drill this well at this location pursuant to a contract with an owner of such a mineral or working interest, or to a voluntary pooling agreement or a compulsory pooling order heretofore entered by the division.

Signature: *Tracie J Cherry* Date: 02/26/13

Tracie J Cherry

Printed Name

tjcherry@basspet.com

Email Address

SURVEYOR CERTIFICATION

I hereby certify that the well location shown on this plat was plotted from field notes of actual surveys made by me or under my supervision, and that the same is true and correct to the best of my belief.

Date Surveyed: NOVEMBER 14, 2011
Signature and Seal of Professional Surveyor
No. 25538

Certificate No. Gary L. Jones 7977

Basin Surveys 25538