

UNITED STATES
DEPARTMENT OF THE INTERIOR
BUREAU OF LAND MANAGEMENTFORM APPROVED
OMB NO. 1004-0135
Expires: July 31, 2010**SUNDRY NOTICES AND REPORTS ON WELLS**
*Do not use this form for proposals to drill or to re-enter an abandoned well. Use form 3160-3 (APD) for such proposals.***SUBMIT IN TRIPLICATE - Other instructions on reverse side.**

1. Type of Well <input checked="" type="checkbox"/> Oil Well <input type="checkbox"/> Gas Well <input type="checkbox"/> Other		5. Lease Serial No. NMLC061862
2. Name of Operator DEVON ENERGY PRODUCTION CO EMail: Denise.Menoud@dvn.com		6. If Indian, Allottee or Tribe Name
3a. Address 333 WEST SHERIDAN AVE OKLAHOMA CITY, OK 73102	3b. Phone No. (include area code) Ph: 575-746-5544	7. If Unit or CA/Agreement, Name and/or No. 891005247X
4. Location of Well (Footage, Sec., T., R., M., or Survey Description) Sec 13 T25S R31E SWSW 330FNL 660FWL		8. Well Name and No. COTTON DRAW UNIT 159H
		9. API Well No. 30-015-40385-00-S1
		10. Field and Pool, or Exploratory COTTON DRAW
		11. County or Parish, and State EDDY COUNTY, NM

12. CHECK APPROPRIATE BOX(ES) TO INDICATE NATURE OF NOTICE, REPORT, OR OTHER DATA

TYPE OF SUBMISSION	TYPE OF ACTION			
<input type="checkbox"/> Notice of Intent	<input type="checkbox"/> Acidize	<input type="checkbox"/> Deepen	<input type="checkbox"/> Production (Start/Resume)	<input type="checkbox"/> Water Shut-Off
<input checked="" type="checkbox"/> Subsequent Report	<input type="checkbox"/> Alter Casing	<input type="checkbox"/> Fracture Treat	<input checked="" type="checkbox"/> Reclamation	<input type="checkbox"/> Well Integrity
<input type="checkbox"/> Final Abandonment Notice	<input type="checkbox"/> Casing Repair	<input type="checkbox"/> New Construction	<input type="checkbox"/> Recomplete	<input type="checkbox"/> Other
	<input type="checkbox"/> Change Plans	<input type="checkbox"/> Plug and Abandon	<input type="checkbox"/> Temporarily Abandon	
	<input type="checkbox"/> Convert to Injection	<input type="checkbox"/> Plug Back	<input type="checkbox"/> Water Disposal	

13. Describe Proposed or Completed Operation (clearly state all pertinent details, including estimated starting date of any proposed work and approximate duration thereof. If the proposal is to deepen directionally or recompleat horizontally, give subsurface locations and measured and true vertical depths of all pertinent markers and zones. Attach the Bond under which the work will be performed or provide the Bond No. on file with BLM/BIA. Required subsequent reports shall be filed within 30 days following completion of the involved operations. If the operation results in a multiple completion or recompleat in a new interval, a Form 3160-4 shall be filed once testing has been completed. Final Abandonment Notices shall be filed only after all requirements, including reclamation, have been completed, and the operator has determined that the site is ready for final inspection.)

THIS LOCATION HAS BEEN DOWNSIZED FROM AN ORIGINAL PAD SIZE OF 350' X 420'.

ACRES RECLAIMED = 0.7093

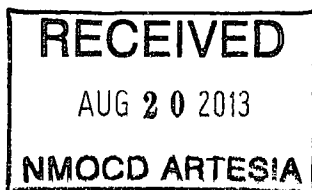
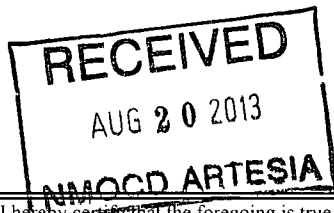

Accepted for record
UDCdenMOCD 8/20/13
Accepted for Record Purposes.
Approval Subject to Onsite Inspection.
If BLM Objectives are not achieved,
additional work may be required.
Date: 8-18-13
Signature: J. Amos

14. I hereby certify that the foregoing is true and correct.	
Electronic Submission #211391 verified by the BLM Well Information System For DEVON ENERGY PRODUCTION CO LP, sent to the Hobbs Committed to AFMSS for processing by KURT SIMMONS on 07/12/2013 (13KMS2406SE)	
Name (Printed/Typed) DENISE MENOUD	Title AUTHORIZED REPRESENTATIVE
Signature (Electronic Submission)	Date 06/21/2013

THIS SPACE FOR FEDERAL OR STATE OFFICE USE

Approved By ACCEPTED	JAMES A AMOS Title SUPERVISORY EPS	Date 08/18/2013
Conditions of approval, if any, are attached. Approval of this notice does not warrant or certify that the applicant holds legal or equitable title to those rights in the subject lease which would entitle the applicant to conduct operations thereon.		
Office Hobbs		

Title 18 U.S.C. Section 1001 and Title 43 U.S.C. Section 1212, make it a crime for any person knowingly and willfully to make to any department or agency of the United States any false, fictitious or fraudulent statements or representations as to any matter within its jurisdiction.

**** BLM REVISED ** BLM REVISED ** BLM REVISED ** BLM REVISED ** BLM REVISED ****

Revisions to Operator-Submitted EC Data for Sundry Notice #211391

	Operator Submitted	BLM Revised (AFMSS)
Sundry Type:	RECL SR	RECL SR
Lease:	NMLC061862	NMLC061862
Agreement:		891005247X (NMNM70928X)
Operator:	DEVON ENERGY PRODUCTION CO LP PO BOX 250 ARTESIA, NM 88211 Ph: 575-748-3371	DEVON ENERGY PRODUCTION CO LP 333 WEST SHERIDAN AVE OKLAHOMA CITY, OK 73102 Ph: 405 235 3611
Admin Contact:	DENISE MENOUD AUTHORIZED REPRESENTATIVE E-Mail: Denise.Menoud@dvn.com Ph: 575-746-5544	DENISE MENOUD AUTHORIZED REPRESENTATIVE E-Mail: Denise.Menoud@dvn.com Ph: 575-746-5544
Tech Contact:	DENISE MENOUD AUTHORIZED REPRESENTATIVE E-Mail: Denise.Menoud@dvn.com Ph: 575-746-5544	DENISE MENOUD AUTHORIZED REPRESENTATIVE E-Mail: Denise.Menoud@dvn.com Ph: 575-746-5544
Location:		
State:	NM	NM
County:	EDDY COUNTY	EDDY
Field/Pool:	COTTON DRAW; DELAWARE, SO	COTTON DRAW
Well/Facility:	COTTON DRAW UNIT 159H Sec 13 T25S R31E 177FNL 554FWL	COTTON DRAW UNIT 159H Sec 13 T25S R31E SWSW 330FNL 660FWL



**Interim
Site
Reclamation**

Devon Energy
Production Co.

Cotton Draw Unit 159H
API #30-15-40385
Sec. 13-T25S-R31E
Eddy County, NM



Reclamation
Area =
0.7093 Acres

350'

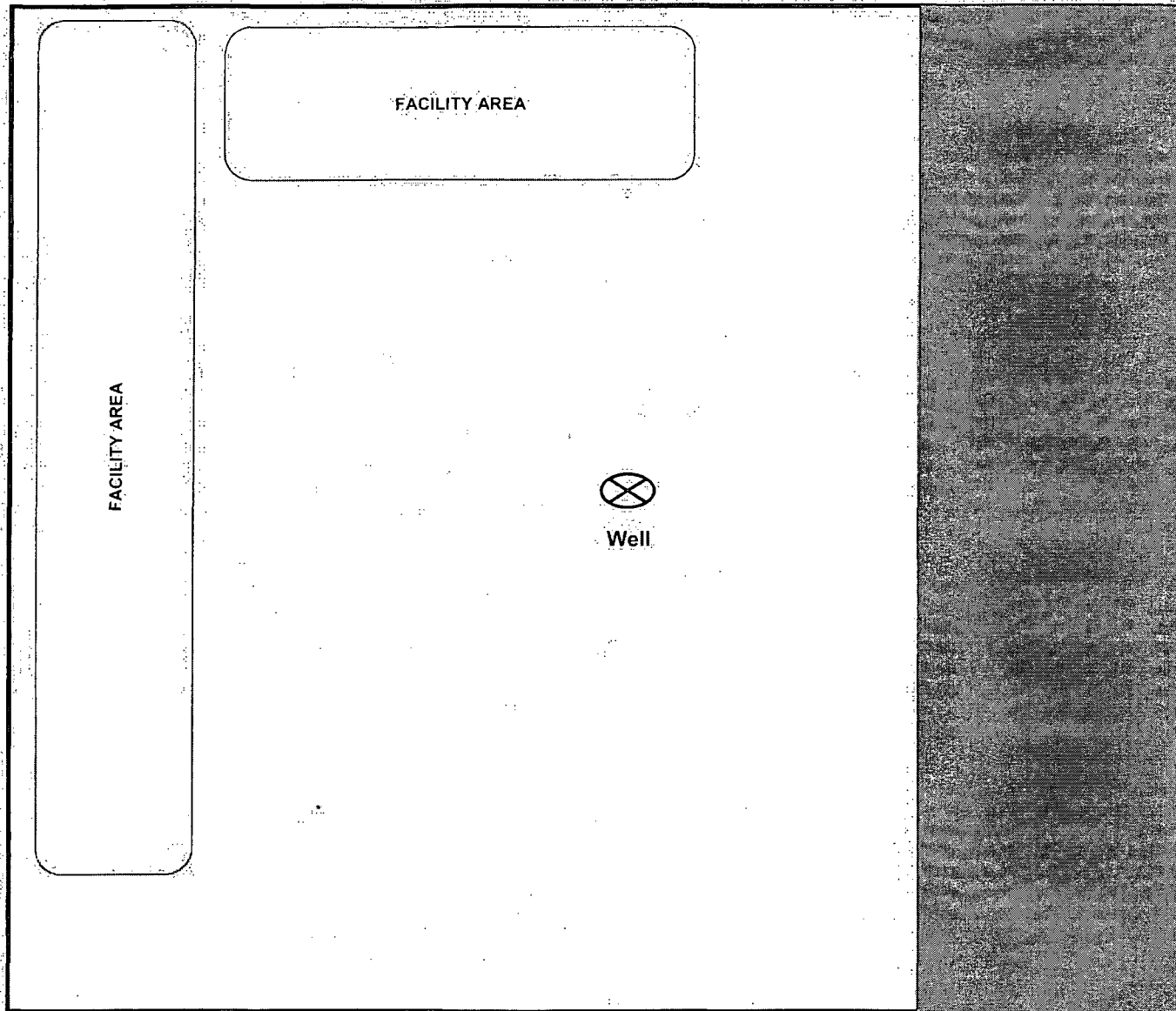

420'

Devon - Cotton Draw unit 159H

N.D.
DUE 4-7-13

30-015-40385

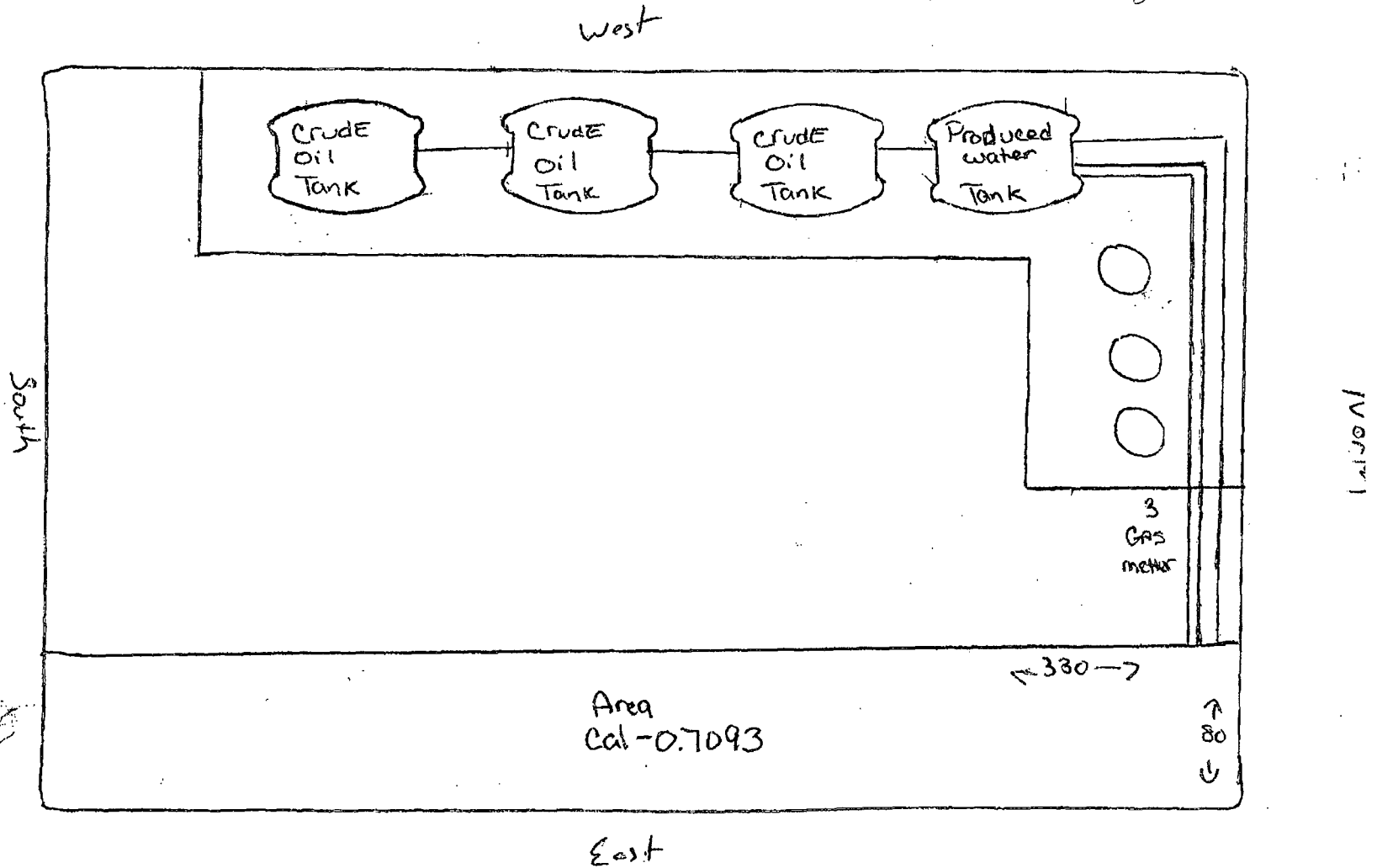

devon

**Proposed Interim
Site Configuration**

Devon Energy Production Co.
Cotton Draw Unit 159H
330' FSL & 660' FWL
Sec. 13 T25S R31E
Eddy County,
NM

Proposed
Reclamation Area



1" : 60'

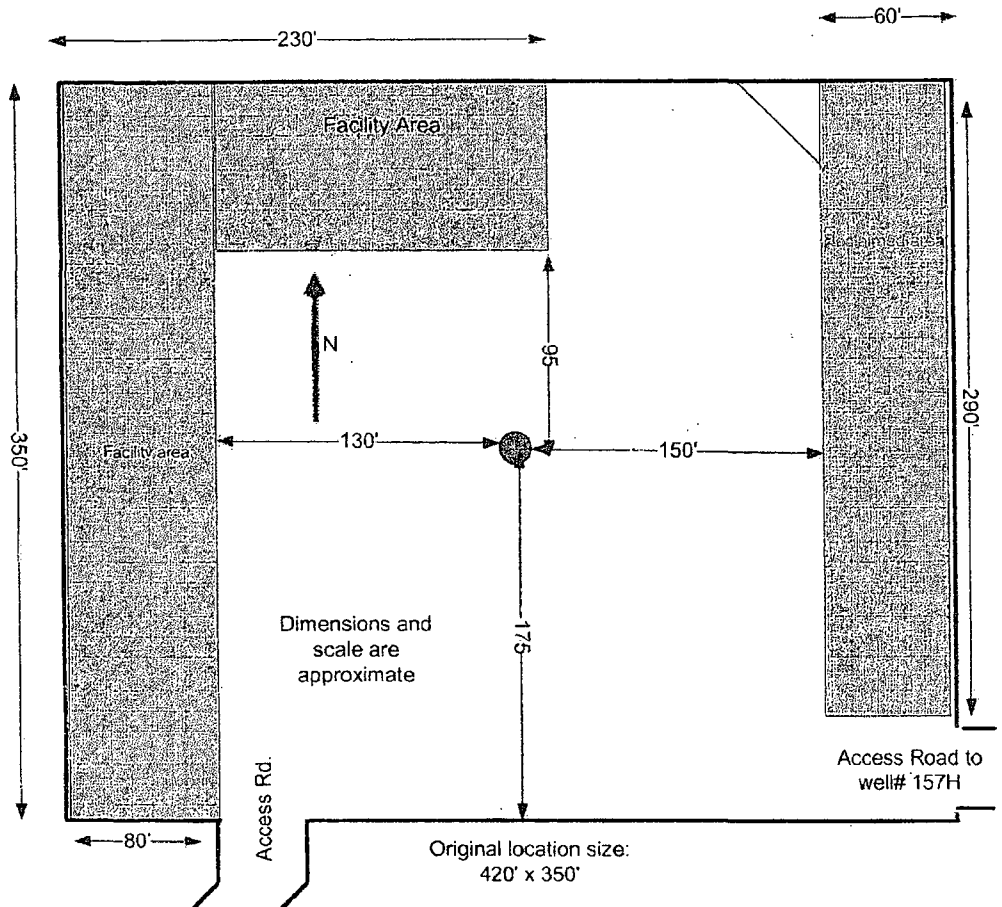

SURFACE USE PLAN

Devon Energy Production Company, LP

Cotton Draw Unit 159H

Surface Location: 330' FSL & 660' FWL, Unit M, Sec 13 T25S R31E, Eddy, NM

Bottom Hole Location: 200' FNL & 660' FWL, Unit D, Sec 13 T25S R31E, Eddy, NM

1. Existing Roads:

- a. The well site and elevation plat for the proposed well are reflected on the well site layout; Form C-102. The well was staked by Madron Surveying, Inc.
- b. All roads into the location are depicted on Exhibit 3.
- c. Directions to Location: From state Hwy 128 and paved CR 1, go south on CR 1, 6.3 miles turn right and go west 2.0 miles turn right and go north 0.8 miles bend left and go west 1.9 miles to a proposed road survey follow flags south 147' then SW 353' to trail road follow trail south 0.7 miles bend left and go east 500' and location is on the left (north) 320'.

2. New or Reconstructed Access Roads:

- a. The well site layout, Form C-102 shows the existing County road. Approximately 571' of new access road will be constructed as follows. The maximum width of the road will be 15'. It will be crowned and made of 6" rolled and compacted caliche. Water will be deflected, as necessary, to avoid accumulation and prevent surface erosion.
- b. Surface material will be native caliche. This material will be obtained from a BLM approved pit nearest in proximity to the location. The average grade will be approximately 1%.
- c. No cattle guards, grates or fence cuts will be required. No turnouts are planned.

3. Location of Existing Wells:

One Mile Radius Plat shows all existing and proposed wells within a one-mile radius of the proposed location. See attached plat.

4. Location of Existing and/or Proposed Production Facilities:

- a. In the event the well is found productive it will go to the battery on site and the necessary production equipment will be installed at the well site.
- b. If necessary, the well will be operated by means of an electric prime mover. Electric power poles will be set along side of the access road.
- c. All flow lines will adhere to API standards.
- d. If the well is productive, rehabilitation plans are as follows:
 - i. The original topsoil from the well site will be returned to the location. The drill site will then be contoured as close as possible to the original state.