

DISTRICT I
1625 N. French Dr., Hobbs, NM 88240
Phone: (575) 393-6161 Fax: (575) 393-0720

DISTRICT II
811 S. First St., Artesia, NM 88210
Phone: (575) 748-1283 Fax: (575) 748-9720

DISTRICT III
1000 Rio Brazos Road, Aztec, NM 87410
Phone: (505) 334-6178 Fax: (505) 334-6170

DISTRICT IV
1220 S. St. Francis Dr., Santa Fe, NM 87505
Phone: (505) 476-3460 Fax: (505) 476-3462

State of New Mexico
Energy, Minerals & Natural Resources Department
OIL CONSERVATION DIVISION
1220 South St. Francis Dr.
Santa Fe, New Mexico 87505

Form C-102
Revised August 1, 2011
Submit one copy to appropriate
District Office

AMENDED REPORT

WELL LOCATION AND ACREAGE DEDICATION PLAT

API Number 30-015-41771	Pool Code 96830	Pool Name Artesia, Glorieta - Yeso
Property Code 40198	Property Name T REX STATE	Well Number 2
OGRID No. 873	Operator Name APACHE CORPORATION	Elevation 3694'

Surface Location

UL or lot No.	Section	Township	Range	Lot Idn	Feet from the	North/South line	Feet from the	East/West line	County
B	31	17-S	28-E		575	NORTH	1650	EAST	EDDY

Bottom Hole Location If Different From Surface

UL or lot No.	Section	Township	Range	Lot Idn	Feet from the	North/South line	Feet from the	East/West line	County
B	31	17-S	28-E		330	NORTH	1650	EAST	EDDY

Dedicated Acres	Joint or Infill	Consolidation Code	Order No.

NO ALLOWABLE WILL BE ASSIGNED TO THIS COMPLETION UNTIL ALL INTERESTS HAVE BEEN CONSOLIDATED OR A NON-STANDARD UNIT HAS BEEN APPROVED BY THE DIVISION

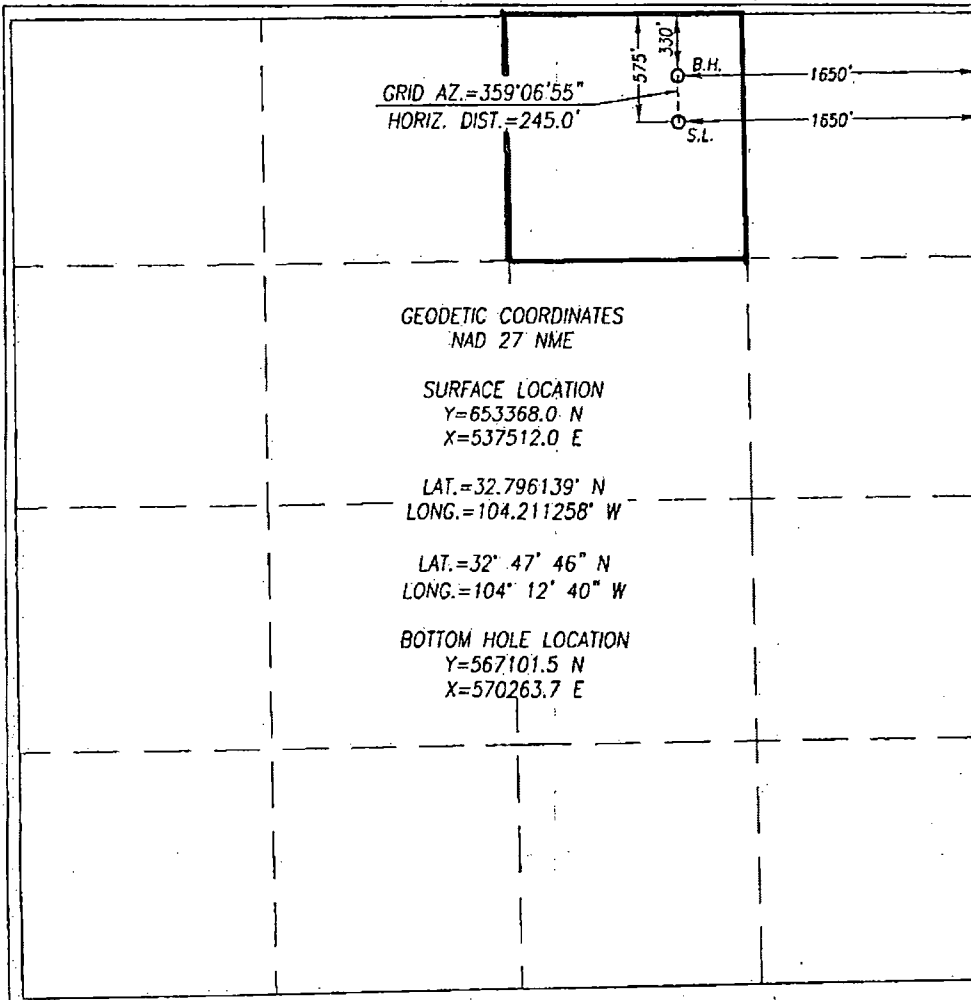

OPERATOR CERTIFICATION

I hereby certify that the information herein is true and complete to the best of my knowledge and belief, and that this organization either owns a working interest or unleased mineral interest in the land including the proposed bottom hole location or has a right to drill this well at this location pursuant to a contract with an owner of such mineral or working interest, or to a voluntary pooling agreement or a compulsory pooling order heretofore entered by the division.

Michelle Cooper 10-31-13
Signature Date

Michelle Cooper
Printed Name

michelle.cooper@apachecorp.com
E-mail Address

SURVEYOR CERTIFICATION

I hereby certify that the well location shown on this plat was plotted from field notes of actual surveys made by me or under my supervision, and that the same is true and correct to the best of my belief.

AUGUST 23, 2013

Date of Survey
Signature & Seal of Professional Surveyor:

Ronald S. Eidson 8/16/13
Certification Number: 3239
Name: Ronald S. Eidson
BKL WSC W.O. 13.11.0944

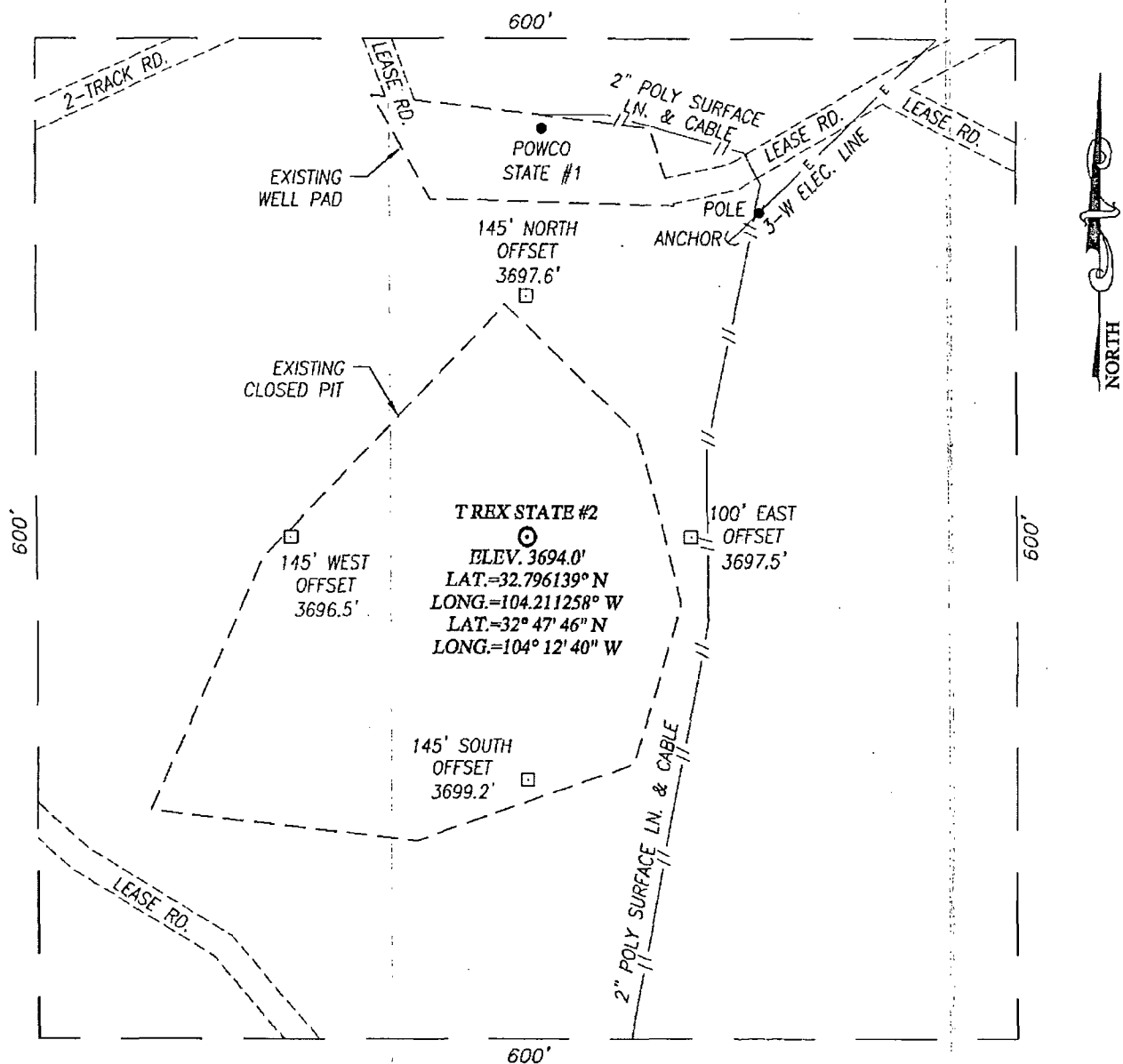

DIRECTIONS TO LOCATION

FROM THE INTERSECTION OF US, HWY. 82 AND CO. RD. 205 (TV TOWER) GO SOUTH ON CO. RD. 205 APPROX. 0.3 MILES; TURN RIGHT AND GO WEST ONTO A CALICHE LEASE ROAD AND GO APPROX. 400 FEET TO THE SOUTHWEST PAD CORNER; FOLLOW OLD LEASE ROAD APPROX. 430 FEET TO A "Y" KEEP LEFT; TURN SOUTHWEST AND GO APPROX. 110 FEET TO AN OLD WELL PAD. THIS STAKED LOCATION IS 401 FEET NORTH FROM THE NORTHWEST PAD CORNER.

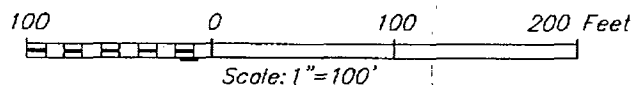

APACHE CORPORATION

T REX STATE #2 WELL
LOCATED 575 FEET FROM THE NORTH LINE
AND 1650 FEET FROM THE EAST LINE OF SECTION 31,
TOWNSHIP 17 SOUTH, RANGE 28 EAST, N.M.P.M.,
EDDY COUNTY, NEW MEXICO

PROVIDING SURVEYING SERVICES
 SINCE 1946
JOHN WEST SURVEYING COMPANY
 412 N. DAL PASO
 HOBBS, N.M. 88240
 (575) 393-3117 www.jwsc.biz

Survey Date: 8/23/13	CAD Date: 9/3/13	Drawn By: BKL
W.O. No.: 13110944	Rev: .	Rel. W.O.: Sheet 1 of 1

VICINITY MAP

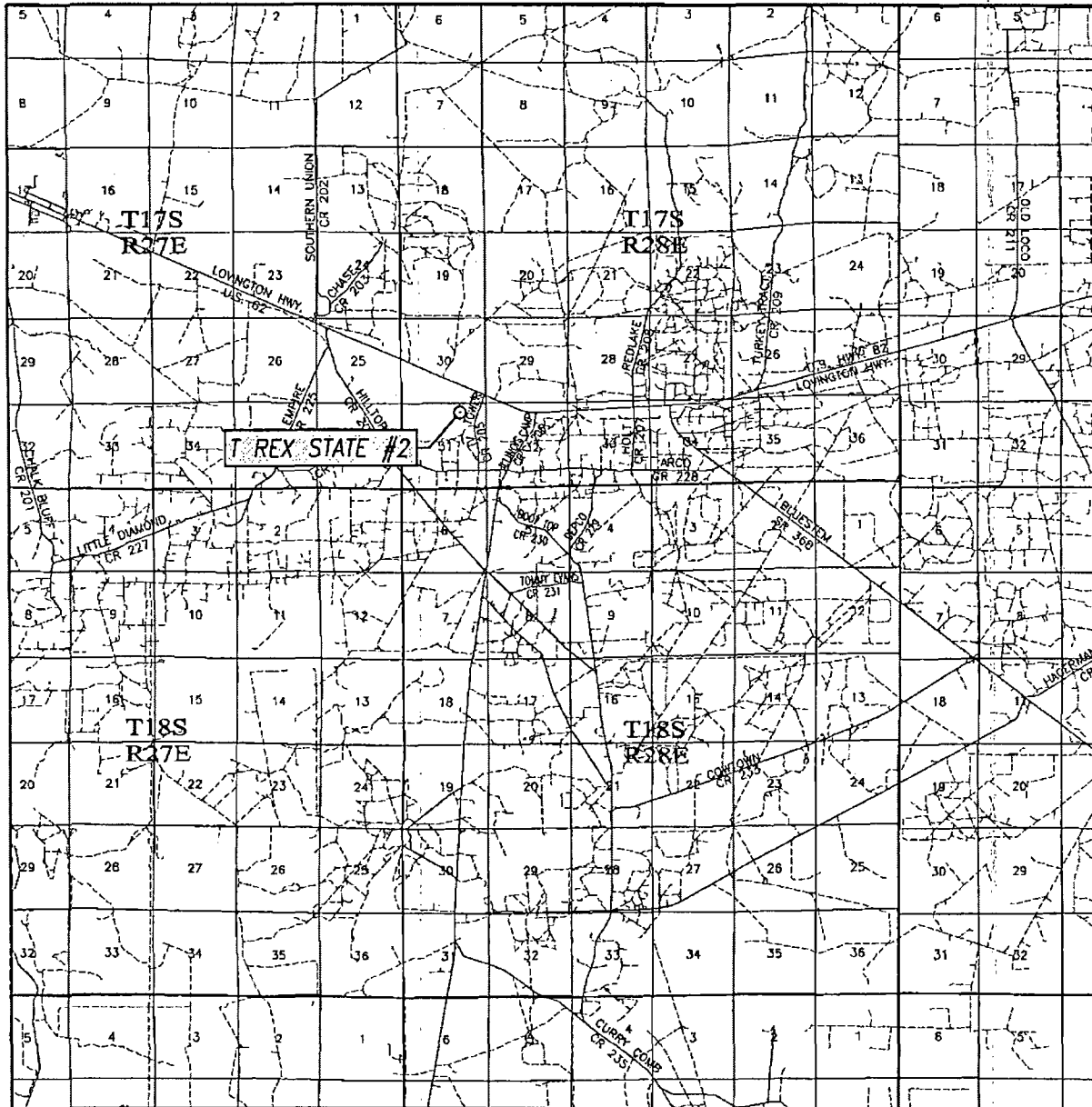

SCALE: 1" = 2 MILES

SEC. 31 TWP. 17-S RGE. 28-E

SURVEY N.M.P.M.

COUNTY EDDY STATE NEW MEXICO

DESCRIPTION 575' FNL & 1650' FEL

ELEVATION 3694'

OPERATOR APACHE CORPORATION

LEASE T REX STATE

PROVIDING SURVEYING SERVICES
SINCE 1946

JOHN WEST SURVEYING COMPANY

412 N. DAL PASO
HOBBS, N.M. 88240
(575) 393-3117 www.jwsc.biz