

DISTRICT I
1625 N. French Dr., Hobbs, NM 88240
Phone (505) 533-6161 Fax (505) 533-0720

DISTRICT II
811 S. First St., Artesia, NM 88210
Phone (505) 743-1223 Fax (505) 743-0720

DISTRICT III
1000 Rio Bravo Rd., Artec, NM 87410
Phone (505) 334-6176 Fax (505) 334-6176

DISTRICT IV
1220 S. St. Francis Dr., Santa Fe, NM 87505
Phone (505) 476-3440 Fax (505) 476-3442

RECEIVED
MAR 11 2014

OIL CONSERVATION DIVISION
INMOCD ARTE

State of New Mexico
Energy, Minerals and Natural Resources Department

Form C-102
Revised August 1, 2011

Submit one copy to appropriate
District Office

1220 South St. Francis Dr.
Santa Fe, New Mexico 87505

WELL LOCATION AND ACREAGE DEDICATION PLAT

AMENDED REPORT
AS Drilled

API Number 30-015-41896	Pool Code 37920	Pool Name Leo; Bone Spring South
Property Code 40303	Property Name DORADO 34 EH FED COM	Well Number 1H
OGRID No. 14744	Operator Name MEWBOURNE OIL COMPANY	Elevation 3434

Surface Location

UL or lot No.	Section	Township	Range	Lot Idn	Feet from the	North/South line	Feet from the	East/West line	County
H	33	18 S	30 E		2206	NORTH	47	EAST	EDDY

Bottom Hole Location If Different From Surface

UL or lot No.	Section	Township	Range	Lot Idn	Feet from the	North/South line	Feet from the	East/West line	County
H	34	18 S	30 E		2150	NORTH	467	EAST	EDDY

Dedicated Acres 160	Joint or Infill	Consolidation Code	Order No.
------------------------	-----------------	--------------------	-----------

NO ALLOWABLE WILL BE ASSIGNED TO THIS COMPLETION UNTIL ALL INTERESTS HAVE BEEN CONSOLIDATED
OR A NON-STANDARD UNIT HAS BEEN APPROVED BY THE DIVISION

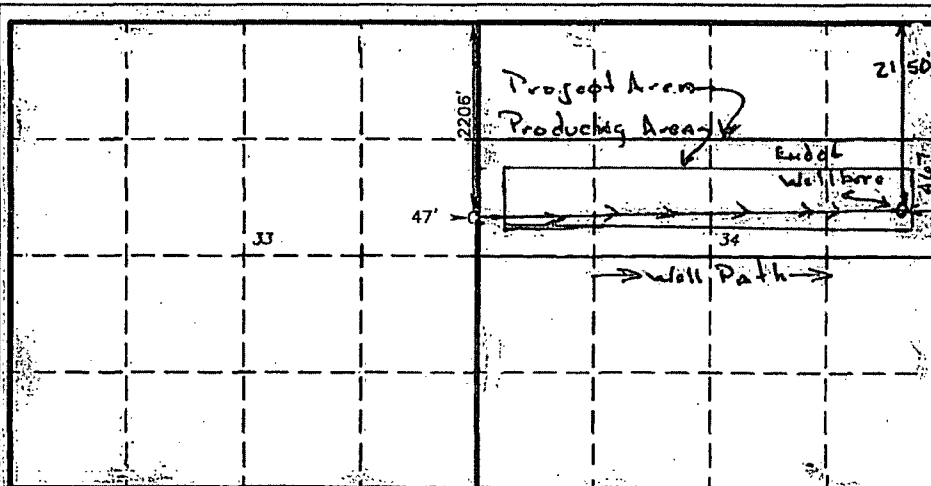

SURFACE LOCATION
Lat. - N 32° 42' 18.01"
Long. - W 103° 58' 04.90"
NAD83 - N 620385.38
NAD83 - E 612367.27
(NAD-27)

OPERATOR CERTIFICATION

I hereby certify that the information contained herein is true and complete to the best of my knowledge and belief, and that this organization either owns a working interest or unleased mineral interest in the land including the proposed bottom hole location or has a right to drill this well at this location pursuant to a contract with an owner of such a mineral or working interest, or to a voluntary pooling agreement or a compulsory pooling order heretofore entered by the division.

Signature: [Signature] Date: 2/22/14

Printed Name: [Name]

Email Address:

SURVEYOR CERTIFICATION

I hereby certify that the well location shown on this plat was plotted from field notes of actual surveys made by me or under my supervision and that the same is true and correct to the best of my belief.

Date Surveyed: [Date]
Signature: [Signature]
Professional Surveyor: [Signature]
W.B. 1000000000

Certificate No. Gary L. Jones 7977

BASIN SURVEYS 27908