

UNITED STATES
DEPARTMENT OF THE INTERIOR
BUREAU OF LAND MANAGEMENTFORM APPROVED
OMB NO. 1004-0135
Expires: July 31, 2010**SUNDRY NOTICES AND REPORTS ON WELLS**
*Do not use this form for proposals to drill or to re-enter an abandoned well. Use form 3160-3 (APD) for such proposals.***SUBMIT IN TRIPLICATE - Other instructions on reverse side.**

1. Type of Well <input checked="" type="checkbox"/> Oil Well <input type="checkbox"/> Gas Well <input type="checkbox"/> Other		5. Lease Serial No. NMNM90807
2. Name of Operator SM ENERGY COMPANY		6. If Indian, Allottee or Tribe Name
Contact: VICKIE MARTINEZ E-Mail: VMARTINEZ@SM-ENERGY.COM		7. If Unit or CA/Agreement, Name and/or No.
3a. Address 3300 N "A" STREET BLDG 7-200 MIDLAND, TX 79705	3b. Phone No. (include area code) Ph: 432-688-1709 Fx: 432-688-1701	8. Well Name and No. OSAGE 34 FEDERAL 6H
4. Location of Well (Footage, Sec., T., R., M., or Survey Description) Sec 34 T19S R29E 1750FSL 15FEL		9. API Well No. 30-015-41597
		10. Field and Pool, or Exploratory PARKWAY BONE SPRING
		11. County or Parish, and State EDDY COUNTY, NM

12. CHECK APPROPRIATE BOX(ES) TO INDICATE NATURE OF NOTICE, REPORT, OR OTHER DATA

TYPE OF SUBMISSION	TYPE OF ACTION			
<input checked="" type="checkbox"/> Notice of Intent	<input type="checkbox"/> Acidize	<input type="checkbox"/> Deepen	<input type="checkbox"/> Production (Start/Resume)	<input type="checkbox"/> Water Shut-Off
<input type="checkbox"/> Subsequent Report	<input type="checkbox"/> Alter Casing	<input type="checkbox"/> Fracture Treat.	<input checked="" type="checkbox"/> Reclamation	<input type="checkbox"/> Well Integrity
<input type="checkbox"/> Final Abandonment Notice	<input type="checkbox"/> Casing Repair	<input type="checkbox"/> New Construction	<input type="checkbox"/> Recomplete	<input type="checkbox"/> Other
	<input type="checkbox"/> Change Plans	<input type="checkbox"/> Plug and Abandon	<input type="checkbox"/> Temporarily Abandon	
	<input type="checkbox"/> Convert to Injection	<input type="checkbox"/> Plug Back	<input type="checkbox"/> Water Disposal	

13. Describe Proposed or Completed Operation (clearly state all pertinent details, including estimated starting date of any proposed work and approximate duration thereof. If the proposal is to deepen directionally or recompleat horizontally, give subsurface locations and measured and true vertical depths of all pertinent markers and zones. Attach the Bond under which the work will be performed or provide the Bond No. on file with BLM/BIA. Required subsequent reports shall be filed within 30 days following completion of the involved operations. If the operation results in a multiple completion or recompleat in a new interval, a Form 3160-4 shall be filed once testing has been completed. Final Abandonment Notices shall be filed only after all requirements, including reclamation, have been completed, and the operator has determined that the site is ready for final inspection.)

SM ENERGY HAS CONTRACTED TALON/LPE TO DO RECLAMATION SERVICES ON THE OSAGE 34 FEDERAL 6H, AN ACTIVE WELL.
THE LOCATION WILL BE DOWNSIZED AND THE CALICHE WILL BE REMOVED.
THE CALICHE WILL BE USED TO REPAIR LEASE ROADS IN THE AREA.
THE WELL LOCATION WILL BE CONTOURED TO MATCH THE SURROUNDING TERRAIN AND WILL BE SEEDED USING BLM RECOMMENDED SEED MIX FOR THE AREA.

WES 3/13/14

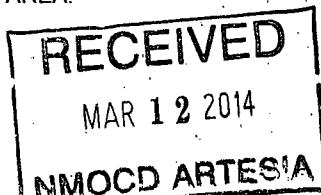
Approved for record
RECORDED

Approval subject to compliance with the approved Interim Reclamation Plan (attached) and compliance with attached Interim Reclamation Objectives and Procedures.

14. I hereby certify that the foregoing is true and correct.	
Electronic Submission #235324 verified by the BLM Well Information System For SM ENERGY COMPANY, sent to the Carlsbad Committed to AFMSS for processing by DEBORAH HAM on 03/07/2014 ()	
Name (Printed/Typed) VICKIE MARTINEZ	Title ENGINEER TECH II
Signature (Electronic Submission)	Date 02/12/2014

THIS SPACE FOR FEDERAL OR STATE OFFICE USE

Approved By <u>James H. Brown</u>	Title <u>SEAS</u>	Date <u>3-9-14</u>
Conditions of approval, if any, are attached. Approval of this notice does not warrant or certify that the applicant holds legal or equitable title to those rights in the subject lease which would entitle the applicant to conduct operations thereon.	Office <u>CFO</u>	

Title 18 U.S.C. Section 1001 and Title 43 U.S.C. Section 1212, make it a crime for any person knowingly and willfully to make to any department or agency of the United States any false, fictitious or fraudulent statements or representations as to any matter within its jurisdiction.

**** OPERATOR-SUBMITTED ** OPERATOR-SUBMITTED ** OPERATOR-SUBMITTED ****

SECTION 34, TOWNSHIP 19 SOUTH, RANGE 29 EAST, N.M.P.M.,
EDDY COUNTY, NEW MEXICO.

PAGE 25

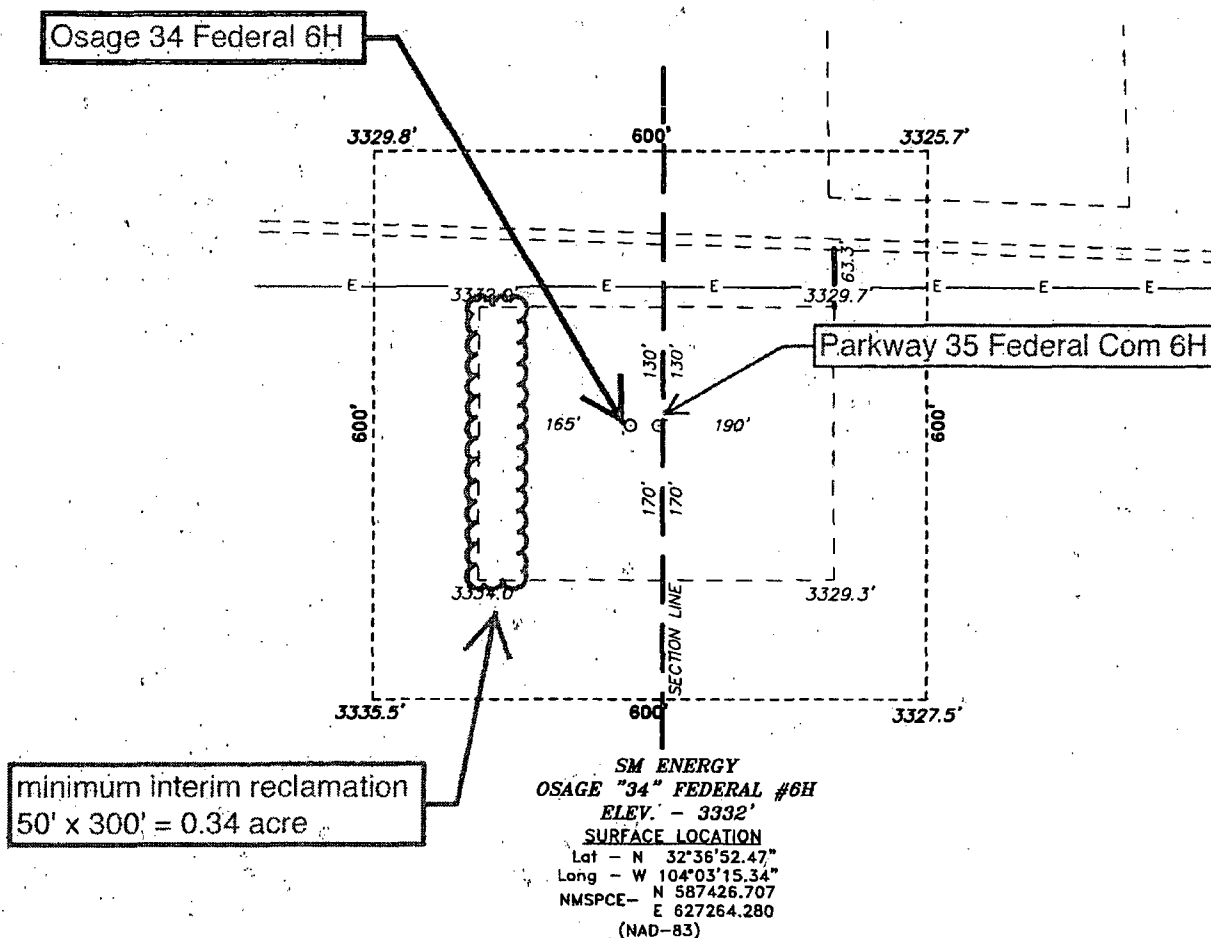

Directions to Location:

FROM THE JUNCTION OF HWY 62-180 AND CO. RD. 238, GO NORTHEAST ON CO. RD. 238 FOR 2.5 MILES TO LEASE ROAD, ON LEASE ROAD GO NORTH 4.0 MILES TO LEASE ROAD, GO EAST FOR 1.3 MILES TO WELL PAD AND PROPOSED LEASE ROAD.

200 0 200 400 FEET
SCALE: 1" = 200'

SM ENERGY

REF: OSAGE "34" FEDERAL #6H / WELL PAD TOPO

THE OSAGE "34" FEDERAL #6H LOCATED 1700'
FROM THE SOUTH LINE AND 35' FROM THE EAST LINE OF
SECTION 34, TOWNSHIP 19 SOUTH, RANGE 29 EAST,
N.M.P.M., EDDY COUNTY, NEW MEXICO.

BASIN SURVEYS P.O. BOX 1786-HOBBS, NEW MEXICO

W.O. Number: 28487

Drawn By: J. SMALL

N.M.P.M., EDDY COUNTY, NEW MEXICO.

Date: 05-02-2013 Disk: DAJ 28487

Survey Date: 04-18-2013

Sheet 1 of 1 Sheets



United States Department of the Interior

BUREAU OF LAND MANAGEMENT

Carlsbad Field Office
620 E. Greene St.
Carlsbad, New Mexico 88220-6292
www.blm.gov/nm



In Reply Refer To: 1310

Interim Reclamation Procedures

Reclamation Objective: Oil and gas development is one of many uses of the public lands and resources. While development may have a short- or long-term effect on the land, successful reclamation can ensure the effect is not permanent. During the life of the development, all disturbed areas not needed for active support of production operations should undergo "interim" reclamation in order to minimize the environmental impacts of development on other resources and uses.

Interim reclamation consists of minimizing the footprint of disturbance by reclaiming all portions of the well site not needed for production operations. The portions of the cleared well site not needed for operational and safety purposes are recontoured to a final or intermediate contour that blends with the surrounding topography as much as possible. Sufficient level area remains for setup of a workover rig and to park equipment. Topsoil is respread over areas not needed for all-weather operations. Production facilities should be clustered to maximize the opportunity for interim reclamation. In order to inspect and operate the well or complete workover operations, it may be necessary to drive, park, and operate on restored, interim vegetation within the previously disturbed area. This is generally acceptable provided damage is repaired and reclaimed following use.

To reduce final reclamation costs; maintain healthy, biologically active topsoil; and to minimize habitat, visual, and forage loss during the life of the well, all salvaged topsoil should be spread over the area of interim reclamation, rather than stockpiled.

1. The Application for Permit to Drill or Reenter (APD, Form 3160-3), Surface Use Plan of Operations must include adequate measures for stabilization and reclamation of disturbed lands. Oil and Gas operators must plan for reclamation, both interim and final, up front in the APD process as per Onshore Oil and Gas Order No. 1.
2. For wells and/or access roads not having an approved plan, or an inadequate plan for surface reclamation (either interim or final reclamation), the operator must submit a proposal describing the procedures for reclamation. For interim reclamation, the appropriate time for submittal would be when filing the Well Completion or Recompletion Report and Log (Form 3160-4). Interim reclamation is to be completed within 6 months of well completion.
3. If you have an approved Surface Use Plan of Operation and/or an approved Sundry Notice, you are free to proceed with interim reclamation as per approved APD or Sundry Notice. If you have issues or concerns, contact a BLM specialist to assist you. It would be in your interest to have a BLM specialist look at the location and access road prior to the removal of reclamation equipment to ensure that it meets BLM objectives. Upon conclusion submit a Form 3160-5, Subsequent Report of Reclamation. This will prompt a specialist to inspect the location to verify work was completed as per approved plans.
4. The approved Subsequent Report of Reclamation will be your notice that the native soils, contour and seedbed have been reestablished. If the BLM objectives have not been met the operator will be notified and corrective actions may be required.
5. It is the responsibility of the operator to monitor these locations and/or access roads until such time as the operator feels that the BLM objective has been met.

If there are any questions, please feel free to contact any of the following specialists:

Jim Amos
Supervisory Environmental Protection Specialist
575-234-5909 (Office), 575-361-2648 (Cell)

Linda Denniston
Environmental Protection Specialist
575-234-5974

Jennifer Van Curen
Environmental Protection Specialist
575-234-5905

Mike Burton
Environmental Protection Specialist
575-234-2226

Jeffery Robertson
Natural Resource Specialist

Solomon Hughes
Natural Resource Specialist
575-234-5951

Douglas Hoag
Civil Engineering Technician
575-234-5979