

UNITED STATES
DEPARTMENT OF THE INTERIOR
BUREAU OF LAND MANAGEMENTFORM APPROVED
OMB No. 1004-0137
Expires: October 31, 2014**SUNDRY NOTICES AND REPORTS ON WELLS**
Do not use this form for proposals to drill or to re-enter an abandoned well. Use Form 3160-3 (APD) for such proposals.5. Lease Serial No.
NMNM117545

6. If Indian, Allottee or Tribe Name

SUBMIT IN TRIPLICATE - Other instructions on page 2.

1. Type of Well

☒ Oil Well☐ Gas Well☐ Other

2. Name of Operator

Rubicon Oil & Gas, LLC

3a. Address

508 W. Wall St., Suite 500, Midland, TX 79701

3b. Phone No. (include area code)

432 683-6565

4. Location of Well (Footage, Sec., T., R., M., or Survey Description)

660' FNL & 1300' FWL, Sec 30, T20S, R25E, UL-D

7. If Unit of CA/Agreement, Name and/or No.

8. Well Name and No.

Stone 30 Federal, Well #1

9. API Well No.

30 015 35940

10. Field and Pool or Exploratory Area

Cemetery, Yeso

11. County or Parish, State

Eddy County, NM

12. CHECK THE APPROPRIATE BOX(ES) TO INDICATE NATURE OF NOTICE, REPORT OR OTHER DATA

TYPE OF SUBMISSION

TYPE OF ACTION

☐ Notice of Intent☐ Acidize☐ Deepen☐ Production (Start/Resume)☐ Water Shut-Off☐ Alter Casing☐ Fracture Treat☐ Reclamation☐ Well Integrity☒ Subsequent Report☐ Casing Repair☐ New Construction☐ Recomplete☒ Other☐ Change Plans☐ Plug and Abandon☐ Temporarily Abandon

facility diagram

☐ Final Abandonment Notice☐ Convert to Injection☒ Plug Back☐ Water Disposal

attached

13. Describe Proposed or Completed Operation: Clearly state all pertinent details, including estimated starting date of any proposed work and approximate duration thereof. If the proposal is to deepen directionally or recompleat horizontally, give subsurface locations and measured and true vertical depths of all pertinent markers and zones. Attach the Bond under which the work will be performed or provide the Bond No. on file with BLM/BIA. Required subsequent reports must be filed within 30 days following completion of the involved operations. If the operation results in a multiple completion or recompleat in a new interval, a Form 3160-4 must be filed once testing has been completed. Final Abandonment Notices must be filed only after all requirements, including reclamation, have been completed and the operator has determined that the site is ready for final inspection.)

6/12/13: Moved in rigged up.

6/13/13: MIRU pump truck. Load casing w/5 bbl fresh water, test casing & frac vavle to 3000 psi, good test. MIRU wireline, RIH to PBDT @ 3258', POOH & PU GR-CCL & RIN to PBDT. Log up to 2000'. 3 1/8" perf gun, perforate Yeso 2836-840, 2793-795, 2769-771, 2728-730, 2693-695'. 12', 36 holes, 3 SPF. RD wireline & shut-in.

6/14/13: Frac well with 2000 gals 15% NEFE, 22700 gals 15% gel, 4800 gal 15% xlink. ISIP 2093'. Resume pumping. 13300 gal 15% xlink pad, 81400 gals 15% xlink w/135300# 20/40 sand, 9300 gals 15% xlink w/31000 20/40 SLC. ISIP 1849 psi. Total load to recover 2708 bbls, 166300# sand.

6/15/13-7/2/13: Recovering load.

9/24/13: Ran 2 3/8" J55 tubing to 2957'. Set frac tanks & generator for pumping unit. 9/25/13: Ran rods to 2911'. Well put on pump.

9/30/13: Well test 10 bbls oil per day and 20 bbls water per day. Gas tsm.

Setting up battery. No crude oil purchaser to date.

Battery diagram attached.

400 60000 3/14/14
p1000101 p000000

RECEIVED

MAR 14 2014

NMOCD ARTESIA

14. I hereby certify that the foregoing is true and correct. Name (Printed/Typed)

Ann Ritchie

Title Regulatory

Signature

Date 02/05/2014

THIS SPACE FOR FEDERAL OR STATE OFFICE USE

Approved by the BLM/BIA (Printed/Typed)

Title

Conditions of approval, if any, are attached. Approval of this notice does not warrant or certify

Date

that the applicant holds legal or equitable title to those rights in the subject lease which would

Office

entitle the applicant to conduct operations thereon.

Office

Title 18 U.S.C. Section 1001 and Title 43 U.S.C. Section 1212, make it a crime for any person knowingly and willfully to make to any department or agency of the United States any false, fictitious or fraudulent statements or representations as to any matter within its jurisdiction.

(Instructions on page 2)

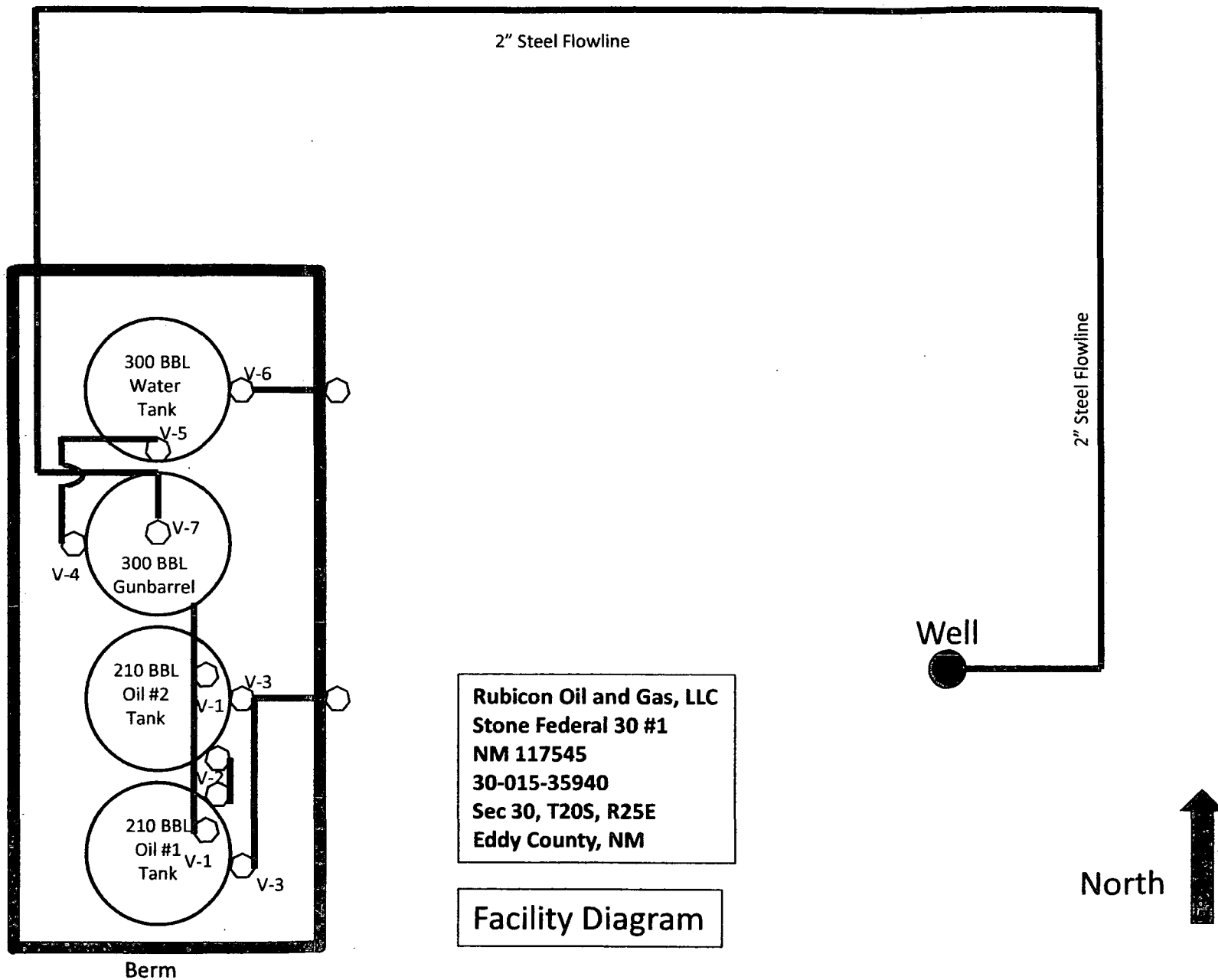

Rubicon Oil & Gas, LLC
Stone 30 Federal No. 1
NM 117545
30-015-35940
Sec 30, T20S, R25E
Eddy County, NM

Valving Configuration for Production and Sales Operations

1. Production Phase (OT #1)
 - a) Valves #1,#2, #4, #5, & #7 Open
 - b) Valve #3 closed & sealed
 - c) Valves #6 closed
 - d) OT #2 valves #1 closed, #3 closed & sealed
2. Production Phase (OT #2)
 - e) Valves #1,#2, #4, #5, & #7 Open
 - f) Valve #3 closed & sealed
 - g) Valves #6 closed
 - a) OT #1 valves #1 closed, #3 closed & sealed
3. Sales Phase (OT #1)
 - a) Valves #1, & #2 closed and sealed
 - b) Valve #3 open (during truck loading)
 - c) OT #2 valves #1 open, & #3 closed & sealed
4. Sales Phase (OT #2)
 - a) Valves #1, & #2 closed and sealed
 - b) Valve #3 open (during truck loading)
 - c) OT #1 valves #1 open, & #3 closed & sealed