

UNITED STATES
DEPARTMENT OF THE INTERIOR
BUREAU OF LAND MANAGEMENT

OCD Artesia

FORM APPROVED
OMB NO. 1004-0135
Expires: July 31, 2010

SUNDRY NOTICES AND REPORTS ON WELLS
Do not use this form for proposals to drill or to re-enter an abandoned well. Use form 3160-3 (APD) for such proposals.

SUBMIT IN TRIPLICATE - Other instructions on reverse side.

1. Type of Well <input checked="" type="checkbox"/> Oil Well <input type="checkbox"/> Gas Well <input type="checkbox"/> Other		5. Lease Serial No. NMNM0405444A
2. Name of Operator DEVON ENERGY PRODUCTION CO		6. If Indian, Allottee or Tribe Name
Contact: TRINA C COUCH Email: trina.couch@dev.com		7. If Unit or CA/Agreement, Name and/or No.
3a. Address 333 WEST SHERIDAN AVE OKLAHOMA CITY, OK 73102	3b. Phone No. (include area code) Ph: 405-228-7203	8. Well Name and No. ALDABRA 25 FEDERAL COM 2H
4. Location of Well (Footage, Sec., T., R., M., or Survey Description) Sec 25 T23S R31E SWSW 200FSL 685FWL		9. API Well No. 30-015-38613-00-X1
		10. Field and Pool, or Exploratory JENNINGS
		11. County or Parish, and State EDDY COUNTY, NM

12. CHECK APPROPRIATE BOX(ES) TO INDICATE NATURE OF NOTICE, REPORT, OR OTHER DATA

TYPE OF SUBMISSION	TYPE OF ACTION			
<input checked="" type="checkbox"/> Notice of Intent	<input type="checkbox"/> Acidize	<input type="checkbox"/> Deepen	<input type="checkbox"/> Production (Start/Resume)	<input type="checkbox"/> Water Shut-Off
<input type="checkbox"/> Subsequent Report	<input type="checkbox"/> Alter Casing	<input type="checkbox"/> Fracture Treat	<input type="checkbox"/> Reclamation	<input type="checkbox"/> Well Integrity
<input type="checkbox"/> Final Abandonment Notice	<input type="checkbox"/> Casing Repair	<input type="checkbox"/> New Construction	<input type="checkbox"/> Recomplete	<input checked="" type="checkbox"/> Other
	<input type="checkbox"/> Change Plans	<input type="checkbox"/> Plug and Abandon	<input type="checkbox"/> Temporarily Abandon	Change to Original APD
	<input type="checkbox"/> Convert to Injection	<input type="checkbox"/> Plug Back	<input type="checkbox"/> Water Disposal	

13. Describe Proposed or Completed Operation (clearly state all pertinent details, including estimated starting date of any proposed work and approximate duration thereof. If the proposal is to deepen directionally or recompleat horizontally, give subsurface locations and measured and true vertical depths of all pertinent markers and zones. Attach the Bond under which the work will be performed or provide the Bond No. on file with BLM/BIA. Required subsequent reports shall be filed within 30 days following completion of the involved operations. If the operation results in a multiple completion or recompleat in a new interval, a Form 3160-4 shall be filed once testing has been completed. Final Abandonment Notices shall be filed only after all requirements, including reclamation, have been completed, and the operator has determined that the site is ready for final inspection.)

Devon Energy Production Company, L.P. respectfully requests to change the name on the approved subject well:

FROM
ALDABRA 25 FED 2H

TO
ALDABRA 25 FED COM 2H

NM OIL CONSERVATION
ARTESIA DISTRICT

AUG 19 2014

**SUBJECT TO LIKE
APPROVAL BY STATE**

*Please see revised plat attached

RECEIVED

Accepted for record
NMOC

TEC 8-19-2014

14. I hereby certify that the foregoing is true and correct. Electronic Submission #253302 verified by the BLM Well Information System For DEVON ENERGY PRODUCTION CO LP, sent to the Carlsbad Committed to AFMSS for processing by JENNIFER MASON on 08/11/2014 (14JAM0379SE)	
Name (Printed/Typed) TRINA C COUCH	Title REGULATORY ANALYST
Signature (Electronic Submission)	Date 07/16/2014
APPROVED	
THIS SPACE FOR FEDERAL OR STATE OFFICE USE	
Approved By	Title
Conditions of approval, if any, are attached. Approval of this notice does not warrant or certify that the applicant holds legal or equitable title to those rights in the subject lease which would entitle the applicant to conduct operations thereon.	Office
BUREAU OF LAND MANAGEMENT CARLSBAD FIELD OFFICE	
Title 18 U.S.C. Section 1001 and Title 43 U.S.C. Section 1212, make it a crime for any person knowingly and willfully to make to any department or agency of the United States any false, fictitious or fraudulent statements or representations as to any matter within its jurisdiction.	

**** BLM REVISED ** BLM REVISED ** BLM REVISED ** BLM REVISED ** BLM REVISED ****

District I

1625 N. French Dr., Hobbs, NM 88240

District II

1301 W. Grand Avenue, Artesia, NM 88210

District III

1000 Rio Brazos Rd., Aztec, NM 87410

District IV

1220 S. St. Francis Dr., Santa Fe, NM 87505

State of New Mexico

Energy, Minerals & Natural Resources Department

OIL CONSERVATION DIVISION

1220 South St. Francis Dr.

Santa Fe, NM 87505

Form C-102

Revised October 15, 2009

Submit one copy to appropriate

District Office

☐ AMENDED REPORT

WELL LOCATION AND ACREAGE DEDICATION PLAT

¹ API Number	² Pool Code	³ Pool Name Bone Spring
⁴ Property Code	⁵ Property Name ALDABRA "25" FED. COM	⁶ Well Number 2H
⁷ OGRID No. 6137	⁸ Operator Name DEVON ENERGY PRODUCTION COMPANY, L.P.	⁹ Elevation 3484.7

¹⁰ Surface Location

UL or lot no.	Section	Township	Range	Lot Idn	Feet from the	North/South line	Feet from the	East/West line	County
M	25	23 S	31 E		200	SOUTH	685	WEST	EDDY

¹¹ Bottom Hole Location If Different From Surface

UL or lot no.	Section	Township	Range	Lot Idn	Feet from the	North/South line	Feet from the	East/West line	County
D	25	23 S	31 E		330	NORTH	1000	WEST	EDDY

¹² Dedicated Acres 160	¹³ Joint or Infill	¹⁴ Consolidation Code	¹⁵ Order No.
--------------------------------------	-------------------------------	----------------------------------	-------------------------

No allowable will be assigned to this completion until all interests have been consolidated or a non-standard unit has been approved by the division.

<p>1000'</p> <p>330'</p> <p>NW CORNER SEC. 25 LAT. = 32°16'58.20"N LONG. = 103°44'24.25"W</p> <p>NMSP EAST (FT) N = 467084.84 E = 724686.25</p>	<p>TOE TARGET</p> <p>TOE TARGET LAT. = 32°16'54.93"N LONG. = 103°44'12.60"W</p> <p>NMSP EAST (FT) N = 466759.94 E = 725688.05</p>		<p>NE CORNER SEC. 25 LAT. = 32°16'58.17"N LONG. = 103°43'22.78"W</p> <p>NMSP EAST (FT) N = 467111.87 E = 729964.84</p>	<p>¹⁷ OPERATOR CERTIFICATION</p> <p>I hereby certify that the information contained herein is true and complete to the best of my knowledge and belief, and that this organization either owns a working interest or unleased mineral interest in the land including the proposed bottom hole location or has a right to drill this well at this location pursuant to a contract with an owner of such a mineral or working interest, or to a voluntary pooling agreement or a compulsory pooling order heretofore entered by the division.</p> <p>7/16/14</p> <p>Signature _____ Date _____</p> <p>Printed Name Trina C. Couch, Regulatory Analyst</p>
<p>SW CORNER SEC. 25 LAT. = 32°16'05.93"N LONG. = 103°44'24.27"W</p> <p>NMSP EAST (FT) N = 461801.94 E = 724713.65</p>	<p>ALDABRA "25" FED. COM #2H</p> <p>ELEV. = 3484.7'</p> <p>LAT. = 32°16'07.914"N (NAD83) LONG. = 103°44'16.294"W</p> <p>NMSP EAST (FT) N = 462005.94 E = 725397.74</p>			<p>¹⁸ SURVEYOR CERTIFICATION</p> <p>I hereby certify that the well location shown on this plat was plotted from field notes of actual surveys made by me or under my supervision, and that the same is true and correct to the best of my belief.</p> <p>SEPTEMBER 16, 2014</p> <p>Date of Survey _____</p> <p>Signature and Seal of Professional Surveyor _____</p> <p>Certificate Number _____</p> <p>ELIMONIE JARAMILLO, PLS 12797</p> <p>SURVEY NO. 218</p>
<p>1000'</p> <p>200'</p> <p>685'</p> <p>660'</p> <p>SURFACE LOCATION</p>	<p>HEAL TARGET</p> <p>HEAL TARGET LAT. = 32°16'12.46"N LONG. = 103°44'12.62"W</p> <p>NMSP EAST (FT) N = 462467.70 E = 725710.38</p>		<p>SE CORNER SEC. 25 LAT. = 32°16'05.94"N LONG. = 103°43'22.80"W</p> <p>NMSP EAST (FT) N = 461832.84 E = 729992.42</p>	

EXIST. CALICHE RD.

600'

4/W POWERLINE

142' ACCESS ROAD

150' NORTH
OFFSET
EL. 3487.5'

ALDABRA "25" FED. COM #2H
ELEV. = 3484.7'

150' WEST
OFFSET
EL. 3482.8'

150' EAST
OFFSET
EL. 3490.7'

150' SOUTH
OFFSET
EL. 3484.0'

LAT. = 32°16'07.914"N (NAD83)
LONG. = 103°44'16.294"W
NMSP EAST (FT)
N = 462005.94
E = 725397.74

SEC. 25
SEC. 36

LEGEND
① - ALDABRA "25" FED. COM #1H WELL

600'

SCALE 1" = 100

DIRECTIONS TO LOCATION

FROM STATE HWY. 128 AND CO. RD. 798 (RED RD.) GO NORTH ON
CR 798 1.2 MILES, TURN RIGHT ON CALICHE ROAD AND GO EAST
0.15 MILES AND LOCATION IS ON RIGHT (SOUTH) 330'

DEVON ENERGY PRODUCTION COMPANY, L.P.

ALDABRA "25" FED. COM #2H

LOCATED 200 FT. FROM THE SOUTH LINE
AND 685 FT. FROM THE WEST LINE OF
SECTION 25, TOWNSHIP 23 SOUTH,
RANGE 31 EAST, N.M.P.M.
EDDY COUNTY, STATE OF NEW MEXICO

SEPTEMBER 18, 2010

SURVEY NO. 218

MADRON SURVEYING, INC. 301 SOUTH CANAL CARLSBAD, NEW MEXICO
(505) 897-5820

SECTION 25, TOWNSHIP 23 SOUTH, RANGE 31 EAST, N.M.P.M.
 EDDY COUNTY, STATE OF NEW MEXICO
LOCATION VERIFICATION MAP

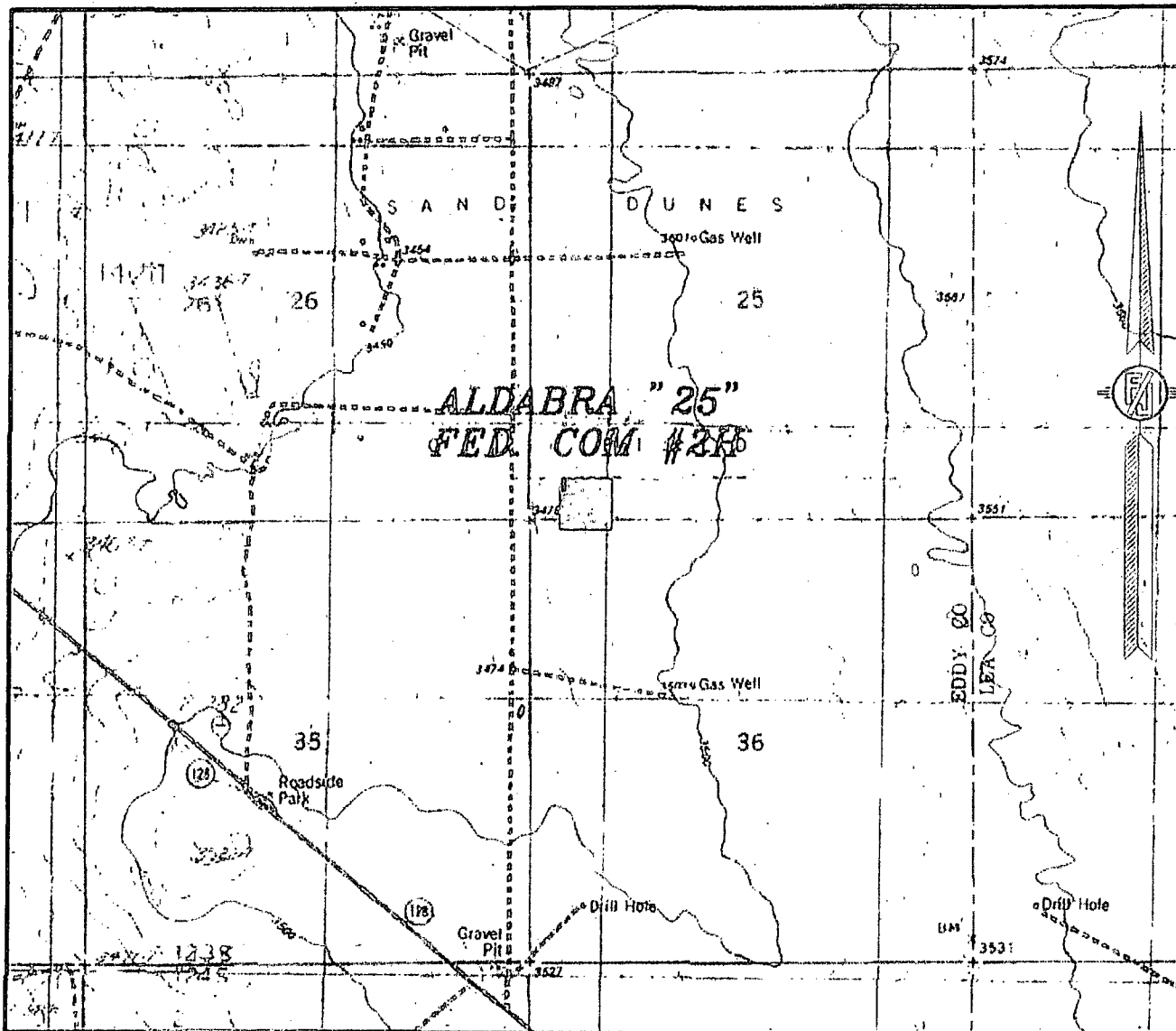

CONTOUR INTERVAL:
 LOS MEDANOS

NOT TO SCALE

DEVON ENERGY PRODUCTION COMPANY, L.P.

ALDABRA "25" FED. COM #2H

LOCATED 200 FT. FROM THE SOUTH LINE
 AND 685 FT. FROM THE WEST LINE OF
 SECTION 25, TOWNSHIP 23 SOUTH,
 RANGE 31 EAST, N.M.P.M.
 EDDY COUNTY, STATE OF NEW MEXICO

SEPTEMBER 18, 2010

SURVEY NO. 218

MADRON SURVEYING, INC. 501 SOUTH CALI CARLSBAD, NEW MEXICO
 (575) 381-5835

SECTION 25, TOWNSHIP 23 SOUTH, RANGE 31 EAST, N.M.P.M.
EDDY COUNTY, STATE OF NEW MEXICO
VICINITY MAP

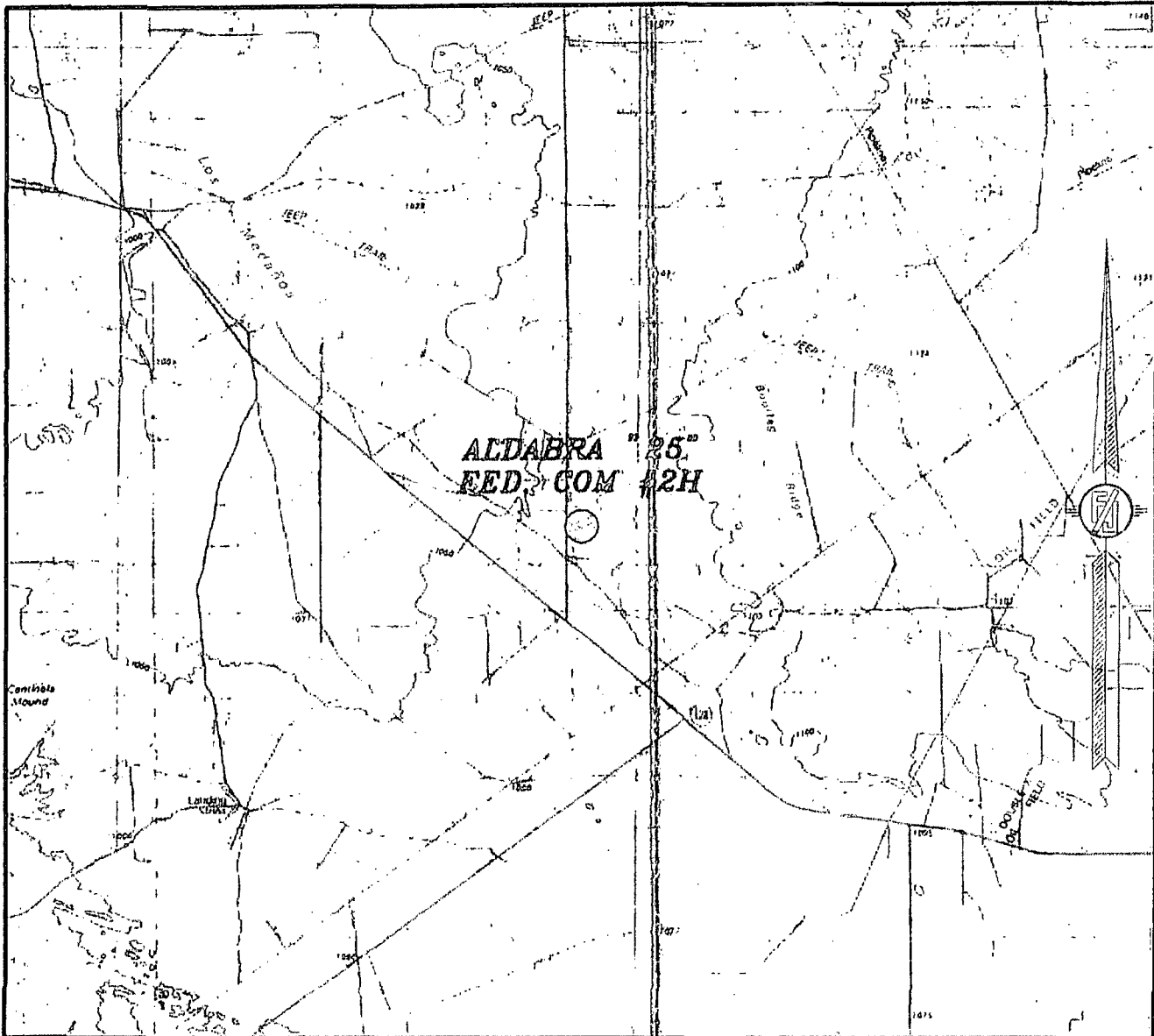

NOT TO SCALE

DEVON ENERGY PRODUCTION COMPANY, L.P.

ALDABRA "25" FED. COM #2H

LOCATED 200 FT. FROM THE SOUTH LINE
AND 685 FT. FROM THE WEST LINE OF

SECTION 25, TOWNSHIP 23 SOUTH,

RANGE 31 EAST, N.M.P.M.

EDDY COUNTY, STATE OF NEW MEXICO

SEPTEMBER 18, 2010

SURVEY NO. 218

MADRON SURVEYING, INC. 351 SOUTH CARL
(5/5) 847-5830 CARLSBAD, NEW MEXICO

SECTION 25, TOWNSHIP 23 SOUTH, RANGE 31 EAST, N.M.P.M.
EDDY COUNTY, STATE OF NEW MEXICO

AERIAL PHOTO

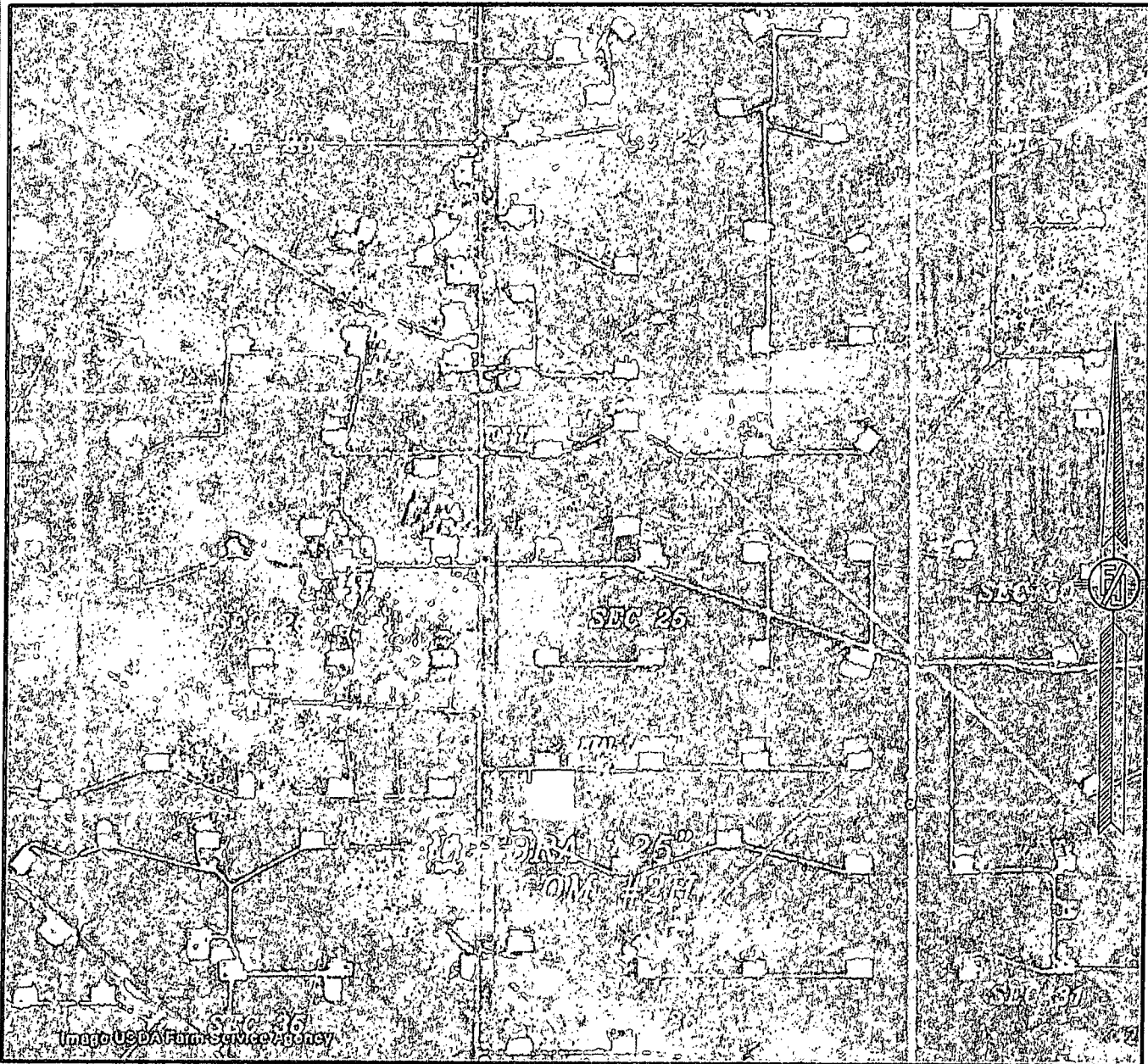

NOT TO SCALE
AERIAL PHOTO:
GOOGLE EARTH
USDA - AUG, 2009

DEVON ENERGY PRODUCTION COMPANY, L.P.

ALDABRA "25" FED. COM #2H

LOCATED 200 FT. FROM THE SOUTH LINE
AND 685 FT. FROM THE WEST LINE OF
SECTION 25, TOWNSHIP 23 SOUTH,
RANGE 31 EAST, N.M.P.M.
EDDY COUNTY, STATE OF NEW MEXICO

SEPTEMBER 18, 2010

SURVEY NO. 218

MADRON SURVEYING, INC. 301 SOUTH CANAL CARLSBAD, NEW MEXICO
(575) 887-5836