

Resubmitted 1st. 2
If earthen pits are used in association with the drilling of this well, an OCD pit permit must be obtained prior to pit construction.

Form 3160-3
(August 1999)

UNITED STATES
DEPARTMENT OF THE INTERIOR
BUREAU OF LAND MANAGEMENT

APPLICATION FOR PERMIT TO DRILL OR REENTER

RECEIVED

DEC 12 2005

COB-ARTESIA

0
OMB No. 1004-0136
Expires November 30, 2000

5. Lease Serial No.

NMLC028990B

6. If Indian, Allottee or Tribe Name

7. If Unit or CA Agreement, Name and No.

13231

8. Lease Name and Well No.

Creek AL Federal #18 A

9. API Well No.

30-015-34470

10. Field and Pool, or Exploratory

Shugart; Bone Spring, North

11. Sec., T., R., M., or Blk. and Survey or Area

Section 25, T18S-R30E, NENE

12. County or Parish

Eddy County

13. State

NM

1a. Type of Work:

☒ DRILL

☐ REENTER

b. Type of Well:

☒ Oil Well

☐ Gas Well

☐ Other

☐ Single Zone

☐ Multiple Zone

2. Name of Operator

Yates Petroleum Corporation, 25575

3A. Address 105 South Fourth Street

Artesia, New Mexico 88210

3b. Phone No. (include area code)

(505) 748-1471

4. Location of Well (Report location clearly and in accordance with any State requirements. *)

At surface

500' FNL and 500' FEL, Unit A

At proposed prod. Zone

Same

Secretary's Potash

14. Distance in miles and direction from nearest town or post office*

Approximately 9 miles Southwest of Loco Hills, New Mexico

15. Distance from proposed*

location to nearest property or lease line, ft. (Also to nearest drig. unit line, if any)

500'

16. No. of Acres in lease

560

17. Spacing Unit dedicated to this well

40 acres NE/NE

18. Distance from proposed location*

to nearest well, drilling, completed, applied for, on this lease, ft.

1700'

19. Proposed Depth

8400'

20. BLM/BIA Bond No. on file

NM-2811

21. Elevations (Show whether DF, KDB, RT, GL, etc.)

3620' GL

22. Approximate date work will start*

ASAP

23. Estimated duration

30 days

24. Attachments

Captain Controlled Water Basin

The following, completed in accordance with the requirements of Onshore Oil and Gas Order No. 1, shall be attached to this form:

1. Well plat certified by a registered surveyor.

2. A Drilling Plan.

3. A Surface Use Plan (if the location is on National Forest System Lands, the SUPO shall be filed with the appropriate Forest Service Office.

4. Bond to cover the operations unless covered by an existing bond on file (see Item 20 above).

5. Operator certification.

6. Such other site specific information and/or plans as may be required by the authorized office.

15. Signature

Debbie L. Caffall

Name (Printed/Typed)

Debbie L. Caffall

Date

10/19/2005

Title:

Regulatory Technician

Approved by (Signature)

/s/ Linda S. C. Rundell

Name (Printed/Typed)

/s/ Linda S. C. Rundell

Date

DEC 02 2005

Title

STATE DIRECTOR

Office

NM STATE OFFICE

Application approval does not warrant or certify that the applicant holds legal or equitable title to those rights in the subject lease which would entitle the applicant to conduct operations thereon.

Conditions of approval, if any, are attached.

APPROVAL FOR 1 YEAR

Title 18 U.S.C. Section 1001 and Title 43 U.S.C. Section 1212, make it a crime for any person knowingly and willfully to make to any department or agency of the United States any false, fictitious or fraudulent statements or representations as to any matter within its jurisdiction.

*(Instructions on reverse)

C-144 attached

Previously Approved

APPROVAL SUBJECT TO
GENERAL REQUIREMENTS AND
SPECIAL STIPULATIONS
ATTACHED

WITNESS : 13 3/8" CSG CEMENT JOB

District I
1625 N. French Dr., Hobbs, NM 88240

District II
811 South First, Artesia, NM 88210

District III
1000 Rio Brazos Rd., Aztec, NM 87410

District IV
1220 S. St. Francis Dr., Santa Fe, NM 87505

State of New Mexico
Energy, Minerals & Natural Resources Department

OIL CONSERVATION DIVISION
1220 South St. Francis Dr.
Santa Fe, NM 87505

Form C-102
Revised August 15, 2000

Submit to Appropriate District Office
State Lease - 4 Copies
Fee Lease - 3 Copies

☐ AMENDED REPORT

WELL LOCATION AND ACREAGE DEDICATION PLAT

¹ API Number 30-015-32107-00-X1	² Pool Code 56405	³ Pool Name Shugart Bone Spring, North
⁴ Property Code	⁵ Property Name Creek AL Federal	⁶ Well Number 18
⁷ OGRID No. 025575	⁸ Operator Name Yates Petroleum Corporation	⁹ Elevation 3620

¹⁰ Surface Location

UL or lot no. A	Section 25	Township 18S	Range 30E	Lot Idn	Feet from the 500	North/South line North	Feet from the 500	East/West line East	County Eddy
---------------------------	----------------------	------------------------	---------------------	---------	-----------------------------	----------------------------------	-----------------------------	-------------------------------	-----------------------

¹¹ Bottom Hole Location If Different From Surface

UL or lot no.	Section	Township	Range	Lot Idn	Feet from the	North/South line	Feet from the	East/West line	County
¹² Dedicated Acres 40	¹³ Joint or Infill	¹⁴ Consolidation Code	¹⁵ Order No.						

NO ALLOWABLE WILL BE ASSIGNED TO THIS COMPLETION UNTIL ALL INTERESTS HAVE BEEN CONSOLIDATED OR A NON-STANDARD UNIT HAS BEEN APPROVED BY THE DIVISION

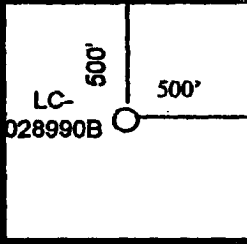
¹⁶		¹⁷ OPERATOR CERTIFICATION I hereby certify that the information contained herein is true and complete to the best of my knowledge and belief. <i>Cy Cowan</i> Signature Cy Cowan Printed Name Regulatory Agent Title 9/26/03 Date
		¹⁸ SURVEYOR CERTIFICATION I hereby certify that the well location shown on this plat was plotted from field notes of actual surveys made by me or under my supervision, and that the same is true and correct to the best of my belief. REFER TO ORIGINAL PLAT Date of Survey Signature and Seal of Professional Surveyor:
		Certificate Number

YATES PETROLEUM CORPORATION
Creek ALFederal #18
 500' FNL & 500' FEL
 Section. 25 -T18S-R30-E
 Eddy County, New Mexico

1. The estimated tops of geologic markers are as follows:

Rustler	490'
Tansill	1810'
Yates	1922'
Seven Rivers	2360'
Queen	3075'
Grayburg	3575'
Delaware	4500'
Bone Spring	5930'
Dolomite	8225'
TD	8400'

2. The estimated depths at which anticipated water, oil or gas formations are expected to be encountered:

Water: Approx 250' - 350'
 Oil or Gas: All Potential Zones

3. Pressure Control Equipment: BOPE will be installed on the 8 5/8" casing and rated for 3000 BOP systems will be consistent with API RP 53. Pressure tests will be conducted before drilling out from under all casing strings which are set and cemented in place. Blowout Preventor controls will be installed prior to drilling the surface plug and will remain in use until the well is completed or abandoned. Preventors will be inspected and operated at least daily to ensure good mechanical working order, and this inspection recorded on the daily drilling report. See Exhibit B.

Auxiliary Equipment:

A. Auxiliary Equipment: Kelly cock, pit level indicators, flow sensor equipment and a sub with full opening valve to fit the drill pipe and collars will be available on the rig floor in the open position at all times for use when kelly is not in use.

4. THE PROPOSED CASING AND CEMENTING PROGRAM:

A. Casing Program: (All New)

<u>Hole Size</u>	<u>Casing Size</u>	<u>Wt./Ft</u>	<u>Grade</u>	<u>Coupling</u>	<u>Interval</u>	<u>Length</u>
17 1/2"	13 3/8"	48#	H-40	ST&C	0-700'	700'
11 "	8 5/8"	32#	J-55	ST&C	0-2800'	2800'
7 7/8"	5 1/2"	17#	J-55	LT&C	0-100'	100'
7 7/8"	5 1/2"	15.5#	J-55	LT&C	100-6800'	6700'
7 7/8"	5 1/2"	17#	J-55	LT&C	6800-8400'	1600'

Minimum Casing Design Factors: Collapse 1.125, Burst 1.0, Joint Strength 1.8

B. CEMENTING PROGRAM:

Surface casing: 400 sx Lite (Yld 2 Wt.12.5) Tail in w/ 250 sx Class "C"+ 2% CaCL₂ (Yld 1.32 Wt 14.8)

Intermediate Casing: 600 sx Lite (Yld 2 Wt 12.5); Tail in w/250 sx Class "C" + 2% CaCL₂ (Yld 1.32 Wt. 14.8)

Production Casing: TOC-2300'; 550 sx Lite (Yld 2 Wt. 12.5). Tail in w/ 500 sx Super "C" (Yld 1.62 Wt 13.2)

5. Mud Program and Auxiliary Equipment:

<u>Interval</u>	<u>Type</u>	<u>Weight</u>	<u>Viscosity</u>	<u>Fluid Loss</u>
0-700'	FW/Native Mud	8.4-9.0	28-32	N/C
700'-2800'	Brine	10.0-10.2	28	N/C
2800'-TD'	FW/Cut Brine	8.4-9.2	28	N/C

Sufficient mud material(s) to maintain mud properties, control lost circulation and contain a blow out will be available at the well site during drilling operations. Mud will be checked hourly by rig personnel.

6. EVALUATION PROGRAM:

Samples: 30' samples to 5000'. 10' samples 5000' to TD.

Logging: Platform HALS

Coring: Sidewall cores as warranted.

DST's: As warranted.

7. Abnormal Conditions, Bottom hole pressure and potential hazards:

Anticipated BHP:

From: O	TO: 700'	Anticipated Max. BHP:	300	PSI
From: 700'	TO: 2800'	Anticipated Max. BHP:	1200	PSI
From: 2800'	TO: TD	Anticipated Max. BHP:	3700	PSI

No abnormal pressures or temperatures are anticipated.

Lost Circulation Zones Anticipated: None.

H₂S Zones Anticipated: None

8. ANTICIPATED STARTING DATE:

Plans are to drill this well as soon as possible after receiving approval. It should take approximately 30 days to drill the well with completion taking another 15 days.

MULTI-POINT SURFACE USE AND OPERATIONS PLAN
Yates Petroleum Corporation
Creek AL Federal #18
500' FNL & 500' FEL
Section. 25, T-18S-R30-E
Eddy County, New Mexico

This plan is submitted with Form 3160-3, Application for Permit to Drill, covering the above described well. The purpose of this plan is to describe the location of the proposed well, the proposed construction activities and operations plan, the magnitude of the surface disturbance involved and the procedures to be followed in rehabilitating the surface after completion of the operations, so that a complete appraisal can be made of the environmental effect associated with the operations.

1. EXISTING ROADS:

Exhibit A is a portion of the BLM map showing the well and roads in the vicinity of the proposed location. The proposed wellsite is located approximately 9 miles southeast of Loco Hills, New Mexico and the access route to the location is indicated in red and green on Exhibit A.

DIRECTIONS:

Go east of Artesia on Highway 82 to Highway 360. Turn right on 360 and go to Duval Shaft Road (CR-251). Turn left on Duval Shaft Road and go to Grubbs Road (CR-250). Turn right on Grubbs road and go approx. 4.8 miles. Turn left here and go approx. .7 of a mile. Turn left and go .7 of a mile to the Creek AL Battery on the right. On the northwest corner of the Creek Battery follow lease road to the north for approx. .2 of a mile. The new road will start here going east.

2. PLANNED ACCESS ROAD.

- A. The proposed new access will go east for approximately .2 of a mile to the southwest corner of the drilling pad. The road will lie in a west to east direction.
- B. The new road will be 14 feet in width (driving surface) and will be adequately drained to control runoff and soil erosion.
- C. The new road will be bladed with drainage on one side. Traffic turnouts may be built.
- D. The route of the road is visible.
- E. Existing roads will be maintained in the same or better condition.

3. LOCATION OF EXISTING WELL

- A. There is drilling activity within a one-mile radius of the wellsite.
- B. Exhibit D shows existing wells within a one-mile radius of the proposed wellsite.

4. LOCATION OF EXISTING AND/OR PROPOSED FACILITIES

- A. There are production facilities on this lease at the present time.
- B. In the event that the well is productive, the necessary production facilities will be installed on the drilling pad. If the well is productive oil, a gas or diesel self-contained unit will be used to provide the necessary power. No power will be required if the well is productive of gas.

5. LOCATION AND TYPE OF WATER SUPPLY:

- A. It is planned to drill the proposed well with a fresh water system. The water will be obtained from commercial sources and will be hauled to the location by truck over the existing and proposed roads shown in Exhibit A.

6. SOURCE OF CONSTRUCTION MATERIALS:

Dirt contractor will locate closest pit and obtain any permits and materials needed for construction.

7. METHODS OF HANDLING WASTE DISPOSAL:

- A. Drill cuttings will be disposed of in the reserve pits.
- B. Drilling fluids will be allowed to evaporate in the reserve pits until the pits are dry.
- C. Water produced during operations will be collected in tanks until hauled to an approved disposal system, or separate disposal application will be submitted.
- D. Oil produced during operations will be stored in tanks until sold.
- E. Current laws and regulations pertaining to the disposal of human waste will be complied with.
- F. All trash, junk, and other waste materials will be contained in trash cages or bins to prevent scattering and will be removed and deposited in an approved sanitary land fill. Burial on site is not approved.

8. ANCILLARY FACILITIES: None.

9. WELLSITE LAYOUT:

- A. Exhibit C shows the relative location and dimensions of the well pad, the reserve pits, the location of the drilling equipment, rig orientation and access road approach.
- B. The reserve pits will be plastic lined.
- C. A 400' x 400' area has been staked and flagged.

10. PLANS FOR RESTORATION

- A. After finishing drilling and/or completion operations, all equipment and other material not needed for further operations will be removed. The location will be cleaned of all trash and junk to leave the wellsite in as aesthetically pleasing a condition as possible.
- B. Unguarded pits, if any, containing fluids will be fenced until they have dried and been leveled.
- C. If the proposed well is non-productive, all rehabilitation and/or vegetation requirements of the Bureau of Land Management will be complied with and will be accomplished as expeditiously as possible. All pits will be filled level after they have evaporated and dried.

11. SURFACE OWNERSHIP: Federal surface, Administered by the Bureau of Land Management, Carlsbad, New Mexico.

12. OTHER INFORMATION:

- A. Topography: Refer to the existing archaeological report for a description of the topography, flora, fauna, soil characteristics, dwellings, historical and cultural sites.
- B. The primary surface use is for grazing.

13. OPERATOR'S REPRESENTATIVE

- | | |
|---|--|
| A. Through A.P.D. Approval: | B. Through Drilling Operations,
Completions and Production: |
| Cy Cowan, Regulatory Agent

Yates Petroleum Corporation
105 South Fourth Street
Artesia, New Mexico 88210
Phone (505) 748-1471 | Pinson McWhorter,
Operations Manager
Yates Petroleum Corporation
105 South Fourth Street
Artesia, New Mexico 88210
Phone (505) 748-1471 |

14. CERTIFICATION:

I hereby certify that I, or persons under my direct supervision, have inspected the proposed drill site and access route, that I am familiar with the conditions which presently exist; that the statements made in this plan are to the best of my knowledge, true and correct; and , that the work associated with the operations proposed herein will be performed by Yates Petroleum Corporation and its contractors and subcontractors in conformity with this plan and the terms and conditions under which it is approved. This statement is subject to the provisions of 18 U.S.C. 1001 for the filing of a false statement.

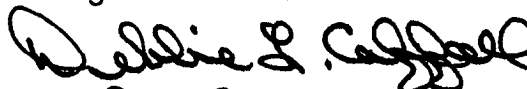
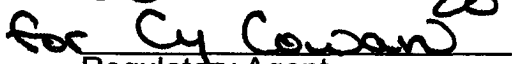

Regulatory Agent

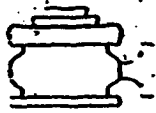
10/19/2005



Yates Petroleum Corporation

BOP-3

Typical 3,000 psi Pressure System Schematic Annular with Double Ram Preventer Stack

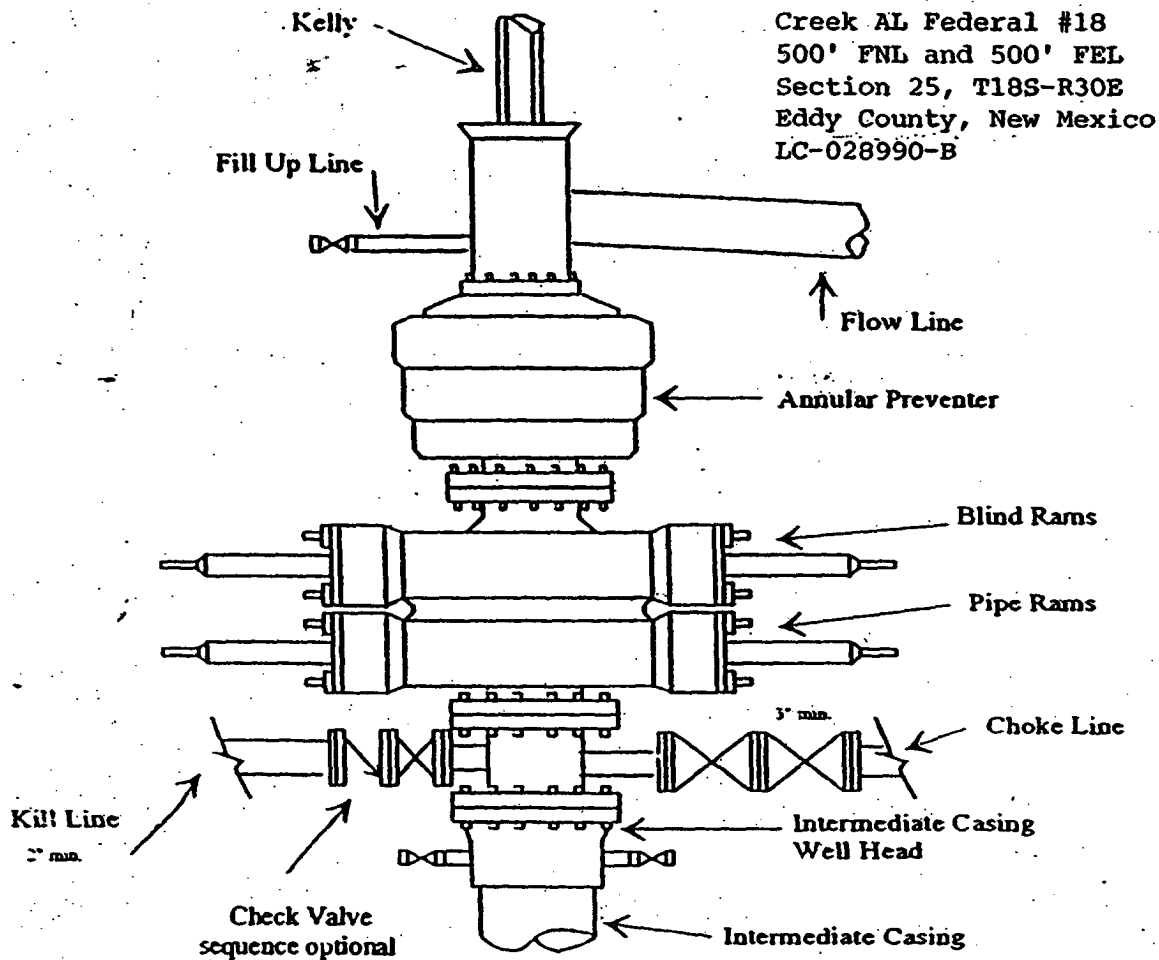

Typical 3,000 psi choke manifold assembly with at least these minimum features

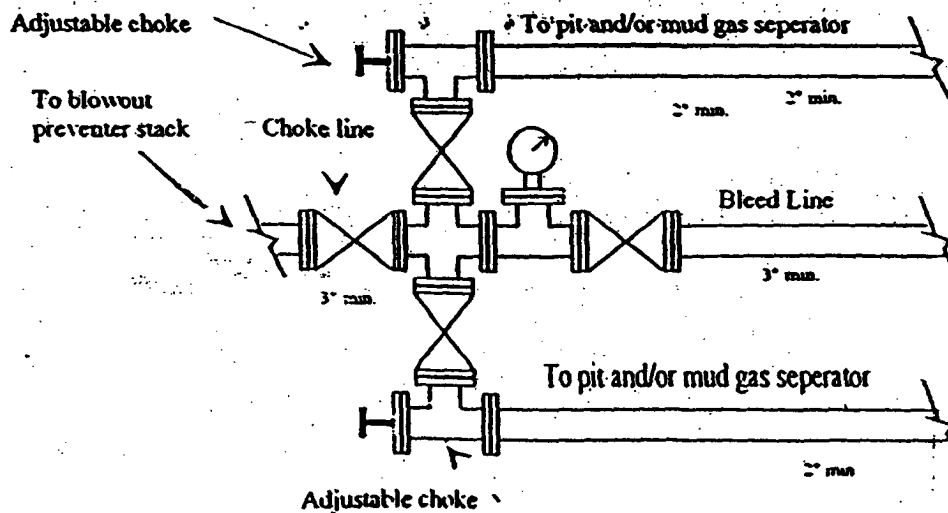

MARTIN YATES, III
1912 - 1985
FRANK W. YATES
1936 - 1986



105 SOUTH FOURTH STREET
ARTESIA, NEW MEXICO 88210-2118
TELEPHONE (505) 748-1471

S. P. YATES
CHAIRMAN OF THE BOARD
JOHN A. YATES
PRESIDENT
PEYTON YATES
EXECUTIVE VICE PRESIDENT
RANDY G. PATTERSON
SECRETARY
DENNIS G. KINSEY
TREASURER

October 19, 2005

Attention: Mr. Dan Morehouse, Chief Mining Engineer
Mosaic Potash Carlsbad Inc.
P.O. Box 71
Carlsbad, New Mexico 88221-0071

RE: Creek AL Federal #18
Township 18 South, Range 30 East
Section 25: 500' FNL & 500' FEL
Eddy County, New Mexico

Dear Mr. Morehouse:

Yates Petroleum Corporation wishes to place the captioned well on our list for future drilling operations. We are planning to drill this well to a total depth of 8,200' or 100' below the base of the Delaware Formation. We have been advised that your company is the owner of certain potash leases in this area. Therefore, we respectfully request that you waive any objections you may have to this proposed well location and so indicate by signing and returning one copy of this letter in the enclosed envelope.

Your favorable consideration of this request will be greatly appreciated. Thank you.

Very truly yours,

YATES PETROLEUM CORPORATION

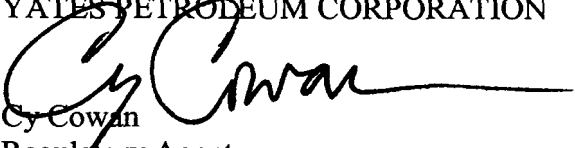
Cy Cowan
Regulatory Agent

☐ NO OBJECTION OFFERED
Mosaic Potash Carlsbad Inc.

By: _____

Title: _____

Date: _____

☐ OBJECTION OFFERED
Mosaic Potash Carlsbad Inc.

By: _____

Title: _____

Date: _____

CONDITIONS OF APPROVAL - DRILLING

Operator's Name: YATES PETROLEUM CORPORATION
Well Name & No.: 18 - CREEK AL FEDERAL
Location: 500' FNL & 500' FEL - SEC 25 - T18S - R30E - EDDY COUNTY
Lease: NMLC-028990-B

I. DRILLING OPERATIONS REQUIREMENTS:

1. The Bureau of Land Management (BLM) is to be notified at the Roswell Field Office, 2909 West Second St., Roswell NM 88201, (505) 627-0272 for wells in Chaves and Roosevelt Counties; the Carlsbad Field Office, 620 East Greene St., Carlsbad, NM 88220, (505) 234-5909 or (505) 361-2822 (After hours) - for wells in Eddy County; and the Hobbs Field Station, 414 West Taylor, Hobbs NM 88240, (505) 393-3612 for wells in Lea County, in sufficient time for a representative to witness:
 - A. Spudding
 - B. Cementing casing: 13-3/8 inch 8-5/8 inch 5-1/2 inch
 - C. BOP tests
2. Unless the production casing has been run and cemented or the well has been properly plugged, the drilling rig shall not be removed from over the hole without prior approval.
3. Submit a Sundry Notice (Form 3160-5, one original and five copies) for each casing string, describing the casing and cementing operations. Include pertinent information such as; spud date, hole size, casing (size, weight, grade and thread type), cement (type, quantity and top), water zones and problems or hazards encountered. The Sundry shall be submitted within 15 days of completion of each casing string. The reports may be combined into the same Sundry if they fall within the same 15 day time frame.
4. The API No. assigned to the well by NMOCD shall be included on the subsequent report of setting the first casing string.

II. CASING:

1. The 13-3/8 inch surface casing shall be set at 700 feet, however if salt occurs above the setting depth of 700 feet set surface casing at least 10 feet above the salt, below usable water and cement circulated to the surface. If cement does not circulate to the surface the appropriate BLM office shall be notified and a temperature survey or cement bond log shall be run to verify the top of the cement. Remedial cementing shall be completed prior to drilling out that string.
2. The minimum required fill of cement behind the 8-5/8 inch salt protection casing is circulate cement to the surface.
3. The minimum required fill of cement behind the 5-1/2 inch production casing is cement shall extend upward a minimum of 500 feet above the uppermost hydrocarbon bearing interval.

III. PRESSURE CONTROL:

1. All BOP systems and related equipment shall comply with well control requirements as described in Onshore Oil and Gas Order No. 2. The BOP and related equipment shall be installed and operational before drilling below the 13-3/8 inch casing shoe and shall be tested as described in Onshore Order No. 2. Any equipment failing to test satisfactorily shall be repaired or replaced.
2. Minimum working pressure of the blowout preventer and related equipment (BOPE) is 2000 psi.
3. The appropriate BLM office shall be notified in sufficient time for a representative to witness the tests.
 - The tests shall be done by an independent service company.
 - The results of the test shall be reported to the appropriate BLM office.
 - Testing fluid must be water or an appropriate clear liquid suitable for sub-freezing temperatures. Use of drilling mud for testing is not permitted since it can mask small leaks.
 - Testing must be done in a safe workman-like manner. Hard line connections shall be required.