

# OCD-ARTESIA

Form 3160-5  
(June 1990)

## UNITED STATES DEPARTMENT OF THE INTERIOR BUREAU OF LAND MANAGEMENT

FORM APPROVED  
Budget Bureau No. 1004-0135  
Expires: March 31, 1993

### SUNDRY NOTICES AND REPORTS ON WELLS

Do not use this form for proposals to drill or to deepen or reentry to a different reservoir.  
Use "APPLICATION FOR PERMIT—" for such proposals

*SUBMIT IN TRIPLICATE*

1 Type of Well

☒ Oil Well    ☐ Gas Well    ☐ Other

2 Name of Operator

Chevron USA Inc. (Mack Energy Agent)

3 Address and Telephone No.

P.O. Box 960, Artesia, NM 88211-0960

(505)748-1288

4 Location of Well (Footage, Sec., T. R., M. or Survey Description)

1650 FSL & 2310 FWL, Sec. 14 T17S R31E, K

5 Lease Designation and Serial No.

NMLC-029418A

6 If Indian, Allottee or Tribe Name

7 If Unit or CA, Agreement Designation

8 Well Name and No.

Skelly Unit #961

9 API Well No.

30-015-34324

10 Field and Pool, or Exploratory Area

Fren Paddock

11 County or Parish, State

Eddy, NM

12 CHECK APPROPRIATE BOX(S) TO INDICATE NATURE OF NOTICE, REPORT, OR OTHER DATA

#### TYPE OF SUBMISSION

- ☒ Notice of Intent
- ☐ Subsequent Report
- ☐ Final Abandonment Notice

#### TYPE OF ACTION

- ☐ Abandonment

☐ Recompletion

☐ Plugging Back

☐ Casing Repair

☐ Altering Casing

☒ Other

Location Change

☐ Change of Plans

☐ New Construction

☐ Non-Routine Fracturing

☐ Water Shut-Off

☐ Conversion to Injection

☐ Dispose Water

(Note: Report results of multiple completion on Well Completion or Recompletion Report and Log form.)

13 Describe Proposed or Completed Operations (Clearly state all pertinent details, and give pertinent dates, including estimated date of starting any proposed work. If well is directionally drilled, give subsurface locations and measured and true vertical depths for all markers and zones pertinent to this work.)\*

Mack Energy Corporation proposes to change footage from 990 FSL & 1825 FWL to 1650 FSL & 2310 FWL. The location will also be turned with the pits to the northeast with the existing road. The location was moved because of a 12" gas line. An Archaeological survey has been ordered and should be in your office soon.

14 I hereby certify that the foregoing is true and correct

Signed Gerry W. Shenell

Title Production Clerk

Date 11/2/2005

(This space for Federal or State office use)

Approved by /s/ Joe G. Lara

ACTING FIELD MANAGER

Date DEC 19 2005

Title 18 U.S.C. Section 1001, makes it a crime for any person knowingly and willfully to make to any department or agency of the United States any false, fictitious or fraudulent statements or representations as to any matter within its jurisdiction

•See Instruction on Reverse Side

DISTRICT I  
1625 N. FRANKLIN DR., BOBBS, NM 88240

DISTRICT II  
1301 V. GRAND AVENUE, ARTESIA, NM 88210

DISTRICT III  
1000 Rio Brazos Rd., Aztec, NM 87410

DISTRICT IV  
1220 S. ST. FRANCIS DR., SANTA FE, NM 87505

State of New Mexico  
Energy, Minerals and Natural Resources Department

OIL CONSERVATION DIVISION  
1220 SOUTH ST. FRANCIS DR.  
Santa Fe, New Mexico 87505

Form C-102  
Revised JUNE 10, 2003  
Submit to Appropriate District Office  
State Lease - 4 Copies  
Fee Lease - 3 Copies

WELL LOCATION AND ACREAGE DEDICATION PLAT

☐ AMENDED REPORT

API Number	Pool Code 26770	Pool Name Fren Paddock
Property Code 29742	Property Name SKELLY UNIT	Well Number 961
OGRID No. 4323	Operator Name MACK ENERGY CORPORATION	Elevation 3899'

Surface Location

UL or lot No. K	Section 14	Township 17-S	Range 31-E	Lot Idn	Feet from the 1650	North/South line SOUTH	Feet from the 2310	East/West line WEST	County EDDY
--------------------	---------------	------------------	---------------	---------	-----------------------	---------------------------	-----------------------	------------------------	----------------

Bottom Hole Location If Different From Surface

UL or lot No.	Section	Township	Range	Lot Idn	Feet from the	North/South line	Feet from the	East/West line	County
Dedicated Acres 40	Joint or Infill	Consolidation Code	Order No.						

NO ALLOWABLE WILL BE ASSIGNED TO THIS COMPLETION UNTIL ALL INTERESTS HAVE BEEN CONSOLIDATED  
OR A NON-STANDARD UNIT HAS BEEN APPROVED BY THE DIVISION

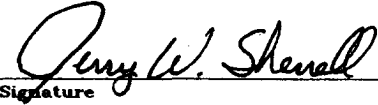
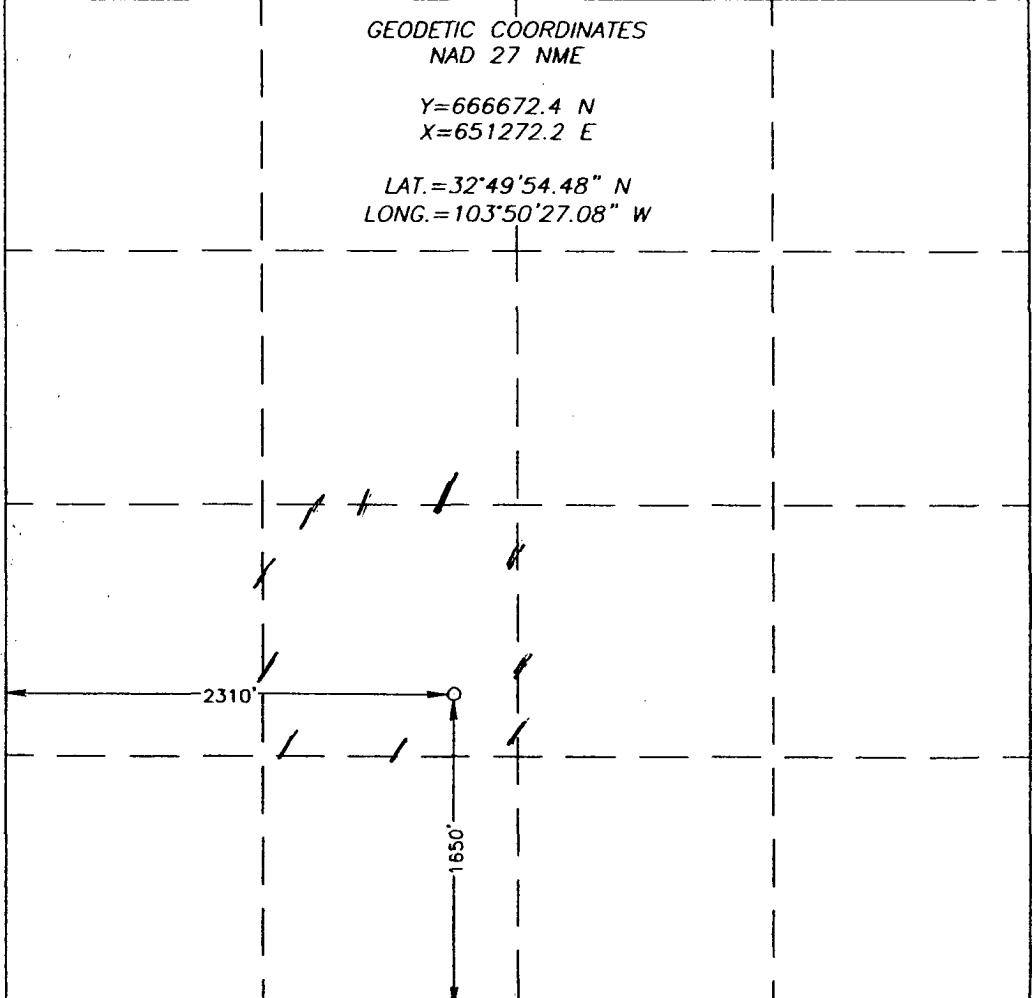
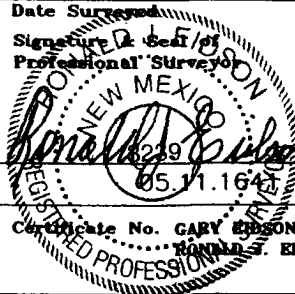
GEODETIC COORDINATES NAD 27 NME  Y=666672.4 N X=651272.2 E  LAT.=32°49'54.48" N LONG.=103°50'27.08" W		<b>OPERATOR CERTIFICATION</b>  I hereby certify the the information contained herein is true and complete to the best of my knowledge and belief.   Signature Jerry W. Sherrell Printed Name Production Clerk Title 11/2/2005 Date	
		<b>SURVEYOR CERTIFICATION</b>  I hereby certify that the well location shown on this plat was plotted from field notes of actual surveys made by me or under my supervision, and that the same is true and correct to the best of my belief.  OCTOBER 21, 2005 Date Surveyed Signature of Seal of Professional Surveyor  10/28/05 Certificate No. GARY EDSON 12641 RONALD F. KIDSON 3239	

**SECTION 14, TOWNSHIP 17 SOUTH, RANGE 31 EAST, N.M.P.M.,**  
 EDDY COUNTY, NEW MEXICO

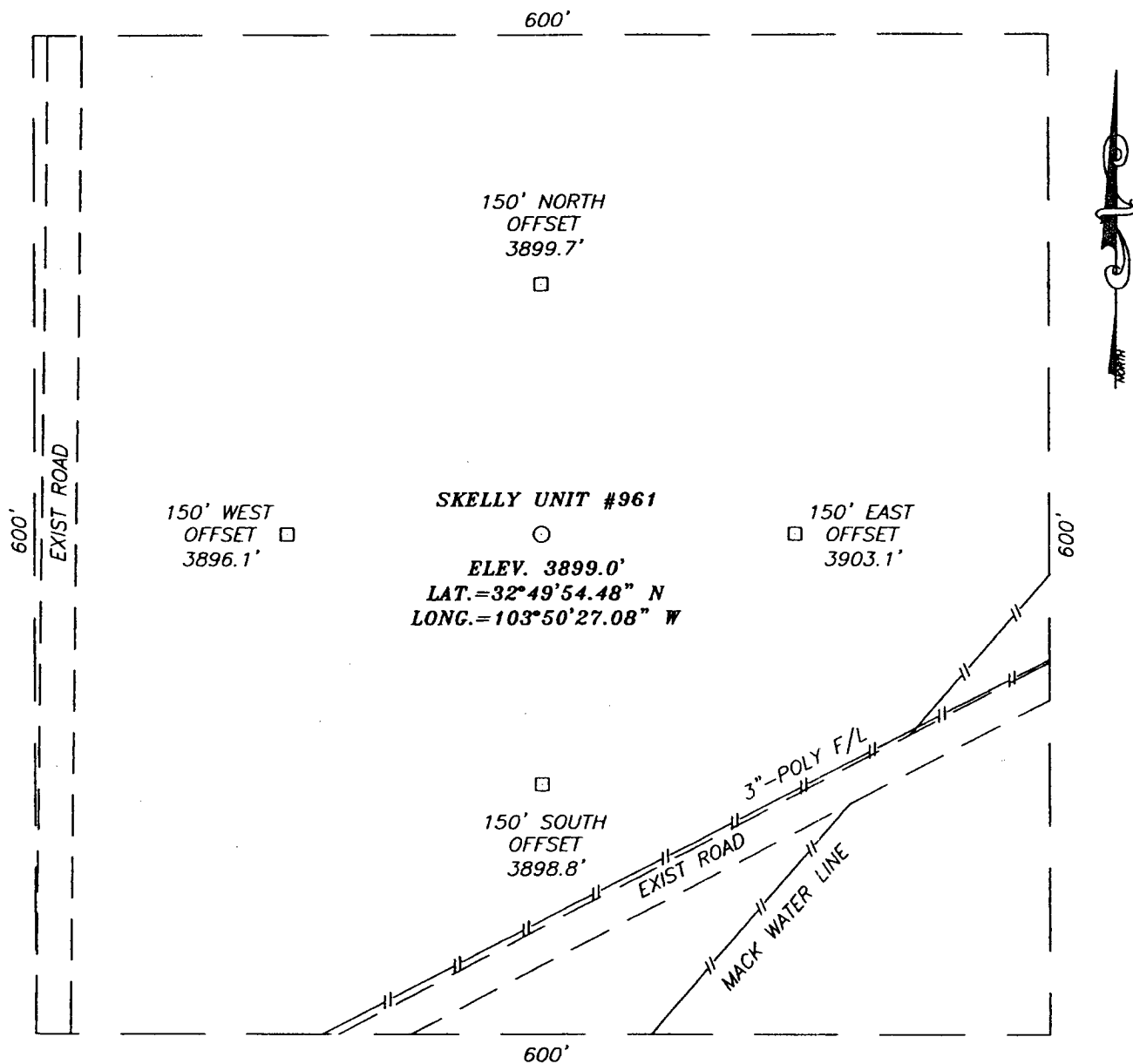

**DIRECTIONS TO LOCATION**

FROM THE INTERSECTION OF U.S. HWY. #82 AND  
 CO. RD. #529 (BERMUDA RD.) GO NW APPROX.  
 2.0 MILES. TURN LEFT (NW) AND GO APPROX.  
 0.25 MILES. TURN RIGHT (NORTH) AND GO  
 APPROX. 0.6 MILES. THIS LOCATION IS APPROX.  
 200' NW OF ROAD.

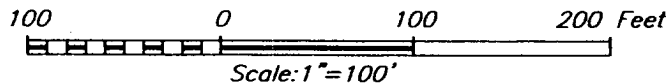

**MACK ENERGY CORPORATION**

SKELLY UNIT #961 WELL  
 LOCATED 1650 FEET FROM THE SOUTH LINE  
 AND 2310 FEET FROM THE WEST LINE OF SECTION 14,  
 TOWNSHIP 17 SOUTH, RANGE 31 EAST, N.M.P.M.,  
 EDDY COUNTY, NEW MEXICO.

Survey Date: 10/21/05	Sheet 1 of 1 Sheets
W.O. Number: 05.11.1641	Dr By: J.R.
Date: 10/27/05	Disk: CD#5
05111641	Scale: 1"=100'

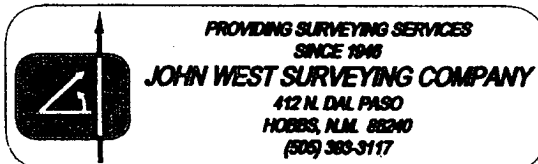

# VICINITY MAP

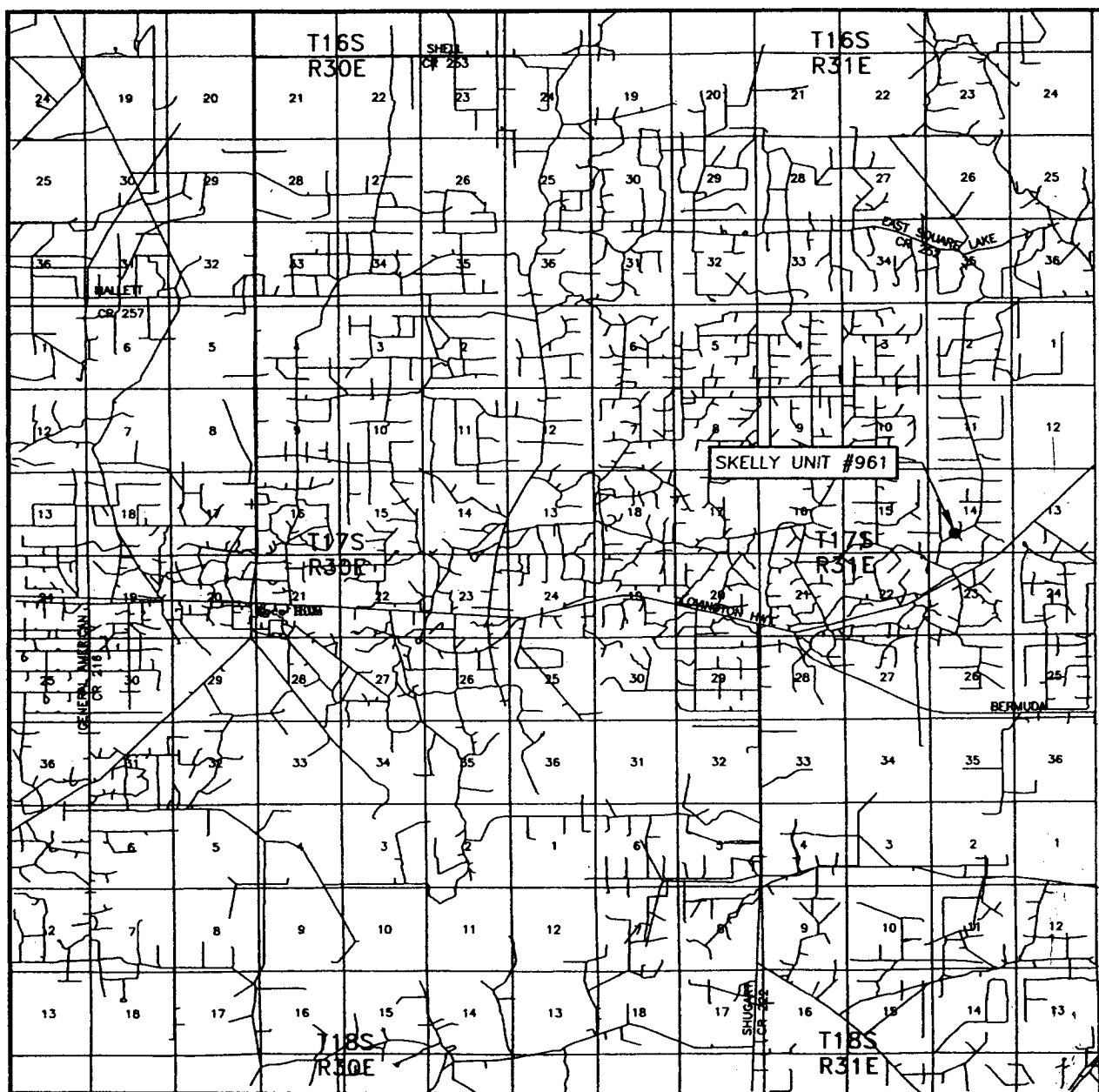

SCALE: 1" = 2 MILES

SEC. 14 TWP. 17-S RGE. 31-E

SURVEY N.M.P.M.

COUNTY EDDY

DESCRIPTION 1650' FSL & 2310' FWL

ELEVATION 3899'

OPERATOR MACK ENERGY CORPORATION

LEASE SKELLY UNIT

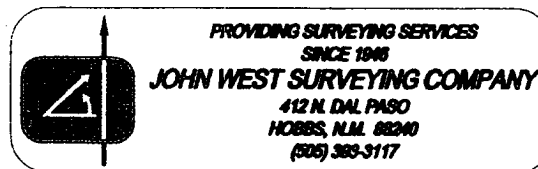

# LOCATION VERIFICATION MAP

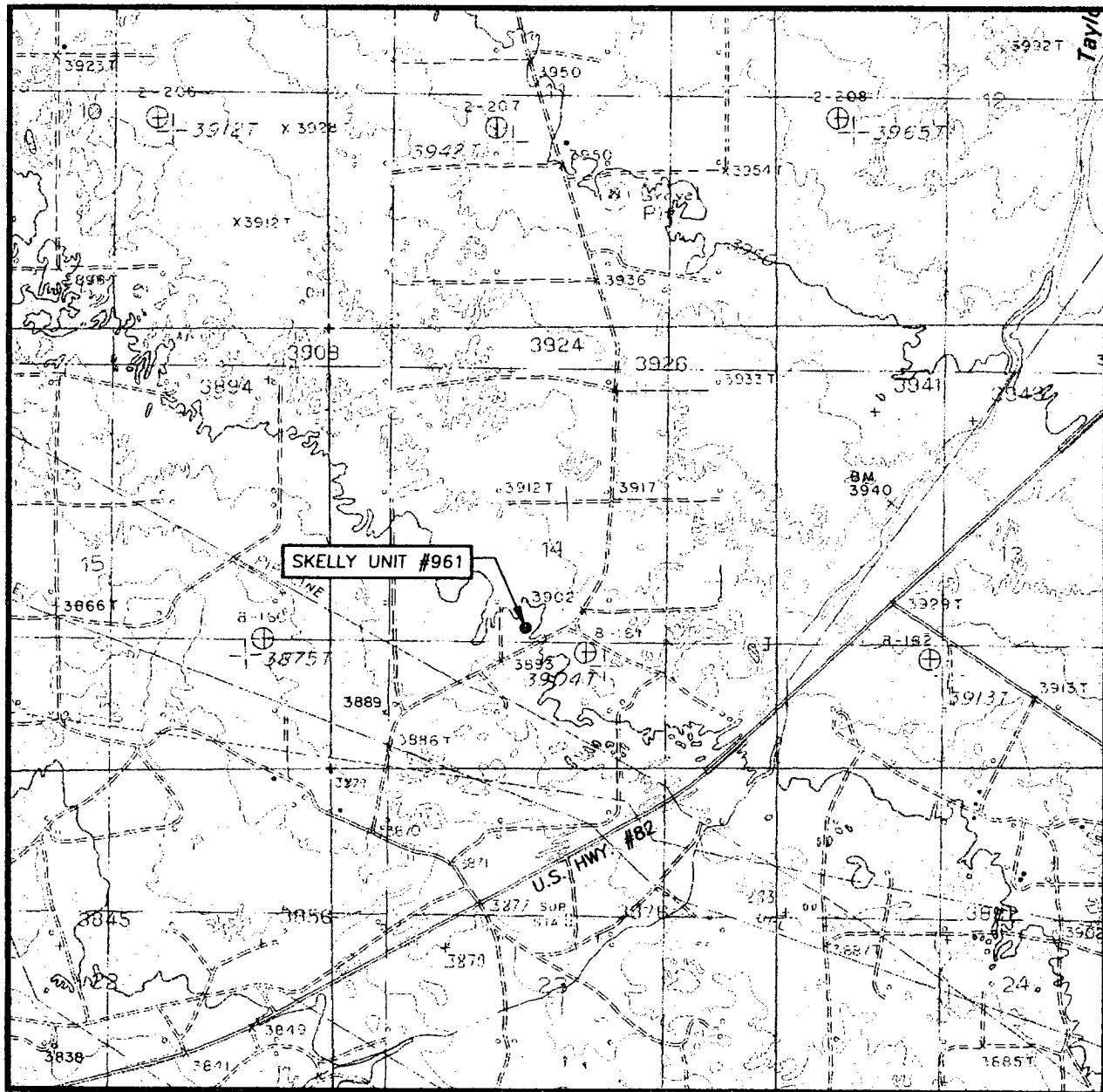

SCALE: 1" = 2000'

CONTOUR INTERVAL:  
MALJAMAR, N.M. - 10'

SEC. 14 TWP. 17-S RGE. 31-E

SURVEY N.M.P.M.

COUNTY EDDY

DESCRIPTION 1650' FSL & 2310' FWL

ELEVATION 3899'

OPERATOR MACK ENERGY CORPORATION

LEASE SKELLY UNIT

U.S.G.S. TOPOGRAPHIC MAP  
MALJAMAR, N.M.

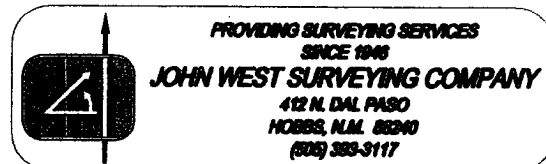

# LOCATION VERIFICATION MAP

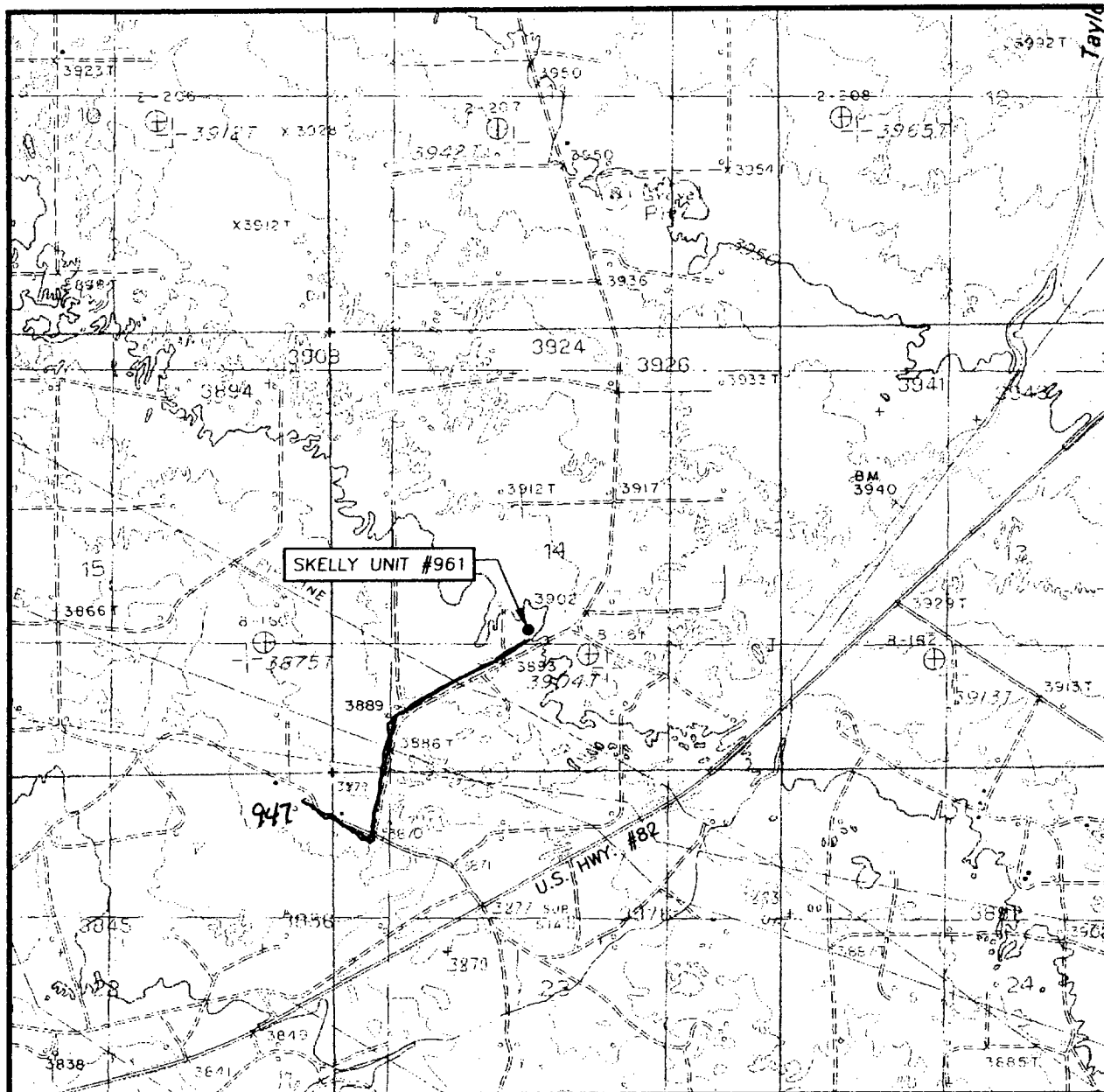

SCALE: 1" = 2000'

CONTOUR INTERVAL:  
MALJAMAR, N.M. - 10'

SEC. 14 TWP. 17-S RGE. 31-E

SURVEY N.M.P.M.

COUNTY EDDY

DESCRIPTION 1650' FSL & 2310' FWL

ELEVATION 3899'

OPERATOR MACK ENERGY CORPORATION

LEASE SKELLY UNIT

U.S.G.S. TOPOGRAPHIC MAP  
MALJAMAR, N.M.

Follow road to the Skelly #947  
then to the TB



PROVIDING SURVEYING SERVICES  
SINCE 1946  
**JOHN WEST SURVEYING COMPANY**  
412 N. DAL PASO  
HOBBES, N.M. 88240  
(505) 383-3117