

State of New Mexico
Energy Minerals and Natural Resources

Form C-144
June 1, 2004

Oil Conservation Division
1220 South St. Francis Dr.
Santa Fe, NM 87505

For drilling and production facilities, submit to
appropriate NMOCD District Office.
For downstream facilities, submit to Santa Fe
office

Pit or Below-Grade Tank Registration or Closure

Is pit or below-grade tank covered by a "general plan"? Yes ☐ No ☒

Type of action: Registration of a pit or below-grade tank ☒ Closure of a pit or below-grade tank ☒

Operator: <u>Mewbourne Oil Company</u> Telephone: <u>505-393-5905</u> e-mail address: <u>hobeng@mewbourne.com</u>		
Address: <u>P.O. Box 5270, Hobbs, New Mexico 88241</u>		
Facility or well name: <u>Angel Draw "2" State Com #3</u>	API #: <u>30-015-34098</u>	U/L or Qtr/Qtr <u>E</u> Sec <u>2</u> T <u>20S</u> R <u>27E</u>
County: <u>Eddy</u>	Latitude <u>32-36-18.0 N</u>	Longitude <u>104-15-23.1 W</u> NAD: 1927 <input type="checkbox"/> 1983 <input checked="" type="checkbox"/>
Surface Owner: Federal <input checked="" type="checkbox"/> State <input type="checkbox"/> Private <input type="checkbox"/> Indian <input type="checkbox"/>		
Pit Type: Drilling <input type="checkbox"/> Production <input type="checkbox"/> Disposal <input checked="" type="checkbox"/> Workover <input type="checkbox"/> Emergency <input type="checkbox"/> Lined <input checked="" type="checkbox"/> Unlined <input type="checkbox"/> Liner type: Synthetic <input checked="" type="checkbox"/> Thickness <u>12</u> mil Clay <input type="checkbox"/> Pit Volume <u>4800</u> bbl	Below-grade tank Volume: _____ bbl Type of fluid: _____ Construction material: _____ Double-walled, with leak detection? Yes <input type="checkbox"/> If not, explain why not. _____	
Depth to ground water (vertical distance from bottom of pit to seasonal high water elevation of ground water.)	Less than 50 feet 50 feet or more, but less than 100 feet <input checked="" type="checkbox"/> 100 feet or more	(20 points) (10 points) <input checked="" type="checkbox"/> (0 points)
Wellhead protection area: (Less than 200 feet from a private domestic water source, or less than 1000 feet from all other water sources.)	Yes No <input checked="" type="checkbox"/>	(20 points) (0 points) <input checked="" type="checkbox"/>
Distance to surface water: (horizontal distance to all wetlands, playas, irrigation canals, ditches, and perennial and ephemeral watercourses.)	Less than 200 feet 200 feet or more, but less than 1000 feet 1000 feet or more <input checked="" type="checkbox"/>	(20 points) (10 points) (0 points) <input checked="" type="checkbox"/>
Ranking Score (Total Points)		10 points

If this is a pit closure: (1) Attach a diagram of the facility showing the pit's relationship to other equipment and tanks. (2) Indicate disposal location: (check the onsite box if you are burying in place) onsite ☒ offsite ☐ If offsite, name of facility _____. (3) Attach a general description of remedial action taken including remediation start date and end date. (4) Groundwater encountered: No ☒ Yes ☐ If yes, show depth below ground surface _____ ft. and attach sample results. (5) Attach soil sample results and a diagram of sample locations and excavations.

Additional Comments: Mewbourne Oil Company proposes to dig a "deep bury" pit to dispose of the reserve pit from this location. The pit will be lined with a 12 mil liner and capped with 20 mil plastic. Enclosed is a diagram of the location with an approximate location of the "deep bury" pit. Both pits will be closed during the operation. We will start the "clean up" as soon as the equipment is available following NMOCD approval.

I hereby certify that the information above is true and complete to the best of my knowledge and belief. I further certify that the above-described pit or below-grade tank has been/will be constructed or closed according to NMOCD guidelines <input checked="" type="checkbox"/> , a general permit <input type="checkbox"/> , or an (attached) alternative OCD-approved plan <input type="checkbox"/> .		
Date: <u>02/06/2006</u>	Signature <u>F. Lathan</u>	
Printed Name/Title <u>F. Lathan / Drilling Foreman</u>	Signature <u>Gerry Guye</u>	
Your certification and NMOCD approval of this application/closure does not relieve the operator of liability should the contents of the pit or tank contaminate ground water or otherwise endanger public health or the environment. Nor does it relieve the operator of its responsibility for compliance with any other federal, state, or local laws and/or regulations.		
Approval: <u>Gerry Guye</u> Printed Name/Title <u>Compliance Officer</u>	Signature <u>Gerry Guye</u>	Date: <u>2-9-06</u>

ANGEL DRAW "Z" STATE Com #3
API # 30-015-34098

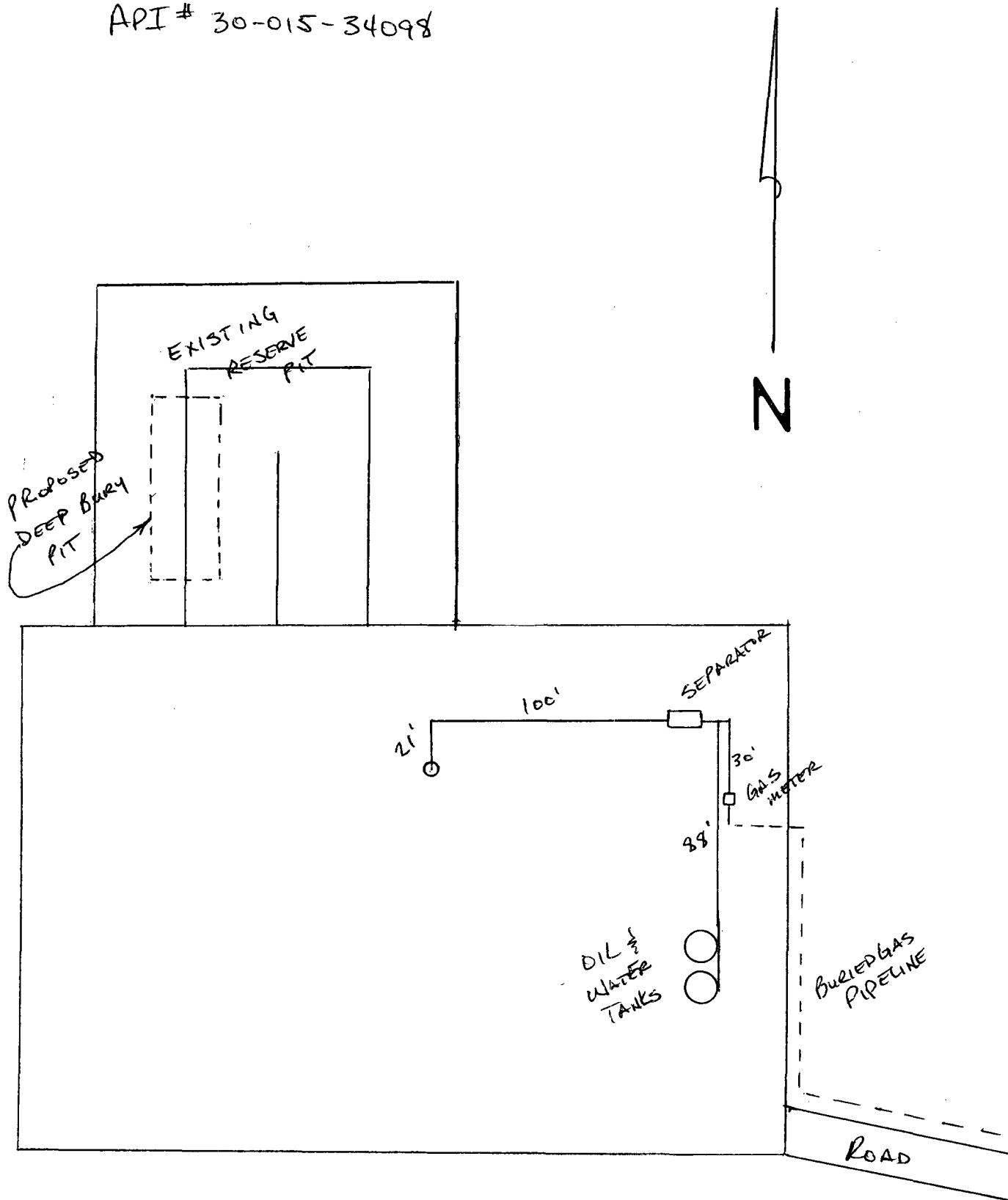

SCALE: 1" = 60'