

DISTRICT I
1625 N. French Dr., Hobbs, NM 88240
Phone: (575) 393-6161 Fax: (575) 393-6720

DISTRICT II
811 S. First St., Artesia, NM 88210
Phone: (575) 748-1283 Fax: (575) 748-9720

DISTRICT III
1000 Rio Brazos Rd., Aztec, NM 87410
Phone: (505) 334-6178 Fax: (505) 334-6170

DISTRICT IV
1220 S. St. Francis Dr., Santa Fe, NM 87505
Phone: (505) 476-3460 Fax: (505) 476-3462

State of New Mexico
Energy, Minerals & Natural Resources Department
OIL CONSERVATION DIVISION
1220 South St. Francis Dr.
Santa Fe, New Mexico 87505

NM OIL CONSERVATION

ARTESIA DISTRICT

Form C-102

Revised August 1, 2011

Submit one copy to appropriate District Office

NOV 19 2015

RECEIVED

AMENDED REPORT

WELL LOCATION AND ACREAGE DEDICATION PLAT

API Number 30-015-43038	Pool Code 52800	Pool Name ROSS DRAW, DELAWARE, WEST
Property Code 40341	Property Name RDX FEDERAL 28	Well Number 24
OGRID No 246289	Operator Name RKI EXPLORATION & PRODUCTION	Elevation 2997'

Surface Location

UL or lot no. H	Section 28	Township 26 S	Range 30 E	Lot Idn	Feet from the 1650	North/South line NORTH	Feet from the 990	East/West line EAST	County EDDY
---------------------------	----------------------	-------------------------	----------------------	---------	------------------------------	----------------------------------	-----------------------------	-------------------------------	-----------------------

Bottom Hole Location If Different From Surface

UL or lot no.	Section	Township	Range	Lot Idn	Feet from the	North/South line	Feet from the	East/West line	County
---------------	---------	----------	-------	---------	---------------	------------------	---------------	----------------	--------

Dedicated Acres 40	Joint or Infill	Consolidated Code	Order No.
------------------------------	-----------------	-------------------	-----------

No allowable will be assigned to this completion until all interests have been consolidated or a non-standard unit has been approved by the division.

NW COR SEC 28 NMSP-E (NAD 83) N (Y) = 371527.1 E (X) = 677240.1			NE COR SEC 28 NMSP-E (NAD 83) N (Y) = 371559.3 E (X) = 682558.1
		RDX 28 FEDERAL 24 SHL NMSP-E (NAD 83) N (Y) = 369903.3' E (X) = 681577.4' LAT. = 32°00'58.09"N LONG. = 103°52'51.07"W	
		NMSP-E (NAD 27) N (Y) = 369846.0' E (X) = 640391.1' LAT. = 32.0160118°N LONG. = 103.8803745°W	
SW COR SEC 28 NMSP-E (NAD 83) N (Y) = 366212.5 E (X) = 677272.5			SE COR SEC 28 NMSP-E (NAD 83) N (Y) = 366240.9 E (X) = 682588.0

OPERATOR CERTIFICATION

I hereby certify that the information contained herein is true and complete to the best of my knowledge and belief, and that this organization either owns a working interest or unleased mineral interest in the land including the proposed bottom hole location or has a right to drill this well at this location pursuant to a contract with an owner of such a mineral or working interest, or to voluntary pooling agreement or a compulsory pooling order heretofore entered by the division.

Heather Brehm 11/02/2015
Signature Date

Heather Brehm
Print Name

heather.brehm@wpw.com
E-mail Address

SURVEYORS CERTIFICATION

I hereby certify that the well location shown on this plat was plotted from field notes of actual surveys made by me or under my supervision, and that the same is true and correct to the best of my belief.

August 22, 2013

Date of Survey

Signature and Seal of Professional Surveyor

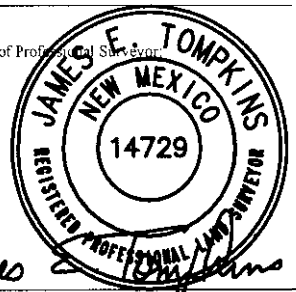

Job No. WTC48881

JAMES E. TOMPKINS 14729

Certificate Number