

30-015-43463

SURFACE LOCATION
NEW MEXICO EAST
NAD 1927
X=587603
Y=445357
LAT.: N 32.2240859
LONG.: W 104.0500469

FIRST PERFORATION POINT
NEW MEXICO EAST
NAD 1927
X=588264
Y=445320
LAT.: N 32.2239793
LONG.: W 104.0479106

LAST PERFORATION POINT
NEW MEXICO EAST
NAD 1927
X=592924
Y=445336
LAT.: N 32.2239895
LONG.: W 104.0328407

BOTTOM HOLE LOCATION
NEW MEXICO EAST
NAD 1927
X=593014
Y=445337
LAT.: N 32.2239897
LONG.: W 104.0325497

FND BRASS CAP.
U.S. G.L.O. SUR

13 18

S 00°54'57" E 2637.37'

S 00°58'13" E 2840.88'

S 00°18'21" E 2880.05'

14 13
23 24

FND BRASS CAP.
U.S. G.L.O. SUR

N 89°40'58" W 2633.53'

N 89°39'32" W 2630.60'

13 18
24 19

FND BRASS CAP.
U.S. G.L.O. SUR



SCALE: 1" = 1000'
0' 500' 1000'

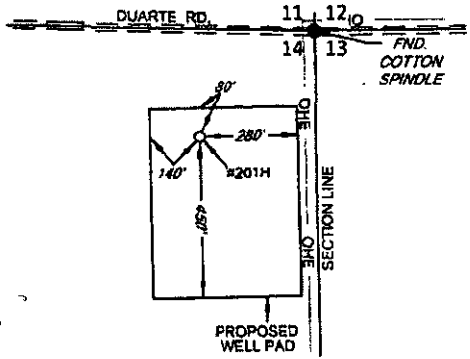

LEASE NAME & WELL NO.: JANIE CONNER 13-24S-28E RB #201H

SECTION 14 TWP 24-S RGE 28-E SURVEY N.M.P.M.

COUNTY EDDY STATE NM

DESCRIPTION .299' FNL & 330' FEL

DISTANCE & DIRECTION

FROM INT. OF DUARTE RD. & US-285 GO EAST ON DUARTE RD.
±1.3 MILES TO A POINT ±300 FEET NORTH OF THIS LOCATION.



Michael Blake Brown, P.S. No. 18329
OCTOBER 12, 2015

ALL BEARINGS, DISTANCES, AND COORDINATE VALUES CONTAINED HEREON ARE GRID
BASED UPON THE NEW MEXICO STATE PLANE COORDINATE SYSTEM, EAST ZONE OF THE
NORTH AMERICAN DATUM 1927, U.S. SURVEY FEET

THIS EASEMENT/SERVITUDE LOCATION SHOWN HEREON HAS BEEN SURVEYED ON THE GROUND
UNDER MY SUPERVISION AND PREPARED ACCORDING TO THE EVIDENCE FOUND AT THE TIME OF
SURVEY, AND DATA PROVIDED BY MATADOR PRODUCTION COMPANY. THIS CERTIFICATION IS MADE
AND LIMITED TO THOSE PERSONS OR ENTITIES SHOWN ON THE FACE OF THIS PLAT AND IS
NON-TRANSFERABLE. THIS SURVEY IS CERTIFIED FOR THIS TRANSACTION ONLY.

TOPOGRAPHIC
LOYALTY INNOVATION LEGACY
1400 EVERMAN PARKWAY, Ste. 187 - FT. WORTH, TEXAS 76140
TELEPHONE: (817) 744-7512 - FAX (817) 744-7548
2803 NORTH BIG SPRING - MIDLAND, TEXAS 79708
TELEPHONE: (432) 682-1853 OR (800) 787-1853 - FAX (432) 682-1743
WWW.TOPOGRAPHIC.COM

30-015-43463



RIG: 297

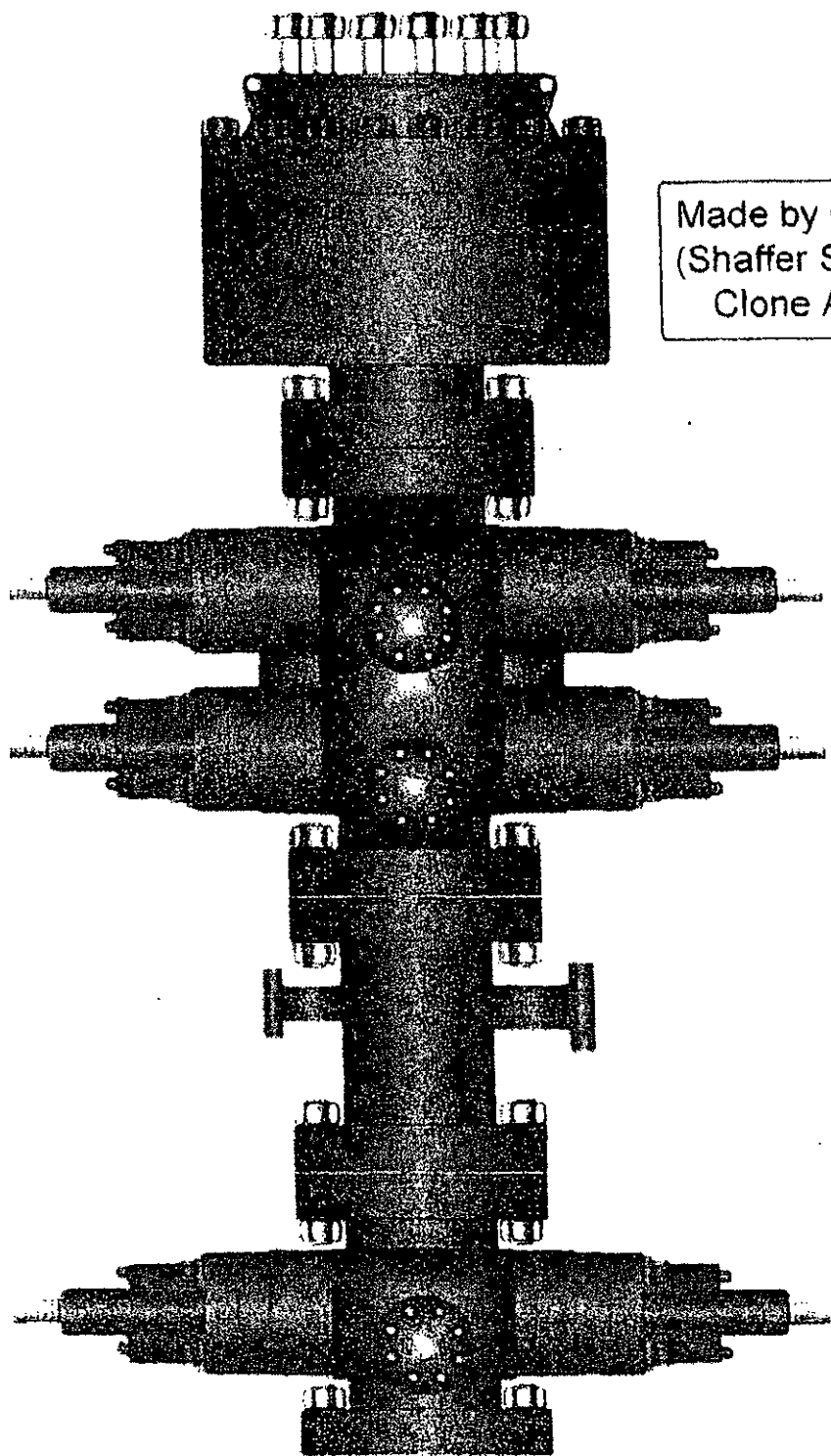

Made by Cameron
(Shaffer Spherical)
Clone Annular

PATTERSON-UTI # PS2-621

STYLE: New Shaffer Spheric

BORE 13 5/8" PRESSURE 5,0

HEIGHT: 48 1/2" WEIGHT: 13,800

PATTERSON-UTI # PC2-12

STYLE: New Cameron Type

BORE 13 5/8" PRESSURE 10,

RAMS: TOP 5" Pipe BTM Blir

HEIGHT: 66 5/8" WEIGHT: 24,00

Length 40" Outlets 4" 11

DSA 4" 10M x 2" 10M

PATTERSON-UTI # PC2-21

STYLE: New Cameron Typ

BORE 13 5/8" PRESSURE 10

RAMS: 5" Pipe

HEIGHT: 41 5/8" WEIGHT: 13,00

WING VALVES