

UNITED STATES  
DEPARTMENT OF THE INTERIOR  
BUREAU OF LAND MANAGEMENT

OCD Artesia

FORM APPROVED  
OMB No. 1004-0137  
Expires: October 31, 2014**SUNDRY NOTICES AND REPORTS ON WELLS**  
**Do not use this form for proposals to drill or to re-enter an abandoned well. Use Form 3160-3 (APD) for such proposals.**5. Lease Serial No.  
NMLC-069464-A; NMNM-54113

6. If Indian, Allottee or Tribe Name

**SUBMIT IN TRIPLICATE** - Other instructions on page 2.

## 1. Type of Well

☒ Oil Well ☐ Gas Well ☐ Other

## 2. Name of Operator

Devon Energy Production Co LP (6137)

## 3a. Address

PO BOX 250, ARTESIA, NM 88211

## 3b. Phone No. (include area code)

575-748-3371

## 4. Location of Well (Footage, Sec., T., R., M., or Survey Description)

Unit P, 290' FSL &amp; 195' FEL, Sec 7, T19S, R31E

7. If Unit of CA/Agreement, Name and/or No.

## 8. Well Name and No.

Strawberry 7 Fed Com 10H

## 9. API Well No.

30-015-41575

## 10. Field and Pool or Exploratory Area

Bone Spring; Hackberry N.

## 11. County or Parish, State

Eddy County, NM

## 12. CHECK THE APPROPRIATE BOX(ES) TO INDICATE NATURE OF NOTICE, REPORT OR OTHER DATA

TYPE OF SUBMISSION	TYPE OF ACTION			
<input type="checkbox"/> Notice of Intent	<input type="checkbox"/> Acidize	<input type="checkbox"/> Deepen	<input type="checkbox"/> Production (Start/Resume)	<input type="checkbox"/> Water Shut-Off
<input checked="" type="checkbox"/> Subsequent Report	<input type="checkbox"/> Alter Casing	<input type="checkbox"/> Fracture Treat	<input checked="" type="checkbox"/> Reclamation	<input type="checkbox"/> Well Integrity
<input type="checkbox"/> Final Abandonment Notice	<input type="checkbox"/> Casing Repair	<input type="checkbox"/> New Construction	<input type="checkbox"/> Recomplete	<input checked="" type="checkbox"/> Other
	<input type="checkbox"/> Change Plans	<input type="checkbox"/> Plug and Abandon	<input type="checkbox"/> Temporarily Abandon	Downsizing
	<input type="checkbox"/> Convert to Injection	<input type="checkbox"/> Plug Back	<input type="checkbox"/> Water Disposal	

13. Describe Proposed or Completed Operation: Clearly state all pertinent details, including estimated starting date of any proposed work and approximate duration thereof. If the proposal is to deepen directionally or recompleat horizontally, give subsurface locations and measured and true vertical depths of all pertinent markers and zones. Attach the Bond under which the work will be performed or provide the Bond No. on file with BLM/BIA. Required subsequent reports must be filed within 30 days following completion of the involved operations. If the operation results in a multiple completion or recompleat in a new interval, a Form 3160-4 must be filed once testing has been completed. Final Abandonment Notices must be filed only after all requirements, including reclamation, have been completed and the operator has determined that the site is ready for final inspection.)

This location has been downsized from an original pad location size of 300' x 360'. Acres retained = 0.6267.

NM OIL CONSERVATION

ARTESIA DISTRICT

DEC 18 2015

RECEIVED

Accepted for Record Purposes.  
Approval Subject to Onsite Inspection.  
If BLM Objectives are not achieved,  
additional work may be required.

Date: 12-12-15

Signature: James C. [Signature]

## 14. I hereby certify that the foregoing is true and correct. Name (Printed/Typed)

Denise Menoud (575-746-5544)

Title Admin Field Support

Signature

[Signature]

Date 02/12/2015

## THIS SPACE FOR FEDERAL OR STATE OFFICE USE

Approved by

Title

Date

Conditions of approval, if any, are attached. Approval of this notice does not warrant or certify that the applicant holds legal or equitable title to those rights in the subject lease which would entitle the applicant to conduct operations thereon.

Office

Title 18 U.S.C. Section 1001 and Title 43 U.S.C. Section 1212, make it a crime for any person knowingly and willfully to make to any department or agency of the United States any false, fictitious or fraudulent statements or representations as to any matter within its jurisdiction.

(Instructions on page 2)

d#da\X<sup>-</sup>aY<sup>-</sup>, E<sup>-</sup> +<sup>-</sup>) #D<sup>-</sup>) zÖ<sup>-</sup>, Ee<sup>-</sup>, #DE<sup>-</sup> + #

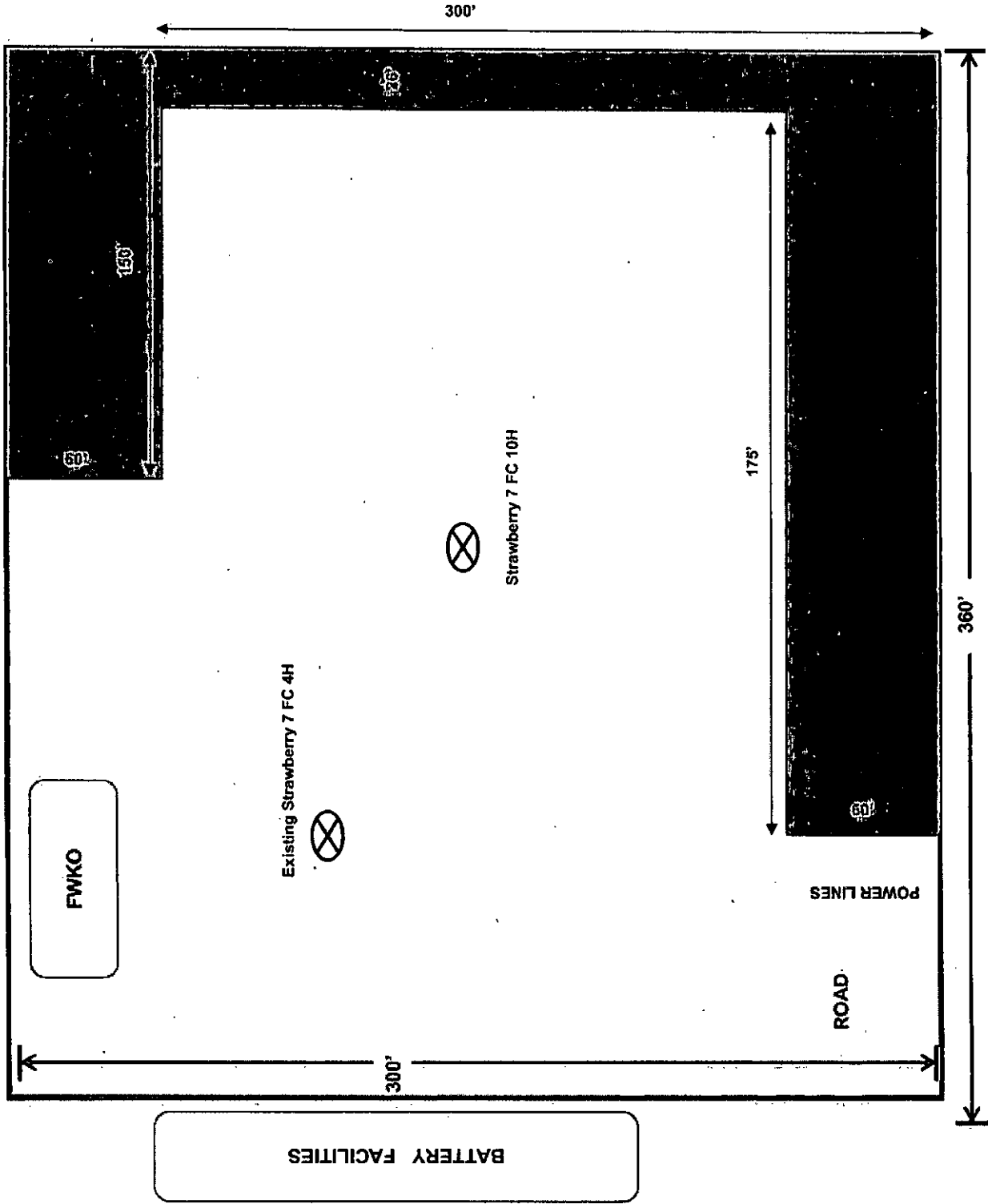

**Interim  
Site  
Reclamation**

Devon Energy  
Production Co.

Strawberry 7 Fed Com  
10H  
API #30-15-41575  
Sec. 7-T19S-R31E  
Eddy County, NM



Reclamation  
Area =  
0.6267 Acres

[illegible]

This map is for **Starch** program only and is neither a legally recorded map nor survey and is not intended to be used as one. Devoe makes no warranty, representation, or guarantee of any kind regarding this map.

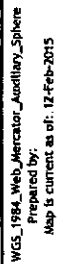

WGS\_1984\_Web\_Mercator\_Auxiliary\_Sphere  
Prepared by:  
Map is current as of: 12-Feb-2015

	Miles.	
1	0.01	1.1 7023

**TDM Wells**  
**Demon TDM Wells**

