

UNITED STATES
DEPARTMENT OF THE INTERIOR
BUREAU OF LAND MANAGEMENTFORM APPROVED
OMB NO. 1004-0135
Expires: July 31, 2010**SUNDRY NOTICES AND REPORTS ON WELLS**
*Do not use this form for proposals to drill or to re-enter an abandoned well. Use form 3160-3 (APD) for such proposals.***NM OIL CONSERVATION DISTRICT**
RECEIVED
DEC 18 2015**SUBMIT IN TRIPLICATE - Other instructions on reverse side**

1. Type of Well <input checked="" type="checkbox"/> Oil Well <input type="checkbox"/> Gas Well <input type="checkbox"/> Other		5. Lease Serial No. NMLC029426B
2. Name of Operator APACHE CORPORATION		6. If Indian, Allottee or Tribe Name
Contact: JENNIFER E VAN CUREN E-Mail: Jennifer.vancuren@arcadis.com		7. If Unit or CA/Agreement, Name and/or No. NMMN134086
3a. Address 303 VETERANS AIRPARK LANE SUITE 3000 MIDLAND, TX 79705	3b. Phone No. (include area code) Ph: 432-687-5400 Ext: 117 Fx: 432-687-5401	8. Well Name and No. CROW FEDERAL 22H
4. Location of Well (Footage, Sec., T., R., M., or Survey Description) Sec 9 T17S R31E SWNW 1680FNL 10FWL 32.851674 N Lat, 103.883393 W Lon		9. API Well No. 30-015-41166-00-S1
		10. Field and Pool, or Exploratory FREN
		11. County or Parish, and State EDDY COUNTY, NM

12. CHECK APPROPRIATE BOX(ES) TO INDICATE NATURE OF NOTICE, REPORT, OR OTHER DATA

TYPE OF SUBMISSION	TYPE OF ACTION			
<input checked="" type="checkbox"/> Notice of Intent	<input type="checkbox"/> Acidize	<input type="checkbox"/> Deepen	<input type="checkbox"/> Production (Start/Resume)	<input type="checkbox"/> Water Shut-Off
<input type="checkbox"/> Subsequent Report	<input type="checkbox"/> Alter Casing	<input type="checkbox"/> Fracture Treat	<input checked="" type="checkbox"/> Reclamation	<input type="checkbox"/> Well Integrity
<input type="checkbox"/> Final Abandonment Notice	<input type="checkbox"/> Casing Repair	<input type="checkbox"/> New Construction	<input type="checkbox"/> Recomplete	<input type="checkbox"/> Other
	<input type="checkbox"/> Change Plans	<input type="checkbox"/> Plug and Abandon	<input type="checkbox"/> Temporarily Abandon	
	<input type="checkbox"/> Convert to Injection	<input type="checkbox"/> Plug Back	<input type="checkbox"/> Water Disposal	

13. Describe Proposed or Completed Operation (clearly state all pertinent details, including estimated starting date of any proposed work and approximate duration thereof. If the proposal is to deepen directionally or recomple horizontally, give subsurface locations and measured and true vertical depths of all pertinent markers and zones. Attach the Bond under which the work will be performed or provide the Bond No. on file with BLM/BIA. Required subsequent reports shall be filed within 30 days following completion of the involved operations. If the operation results in a multiple completion or recompletion in a new interval, a Form 3160-4 shall be filed once testing has been completed. Final Abandonment Notices shall be filed only after all requirements, including reclamation, have been completed, and the operator has determined that the site is ready for final inspection.)

APACHE REQUESTS TO MODIFY / CHANGE THE ORIGINAL PLANS FOR THE INTERIM RECLAMATION (IR) FOR THE FOLLOWING WELLS.

LEASE # NMLC029426B
CROW FEDERAL 22H, E-9-17S-31E, 1680'FNL & 10'FWL, 3001541166
CROW FEDERAL 23H, E-9-17S-31E, 1650'FNL & 10'FWL, 3001541167
CROW FEDERAL 24H, E-9-17S-31E, 1620'FNL & 10'FWL, 3001541168
LEASE # NMLC029435B
NFE FEDERAL 58H, E-8-17S-31E, 1672'FNL & 85'FEL, 3101543088

12/21/15
Approved for record
RWA/DCD

ORIGINAL PLANS DID NOT ACCOUNT FOR THE SATELLITE FACILITY LOCATED ON THE NORTH TO THE EAST OF THE ACCESS ROAD OR ELECTRICITY WITH PANELS FOR EACH WELL. NFE FEDERAL 58 WAS ADDED TO PAD WITH NO IR PLANNED. PLEASE SEE TABLE BELOW FOR ORIGINALLY PLANNED BEFORE AND AFTER ADDITIONAL NFE FEDERAL 58

14. I hereby certify that the foregoing is true and correct.	
Electronic Submission #323616 verified by the BLM Well Information System For APACHE CORPORATION, sent to the Carlsbad Committed to AFMSS for processing by JENNIFER SANCHEZ on 11/16/2015 (16JAS1163SE)	
Name (Printed/Typed) JENNIFER E VAN CUREN	Title AUTHORIZED REPRESENTATIVE
Signature (Electronic Submission)	Date 11/15/2015

THIS SPACE FOR FEDERAL OR STATE OFFICE USE

Approved By <i>Jennifer E. Van Curen</i>	Title <i>SPET</i>	Date <i>12-12-15</i>
Conditions of approval, if any, are attached. Approval of this notice does not warrant or certify that the applicant holds legal or equitable title to those rights in the subject lease which would entitle the applicant to conduct operations thereon.		Office <i>CFD</i>

Title 18 U.S.C. Section 1001 and Title 43 U.S.C. Section 1212, make it a crime for any person knowingly and willfully to make to any department or agency of the United States any false, fictitious or fraudulent statements or representations as to any matter within its jurisdiction.

**** BLM REVISED ** BLM REVISED ** BLM REVISED ** BLM REVISED ** BLM REVISED ****

Additional data for EC transaction #323616 that would not fit on the form

• **32. Additional remarks, continued**

AND REVISED IR.

TYPE	PAD AS BUILT	ACREAGE	WELL PAD REMAINING	ACREAGE
ORIGINAL	291 X 355 FEET	2.37	244 X 285 FEET	1.59
ORIGINAL	291 X 355 FEET	2.37	291 X 355 FEET	2.49
REVISED	291 X 355 FEET	2.37	214 X 310 FEET	1.52

THE EXTRA RECLAMATION WILL BE TRACKED BY ARCADIS WHICH IS 0.97 ACRES FOR THIS SITE.

IR WORK TO BE COMPLETED ? REMOVE ANY FRAC SAND AND UNUSED GRAVEL. PROPANE TANKS, IF STILL PRESENT, WILL BE REALIGNED TO MAXIMIZE THE IR ON THE EAST SIDE. CALICHE FREE OF ANY CONTAMINATION WILL BE REMOVED AND STOCKPILED FOR USE ON ROADS OR CONSTRUCTION OF WELL PADS. AREAS TO BE RECLAIMED WILL BE RECONTOURED TO MATCH SURROUNDING AREAS, THE TOPSOIL WILL BE DISTRIBUTED ACROSS ALL RECLAIMED AREAS, RIPPED ACROSS ANY SLOPED AREAS (<1% ANTICIPATED), AND SEEDED WITH BLM LPC SEED MIXTURE. WELL PAD WILL BE BERMED TO PREVENT CONTAMINANTS FROM LEAVING LOCATION IF AN UNDESIREABLE EVENT WAS TO OCCUR.

ALL LPC GUIDELINES WILL BE FOLLOWED IF IR STARTS AFTER MARCH 1 OR BEFORE JUNE 15.

ALL WELLS HAVE BEEN DRILLED AND NFE FEDERAL 58H IS BEING COMPLETED. AS SOON AS WELL IS COMPLETED AND APPROVAL OF SUNDRY IS RECEIVED, IR WILL BEGIN.

PLEASE SEE ATTACHED DIAGRAM OF REVISED PLAN.

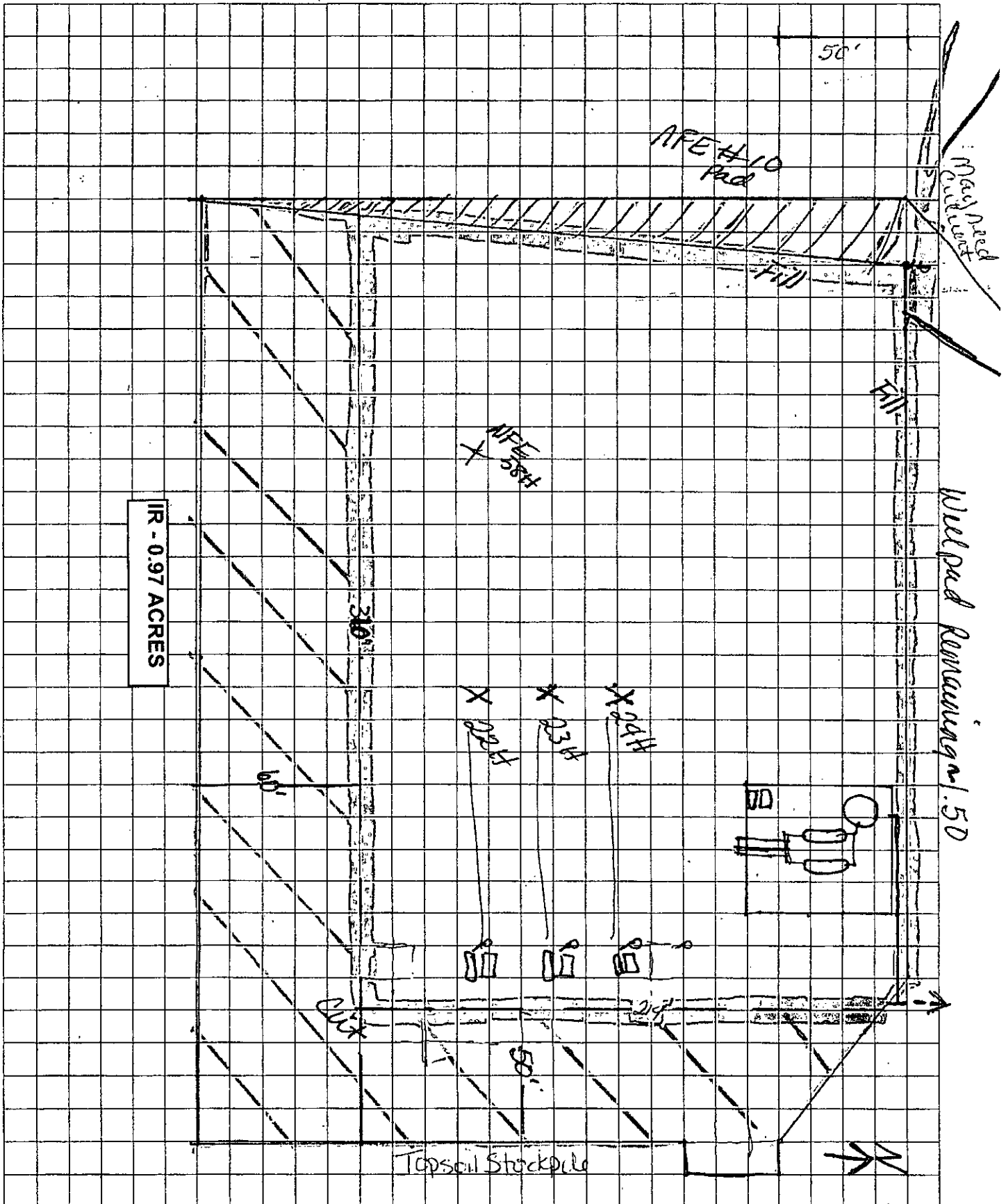

Imagine the result