

## State of New Mexico

Form C-102

Revised August 1, 2011

## Energy, Minerals &amp; Natural Resources Department

Submit one copy to appropriate

## OIL CONSERVATION DIVISION

District Office

1220 South St. Francis Dr.

Santa Fe, New Mexico 87505

AMENDED REPORT

DISTRICT I  
Hobbs, NM 88240  
Phone: (505) 393-6161 Fax: (505) 393-0720

DISTRICT II  
Alamogordo, NM 88001  
Phone: (505) 748-1283 Fax: (505) 748-9720

DISTRICT III  
1000 Rio Brazos Rd., Artesia, NM 87410  
Phone: (505) 334-6178 Fax: (505) 334-6170

DISTRICT IV  
1220 S. St. Francis Dr., Santa Fe, NM 87505  
Phone: (505) 476-3460 Fax: (505) 476-3462

## OIL CONSERVATION AND ACREAGE DEDICATION PLAT

API Number 30-015-43415	ARTESIA DISTRICT JUN 06 2016 RECEIVED	Pool Code 72897	Pool Name Brushy Draw UNDESIGNATED WOLF CAMP wolf camp
Property Code 40484	Property Name EAST PECOS FEDERAL 22		Well Number 11H
GRID No. 246289	Operator Name RKI EXPLORATION & PRODUCTION		Elevation 2879

## Surface Location

UL or lot no.	Section	Township	Range	Lot Idn	Feet from the	North/South line	Feet from the	East/West line	County
N	22	26S	29E		150	S	1380	W	EDDY

## Bottom Hole Location If Different From Surface

UL or lot no.	Section	Township	Range	Lot Idn	Feet from the	North/South line	Feet from the	East/West line	County
C	22	26S	29E		230	N	1650	W	EDDY

Dedicated Acres	Joint or Infill	Consolidated Code	Order No.
320.0			

No allowable will be assigned to this completion until all interests have been consolidated or a non-standard unit has been approved by the division.

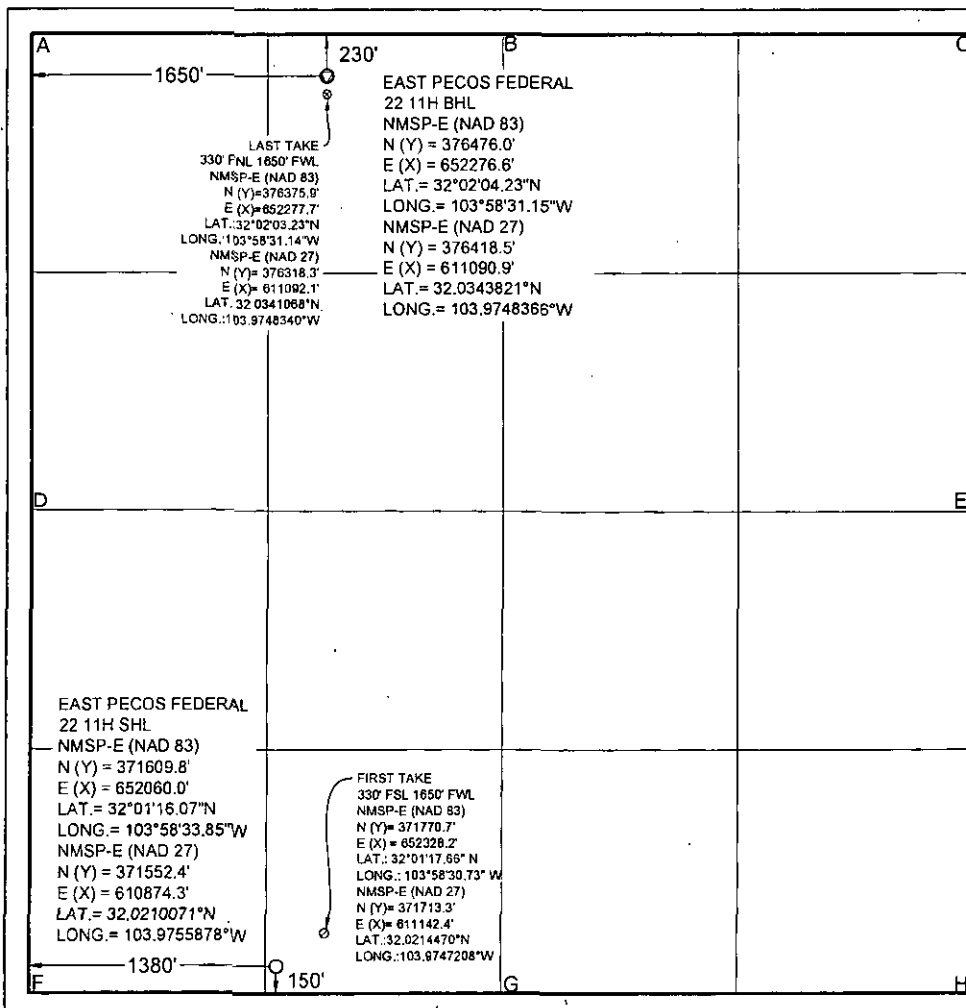

## OPERATOR CERTIFICATION

I hereby certify that the information contained herein is true and complete to the best of my knowledge and belief, and that this organization either owns a working interest or unleased mineral interest in the land including the proposed bottom hole location or has a right to drill this well at this location pursuant to a contract with an owner of such a mineral or working interest, or to voluntary pooling agreement or a compulsory pooling order heretofore entered by the division.

Signature: Heather Brehm  
Date: 05.02.16

Print Name: Heather Brehm

E-mail Address: heather.brehm@wpenergy.com

heather.brehm@wpenergy.com  
E-mail Address

## SURVEYORS CERTIFICATION

I hereby certify that the well location shown on this plat was plotted from field notes of actual surveys made by me or under my supervision, and that the same is true and correct to the best of my belief.

Date of Survey: MARCH 30, 2016

Signature and Seal of Professional Surveyor

Signature and Seal of Professional Surveyor

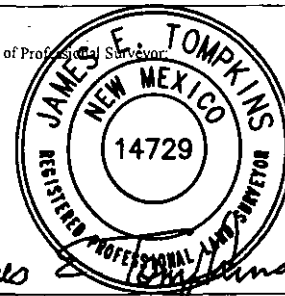

Job No.: WTC51102

James E. Tompkins 14729

Certificate Number